

NOISE & VIBRATION MANAGEMENT PLAN

Sutton Wharf, Rochehall Way, Purdeys Industrial Estate, Rochford, SS4 1JU

Allsort Grab Services Ltd

Version:	1.0	Date:	07 March 2023		
Doc. Ref:	3117-002-B	Author(s):	TB/IA	Checked:	ASG
Client No:	3117	Job No:	002		



Oaktree Environmental Ltd

Waste, Planning & Environmental Consultants

Oaktree Environmental Ltd, Lime House, 2 Road Two, Winsford Industrial Estate, Winsford, Cheshire, CW7 3QZ
Tel: 01606 558833 | E-Mail: sales@oaktree-environmental.co.uk | Web: www.oaktree-environmental.co.uk
REGISTERED IN THE UK | COMPANY NO. 4850754

© OAKTREE ENVIRONMENTAL LTD – THE UNAUTHORISED COPYING OR REPRODUCTION OF THIS DOCUMENT (OR PART THEREOF) IS STRICTLY PROHIBITED

Document History:

Version	Issue date	Author	Checked	Description
1.0	07/03/2023	IA/TB	IA	Document issue

CONTENTS

DOCUMENT HISTORY:	I
CONTENTS	II
LIST OF TABLES	III
LIST OF APPENDICES:.....	III
1 INTRODUCTION	4
1.1 SITE HISTORY / BACKGROUND	4
1.2 SITE DESCRIPTION AND PROPOSED DEVELOPMENT	4
1.3 HOURS OF OPERATION	5
2 SENSITIVE RECEPTORS	6
2.1 RECEPTOR PLAN	6
2.2 LIST OF RECEPTORS	6
2.3 OTHER NOISE SOURCES	7
3 NOISE MANAGEMENT AND CONTROLS	8
3.1 NOISE SENSITIVE RECEPTORS	8
3.2 NOISE SOURCES	8
3.3 NOISE MANAGEMENT TABLE	9
3.4 MONITORING AND RECORDING	14
3.5 MONITORING	14
3.6 EMERGENCIES.....	15
4 ACTIONS WHEN COMPLAINTS ARE RECEIVED	16
4.1 COMPLAINTS PROCEDURE	16
4.2 COMPLAINTS RECORDING	17
4.3 KEY RESPONSIBILITIES	17
5 TRAINING	18
5.1 TRAINING REGIME.....	18
5.2 VEHICLE / PLANT PREVENTATIVE MAINTENANCE TRAINING	18
5.3 LIAISON WITH NEIGHBOURS	18

List of Tables

Table 2.1 – Distances to Selected, Representative Sensitive Locations.....	6
Table 2.2 – Other Noise Emitting Operators.....	7
Table 3.1 – Noise Management Table.....	10
Table 4.1 – Key Responsibilities	17

List of Appendices:

Appendix I - Drawings

Appendix II - Complaints Procedure and Recording Form

1 Introduction

1.1 Site history / background

1.1.1 Oaktree Environmental Ltd have been instructed by Allsort Grab Services Ltd to prepare a Noise & Vibration Management Plan (NVMP) which will outline the methods by which Allsort Grab Services Ltd will assess and minimise the potential impacts of noise generated through the operation of the site situated at Sutton Wharf, Rochehall Way, Purdeys Industrial Estate, Rochford, SS4 1JU.

1.1.2 Reference should be made to the accompanying Noise Impact Assessment (NIA) also produced by Oaktree Environmental which contains specific mitigation and good practice measures derived from this assessment used to inform the Subsequent Noise & Vibration Management Plan (NVMP). These mitigation measures will be put in place by site management. Where appropriate, the site will work to the relevant Appropriate Measures to prevent and reduce noise emissions.

1.1.1 The purpose of this document is to accompany an Environmental Permit (EP) application for the physical treatment facility of non-hazardous waste submitted on behalf of Allsort Grab Services Ltd (the operator). The site proposes to accept, store and treat (via screening and crushing) inert and CDE wastes.

1.2 Site Description and Proposed Development

1.1.3 The site is located on Land at Sutton Wharf, Rochehall Way, Purdeys Industrial Estate, Rochford, SS4 1JU as shown on Drawing No. 3117-002-02. The site is bordered by industrial/commercial premises.

1.2.1 Allsort Grab Services Ltd will hold and operate an Environmental Permit (EP) for the following activities:

- Physical treatment of non-hazardous waste (referenced as 1.16.12 of the EPR 2019 charging tables).

1.2.2 The throughput of the site will be limited to <75,000 tonnes per annum.

1.2.3 The Environmental Permit is required for the storage (keeping) prior to removal, and treatment (all types of handling/processing) of waste i.e. CDE wastes. Waste treatment processes to be carried out on site may include the following:

- Compacting (by loading shovel)
- Sorting (with loading shovel/excavator or by hand)
- Screening (by using appropriate mechanical screening plant and equipment)
- Separation (by using appropriate mechanical screening plant and equipment)
- Crushing (by using appropriate plant and equipment)
- Blending (by loading shovel and trommel)

1.3 Hours of Operation

1.1.4 The waste site will be open during the following hours for all waste operations, i.e. depositing, sorting, moving, storing and removing waste:

Monday to Friday	07:00 – 17:00
Saturday	07:00 – 14:00
Sundays, Bank/Public holidays	Closed

2 Sensitive Receptors

2.1 Receptor Plan

2.1.1 A sensitive receptors plan (SRP) has been produced to accompany this NVMP and is shown in Appendix I. The receptors highlighted are those which are considered to be at risk by noise generated by the site.

2.2 List of receptors

2.1.2 The receptors listed from the SRP are also shown in the table below with approximate distances to these residential properties.

Table 2.1 – Distances to Selected, Representative Sensitive Locations

Boundary	Receptor	Approximate distance from site (m)
North	Runwood Homes Senior Living	365
South / southeast	Commercial/Residential property / units	>300
East	Crouch & Roach Estuaries (Mid-Essex Coast Phase 3) (SPA)	60
North / East / South	Blackwater, Crouch, Roach and Colne Estuaries (MCZ)	60
East	Essex Estuaries (SAC)	213
East	Crouch and Roach Estuaries (RAMSAR)	213
East	Crouch and Roach Estuaries (SSSI)	213
North / Northwest / South / Southwest	Fish migratory routes (Protected fish migratory routes)	60

2.1.3 For full details of the existing noise level at these locations as well as a subjective assessment of the existing noise climate, reference should be made to the accompanying NIA.

2.3 Other noise sources

2.1.4 The site is located within an established industrial estate with numerous surrounding commercial/industrial uses. Other land uses which will contribute to the background noise level are tabulated below in the Table below:

Table 2.2 – Other Noise Emitting Operators

Company	Address	Type of Business	Approximate distance from site boundary (m)
Sutton Wharf boatyard	Rocehall Way, Purdeys Industrial Estate, Rochford, SS4 1JU	Industrial/commercial	Adjacent / north & east
Public Sewer Services	Rocehall Way, Purdeys Industrial Estate, Rochford, SS4 1JU	Industrial/commercial	125 / north west
Apparent waste management facility	Welton Way, Purdeys Industrial Estate, Rochford, SS4 1JU	Waste recycling facility	350 / north west
Apparent waste management facility	Welton Way, Purdeys Industrial Estate, Rochford, SS4 1JU	Waste recycling facility	420 / north west
Apparent waste management facility	Welton Way, Purdeys Industrial Estate, Rochford, SS4 1JU	Waste recycling facility	520 / north west
Apparent waste management facility	Brickfields Way, Purdeys Industrial Estate, Rochford, SS4 1JU	Waste recycling facility	640 / west
Apparent waste management facility	Purdeys Way, Purdeys Industrial Estate, Rochford, SS4 1JU	Waste recycling facility	715 / west

2.1.5 Additional noise emitting operators are also located within the industrial estate.

3 Noise Management and Controls

3.1 Noise Sensitive Receptors

3.1.1 As discussed previously, the site lies within an heavy industrial setting with the nearest noise sensitive residential receptors located between approx. 300m from the site.

3.1.2 The proposed operation and layout of the site has been planned in order to contain all the required operations and activities within the site including the recent construction of the acoustic screen and open fronted waste building, thus limiting the impacts from noise on the above receptors.

3.1.3 In terms of potential noise impact, whilst the development proposed will be operated using the Best Practicable Means at all times, this site-specific NVMP has been prepared in order to ensure the noise levels at the site can be managed appropriately and reduce any impact on the surrounding receptors.

3.2 Noise Sources

3.1.4 It is considered the most significant noise activities with regards to noise levels would comprise the operation of the crushing and screening activities. Additional sources include treatment plant, movement/sorting of wastes, tipping of wastes and loading of HGVs.

3.1.5 The treatment plant and storage areas are located externally but are screened by concrete walls to a height of between 2.1-3.5m which provide noise attenuation. It is considered due to the assessment in the previous sections, the impact associated with activities would be identified as low.

3.1.6 Notwithstanding the above, in order to further limit the potential for noise related impacts associated with the site, the relevant control measures associated with regards to these sources are included within the noise management table in Section 3.1.

3.3 Noise Management Table

- 3.1.7 A site-specific NVMP table overleaf details the above noise sources and how the current and proposed infrastructure on site will reduce the impact of noise to surrounding properties.
- 3.1.8 In addition to the existing controls in this NVMP, the complaints procedure further discussed in Section 4 will be used in the event that any noise complaints are received. If a noise complaint is received and the applicant has been made aware, immediate action will take place reviewing and identifying whether any changes to existing procedures are required or if new procedures need to be put in place. Any changes which may be required will be implemented immediately.

Table 3.1 – Noise Management Table

Source(s)	Receptor(s)	Consequences	Probability of noise disturbance	Remedial Action/ Recommendations/ Comments	Assessment Outcome following actions / recommendations
HGVs travelling to and from the site for delivery/ collection of products	As detailed on Sensitive Receptors Plan	Noise pollution	Low	<p>Site management will aim to ensure that vehicle movements are spread out evenly throughout the day.</p> <p>All drivers are required to enter and exit the site with due consideration for neighbours.</p> <p>The existing access road to the site will be maintained in good state of repair to prevent unnecessary noise being generated.</p> <p>Implementation of a 5mph speed limit onsite.</p> <p>All skip lorries operated by Allsort Grab Services Ltd be fitted with chain socks in order to reduce the noise produced by the loose chains banging on the side of the skip.</p> <p>All vehicles associated with the site be fitted with white noise reversing alarms Engines to be switched off when not in use.</p>	Very low
Vehicles tipping waste deliveries into the waste reception areas	As detailed on Sensitive Receptors Plan	Noise pollution	Low	<p>The waste tipping areas are located to the south as prescribed in the site layout plan and benefits from immediate screening via the concrete walls.</p> <p>Drivers must lower the tipper body before driving away from the tipping area.</p> <p>Drop heights will be kept to a minimum to reduce noise levels.</p> <p>Management will ensure that all vehicles involved in the tipping of waste operated by Allsort Grab Services Ltd are functioning suitable i.e. vehicles must be well maintained and operated with silencers and moving parts to be regularly lubricated.</p> <p>All vehicles will benefit from white noise reverse alarms.</p>	Very Low / Negligible

Source(s)	Receptor(s)	Consequences	Probability of noise disturbance	Remedial Action/ Recommendations/ Comments	Assessment Outcome following actions / recommendations
Loading and operation of waste into crusher and screener.	As detailed on Sensitive Receptors Plan and in Section 2 of this document	Noise pollution	Med	<p>Drop heights will be kept to a minimum in order to reduce the produced levels of noise / vibration</p> <p>Management will ensure that all loading plant operated by Allsort Grab Services Ltd is functioning suitably i.e. moving parts to be regularly lubricated.</p> <p>The main plant treatment area is located in the south/southeast of the site and is screened by acoustic walls to the south. The plant will be located as close to the walls as possible in order to ensure the maximum attenuation by the screening.</p> <p>Operatives will be informed to turn off engines when the plant is not in use and no revving of engines will be permitted at the site.</p> <p>Any malfunctions in plant i.e. missing screws/bolts which result in excessive noise will be de-commissioned until an alternative loading plant sourced.</p> <p>Typically crushing activities and screening of soil will not be carried out every day, this will be seasonal and usually April to October only. This will typically be 1-2 days per week and be limited to 4 hours per day, undertaken between 09:00-16:00</p>	Low
Loading waste into HGVs/skip wagons	As detailed on Sensitive Receptors Plan and in Section 2 of this document	Noise pollution	Med - Low	<p>Drop / loading heights will be kept to a minimum to prevent excessive noise.</p> <p>The loading areas are located to the south of the acoustic bays and perimeter walls which will offer acoustic screening.</p> <p>Plant operatives will be instructed / trained to not scrape or bang the loading shovel bucket on the floor creating noise/vibration prior to deposit.</p>	Low
Manoeuvring of plant around external areas of the site	As detailed on Sensitive Receptors Plan and in Section 2 of this document	Noise pollution	Med - Low	<p>Management will ensure that all site vehicles operated by Allsort Grab Services Ltd are functioning suitable i.e. vehicles must be well maintained and operated with silencers and moving parts to be regularly lubricated.</p> <p>The site will be relatively flat and maintained in good state of repair to prevent unnecessary banging of vehicles on uneven ground.</p> <p>A maximum speed limit of 5mph will be maintained.</p> <p>Drivers will be informed to turn off engines when the vehicle is not in use and no revving of engines will be permitted at the site.</p> <p>All vehicles will benefit from white noise reverse alarms.</p>	Low

Source(s)	Receptor(s)	Consequences	Probability of noise disturbance	Remedial Action/ Recommendations/ Comments	Assessment Outcome following actions / recommendations
Small vehicles travelling to and from the site (e.g. staff and visitor's cars, courier van deliveries etc.)	As detailed on Sensitive Receptors Plan and in Section 2 of this document	Noise pollution	Low	All those working on and visiting the site to be made aware of need for considerate driving and keeping vehicles well maintained. Small vehicles will arrive marginally earlier than the main site operating hours.	Very Low / Negligible
Repairs	As detailed on Sensitive Receptors Plan and in Section 2 of this document	Noise pollution	Low	If repairs to the site are required, the work is to be undertaken with due regard for the possible noise nuisance and during the normal working day. In the event of major repair work being undertaken which is likely to cause significant noise and disruption, neighbouring residents and the EA will be notified in advance.	Very Low / Negligible

3.4 Monitoring and recording

- 3.1.9 **Assessment** - Site management i.e. The site manager, compliance manager or TCM will subjectively monitor noise levels in and around the entire site perimeter throughout the day. Should it be deemed necessary by site management, monitoring using an appropriate Type 1 Sound Level Meter will be carried out while the site is operational should it be observed that unacceptable levels of noise are being emitted from the site.
- 3.1.10 The results of monitoring exercises and any remedial action taken will be entered into the site's diary or log book which is available for the EA to inspect upon request. The name of the inspector will be stated in the site's diary / inspection form for each day of operation.
- 3.1.11 Should the monitoring conclude that a certain activity is giving rise to noise which is causing unacceptable impacts, steps will be made to reduce the impact of this activity and will be agreed with the EA prior to commencement.
- 3.1.12 Site management will be suitably trained to carry out these duties and delegate to operational staff. Further information regarding training and technical competence is provided within the site's EMS.

3.5 Monitoring

- 3.1.13 Operational staff will continuously monitor noise emissions whilst the treatment plant is in operation and will control noise levels using the procedures listed above, asking site management for advice as required. Work procedures will be stopped/adjusted should it be evident significant noise is being generated which has the potential to cause annoyance.
- 3.1.14 Site management will also be required to make a note of any unavoidable events such as plant failure, in the site diary, rather than just actual complaints received. This will ensure that if complaints are received retrospectively from either the EA or directly, any circumstances which led to that complaint as a result of elements outside of the

operator's control would be able to be attributed (or, at least, in part) to the cause of the complaint.

3.6 Emergencies

3.1.15 In the event of any unforeseen circumstances i.e. faulty equipment, the site manager will make an assessment of whether to cease activities/all operations with the main emphasis on site will be to reduce any noise impacts.

4 Actions when complaints are received

4.1 Complaints procedure

- 4.1.1 If any noise complaints are received, the relevant operator will complete a 'complaints and events log' and detailed individually on the complaints form (in Appendix II), both of which will be kept for inspection on request by the LA, EA or third parties. Details of information to be completed are dates, nature of complaint, weather conditions at the time of the complaint, investigation details, action taken and a signature (as a minimum).
- 4.1.2 The operator would also be required to make a note of any unavoidable events plant/equipment malfunctions in the site diary, rather than just actual complaints received. This will ensure that if complaints are received retrospectively from either the Council/EA or third parties, any circumstances which led to that complaint as a result of elements outside of the operator's control would be able to be attributed to the cause of the complaint.
- 4.1.3 It must be noted that the site lies adjacent to several industrial uses, so in the event of a complaint, the operator will substantiate the complaint by carrying out noise monitoring to identify whether the complaint is valid. If the complaint is valid, the site will implement the complaint procedures check and if required, amend site operations.
- 4.1.4 If the source cannot be ascertained with 100% confidence, site management will either suspend or reduce the likely noise generating activities.
- 4.1.5 If the source is within the site's control, site management will take appropriate action to ensure the issue has been rectified. This may take the form of the following:
- i) Investigating the source to prevent a re-occurrence.
 - ii) Suspending operations which are not being conducted using best-practice controls.
 - iii) Investigate noise mitigation measures

- iv) Logging findings of a – c in the site diary / complaints form and also in the reporting template within the EP.

4.2 Complaints recording

4.1.6 Any complaints received in relation to noise and vibration will be recorded on the form shown in Appendix II. This form will normally be completed, signed and dated by the site manager, compliance manager or TCM, if they are not available, the office manager

4.3 Key responsibilities

4.1.7 The table below outlines the key responsibilities and the staff member responsible for each task.

Table 4.1 – Key Responsibilities

Task	Staff position responsible
Noise monitoring and ongoing assessment	Site manager + operative
Vehicle maintenance	Specialist contractor
Overseeing of deliveries	Site manager + operative

5 Training

5.1 Training regime

5.1.1 All employees and sub-contractors of Allsort Grab Services Ltd involved with potentially noisy operations will receive training in noise and vibration monitoring and complaint reporting.

5.1.2 Training will be given to all relevant persons to make sure they are competent in completing noise and vibration survey forms, noise and vibration complaint report forms and the site diary to ensure sufficient monitoring of noise and vibration can be carried out and any problems addressed correctly.

5.1.3 When selecting new plant and equipment, consideration shall be given to the need to meet all legislation and statutory guidance on noise levels and to minimise levels of noise from selected equipment.

5.2 Vehicle / plant preventative maintenance training

5.1.4 This training is provided specifically for the vehicle and plant operators in order to ensure that all plant and machinery is checked regularly to prevent any occurrences which may lead to any adverse impacts on the environment or human health.

5.1.5 Training will be based on the preventative maintenance schedule supplied by the plant/equipment manufacturer.

5.1.6 The same training will be provided to senior management enabling a dual-level maintenance programme.

5.3 Liaison with neighbours

5.1.7 In the extreme event of a significant, but temporary, increase in noise and vibration from the site, neighbours will be contacted to advise them of the occurrence and action being taken to remediate the issue on site.

- 5.1.8 An open-door policy will be encouraged by the operator to enable any complaints from neighbouring premises (if received) to be dealt with immediately. The complainant will then be supplied with remedial actions taken and any procedures or measures put in place by the operator to reduce or ideally eradicate the likelihood of a subsequent complaint.

Appendix I

Drawings



NOTES

Drawing for indication only. Reproduced with the permission of the controller of H.M.S.O. Crown copyright licence No. 100022432. This drawing is copyright and property of Oaktree Environmental Ltd.

REVISION HISTORY

Rev:	Date:	Init:	Description:
-	17.02.22	IA	Initial drawing
A	27.04.22	IA	Layout changes

KEY:

-  Permit boundary
-  Denotes perimeter wall comprising 7ft high concrete wall (14ft high micro-dust netting installed above).

Oaktree Environmental Ltd
Waste, Planning and Environmental Consultants

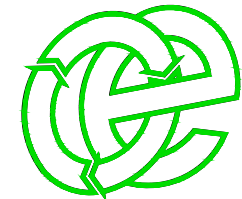

DRAWING TITLE
SITE LAYOUT PLAN

CLIENT
Allsort Grab Services Ltd

PROJECT/SITE
Sutton Wharf, Rochehall Way, Purdeys Industrial Estate, Rochford, SS4 1JU

SCALE @ A4 1:500	CLIENT NO 3117	JOB NO 001
----------------------------	--------------------------	----------------------

DRAWING NUMBER 3117-001-03	REV A	STATUS Issued
--------------------------------------	-----------------	-------------------------

DRAWN BY IA	CHECKED IA	DATE 27.04.22
-----------------------	----------------------	-------------------------

Lime House, Road Two, Winsford, Cheshire, CW7 3QZ
t: 01606 558833 | e: sales@oaktree-environmental.co.uk

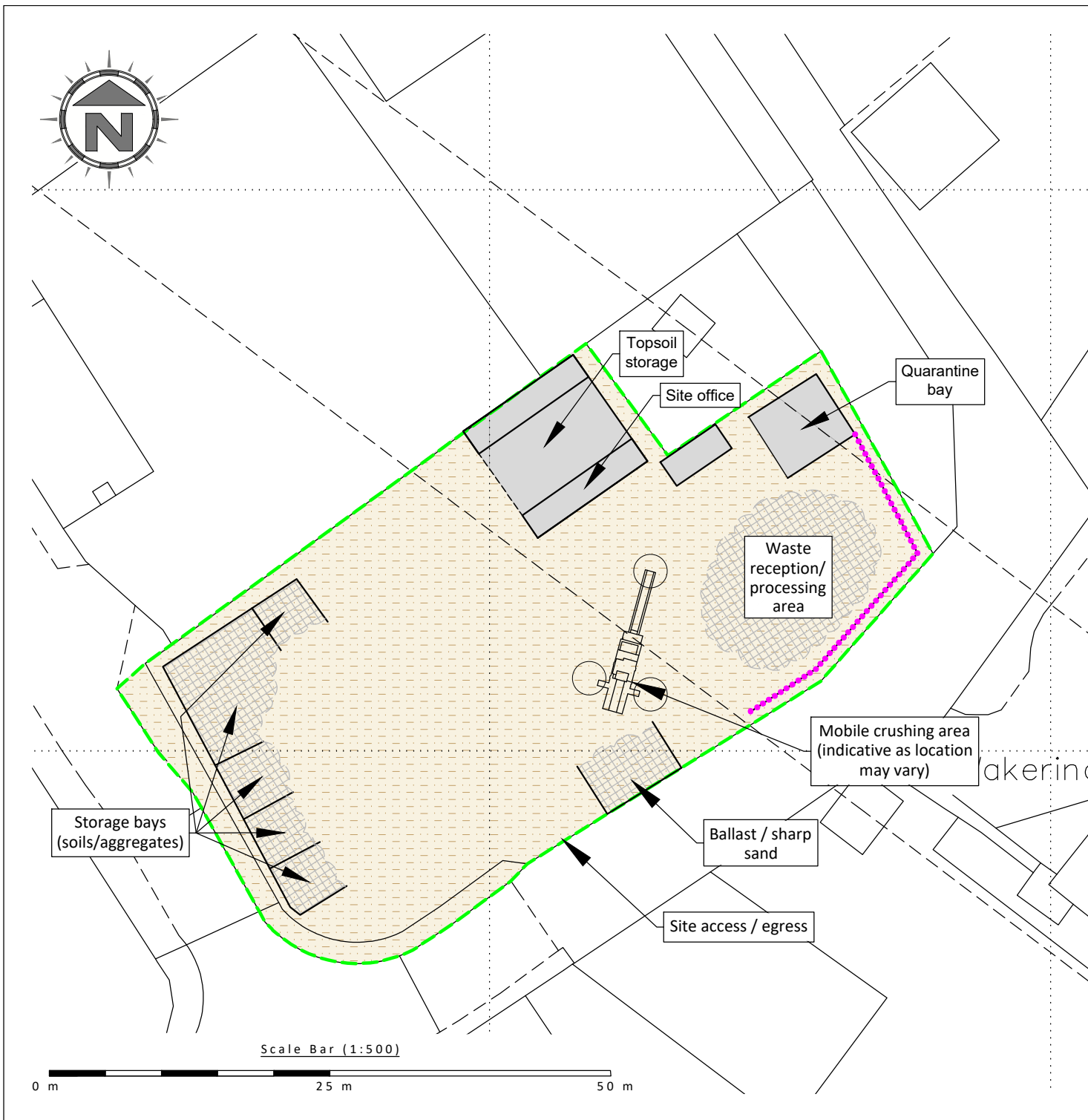

KEY:

- Permit boundary
- Main River
- Surface water body (river / stream / pond / pool / lake)
- Workplaces (includes agriculture industry, commerce and retail)
- Residential blocks
- Class A roads
- Class B roads
- Class C roads
- SCH School
- Woodland areas
- Protected sites (Ramsar, SSSI, SPA, SAC)
- Marine conservation zone
- Migratory fish routes - fish/eel (open) **If applicable** - information taken from 'Essex Fish Migration Roadmap' & 'Greater Thames Estuary Fish Migration Roadmap'
- Migratory fish routes - fish/eel (closed) **If applicable** - information taken from 'Essex Fish Migration Roadmap' & 'Greater Thames Estuary Fish Migration Roadmap'
- Barriers

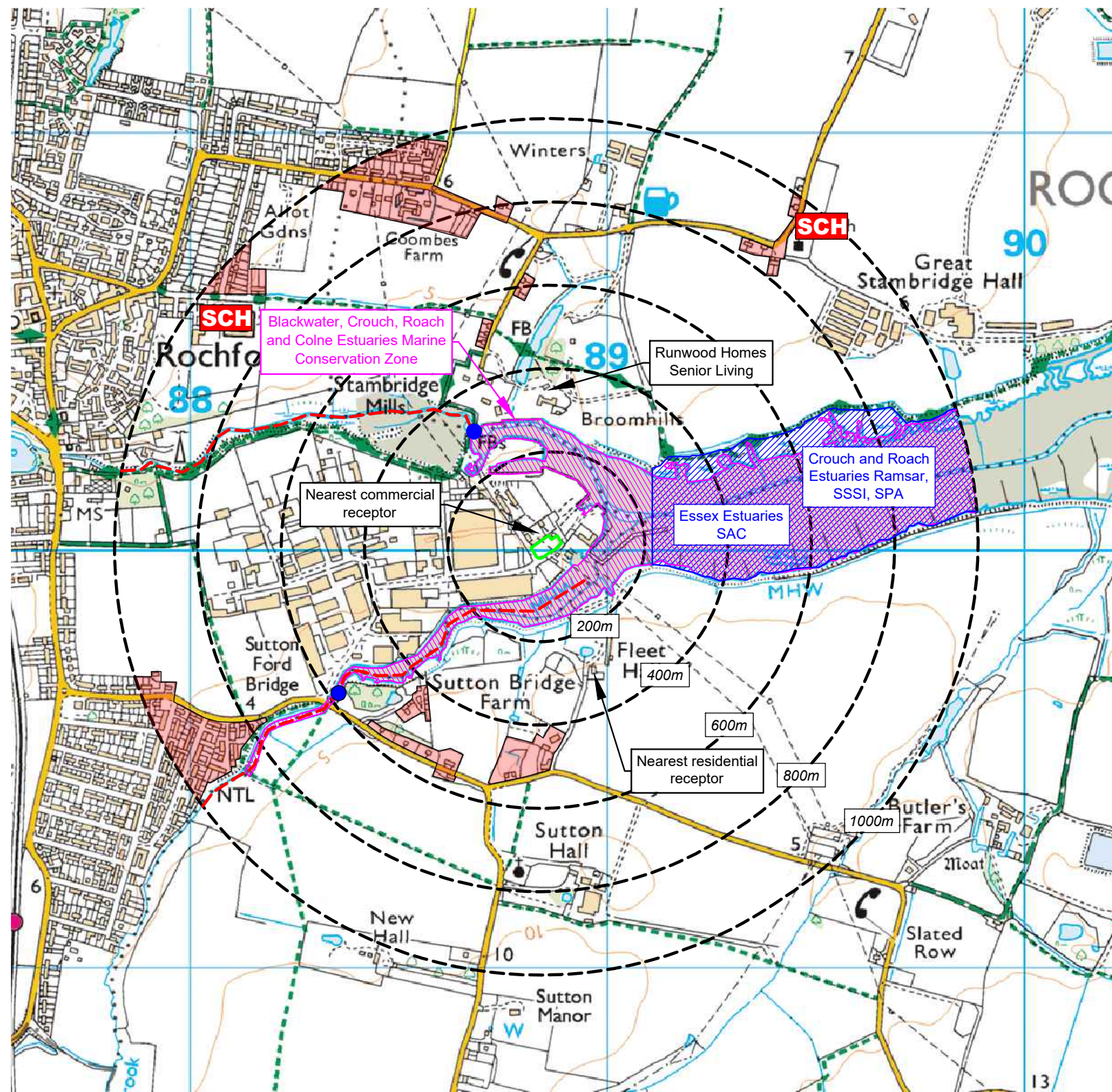
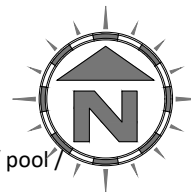

Compass Wind Rose for Southend (EGMC) Period 1988-2022
- source: Iowa State University

NOTES

1. Boundaries are shown indicatively.
2. Wind rose data shows the prevailing wind direction to be Southerly.

Drawing for indication only. Reproduced with the permission of the controller of H.M.S.O. Crown copyright licence No. 100022432. This drawing is copyright and property of Oaktree Environmental Ltd.

REVISION HISTORY

Rev:	Date:	Init:	Description:
-	17.02.22	IA	Initial drawing
A	06.03.23	IA	EA comments

Oaktree Environmental Ltd
Waste, Planning and Environmental Consultants

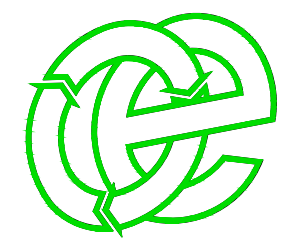

DRAWING TITLE
RECEPTOR PLAN

CLIENT
Allsort Grab Services Ltd

PROJECT/SITE
Sutton Wharf, Rochehall Way, Purdeys Industrial Estate, Rochford, SS4 1JU

SCALE @ A3 1:12,500	CLIENT NO 3117	JOB NO 001
-------------------------------	--------------------------	----------------------

DRAWING NUMBER 3117-001-04	REV A	STATUS Issued
--------------------------------------	-----------------	-------------------------

DRAWN BY IA	CHECKED --	DATE 06.03.23
-----------------------	----------------------	-------------------------

Lime House, Road Two, Winsford, Cheshire, CW7 3QZ
t: 01606 558833 | e: sales@oaktree-environmental.co.uk

Appendix II

Complaints Procedure and Recording Form

COMPLAINTS PROCEDURE

- 1) Any complaints received in relation to noise and vibration will be recorded on the form below. This form will normally be completed, signed and dated by the site operator, if they are not available, the Office Manager will complete the form.
- 2) The name, address and telephone number of the caller will be requested.
- 3) Each complaint will be given a reference number.
- 4) The caller will be asked to give details of:
 - the nature of the complaint;
 - the time;
 - how long it lasted;
 - how often it occurs;
 - is this the first time the problem has been noticed; and,
 - what prompted them to complain.
- 5) The person completing the form will then, if possible, make a note of:
 - the weather conditions at the time of the problem (rain snow fog etc.)
 - strength and direction of the wind; and,
 - the activity on the site at the time the noise was detected, particularly anything unusual.
- 6) The reason for the complaint will be investigated and a note of the findings added to the report.
- 7) The caller will then be contacted with an explanation of the source of the complaint if identified and the action taken to prevent a recurrence of the problem in future.
- 8) If the caller is unhappy about the outcome or unwilling to identify themselves the caller will be referred to the EA.
- 9) Following any complaint the complaints procedure will be reviewed to see if any changes are required or if new procedures need to be put in place.

Complaints Report Form	
Date Recorded	Reference Number
Name and address of caller	
Telephone number of caller	
Time and Date of call	
Nature of complaint (noise, vibration) (date, time, duration)	
Weather at the time of complaint (rain, snow, fog, etc.)	
Wind (strength, direction)	
Any other complaints relating to this report	
Any other relevant information	
Potential reasons for complaint	
The operations being carried out on site at the time of the complaint	
Follow Up	
Actions taken	
Date of call back to complainant	
Summary of call back conversation	
Recommendations	
Change in procedures	
Changes to Written Management System	
Date changes implemented	
Form completed by	
Signed	
Date completed	