

MANHOLE SCHEDULE								
MH No.	MANHOLE DIAMETER (mm)	MANHOLE TYPE	COVER LEVEL (m)	INVERT LEVEL (m)	SOFFIT LEVEL (m)	DEPTH TO SOFFIT (m)	EASTING (m)	NORTHING (m)
S1	2100	Type C	33.350	32.250	32.55	0.800	442076.828	391110.365
S2	1500	Type C	33.235	32.100	32.550	0.685	441971.125	391298.326
S2a	1500	Type C	33.195	31.925	32.450	0.745	441990.547	391263.357
S3	1500	Type C	33.231	32.200	31.750	1.481	442047.105	391163.135
S3a	1500	Type C	33.185	32.075	32.600	0.585	442037.193	391180.506
S3b	1500	Type C	33.235	31.956	32.556	0.679	442028.480	391195.776
S4	1500	Type C	33.200	31.806	32.406	0.794	441999.045	391248.059
S5	1500	Type B	33.527	31.738	32.263	1.264	441975.516	391235.428
S6	1500	Type B	33.515	31.725	32.250	1.265	441971.561	391243.586
S7	1200	Type B	33.497	31.714	31.864	1.633	441953.652	391280.122
PS	TBC	Type B	33.525	31.677	31.827	1.698	441949.238	391284.924
S8	900	Type B	33.624	32.474	32.624	1.200	441934.989	391388.540
S9	900	Type B	33.689	32.399	32.549	1.340	441927.519	391409.911
S10	900	Type B	33.675	32.097	32.247	1.428	441899.518	391496.072
S11	900	Type B	33.086	31.791	31.941	1.144	441880.311	391585.616
S12	900	Type B	33.286	31.755	31.905	1.382	441870.059	391589.815
S13	900	Type B	33.187	31.700	31.850	1.337	441870.054	391601.321
S14	900	Type B	33.171	31.680	31.830	1.341	441870.054	391602.886
EXS-1	N/A	Unknown	32.130	31.084	31.184	0.946	441910.061	391664.833
EXS-2	N/A	Unknown	32.170	29.630	n/a	Unknown	441917.768	391667.746
EXS-3	N/A	Unknown	32.170	30.070	30.295	1.875	441934.881	391609.787

- DRAINAGE NOTES**
- ALL DRAINAGE CONSTRUCTION TO BE DONE IN ACCORDANCE WITH SEWERS FOR ADOPTION 8th EDITION.
  - THE CONTRACTOR IS TO WORK IN ACCORDANCE WITH ALL APPROPRIATE GUIDANCE AND ACCEPTED GOOD PRACTICE INCLUDING HSE PUBLICATION HS647.
  - THE CONTRACTOR SHALL BE RESPONSIBLE FOR ESTABLISH THE EXTENT OF ALL PREVIOUS BUILDING FOUNDATIONS AND OBSTRUCTIONS ON THE SITE WHATEVER MEANS NECESSARY PRIOR TO WORKS COMMENCING.
  - THE CONTRACTOR SHALL BE RESPONSIBLE FOR DIVERSION AND OR PROTECTION OF ALL SERVICES WITHIN THE ZONE OF WORKS. THE CONTRACTOR SHALL BE RESPONSIBLE FOR IDENTIFYING ALL SUCH SERVICES WITH THE VARIOUS UNDERTAKERS AND CONFIRMING THEIR LOCATION PRIOR TO UNDERTAKING ANY WORKS.
- HAZARD NOTES**
- ALL EXISTING SERVICES HAVE BEEN TRACED BY A GPR SURVEY COMPLETED BY CENTRA LTD, DRAWING REF: 190871. THOUGH EXISTING SERVICES HAVE BEEN LOCATED AND DEPTHS RECORDED, SIZE AND DIAMETER OF SERVICES ARE UNKNOWN. IT IS THE CONTRACTOR'S RESPONSIBILITY TO ENSURE THAT WORKS UNDERTAKEN NEAR EXISTING SERVICES THAT HAND DIG TRIAL PITS ARE COMPLETED TO CONFIRM THE POSITIONING AND SIZE OF EXISTING SERVICES. REFER TO BELOW LEGEND AND LAYOUT FOR TYPE AND LOCATION OF EXISTING SERVICES.

- LEGEND**
- PROPOSED STORM DRAINAGE RUN.
  - NEW DRAINAGE GULLY RUN.
  - NEW RISING MAIN.
  - ACCESS ROAD BOUNDARY.
  - STORAGE AREA BOUNDARY.
  - PROCESSING AREA BOUNDARY.

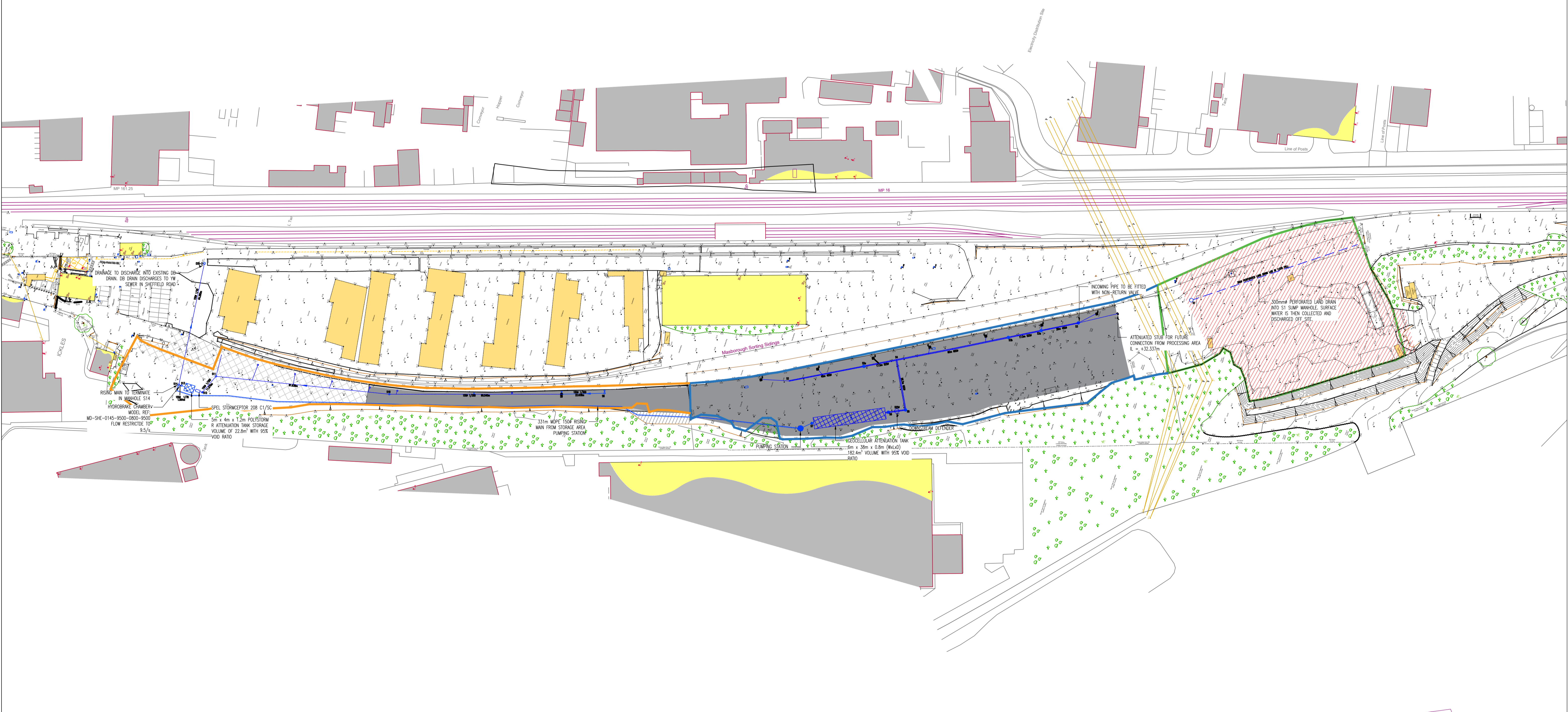

No.	REVISION	by	date	No.	REVISION	by	date

**NOTES**

- Do not scale from this drawing
- All dimensions to be checked on site
- As built drawings are prepared, in part, based upon information furnished by others. While this information is believed to be reliable, James & Nicholas LLP assume no responsibility for the accuracy of As built drawings or for any errors or omissions that may have been incorporated into them as a result of incorrect information provided to us by others. Those relying on an As built drawing are advised to obtain independent verification of its accuracy.

**STAGE**

AS-BUILT

**REFER ALSO TO THE FOLLOWING:**

Drawings:

Bending Schedules:

**CLIENT**

**james&nicholas**

Grove House, Grove Place, Port Talbot SA13 1XA • Tel 01639 885431 • Fax 01639 891687  
 admin@jamesandnicholas.com • www.jamesandnicholas.com  
 James & Nicholas Limited Liability Partnership. Registered in the UK No. OC303071

**Job title**  
 DRAINAGE STRATEGY, BESPOKE PERMIT APPLICATION, ACCESS ROAD AND STORAGE AREA, ROTHERHAM, CELSA

**Drawing title**  
 OVERALL SITE DRAINAGE PLAN

**Job No:** 24.21 **Drawing No.:** C01 **Rev.:** /

**scales:** SCALE 1:1000 @ A1

**drawn:** R.P. 06.03.24  
**checked:** K.J. 06.03.24  
**approved:** K.J.T. 06.03.24

**Copyright** ©