



**HORSE HILL**  
DEVELOPMENTS LTD

## Environmental Permit Application

### SITE LOCATION PLAN AND LAYOUT PLAN

PLAN TITLE	DRAWING NUMBER	REV
Location Plan (Permit Boundary)	ZG-HHD-HH-PROD-EPR-01	1
Indicative Layout Plan Production & Extended Well Test	ZG-HHD-HH-PROD-EPR-03	0
Indicative Layout Plan Drilling	ZG-HHD-HH-PROD-EPR-04	0
Area of Sub-surface	ZG-HHD-HH-PROD-EPR-05	0



KEY:

- PERMIT APPLICATION BOUNDARY
- WATER FEATURES (PONDS, DRAINS)
- UNMADE PUBLIC FOOTPATH  Path (um)

NOTES:

APPLICANT:



REVISION HISTORY				
1	JAN21	JF	REVISED SITE BOUNDARY	JF
0	JAN19	JF	ORIGINAL FOR ISSUE	JF
REV	DATE	BY	DETAILS	APR

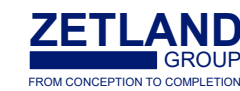

ZETLAND GROUP LIMITED  
THE INNOVATION CENTRE, VIENNA COURT, WINDLEHAM BUSINESS PARK, REDCAR, TS10 5SH  
T: +44(0)1642 77726 E: info@zetlandgroup.com W: www.zetlandgroup.com  
Registered in England No. 0989893 Registered office: The Innovation Centre, Vienna Court, Windleham Business Park, Redcar, TS10 5SH

THIS DOCUMENT IS THE PROPERTY OF ZETLAND GROUP LIMITED. IT CONTAINS PROPRIETARY AND CONFIDENTIAL INFORMATION WHICH MUST NOT BE DUPLICATED, USED OR DISCLOSED OTHER THAN AS EXPRESSLY AUTHORISED BY ZETLAND GROUP LIMITED OR ITS REPRESENTATIVE. © 2021

**SITE:** HORSE HILL WELL SITE, HORSE HILL, HOOKWOOD, HORLEY, SURREY, RH6 0RB

**PROJECT:** APPLICATION FOR ENVIRONMENTAL PERMIT (HYDROCARBON PRODUCTION)

**TITLE:** LOCATION PLAN (PERMIT BOUNDARY)

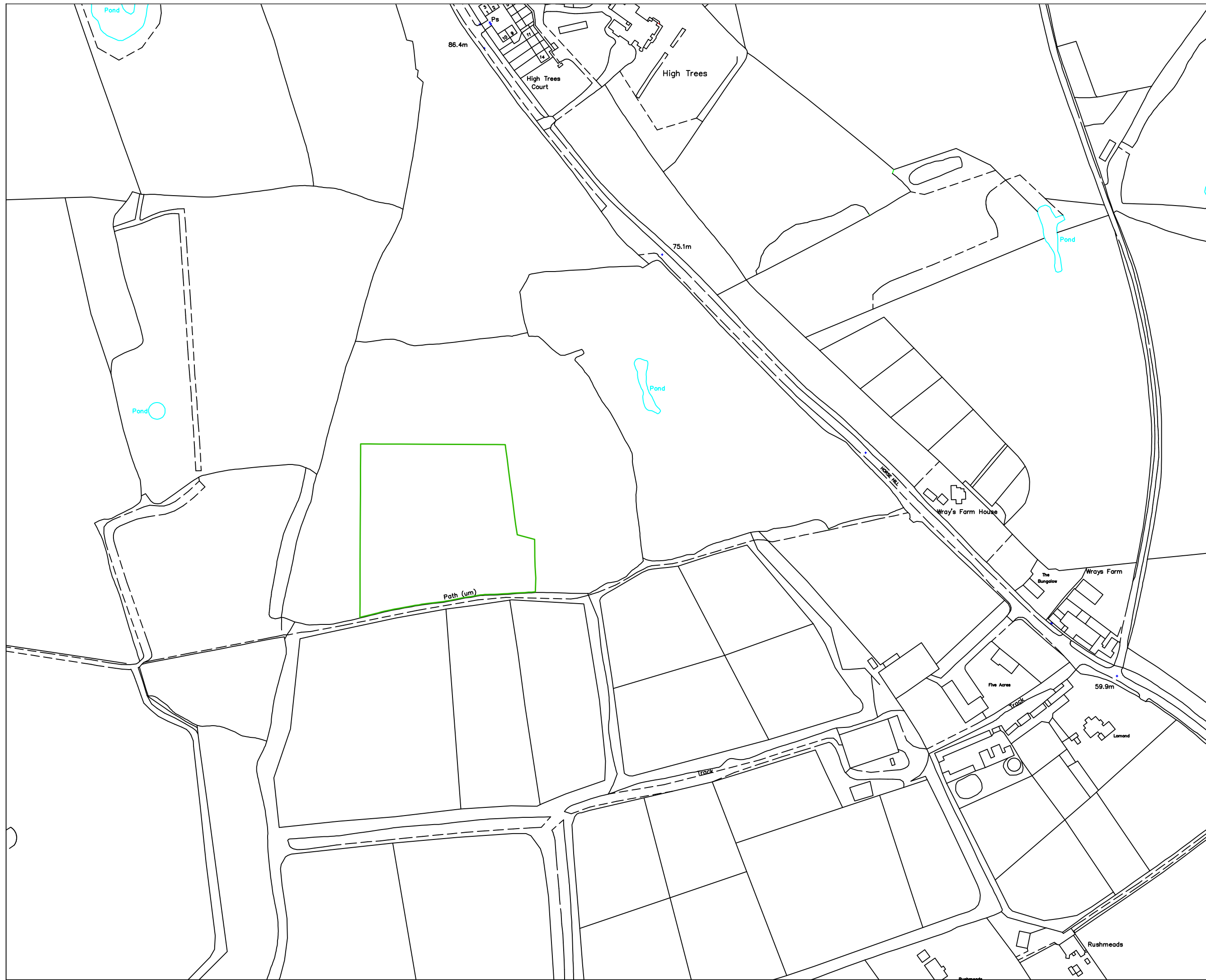



KEY:  
 SITE BOUNDARY   
 PERMITTED ACTIVITIES   
 UNMADE PUBLIC FOOTPATH  Path (um)

NOTES:

APPLICANT:  
**HORSE HILL DEVELOPMENTS LTD**

REVISION HISTORY				
REV	DATE	BY	DETAILS	APR
0	JAN21	JF	ORIGINAL FOR ISSUE	JF
-	-	-	-	-
-	-	-	-	-
-	-	-	-	-

**ZETLAND GROUP**  
 FROM CONCEPTION TO COMPLETION  
ZETLAND GROUP LIMITED  
 THE INNOVATION CENTRE, VIENNA COURT, WINDLEHAM BUSINESS PARK, REDCAR, TS10 5SH  
 T: +44(0)1642 77726 E: info@zetlandgroup.com W: www.zetlandgroup.com  
 Registered in England No. 0988893 Registered office: The Innovation Centre, Vienna Court, Windleham Business Park, Redcar, TS10 5SH

THIS DOCUMENT IS THE PROPERTY OF ZETLAND GROUP LIMITED. IT CONTAINS PROPRIETARY AND CONFIDENTIAL INFORMATION WHICH MUST NOT BE DUPLICATED, USED OR DISCLOSED OTHER THAN AS EXPRESSLY AUTHORISED BY ZETLAND GROUP LIMITED OR ITS REPRESENTATIVE. © 2021

SITE: HORSE HILL WELL SITE, HORSE HILL, HOOKWOOD, HORLEY, SURREY, RH6 0RB

PROJECT: APPLICATION FOR ENVIRONMENTAL PERMIT (HYDROCARBON PRODUCTION)

TITLE: INDICATIVE LAYOUT PLAN - HYDROCARBON PRODUCTION

CLASS 1 OIL / WATER INTERCEPTOR LEADING TO OUTLET 1 AS PER PERMIT NO. BB3691NN

POINT SOURCE EMISSION AS PER PERMIT NO. BB3300XG (PSE-01)

POINT SOURCE EMISSION AS PER PERMIT NO. SP3339YS (PSE-02)

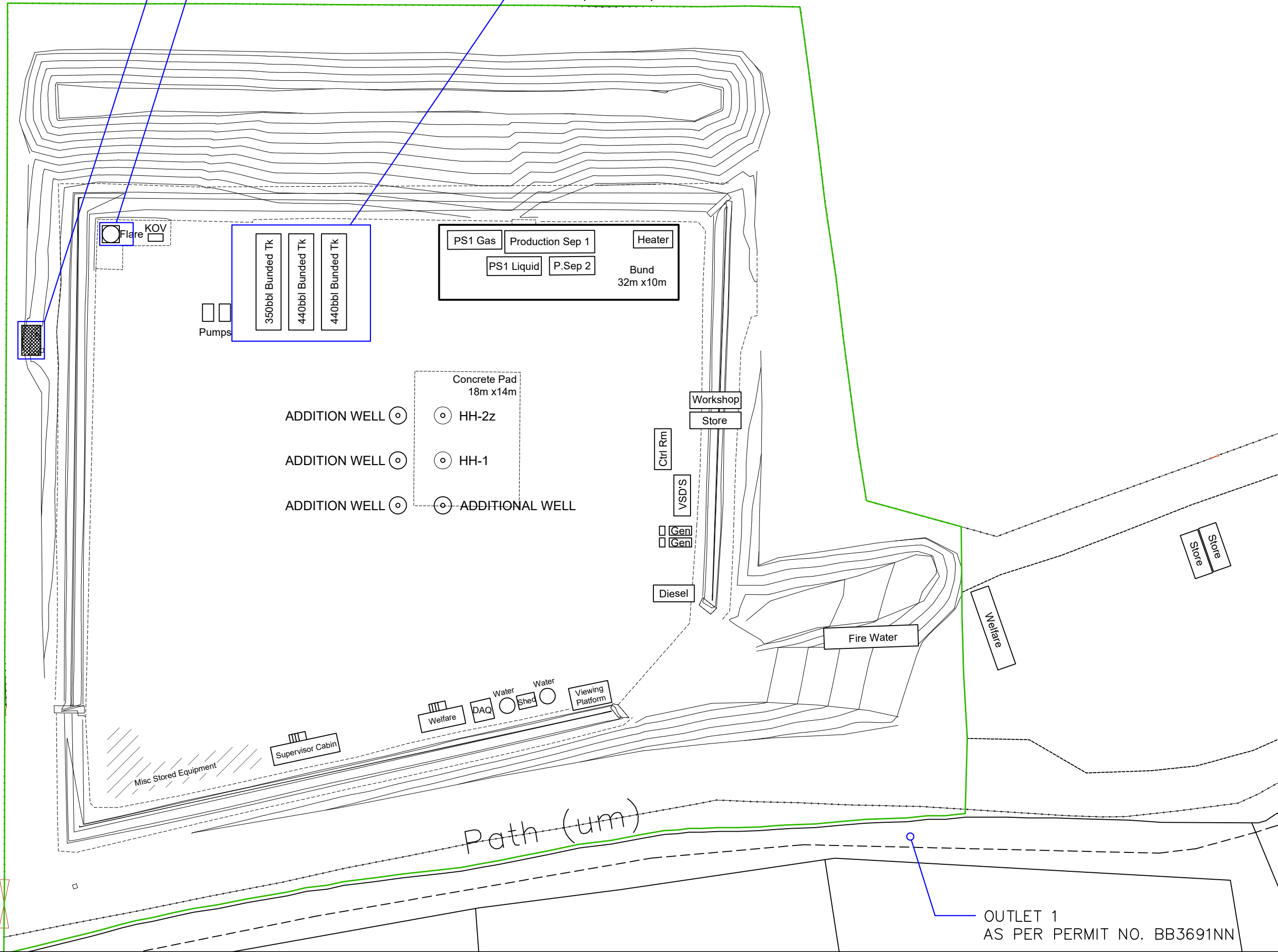

OUTLET 1 AS PER PERMIT NO. BB3691NN



KEY:

- SITE BOUNDARY
- DRILLING RIG EQUIPMENT
- UNMADE PUBLIC FOOTPATH  Path (um)

NOTES:

APPLICANT:



REVISION HISTORY				
REV	DATE	BY	DETAILS	APR
0	JAN21	JF	ORIGINAL FOR ISSUE	JF
-	-	-	-	-
-	-	-	-	-
-	-	-	-	-



ZETLAND GROUP LIMITED  
THE INNOVATION CENTRE, VIENNA COURT, WINDLEHAM BUSINESS PARK, REDCAR, TS10 5SH  
T: +44(0)1642 77726 E: info@zetlandgroup.com W: www.zetlandgroup.com  
Registered in England No. 0988993 Registered office: The Innovation Centre, Vienna Court, Windleham Business Park, Redcar, TS10 5SH

THIS DOCUMENT IS THE PROPERTY OF ZETLAND GROUP LIMITED. IT CONTAINS PROPRIETARY AND CONFIDENTIAL INFORMATION WHICH MUST NOT BE DUPLICATED, USED OR DISCLOSED OTHER THAN AS EXPRESSLY AUTHORISED BY ZETLAND GROUP LIMITED OR ITS REPRESENTATIVE. © 2021

SITE: HORSE HILL WELL SITE, HORSE HILL, HOOKWOOD, HORLEY, SURREY, RH6 0RB

PROJECT: APPLICATION FOR ENVIRONMENTAL PERMIT (HYDROCARBON PRODUCTION)

TITLE: INDICATIVE LAYOUT PLAN - DRILLING OPERATIONS

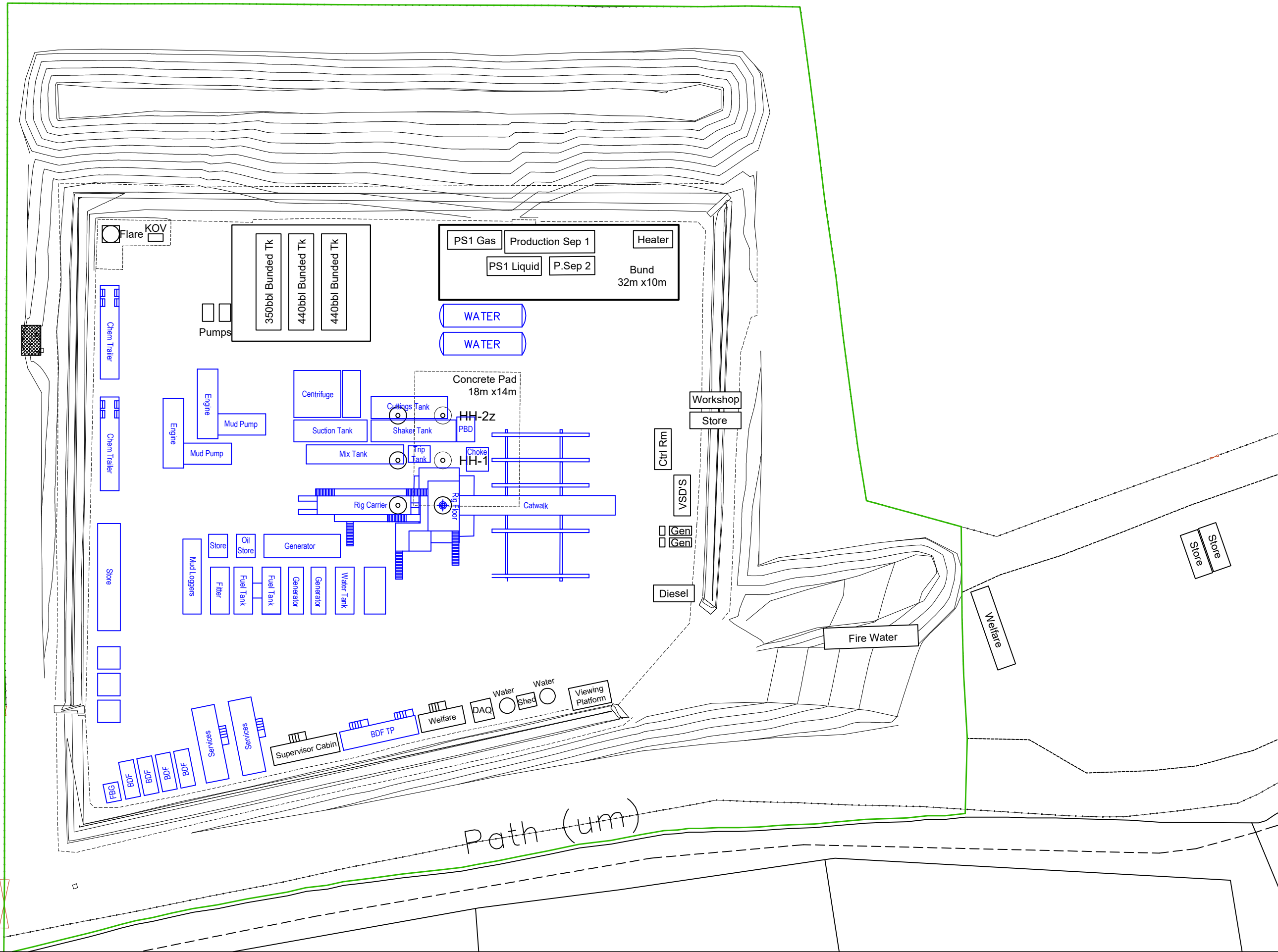

Path (um)



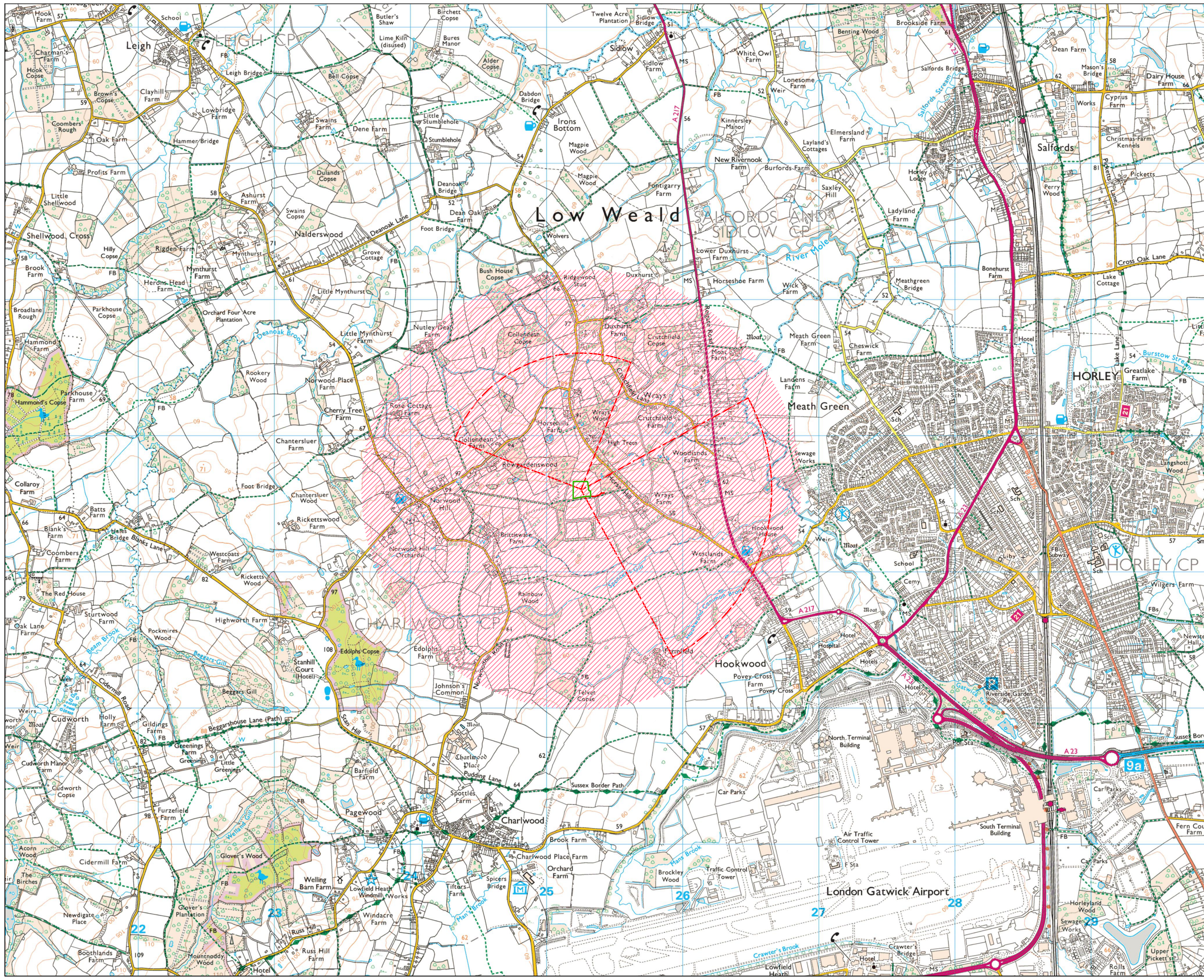

THE ORDNANCE SURVEY DATA ON THIS PLAN HAS BEEN REPRODUCED FROM ORDNANCE SURVEY © BY PERMISSION OF ORDNANCE SURVEY © ON BEHALF OF THE CONTROLLER OF HER MAJESTY'S STATIONERY OFFICE © CROWN COPYRIGHT 2016. ALL RIGHTS RESERVED. LICENCE No. 100022432



- KEY:
- PERMIT APPLICATION BOUNDARY
  - PRODUCTION BOREHOLES
  - ZONE OF DEVIATION
  - AREA OF OIL & GAS EXTRACTION

NOTES:

APPLICANT:

**HORSE HILL DEVELOPMENTS LTD**

REVISION HISTORY				
REV	DATE	BY	DETAILS	APR
0	JAN21	JF	ORIGINAL FOR ISSUE	JF

**ZETLAND GROUP**  
FROM CONCEPTION TO COMPLETION

ZETLAND GROUP LIMITED  
THE INNOVATION CENTRE, VENNA COURT, HORLEYHAM BUSINESS PARK, REDCAR, TS10 5SH  
T: +44(0)1642 77728 E: info@zetlandgroup.com W: www.zetlandgroup.com

THIS DOCUMENT IS THE PROPERTY OF ZETLAND GROUP LIMITED. IT CONTAINS PROPRIETARY AND CONFIDENTIAL INFORMATION WHICH MUST NOT BE DUPLICATED, USED OR DISCLOSED OTHER THAN AS EXPRESSLY AUTHORISED BY ZETLAND GROUP LIMITED OR ITS REPRESENTATIVE © 2021

SITE: HORSE HILL WELL SITE, HORSE HILL, HOOKWOOD, HORLEY, SURREY, RH6 0RB

PROJECT: APPLICATION FOR ENVIRONMENTAL PERMIT (HYDROCARBON PRODUCTION)

TITLE: AREA OF SUB-SURFACE BOREHOLE DEVIATION & AREA OF EXTRACTION

Scale: 1:25,000	DWG. No: ZG-HHD-HH-PROD-EPR-05
Size: A3	
Sheet: 1 of 1	