







**NOTES:**

1. ALL DIMENSIONS IN MILLIMETRES AND ALL LEVELS IN METRES ABOVE ORDNANCE DATUM.
2. DO NOT SCALE FROM THIS DRAWING.
3. ANY ANOMALIES IDENTIFIED WITH THE DETAILS SHOWN ON THIS DRAWING ARE TO BE BROUGHT TO THE ATTENTION OF FCC ENVIRONMENT (UK) LIMITED PRIOR TO CONSTRUCTION WORKS COMMENCING.

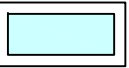
**LEGEND:**

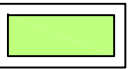
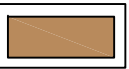
-  Ownership Boundary
-  Operational Area
-  Proposed Area
-  Temporary Capped Area
-  Permanently Capped Area
-  Construction Area
-  To be Capped Nov/Dec 2020
-  Latest Available Ground Contours
-  As-built Cell Footprint

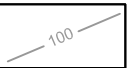
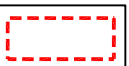
Revision:	Date:	Description:	By:	Chk:
-	-	-	-	-
-	-	-	-	-
-	-	-	-	-

Reference files:  
 Information taken from plans:  
 Site Survey: 604W3182 - 2020 Q2 FULL TOPO AS AT 091020  
 Cell Footprints: 604B3130A

Reproduced from Ordnance Survey Digital maps with the permission of the Controller of Her Majesty's Stationery Office. © Crown copyright. FCC Environment (UK) Limited, 6 Sidings Court, White Rose Way, DONCASTER DN4 5NU, Licence No 0100031673



Site: **BUCKDEN LANDFILL SITE**

Drawing Title: **Annual Site Plan 2021**

Drawn By: BS	Checked By: RH	Date: 05.01.21	Scale: 1:4000	Paper Size: A3
Status: FINAL	Revision: -	Drawing No: <b>604A382</b>	Plan Number: <b>PLAN 2</b>	

Last Saved By: Ben Stocks Date: 17-Mar-2021 09:00:00

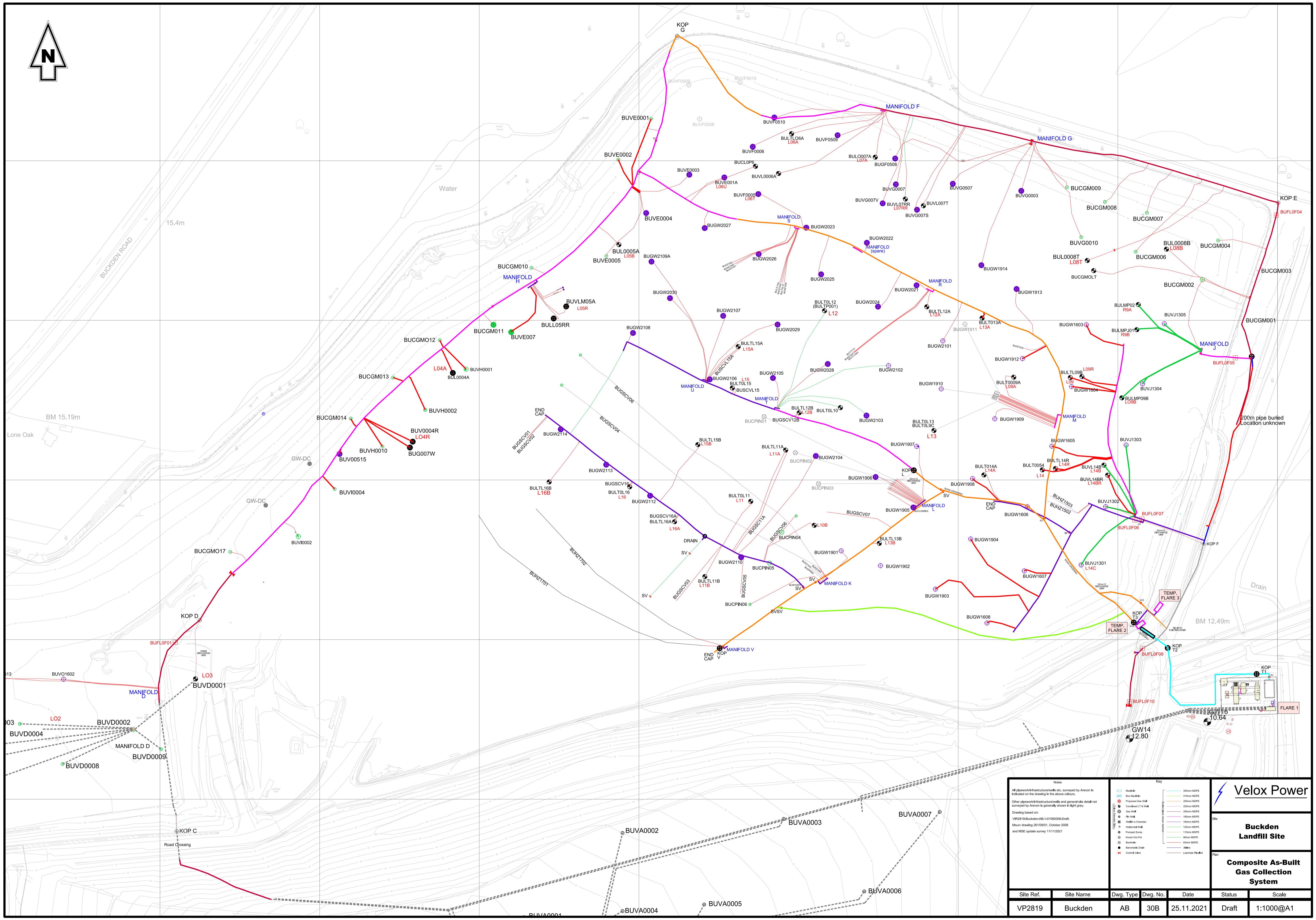

BM 15.19m  
Lone Oak

BM 12.49m

BUVD0001  
BUVD0002  
BUVD0004  
BUVD0008  
MANIFOLD D

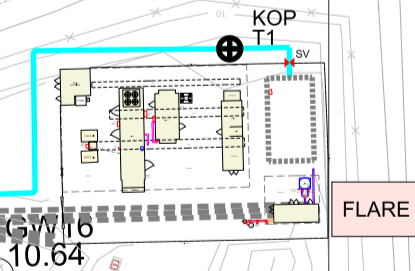

**Notes**

- All pipework/infrastructure/wells etc. surveyed by Arcon is indicated on the drawing in the above colours.
- Other pipework/infrastructure/wells and general site detail not surveyed by Arcon is generally shown in light grey.
- Drawing based on:
  - VR2819-Buckden-AB-1-01082008-Draft
  - Major drawing 26109/01, October 2008
  - and MSE update survey 11/12/2021

**Key**

- Manifold
- Box Manifold
- Proposed Gas Well
- Control LTA Well
- Gas Well
- Pin Well
- Well in Chamber
- Horizontal Well
- Pumped Sump
- Knock Out Pit
- Blockout
- Blockout Drain
- Control Valve
- 200mm MDEP
- 150mm MDEP
- 100mm MDEP
- 75mm MDEP
- 50mm MDEP
- 30mm MDEP
- 15mm MDEP
- Loosefit Pipe

**Velox Power**

**Buckden Landfill Site**

**Composite As-Built Gas Collection System**

Site Ref.	Site Name	Dwg. Type	Dwg. No.	Date	Status	Scale
VP2819	Buckden	AB	30B	25.11.2021	Draft	1:1000@A1

**Key**

Safety	DSEAR

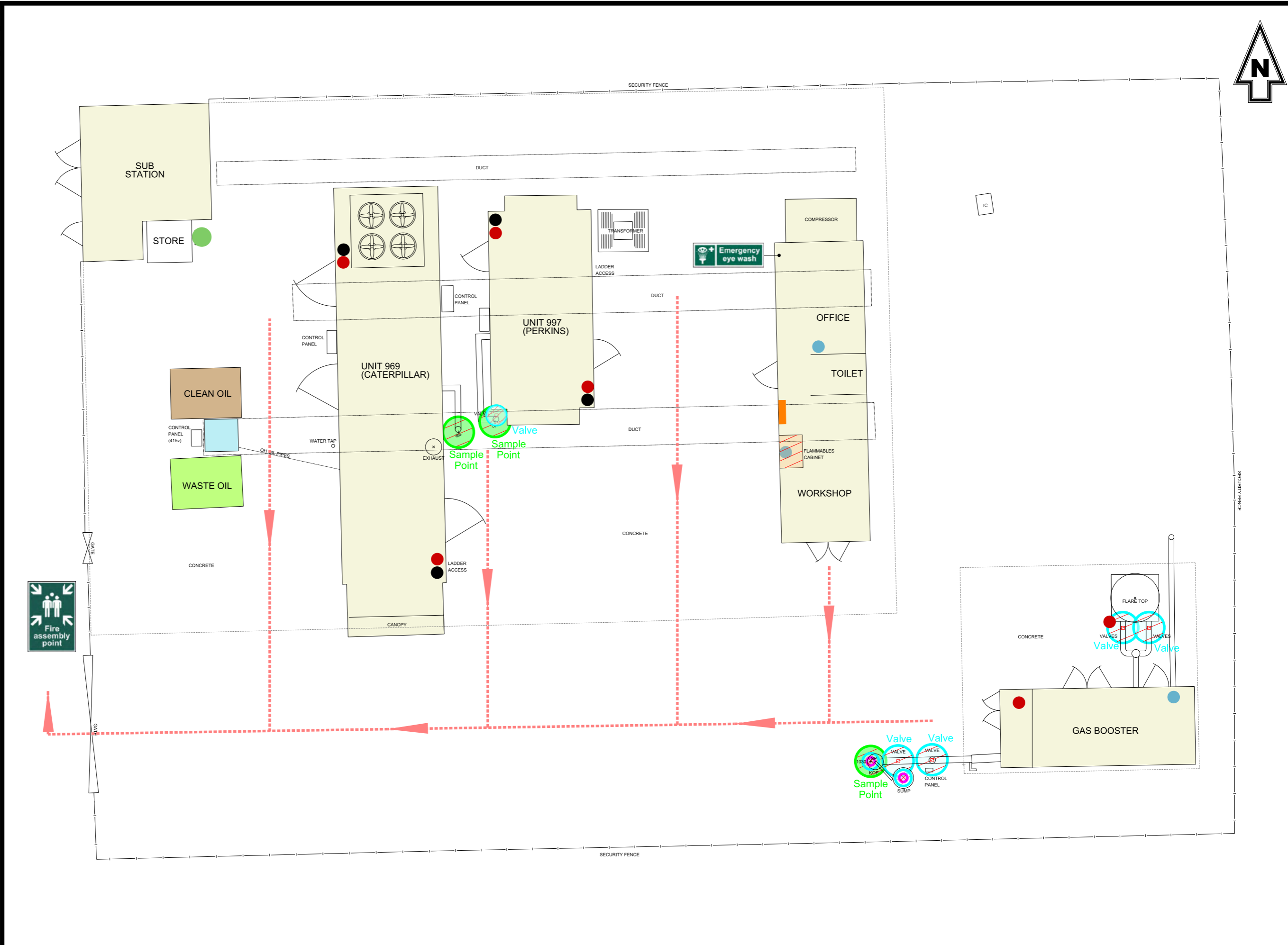

Site Ref.	Site Name	Dwg. Type	Dwg. No.	Date	Status	Scale
2819	Buckden	ECL	1	25.11.2021	Final	A3

**Key**

Safety	DSEAR

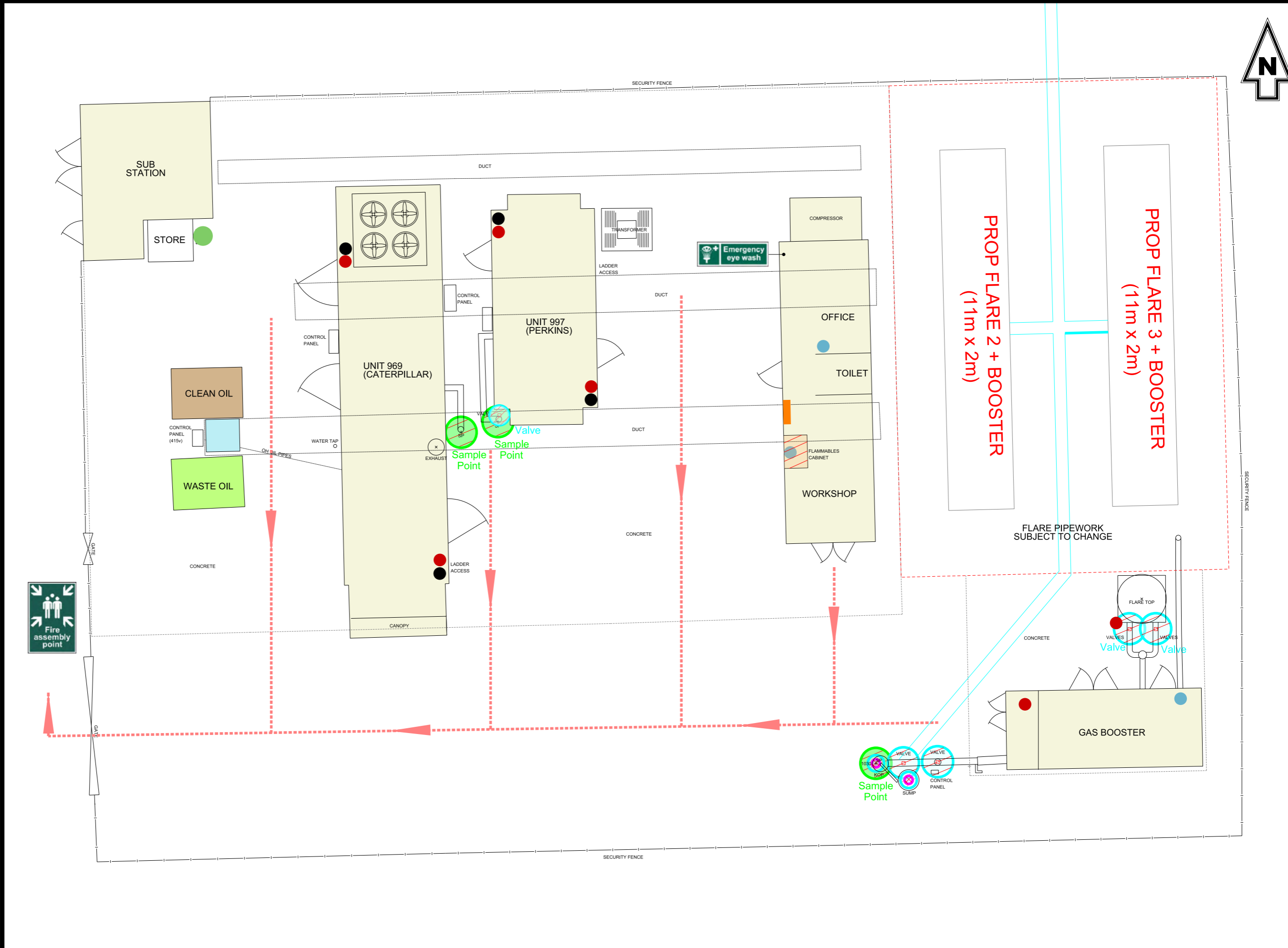

Site Ref.	Site Name	Dwg. Type	Dwg. No.	Date	Status	Scale
2819	Buckden	CP	1	25.11.2021	Draft	A3