

Environmental Management System Summary

Normal Operations

On a daily basis this will include checks on all equipment to ensure its proper functionality, with any defects being logged and repairs instigated. Daily records will be kept of water and feed consumption, temperatures, humidity and bird mortalities.

Maintenance Schedule Recording

Maintenance log submitted details preventative measures servicing carried out on site, these will cover the main areas such as feed and water systems, heating and ventilation systems in line with manufacturer's guidance. Generator is test run weekly under full load to ensure their availability under a mains power interruption, this will also test the alarm systems notifying staff members. Regular checks are made on buildings integrity, including fuel tank bunding and collision protection barriers for all fuel and feed storage areas.

Incidents and Abnormal Operations

Any deviations from normal operations are logged and dated, with corrective actions noted, listing person/contractor detailed to implement corrective actions, dated and signed.

Complaints

All complaints are recorded on the "Complaints Log". This will be dated and nature of complaint recorded, site manager/operator will be responsible for investigation of complaint, remedial action taken and complainant notified of the corrective action taken. The site will display a sign with permit number and contact details for both farm and Environment Agency, at a location outside the site boundary that has public access.

Accident/Emergency Plan

A detailed emergency plan is held on site to cover all eventualities that may pose an environmental risk. As per the H1 risk assessment for accidents.

Biomass Operation – Management/Emergency Plan

Type of operation	Potential Risk	Control Measures
Boiler operation	Fire hazard	Operated to manufacturer's specifications and guidance. Regular servicing and cleaning. Daily operating temperatures recorded.
Boiler operation	Dust /noise or odour	Any deviance from normal operation should result in boiler shutdown with abnormalities recorded and manufacturer's guidance requested before further use.
Boiler operation	Ash removal and storage	Ash should be removed as per manufacturer's guidance using the correct PPE, storage of ash in sealed heat proof container awaiting disposal with litter at crop depletion.
Boiler Operation	Vandalism/Intruders	Boiler house to remain locked and secure at all times with authorised access only.
Woodchip storage	Fire risk	Authorised entry only, warning signs displayed of fuel storage, ie. No Smoking, No Naked flames etc.
Woodchip storage	Overheating	Moisture content monitored and recorded frequently (daily) to prevent mass overheating.

Training

All staff are suitably qualified to work at the installation, any new staff are mentored until such time as training is given. Staff are trained in both Health and Safety and environmental awareness. All staff and Contractors are made aware of the "How to Comply Document" upon entry to the site. Both staff and contractors have defined roles.

Installation Plans

All key plans are reviewed on an annual basis or following an incident, with details and dates recorded of any amendments. These will include Emergency, Noise, Odour and Site Closure Plans.

Site Security

Site has a secure boundary fence, all fuel stores, poultry houses and all store rooms are kept locked and secure, preventing any unauthorised access.

Non Technical Summary

Bedfordia farm poultry unit will have a permit to rear 320,000 broilers in 6 poultry houses, houses are to be heated by four biomass boiler units.

Birds will be housed at day old and de populated at around thirty-two to forty days of age with approximately seven days empty, which will give 7 cycles per annum, this will be done on an all out all in basis.

Before bird arrival the houses will be pre-warmed by hot water blown air heaters. Floors will be covered to a minimum depth of 2 cm of bulk wood shavings. Temperature and humidity will be computer controlled and closely monitored on a daily basis to achieve a target level of 21° C post brooding and a relative humidity of 55-60%, this should achieve dry litter, which is important to minimising emissions. Ventilation is controlled by a negative pressure system using high velocity roof mounted extraction fans with side wall air inlets, with gable fans for summer cooling. Water is via a nipple drinking system fitted with cups to reduce leakage and spills leading to drier litter.

Birds will be fed a minimum of three diets during their growth, with gradually reducing levels of protein and phosphorous as bird age increases.

Feed is delivered from a UKAS accredited feed mill and blown into bulk feed bins situated at the ends of the houses, from the feed bins the feed is augered into the houses and distributed to the birds via a pan feeding system.

At depletion the litter will be removed from the site and used on operator controlled land with some surplus being sold. The farm will then be pressure washed disinfected, dried out prior to the cycle beginning again.

Fallen stock during the production cycle will be collected and recorded daily. These will be collected and incinerated regularly by a licensed incinerator.

The above measures are designed to reduce emissions, trees and hedges will trap dust particles reducing odour. Ammonia emissions will be reduced by reduced protein feed, maintaining good litter conditions with dry matter content above 60%. Containment of wash waters will prevent pollutants being released to the environment.

Management plans are in place to reduce odour and noise.

Records of tonnages of litter and wash water exported off site are recorded.

Proposed Changes

Operator at Bedfordia Farm Poultry Unit is proposing to downsize the permitted installation due to planning concerns.

The revised installation will consist of six poultry houses for the production of broilers, bird place numbers will be reduced to 320,000.

No changes to the installation boundary, all management plans are current with no changes planned.

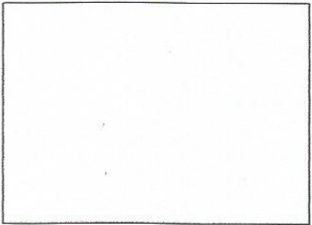
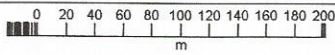
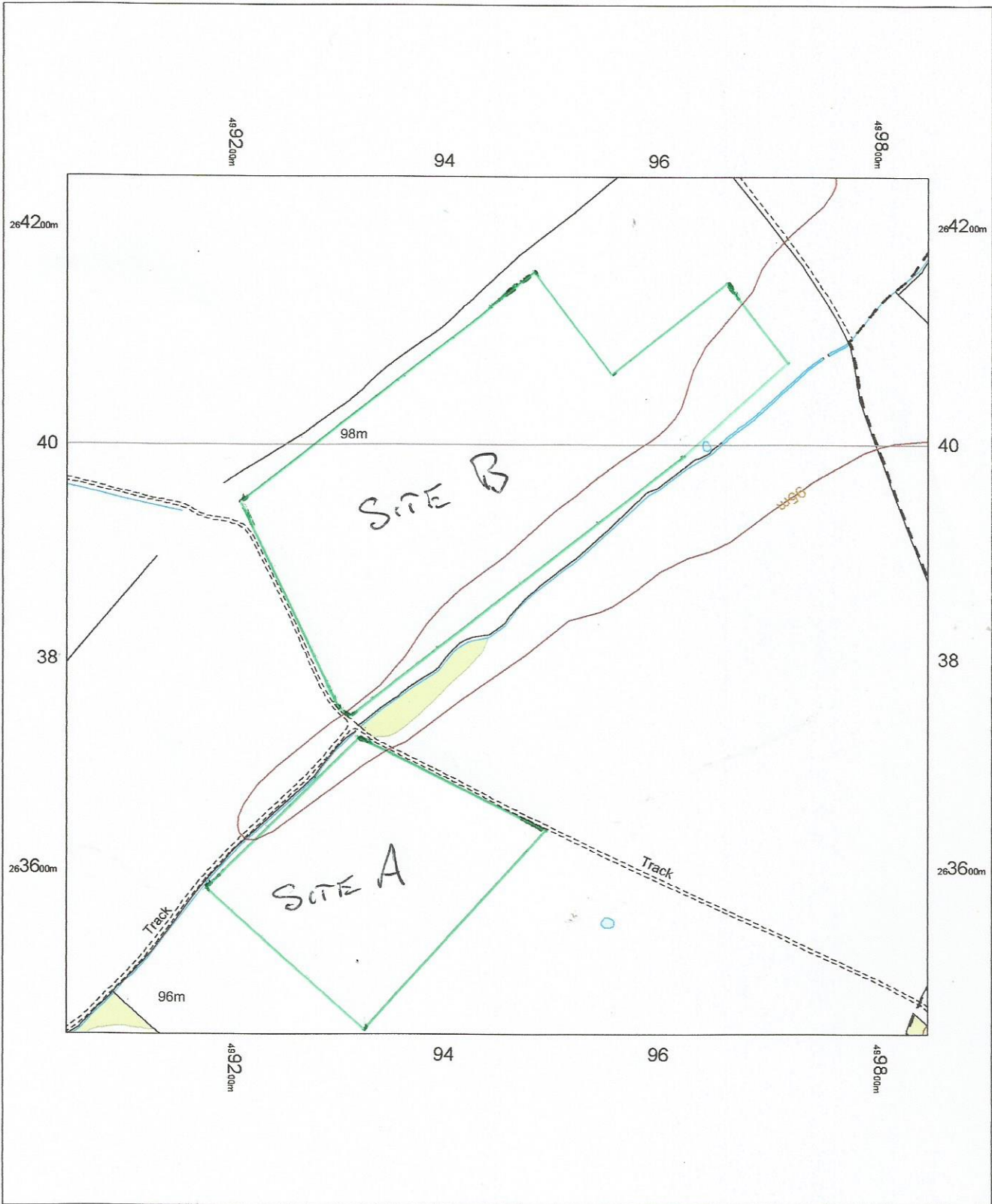

OS VectorMap Local - Landplan Style
 17 October 2016, ID: HMC-00568819
www.themapcentre.com
 1:5000 scale print at A4, Centre: 499450 E, 263850 N
 ©Crown Copyright Ordnance Survey. Licence no. 100018971

