

Appendix A. Pipeline Route Geological Long Sections

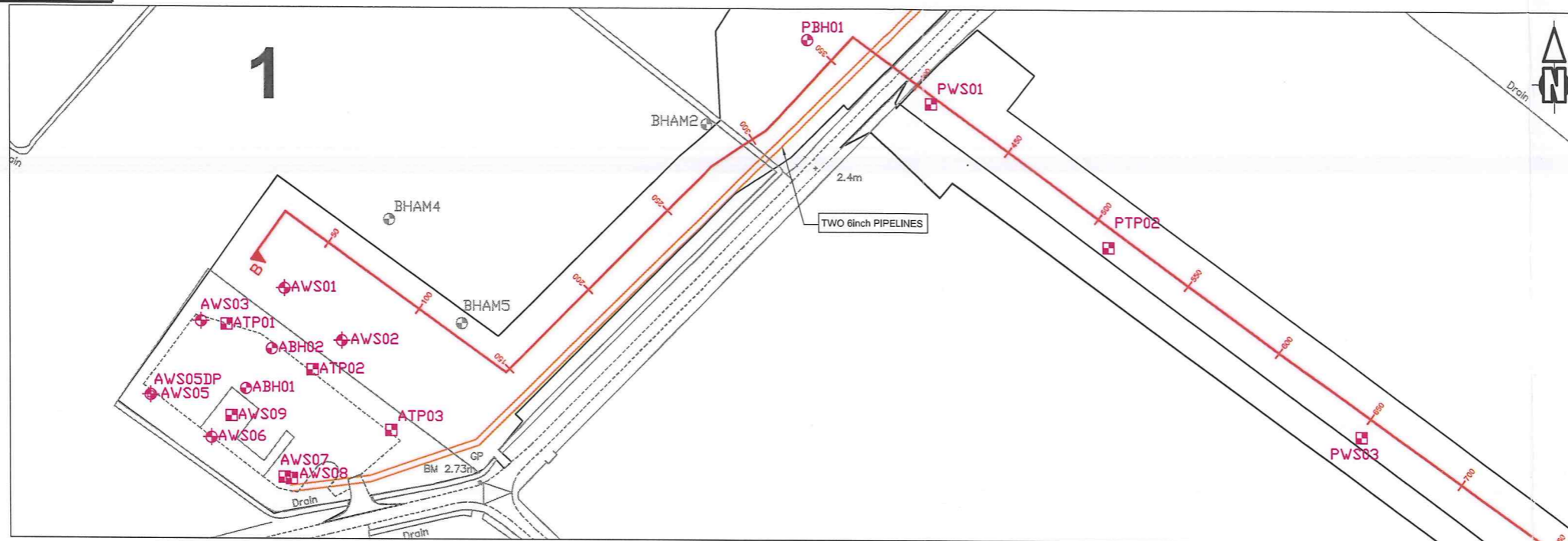

PLAN : SCALE 1:2500

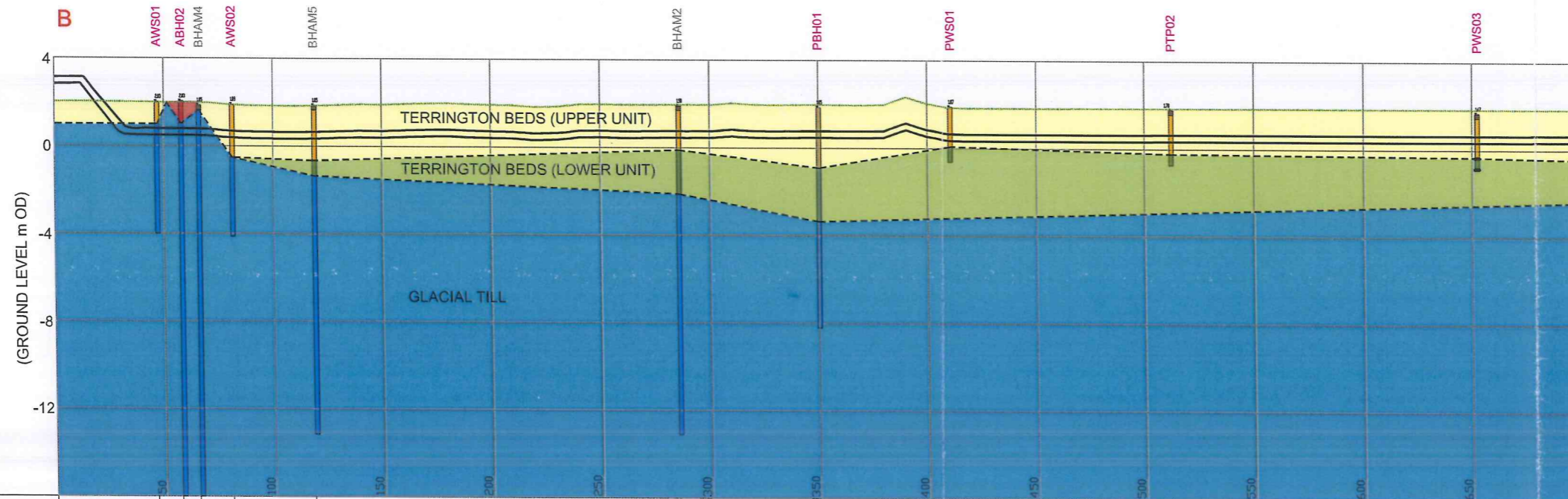

EXISTING GROUND LEVEL (m OD)	CHAINAGE	INVERT LEVEL (m OD)
2	46	
2.03	57	
1.85	66	
1.89	80	
1.85	119	
1.90	286	
1.85	349	
1.87	410	
1.78	511	
1.80	512	
1.67	652	

LONGSECTION ALONG B-B' : SCALE HORZ 1:2500 VERT 1:250

ATKINS

Legend

- Fill Material
- Topsoil
- Terrington Beds (Upper Unit)
- Terrington Beds (Lower Unit)
- Peat
- Glacial Till

- Section Line
- Existing 10inch Pipeline
- Existing Pipeline
- Existing Ground Level
- Proposed Pipeline
- Indicative Geological Boundary
- 2011 Ground Investigation
- 1999 Ground Investigation

Notes:

- The stratigraphy shown is based on information from the nearest exploratory holes to the chosen section. The actual stratigraphy could differ from what is shown due to local variations in ground conditions.
- For information on groundwater please see the interpretative report.
- These drawings should not be used as service information drawings. Some pipeline information is shown where it was available from Fluor's baseline plans. The accuracy of this information and the potential presence of other services has not been checked by Atkins.
- The stratigraphy shown is a conjecture, based on information from the nearest exploratory holes to the chosen section. The actual stratigraphy could differ from what is shown due to local variations in ground conditions.
- The ground surface profile, which was provided by Fluor, was developed from topographic survey data. At some locations, where the survey data is at a distance from the pipe-line route, the actual topographic profile will differ from that shown on this plan.

0	FOR CLIENT COMMENT	DH	29.07.11	AD	JB
REV	DESCRIPTION	BY	DATE	CHKD	AUTH

ATKINS

Atkins Limited
 Chadwick House
 Birchwood Park
 Warrington
 WA3 6AE
 England
 Telephone +44(0)1925 238000
 Fax +44(0)1925 238500

CLIENT:

FLUOR

Fluor Limited
 Fluor Centre
 140 Pinehurst Road
 Farnborough
 Hampshire GU14 7BF

PROJECT:

UGS SALTFLEETBY

TITLE:

FIGURE 1 : PIPELINE ROUTE
 GEOLOGICAL LONG SECTION

SCALE:	ORIGINAL SIZE:	DESIGNED:	DRAWN:	CHECKED:	AUTHORISED:
SHOWN	A3	RS	DH	AD	JB
OFFICE:	DATE:	DATE:	DATE:	DATE:	DATE:
	29.07.11	29.07.11	29.07.11	29.07.11	29.07.11

PROJECT NO:	REV:
5097367_GTG20093413	/0

PROJECT NO:
5097367_GTG20093413

REV:
/0

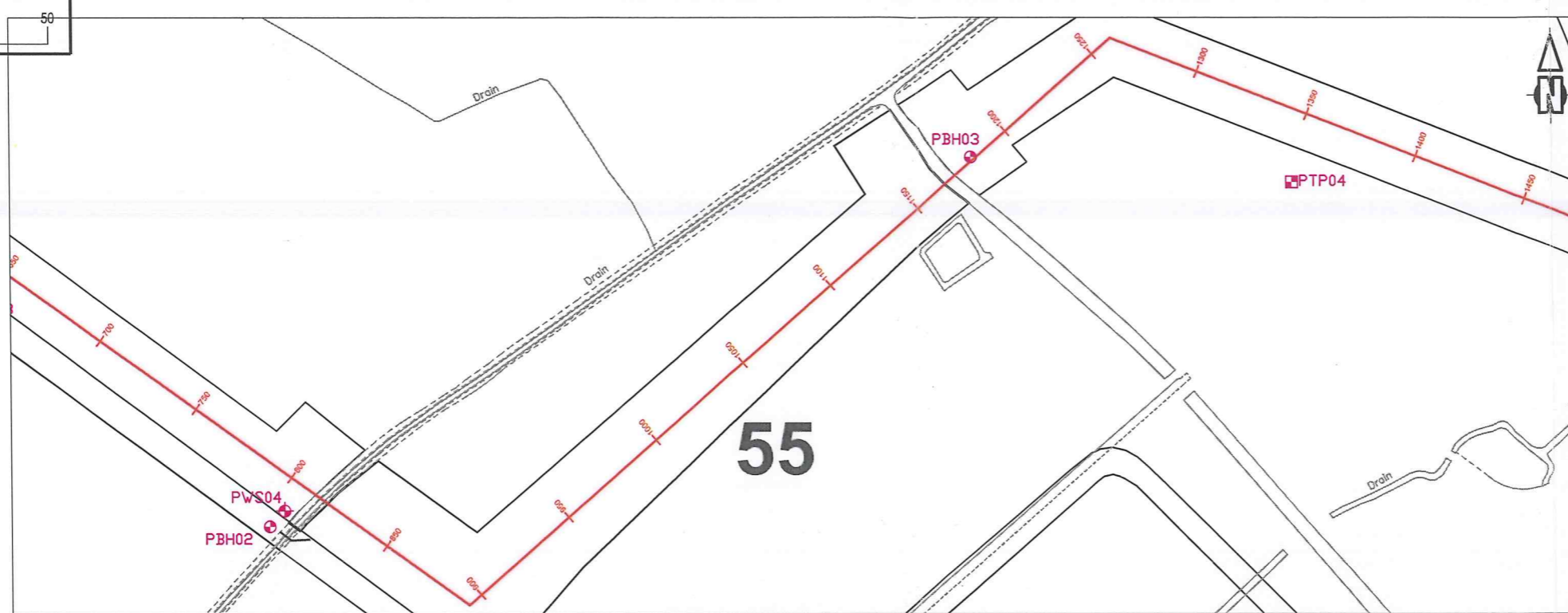
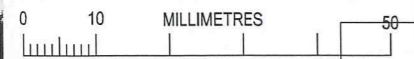

PLAN : SCALE 1:2500

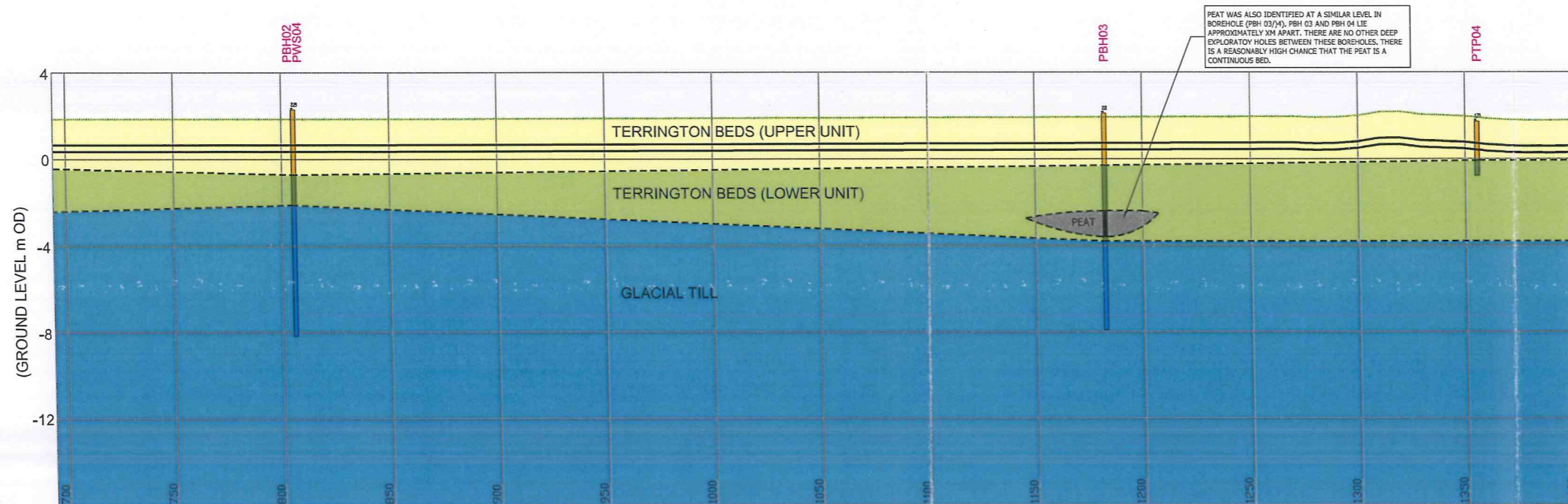

PEAT WAS ALSO IDENTIFIED AT A SIMILAR LEVEL IN BOREHOLE (PBH 03/4). PBH 03 AND PBH 04 LIE APPROXIMATELY 3M APART. THERE ARE NO OTHER DEEP EXPLORATORY HOLES BETWEEN THESE BOREHOLES, THERE IS A REASONABLY HIGH CHANCE THAT THE PEAT IS A CONTINUOUS BED.

EXISTING GROUND LEVEL (m OD)		2.29		2.11		1.73
CHAINAGE		805		1181		1355
INVERT LEVEL (m OD)						

LONGSECTION ALONG B-B' : SCALE HORZ 1:2500 VERT 1:250

ATKINS

Legend

- Fill Material
- Topsoil
- Terrington Beds (Upper Unit)
- Terrington Beds (Lower Unit)
- Peat
- Glacial Till

- Section Line
- Existing 10inch Pipeline
- Existing Pipeline
- Existing Ground Level
- Proposed Pipeline
- Indicative Geological Boundary
- 2011 Ground Investigation
- 1999 Ground Investigation

Notes:

1. The stratigraphy shown is based on information from the nearest exploratory holes to the chosen section. The actual stratigraphy could differ from what is shown due to local variations in ground conditions.
2. For information on groundwater please see the interpretative report.
3. These drawings should not be used as service information drawings. Some pipeline information is shown where it was available from Fluor's baseline plans. The accuracy of this information and the potential presence of other services has not been checked by Atkins.
4. The stratigraphy shown is a conjecture, based on information from the nearest exploratory holes to the chosen section. The actual stratigraphy could differ from what is shown due to local variations in ground conditions.
5. The ground surface profile, which was provided by Fluor, was developed from topographic survey data. At some locations, where the survey data is at a distance from the pipe-line route, the actual topographic profile will differ from that shown on this plan.

0	FOR CLIENT COMMENT	DH	29.07.11	AD	JB
---	--------------------	----	----------	----	----

ATKINS

Atkins Limited
Chadwick House
Birchwood Park
Warrington
WA3 6AE
England

Telephone +44(0)1925 238000
Fax +44(0)1925 238500

CLIENT:

FLUOR.

Fluor Limited
Fluor Centre
140 Pinehurst Road
Farnborough
Hampshire GU14 7BF

PROJECT:

UGS SALT FLEETBY

TITLE:

FIGURE 2 : PIPELINE ROUTE
GEOLOGICAL LONG SECTION

SCALE:	ORIGINAL SIZE: A3	DESIGNED: RS	DRAWN: DH	CHECKED: AD	AUTHORISED: JB
SHOWN	OFFICE:	DATE: 29.07.11	DATE: 29.07.11	DATE: 29.07.11	DATE: 29.07.11

PROJECT NO: 5097367_GTG20093413

REV: /0

PROJECT NO: 5097367_GTG20093413

REV: /0

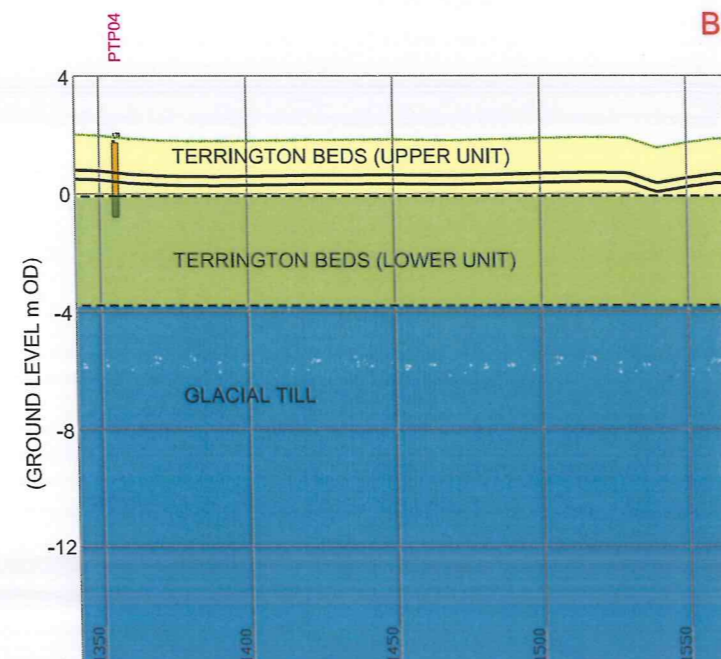
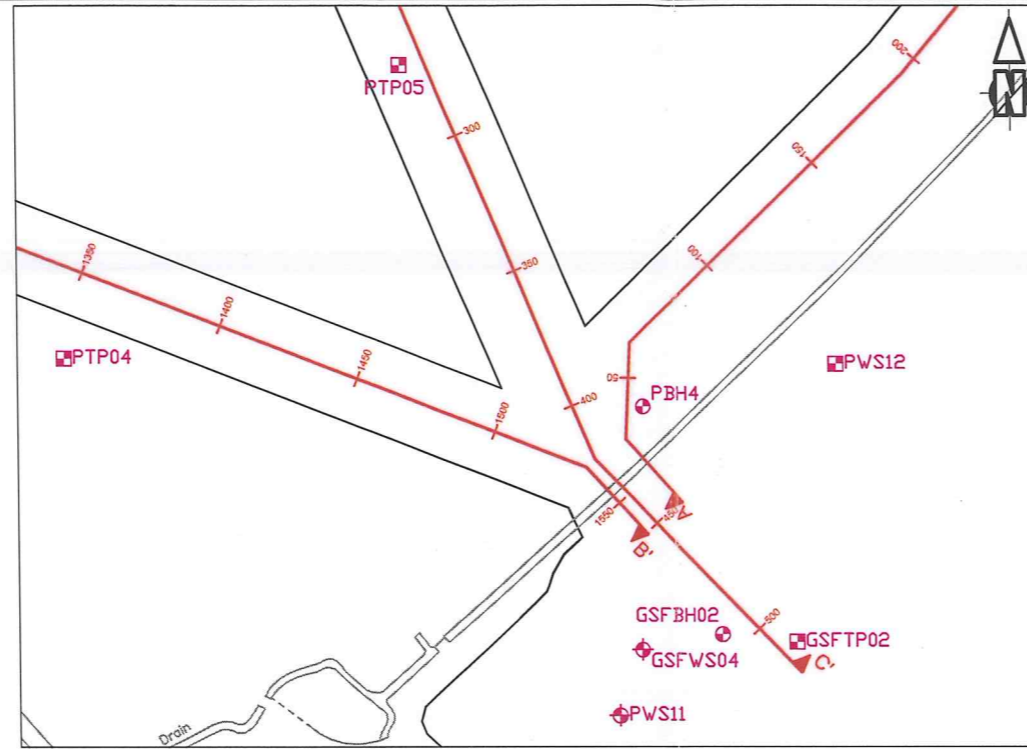
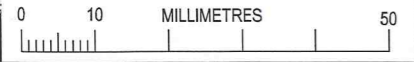

LONGSECTION ALONG B-B' : SCALE HORZ 1:2500 VERT 1:250

ATKINS

- Legend**
- Fill Material
 - Topsoil
 - Terrington Beds (Upper Unit)
 - Terrington Beds (Lower Unit)
 - Peat
 - Glacial Till
- Section Line**
- Existing 10 inch Pipeline
 - Existing Pipeline
 - Existing Ground Level
 - Proposed Pipeline
 - Indicative Geological Boundary
- Notes:**
- The stratigraphy shown is based on information from the nearest exploratory holes to the chosen section. The actual stratigraphy could differ from what is shown due to local variations in ground conditions.
 - For information on groundwater please see the interpretative report.
 - These drawings should not be used as service information drawings. Some pipeline information is shown where it was available from Fluor's baseline plans. The accuracy of this information and the potential presence of other services has not been checked by Atkins.
 - The stratigraphy shown is a conjecture, based on information from the nearest exploratory holes to the chosen section. The actual stratigraphy could differ from what is shown due to local variations in ground conditions.
 - The ground surface profile, which was provided by Fluor, was developed from topographic survey data. At some locations, where the survey data is at a distance from the pipe-line route, the actual topographic profile will differ from that shown on this plan.

0	FOR CLIENT COMMENT	DH	29.07.11	AD	JB
REV	DESCRIPTION	BY	DATE	CHK'D	AUTH

ATKINS
 Atkins Limited
 Chadwick House
 Birchwood Park
 Warrington
 WA3 6AE
 England
 Telephone +44(0)1925 238000
 Fax +44(0)1925 238500

CLIENT:
FLUOR.
 Fluor Limited
 Fluor Centre
 140 Pinehurst Road
 Farnborough
 Hampshire GU14 7BF

PROJECT:
 UGS SALTFLEETBY

TITLE:
 FIGURE 3 : PIPELINE ROUTE
 GEOLOGICAL LONG SECTION

SCALE:	ORIGINAL SIZE:	DESIGNED:	DRAWN:	CHECKED:	AUTHORISED:
SHOWN	A3	RS	DH	AD	JB
OFFICE:	DATE:	DATE:	DATE:	DATE:	DATE:
	29.07.11	29.07.11	29.07.11	29.07.11	29.07.11
PROJECT NO:	5097367_GTG20093413				REV:
					0

PROJECT NO: 5097367_GTG20093413

REV: 0

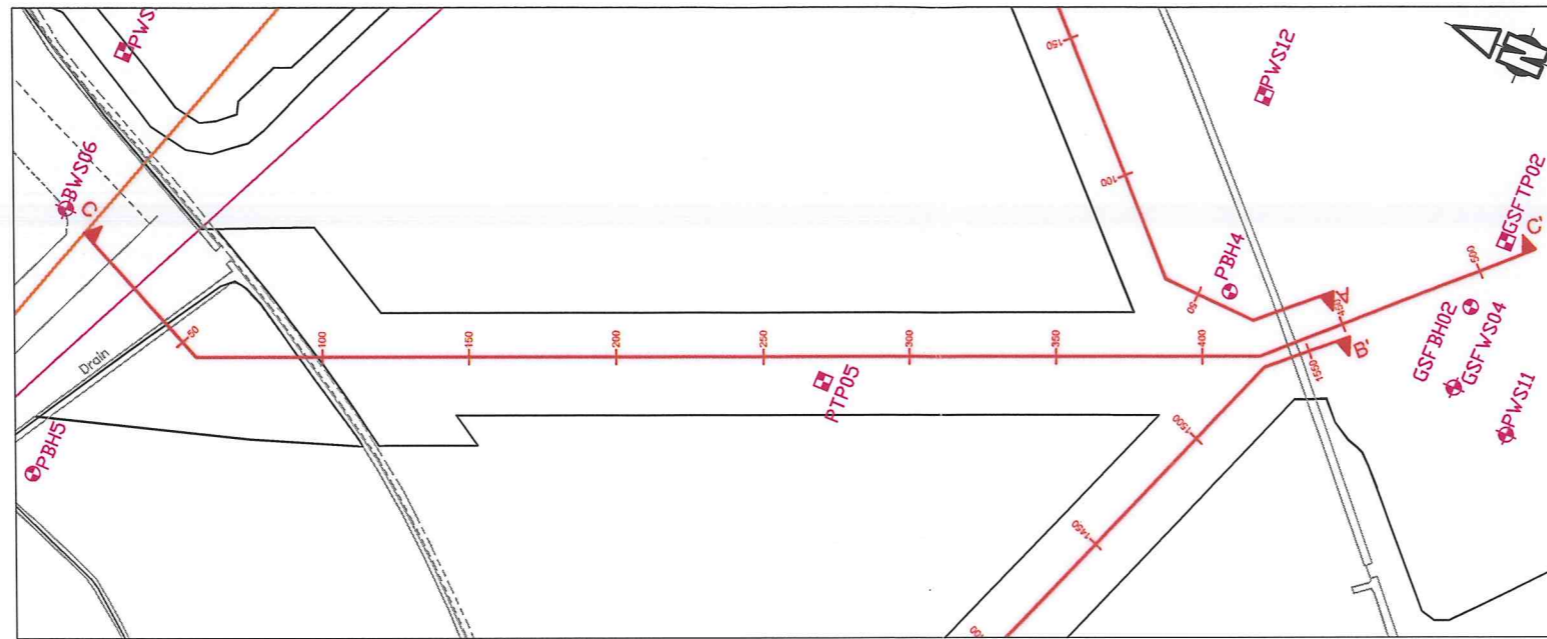

PLAN : SCALE 1:2500

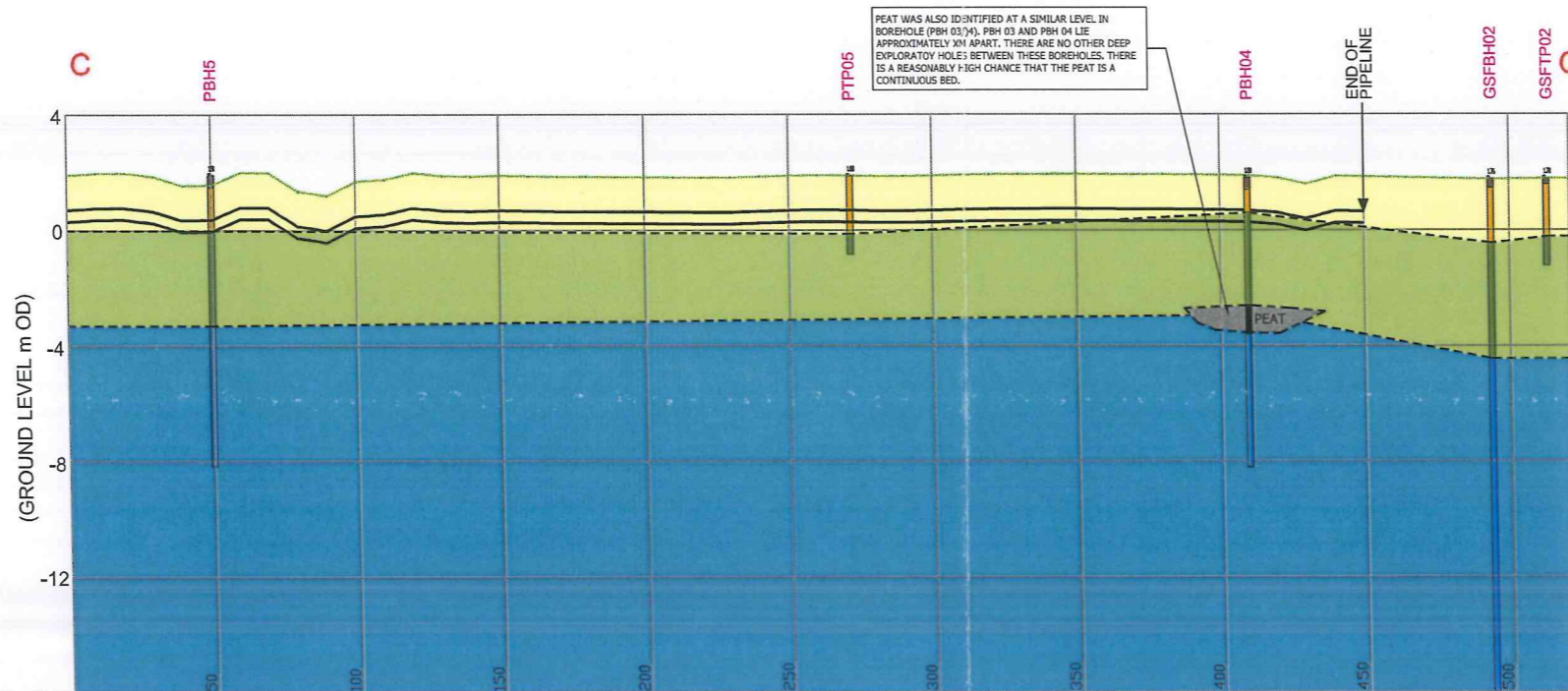

PEAT WAS ALSO IDENTIFIED AT A SIMILAR LEVEL IN BOREHOLE (PBH 03/4). PBH 03 AND PBH 04 LIE APPROXIMATELY 20M APART. THERE ARE NO OTHER DEEP EXPLORATORY HOLES BETWEEN THESE BOREHOLES, THERE IS A REASONABLY HIGH CHANCE THAT THE PEAT IS A CONTINUOUS BED.

EXISTING GROUND LEVEL (m OD)	1.91	1.88	1.85	1.76	1.78
CHAINAGE	49	271	410	493	512
INVERT LEVEL (m OD)					

LONGSECTION ALONG C-C' : SCALE HORZ 1:2500 VERT 1:250

ATKINS

Legend

- Fill Material
- Topsoil
- Terrington Beds (Upper Unit)
- Terrington Beds (Lower Unit)
- Peat
- Glacial Till

- Section Line
- Existing 10inch Pipeline
- Existing Pipeline
- Existing Ground Level
- Proposed Pipeline
- Indicative Geological Boundary
- 2011 Ground Investigation
- 1999 Ground Investigation

Notes:

- The stratigraphy shown is based on information from the nearest exploratory holes to the chosen section. The actual stratigraphy could differ from what is shown due to local variations in ground conditions.
- For information on groundwater please see the interpretative report.
- These drawings should not be used as service information drawings. Some pipeline information is shown where it was available from Fluor's baseline plans. The accuracy of this information and the potential presence of other services has not been checked by Atkins.
- The stratigraphy shown is a conjecture, based on information from the nearest exploratory holes to the chosen section. The actual stratigraphy could differ from what is shown due to local variations in ground conditions.
- The ground surface profile, which was provided by Fluor, was developed from topographic survey data. At some locations, where the survey data is at a distance from the pipe-line route, the actual topographic profile will differ from that shown on this plan.

0	FOR CLIENT COMMENT	DH	29.07.11	AD	JB
REV	DESCRIPTION	BY	DATE	CHK'D	AUTH

ATKINS
 Atkins Limited
 Chadwick House
 Birchwood Park
 Warrington
 WA3 6AE
 England
 Telephone +44(0)1925 238000
 Fax +44(0)1925 238500

CLIENT:
FLUOR.
 Fluor Limited
 Fluor Centre
 140 Pinhurst Road
 Farnborough
 Hampshire GU14 7BF

PROJECT:
 UGS SALT FLEETBY

TITLE:
 FIGURE 4 : PIPELINE ROUTE 2
 GEOLOGICAL LONG SECTION

SCALE:	ORIGINAL SIZE:	DESIGNED:	DRAWN:	CHECKED:	AUTHORISED:
SHOWN	A3	RS	DH	AD	JB
OFFICE:	DATE:	DATE:	DATE:	DATE:	DATE:
	29.07.11	29.07.11	29.07.11	29.07.11	29.07.11

PROJECT NO:
 5097367_GTG20093413

PROJECT NO: 5097367_GTG20093413

REV: /0

REV: /0

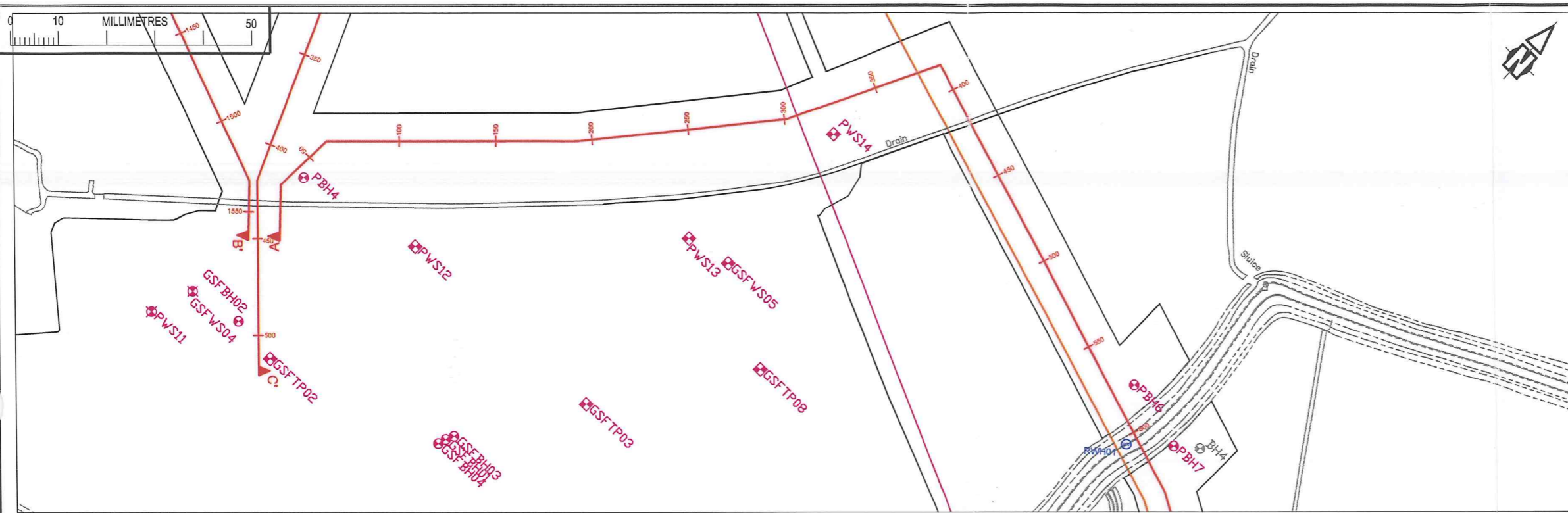

PLAN : SCALE 1:2500

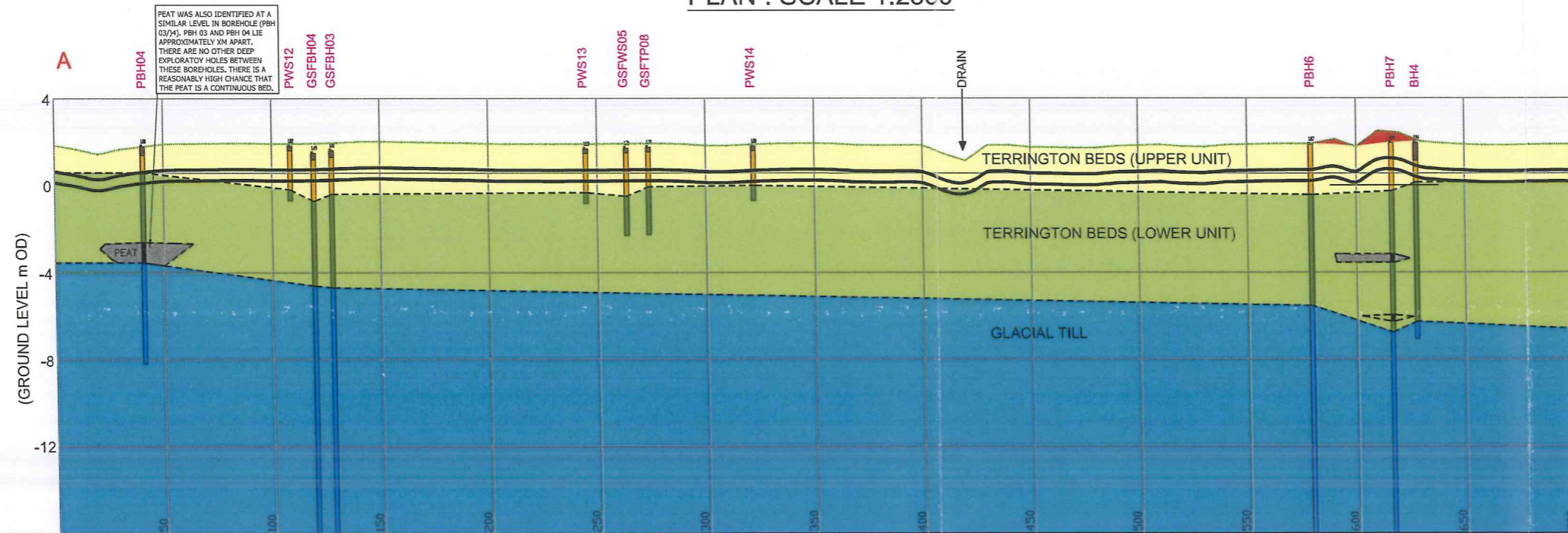

PEAT WAS ALSO IDENTIFIED AT A SIMILAR LEVEL IN BOREHOLE (PBH 03/04). PBH 03 AND PBH 04 LIE APPROXIMATELY 2M APART. THERE ARE NO OTHER DEEP EXPLORATORY HOLES BETWEEN THESE BOREHOLES. THERE IS A REASONABLY HIGH CHANCE THAT THE PEAT IS A CONTINUOUS BED.

EXISTING GROUND LEVEL (m OD)	CHAINAGE	INVERT LEVEL (m OD)
1.85	41	
1.82	108	
1.49	118	
1.61	127	
1.68	244	
1.71	263	
1.75	273	
1.80	321	
1.87	578	
1.94	616	

LONGSECTION ALONG A-A' : SCALE HORZ 1:2500 VERT 1:250

ATKINS

Legend

- Fill Material
- Topsoil
- Terrington Beds (Upper Unit)
- Terrington Beds (Lower Unit)
- Peat
- Glacial Till
- Section Line
- Existing 10inch Pipeline
- Existing Pipeline
- Existing Ground Level
- Proposed Pipeline
- Indicative Geological Boundary
- 2011 Ground Investigation
- 1999 Ground Investigation
- Surface Water Sample

Notes:

1. The stratigraphy shown is based on information from the nearest exploratory holes to the chosen section. The actual stratigraphy could differ from what is shown due to local variations in ground conditions.
2. For information on groundwater please see the interpretative report.
3. These drawings should not be used as service information drawings. Some pipeline information is shown where it was available from Fluor's baseline plans. The accuracy of this information and the potential presence of other services has not been checked by Atkins.
4. The stratigraphy shown is a conjecture, based on information from the nearest exploratory holes to the chosen section. The actual stratigraphy could differ from what is shown due to local variations in ground conditions.
5. The ground surface profile, which was provided by Fluor, was developed from topographic survey data. At some locations, where the survey data is at a distance from the pipe-line route, the actual topographic profile will differ from that shown on this plan.

0	FOR CLIENT COMMENT	DH	29.07.11	AD	JB
---	--------------------	----	----------	----	----

ATKINS
 Atkins Limited
 Chadwick House
 Birchwood Park
 Warrington
 WA3 6AE
 England
 Telephone +44(0)1925 238000
 Fax +44(0)1925 238500

CLIENT:
FLUOR.
 Fluor Limited
 Fluor Centre
 140 Pinehurst Road
 Farnborough
 Hampshire GU14 7BF

PROJECT:
 UGS SALT FLEETBY

TITLE:
 FIGURE 5 : PIPELINE ROUTE
 GEOLOGICAL LONG SECTION

SCALE:	ORIGINAL SIZE:	DESIGNED:	DRAWN:	CHECKED:	AUTHORISED:
SHOWN	A3	RS	DH	AD	JB
OFFICE:	DATE:	DATE:	DATE:	DATE:	DATE:
	29.07.11	29.07.11	29.07.11	29.07.11	29.07.11

PROJECT NO:
 5097367_GTG20093413

PROJECT NO: 5097367_GTG20093413

REV: /0

REV: /0

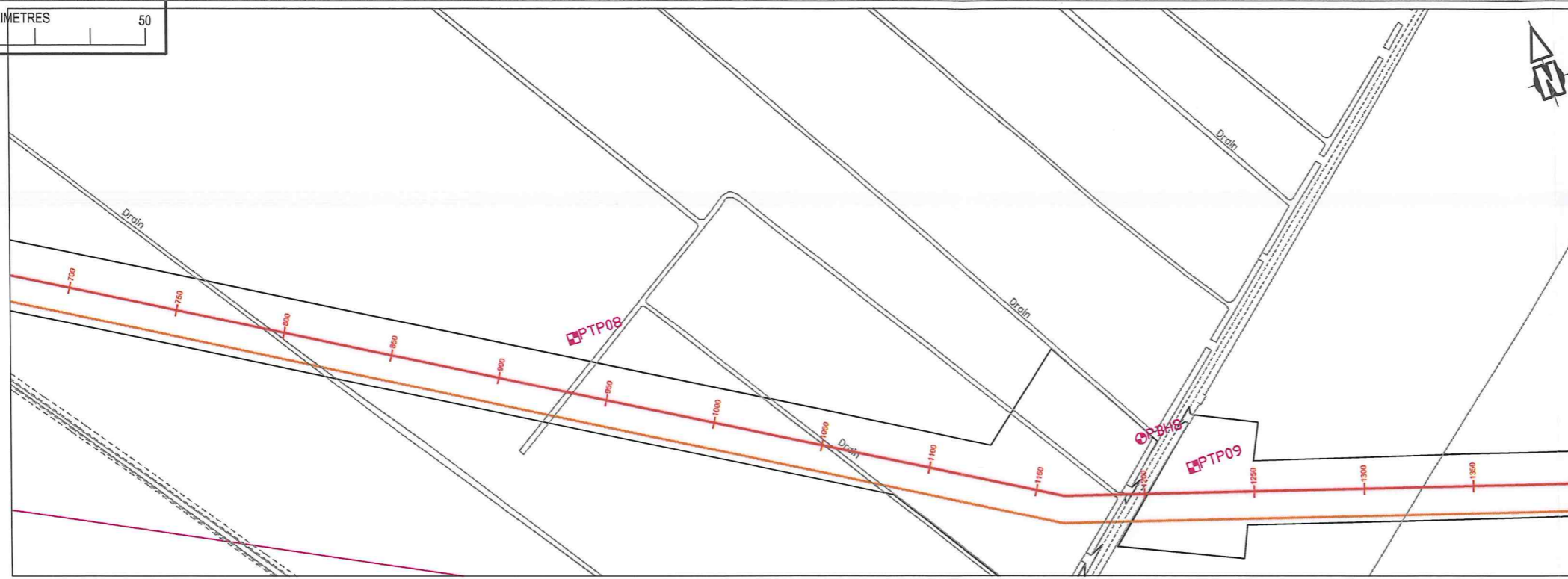
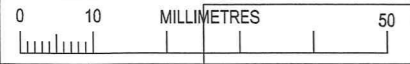

PLAN : SCALE 1:2500

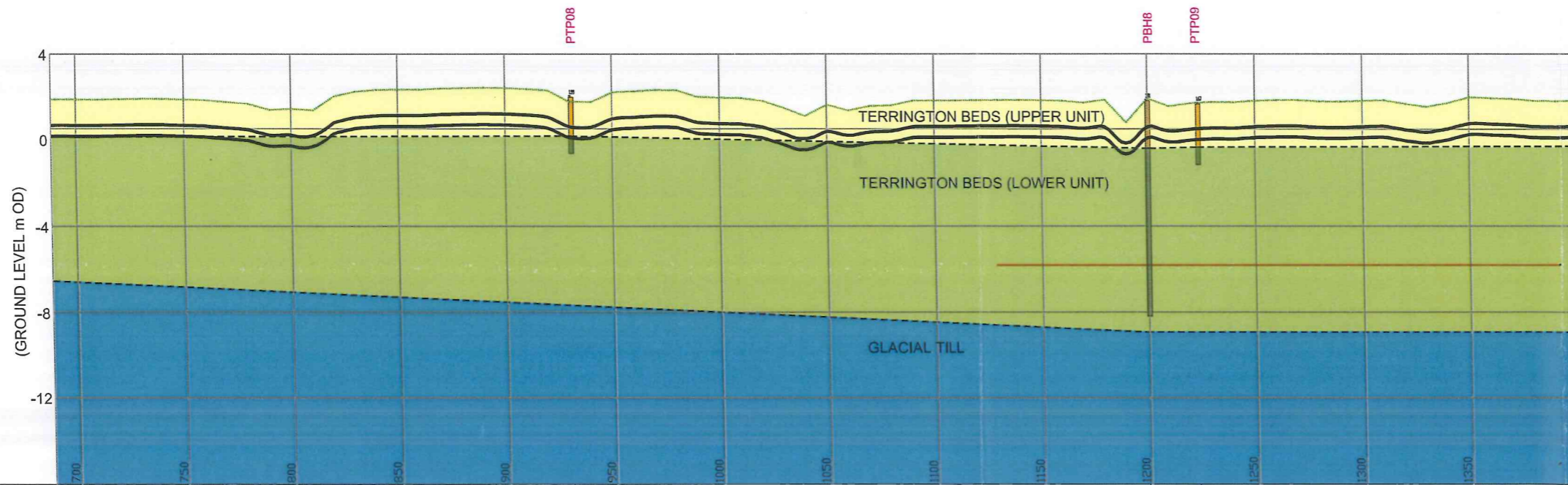

EXISTING GROUND LEVEL (m OD)		1.99	1.81	1.67
CHAINAGE		930	1199	1223
INVERT LEVEL (m OD)				

LONGSECTION ALONG A-A' : SCALE HORZ 1:2500 VERT 1:250

ATKINS

- Legend**
- Fill Material
 - Topsoil
 - Terrington Beds (Upper Unit)
 - Terrington Beds (Lower Unit)
 - Peat
 - Glacial Till
 - Section Line
 - Existing 10inch Pipeline
 - Existing Pipeline
 - Existing Ground Level
 - Proposed Pipeline
 - Indicative Geological Boundary
 - 2011 Ground Investigation
 - 1999 Ground Investigation
 - Surface Water Sample

- Notes:**
- The stratigraphy shown is based on information from the nearest exploratory holes to the chosen section. The actual stratigraphy could differ from what is shown due to local variations in ground conditions.
 - For information on groundwater please see the interpretative report.
 - These drawings should not be used as service information drawings. Some pipeline information is shown where it was available from Fluor's baseline plans. The accuracy of this information and the potential presence of other services has not been checked by Atkins.
 - The stratigraphy shown is a conjecture, based on information from the nearest exploratory holes to the chosen section. The actual stratigraphy could differ from what is shown due to local variations in ground conditions.
 - The ground surface profile, which was provided by Fluor, was developed from topographic survey data. At some locations, where the survey data is at a distance from the pipe-line route, the actual topographic profile will differ from that shown on this plan.

0	FOR CLIENT COMMENT	DH	29.07.11	AD	JB
REV	DESCRIPTION	BY	DATE	CHK'D	AUTH

ATKINS
 Atkins Limited
 Chadwick House
 Birchwood Park
 Warrington
 WA3 6AE
 England
 Telephone +44(0)1925 238000
 Fax +44(0)1925 238500

CLIENT:
FLUOR.
 Fluor Limited
 Fluor Centre
 140 Pinhurst Road
 Farnborough
 Hampshire GU14 7BF

PROJECT:
 UGS SALTFLEETBY

TITLE:
 FIGURE 6 : PIPELINE ROUTE
 GEOLOGICAL LONG SECTION

SCALE:	ORIGINAL SIZE:	DESIGNED:	DRAWN:	CHECKED:	AUTHORISED:
SHOWN	A3	RS	DH	AD	JB
OFFICE:	DATE:	DATE:	DATE:	DATE:	DATE:
	29.07.11	29.07.11	29.07.11	29.07.11	29.07.11

PROJECT NO:
 5097367_GTG20093413

REV:
 /0

PROJECT NO:
5097367_GTG20093413

REV:
/0

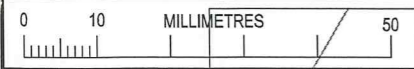

PLAN : SCALE 1:2500

ATKINS

- Legend**
- Fill Material
 - Topsoil
 - Terrington Beds (Upper Unit)
 - Terrington Beds (Lower Unit)
 - Peat
 - Glacial Till
 - Section Line
 - Existing 10inch Pipeline
 - Existing Pipeline
 - Existing Ground Level
 - Proposed Pipeline
 - Indicative Geological Boundary
 - 2011 Ground Investigation
 - 1999 Ground Investigation
 - Surface Water Sample

- Notes:**
- The stratigraphy shown is based on information from the nearest exploratory holes to the chosen section. The actual stratigraphy could differ from what is shown due to local variations in ground conditions.
 - For information on groundwater please see the interpretative report.
 - These drawings should not be used as service information drawings. Some pipeline information is shown where it was available from Fluor's baseline plans. The accuracy of this information and the potential presence of other services has not been checked by Atkins.
 - The stratigraphy shown is a conjecture, based on information from the nearest exploratory holes to the chosen section. The actual stratigraphy could differ from what is shown due to local variations in ground conditions.
 - The ground surface profile, which was provided by Fluor, was developed from topographic survey data. At some locations, where the survey data is at a distance from the pipe-line route, the actual topographic profile will differ from that shown on this plan.

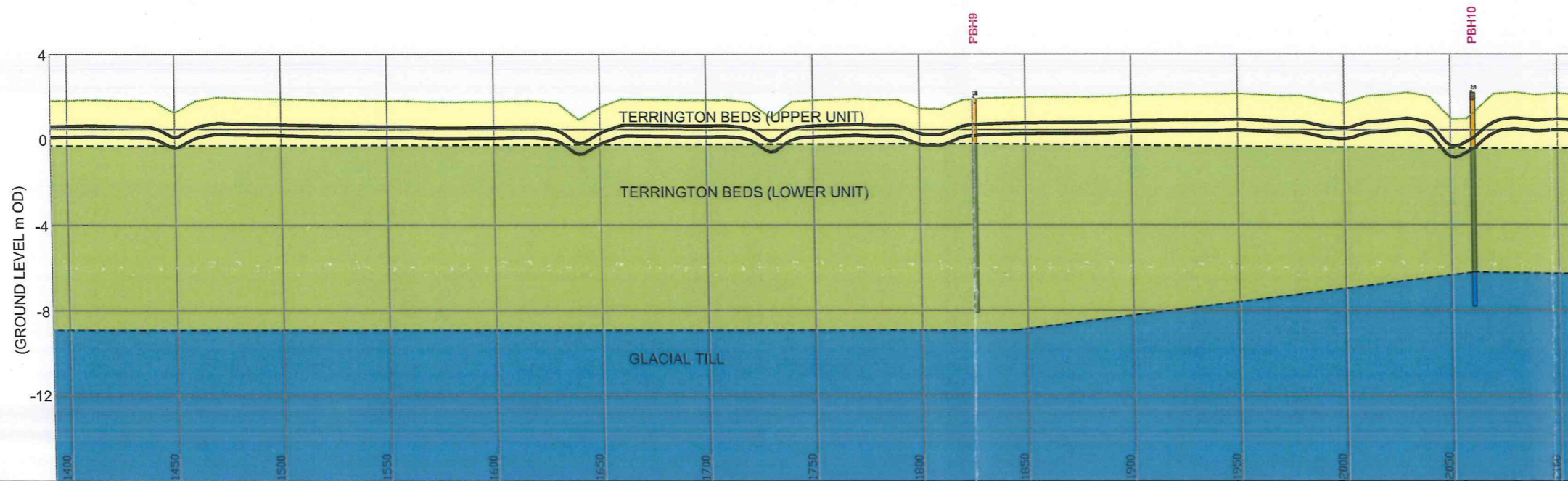

EXISTING GROUND LEVEL (m OD)		1.90	2.19
CHAINAGE		1825	2048
INVERT LEVEL (m OD)			

LONGSECTION ALONG A-A' : SCALE HORZ 1:2500 VERT 1:250

PROJECT NO: 5097367_GTG20093413

REV: /0

0	FOR CLIENT COMMENT	DH	29.07.11	AD	JB
REV	DESCRIPTION	BY	DATE	CHK'D	AUTH

ATKINS

Atkins Limited
Chadwick House
Birchwood Park
Warrington
WA3 6AE
England

Telephone +44(0)1925 238000
Fax +44(0)1925 238500

CLIENT:

FLUOR.

Fluor Limited
Fluor Centre
140 Pinehurst Road
Farnborough
Hampshire GU14 7BF

PROJECT:

UGS SALT FLEETBY

TITLE:

FIGURE 7 : PIPELINE ROUTE
GEOLOGICAL LONG SECTION

SCALE:	ORIGINAL SIZE:	DESIGNED:	DRAWN:	CHECKED:	AUTHORISED:
SHOWN	A3	RS	DH	AD	JB
OFFICE:	DATE:	DATE:	DATE:	DATE:	DATE:
	29.07.11	29.07.11	29.07.11	29.07.11	29.07.11

PROJECT NO: 5097367_GTG20093413 REV: /0

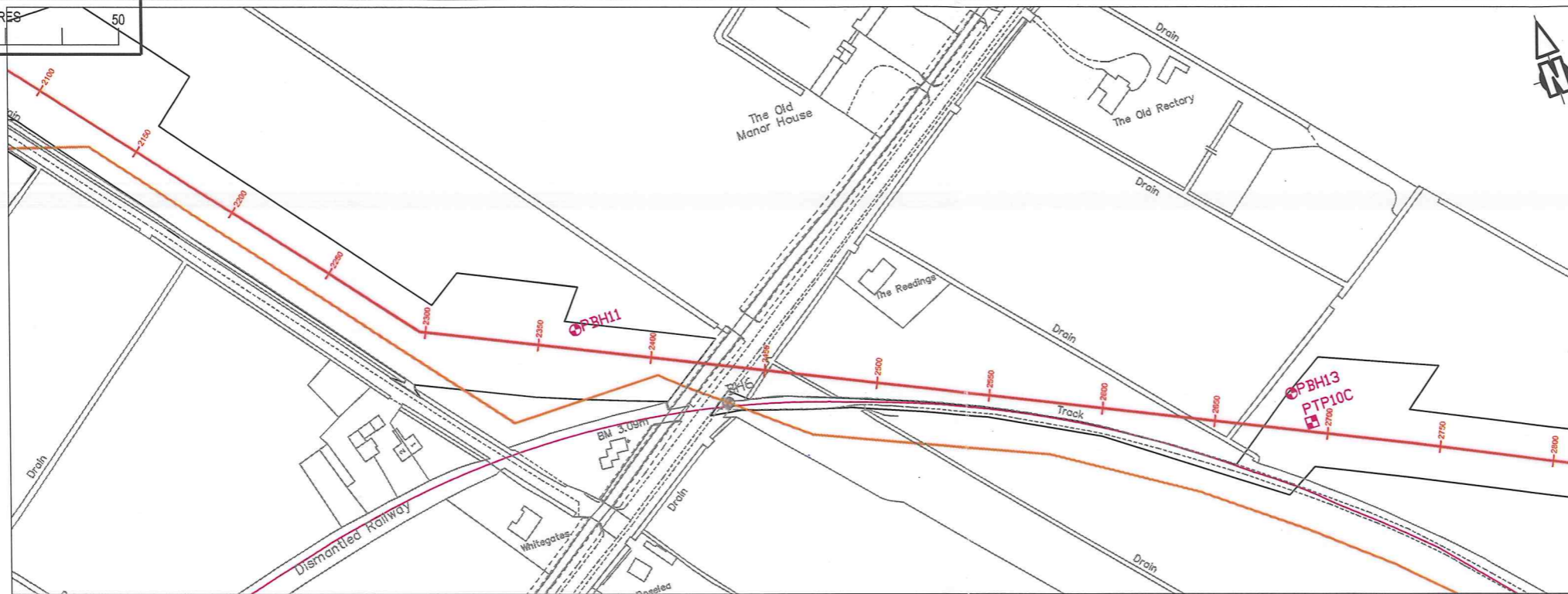

PLAN : SCALE 1:2500

ATKINS

- Legend**
- Fill Material
 - Topsoil
 - Terrington Beds (Upper Unit)
 - Terrington Beds (Lower Unit)
 - Peat
 - Glacial Till
 - Section Line
 - Existing 10inch Pipeline
 - Existing Pipeline
 - Existing Ground Level
 - Proposed Pipeline
 - Indicative Geological Boundary
 - 2011 Ground Investigation
 - 1999 Ground Investigation
 - Surface Water Sample

- Notes:**
- The stratigraphy shown is based on information from the nearest exploratory holes to the chosen section. The actual stratigraphy could differ from what is shown due to local variations in ground conditions.
 - For information on groundwater please see the interpretative report.
 - These drawings should not be used as service information drawings. Some pipeline information is shown where it was available from Fluor's baseline plans. The accuracy of this information and the potential presence of other services has not been checked by Atkins.
 - The stratigraphy shown is a conjecture, based on information from the nearest exploratory holes to the chosen section. The actual stratigraphy could differ from what is shown due to local variations in ground conditions.
 - The ground surface profile, which was provided by Fluor, was developed from topographic survey data. At some locations, where the survey data is at a distance from the pipe-line route, the actual topographic profile will differ from that shown on this plan.

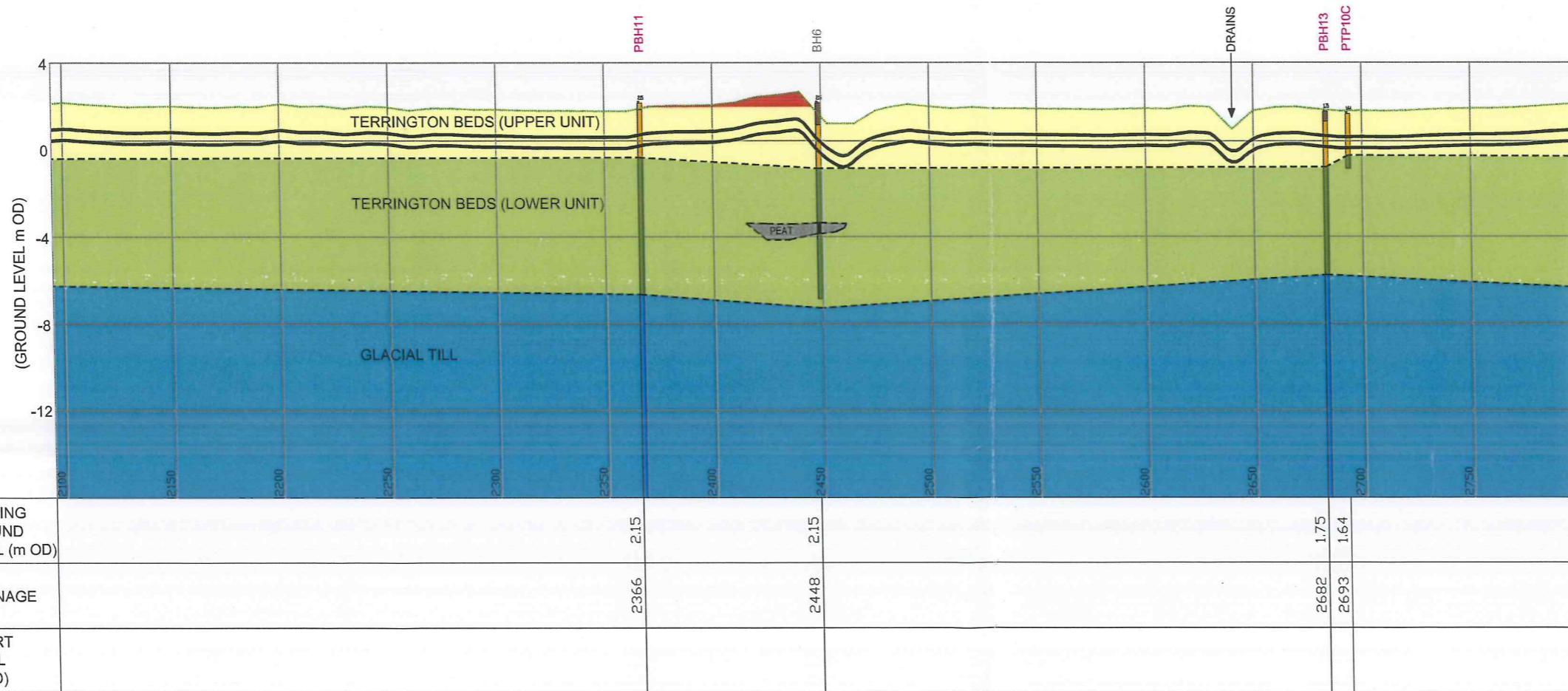

LONGSECTION ALONG A-A' : SCALE HORZ 1:2500 VERT 1:250

PROJECT NO: 5097367_GTG20093413

REV: /0

FOR CLIENT COMMENT	DH	29.07.11	AD	JB
--------------------	----	----------	----	----

REV	DESCRIPTION	BY	DATE	CHK'D	AUTH
Atkins Limited Chadwick House Birchwood Park Warrington WA3 6AE England Telephone +44(0)1925 238000 Fax +44(0)1925 238500					

CLIENT:	Fluor Limited Fluor Centre 140 Pinehurst Road Farnborough Hampshire GU14 7BF
---------	--

PROJECT: UGS SALTFLLEETBY

TITLE: FIGURE 8 : PIPELINE ROUTE GEOLOGICAL LONG SECTION

SCALE:	ORIGINAL SIZE:	DESIGNED:	DRAWN:	CHECKED:	AUTHORISED:
SHOWN	A3	RS	DH	AD	JB
	OFFICE:	DATE:	DATE:	DATE:	DATE:
		29.07.11	29.07.11	29.07.11	29.07.11

PROJECT NO: 5097367_GTG20093413 /0

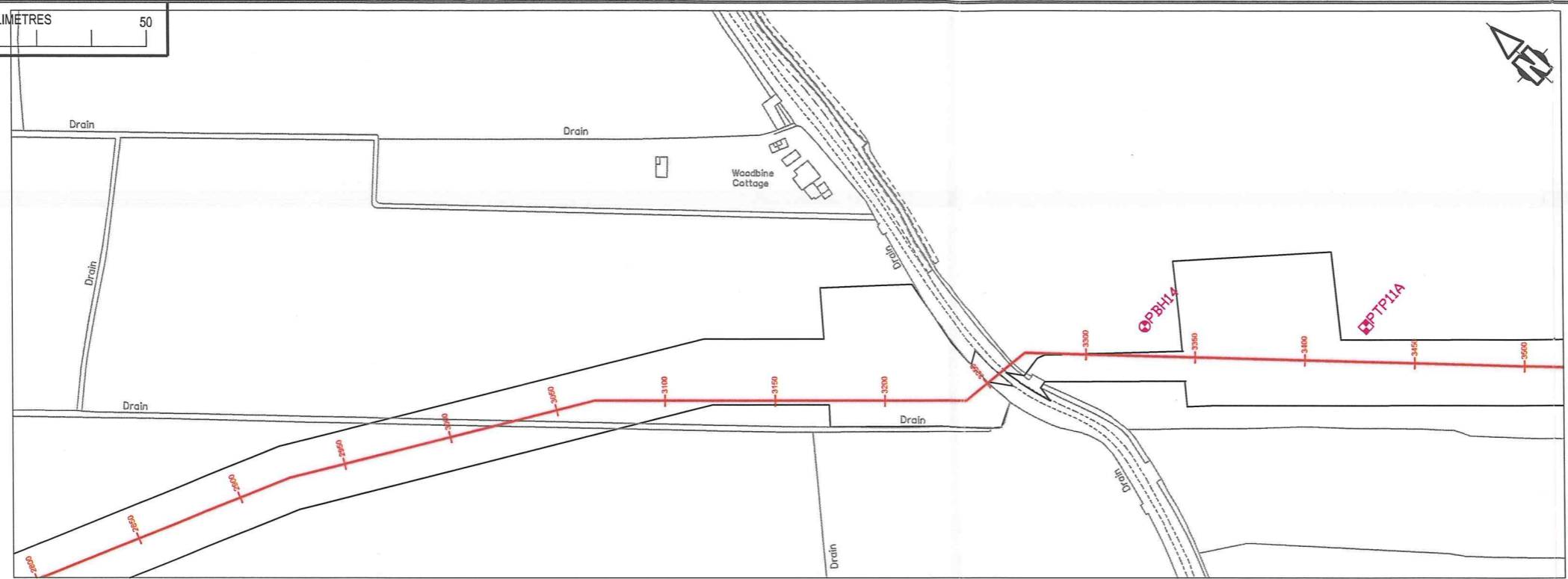

PLAN : SCALE 1:2500

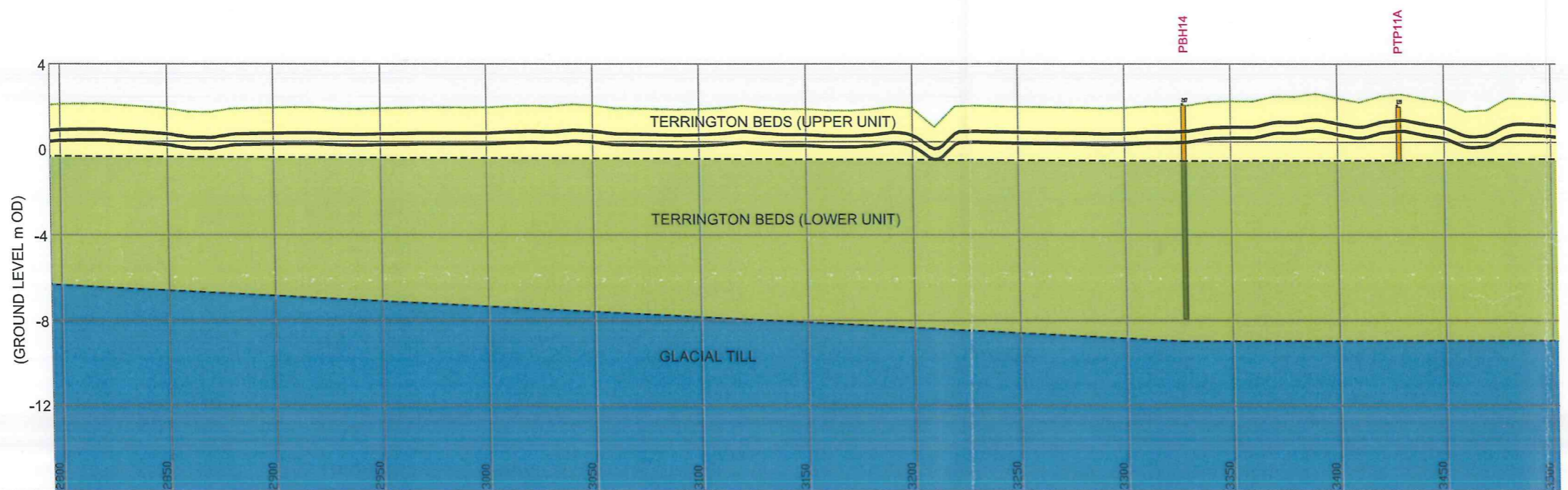

EXISTING GROUND LEVEL (m OD)	2.900	2.950	2.900	2.950	2.900	2.950	3.000	3.050	3.100	3.150	3.200	3.250	3.300	3.350	3.400	3.450
CHAINAGE									3327						3428	
INVERT LEVEL (m OD)																

LONGSECTION ALONG A-A' : SCALE HORIZ 1:2500 VERT 1:250

ATKINS

Legend

- Fill Material
- Topsoil
- Terrington Beds (Upper Unit)
- Terrington Beds (Lower Unit)
- Peat
- Glacial Till

- Section Line
- Existing 10inch Pipeline
- Existing Pipeline
- Existing Ground Level
- Proposed Pipeline
- Indicative Geological Boundary
- 2011 Ground Investigation
- 1999 Ground Investigation
- Surface Water Sample

- Notes:
- The stratigraphy shown is based on information from the nearest exploratory holes to the chosen section. The actual stratigraphy could differ from what is shown due to local variations in ground conditions.
 - For information on groundwater please see the interpretative report.
 - These drawings should not be used as service information drawings. Some pipeline information is shown where it was available from Fluor's baseline plans. The accuracy of this information and the potential presence of other services has not been checked by Atkins.
 - The stratigraphy shown is a conjecture, based on information from the nearest exploratory holes to the chosen section. The actual stratigraphy could differ from what is shown due to local variations in ground conditions.
 - The ground surface profile, which was provided by Fluor, was developed from topographic survey data. At some locations, where the survey data is at a distance from the pipe-line route, the actual topographic profile will differ from that shown on this plan.

0	FOR CLIENT COMMENT	DH	29.07.11	AD	JB
---	--------------------	----	----------	----	----

ATKINS

Atkins Limited
Chadwick House
Birchwood Park
Warrington
WA3 6AE
England

Telephone +44(0)1925 238000
Fax +44(0)1925 238500

CLIENT:

FLUOR.

Fluor Limited
Fluor Centre
140 Pinehurst Road
Farnborough
Hampshire GU14 7BF

PROJECT:
UGS SALTFLEETBY

TITLE:
FIGURE 9 : PIPELINE ROUTE
GEOLOGICAL LONG SECTION

SCALE:	ORIGINAL SIZE:	DESIGNED:	DRAWN:	CHECKED:	AUTHORISED:
SHOWN	A3	RS	DH	AD	JB
	OFFICE:	DATE:	DATE:	DATE:	DATE:
		29.07.11	29.07.11	29.07.11	29.07.11

PROJECT NO:
5097367_GTG20093413

REV:
0

PROJECT NO:
5097367_GTG20093413

REV:
0

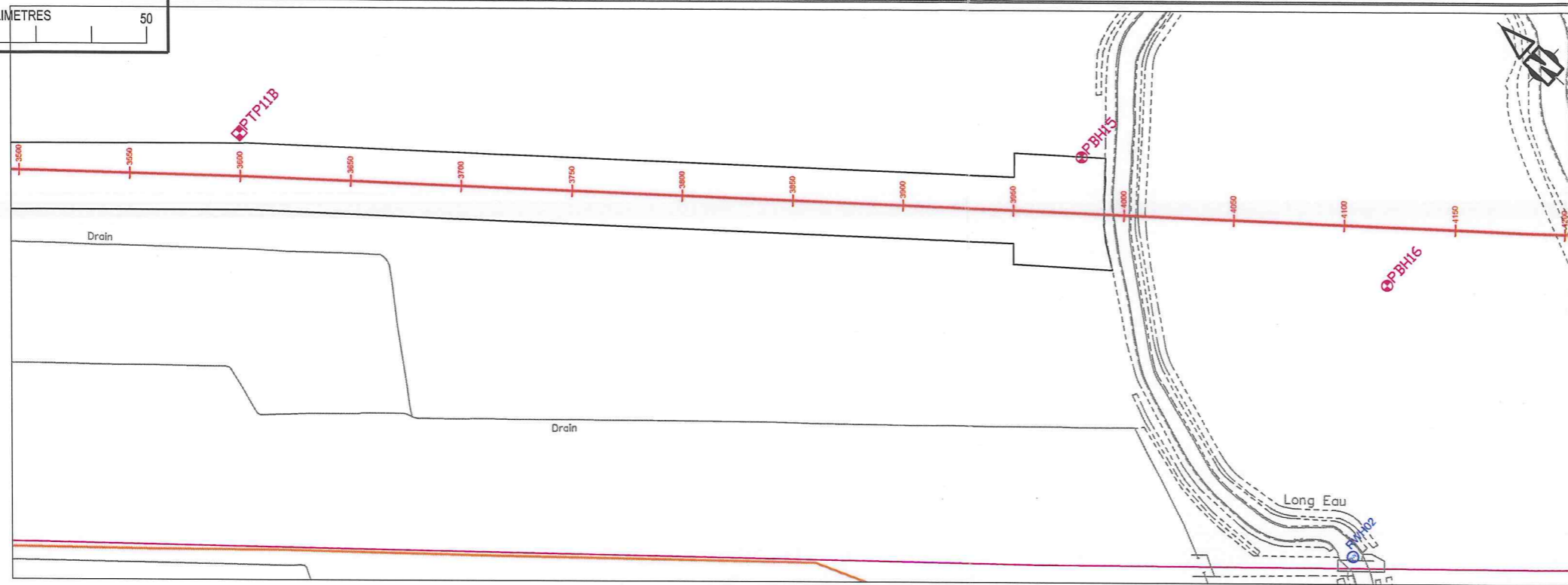
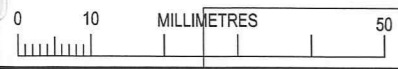

PLAN : SCALE 1:2500

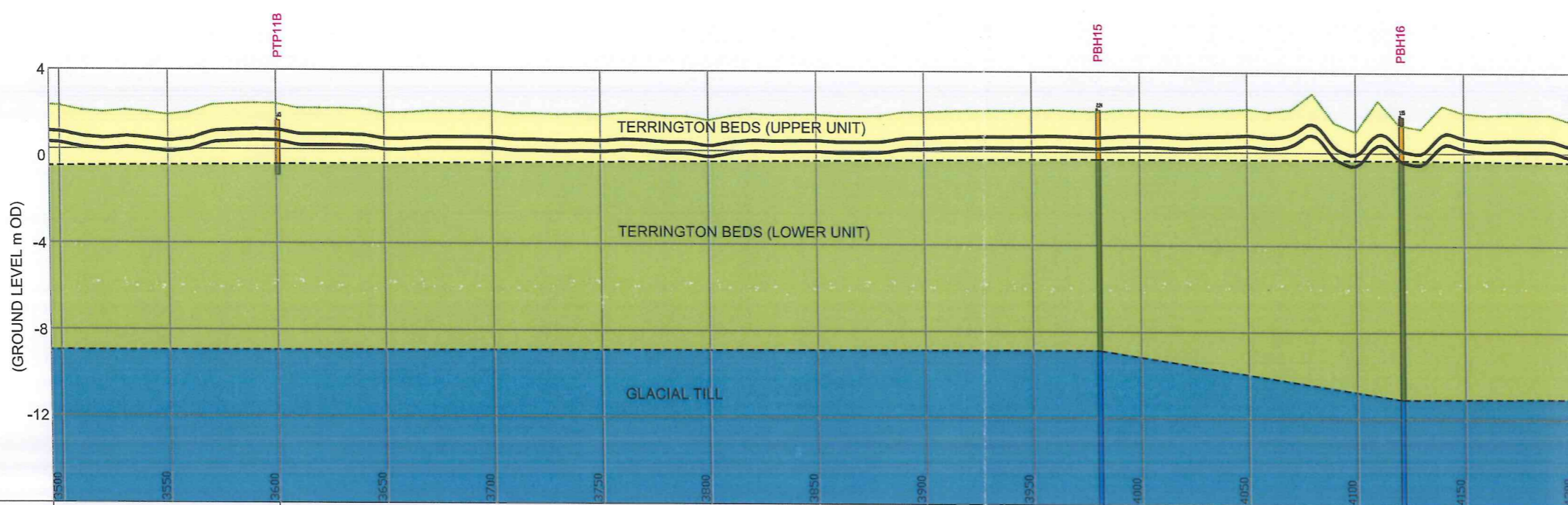

EXISTING GROUND LEVEL (m OD)		1.65		2.24		1.95	
CHAINAGE		3600		3980		4120	
INVERT LEVEL (m OD)							

LONGSECTION ALONG A-A' : SCALE HORZ 1:2500 VERT 1:250

ATKINS

- Legend**
- Fill Material
 - Topsoil
 - Terrington Beds (Upper Unit)
 - Terrington Beds (Lower Unit)
 - Peat
 - Glacial Till
- Notes:**
- The stratigraphy shown is based on information from the nearest exploratory holes to the chosen section. The actual stratigraphy could differ from what is shown due to local variations in ground conditions.
 - For information on groundwater please see the interpretative report.
 - These drawings should not be used as service information drawings. Some pipeline information is shown where it was available from Fluor's baseline plans. The accuracy of this information and the potential presence of other services has not been checked by Atkins.
 - The stratigraphy shown is a conjecture, based on information from the nearest exploratory holes to the chosen section. The actual stratigraphy could differ from what is shown due to local variations in ground conditions.
 - The ground surface profile, which was provided by Fluor, was developed from topographic survey data. At some locations, where the survey data is at a distance from the pipe-line route, the actual topographic profile will differ from that shown on this plan.

0	FOR CLIENT COMMENT	DH	29.07.11	AD	JB
REV	DESCRIPTION	BY	DATE	CHKD	AUTH

ATKINS

Atkins Limited
Chedwick House
Birchwood Park
Warrington
WA3 6AE
England

Telephone +44(0)1925 238000
Fax +44(0)1925 238500

CLIENT:

FLUOR.

Fluor Limited
Fluor Centre
140 Pinhurst Road
Farnborough
Hampshire GU14 7BF

PROJECT:

UGS SALTFLEETBY

TITLE:

FIGURE 10 : PIPELINE ROUTE
GEOLOGICAL LONG SECTION

SCALE:	ORIGINAL SIZE:	DESIGNED:	DRAWN:	CHECKED:	AUTHORISED:
SHOWN	A3	RS	DH	AD	JB
OFFICE:	DATE:	DATE:	DATE:	DATE:	DATE:
	29.07.11	29.07.11	29.07.11	29.07.11	29.07.11

PROJECT NO: 5097367_GTG20093413

REV: /0

PROJECT NO: 5097367_GTG20093

REV: /0

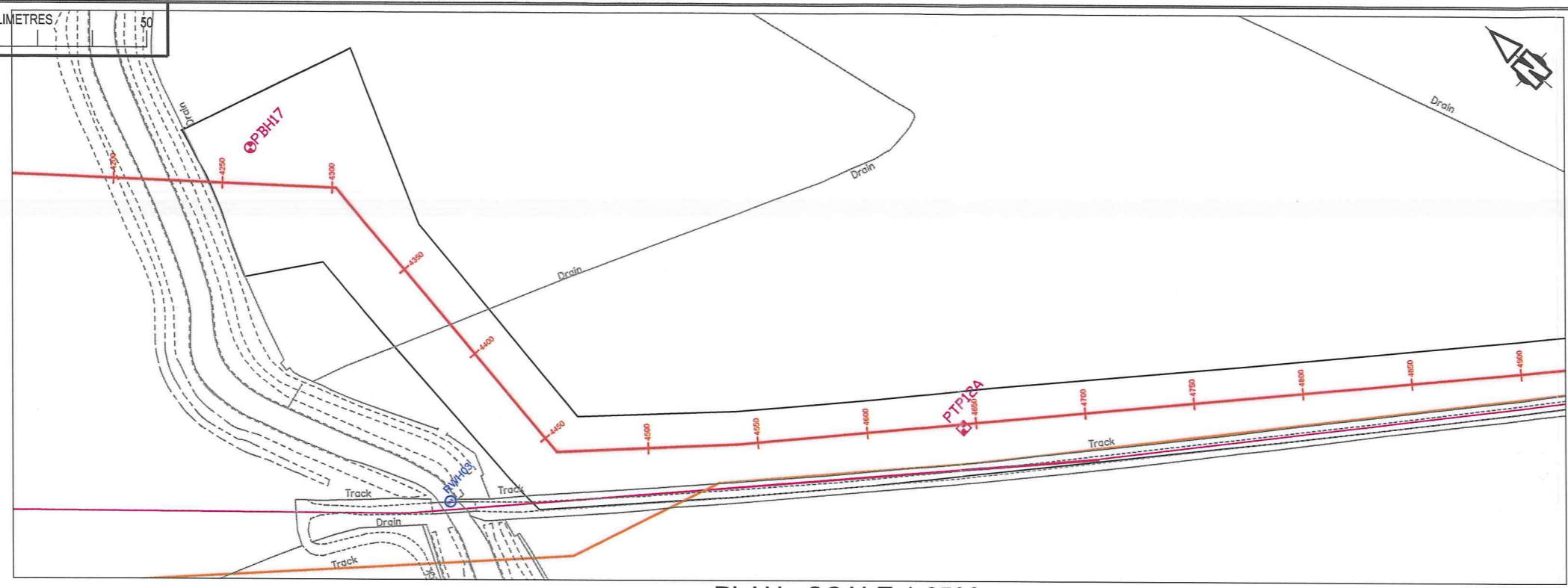
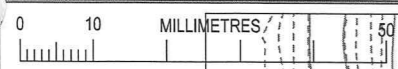

PLAN : SCALE 1:2500

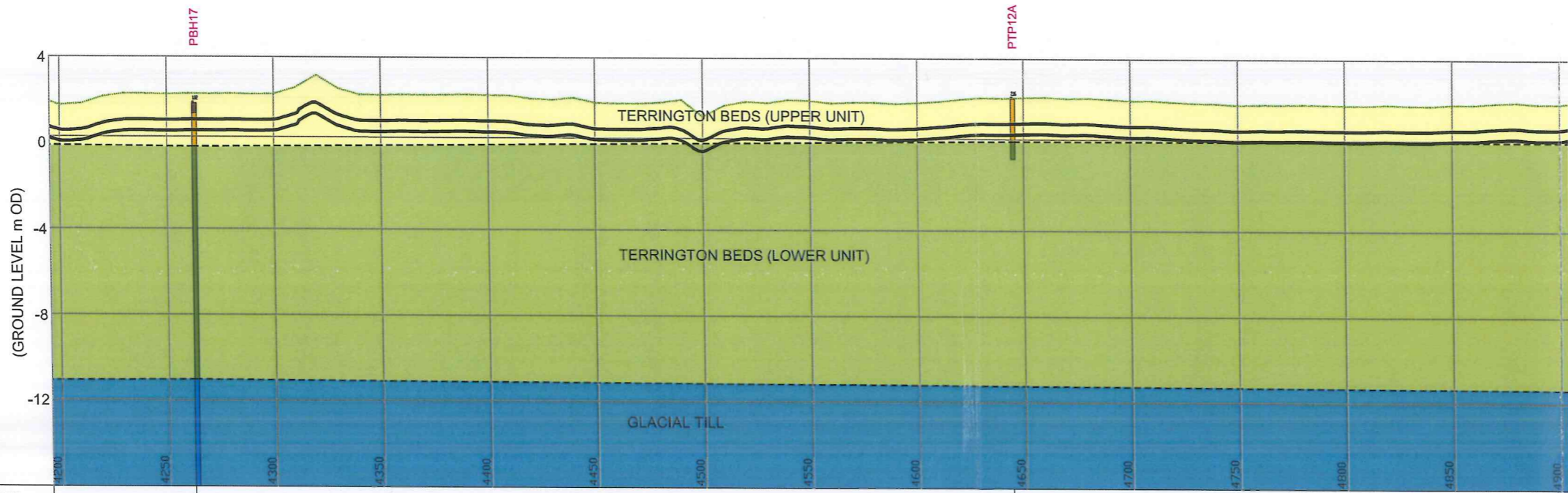

EXISTING GROUND LEVEL (m OD)	1.82	2.16
CHAINAGE	4262	4644
INVERT LEVEL (m OD)		

LONGSECTION ALONG A-A' : SCALE HORZ 1:2500 VERT 1:250

ATKINS

Legend

Fill Material	Terrington Beds (Lower Unit)
Topsoil	Peat
Terrington Beds (Upper Unit)	Glacial Till

- Section Line
- Existing 10inch Pipeline
- Existing Pipeline
- Existing Ground Level
- Proposed Pipeline
- Indicative Geological Boundary
- 2011 Ground Investigation
- 1999 Ground Investigation
- Surface Water Sample

- Notes:**
- The stratigraphy shown is based on information from the nearest exploratory holes to the chosen section. The actual stratigraphy could differ from what is shown due to local variations in ground conditions.
 - For information on groundwater please see the interpretative report.
 - These drawings should not be used as service information drawings. Some pipeline information is shown where it was available from Fluor's baseline plans. The accuracy of this information and the potential presence of other services has not been checked by Atkins.
 - The stratigraphy shown is a conjecture, based on information from the nearest exploratory holes to the chosen section. The actual stratigraphy could differ from what is shown due to local variations in ground conditions.
 - The ground surface profile, which was provided by Fluor, was developed from topographic survey data. At some locations, where the survey data is at a distance from the pipe-line route, the actual topographic profile will differ from that shown on this plan.

0	FOR CLIENT COMMENT	DH	29.07.11	AD	JB
---	--------------------	----	----------	----	----

ATKINS

Atkins Limited
Chadwick House
Birchwood Park
Warrington
WA3 6AE
England

Telephone +44(0)1925 238000
Fax +44(0)1925 238500

CLIENT:

FLUOR.

Fluor Limited
Fluor Centre
140 Pinehurst Road
Farnborough
Hampshire GU14 7BF

PROJECT:

UGS SALTFLEETBY

TITLE:

FIGURE 11 : PIPELINE ROUTE
GEOLOGICAL LONG SECTION

SCALE:	ORIGINAL SIZE:	DESIGNED:	DRAWN:	CHECKED:	AUTHORISED:
SHOWN	A3	RS	DH	AD	JB
	OFFICE:	DATE:	DATE:	DATE:	DATE:
		29.07.11	29.07.11	29.07.11	29.07.11

PROJECT NO: 5097367_GTG20093413

REV: 0

PROJECT NO: 5097367_GTG20093413

REV: 0

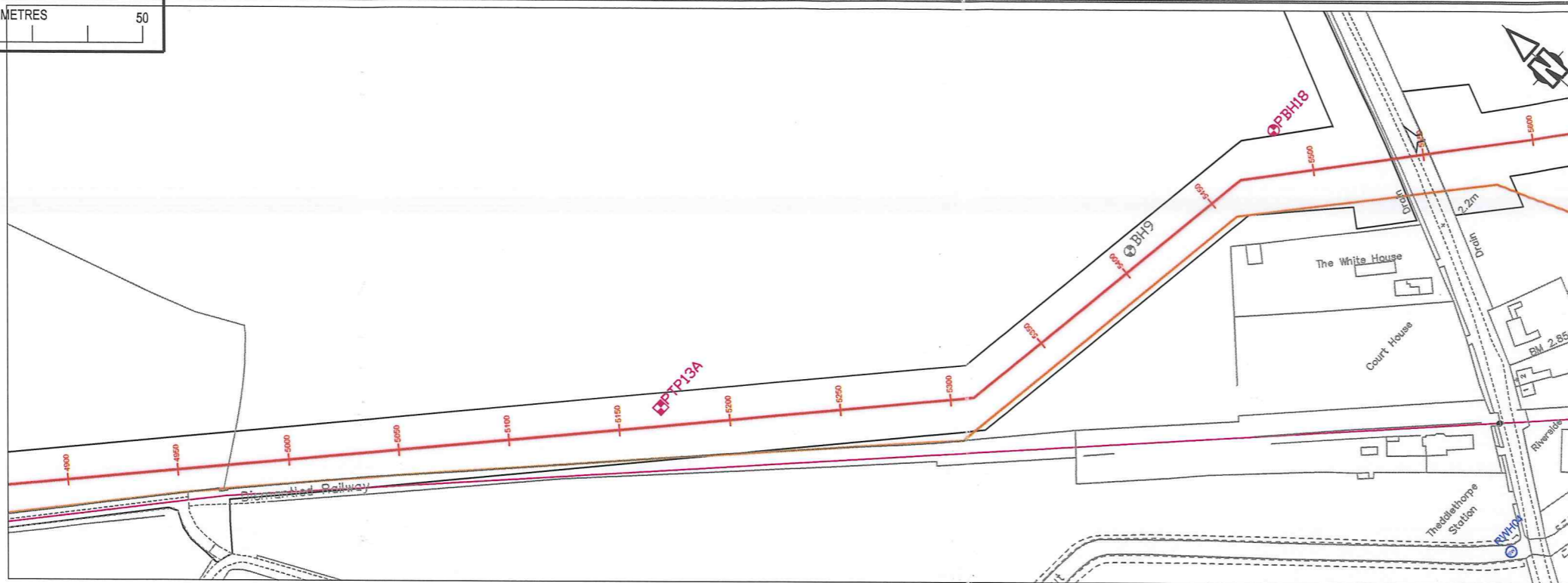
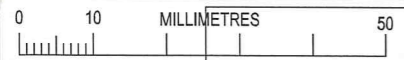

PLAN : SCALE 1:2500

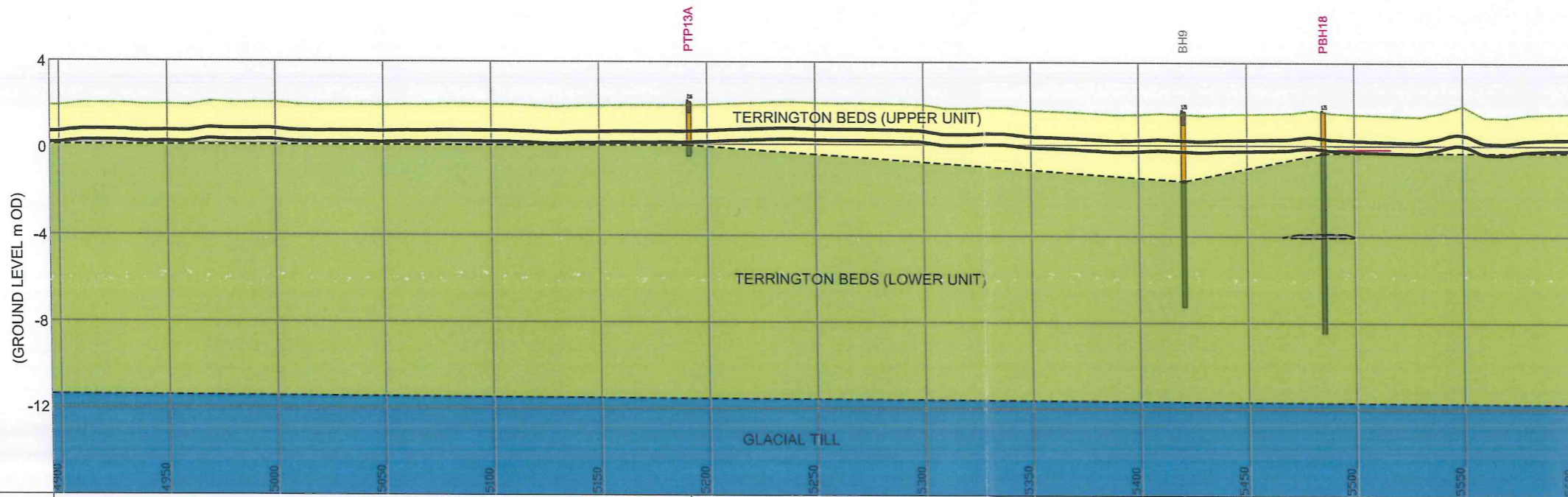

EXISTING GROUND LEVEL (m OD)	CHAINAGE	INVERT LEVEL (m OD)
2.16	5190	
1.75	5420	
1.75	5485	

LONGSECTION ALONG A-A' : SCALE HORZ 1:2500 VERT 1:250

ATKINS

Legend

Fill Material	Terrington Beds (Lower Unit)
Topsoil	Peat
Terrington Beds (Upper Unit)	Glacial Till

- Section Line
- Existing 10inch Pipeline
- Existing Pipeline
- Existing Ground Level
- Proposed Pipeline
- Indicative Geological Boundary
- 2011 Ground Investigation
- 1999 Ground Investigation
- Surface Water Sample

- Notes:
- The stratigraphy shown is based on information from the nearest exploratory holes to the chosen section. The actual stratigraphy could differ from what is shown due to local variations in ground conditions.
 - For information on groundwater please see the interpretative report.
 - These drawings should not be used as service information drawings. Some pipeline information is shown where it was available from Fluor's baseline plans. The accuracy of this information and the potential presence of other services has not been checked by Atkins.
 - The stratigraphy shown is a conjecture, based on information from the nearest exploratory holes to the chosen section. The actual stratigraphy could differ from what is shown due to local variations in ground conditions.
 - The ground surface profile, which was provided by Fluor, was developed from topographic survey data. At some locations, where the survey data is at a distance from the pipe-line route, the actual topographic profile will differ from that shown on this plan.

0	FOR CLIENT COMMENT	DH	29.07.11	AD	JB
REV	DESCRIPTION	BY	DATE	CHKD	AUTH

ATKINS
 Atkins Limited
 Chadwick House
 Birchwood Park
 Warrington
 WA3 6AE
 England
 Telephone +44(0)1925 238000
 Fax +44(0)1925 238500

CLIENT:
FLUOR.
 Fluor Limited
 Fluor Centre
 140 Pinehurst Road
 Farnborough
 Hampshire GU14 7BF

PROJECT:
 UGS SALTFLEETBY

TITLE:
 FIGURE 12 : PIPELINE ROUTE
 GEOLOGICAL LONG SECTION

SCALE:	ORIGINAL SIZE:	DESIGNED:	DRAWN:	CHECKED:	AUTHORISED:
SHOWN	A3	RS	DH	AD	JB
OFFICE:	DATE:	DATE:	DATE:	DATE:	DATE:
	29.07.11	29.07.11	29.07.11	29.07.11	29.07.11

PROJECT NO:
 5097367_GTG20093413 / 0

PROJECT NO:
 5097367_GTG20093413

REV:
 / 0

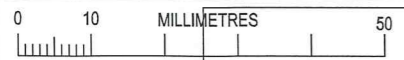

PLAN : SCALE 1:2500

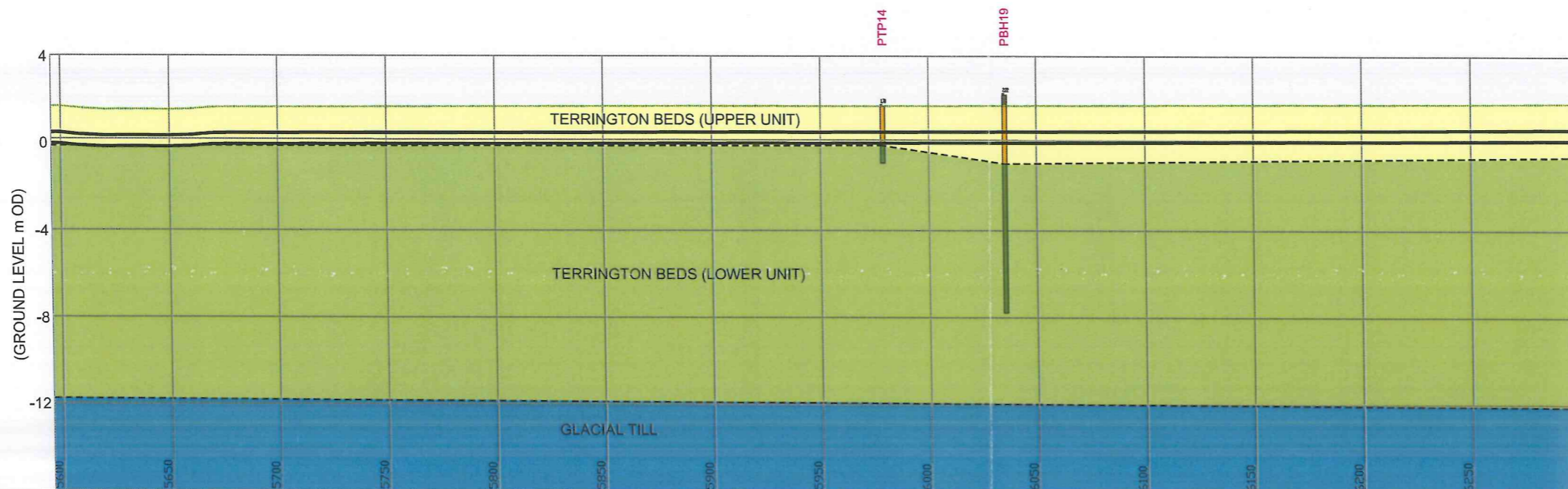

EXISTING GROUND LEVEL (m OD)	CHAINAGE	INVERT LEVEL (m OD)
	5978	1.70
	6035	2.22

LONGSECTION ALONG A-A' : SCALE HORZ 1:2500 VERT 1:250

ATKINS

- Legend**
- Fill Material
 - Topsoil
 - Terrington Beds (Upper Unit)
 - Terrington Beds (Lower Unit)
 - Peat
 - Glacial Till
- Notes:**
- The stratigraphy shown is based on information from the nearest exploratory holes to the chosen section. The actual stratigraphy could differ from what is shown due to local variations in ground conditions.
 - For information on groundwater please see the interpretative report.
 - These drawings should not be used as service information drawings. Some pipeline information is shown where it was available from Fluor's baseline plans. The accuracy of this information and the potential presence of other services has not been checked by Atkins.
 - The stratigraphy shown is a conjecture, based on information from the nearest exploratory holes to the chosen section. The actual stratigraphy could differ from what is shown due to local variations in ground conditions.
 - The ground surface profile, which was provided by Fluor, was developed from topographic survey data. At some locations, where the survey data is at a distance from the pipe-line route, the actual topographic profile will differ from that shown on this plan.

- Notes:**
- The stratigraphy shown is based on information from the nearest exploratory holes to the chosen section. The actual stratigraphy could differ from what is shown due to local variations in ground conditions.
 - For information on groundwater please see the interpretative report.
 - These drawings should not be used as service information drawings. Some pipeline information is shown where it was available from Fluor's baseline plans. The accuracy of this information and the potential presence of other services has not been checked by Atkins.
 - The stratigraphy shown is a conjecture, based on information from the nearest exploratory holes to the chosen section. The actual stratigraphy could differ from what is shown due to local variations in ground conditions.
 - The ground surface profile, which was provided by Fluor, was developed from topographic survey data. At some locations, where the survey data is at a distance from the pipe-line route, the actual topographic profile will differ from that shown on this plan.

0	FOR CLIENT COMMENT	DH	29.07.11	AD	JB
---	--------------------	----	----------	----	----

ATKINS

Atkins Limited
Chadwick House
Birchwood Park
Warrington
WA3 6AE
England

Telephone +44(0)1925 238000
Fax +44(0)1925 238500

CLIENT:

FLUOR.

Fluor Limited
Fluor Centre
140 Pinehurst Road
Farnborough
Hampshire GU14 7BF

PROJECT:

UGS SALTFLEETBY

TITLE:

FIGURE 13 : PIPELINE ROUTE
GEOLOGICAL LONG SECTION

SCALE:	ORIGINAL SIZE: A3	DESIGNED: RS	DRAWN: DH	CHECKED: AD	AUTHORISED: JB
SHOWN:	OFFICE:	DATE: 29.07.11	DATE: 29.07.11	DATE: 29.07.11	DATE: 29.07.11

PROJECT NO: 5097367_GTG20093413

REV: /0

PROJECT NO: 5097367_GTG20093413

REV: /0

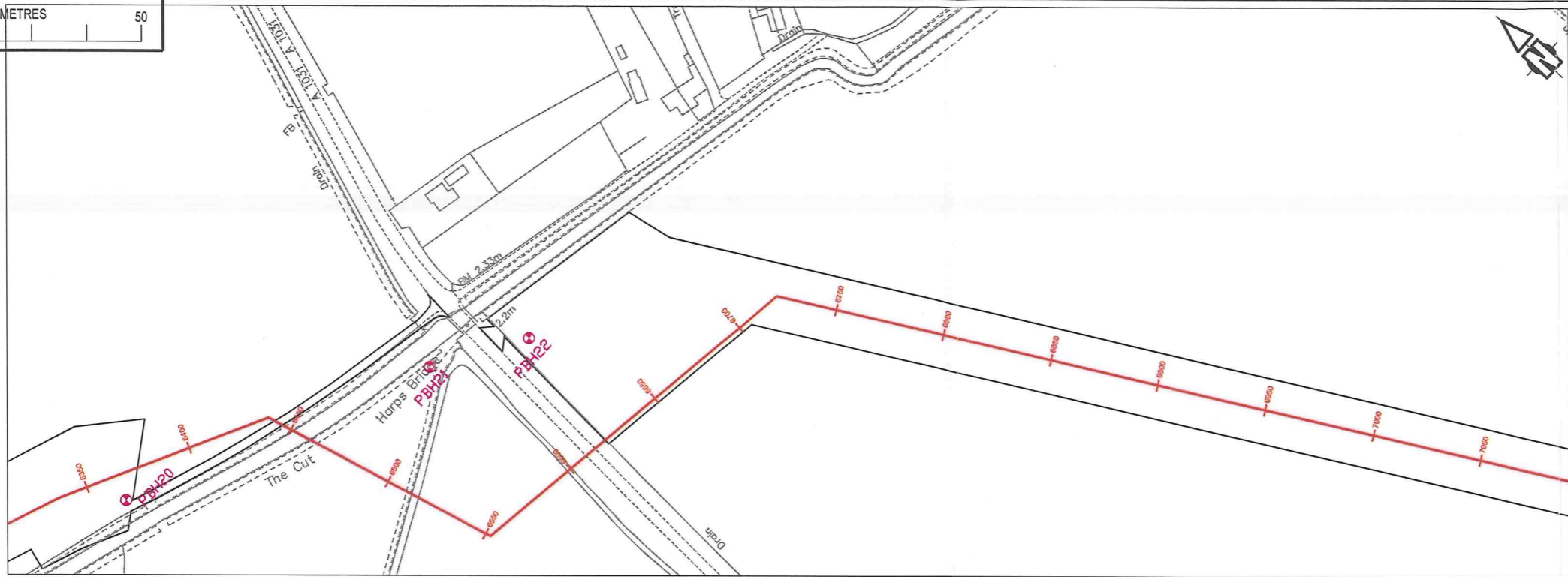

PLAN : SCALE 1:2500

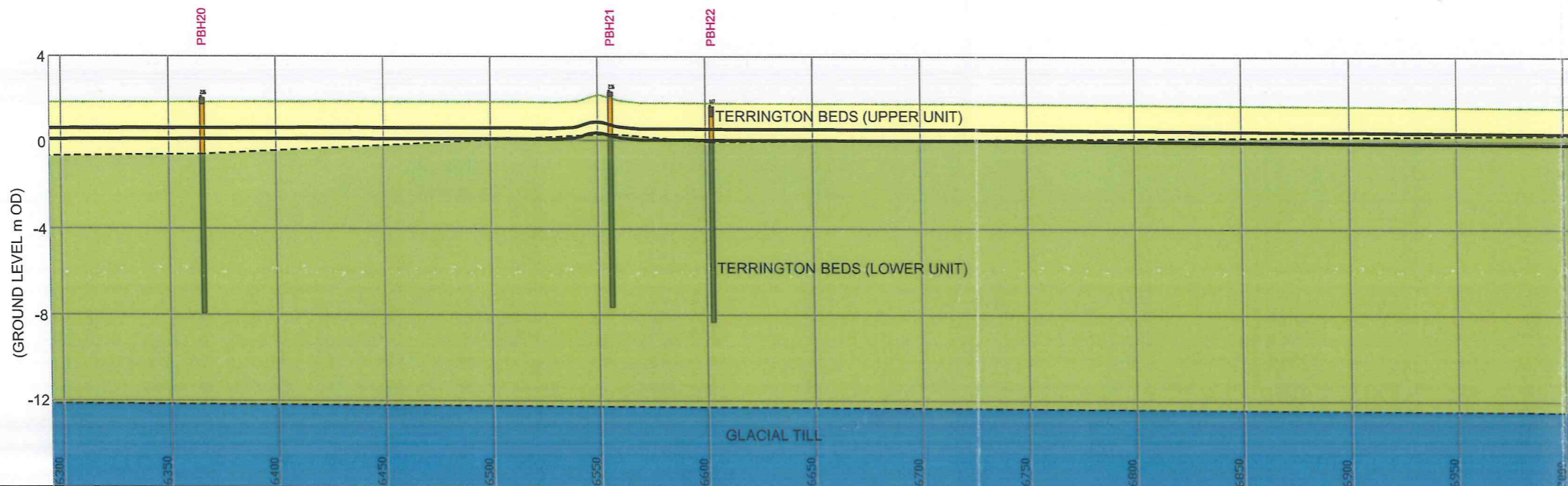

EXISTING GROUND LEVEL (m OD)	CHAINAGE	INVERT LEVEL (m OD)
2.06	6365	
2.36	6555	
1.67	6602	

LONGSECTION ALONG A-A' : SCALE HORZ 1:2500 VERT 1:250

ATKINS

- Legend**
- Fill Material
 - Topsoil
 - Terrington Beds (Upper Unit)
 - Terrington Beds (Lower Unit)
 - Peat
 - Glacial Till
- Notes:**
- The stratigraphy shown is based on information from the nearest exploratory holes to the chosen section. The actual stratigraphy could differ from what is shown due to local variations in ground conditions.
 - For information on groundwater please see the interpretative report.
 - These drawings should not be used as service information drawings. Some pipeline information is shown where it was available from Fluor's baseline plans. The accuracy of this information and the potential presence of other services has not been checked by Atkins.
 - The stratigraphy shown is a conjecture, based on information from the nearest exploratory holes to the chosen section. The actual stratigraphy could differ from what is shown due to local variations in ground conditions.
 - The ground surface profile, which was provided by Fluor, was developed from topographic survey data. At some locations, where the survey data is at a distance from the pipe-line route, the actual topographic profile will differ from that shown on this plan.

REV	DESCRIPTION	BY	DATE	CHKD	AUTH
0	FOR CLIENT COMMENT	DH	29.07.11	AD	JB

ATKINS
 Atkins Limited
 Chadwick House
 Birchwood Park
 Warrington
 WA3 6AE
 England
 Telephone +44(0)1925 238000
 Fax +44(0)1925 238500

CLIENT:
FLUOR.
 Fluor Limited
 Fluor Centre
 140 Pinehurst Road
 Farnborough
 Hampshire GU14 7BF

PROJECT:
 UGS SALTFLEETBY

TITLE:
 FIGURE 14 : PIPELINE ROUTE
 GEOLOGICAL LONG SECTION

SCALE:	ORIGINAL SIZE:	DESIGNED:	DRAWN:	CHECKED:	AUTHORISED:
SHOWN	A3	RS	DH	AD	JB
OFFICE:	DATE:	DATE:	DATE:	DATE:	DATE:
	29.07.11	29.07.11	29.07.11	29.07.11	29.07.11

PROJECT NO: 5097367_GTG20093413
REV: /0

PROJECT NO: 5097367_GTG20093413

REV: /0

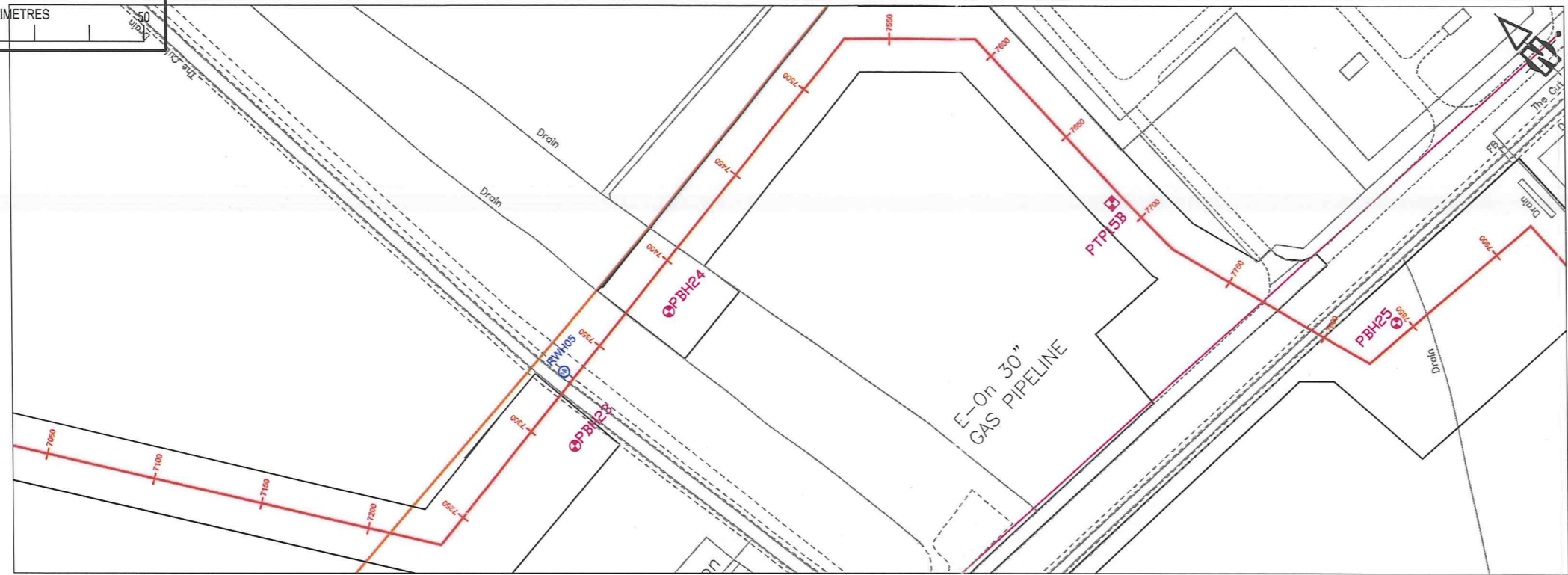
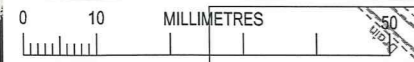

PLAN : SCALE 1:2500

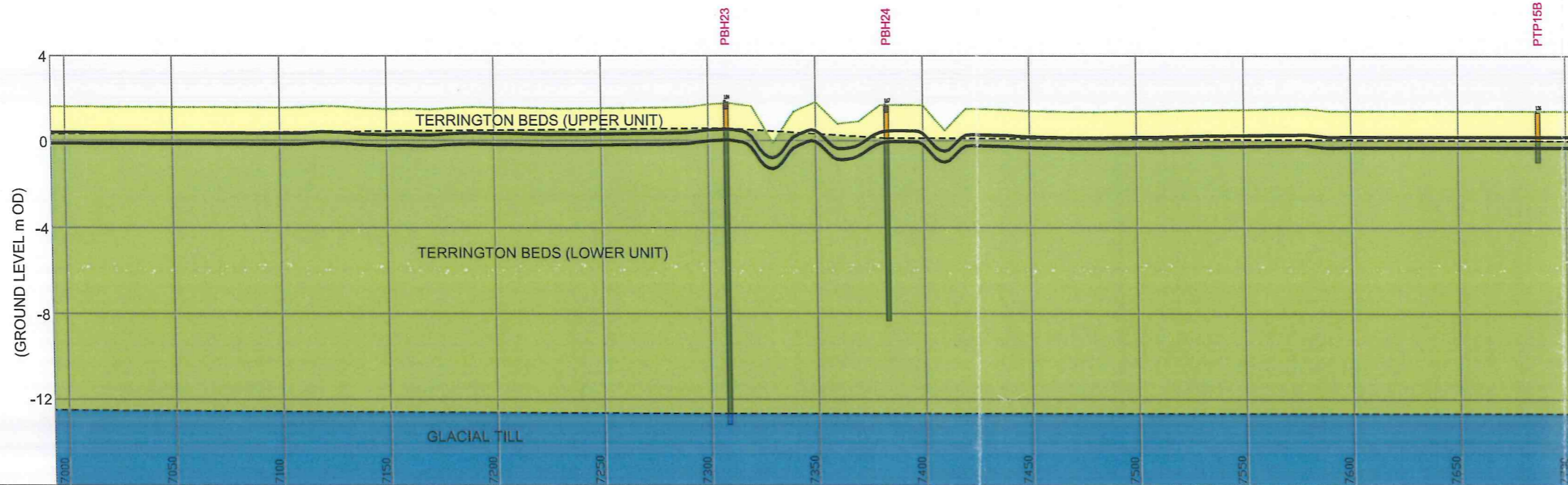

EXISTING GROUND LEVEL (m OD)		1.84	1.67	1.36
CHAINAGE		7307	7382	7686
INVERT LEVEL (m OD)				

LONGSECTION ALONG A-A' : SCALE HORZ 1:2500 VERT 1:250

ATKINS

- Legend**
- Fill Material
 - Topsoil
 - Terrington Beds (Upper Unit)
 - Terrington Beds (Lower Unit)
 - Peat
 - Glacial Till
- Notes:**
- The stratigraphy shown is based on information from the nearest exploratory holes to the chosen section. The actual stratigraphy could differ from what is shown due to local variations in ground conditions.
 - For information on groundwater please see the interpretative report.
 - These drawings should not be used as service information drawings. Some pipeline information is shown where it was available from Fluor's baseline plans. The accuracy of this information and the potential presence of other services has not been checked by Atkins.
 - The stratigraphy shown is a conjecture, based on information from the nearest exploratory holes to the chosen section. The actual stratigraphy could differ from what is shown due to local variations in ground conditions.
 - The ground surface profile, which was provided by Fluor, was developed from topographic survey data. At some locations, where the survey data is at a distance from the pipe-line route, the actual topographic profile will differ from that shown on this plan.

- Notes:**
- The stratigraphy shown is based on information from the nearest exploratory holes to the chosen section. The actual stratigraphy could differ from what is shown due to local variations in ground conditions.
 - For information on groundwater please see the interpretative report.
 - These drawings should not be used as service information drawings. Some pipeline information is shown where it was available from Fluor's baseline plans. The accuracy of this information and the potential presence of other services has not been checked by Atkins.
 - The stratigraphy shown is a conjecture, based on information from the nearest exploratory holes to the chosen section. The actual stratigraphy could differ from what is shown due to local variations in ground conditions.
 - The ground surface profile, which was provided by Fluor, was developed from topographic survey data. At some locations, where the survey data is at a distance from the pipe-line route, the actual topographic profile will differ from that shown on this plan.

0	FOR CLIENT COMMENT	DH	29.07.11	AD	JB
---	--------------------	----	----------	----	----

ATKINS

Atkins Limited
 Chadwick House
 Birchwood Park
 Warrington
 WA3 6AE
 England

Telephone +44(0)1925 238000
 Fax +44(0)1925 238500

CLIENT:

FLUOR.

Fluor Limited
 Fluor Centre
 140 Pinehurst Road
 Farnborough
 Hampshire GU14 7BF

PROJECT:

UGS SALTFLEETBY

TITLE:

FIGURE 15 : PIPELINE ROUTE
 GEOLOGICAL LONG SECTION

SCALE:	ORIGINAL SIZE:	DESIGNED:	DRAWN:	CHECKED:	AUTHORISED:
SHOWN	A3	RS	DH	AD	JB
OFFICE:	DATE:	DATE:	DATE:	DATE:	DATE:
	29.07.11	29.07.11	29.07.11	29.07.11	29.07.11

PROJECT NO: 5097367_GTG20093413

REV: /0

PROJECT NO: 5097367_GTG20093413

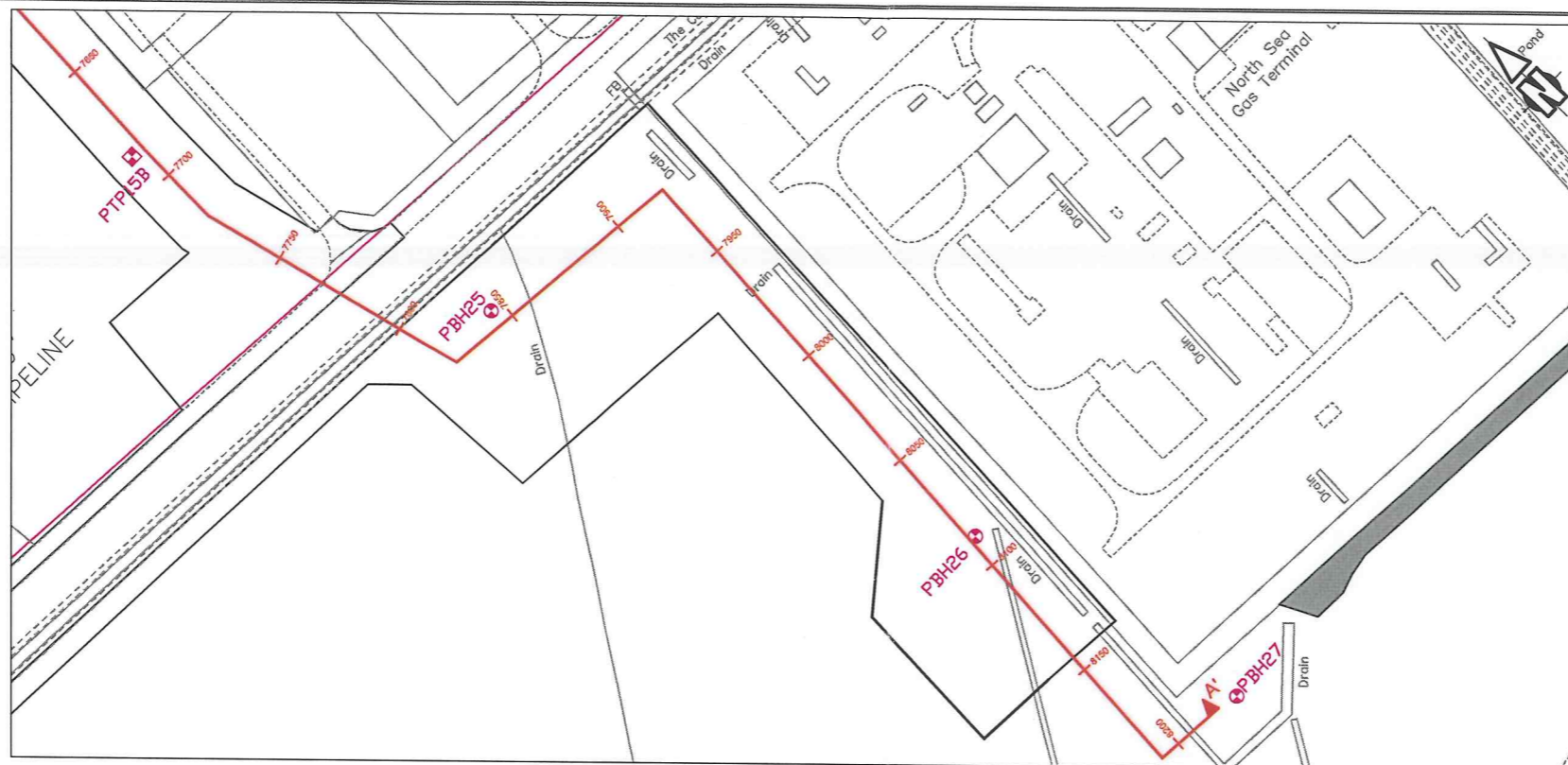
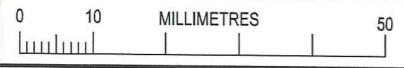

PLAN : SCALE 1:2500

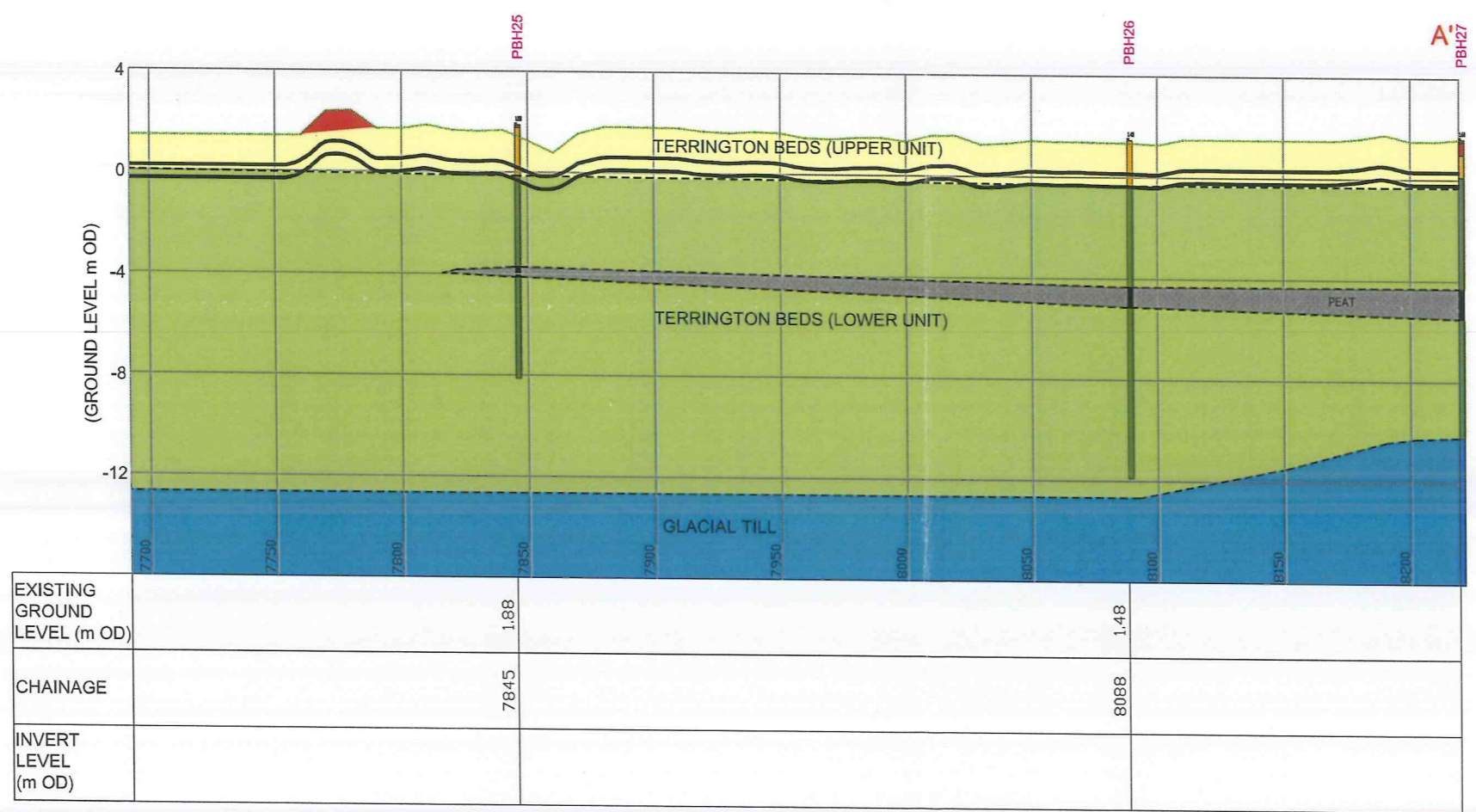

LONGSECTION ALONG A-A' : SCALE HORZ 1:2500 VERT 1:250

ATKINS

- Legend**
- Fill Material
 - Topsoil
 - Terrington Beds (Upper Unit)
 - Terrington Beds (Lower Unit)
 - Peat
 - Glacial Till
- Notes:**
- The stratigraphy shown is based on information from the nearest exploratory holes to the chosen section. The actual stratigraphy could differ from what is shown due to local variations in ground conditions.
 - For information on groundwater please see the interpretative report.
 - These drawings should not be used as service information drawings. Some pipeline information is shown where it was available from Fluor's baseline plans. The accuracy of this information and the potential presence of other services has not been checked by Atkins.
 - The stratigraphy shown is a conjecture, based on information from the nearest exploratory holes to the chosen section. The actual stratigraphy could differ from what is shown due to local variations in ground conditions.
 - The ground surface profile, which was provided by Fluor, was developed from topographic survey data. At some locations, where the survey data is at a distance from the pipe-line route, the actual topographic profile will differ from that shown on this plan.

0	FOR CLIENT COMMENT	DH	29.07.11	AD	JB
REV	DESCRIPTION	BY	DATE	CHKD	AUTH

ATKINS
 Atkins Limited
 Chadwick House
 Birchwood Park
 Warrington
 WA5 6AE
 England
 Telephone +44(0)1925 238000
 Fax +44(0)1925 238500

CLIENT:
FLUOR.
 Fluor Limited
 Fluor Centre
 140 Pinhurst Road
 Farnborough
 Hampshire GU14 7BF

PROJECT:
 UGS SALTFLEETBY

TITLE:
 FIGURE 16 : PIPELINE ROUTE
 GEOLOGICAL LONG SECTION

SCALE:	ORIGINAL SIZE:	DESIGNED:	DRAWN:	CHECKED:	AUTHORISED:
SHOWN	A3	RS	DH	AD	JB
OFFICE:	DATE:	DATE:	DATE:	DATE:	DATE:
	29.07.11	29.07.11	29.07.11	29.07.11	29.07.11
PROJECT NO:	5097367_GTG20093413				REV:
					0

PROJECT NO: 5097367_GTG20093413

REV: 0