

H.M. LAND REGISTRY		TITLE NUMBER		
		DN366521		
ORDNANCE SURVEY PLAN REFERENCE	SS9414 SS9514	Scale 1/2500		
COUNTY DEVON	DISTRICT MID DEVON	© Crown copyright		
NOTE. AREAS ON THIS PLAN ARE EXPRESSED IN ACRES AND HECTARES.				

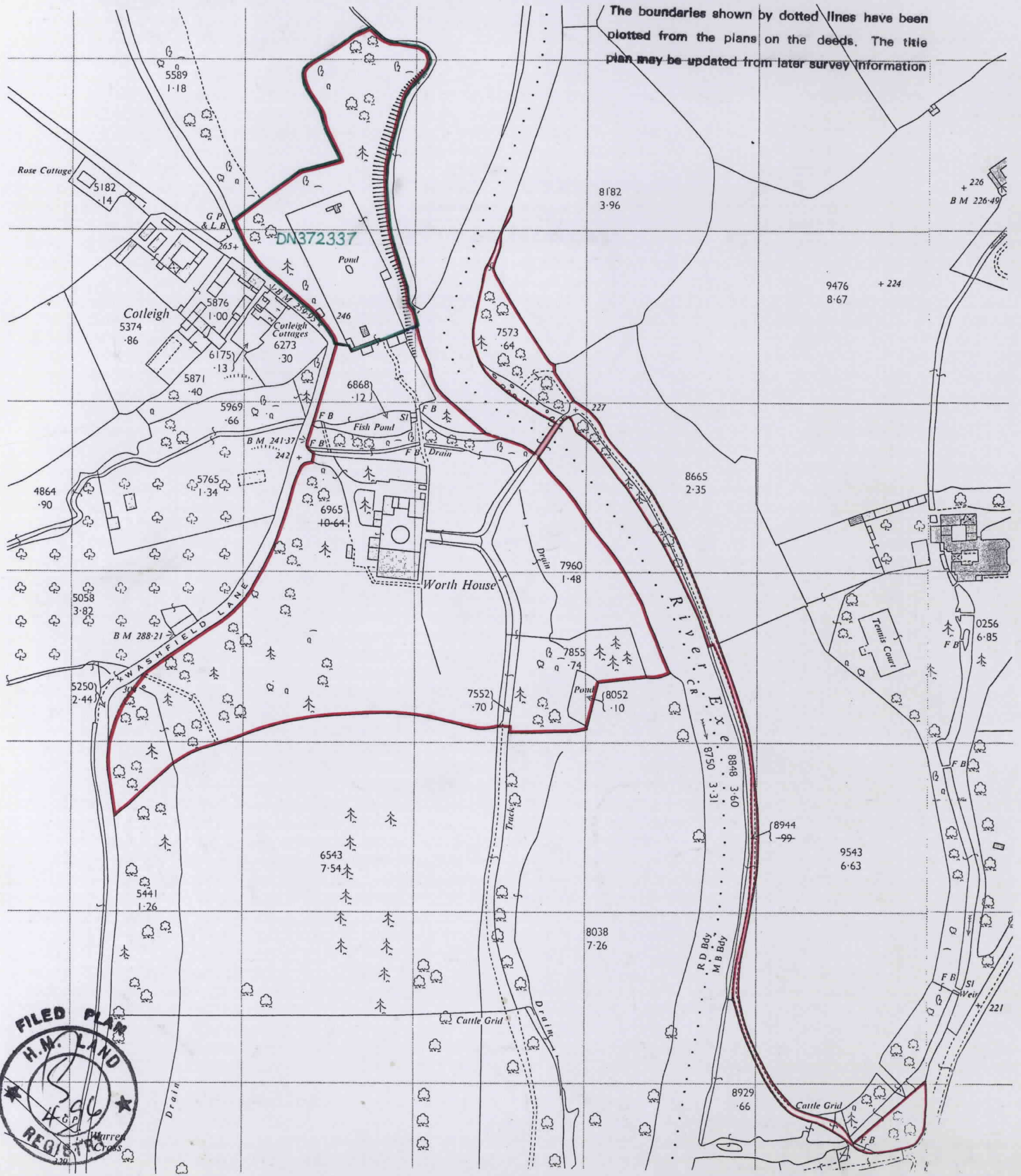

This is a copy of the title plan on 28 OCT 2021 at 15:02:02. This copy does not take account of any application made after that time even if still pending in HM Land Registry when this copy was issued.

This copy is not an 'Official Copy' of the title plan. An official copy of the title plan is admissible in evidence in a court to the same extent as the original. A person is entitled to be indemnified by the registrar if he or she suffers loss by reason of a mistake in an official copy. If you want to obtain an official copy, the HM Land Registry web site explains how to do this.

HM Land Registry endeavours to maintain high quality and scale accuracy of title plan images. The quality and accuracy of any print will depend on your printer, your computer and its print settings. This title plan shows the general position, not the exact line, of the boundaries. It may be subject to distortions in scale. Measurements scaled from this plan may not match measurements between the same points on the ground.

This title is dealt with by HM Land Registry, Plymouth Office.

© Crown Copyright. Produced by HM Land Registry. Further reproduction in whole or in part is prohibited without the prior written permission of Ordnance Survey. Licence Number 100026316.

1

2

3

4

5

6

7

8

F

E

D

C

B

A

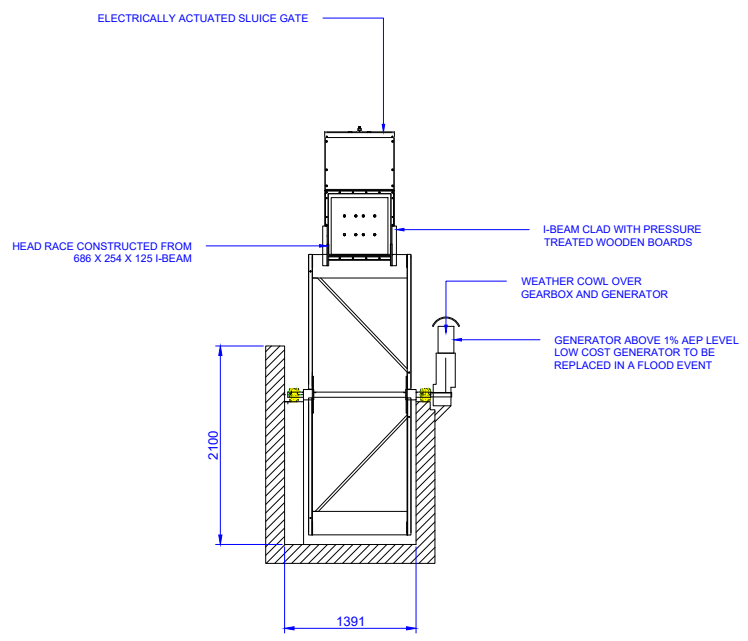
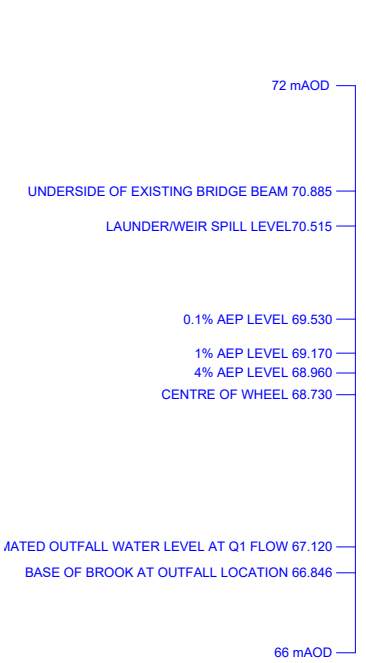
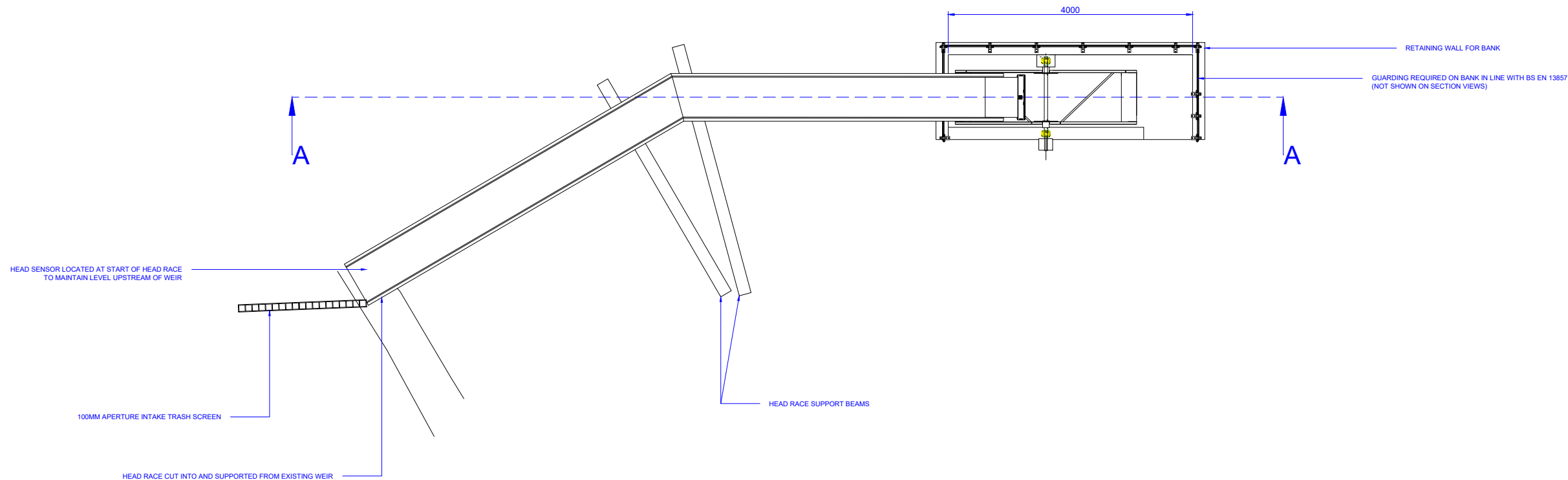

SECTION B-B

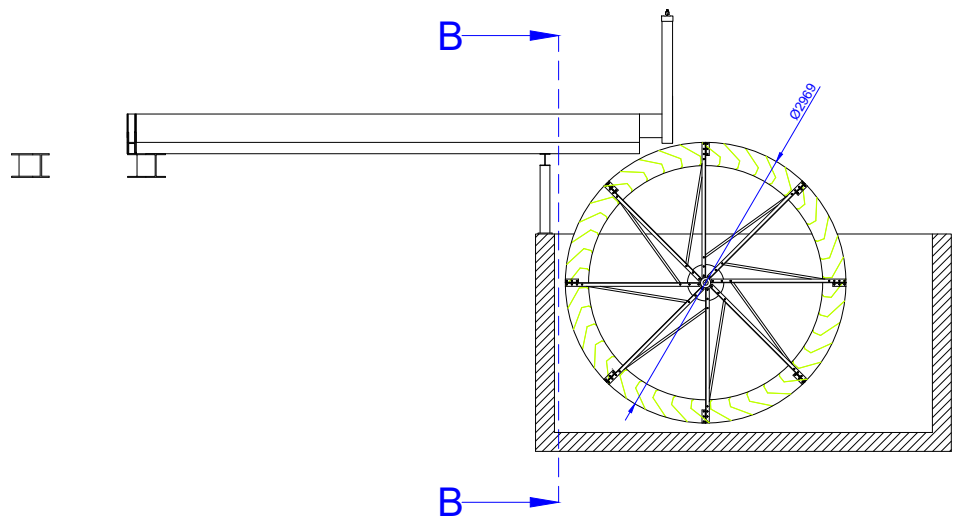

SECTION A-A

NOTES:

- This design should not be copied in any way without permission of the author or the Client mentioned below.
- This drawing contains 3rd party data that, whilst confirmed sufficient for purpose of this drawing has not been verified in entirety.

REFERENCE DRAWINGS
WORTH_P002

00	FIRST ISSUE	JG	14-09-22
Rev.	Description:	By:	Date:

Client:
Tom Babbedge/ Karen Hannan

Site Name:
Worth House HEP

Drawing Title:
General Arrangement

Drawing No:
WORTH_P002

Drawn By / Date
JG / 14-09-2022

Checked By:
AE

Revision:
1

Scale:
1:80

Papersize:
A3

Status:
CONSENTS

Sheet of sheets:
1 OF 1

Brimscombe Mill, Brimscombe,
Stroud, Gloucestershire, GL5 2QG

Tel.: 01453 88 77 44
FAX: 01453 88 77 84

www.renewablesfirst.co.uk

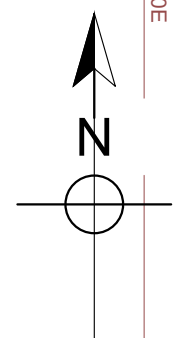

CABLE ROUTE (POWER AND CONTROL)
BACK TO EXISTING SUMMER HOUSE
ALL CONTROL EQUIPMENT
LOCATED IN SUMMER HOUSE

NEW CONCRETE STRUCTURE CUT INTO BANK SO
WATERCOURSE IS DIMENSIONALLY UNAFFECTED.
EXISTING RETAINING WALL TO BE REMOVED AS
REQUIRED AND BANK EXCAVATED.

114700N

114700N

114680N

114680N

NOTES:

1. This design should not be copied in any way without permission of the author or the Client mentioned below.
2. This drawing contains 3rd party data that, whilst confirmed sufficient for purpose of this drawing has not been verified in entirety.

REFERENCE DRAWINGS
WORTH_P002

-	-	-	-
00	FIRST ISSUE	JG	14-09-22
Rev.	Description:	By:	Date:

Client:
Tom Babbedge/ Karen Hannan

Site Name:
Worth House HEP

Drawing Title:
Site Plan

Drawing No:
WORTH_P001

Drawn By / Date
JG / 14-09-2022

Checked By: AE
Revision: 1

Scale: 1:100
Papersize: A3

Status: CONSENTS
Sheet of sheets: 1 OF 1

Renewables FIRST
Brimscombe Mill, Brimscombe,
Stroud, Gloucestershire, GL5 2QG
Tel.: 01453 88 77 44
FAX: 01453 88 77 84
www.renewablesfirst.co.uk

