



**REPORT**

# Biffa Waste Services Ltd., Renwick Road Rail Hub

## *Environmental Permit Application, Non-Technical Summary*

Submitted to:

**Biffa Waste Services Ltd**

Redhill Landfill Site  
Cormongers Lane  
Redhill  
Surrey  
RH1 4ER

Submitted by:

**Golder Associates (UK) Ltd**

Attenborough House Browns Lane Business Park Stanton-on-the-Wolds  
Nottingham NG12 5BL UK

+44 0 115 937 1111

18107248.607/A.1

December 2019

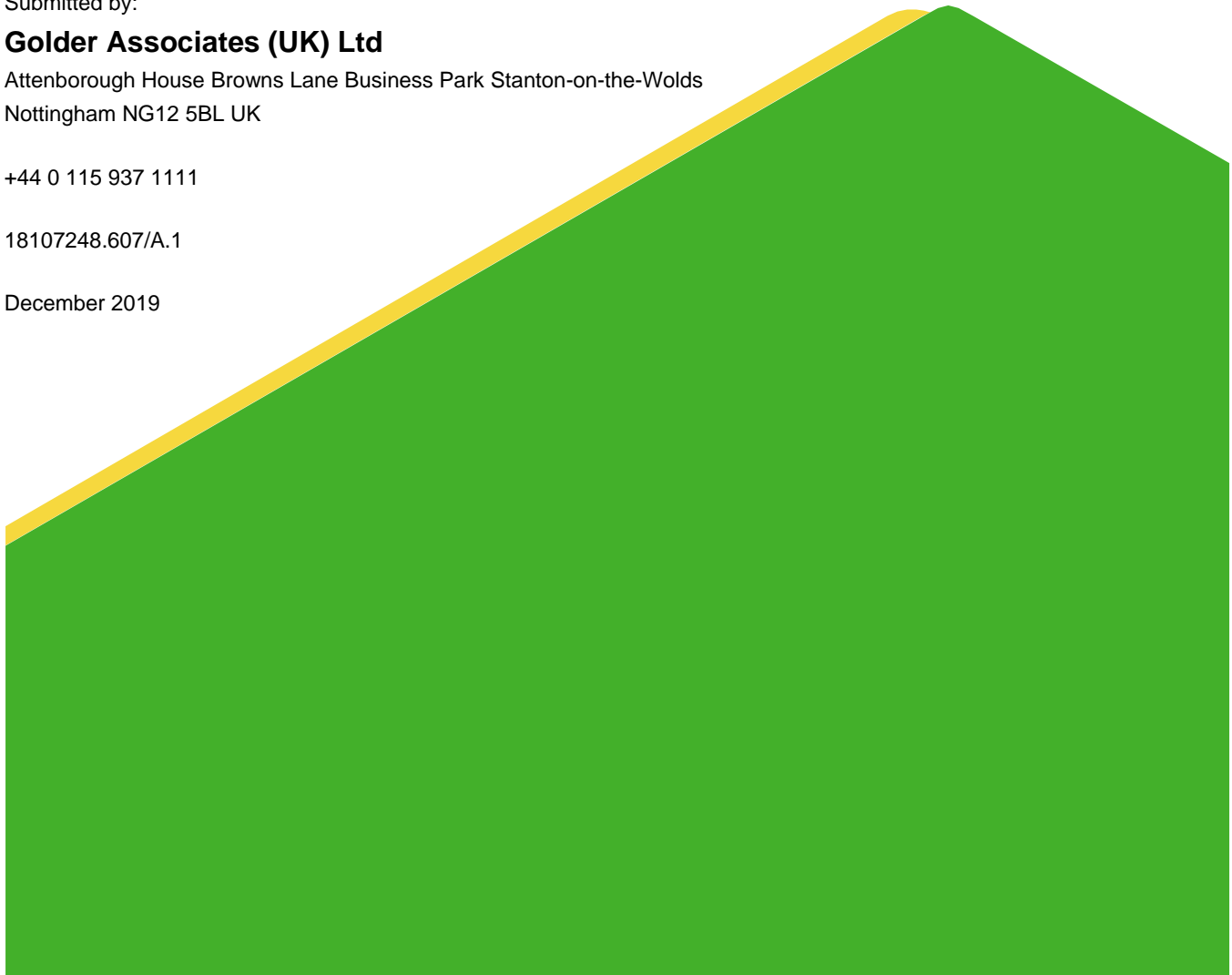

## Distribution List

Biffa Waste Services Ltd - 1 copy (pdf)

Environment Agency - 1 copy (pdf)

Golder Associates (UK) Ltd - 1 copy (pdf)

# Table of Contents

**1.0 NON-TECHNICAL SUMMARY ..... 1**

## 1.0 NON-TECHNICAL SUMMARY

Biffa Waste Services Ltd. (Biffa) has been servicing the waste management needs of the UK since 1912 and is now a UK leading integrated waste management company. Founded over 100 years ago, Biffa has always been at the forefront of development and innovation within the waste management industry. Named after the founder, Richard Biffa, the business was formed as a haulage company providing services to coal power stations in London. Now in the 21st Century, Biffa is a UK leading integrated waste management and recycling business.

Today, Biffa is proud to lead the waste and recycling industry. With operations at over 195 sites spanning the length and breadth of the country, our business has developed far beyond waste collection and into recycling, treatment and energy generation services.

Biffa is applying for an Environmental Permit for a Rail Hub, Waste Transfer Station, at Renwick Road, Barking, East London (the 'Site') in co-operation with GB Rail Freight, a leading rail freight operator. Biffa currently operates similar facilities in Leeds and Manchester. The Permit boundary is shown in Figure 1.

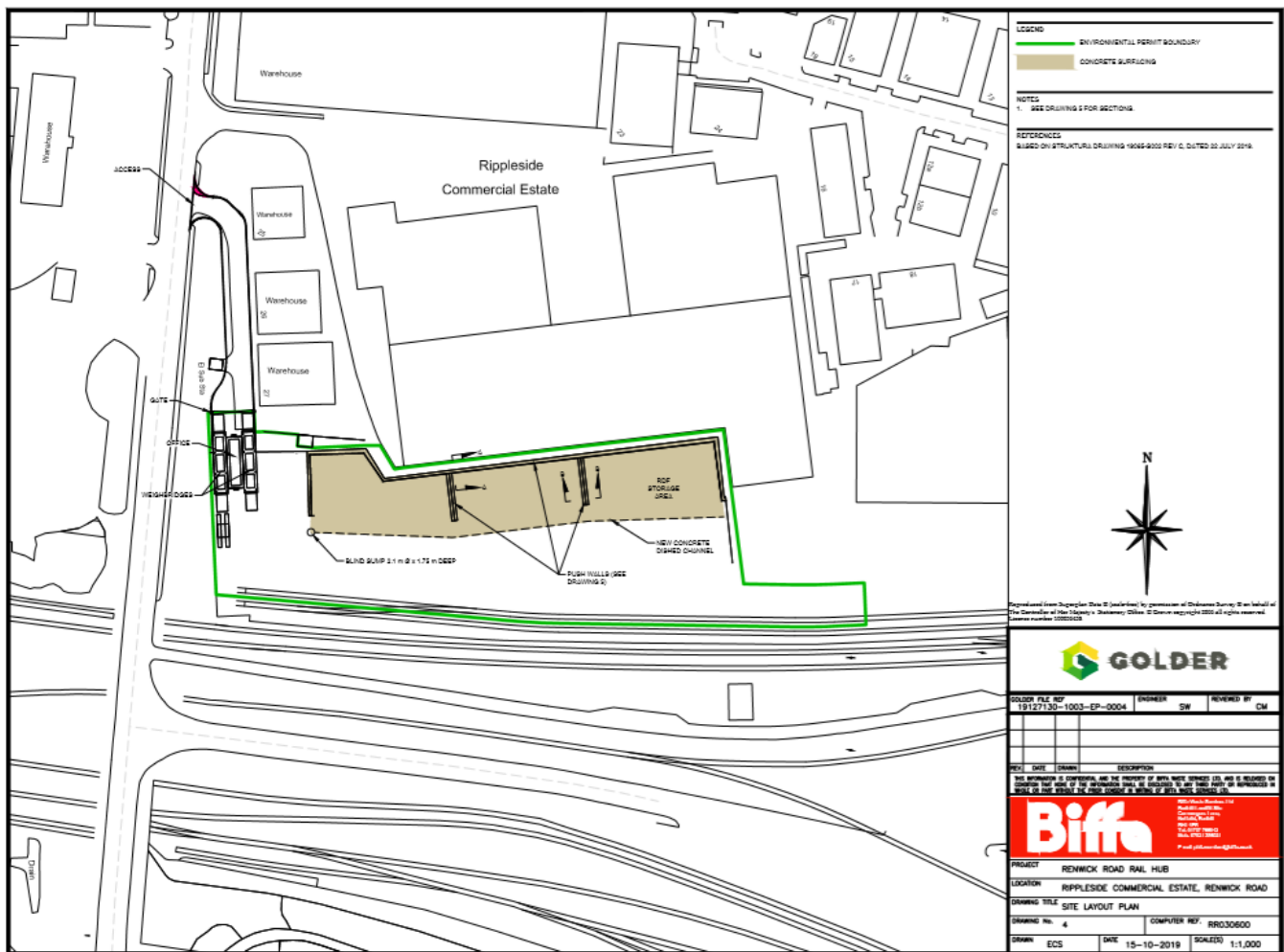

Figure 1: Permit Boundary

The Site will accept and enable the transfer of up to 300,000 tonnes of waste per year of selected non-hazardous wastes. The Site will receive waste materials by road, stockpile, and then load onto rail wagons (for onward distribution) under an Environmental Permit. Wastes will comprise:

- Granular inert and non-hazardous materials delivered to the Site by HGV which will be placed into temporary stockpiles ('bays') prior to loading onto rail wagons for onward haulage for re-use, recovery or disposal at other suitably permitted sites; and
- Baled Refuse Derived Fuel ('RDF') in locked sea containers for temporary storage of those containers prior to loading the sea containers onto rail wagons for onward haulage for recovery or disposal at other suitably permitted sites.

Given the location and environmental setting of the Site, environmental management will be fundamental to the effective management and operation of the Site. The waste transfer activities at Site will be subject to an Environmental Permit which will control the following:

- An annual waste tonnage no greater than 300,000 tonnes per year;
- The maximum amount waste stored at the Site at any one time will not exceed 10,000 tonnes;
- No waste treatment activities including screening or crushing will be carried out at the Site;
- No waste will be burned at the Site;
- Fugitive emissions of dust, particulate matter and odour will be managed and monitored in accordance with a Dust Management Plan and an Odour Management Plan;
- Appropriate measures will be taken to limit and control noise and vibration;
- Appropriate measures will be taken to limit and control pests which may be attracted to the Site; and
- There will be no point source emissions into surface water or groundwater. Surface water will be managed with a closed drainage system and in accordance with the Permit.

The Site will be a 24/7 operation. Incoming road deliveries will tend to be daytime (07:00 to 18:00) and export by train at evening or night-time. The bays will be managed and loading rotated to ensure the minimum residence time for any waste. Bays will be regularly completely emptied.

## Signature Page

### Golder Associates (UK) Ltd



Jeremy Lightfoot  
*Principal*



Chris McDonald  
*Principal*

Date: 20 December 2019

JL/CM/xx

Golder and the G logo are trademarks of Golder Associates Corporation



**[golder.com](http://golder.com)**