

# Hazcare Limited

## Non-Technical Summary

**Application for a Bespoke Environmental Permit for a Waste  
Transfer Station**

**Gibson Lane South, Melton, Hull, East Riding of  
Yorkshire, HU14 3HN**

**Report Ref: CE-GL-1817-RP04-NTS-Final**



**CRESTWOOD ENVIRONMENTAL LTD**

ENVIRONMENT	LANDSCAPE	NOISE	LIGHTING
ECOLOGY	HERITAGE	WATER	TREES
MINERALS / WASTE	AIR QUALITY	LAND QUALITY	VISUALISATION

Science, Technology & Prototyping Centre, University of Wolverhampton Science Park, Glaisher Drive,  
Wolverhampton WV10 9RU. Company Registration no. 06544898

**December 2021**

**Crestwood Report Reference:** CE-GL-1817-RP04-NTS-Final

<b>Version &amp; Status</b>	<b>Date Produced</b>	<b>Written / Updated by:</b>	<b>Checked &amp; Authorised by:</b>
Final	20/12/2021	Louise Parsons BSc (Hons), MSc	Stuart Thompson BSc (Hons), MCIWM, CEnv

This report has been prepared in good faith, with all reasonable skill, care and diligence, based on information provided or known available at the time of its preparation and within the scope of work agreement with the client.

We disclaim any responsibility to the client and others in respect of any matters outside the scope of the above.

The report is provided for the sole use of the named client and is confidential to them and their professional advisors unless otherwise stated in an accompanied 'letter of reliance' with an official Crestwood Environmental Limited letterhead. No responsibility is accepted to others.

Crestwood Environmental Ltd.  
Science, Technology and Prototyping Centre University of Wolverhampton Science Park,  
Glaisher Drive,  
Wolverhampton,  
WV10 9RU  
Tel: 01902 229 563

Email: [info@crestwoodenvironmental.co.uk](mailto:info@crestwoodenvironmental.co.uk)  
Web: [www.crestwoodenvironmental.co.uk](http://www.crestwoodenvironmental.co.uk)

## CONTENTS

1	INTRODUCTION .....	4
2	WASTE ACCEPTANCE .....	4

## DRAWING

CE-GL-1817-DWG01

SITE BOUNDARY AND LAYOUT PLAN

## 1 INTRODUCTION

- 1.1.1 This Non-Technical Summary supports an application for a Bespoke Environmental Permit for Hazcare Ltd (***the Operator***) at Gibson Lane South, Melton, Hull, East Riding of Yorkshire, HU14 3HN (***the Site***). The Site Location and Proposed Environmental Permit Boundary are shown on Drawing No CE-GL-1817-DWG01.
- 1.1.2 It is proposed that the Site will operate as a hazardous and non-hazardous waste transfer facility which will receive and process up to 2600 tonnes of hazardous waste per annum and up to 5000 tonnes of non-hazardous per annum which will amount to no more than 7600 tonnes per annum. All storage and processing is undertaken in an enclosed building comprising of separate dedicated bays.
- 1.1.3 Waste streams will be transported to and from the Site via the Operators own large goods vehicles (LGV`s) before being deposited in the internal receiving bay with fork-lift trucks. Sorting and separation of different wastes will be conducted within the receiving bay and, in order to avoid the mixing of flammable hazardous, non-flammable hazardous and non-hazardous waste types they will be stored, processed and dispatched in separate bays within the building.
- 1.1.4 A bespoke canopy extending from the building will be installed across the entire external yard in order to keep the Site fully contained.
- 1.1.5 Four dedicated, fireproof bays will be constructed in the building for the receipt of wastes. They will comprise concrete block 'legio' walls to three sides and a concrete base and will be used for the receipt of all waste types and the storage of non-hazardous skip waste, non-hazardous flammable waste and flammable hazardous. A 100mm bund will extend across the entrance to each bay which will ensure that at a minimum 110% of the contents of the largest container will be prevented from escape. Additionally, the base of each bay slopes down from the front to the back to facilitate in the containment of any spills of leakages.
- 1.1.6 The Site benefits from an S1 and S2 exemption licences for the storage of packaging, IBC`s, drums and metal material. These will be stored internally and remotely from the other waste bays within the building. It is anticipated that the turnaround of all waste types will not exceed a week.
- 1.1.7 Within a 1km radius of the Site there are no identified Statutory Designated Environmental sites such as Site of Special Scientific Interest (SSSI), Special Protection Areas (SPA), Special Area of Conservation (SAC) or RAMSAR sites. There are also no Local Nature Reserves (LNR) or National Nature Reserves (NNR) within 1km of the Site. At the closest extent, a SSSI, Nelson Bog, is located c.1270m to the south-west of the Site.

## 2 WASTE ACCEPTANCE

- 2.1.1 All waste received at the Site are subjected to documented and recorded acceptance procedures in line with current legislation.
- 2.1.2 All vehicles delivering wastes to the Site stop at the weighbridge to be weighed. Paperwork accompanying the load is checked to make sure that only authorised wastes are accepted. Any unsuitable or non-conforming wastes are rejected from the Site or, if inadvertently deposited, either reloaded onto the delivery vehicle for off-site removal to the waste producer or suitably authorised facility or else placed in a secure quarantine area, prior to off-site removal.

- 2.1.3 All wastes are visually inspected upon deposit as a further measure to ensure that only authorised wastes are accepted at the Site.
- 2.1.4 The Site records are kept of each waste load received and dispatched from the Site. Records are available for inspection by Environmental Agency.
- 2.1.5 A copy of the Environmental Permit and the Fire Prevention and Mitigation Plan are easily accessible by staff members or contractors. Contractors are briefed on the sensitivity of the Site and require a Site induction to maintain the high standards of operation required.
- 2.1.6 The purpose of this application is to ensure that the facility is operating in a compliant manner as well as to improve waste management and control, facilitate improvements in recycling rates and ensure a high standard of environmental protection within Hull, Melton, neighbouring towns and villages and environs.

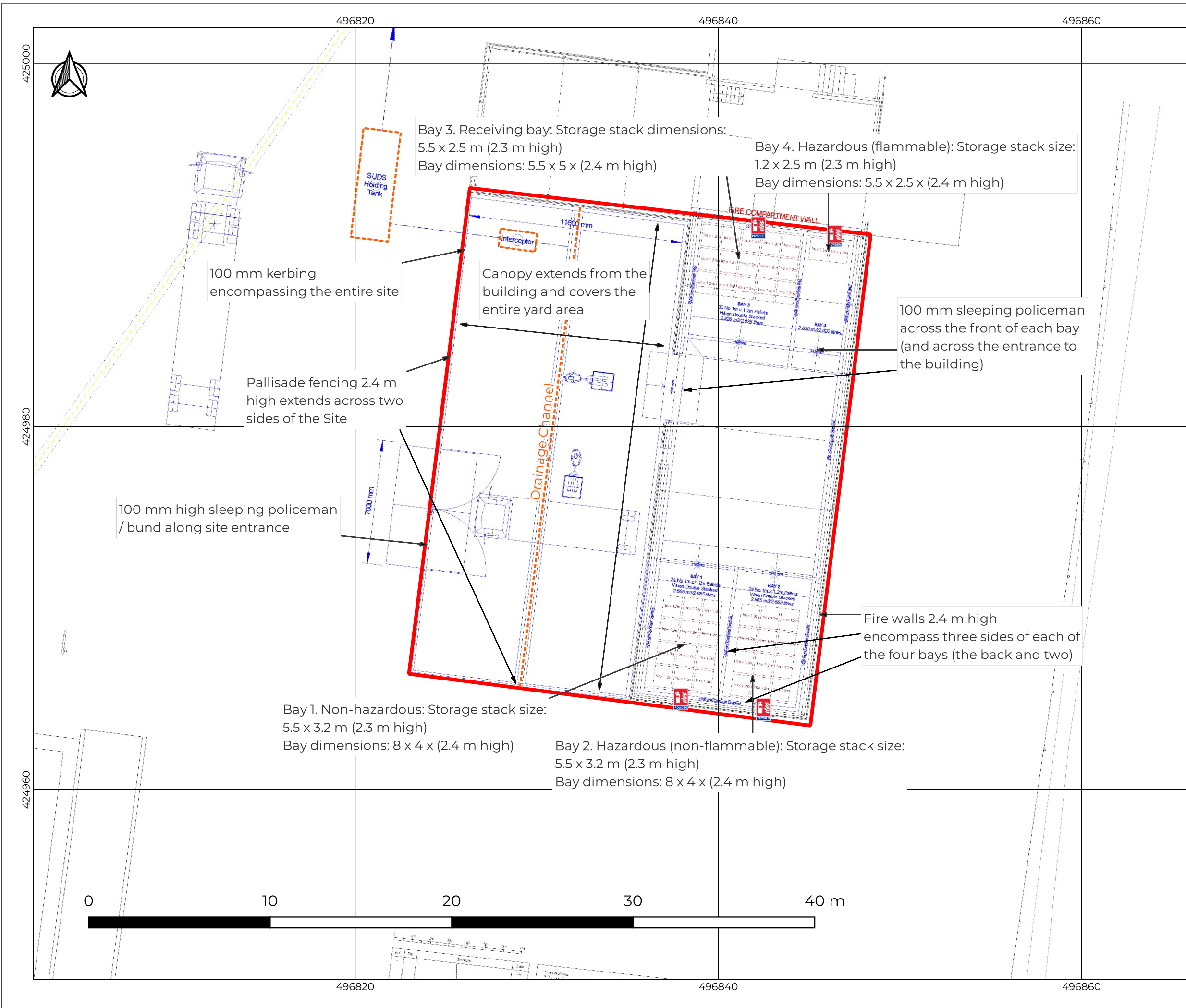

- Legend:**
- Permit Boundary
  - Fire extinguishers
  - Drainage features

**CONFIDENTIAL**

Consultant:  
 Crestwood Environmental Ltd.  
 Units 1 & 2 Nightingale Place  
 Pendeford Business Park  
 Wolverhampton  
 West Midlands  
 WV9 5HF  
 +44 (0)1902 229 563  
[info@crestwoodenvironmental.co.uk](mailto:info@crestwoodenvironmental.co.uk)  
[www.crestwoodenvironmental.co.uk](http://www.crestwoodenvironmental.co.uk)

Client:  
  
 Waste Management Limited

Site: Gibson Lane			
Drawing title: Site boundary and layout plan			
Date: 20 / 12 / 2021	Scale: 1:200	Paper size: A3 (420x297mm)	
Drawn by: AA	Checked by: LP	Status: Final	Final revision: A
Drawing Ref: CE-GL-1817-DWG01		Drawing: DRAWING 1	