

# Non-Technical Summary

## **1 Introduction**

- 1.1 Lydney Skip Hire Ltd is a skip hire company based in Lydney in Harbour Road Industrial Estate.
- 1.2 The company is presently working from a licenced Unit 48 which is approximately 50mtrs from the proposed site at Unit 37 with-in the industrial estate.
- 1.3 Skips are delivered to households and commercial premise through-out the local area.
- 1.4 The waste is hand sorted at the site and separated into different streams to be recycled or landfilled.
- 1.5 Due to the limited space, it has been decided to expand the site to increase recycling construct picking stations, screed and crush construction waste.
- 1.6 Planning permission was granted to develop the new site in July 2020



## **2 New Site Description**

- 2.1 The new site will be surrounded on the main road and separating adjoining premises by a palisade fence and concrete dividers, Large bunded mounds will separate the external site boundary and the wild area in the centre of the site.
- 2.2 Double gates as illustrated in the drawing allow entrance and exit to the site.

- 2.3 The area designated for tipping and sorting the waste will be concreted, the area designated for concrete and rubble will be hard standing with concreted storage bays.
- 2.4 Only permitted vehicles will be allowed to tip
- 2.5 All traffic will be directed to tip at the open shed area.
- 2.6 Lydney Skip hire will not knowingly accept hazardous or waste that is not included in our site licence conditions.
- 2.7 If any waste is found it will either be quarantined and disposed of or returned safely to the producer.
- 2.8 Waste will either be sorted by hand or passed through the picking station into recyclable waste streams.
- 2.9 Inert waste will be moved to the hardstanding area for crushing and screeding and put through a trommel then stored in the appropriate concrete bunkers.
- 2.10 All separated waste will be moved by 360 grab or JCB shovels into storage bays.
- 2.11 The site was inspected, and a Preliminary Environmental Assessment drafted. The management of the site will adhere to the recommendations of the report and have drafted an Environmental Management Plan to ensure the site does not harm the environment.
- 2.12

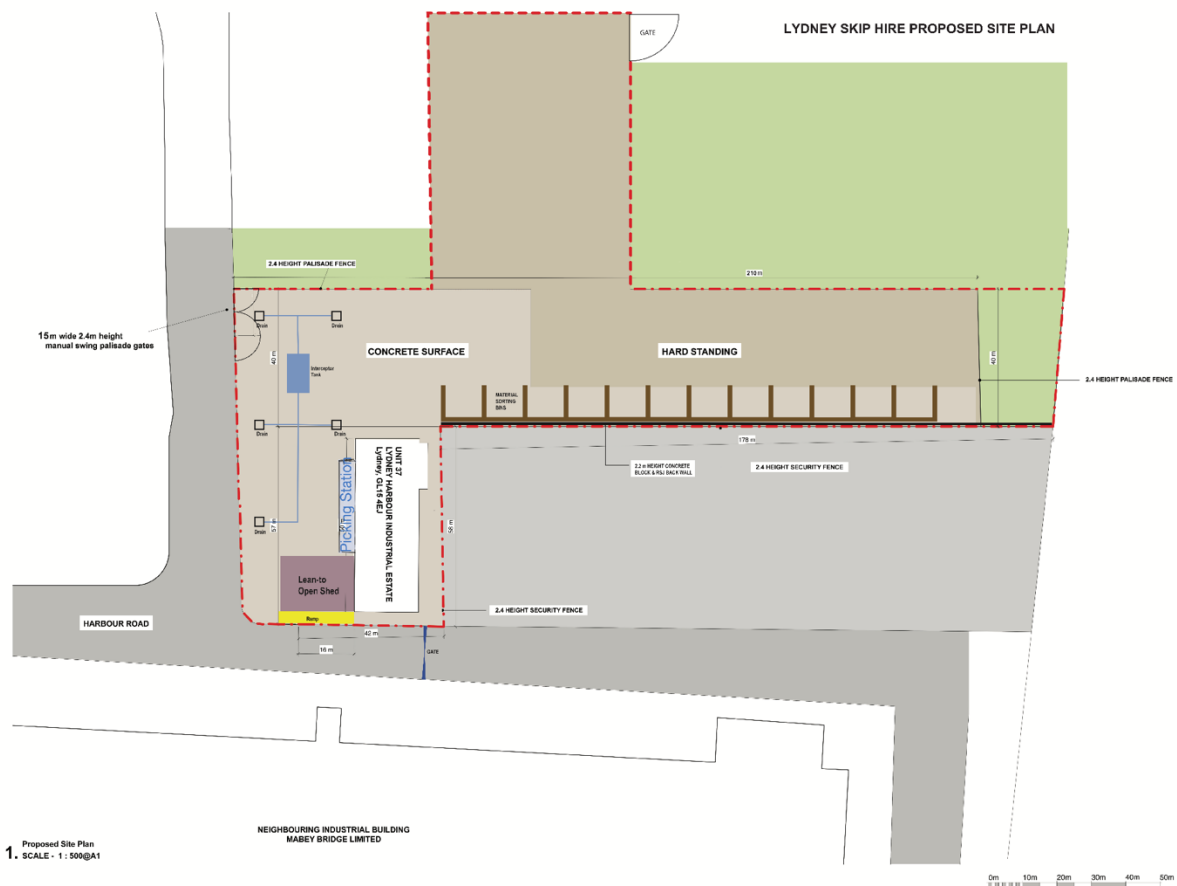

### 3 Operations

- 3.1 The site will be managed in accordance with the site licence and environmental management plan by a competent person.
- 3.2 All vehicles will be maintained, checked, repaired and serviced in accordance with government PUWER and LOLER guidelines.

- 3.3 All working procedures shall be risk assessed and safe systems of work drafted and communicated to the staff.
- 3.4 Only qualified and trained staff will be allowed to handle equipment, plant, machinery and vehicles.