

---

**Water Resources  
LICENCE TO**

**ABSTRACT**

**WATER**

DRAFT

Environment Act 1995  
Water Resources Act 1991 as amended by the  
Water Act 2003  
Water Resources (Abstraction and Impounding)  
Regulations 2006

# IMPORTANT NOTES

## Need for safekeeping

**This licence is an important document.** The permission or right to abstract water may be valuable to your landholding. So -

- **Keep the licence safe, preferably with your deeds etc.**
- **Take careful note of the comments below about “transfer and apportionment” and “death and bankruptcy”.**

**This is to ensure that the permission and any rights granted by the licence continue if you need to pass it on to someone else.**

If you want to:

- [revoke \(cancel\) the licence;](#)
- [notify us of the death or bankruptcy of the licence holder ;](#)
- [vary \(change/amend\) the licence in any way](#)
- **change the owner of the licence or**
- [change your contact address \(but you continue to hold the licence\).](#)

You can find our forms on [.GOV.UK](#) or alternatively contact us for advice on how to make any changes by calling our National Customer Centre on 03708 506 506

## Transfer and apportionment (split)

If you need to pass this licence or any part of it to someone else, you must contact the Environment Agency and obtain the appropriate application forms. Temporary licences cannot be transferred or apportioned. The licence holder remains responsible for compliance with the terms of the licence and any charges payable until the licence has been transferred or apportioned.

## Death or bankruptcy of the licence holder

‘**Vesting**’ is the transfer of responsibility and ownership of a licence when an existing licence holder is no longer able to hold the licence either through death or bankruptcy.

If a licence has been ‘**vested**’ in you, as a result of the death or bankruptcy of the licence holder, please contact the Environment Agency in writing, telling us the licence number(s) and the date that the licence vested in you as a personal representative or trustee of the licence holder. This is necessary in order to enable you to subsequently transfer the licence.

You must notify us in writing within **15 months** of the date of vesting, being either death or bankruptcy of the licence holder giving the full names of all personal representatives or trustees and a contact address.

## Time limits

Your licence may be subject to a time limit (where appropriate this will be shown on the front of your licence). All new abstraction licences are legally required to include a time limit. For variations to licences, time limits are added in accordance with our policy.

The duration of a time limit is determined in accordance with our time limiting policy. The time limit is linked to the next or subsequent review of water resources within the relevant [Abstraction Licensing Strategy](#) (ALS)

At the end of the time limit, we should be able to renew the licence if:

- there is no damage to the environment;
- the need for the abstraction can still be justified;
- water is being used efficiently; and
- you still meet the legal requirements for getting a licence.

If your licence is time limited and you wish to renew it when it expires, you will need to apply for a new licence to replace the existing one. You are advised to submit this application at least six months before it expires. To allow you to give early consideration to this, we will send you a reminder approximately 18 months before the expiry date.

If your licence cannot be renewed, we will endeavour to give at least six years notice. We will also endeavour to give at least six years notice where the licence is likely to be renewed on different terms and will significantly impact upon the use of the licence.

In exceptional circumstances, for example where there are other overriding statutory duties such as the Habitats Regulations, it may not be possible to provide six years notice.

## Charges

Unless specifically exempted, we will levy an annual charge for water authorised to be abstracted by this licence, in accordance with our abstraction charges scheme in force at the time. To work out your charges, please refer to our [Scheme of Abstraction Charges](#) available on GOV.UK.

## Quantity and quality of water

You must not abstract more than the quantity specified in the licence. The Environment Agency does not, by issue of this licence or otherwise, in any way guarantee that the source of supply will produce the quantity of water authorised to be abstracted by this licence, nor that the water is fit for its intended use.

The quantity of water authorised for abstraction is given in cubic metres. One cubic metre is approximately 220 gallons. (The precise conversion is 1 cubic metres = 219.969 gallons).

## Source of supply and authorised point of abstraction

You may abstract from the point(s) specified in the licence and from no other points. If you want to add or change the authorised point(s) of abstraction, you must apply to us to vary the licence.

## Purpose for which water is authorised to be used

You may only use the water for the purpose(s) specified in the licence. You must apply to us to vary the licence if you wish to add to or change the purpose(s).

## Offences

Under the Water Resources Act 1991 it is an offence:-

- to abstract water, or cause or permit any other person to abstract water, unless the abstraction is authorised by and in accordance with an abstraction licence, or is subject to an exemption;
- to do anything to enable abstraction, or to increase abstraction, except in accordance with an abstraction licence or exemption;
- to fail to comply with the conditions of an abstraction licence.

**Note in particular that it may be a condition of the licence to maintain the meter or other measuring device etc. and failure to do so will be an offence;**

- to interfere with a meter or other device which measures quantities of water abstracted so as to prevent it from measuring correctly;
- to fail to provide information which we have reasonably required for the purpose of carrying out any of the Environment Agency’s water resources functions;
- to knowingly make false statements for the purpose of obtaining a licence or consent or in giving required information.

The requirement for a licence is subject to some exemptions, set out in the Water Resources Act 1991 as amended. If in any doubt as to whether you need a licence, contact us at the address shown at the bottom of the front page of the licence.

## Right of appeal

If you are dissatisfied with our decision on your licence application, you have the right to appeal against our decision.

You should write to the Secretary of State for the Environment, Food and Rural Affairs, care of The Planning Inspectorate at:  
The Environment Team  
3A Eagle Wing,  
Temple Quay House,  
2 The Square,  
Temple Quay,  
Bristol,  
BS1 6PN

Alternatively you can obtain an on-line appeal form at:

<https://www.gov.uk/government/publications/water-abstraction-and-impoundment-appeal-form>

You must serve notice of appeal within 28 days of the date of receipt of this licence (although the Secretary of State has power to allow a longer period for serving notice of appeal). See [Water Resources Act 1991, section 43](#).

## Disclosure of information

Details of this licence are placed on a register, kept by the Environment Agency and open for inspection by the public. The public may also obtain further details about it by virtue of the Environmental Information Regulations 2004 (see also Disclosure of Information) except in special cases (for advice please contact us at the address shown on the front page of the licence).

Members of the public are also entitled to ask us for other “environmental information” it holds, including any activities likely to affect “the state of any water” or any “activities or other measures designed to protect it”. That would include the information additional to the licence document e.g. any related agreement or abstraction returns. In certain restricted circumstances it is possible to claim that information should be kept confidential. If you require more information about keeping this information off the public register because it is confidential, please contact us by writing to the address shown on the front page of the licence within 28 days of receiving this licence.

Licence Serial No:	SW/043/0021/030
--------------------	-----------------

Please quote the serial number in all correspondence about this licence



## FULL LICENCE TO ABSTRACT WATER

The Secretary of State for the Environment, Food and Rural Affairs is hereby deemed to grant a licence to:-

Environment Agency (“the Licence Holder”)  
 Horizon House  
 Deanery Road  
 Bristol  
 BS1 5AH

This licence authorises the Licence Holder to abstract water from the source of supply described in the Schedule of Conditions to this licence and subject to the provisions of that Schedule. The licence commences from the effective date shown below and shall remain in force until the date of expiry shown below.

**Signed** ..... **Date of issue** ..... <day/month/year>  
**Date effective** ..... <day/month/year>  
 Deputy Director Water Management & Investment **Date of expiry** ..... 31 March 2037

Environment Agency  
 Horizon House  
 Deanery Road  
 Bristol  
 BS1 5AH

The licence should be kept safe and its existence disclosed on any sale of the property to which it relates. Please read the ‘important notes’ on the cover to this licence.

Note: References to "the map" are to the map which forms part of this licence.  
 References to "the Agency" are to the Environment Agency or any successor body.

## SCHEDULE OF CONDITIONS

<b>1.</b>	<b>SOURCE OF SUPPLY</b>
1.1	Inland water known as the River Avon at Blackwell Hatches near Ashley Road, Salisbury, Wiltshire.
<b>2.</b>	<b>POINT OF ABSTRACTION</b>
2.1	At National Grid Reference SU 13855 30897 marked 'A' on the map.
<b>3.</b>	<b>MEAN OF ABSTRACTION</b>
3.1	Two gravity feed pipes of an internal diameter not exceeding 750 mm controlled by penstocks at an instantaneous flow not exceeding 398 litres per second.
<b>4.</b>	<b>PURPOSE OF ABSTRACTION</b>
4.1	Transfer for the purpose of stream and wetland support.
<b>5.</b>	<b>PERIOD OF ABSTRACTION</b>
5.1	All year.
<b>6.</b>	<b>FURTHER CONDITIONS</b>
6.1	<p>The Licence Holder shall construct, operate and maintain the intake works specified in condition 3.1 in accordance with the specifications and drawings:</p> <p style="padding-left: 40px;">Salisbury River Park Phase 1 – Ashely Road Blackwell Hatch Pipe Culvert Plan and Sections – ENVIMSW002033-ATK-00-3AR-DR-C-000007 – Revision C01 dated 19/07/2022, and</p> <p style="padding-left: 40px;">Salisbury River Park Phase 1 – Ashely Road Blackwell Hatch Retaining Wall Plan and Sections – ENVIMSW002033-ATK-00-3AR-DR-C-000008 – Revision C01 dated 19/07/2022</p> <p>copies of which are appended to this licence, or such minor amendments to those documents that are accepted in writing by the Agency prior to the date of commencement of construction.</p>
6.2	The Licence Holder shall return the water abstracted in pursuance of this licence to the Summerlock Stream at the National Grid Reference: SU 13855 30885 marked 'Q' on the map.
6.3	The Licence Holder shall maintain the intake works specified in condition 3.1 to be free from obstruction at all times and remain effective at all times.
6.4	The Licence Holder shall ensure that during construction and any subsequent maintenance of the works authorised by this licence that the flow in the Summerlock Stream is allowed to pass downstream unchanged in quantity and quality at all times.
6.5	This licence shall cease to be of any effect if the abstraction it authorises has not commenced by <<three years from issue date>>.

## ADDITIONAL INFORMATION

Note: the following is provided for information only. It does not form part of the licence.

### REASONS FOR CONDITIONS

The licence is time-limited to a date to reflect the timing of a future review of the catchment resources availability.

The licence includes a 'self-destruct' condition in order to secure the proper use of water resources and to avoid commitment of water resources to an abstraction right which cannot be exercised.

### IMPORTANT NOTES

**Condition 6.1:** For the purpose of condition 6.1, the Licence Holder shall send any revised drawings to the Wessex IEP Team at [AEPWESSEX@environment-agency.gov.uk](mailto:AEPWESSEX@environment-agency.gov.uk) or any alternative address as may be notified from time to time.

**Operation:** The transfer of water authorised by this licence will be carried out as described in the Operation and Maintenance Manual, as may be amended from time to time.

### Abstraction Reform

We have granted this licence in line with current legal requirements and policies on managing water resources. However, Government have consulted on reforms which may affect the duration, quantities and management of licences before your current licence expires (ends), where appropriate. You should take account of this when making business decisions. If you would like to find out more, please search for 'abstraction reform' on [gov.uk](http://gov.uk).

### Water efficiency note

The Licence Holder should use water abstracted under the terms of this licence in an efficient manner. The Agency may refer to its guidance on water efficiency (or equivalent guidance) in determining whether water is being used efficiently and may offer advice on any measures considered necessary to meet particular recommendations.

### Licence History

Licence serial number	Issue date	Expiry date	Summary of changes
SW/043/0021/030	XX/XX/XXXX	31/03/2037	Original issue of licence. Application No: NPS/WR/037978.

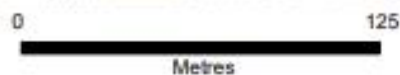
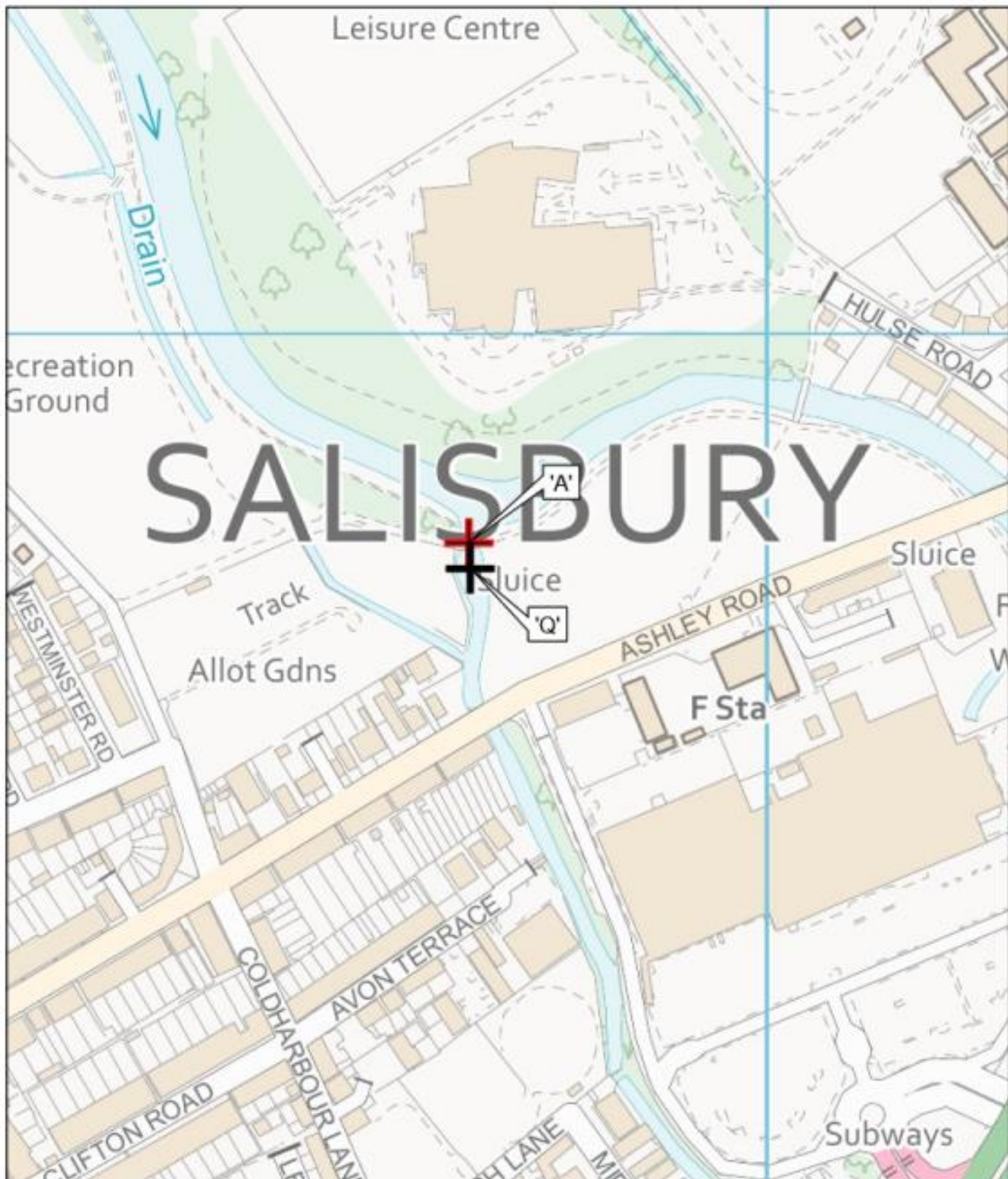

**MAP ACCOMPANYING LICENCE NUMBER  
SW/043/0021/030**

Scale 1:2,500



© Crown Copyright and database rights 2024 Ordnance Survey 100024198.

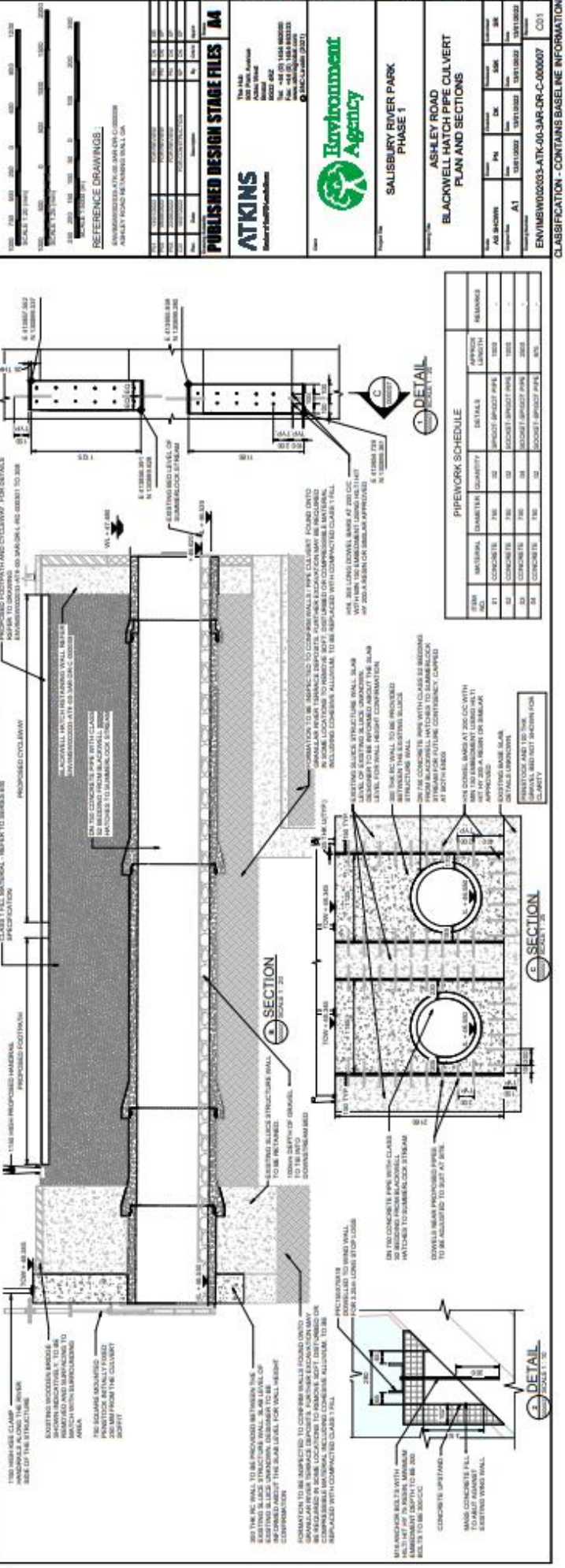
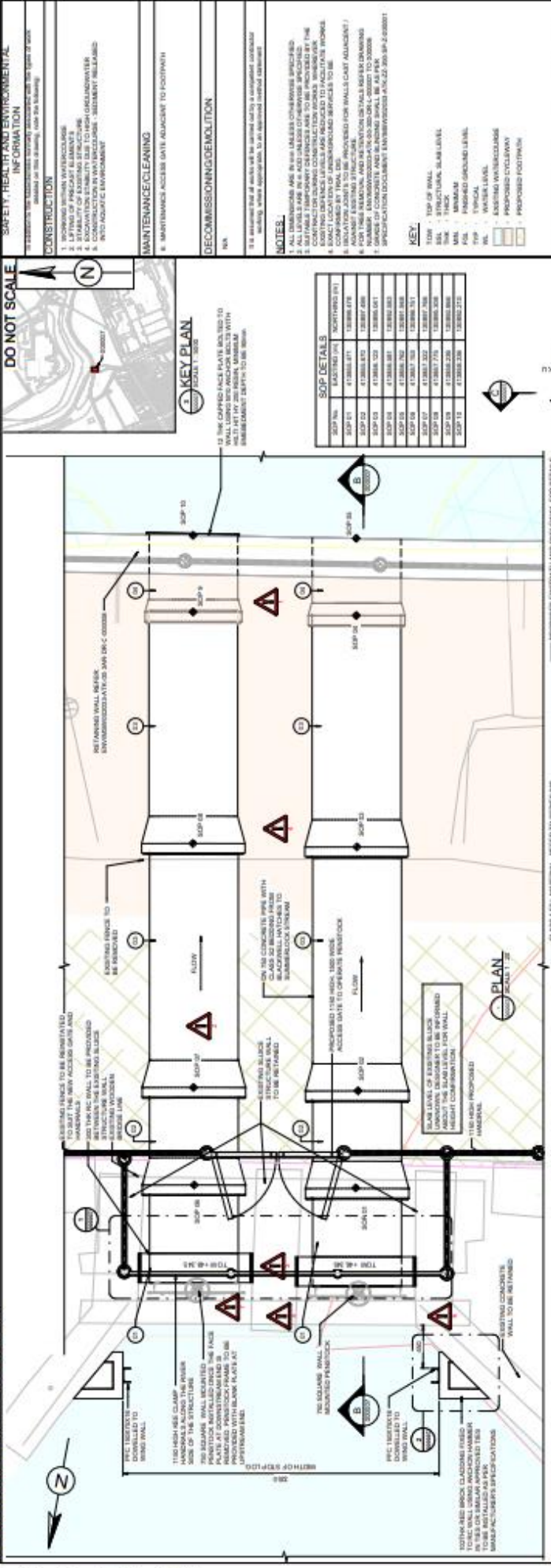

**SAFETY HEALTH AND ENVIRONMENTAL INFORMATION**

1. WORKING WITHIN INFRASTRUCTURE

2. EXCAVATION STABILITY DUE TO HIGH UNDERWATER

3. ENVIRONMENTAL DAMAGE - SETTLEMENT RISK

4. INTO AQUEATIC ENVIRONMENT

**CONSTRUCTION**

1. MAINTENANCE ACCESS GATE ADJACENT TO FOOTWALL

**DECOMMISSIONING/DEMOLITION**

1. ALL DIMENSIONS ARE IN UNLESS OTHERWISE SPECIFIED

2. ALL LEVELS ARE IN UNLESS OTHERWISE SPECIFIED

3. CONTRACTORS DURING CONSTRUCTION WORKS, WHENEVER THE EXISTING STRUCTURE IS TO BE MAINTAINED OR RECONSTRUCTED, THE EXISTING STRUCTURE SHALL BE PROTECTED AND SUPPORTED AS REQUIRED.

4. CONTRACT LOCATIONS OF ALL STRUCTURES SHALL BE TO THE ADJACENT SIDE OF THE ROAD.

5. ADVANTAGE STRUCTURAL

6. ADVANTAGE STRUCTURAL

7. ADVANTAGE STRUCTURAL

8. ADVANTAGE STRUCTURAL

9. ADVANTAGE STRUCTURAL

10. ADVANTAGE STRUCTURAL

11. ADVANTAGE STRUCTURAL

12. ADVANTAGE STRUCTURAL

13. ADVANTAGE STRUCTURAL

14. ADVANTAGE STRUCTURAL

**KEY:**

1. TOP OF WALL

2. STRUCTURAL SLAB LEVEL

3. EXISTING FLOOR LEVEL

4. FINISH FLOOR LEVEL

5. PROPOSED FINISH FLOOR LEVEL

6. PROPOSED FLOOR LEVEL

7. PROPOSED FLOOR LEVEL

8. PROPOSED FLOOR LEVEL

9. PROPOSED FLOOR LEVEL

10. PROPOSED FLOOR LEVEL

11. PROPOSED FLOOR LEVEL

12. PROPOSED FLOOR LEVEL

13. PROPOSED FLOOR LEVEL

14. PROPOSED FLOOR LEVEL

**REFERENCE DRAWINGS:**

ENVIRONMENTAL HEALTH AND SAFETY REPORT

ENVIRONMENTAL IMPACT STATEMENT

ENVIRONMENTAL MONITORING

ENVIRONMENTAL RISK ASSESSMENT

ENVIRONMENTAL SURVEILLANCE

ENVIRONMENTAL IMPROVEMENT

ENVIRONMENTAL PROTECTION

ENVIRONMENTAL RESTORATION

ENVIRONMENTAL SUSTAINABILITY

ENVIRONMENTAL WELLBEING

ENVIRONMENTAL RESILIENCE

ENVIRONMENTAL ADAPTABILITY

ENVIRONMENTAL FLEXIBILITY

ENVIRONMENTAL INCLUSIVITY

ENVIRONMENTAL EQUITY

ENVIRONMENTAL JUSTICE

ENVIRONMENTAL TRANSFORMATIVE CHANGE

ENVIRONMENTAL SYSTEMS THINKING

ENVIRONMENTAL INTEGRATION

ENVIRONMENTAL COOPERATION

ENVIRONMENTAL PARTNERSHIPS

ENVIRONMENTAL LEADERSHIP

ENVIRONMENTAL INNOVATION

ENVIRONMENTAL REVISION

ENVIRONMENTAL IMPROVEMENT

ENVIRONMENTAL PROTECTION

ENVIRONMENTAL RESTORATION

ENVIRONMENTAL SUSTAINABILITY

ENVIRONMENTAL WELLBEING

ENVIRONMENTAL RESILIENCE

ENVIRONMENTAL ADAPTABILITY

ENVIRONMENTAL FLEXIBILITY

ENVIRONMENTAL INCLUSIVITY

ENVIRONMENTAL EQUITY

ENVIRONMENTAL JUSTICE

ENVIRONMENTAL TRANSFORMATIVE CHANGE

ENVIRONMENTAL SYSTEMS THINKING

ENVIRONMENTAL INTEGRATION

ENVIRONMENTAL COOPERATION

ENVIRONMENTAL PARTNERSHIPS

ENVIRONMENTAL LEADERSHIP

ENVIRONMENTAL INNOVATION

ENVIRONMENTAL REVISION

CLASSIFICATION - CONTAINS BASELINE INFORMATION

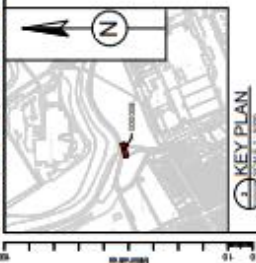

SOP #	DATE	DESCRIPTION
001	13/08/2023	ISSUED FOR PERMIT
002	13/08/2023	ISSUED FOR PERMIT
003	13/08/2023	ISSUED FOR PERMIT
004	13/08/2023	ISSUED FOR PERMIT
005	13/08/2023	ISSUED FOR PERMIT
006	13/08/2023	ISSUED FOR PERMIT
007	13/08/2023	ISSUED FOR PERMIT
008	13/08/2023	ISSUED FOR PERMIT
009	13/08/2023	ISSUED FOR PERMIT
010	13/08/2023	ISSUED FOR PERMIT
011	13/08/2023	ISSUED FOR PERMIT
012	13/08/2023	ISSUED FOR PERMIT
013	13/08/2023	ISSUED FOR PERMIT
014	13/08/2023	ISSUED FOR PERMIT
015	13/08/2023	ISSUED FOR PERMIT
016	13/08/2023	ISSUED FOR PERMIT
017	13/08/2023	ISSUED FOR PERMIT
018	13/08/2023	ISSUED FOR PERMIT
019	13/08/2023	ISSUED FOR PERMIT
020	13/08/2023	ISSUED FOR PERMIT

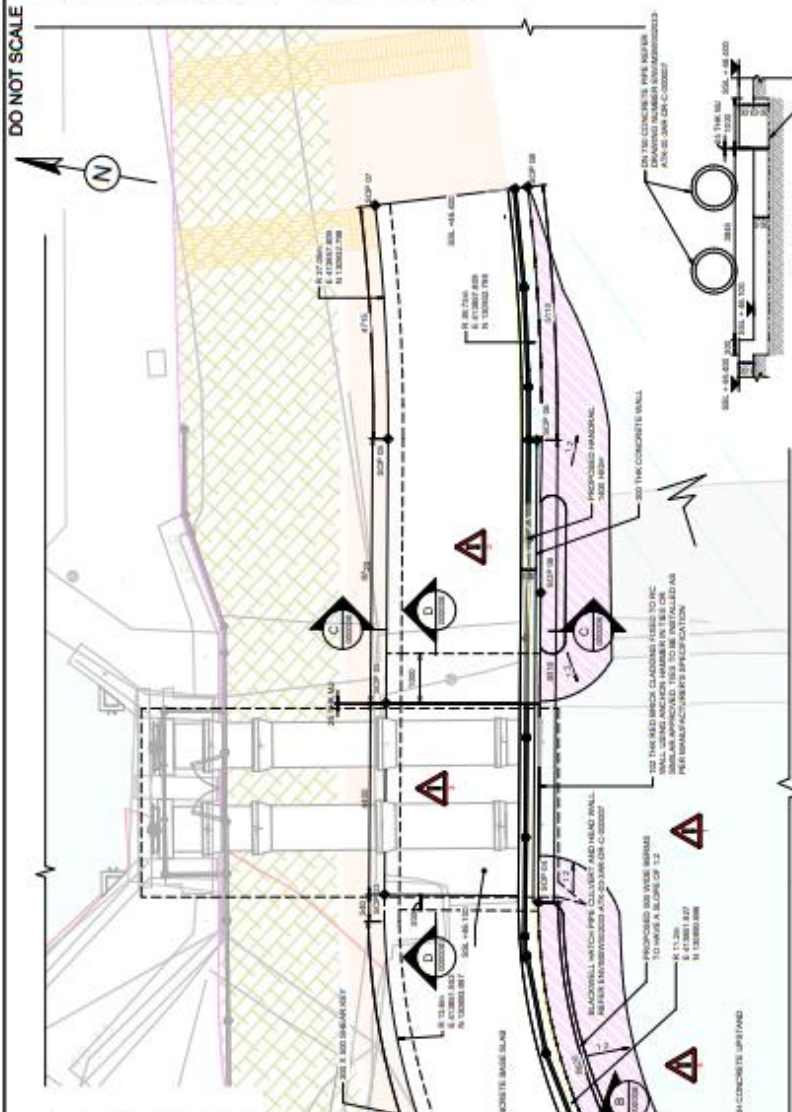

**SAFETY, HEALTH AND ENVIRONMENTAL INFORMATION**

THE PRESENCE OF THE RETAINING WALLS IS SUBJECT TO THE TYPE OF WORK undertaken at this site being, take the following:

- 1. WORKING WITHIN BATTER LIMITS
- 2. EXCAVATION BY AGENCY DUE TO HIGH GROUNDWATER
- 3. EXCAVATION BY AGENCY DUE TO HIGH GROUNDWATER
- 4. EXCAVATION BY AGENCY DUE TO HIGH GROUNDWATER
- 5. CONSTRUCTION OF NEW CHANNEL - INSTANT RELEASE INTO AQUATIC ENVIRONMENT
- 6. MAINTENANCE/CLEANING
- 7. NO ADDITIONAL VARIANCES
- 8. DECOMMISSIONING/DEMOLITION
- 9. NO ADDITIONAL VARIANCES

**NOTES:**

1. ALL DIMENSIONS ARE IN MILLIMETERS UNLESS OTHERWISE SPECIFIED
2. ALL LEVELS ARE IN AUSTRALIAN DATUM UNLESS SPECIFIED
3. CONTRACTOR SHALL VERIFY ALL DIMENSIONS AND LEVELS BEFORE COMMENCING CONSTRUCTION WORKS
4. CONTRACTOR SHALL VERIFY ALL DIMENSIONS AND LEVELS BEFORE COMMENCING CONSTRUCTION WORKS
5. CONTRACTOR SHALL VERIFY ALL DIMENSIONS AND LEVELS BEFORE COMMENCING CONSTRUCTION WORKS
6. EXACT LOCATION OF GROUNDWATER BATTER TO BE COMPARSED BY TRAIL
7. CONTRACTOR SHALL VERIFY ALL DIMENSIONS AND LEVELS BEFORE COMMENCING CONSTRUCTION WORKS
8. CONTRACTOR SHALL VERIFY ALL DIMENSIONS AND LEVELS BEFORE COMMENCING CONSTRUCTION WORKS
9. CONTRACTOR SHALL VERIFY ALL DIMENSIONS AND LEVELS BEFORE COMMENCING CONSTRUCTION WORKS
10. CONTRACTOR SHALL VERIFY ALL DIMENSIONS AND LEVELS BEFORE COMMENCING CONSTRUCTION WORKS
11. CONTRACTOR SHALL VERIFY ALL DIMENSIONS AND LEVELS BEFORE COMMENCING CONSTRUCTION WORKS
12. CONTRACTOR SHALL VERIFY ALL DIMENSIONS AND LEVELS BEFORE COMMENCING CONSTRUCTION WORKS
13. CONTRACTOR SHALL VERIFY ALL DIMENSIONS AND LEVELS BEFORE COMMENCING CONSTRUCTION WORKS
14. CONTRACTOR SHALL VERIFY ALL DIMENSIONS AND LEVELS BEFORE COMMENCING CONSTRUCTION WORKS
15. CONTRACTOR SHALL VERIFY ALL DIMENSIONS AND LEVELS BEFORE COMMENCING CONSTRUCTION WORKS
16. CONTRACTOR SHALL VERIFY ALL DIMENSIONS AND LEVELS BEFORE COMMENCING CONSTRUCTION WORKS
17. CONTRACTOR SHALL VERIFY ALL DIMENSIONS AND LEVELS BEFORE COMMENCING CONSTRUCTION WORKS
18. CONTRACTOR SHALL VERIFY ALL DIMENSIONS AND LEVELS BEFORE COMMENCING CONSTRUCTION WORKS
19. CONTRACTOR SHALL VERIFY ALL DIMENSIONS AND LEVELS BEFORE COMMENCING CONSTRUCTION WORKS
20. CONTRACTOR SHALL VERIFY ALL DIMENSIONS AND LEVELS BEFORE COMMENCING CONSTRUCTION WORKS

**KEY:**

- 1. STRUCTURAL SLAB LEVEL
- 2. TOP OF SOIL
- 3. TOP OF WALL
- 4. FINISHED GROUND LEVEL
- 5. EXISTING GROUND LEVEL
- 6. PROPOSED CYCLINGWAY
- 7. PROPOSED FOOTPATH
- 8. EXISTING FOOTPATH
- 9. EXISTING FOOTPATH
- 10. EXISTING FOOTPATH
- 11. EXISTING FOOTPATH
- 12. EXISTING FOOTPATH
- 13. EXISTING FOOTPATH
- 14. EXISTING FOOTPATH
- 15. EXISTING FOOTPATH
- 16. EXISTING FOOTPATH
- 17. EXISTING FOOTPATH
- 18. EXISTING FOOTPATH
- 19. EXISTING FOOTPATH
- 20. EXISTING FOOTPATH

**REFERENCE DRAWINGS:**

- ENVIRONMENTAL ATKINS C-00007
- BLACKWELL HATCH PPE CLEARLY AND HEAD WALL

**SCALE:** 1:100

**ATKINS**

Published Design Stage Files A4

The Atkin Group  
1000 Park Avenue  
Sydney NSW 1588  
Australia  
Tel: +61 (0) 2 9439 5000  
Fax: +61 (0) 2 9439 5000  
www.atkins.com  
© Atkins Limited 2021

**Environment Agency**

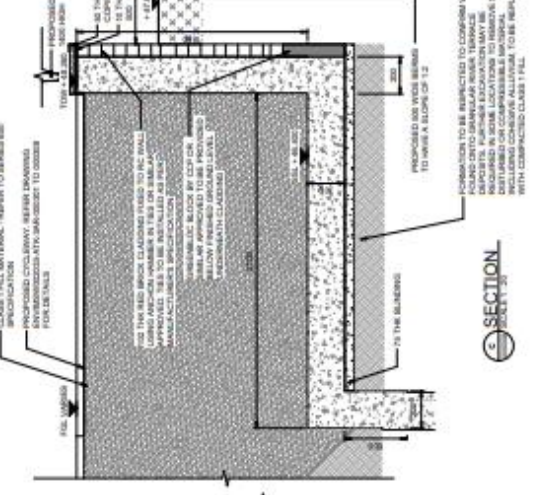
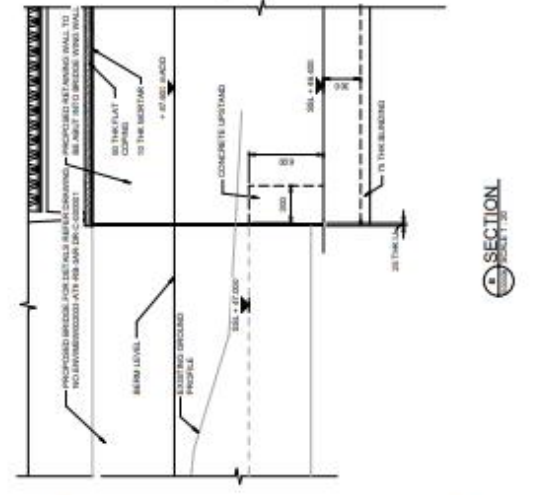
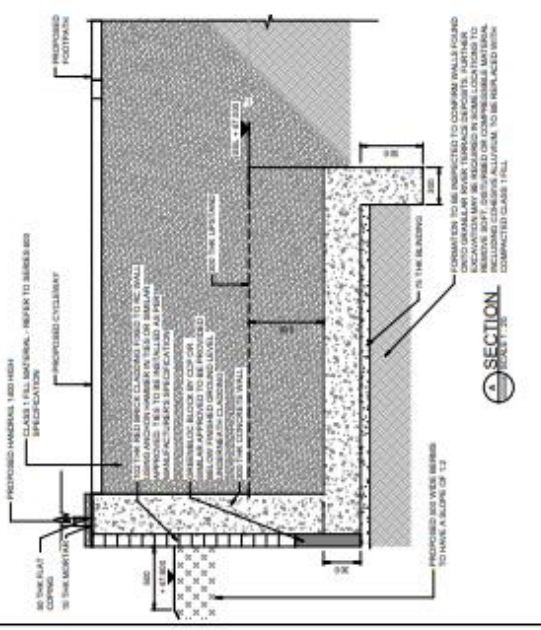

**ENVIRONMENTAL INFORMATION**

THE PRESENCE OF THE RETAINING WALLS IS SUBJECT TO THE TYPE OF WORK undertaken at this site being, take the following:

- 1. WORKING WITHIN BATTER LIMITS
- 2. EXCAVATION BY AGENCY DUE TO HIGH GROUNDWATER
- 3. EXCAVATION BY AGENCY DUE TO HIGH GROUNDWATER
- 4. EXCAVATION BY AGENCY DUE TO HIGH GROUNDWATER
- 5. CONSTRUCTION OF NEW CHANNEL - INSTANT RELEASE INTO AQUATIC ENVIRONMENT
- 6. MAINTENANCE/CLEANING
- 7. NO ADDITIONAL VARIANCES
- 8. DECOMMISSIONING/DEMOLITION
- 9. NO ADDITIONAL VARIANCES

**NOTES:**

1. ALL DIMENSIONS ARE IN MILLIMETERS UNLESS OTHERWISE SPECIFIED
2. ALL LEVELS ARE IN AUSTRALIAN DATUM UNLESS SPECIFIED
3. CONTRACTOR SHALL VERIFY ALL DIMENSIONS AND LEVELS BEFORE COMMENCING CONSTRUCTION WORKS
4. CONTRACTOR SHALL VERIFY ALL DIMENSIONS AND LEVELS BEFORE COMMENCING CONSTRUCTION WORKS
5. CONTRACTOR SHALL VERIFY ALL DIMENSIONS AND LEVELS BEFORE COMMENCING CONSTRUCTION WORKS
6. EXACT LOCATION OF GROUNDWATER BATTER TO BE COMPARSED BY TRAIL
7. CONTRACTOR SHALL VERIFY ALL DIMENSIONS AND LEVELS BEFORE COMMENCING CONSTRUCTION WORKS
8. CONTRACTOR SHALL VERIFY ALL DIMENSIONS AND LEVELS BEFORE COMMENCING CONSTRUCTION WORKS
9. CONTRACTOR SHALL VERIFY ALL DIMENSIONS AND LEVELS BEFORE COMMENCING CONSTRUCTION WORKS
10. CONTRACTOR SHALL VERIFY ALL DIMENSIONS AND LEVELS BEFORE COMMENCING CONSTRUCTION WORKS
11. CONTRACTOR SHALL VERIFY ALL DIMENSIONS AND LEVELS BEFORE COMMENCING CONSTRUCTION WORKS
12. CONTRACTOR SHALL VERIFY ALL DIMENSIONS AND LEVELS BEFORE COMMENCING CONSTRUCTION WORKS
13. CONTRACTOR SHALL VERIFY ALL DIMENSIONS AND LEVELS BEFORE COMMENCING CONSTRUCTION WORKS
14. CONTRACTOR SHALL VERIFY ALL DIMENSIONS AND LEVELS BEFORE COMMENCING CONSTRUCTION WORKS
15. CONTRACTOR SHALL VERIFY ALL DIMENSIONS AND LEVELS BEFORE COMMENCING CONSTRUCTION WORKS
16. CONTRACTOR SHALL VERIFY ALL DIMENSIONS AND LEVELS BEFORE COMMENCING CONSTRUCTION WORKS
17. CONTRACTOR SHALL VERIFY ALL DIMENSIONS AND LEVELS BEFORE COMMENCING CONSTRUCTION WORKS
18. CONTRACTOR SHALL VERIFY ALL DIMENSIONS AND LEVELS BEFORE COMMENCING CONSTRUCTION WORKS
19. CONTRACTOR SHALL VERIFY ALL DIMENSIONS AND LEVELS BEFORE COMMENCING CONSTRUCTION WORKS
20. CONTRACTOR SHALL VERIFY ALL DIMENSIONS AND LEVELS BEFORE COMMENCING CONSTRUCTION WORKS

**KEY:**

- 1. STRUCTURAL SLAB LEVEL
- 2. TOP OF SOIL
- 3. TOP OF WALL
- 4. FINISHED GROUND LEVEL
- 5. EXISTING GROUND LEVEL
- 6. PROPOSED CYCLINGWAY
- 7. PROPOSED FOOTPATH
- 8. EXISTING FOOTPATH
- 9. EXISTING FOOTPATH
- 10. EXISTING FOOTPATH
- 11. EXISTING FOOTPATH
- 12. EXISTING FOOTPATH
- 13. EXISTING FOOTPATH
- 14. EXISTING FOOTPATH
- 15. EXISTING FOOTPATH
- 16. EXISTING FOOTPATH
- 17. EXISTING FOOTPATH
- 18. EXISTING FOOTPATH
- 19. EXISTING FOOTPATH
- 20. EXISTING FOOTPATH

**REFERENCE DRAWINGS:**

- ENVIRONMENTAL ATKINS C-00007
- BLACKWELL HATCH PPE CLEARLY AND HEAD WALL

**SCALE:** 1:100

**ATKINS**

Published Design Stage Files A4

The Atkin Group  
1000 Park Avenue  
Sydney NSW 1588  
Australia  
Tel: +61 (0) 2 9439 5000  
Fax: +61 (0) 2 9439 5000  
www.atkins.com  
© Atkins Limited 2021

**Environment Agency**



**Would you like to find out more about us, or about your environment?**

**Then call us on**

**03708 506 506** (Mon-Fri 8-6)

**email**

**[enquiries@environment-agency.gov.uk](mailto:enquiries@environment-agency.gov.uk)**

**or visit our website**

**[www.gov.uk/environment-agency](http://www.gov.uk/environment-agency)**

**Incident hotline 0800 80 70 60** (24hrs)

**Floodline 0345 988 1188**



Environment first: This publication is printed on paper made from 100 per cent previously used waste. By-products from making the pulp and paper are used for composting and fertiliser, for making cement and for generating energy.