

KEY

— INSTALLATION BOUNDARY

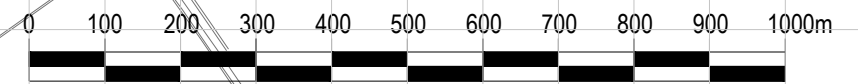
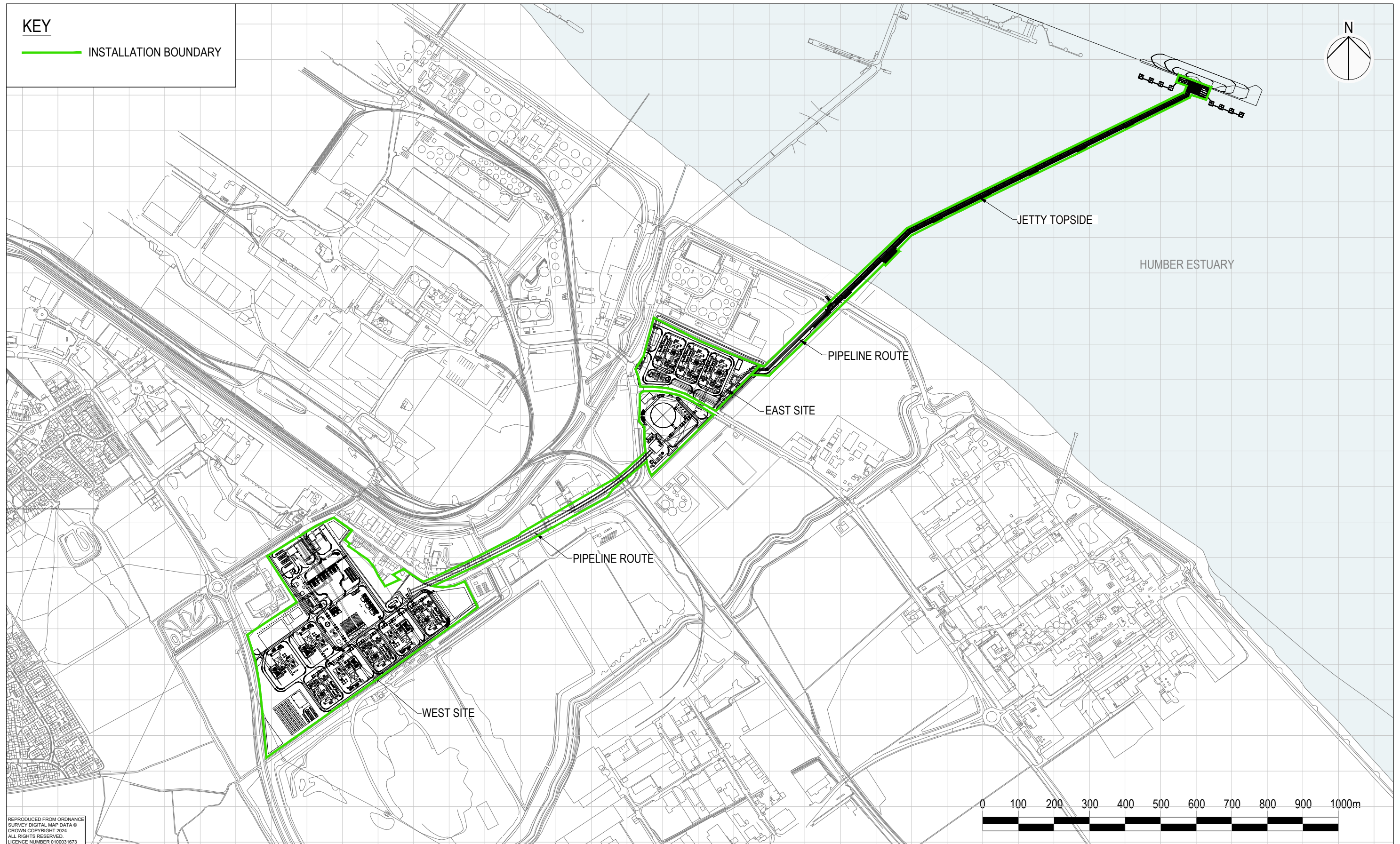
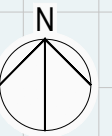

REPRODUCED FROM ORDNANCE SURVEY DIGITAL MAP DATA © CROWN COPYRIGHT 2024. ALL RIGHTS RESERVED. LICENCE NUMBER 0100031673

Project Title
**IMMINGHAM GREEN ENERGY
 TERMINAL PERMIT APPLICATION**

Client

Drawing Title
SITE LAYOUT

Purpose of issue ENVIRONMENTAL PERMIT APPLICATION				
Designed	Drawn	Checked	Approved	Date
-	AAO	CB	AG	05/24
AECOM Internal Project No. 60673509		Suitability -		
Scale @ A3 1:10,000		Zone / Mileage -		

THIS DOCUMENT HAS BEEN PREPARED PURSUANT TO AND SUBJECT TO THE TERMS OF AECOM' APPOINTMENT BY ITS CLIENT. AECOM ACCEPTS NO LIABILITY FOR ANY USE OF THIS DOCUMENT OTHER THAN BY ITS ORIGINAL CLIENT OR FOLLOWING AECOM' EXPRESS AGREEMENT TO SUCH USE, AND ONLY FOR THE PURPOSES FOR WHICH IT WAS PREPARED AND PROVIDED.

AECOM
 Royal Court, Basil Close
 Chesterfield
 Derbyshire, S41 7SL
 Telephone: (01246) 209221
 Fax: (01246) 209229
 www.aecom.com



Drawing Number	FIGURE 3	Rev	-
----------------	-----------------	-----	---