

DRAINAGE LEVEL	CL	IL
1	6.330m AOD	5.236m AOD
2	6.370m AOD	5.386m AOD
3	6.460m AOD	5.536m AOD
4	6.410m AOD	5.574m AOD
5	6.160m AOD	5.650m AOD
6	6.140m AOD	5.726m AOD
7	6.240m AOD	5.800m AOD
8	6.26m AOD	5.686m AOD
9	6.21m AOD	5.536m AOD
10	6.12m AOD	5.386m AOD

STACK	EASTING	NORTHING
1	354315.5	181259.5
2	354319.6	181256.0
3	354323.2	181252.7
4	354327.0	181249.3
5	354330.8	181245.9
6	354334.6	181242.4
7	354342.2	181235.7
8	354345.9	181232.3
9	354349.7	181228.9
10	354353.5	181225.6
11	354357.3	181222.0
OUTFALL POINT	354265	181292

- Permit Boundary
- Stack (as numbered)
- Title AV188665
- Security Fence
- Environmental Buffer (7m width)
- Proposed Electrical Cable Route
- Internal Site Access
- Shared Access
- DRAINAGE**
- + Drainage Levels
- Filter Drain
- ✕ Outfall Point
- Discharge to pond
- Outfall location

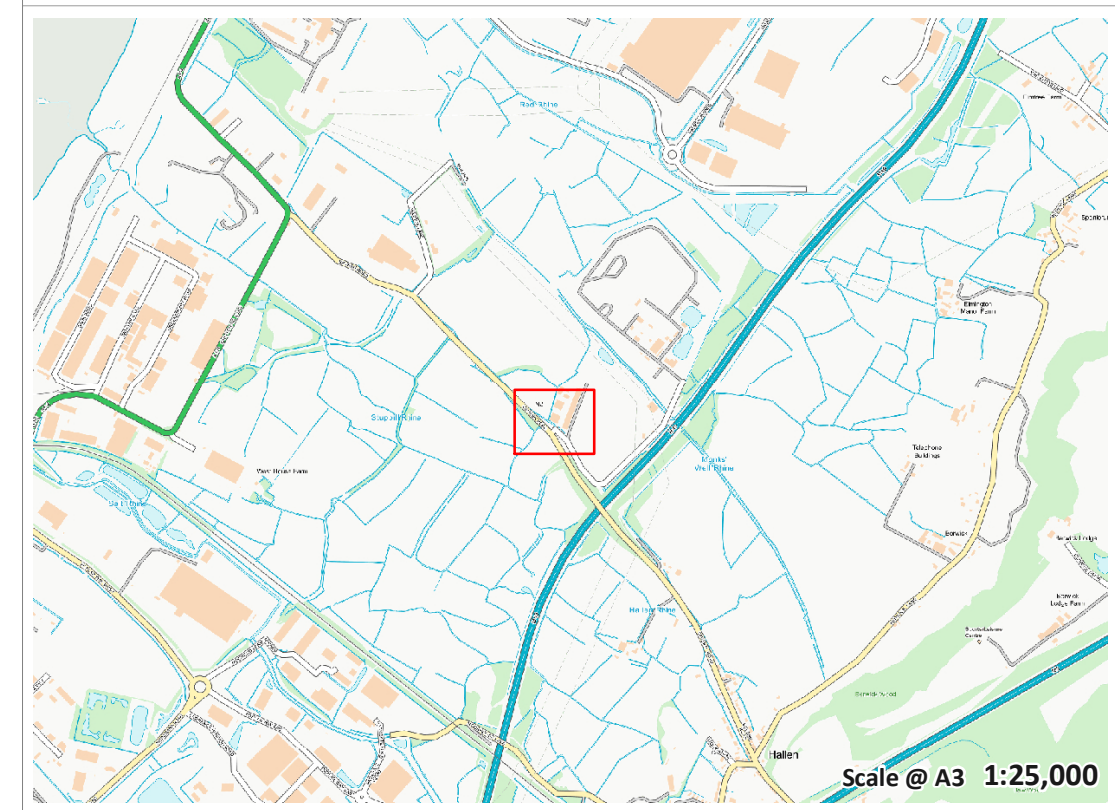
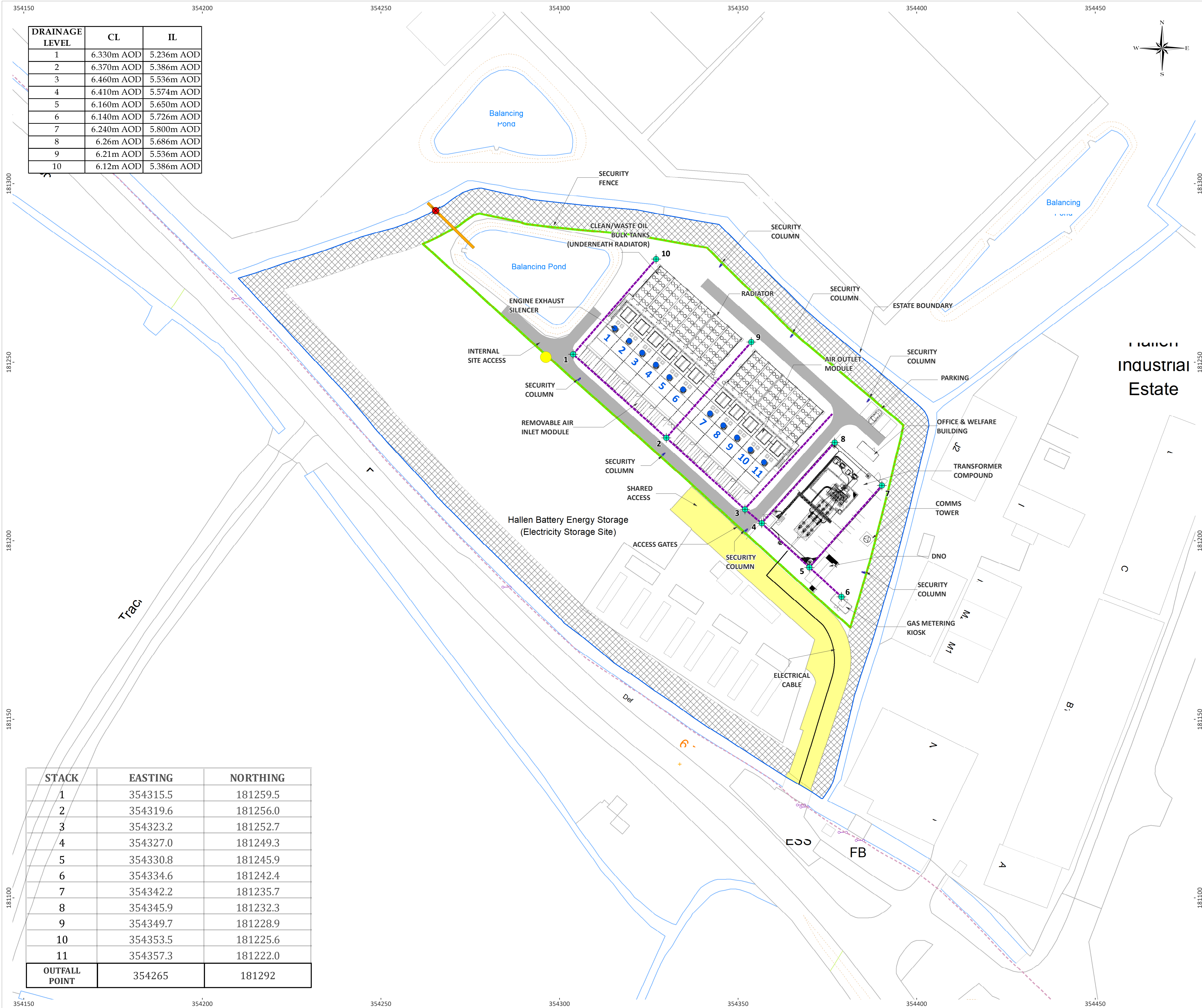

© This drawing is the property of Forsa Energy; the data contained herein, and the map itself can only be reproduced with their prior permission



Site Drainage

**Gas Energy Generating Site
Severn Road, Avonmouth**

NOTE:

Ref: FE/017/584
Date: 16/11/2023
Produced: VM
Approved: RW

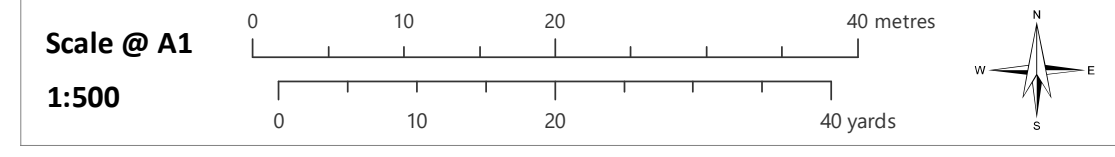

Reproduced from Ordnance Survey digital map data © Crown copyright and database right 2023. License number 0100031673. All rights reserved.