

Environmental Permitting Regulations 2016

Environmental Management System Summary to Support

Application for a Bespoke Environmental Permit

HD White Yard, The Factory

Ford Airfield Industrial Estate

Yapton

BN18 0HY

Submitted on Behalf of:

Refined Metal Recycling Limited

Prepared & Submitted By:

Beyond Waste Ltd



Beyond Waste

www.beyond-waste.com

June 2023

Version: 1.1

Beyond Waste for Refined Metal Recycling Limited

Introduction

This document provides a summary of the site Environmental Management System (EMS) that will be worked to, to assure compliance with the permit. It follows the Environment Agency guidance “Develop a Management System: Environmental Permits” and provides a summary on how each topic is addressed in the site EMS.

The site EMS is the operator's document and will be reviewed at least annually and amended to reflect the needs of the site on an ongoing basis.

EMS Introduction

The site will operate under a bespoke Environmental Permit.

Site Infrastructure Plan

The site infrastructure plan in Appendix 1 shows the location of the following items:

- Waste storage areas
- Buildings, Bays and covered areas.
- Static Plant/Equipment

Site Operations

The following permitted activity will take place on site:

- sorting of catalytic convertors and processing of certain types using static equipment to separate the monolithic catalyst from the casing and the RDF matting.

Waste Acceptance Procedures

Waste acceptance procedures will ensure no non-permitted waste is delivered. Waste acceptance procedures are specific, dependent on what waste is being delivered to the site. The list of materials the site is permitted to accept will be included in the site Environmental Permit.

Beyond Waste for Refined Metal Recycling Limited

Steps to minimise risks to the environment

The EMS contains measures to reduce any fugitive emissions from:

- Dust
- Storage of hazardous substances

There is a separate Dust Emissions Management Plan (ref: RMR (Ford)/DEMP/v1.0) which should be read alongside this Summary EMS document.

Equipment Maintenance Plan

All equipment critical to the efficient operation of the site undergo periodic checks on a preventative basis.

Accident/incident prevention and management plan

All staff are trained on accident procedures. There are accident, emergency & incident plans in place at the site. Contingency plans are also considered.

Complaints Procedure

The Company has a complaints procedure in place, the procedure explains how any complaints received are investigated and responded to, and also gives a list of contacts including out of hours contacts.

Management staff competence and training records

Staff induction records and a Training Matrix will be held. The Site Manager will deliver training on the requirements of the site permit and the EMS through toolbox talks.

Record keeping

The following records are kept onsite and made available for inspection by an authorised officer of the Environment Agency:

- Site diary recording maintenance and monitoring
- Waste transfer notes
- Quarterly input returns
- Events/incident reports
- Complaints records.

Beyond Waste for Refined Metal Recycling Limited

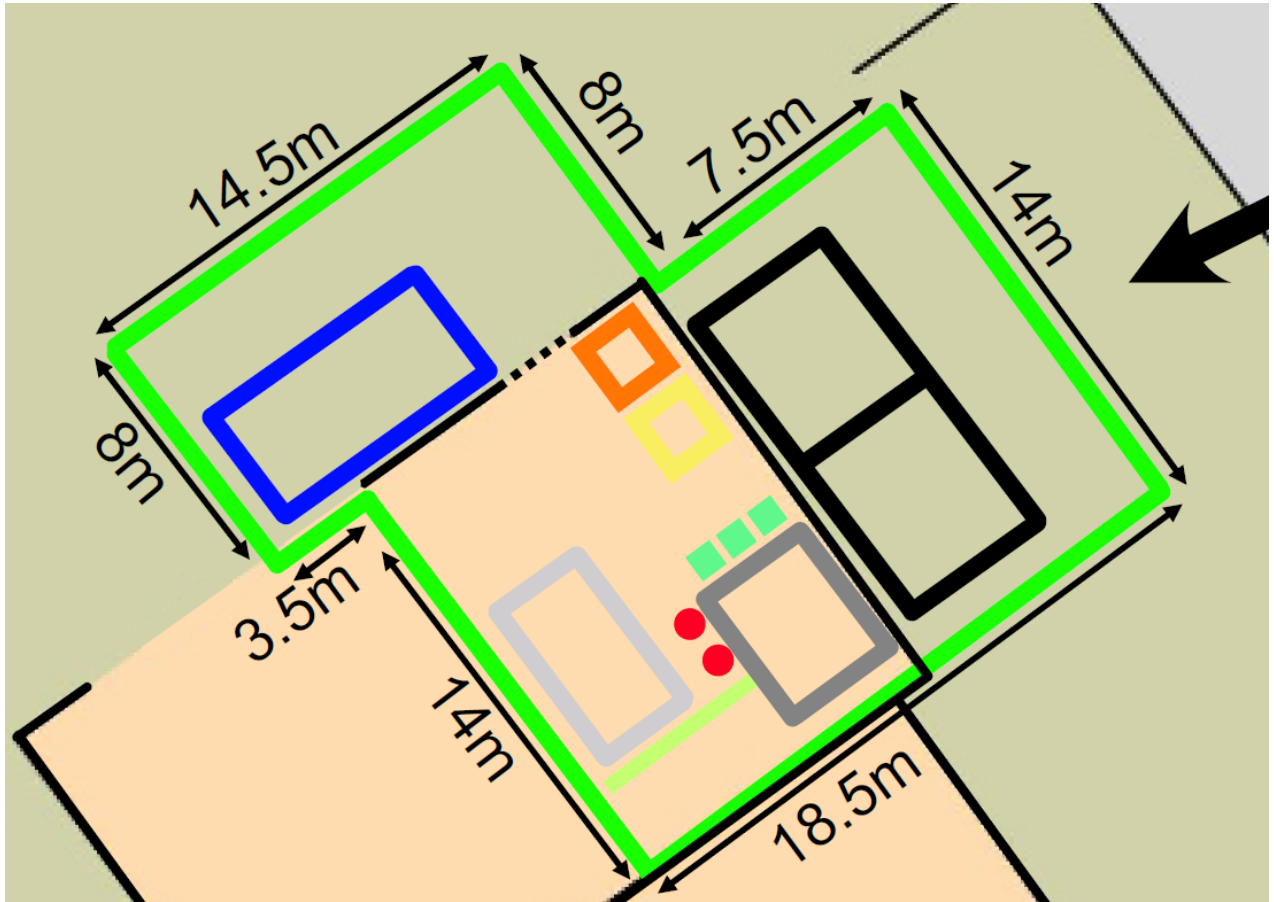

Key:

- Office/Analysis Lab
- Cat Monolith Storage Container
- Plasma Cutting Station
- Top and Tail Shear
- Decanning Machine
- Stainless/Metallic/Net Storage
- Toilet Block
- RCF Barrels
- ⋯ Rollershutter Door

Address: Ford Airfield Industrial Estate The Factory Ford, <u>Yapton</u> BN18 0HY	
Details: Refined Metal Recycling, Ford, Site Layout Plan (Permit App)	
Date: 05/06/2023	Version: 1.1