

Plan Ref	Description	Storage form/containment	Height, width (m) & type of fire wall	Max Length / Width (m)	Operational storage height (m)	Out-of-hours storage height (m)	Approx. Area (m ²)	Conversion factor used	Volume (m ³)	Tonnes (approx.)	Max storage duration	Comments
AREA 1	Tipping / reception area for residual waste (RDF material) >150mm	Free standing / fire wall	3.2m high, 0.8m thick interlocking concrete blocks	20	3	2.2	120	0.75	270	135	<24 hours	The entire pile would be processed during operational hours.
AREA 2	Shredded residual (RDF) waste <300mm	Free standing / fire wall	6, 0.15 / 0.8 & interlocking concrete blocks and concrete panel of building	20	2	2	250	0.5	250	125	<24 hours	The entire pile would be processed during operational hours.
AREA 3	Mixed HIC waste reception and sorting area	Free standing / fire wall	3.2, 1.5 & 0.8 interlocking concrete blocks	15	2	2	75	0.5	75	37.5	<72 hours	The entire pile would normally be processed during operational hours, 72 hours based on contingency
AREA 4	POPs/bulky waste	Free standing / fire wall	3.2m high, 0.8m thick interlocking concrete blocks	12	3	2	90	0.75	202.5	101.25	<24 hours	POPs would be removed from AREA 3 or segregated from AREA 1 following visual inspections
AREAS 5 - 8	Drying bays for SRF material awaiting removal from site	Free standing / fire wall	4, 0.8m & interlocking concrete blocks	14	4	3	50	0.75	150	75	<7 days	The nature of waste may change the bay. If the waste in the bays is wet, it may be stored for up to 7 days so it can dry naturally.
AREA 9	As above or either POPs / mixed HIC waste	Free standing / fire wall	As above	14	4	3	80	0.75	240	120	<7 days	Overflow drying bay from AREAS 5 - 8 but may also be used as overflow for wastes in AREAS 3 & 4.
AREA 10	Holding bay for processed SRF	Free standing / fire wall	As above	12	4	3	90	0.75	270	135	<7 days	Transferred to drying bays (AREAS 5-8) continuously.
AREAS A - B	Containers of non-ferrous metal removed via eddy current separator	12-cubic yard skips	N/A	3.7	1.86	1.86	10	1	20	10	<7 days	Containers usually removed weekly.
AREA C	Sorted waste containers arising from AREA 3	12-cubic yard skips	N/A	3.7	1.86	1.86	10	1	20	10	<7 days	Containers usually removed weekly.

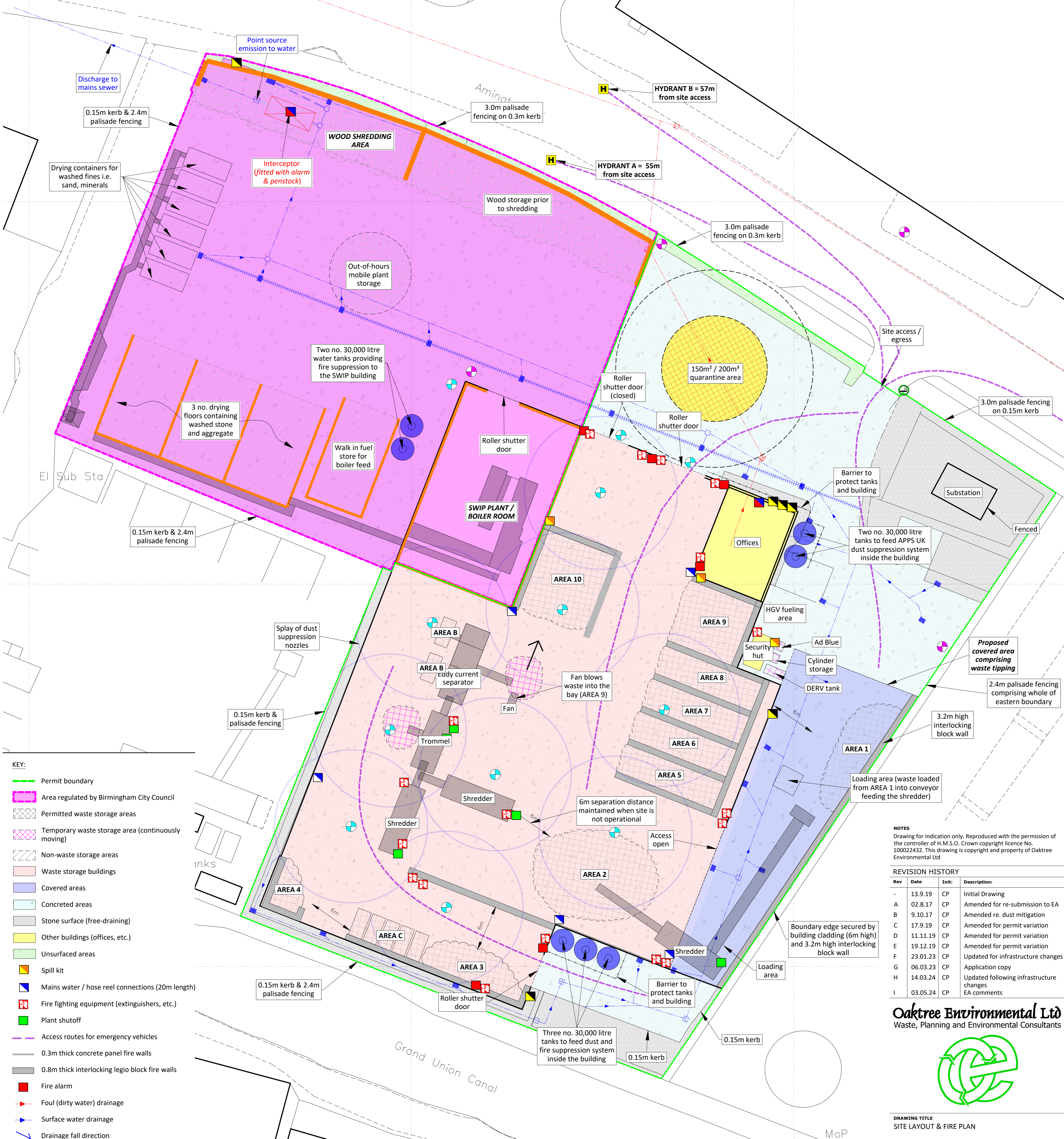

- KEY:**
- Permit boundary
 - Area regulated by Birmingham City Council
 - Permitted waste storage areas
 - Temporary waste storage area (continuously moving)
 - Non-waste storage areas
 - Waste storage buildings
 - Covered areas
 - Concreted areas
 - Stone surface (free-draining)
 - Other buildings (offices, etc.)
 - Unsurfaced areas
 - Spill kit
 - Mains water / hose reel connections (20m length)
 - Fire fighting equipment (extinguishers, etc.)
 - Plant shutoff
 - Access routes for emergency vehicles
 - 0.3m thick concrete panel fire walls
 - 0.8m thick interlocking legio block fire walls
 - Fire alarm
 - Foul (dirty water) drainage
 - Surface water drainage
 - ↘ Drainage fall direction
 - Designated smoking area
 - Fire water containment equipment
 - CCTV camera locations (locations indicative)
 - Smoke detection camera points
 - Dust & odour monitoring points
 - Dust suppression nozzles
 - Suppression system coverage/splay (indicative)
 - H Fire hydrant locations (indicative)

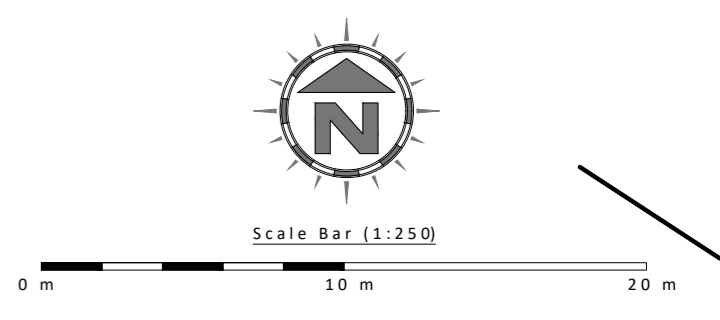
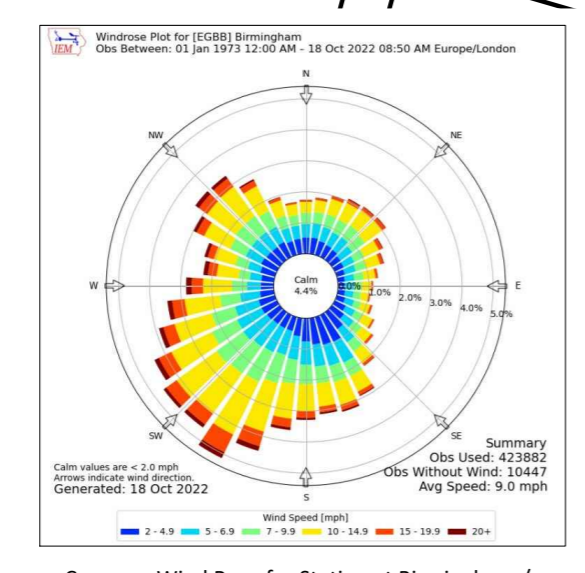

NOTES
Drawing for indication only. Reproduced with the permission of the controller of H.M.S.O. Crown copyright licence No. 100022432. This drawing is copyright and property of Oaktree Environmental Ltd

Rev	Date	Init	Description
-	13.9.19	CP	Initial Drawing
A	02.8.17	CP	Amended for re-submission to EA
B	9.10.17	CP	Amended re. dust mitigation
C	17.9.19	CP	Amended for permit variation
D	11.11.19	CP	Amended for permit variation
E	19.12.19	CP	Amended for permit variation
F	23.01.23	CP	Updated for infrastructure changes
G	06.03.23	CP	Application copy
H	14.03.24	CP	Updated following infrastructure changes
I	03.05.24	CP	EA comments

Oaktree Environmental Ltd
Waste, Planning and Environmental Consultants

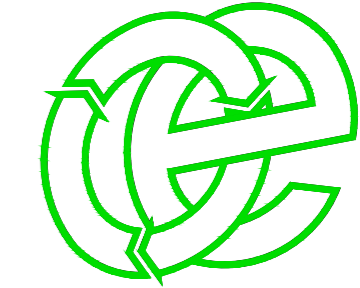

DRAWING TITLE SITE LAYOUT & FIRE PLAN		
CLIENT Klyel Bros. Ltd		
PROJECT/SITE 101 Amington Road, Birmingham B25 8EP		
SCALE @ A1 1:250	JOB NO 012	CLIENT NO 918
DRAWING NUMBER AMI/918/03	REV 1	STATUS Issued
DRAWN CP	CHECKED ---	DATE 03.05.24