

Marygate & Museum Gardens Scheme (B12) Update

Marygate Works Update

Our contractors have now completed the raising of the flood wall from Scarborough Bridge along to the Museum Gardens. Some stretches of the wall still have not yet been clad with exterior brickwork. This is to allow us to carry out our testing on the core of the wall to ensure it meets the required engineering standards and does not require any further treatment. Following our testing and completion of any necessary treatments, we will complete the brickwork and reinstate the coping stones towards the end of the year.

We will be installing glass panels and flood gates along Earlsborough Terrace and on top of the flood wall in front of Esplanade Court in the coming months. The glass panels are currently being manufactured and will be tested in the factory before being delivered to site sometime in mid-November. Once they have been fitted, we will be undertaking further on-site testing to ensure that they meet stringent levels of protection that we have set as the Environment Agency standard. We will contact those residents directly affected closer to the time to confirm dates and plans for installation.

Museum Gardens Works Update

Our works in the Museum Gardens to raise the embankment by up to 700mm began in August 2021. This is progressing well, our contractors have extended the compacted clay core and are working on the benching excavation works at the eastern end of the embankment.

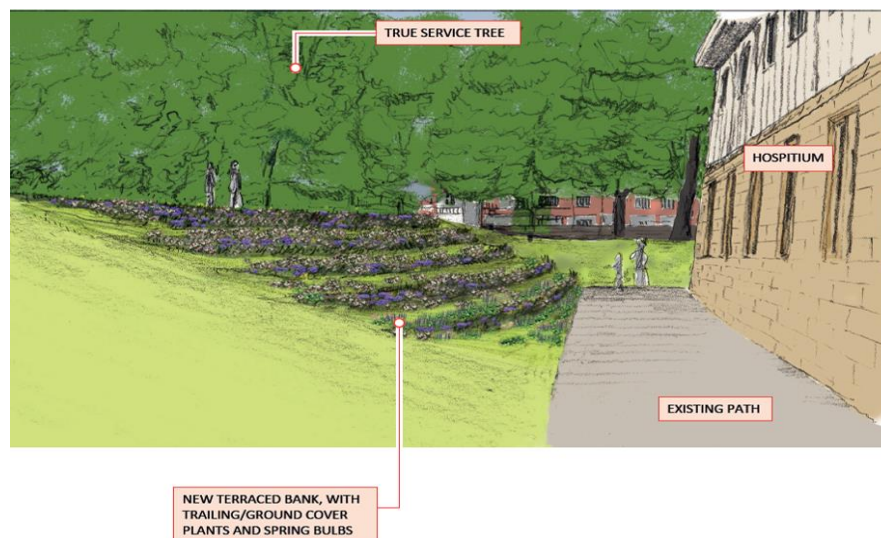

As the works move back towards Marygate this will involve the creation of a larger area of terracing behind the Hospitium. This terracing is made up of pre-seeded greenfix sandbags containing a native grass/seed mix and will be further enhanced by the Landscape planting scheme due to start next spring.

The left photograph shows a large, light-colored concrete ring being lowered into a deep trench. The ring is suspended by heavy chains from a yellow crane. The trench walls are reinforced with red and yellow metal beams. A worker in an orange safety suit is visible on the right side of the trench. The right photograph shows two workers in orange safety gear and white hard hats standing in the trench, looking at the structure. The trench walls are reinforced with red and yellow metal beams. The ground is dark and muddy.

Following this, works on the embankment will resume, and are on track to be completed in the New Year.

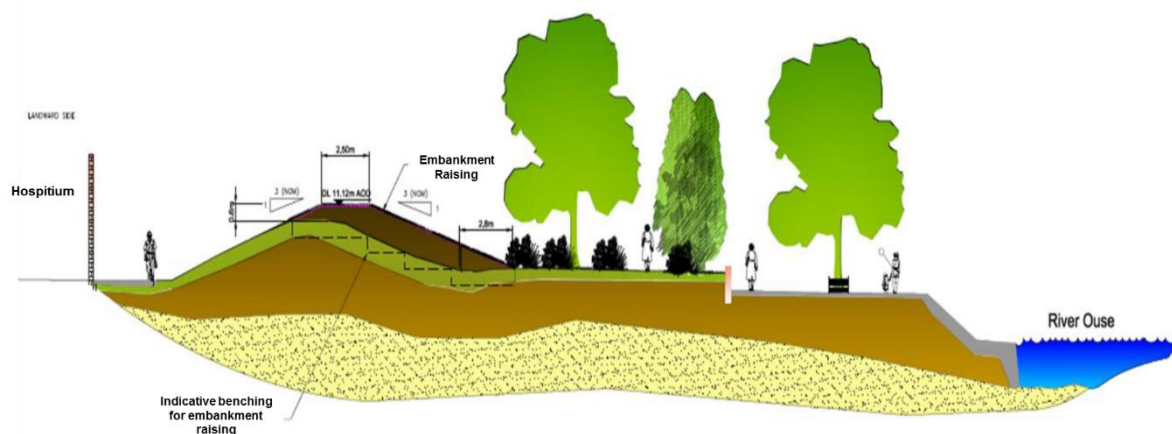

Winter Readiness

As we move into the winter months, we appreciate that there may be questions or concerns regarding the level of flood protection that is in place across the scheme. Whilst we work to improve the level of flood protection in the area, we are ensuring that the existing level of protection remains in place.

All of our floodgates remain fully functional until they are replaced by our new gates. The changeover of gates can be completed in one day and will only take place when weather and flood forecasts are favourable. The Environment Agency network of river level gauging stations across the catchments upstream of York provide us with the means to plan our works. The embankment in the Museum Gardens continues to provide the existing level of protection.

Where our works are at risk of temporarily reducing the existing levels of protection, our contractors BAM Nuttall have put contingency plans in place. They have recently taken delivery of fresh sandbags, securely stored at our construction compound in Marygate carpark, sufficient to be deployed in both B11 and B12 flood cells should the need arise.

However, may we take this opportunity to again remind you that protected properties are still at risk of flooding. The City of York is largely covered by our Flood Warning system. This is a free service which gives notice of when flooding is expected so that you can be prepared or take any necessary action. To sign up for Flood Warnings please:

Call **Floodline on 0345 988 1188** or visit www.gov.uk/sign-up-for-flood-warnings

Find out your risk of flooding, and see what warnings are in force at any time by visiting www.gov.uk/check-flood-risk



You can find useful tips on what to do should flooding threaten your home and valuables by visiting <https://floodsdestroy.campaign.gov.uk>

Footpath Closures

To complete our works safely in the areas alongside the river, we need to close public footpaths and cycleways. We are currently working with City of York Council to organise these footpath closures in locations across the scheme in the coming months. We will endeavour to keep these to a minimum, and only have them in place for periods of time that are necessary for our works to take place. We will provide more specific details of dates and diversion routes these closures closer to the time.

How we're reducing
the risk of flooding
for York



 yorkfloodplan@environment-agency.gov.uk
 consult.environment-agency.gov.uk/yorkshire/yorkfas/
 @YorkFAS  @EnvAgencyYNE

How can I contact the Environment Agency?

During the course of the works we will provide you with updates and may need to get in touch at short notice to let you know of any changes to arrangements. For us to do this please can you provide us with your name, address and contact details. You can do this by emailing us at yorkfloodplan@environment-agency.gov.uk.

We also post regular updates and information regarding road/path/cycle closures on our social media pages. Please follow us on Facebook (www.Facebook.com/YorkFAS) or Twitter (@EnvAgencyYNE)

If you have any questions or require further details regarding the scheme please get in touch with the Environment Agency project team at yorkfloodplan@environment-agency.gov.uk or phone our Customer Service Line on 03708 506506 quoting reference 'Marygate Flood Scheme, York'.

If you have any queries specific to the construction works, please contact our contractor Bam Nuttall by emailing Brian.Hall@bam.com or calling 07423 694783 9am – 5pm Monday – Friday.

Thank you for your continued support.

How we're reducing
the risk of flooding
for York



 yorkfloodplan@environment-agency.gov.uk
 consult.environment-agency.gov.uk/yorkshire/yorkfas/
 @YorkFAS  @EnvAgencyYNE