

**LEGEND**

- Proposed first stage channel (permanently wet)
- Proposed second stage channel (only wet when river levels rise) - wetland meadow mix
- Proposed wetland features and scrapes
- Proposed backwaters (permanently wet)
- Proposed stone permanent maintenance track (seeded with temp works area seed mix)
- Proposed grass covered permanent access track
- Flood embankment raised defence
- Turning area for maintenance vehicle
- Proposed flood wall / raised defence
- Invasive species Himalayan balsam
- Invasive species Stag's Horn Sumach
- Invasive species Virginia creeper
- Proposed wet woodland
- Proposed dry meadow mix
- Proposed woodland edge
- Proposed low shrub planting
- Proposed amenity grassland
- Temporary works area to be seeded
- Proposed riprap
- Gabion mattress
- Proposed fence
- Single-leaf vehicle gate - approx. 4m
- Proposed combined gate (pedestrian swing gate and single-leaf vehicle gate)
- Existing gate to be retained
- Existing rivers, streams and ditches
- Existing Green Belt
- Crops
- Garden
- Existing trees to be retained
- Existing trees to be removed
- Existing trees Root Protection Area
- Proposed tree
- Scheme boundary

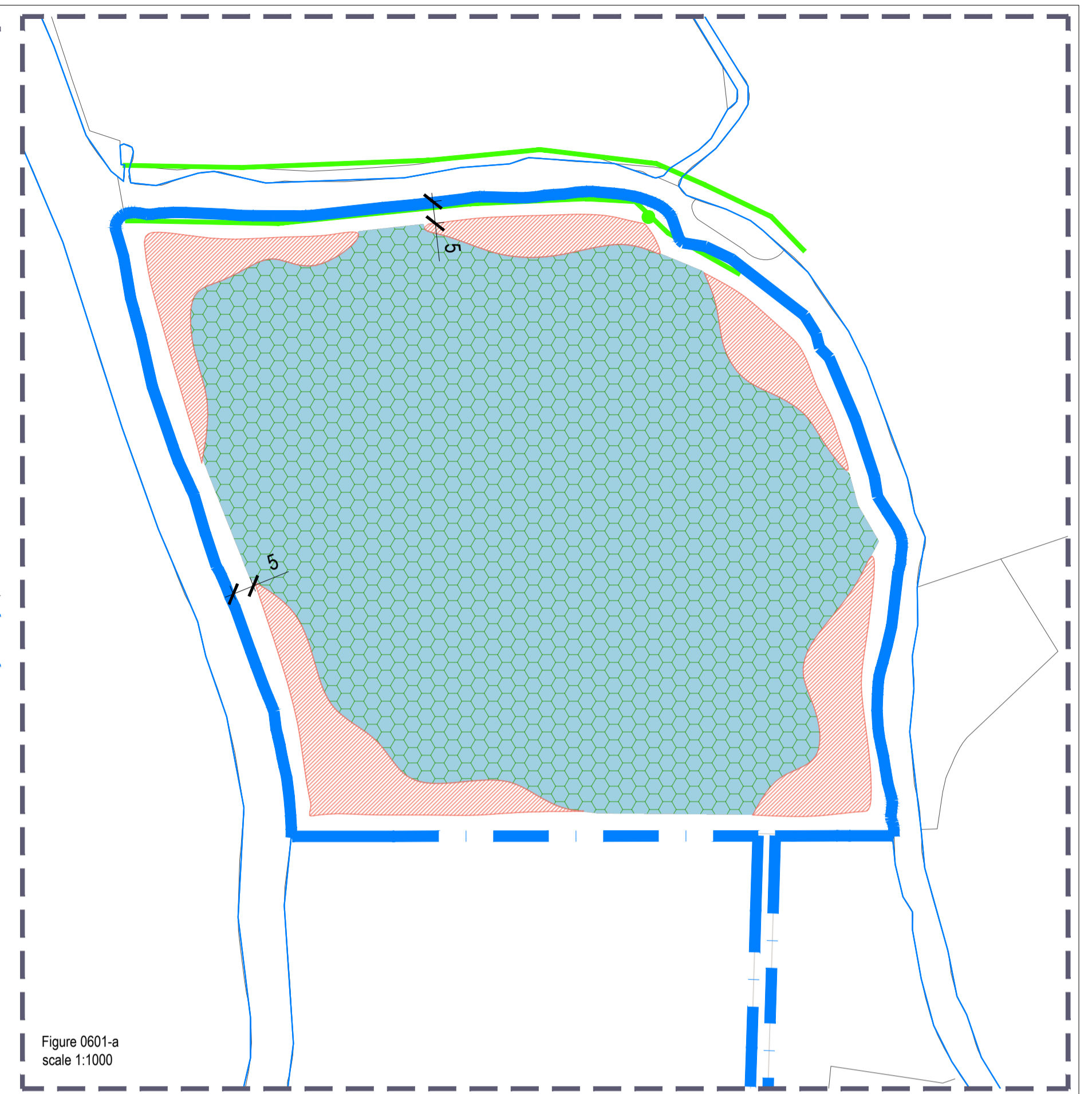
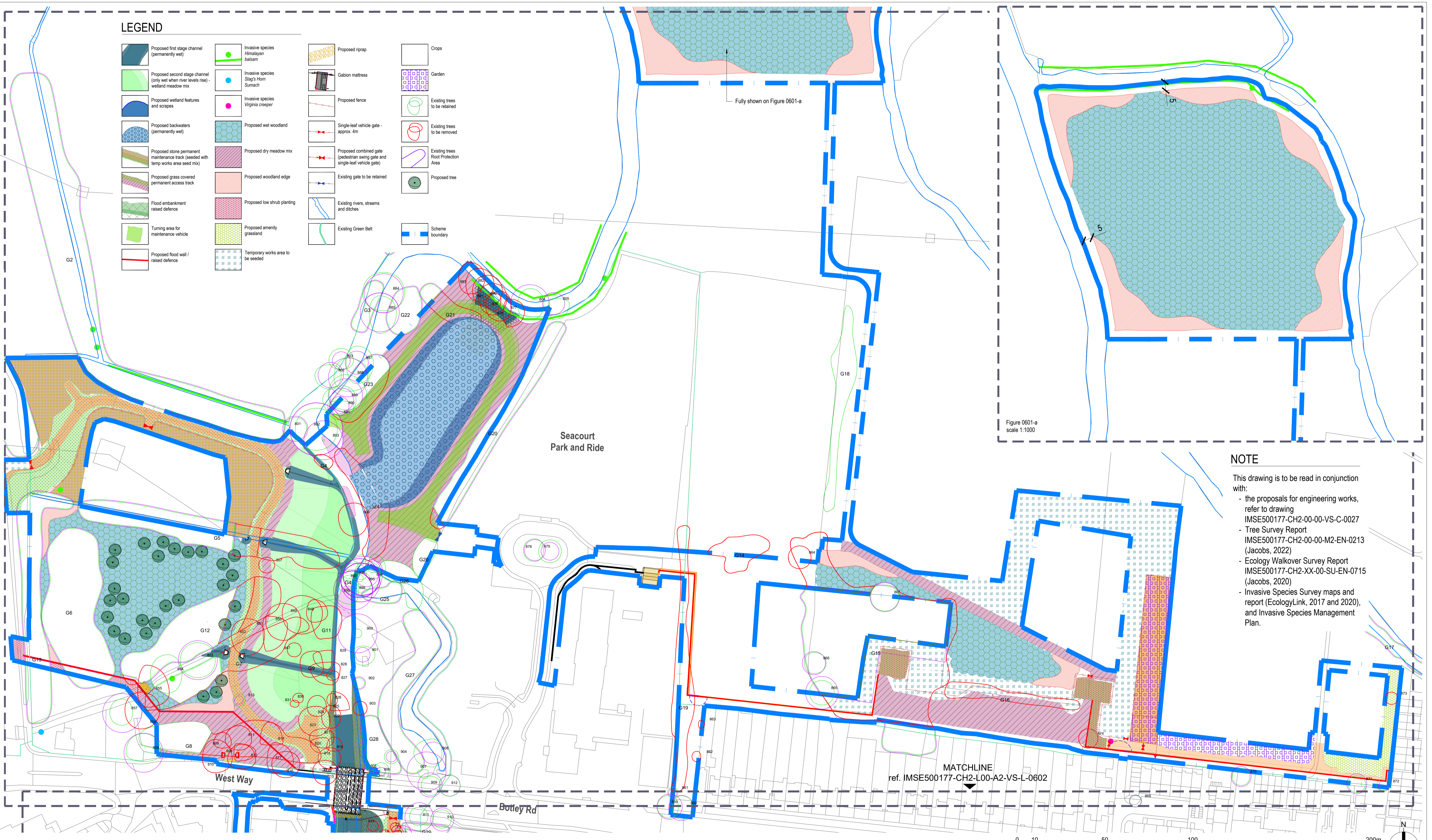

**NOTE**

This drawing is to be read in conjunction with:

- the proposals for engineering works, refer to drawing IMSE500177-CH2-00-00-VS-C-0027
- Tree Survey Report IMSE500177-CH2-00-00-M2-EN-0213 (Jacobs, 2022)
- Ecology Walkover Survey Report IMSE500177-CH2-XX-00-SU-EN-0715 (Jacobs, 2020)
- Invasive Species Survey maps and report (EcologyLink, 2017 and 2020), and Invasive Species Management Plan.

01 Landscape GA (01 of 14)  
scale 1:1000 @ A1  
(1:2000 @ A3)

rev	details	by	date
14	Draft for Planning Application	YA	20.11.2020
15	Draft for Planning Application	YA	12.07.2021
16	Issued for Planning Application	YA	19.11.2021
17	Issued for Planning Application	YA	21.01.2022
18	Eastwyke Ln and Reg25 Works (DRAFT)	YA	13.12.2022
19	Eastwyke Ln and Reg25 Works	YA	25.01.2023

**Notes**

- Information shown on these drawings is not valid for Construction. Please refer to the status of the drawing in the Title and Issue box
- Do not scale from this drawing, use figured dimensions only where they are shown
- Do not procure or manufacture materials, or undertake construction site works from this drawing unless the issue status is noted as 'for construction'
- Any contractor that chooses to take forward this information for construction without full review process and sign-off does so at their own risk.
- All measurements are to be checked on site prior to construction.
- This drawing is to be read in conjunction with all other Gillespies drawings and specification and other consultants drawings as referred.
- Where any conflict or inconsistency occurs between drawing and specification information the Contractor is to immediately notify Gillespies prior to continuing working.
- Information to be read in coordination with Structural Engineers & M&E Engineer drawings & spec: Where any conflict or inconsistency occurs between Gillespies and Engineers drawing and specification information the Contractor is to immediately notify Project Manager prior to continuing working.

Ordnance information shown is reproduced from Ordnance Survey material with the permission of Ordnance Survey on behalf of the Controller of Her Majesty's Stationary Office © Crown Copyright. Unauthorised reproduction infringes Crown Copyright and may lead to prosecution or civil proceedings. License No. 1000 17362

© copyright GILLESPIES LLP, all rights reserved



Project title  
**OXFORD FLOOD ALLEVIATION SCHEME**

Drawing number  
**IMSE500177-CH2-L00-A1-VS-L-0601**

Drawing title  
**Landscape Plan (01 of 14)**

Drawing Status	Revision		
PLANNING	19		
Date	Scale	Drawn	Checked
02.11.2017	1:1000 @ A1	DL	MH

**Environment Agency**  
Kings Meadow House, Kings Meadow Rd, Reading RG1 8DG  
T: 01493 850789  
F: 01493 850770

**GILLESPIES**  
The Coach House, Bagley Croft, Hinkley Hill, OX11 5BS, Oxford  
T: 01865 327170  
F: 01865 327170  
E: design.oxford@gillespies.co.uk