

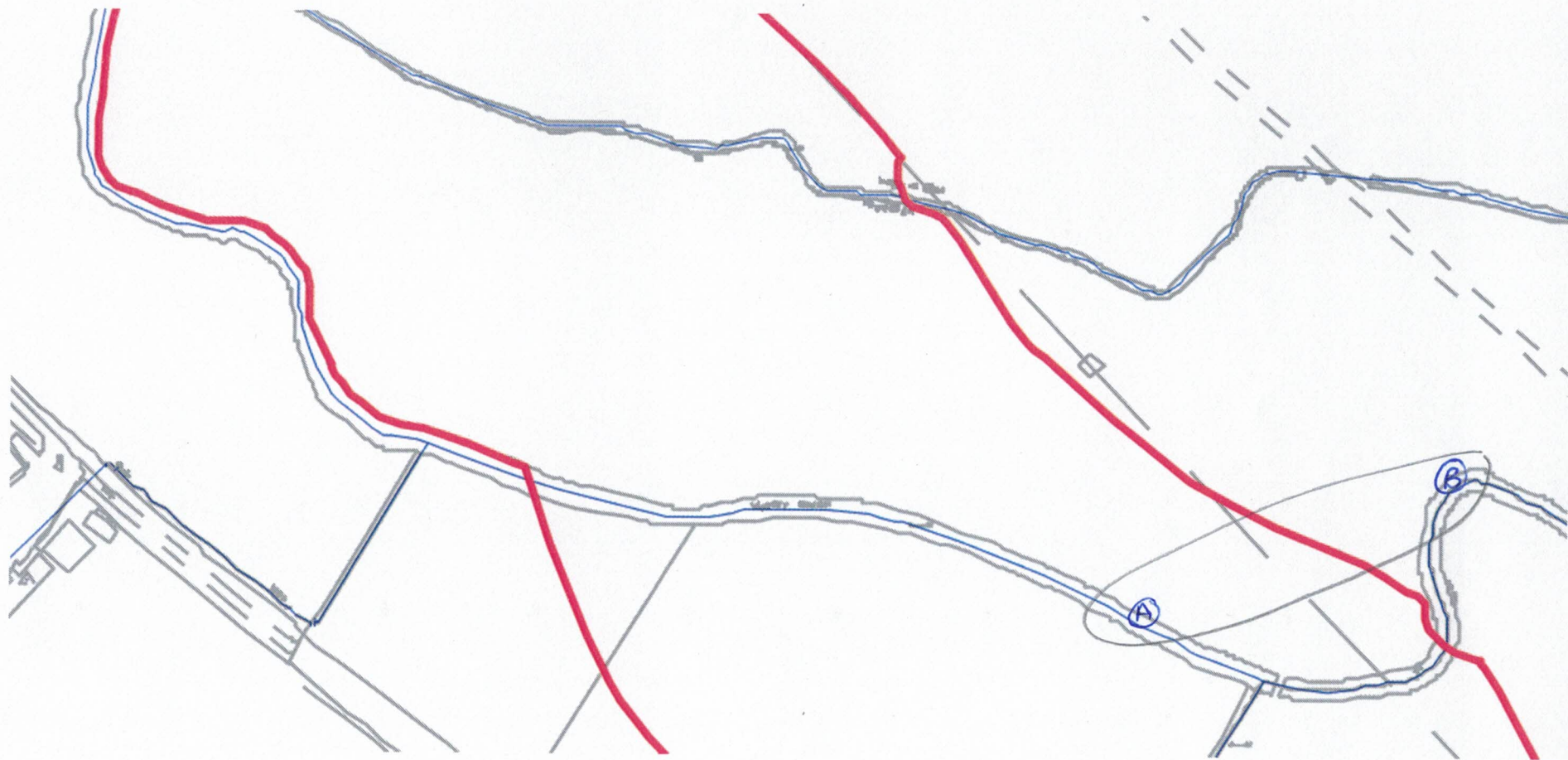

TRANSECT 6 MAP 1 OF 2
REED BUNTING SPECIES MAP

1 territory



TRANSECT 6 MAP 2 OF 2
REED BUNTING SPECIES MAP



TRANSECT 6 MAP 1 OF 2
SONG THRUSH SPECIES MAP

territory on site

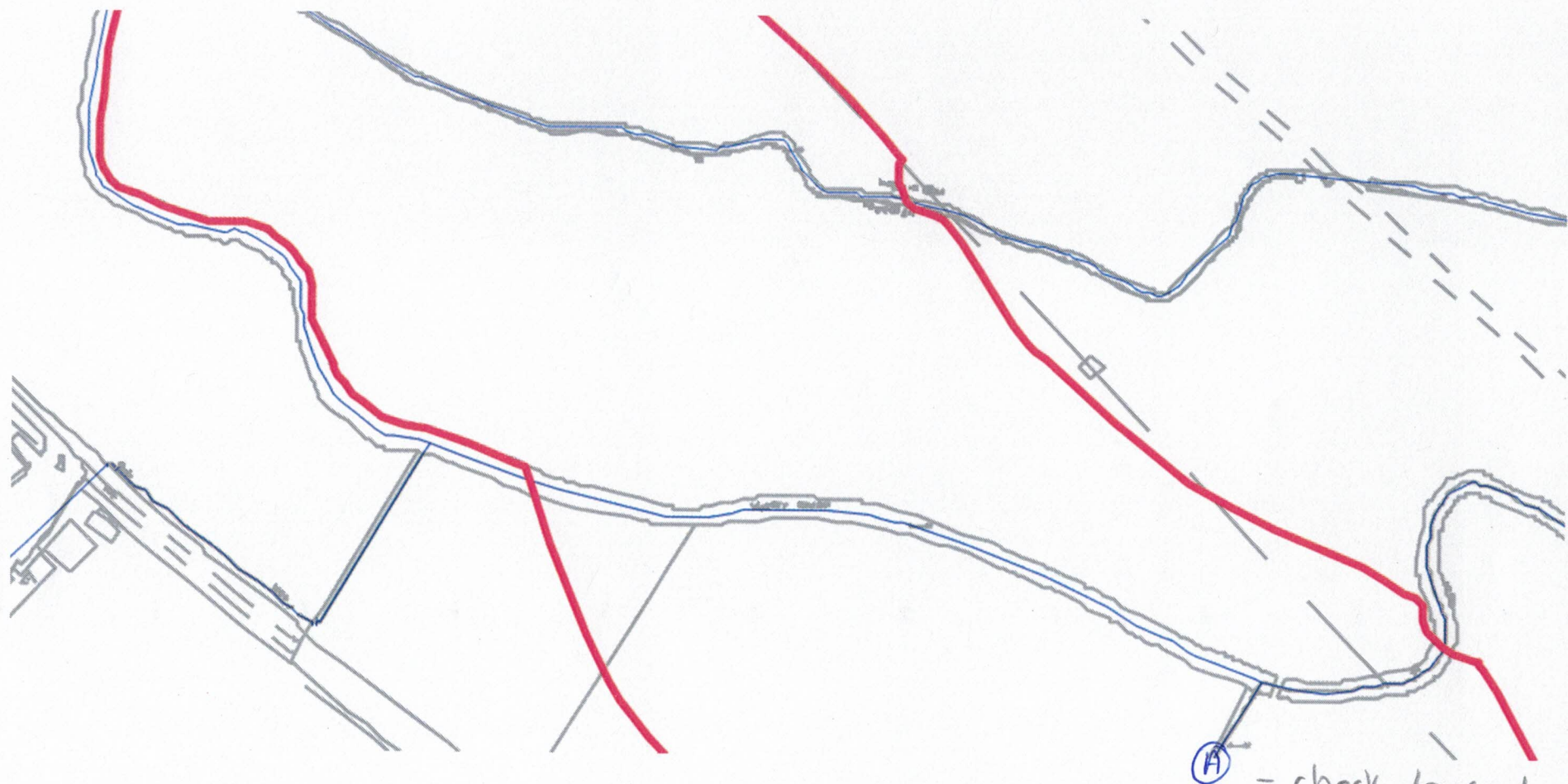

TRANSECT 6 MAP 2 OF 2
SONG THROUSH SPECIES MAP

(A) - check transect
7 which is
neighbouring -
too few registrations
to form a cluster.

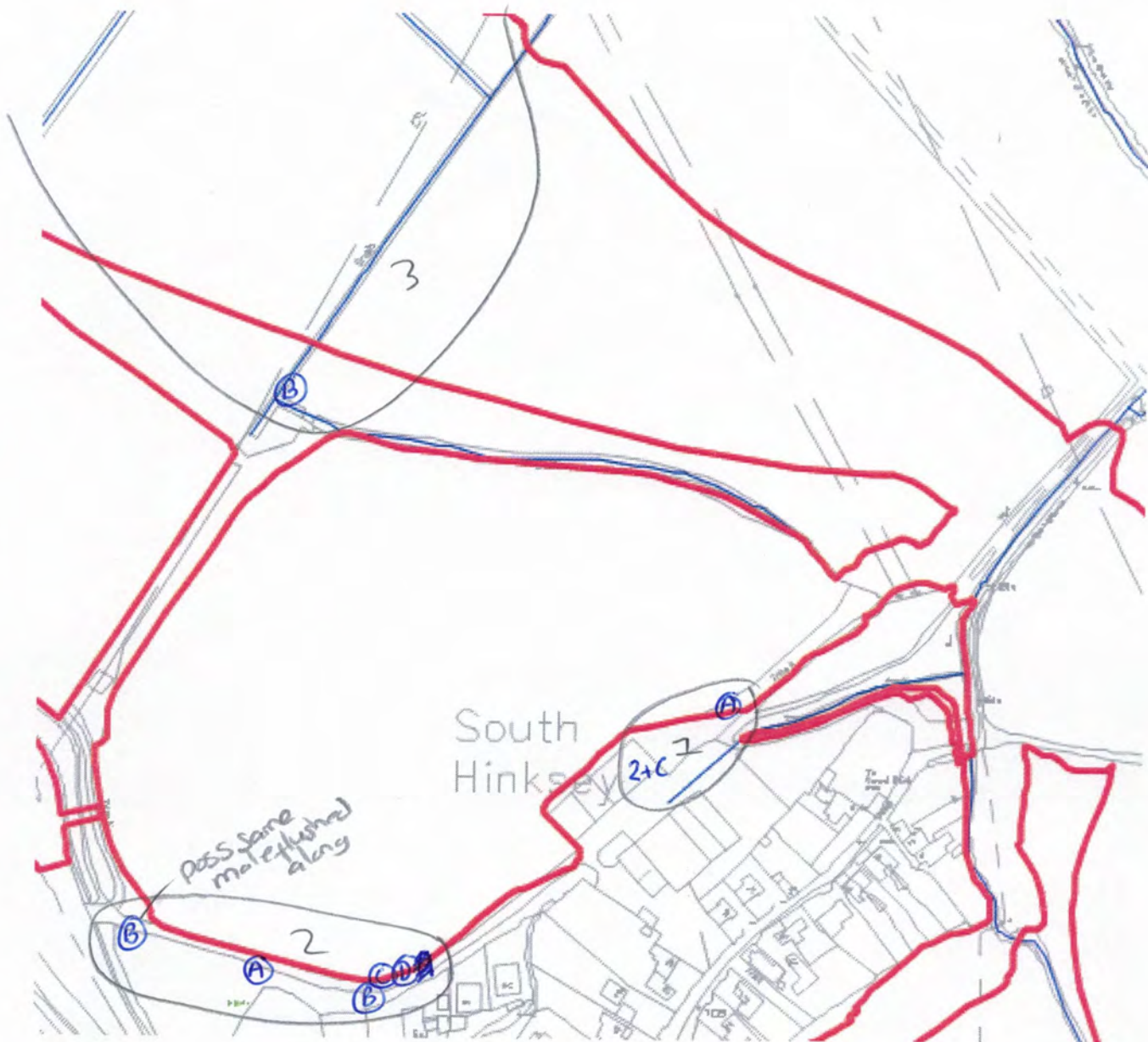

TRANSECT 7 MAP 10F3
 DUNNOCK SPECIES MAP

4 territories



TRANSECT 7 MAP 2 OF 3
 DUNNOCK SPECIES MAP

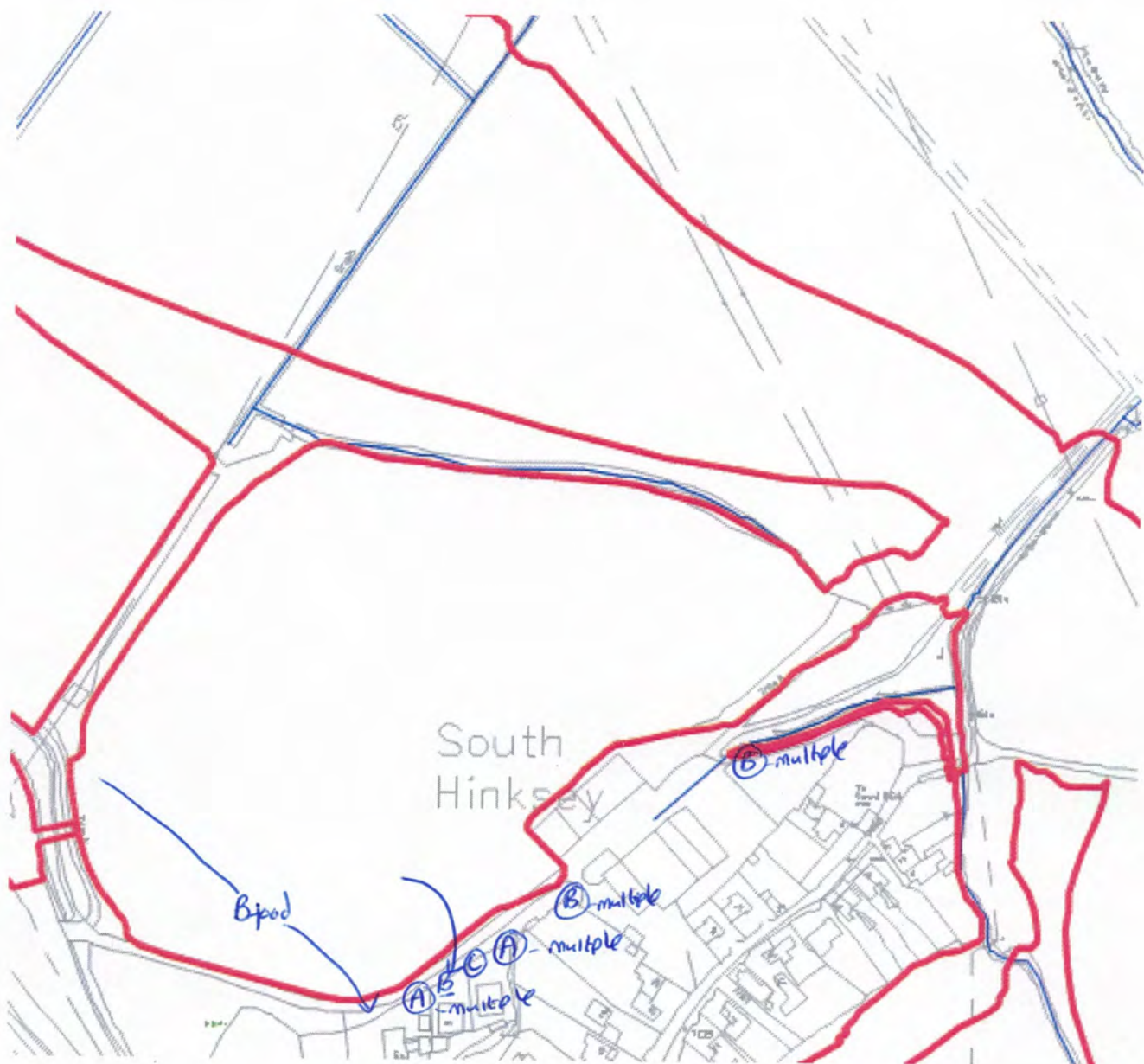

TRANSECT 7 MAP 1 OF 3
HOUSE SPARROW SPECIES MAP

Non-breeding on site.
Prob nesting in houses in village.

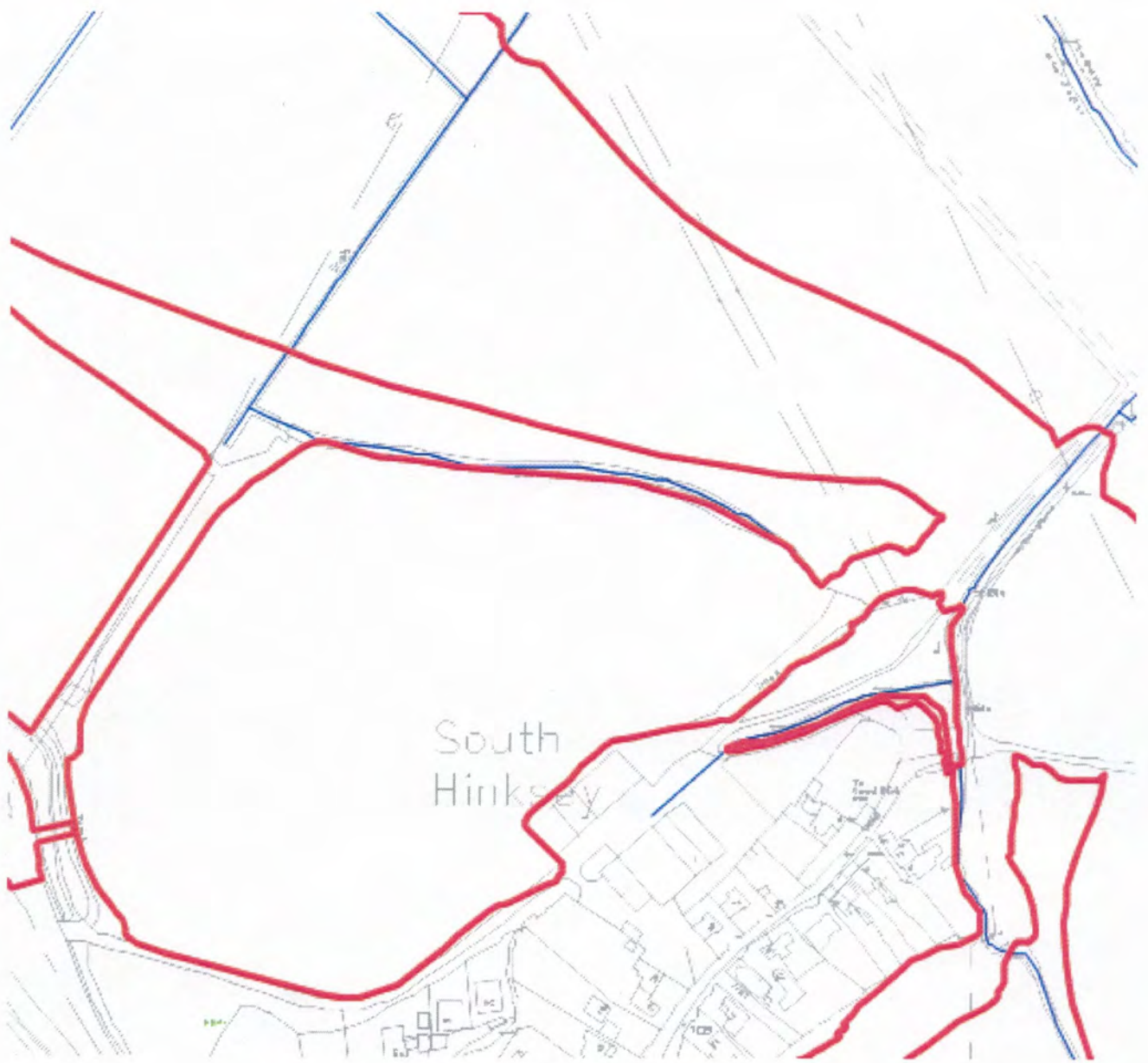

TRANSECT 7 MAP 1 OF 3
MEADOW R.P.I.T SPECIES MAP

1 territory

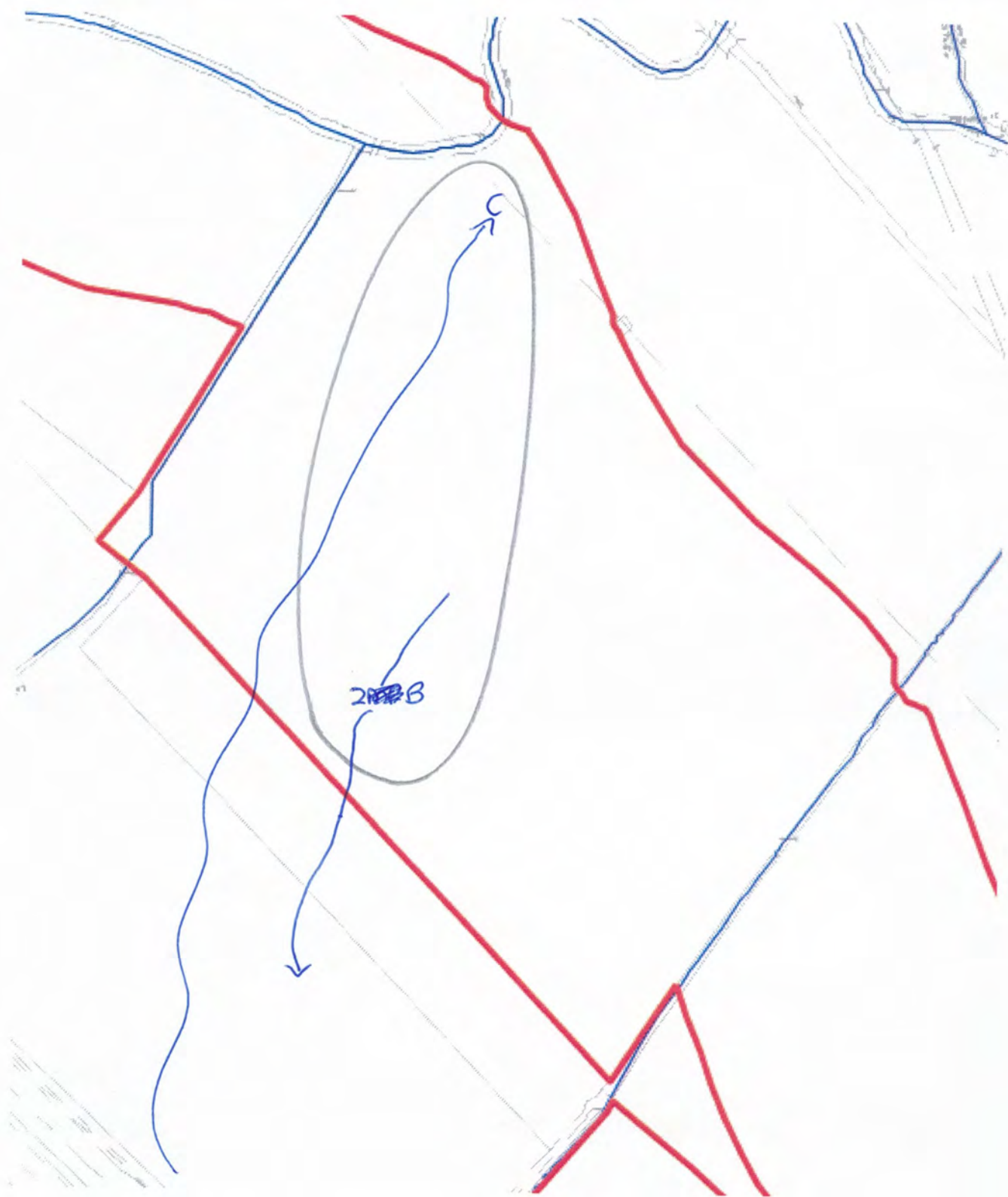

TRANSECT 7 MAP 3 OF 3
MEADOW PIT SPECIES MAP



TRANSECT 7 MAP 1 OF 3
REED BUNTING SPECIES MAP

1 territory

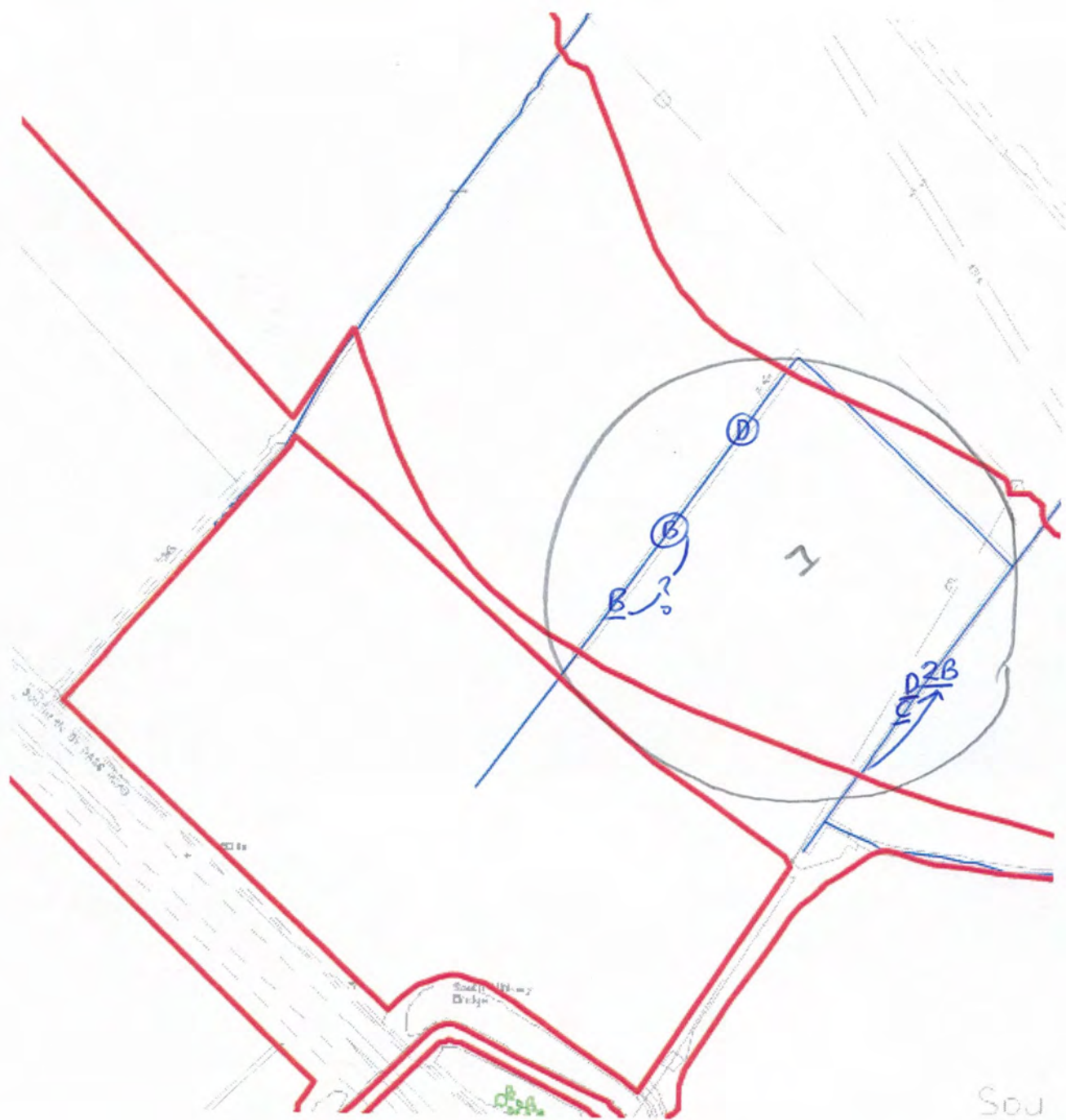

TRANSECT 7 MAP 2 OF 3
 REED BUNTING SPECIES MAP

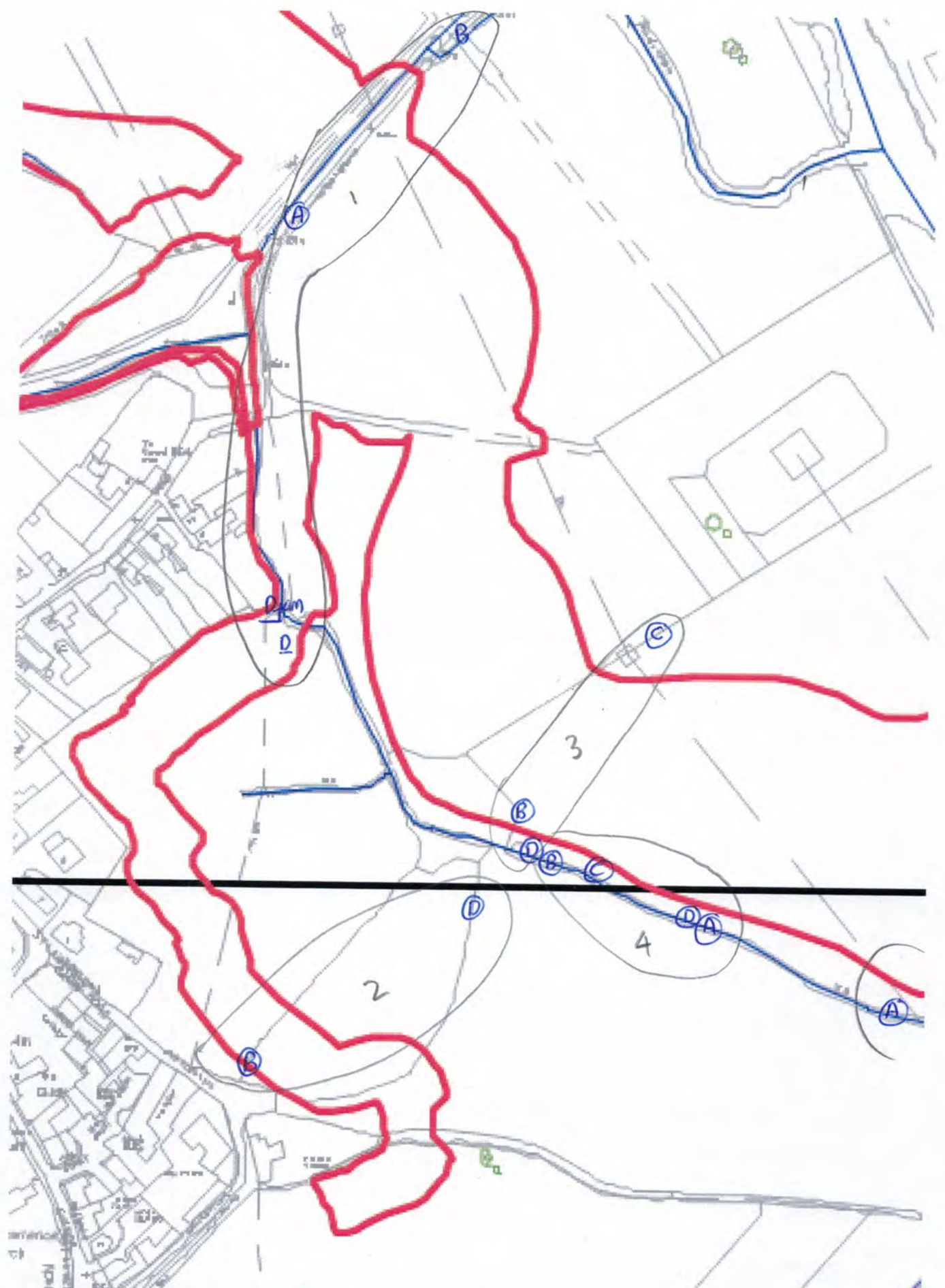

TRANSECT 8 MAP 1 OF 2
 DUNNOCK SPECIES MAP
 3 territories
 on site of 5 territories / clusters
 (1-3) (4-5)

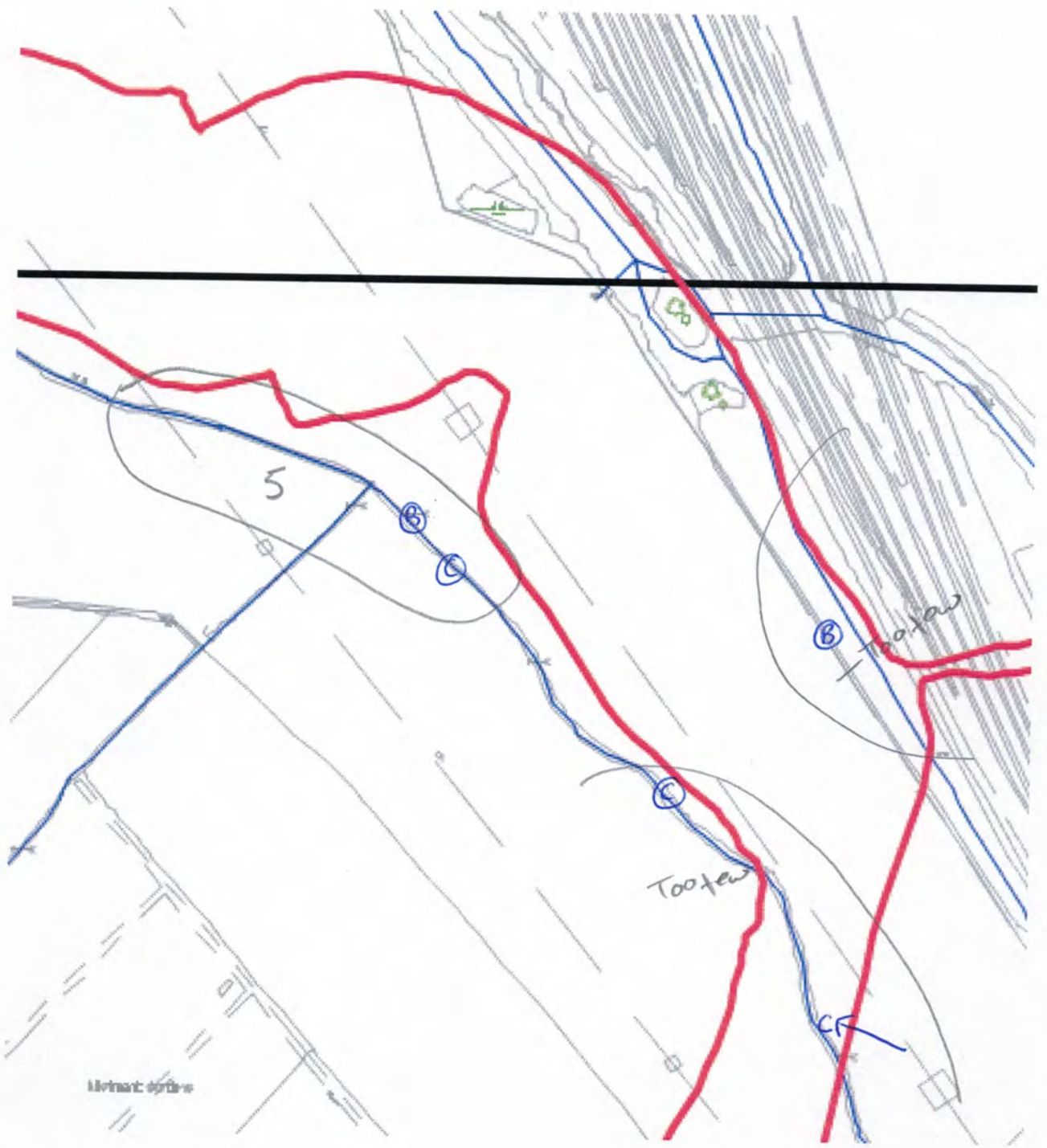

TRANSECT 5 MAP 2 OF 2
DUNNOCK SPECIES MAP

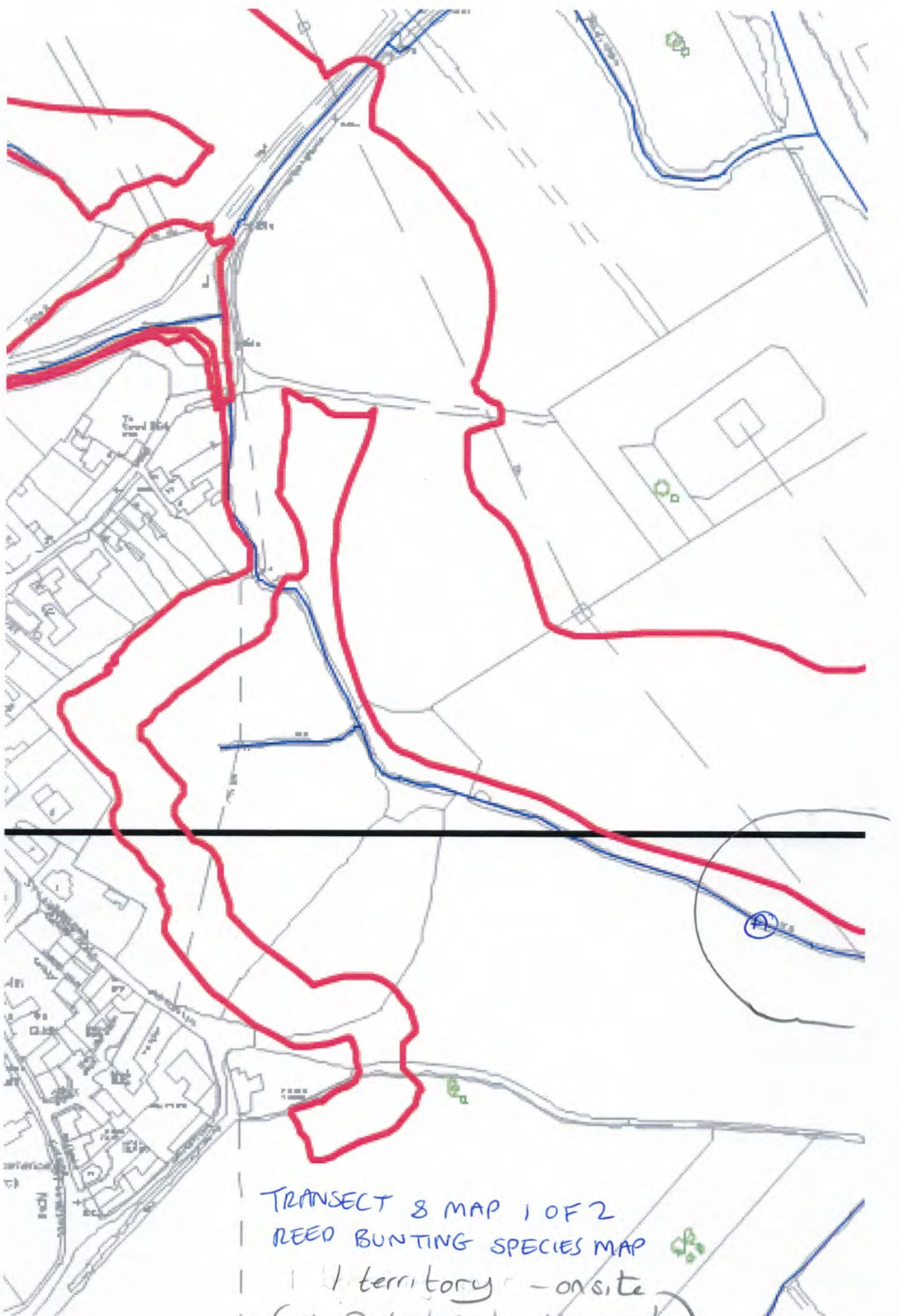

TRANSECT 8 MAP 1 OF 2
REED BUNTING SPECIES MAP
| | territory - on site
(of 2 clusters, 1 just off site)

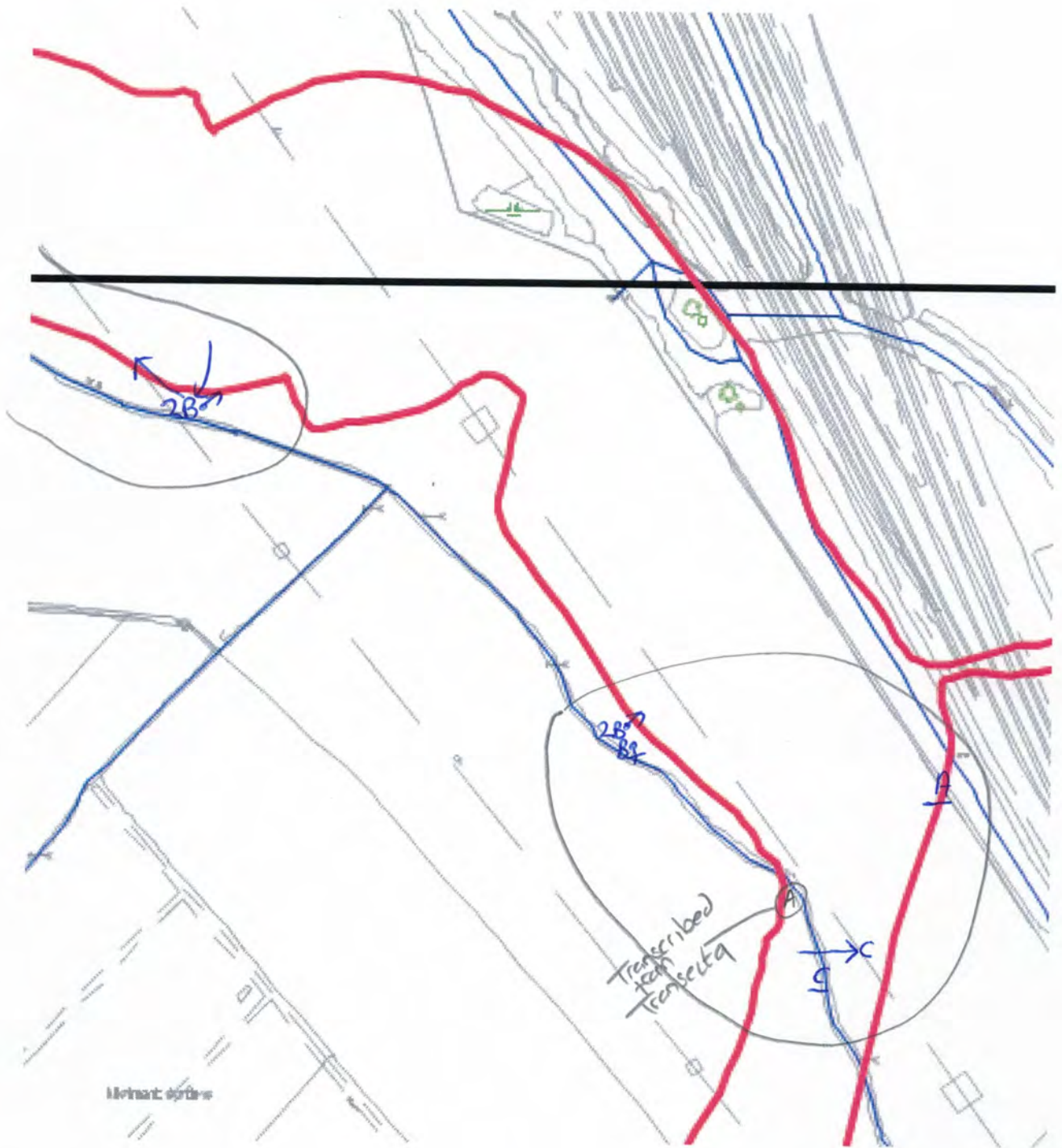

TRANSECT 8 MAP 2 OF 2
REED BUNTING SPECIES MAP

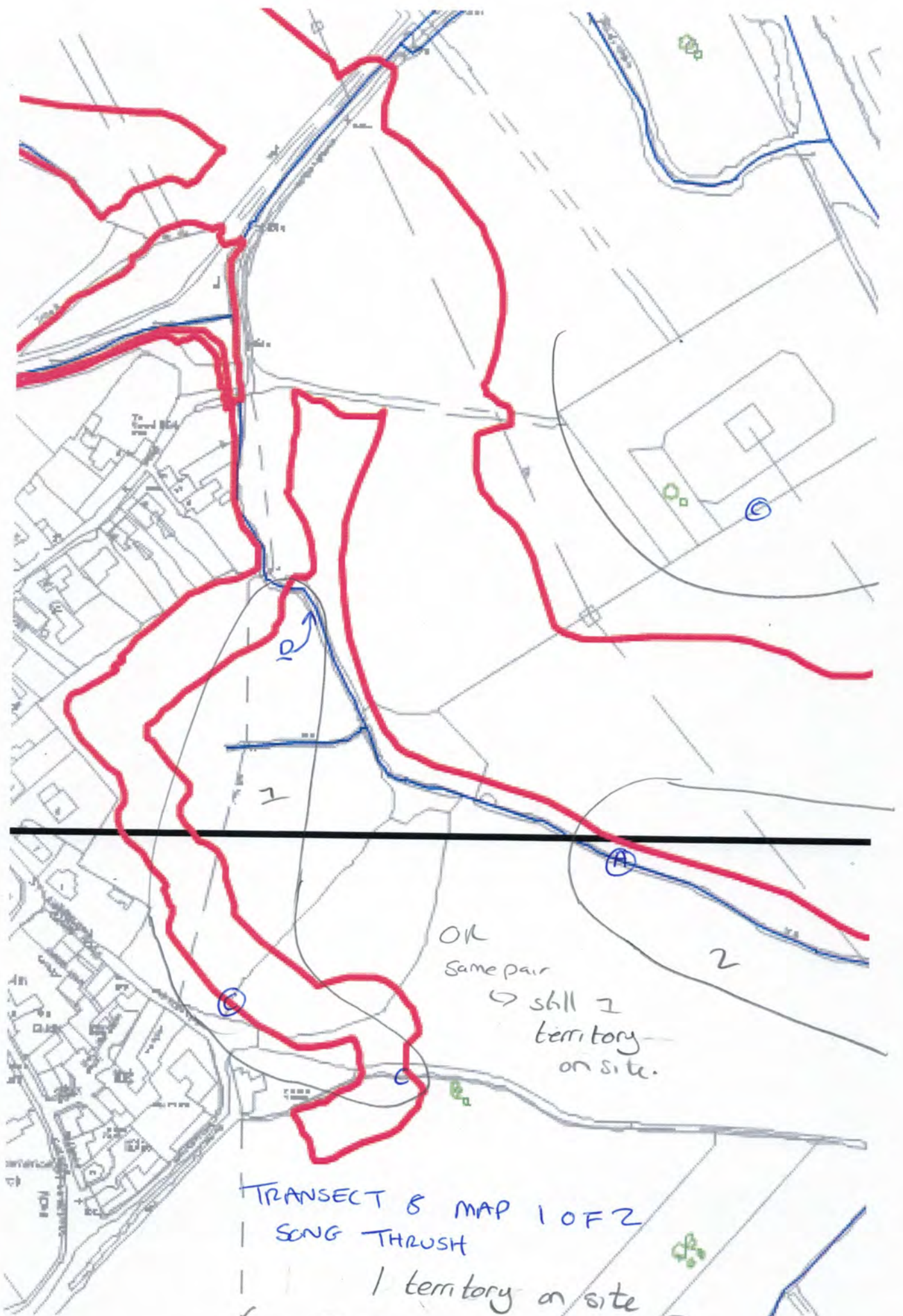

OK
 same pair
 ↳ still 1
 territory
 on site.

TRANSECT 8 MAP 1 OF 2
 | SONG THRUSH
 | 1 territory on site
 (of 2 clusters, 1 just off site)

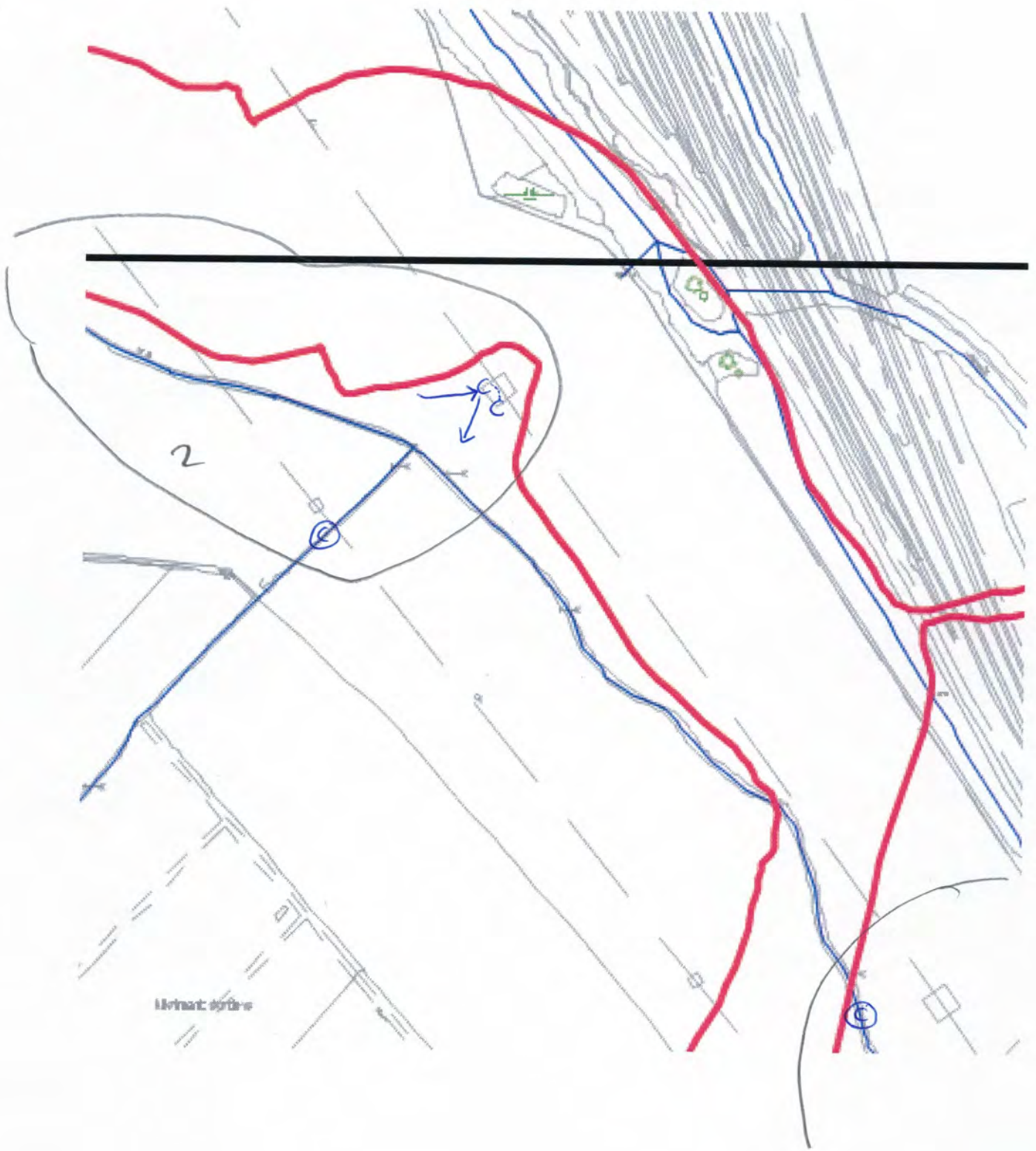

TRANSECT 8 MAP 2 OF 2
SONG THROUGH



TRANSECT a
BULLFINCH SPECIES MAP

1 territory



TRANSECT 9
DUNNOCK SPECIES MAP

1 territory



TRANSECT 9
SONG THRUSH SPECIES MAP

1) territory

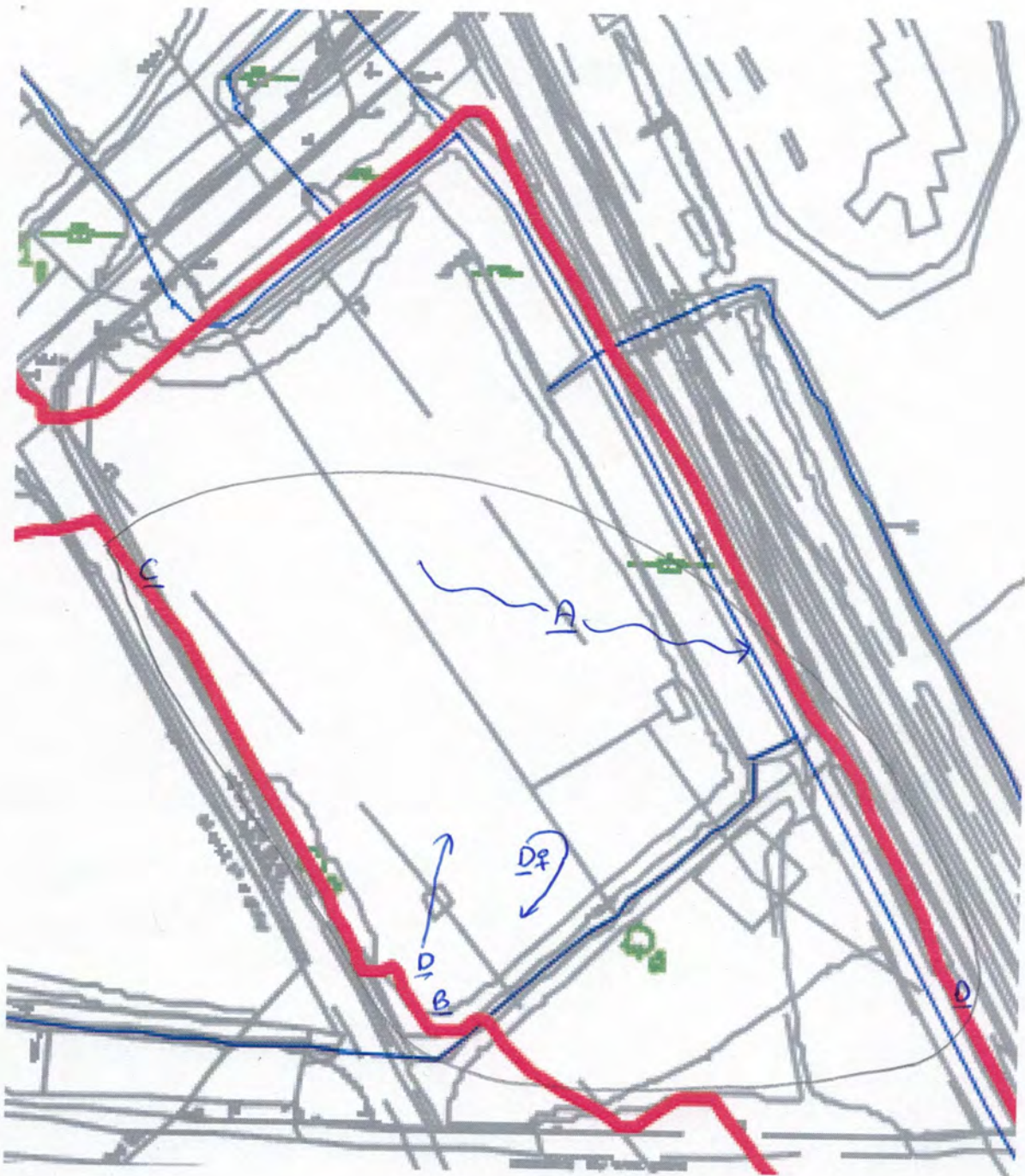

TRANSECT 10
BULLFINCH SPECIES MAP

1 territory

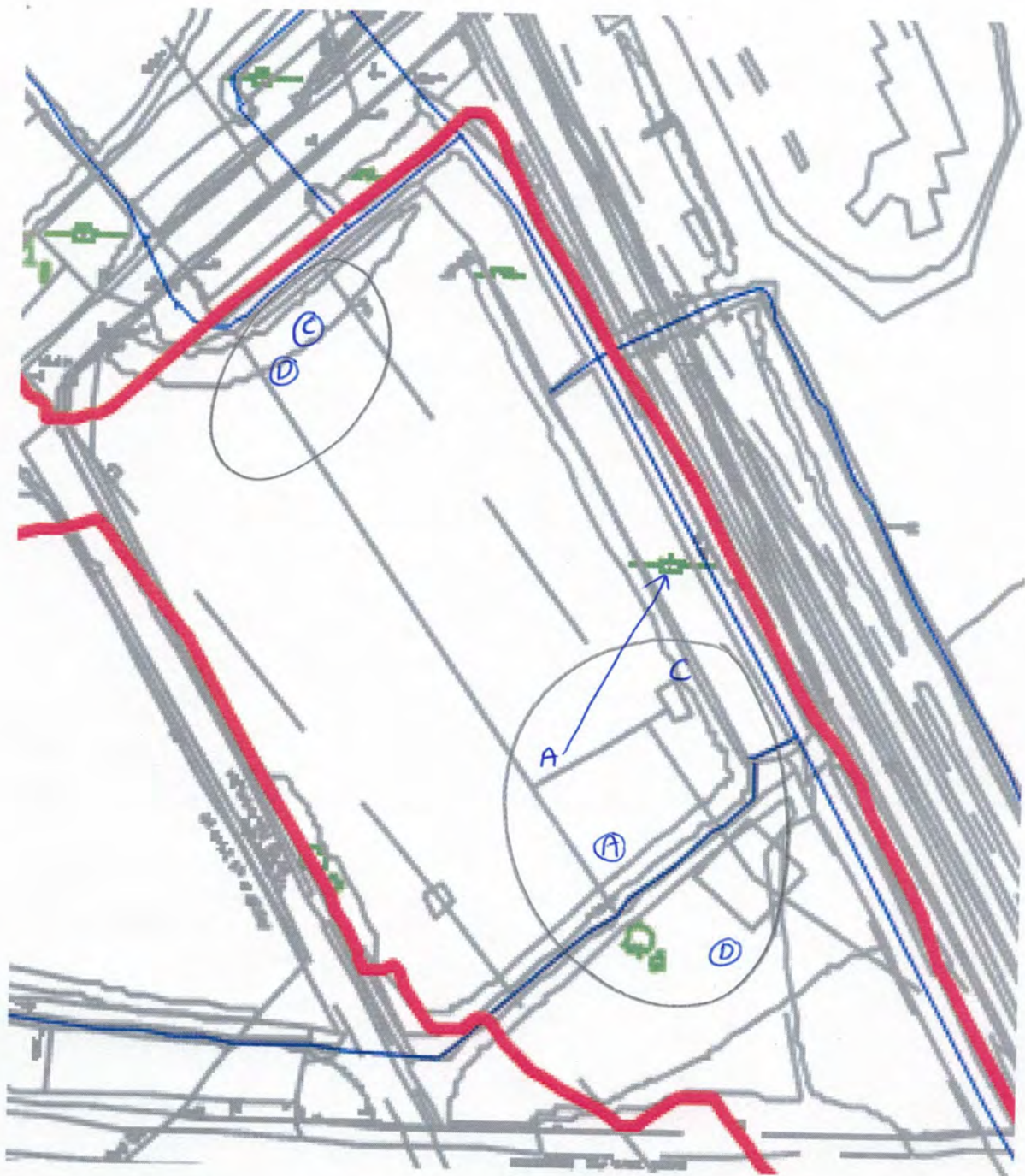

TRANSECT 10
DUNNOCK SPECIES MAP

2 territories

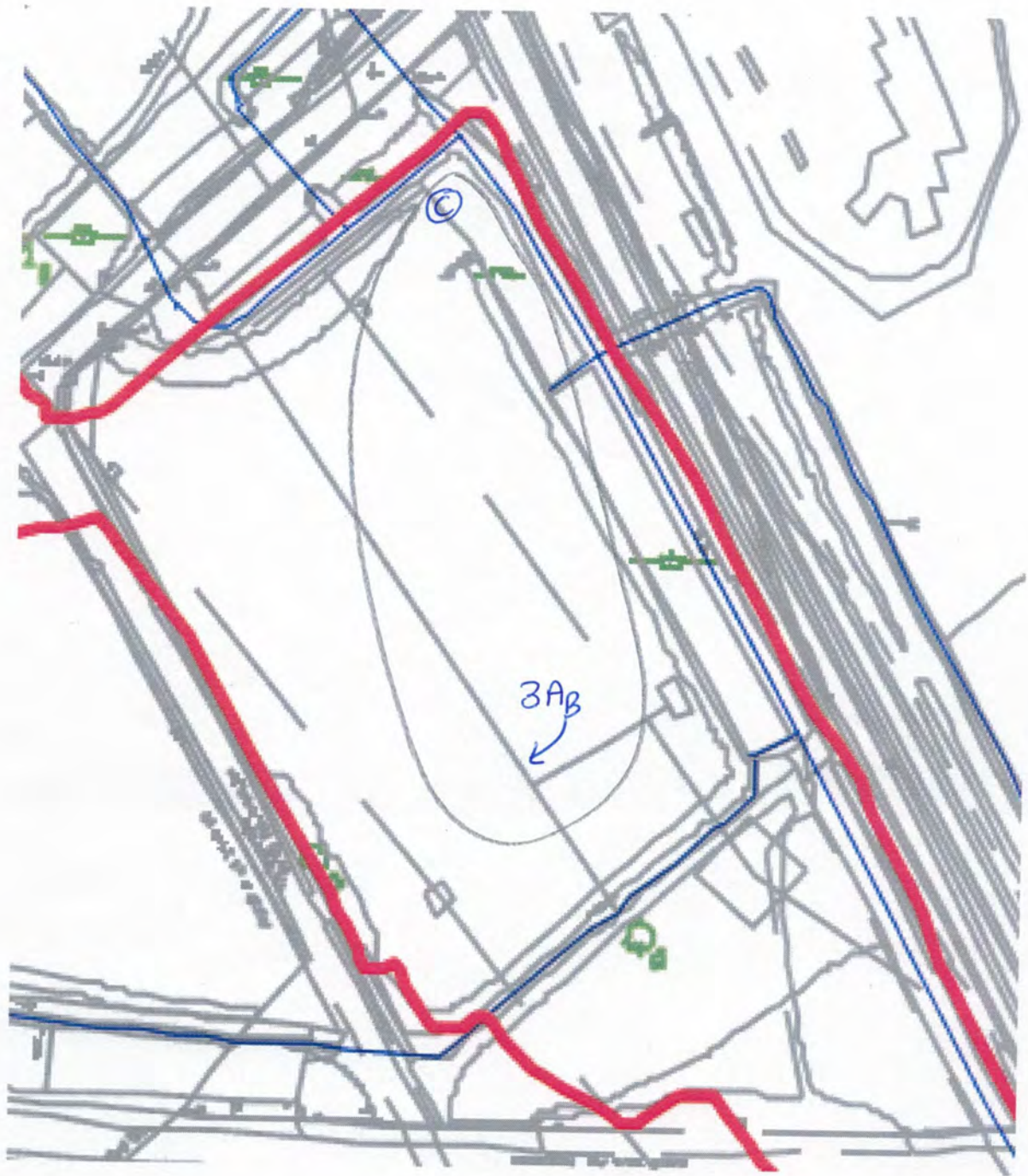

TRANSECT 10
SONG THRUSH SPECIES MAP

1 territory

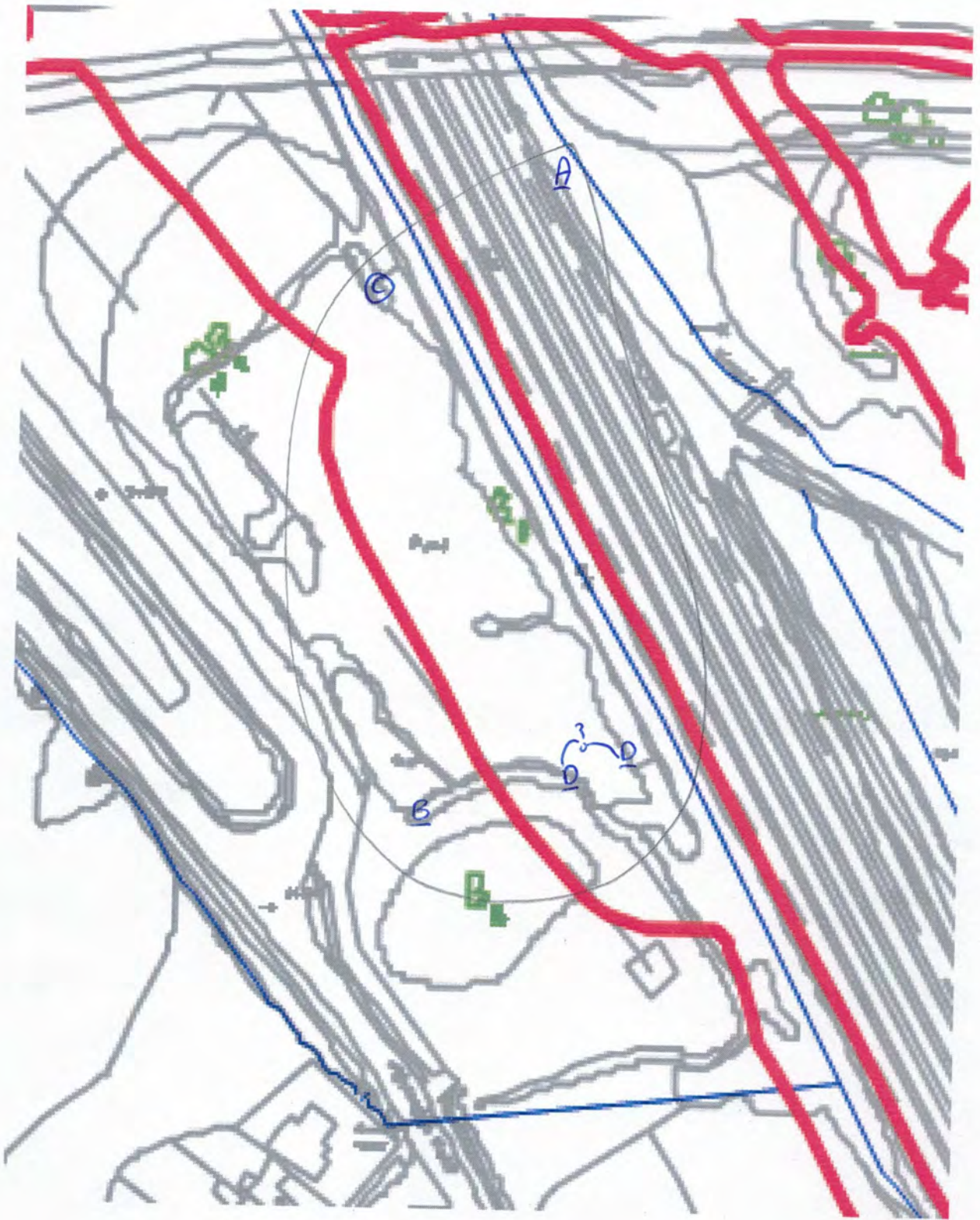

TRANSECT II
BULLFINCH SPECIES MAP

1 territory

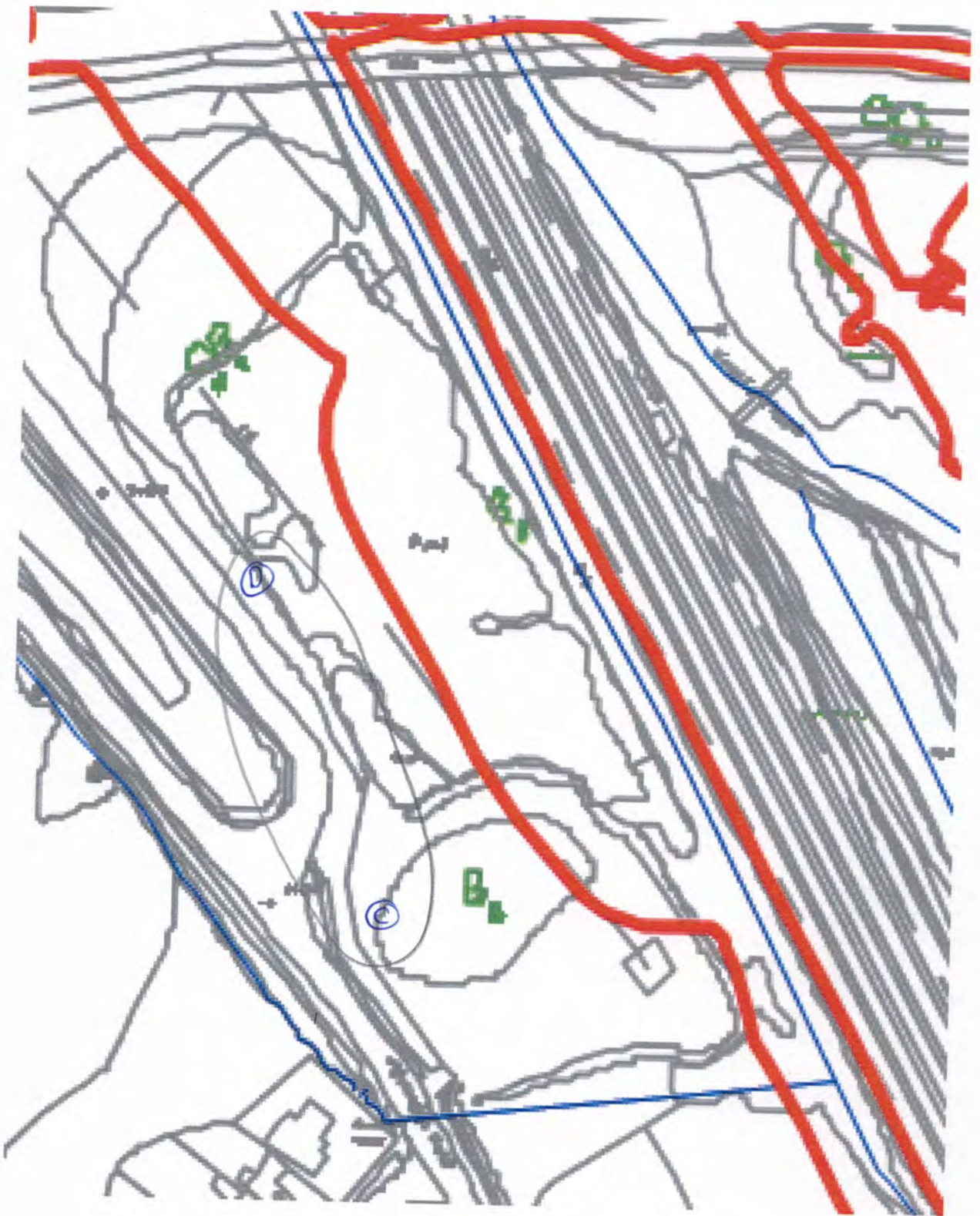

TRANSECT II
SONG THRUSH SPECIES MAP

1 territory



TRANSECT 12 MAP 1 OF 2
DUNNOCK SPECIES MAP

1 territory



TRANSECT 12 MAP 2 OF 2
DUNNOCK SPECIES MAP

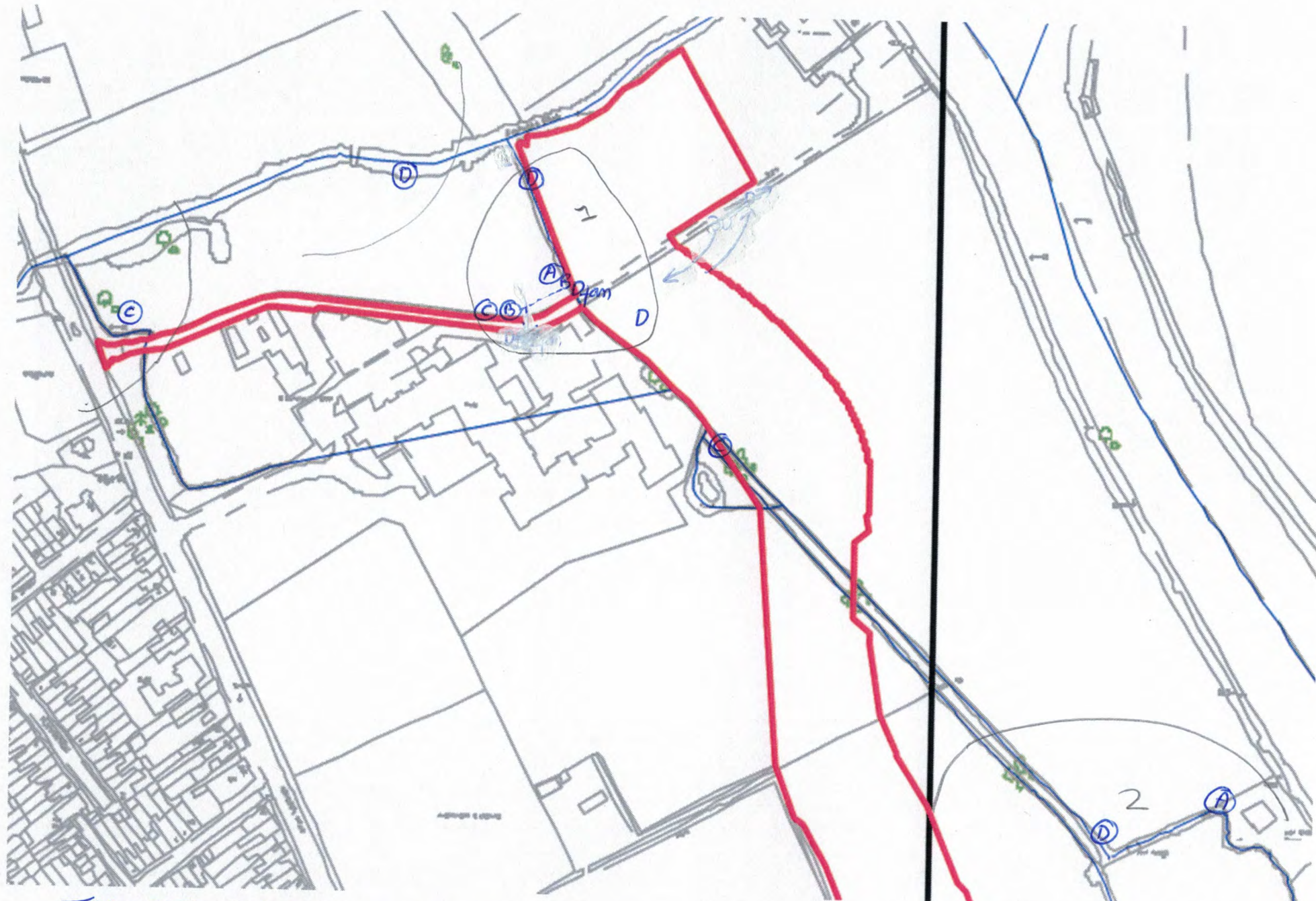

TRANSECT 13 MAP 1 OF 2

DUNNOCK SPECIES MAP

1 territory on site (of 3 clusters, 2 off site)

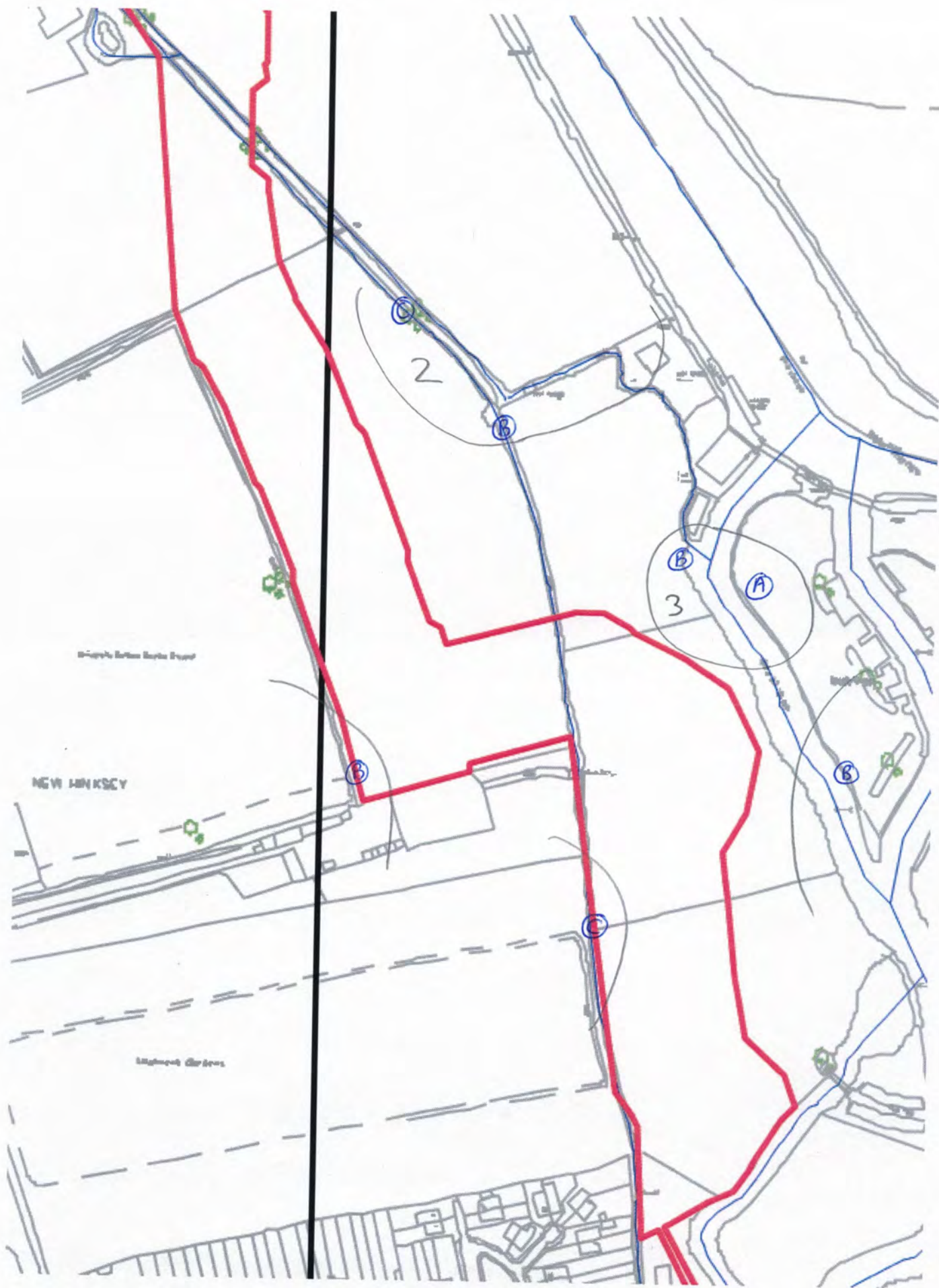

TRANSECT 13 MAP 2 OF 2
DUNNOCK SPECIES MAP

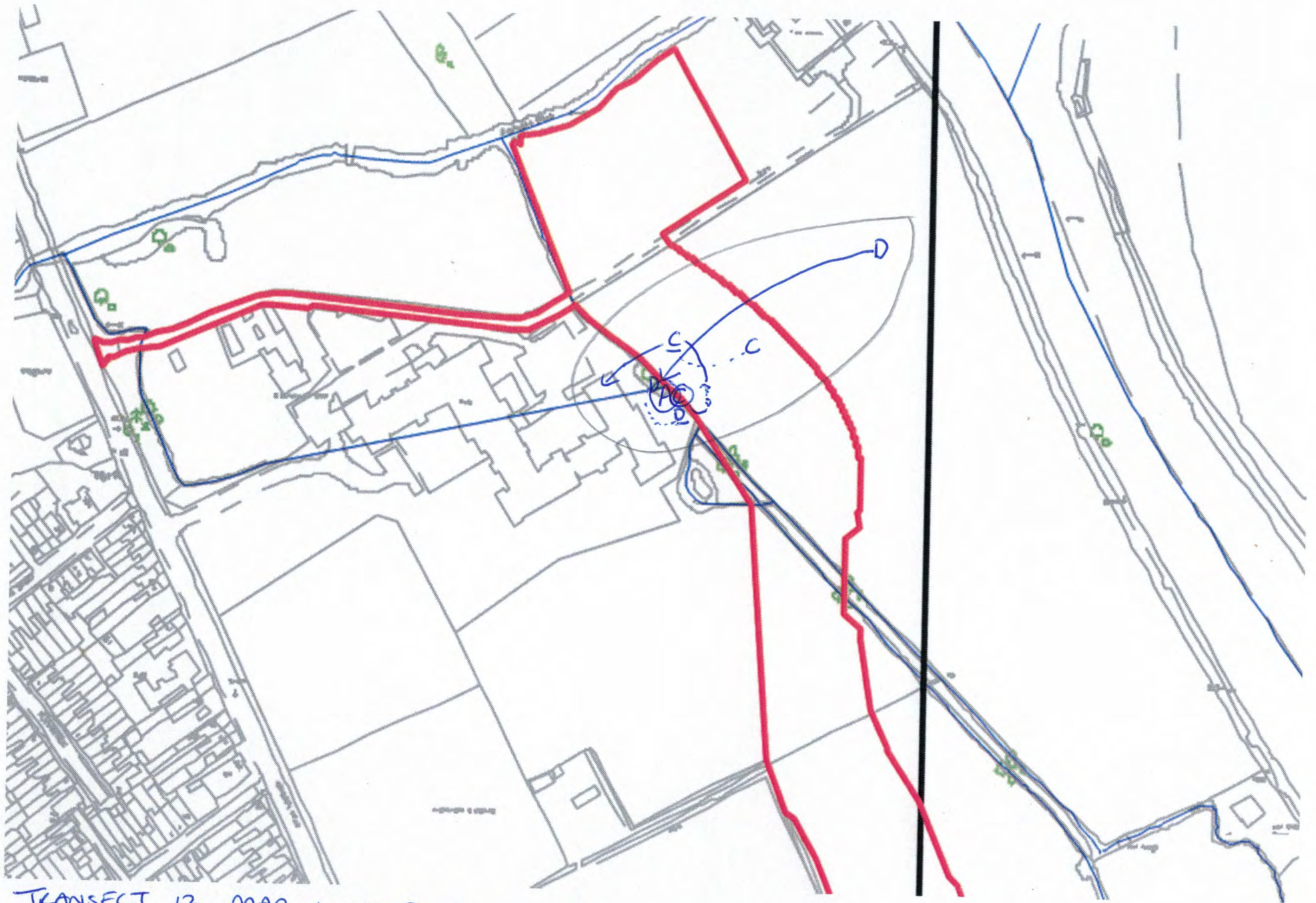

TRANSECT 13 MAP 1 OF 2 MISTLE THRUSH SPECIES MAP

1 territory

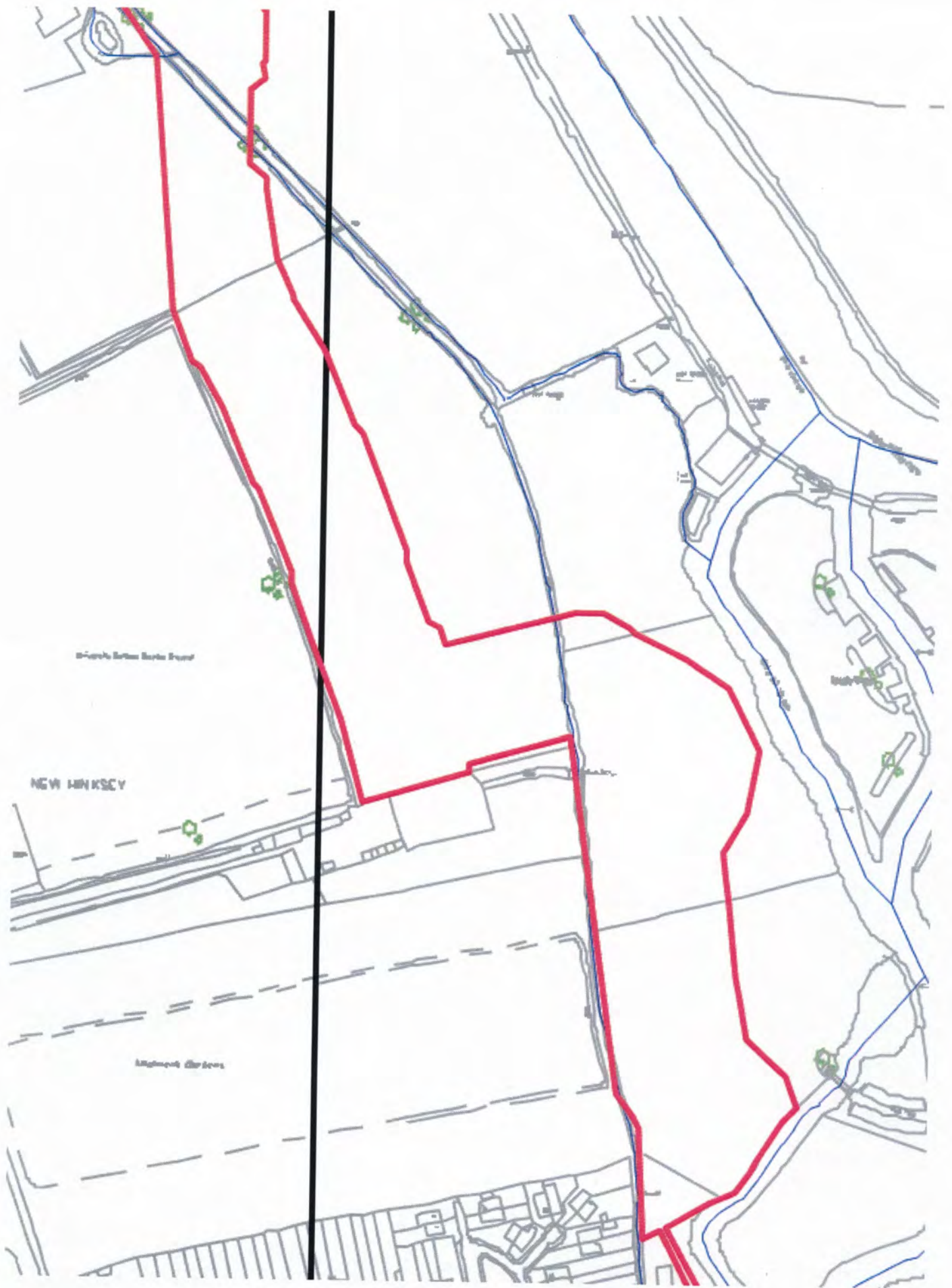

TRANSECT 13 MAP 2 OF 2 MISTLE THRUSH SPECIES MAP

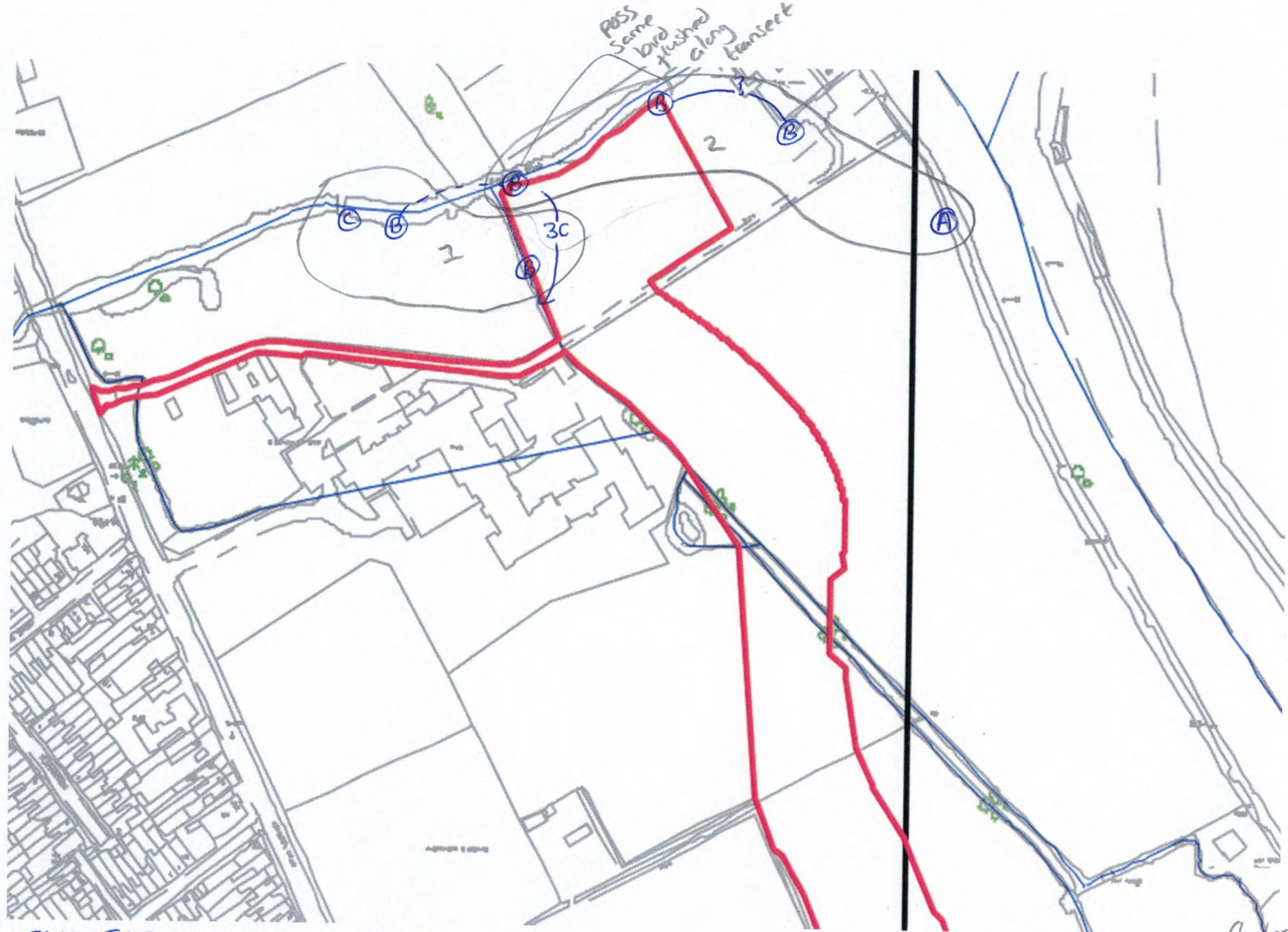

TRANSECT 13 MAP 1 OF 2 SONG THRUSH SPECIES MAP

1 bird territory on site (at 4 clusters, inc 3 offsite)
 Cluster 1 or 2!

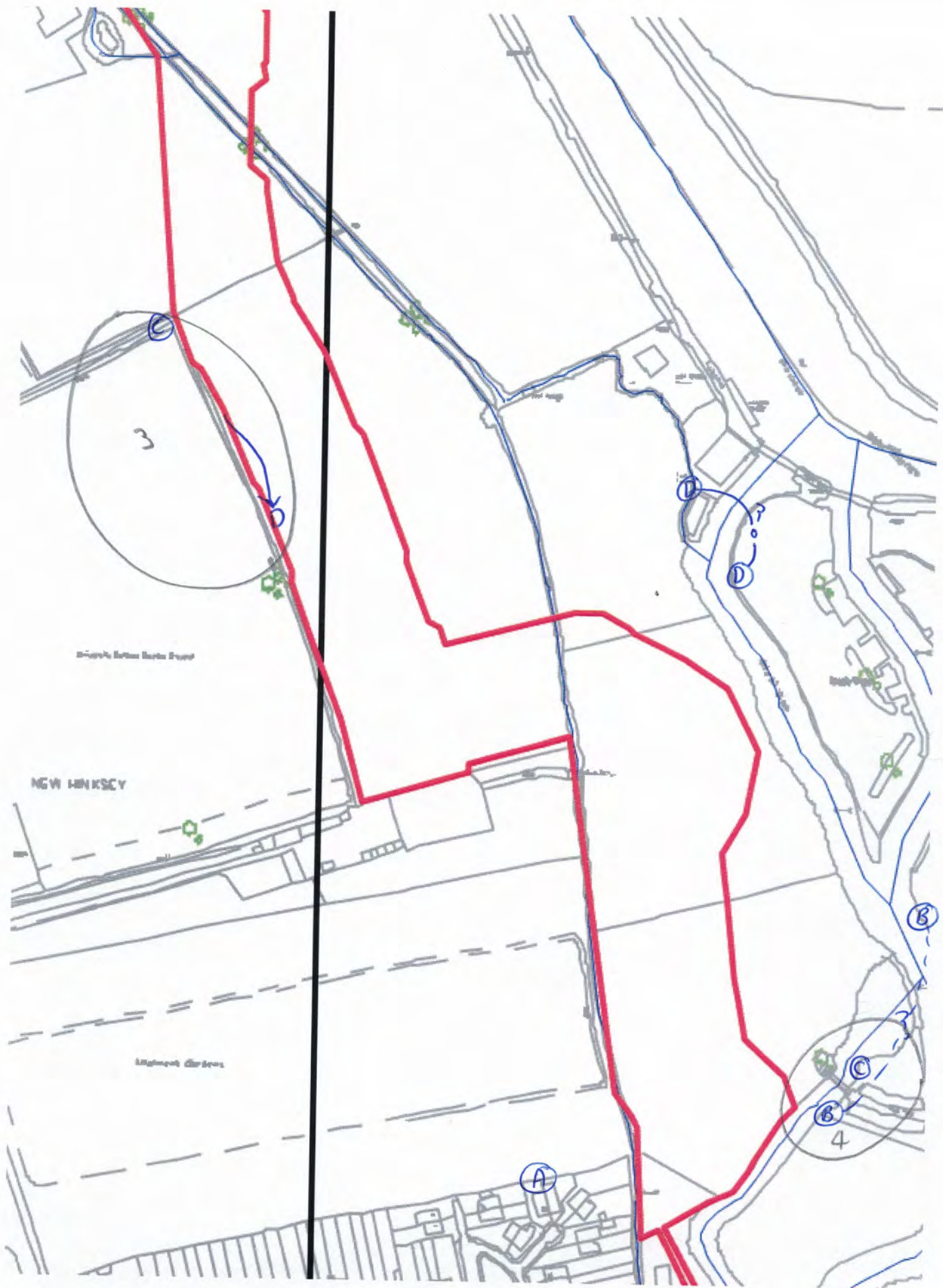

TRANSECT 13 MAP 2 OF 2
SONG THRUSH SPECIES MAP

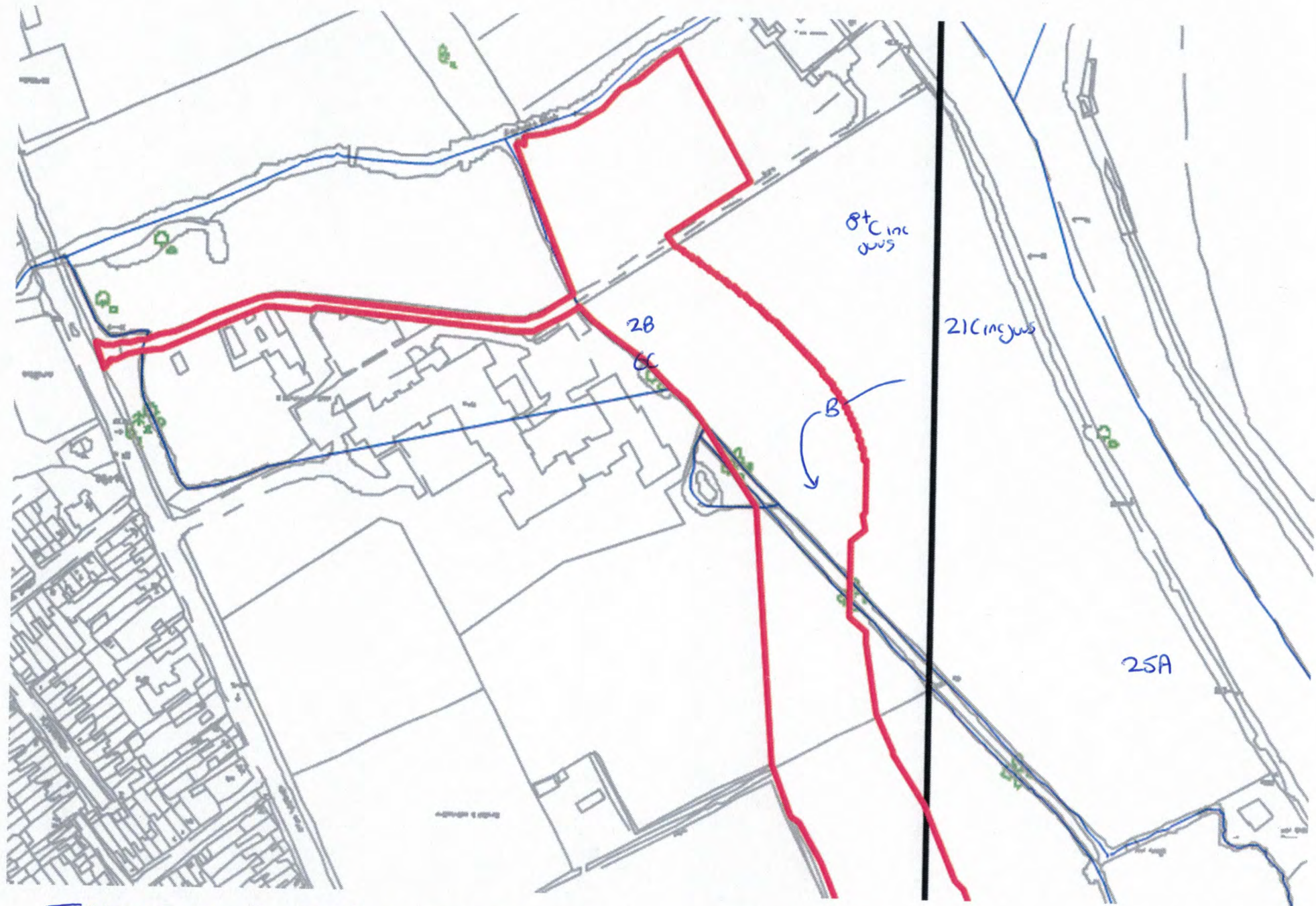

TRANSECT 13 MAP 1 OF 2 STARLING SPECIES MAP

Local/territory onsite
(fields are a common feeding area)

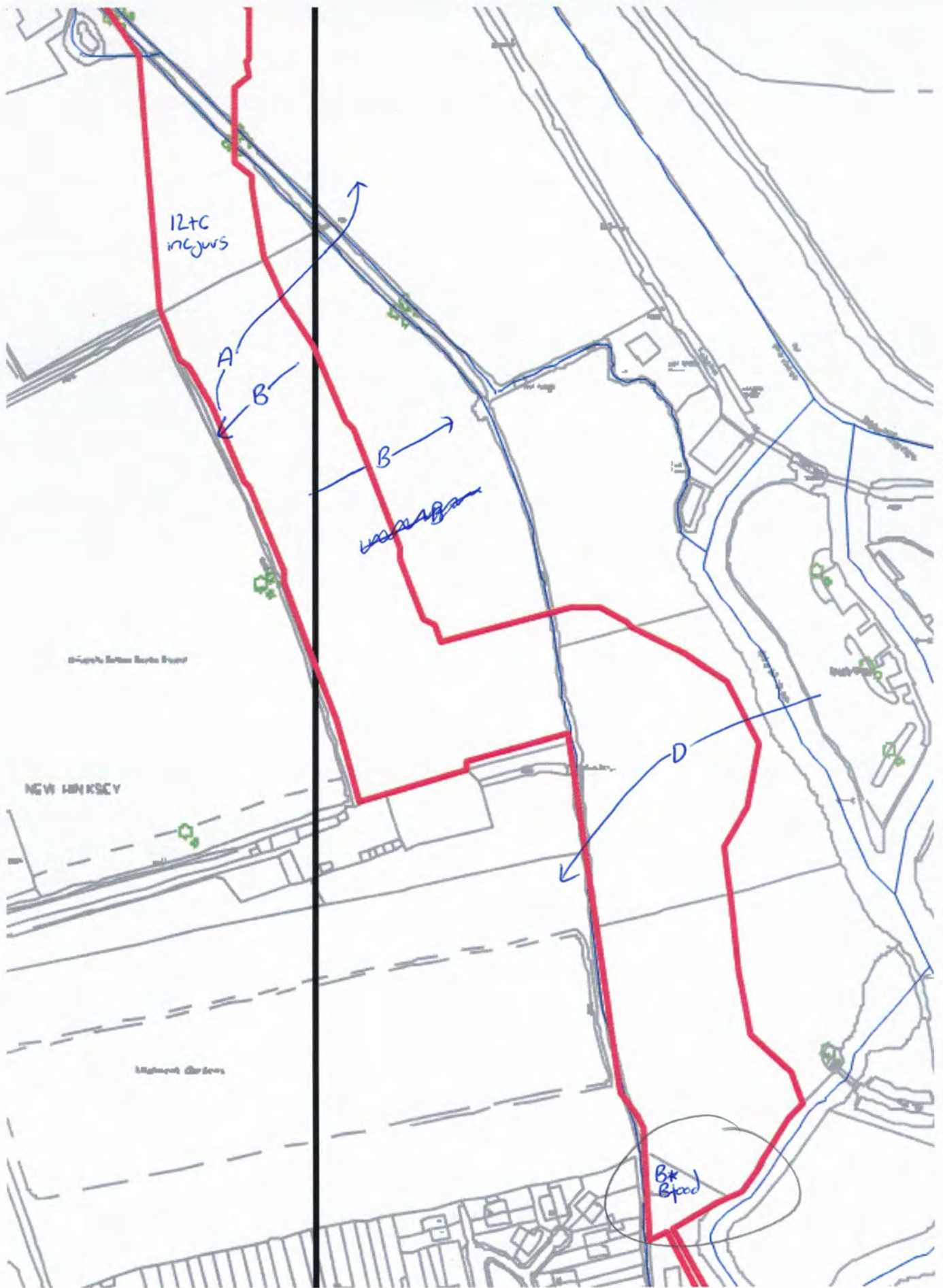

TRANSECT 13 MAP 2 OF 2
STARLING SPECIES MAP

TRANSECT 14
DUNNOCK SPECIES MAP

3 territories - 2 territories
3rd territory is inc.
on Transect 15

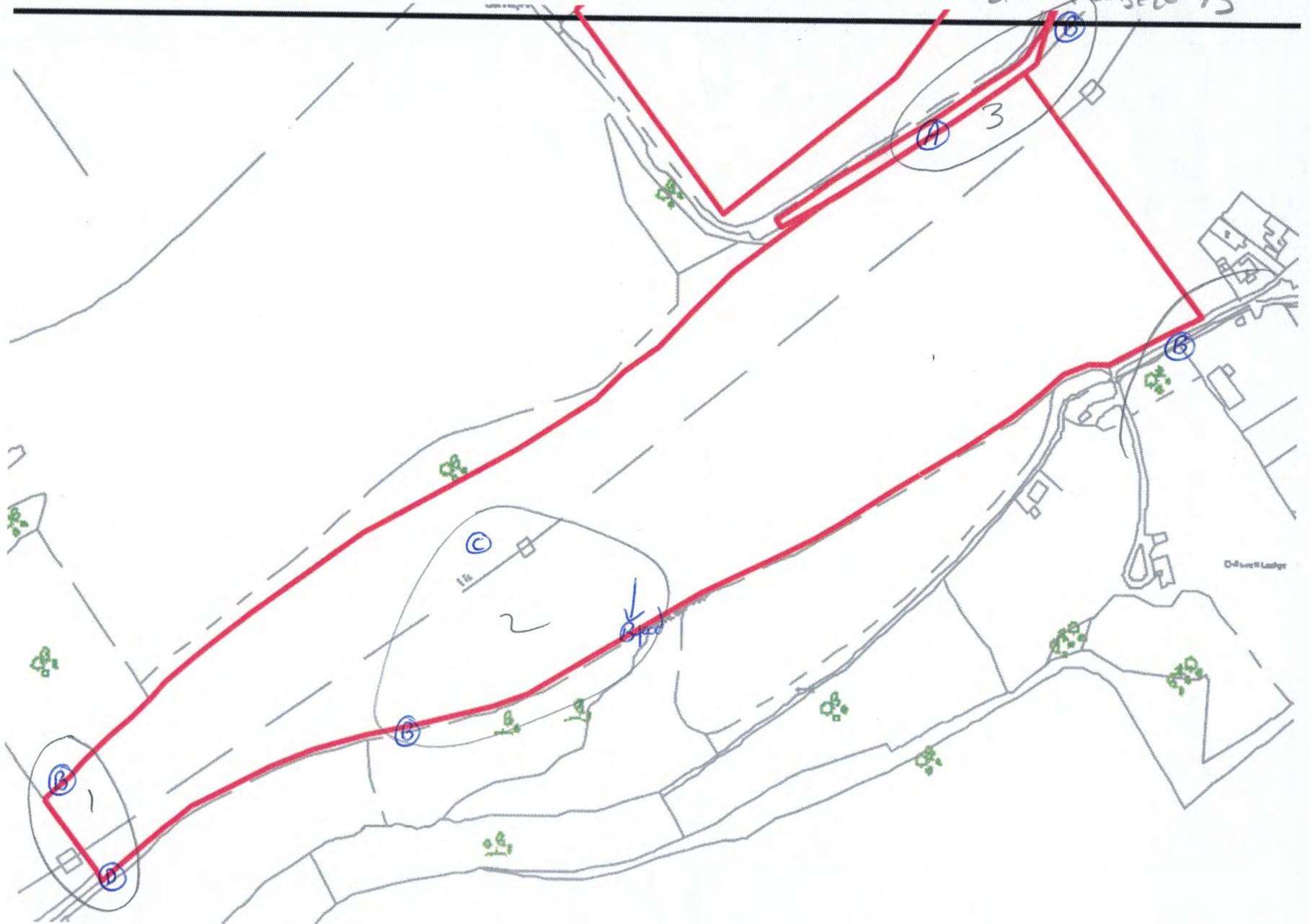

TRANSECT 14
LINNET SPECIES MAP

Semi-colonial

max 5 birds @ same time on visit C
max 3 birds @ same time on visit D

unsexed, so half of 5
is 3 males (in favour
of males)

3 breeding pairs - but prob offsite if the
hedgerows arent included onsite

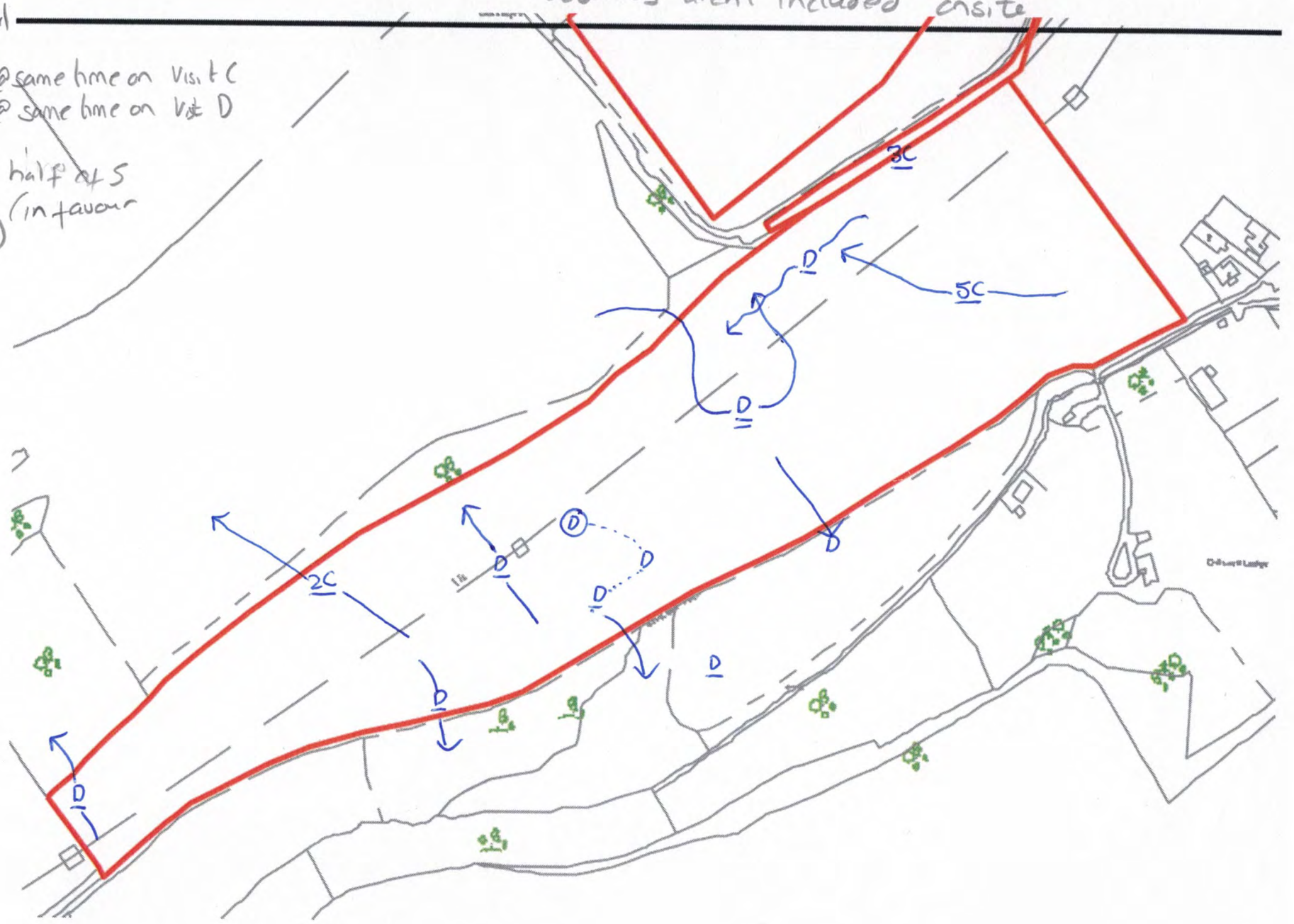

TRANSECT 14
REED BUNTING SPECIES MAP

1 territory - prob offsite
but pass on site in crop

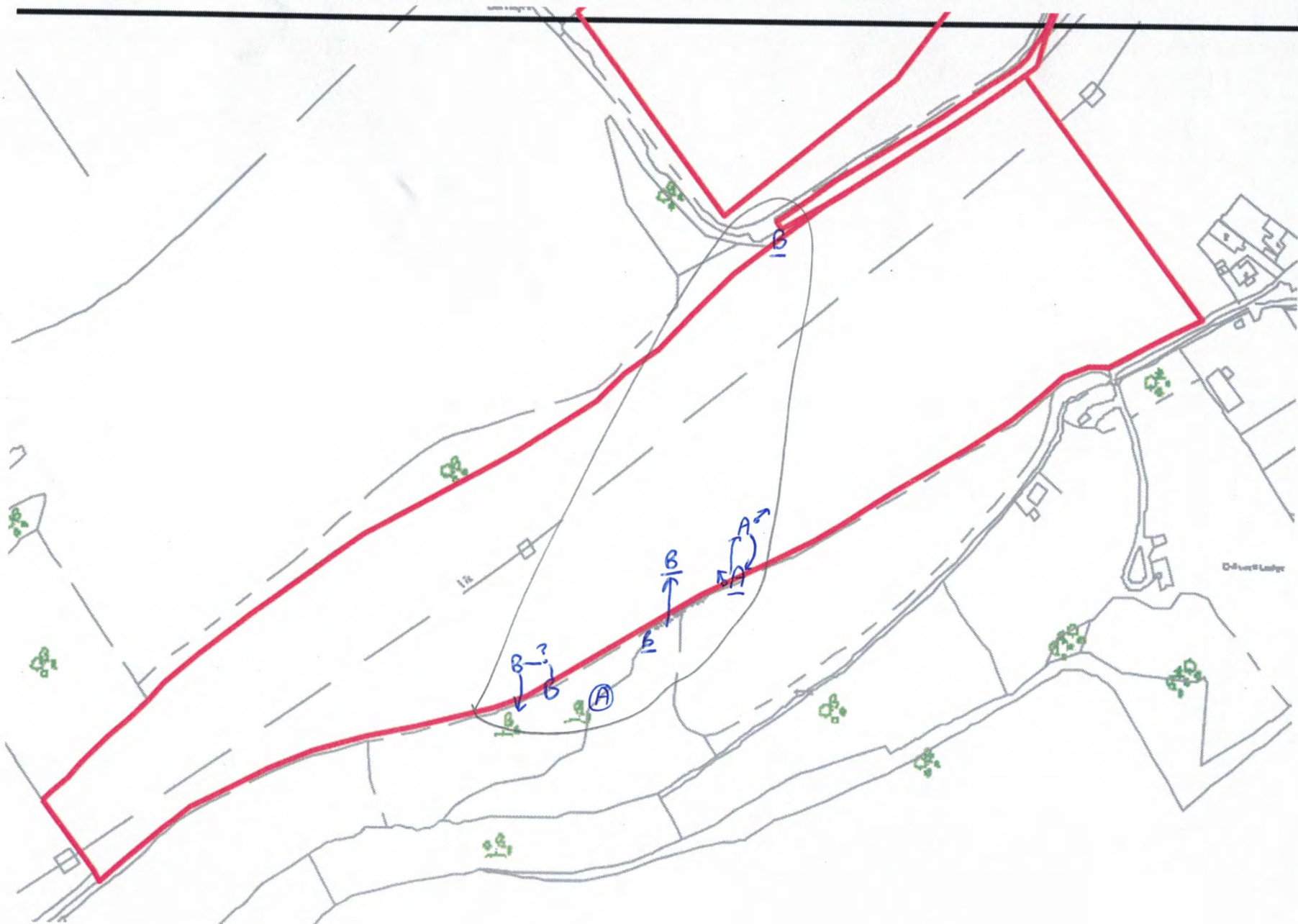

TRANSECT 14
SONG THRUSH SPECIES MAP

! bird territory but prob
just offsite.

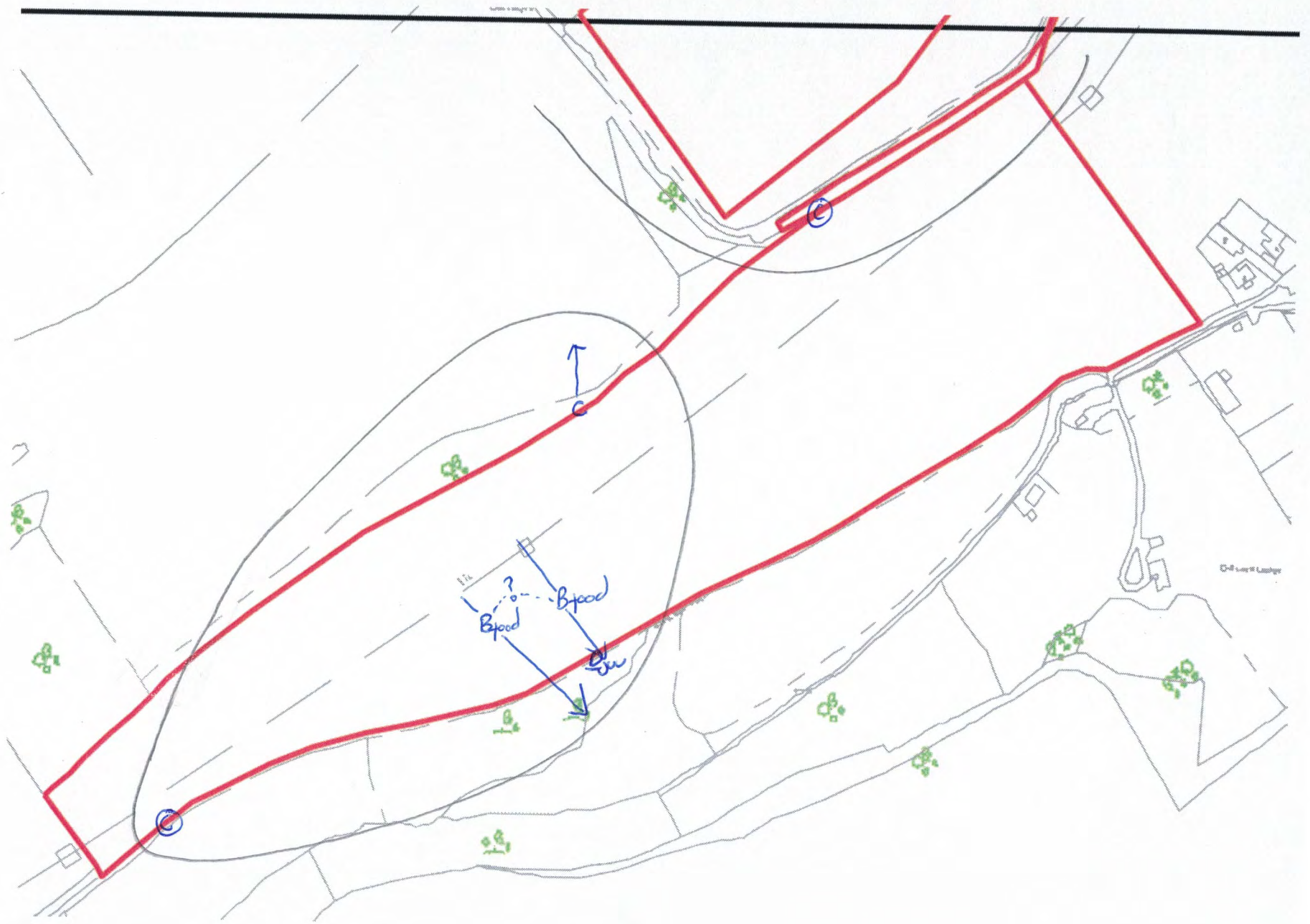

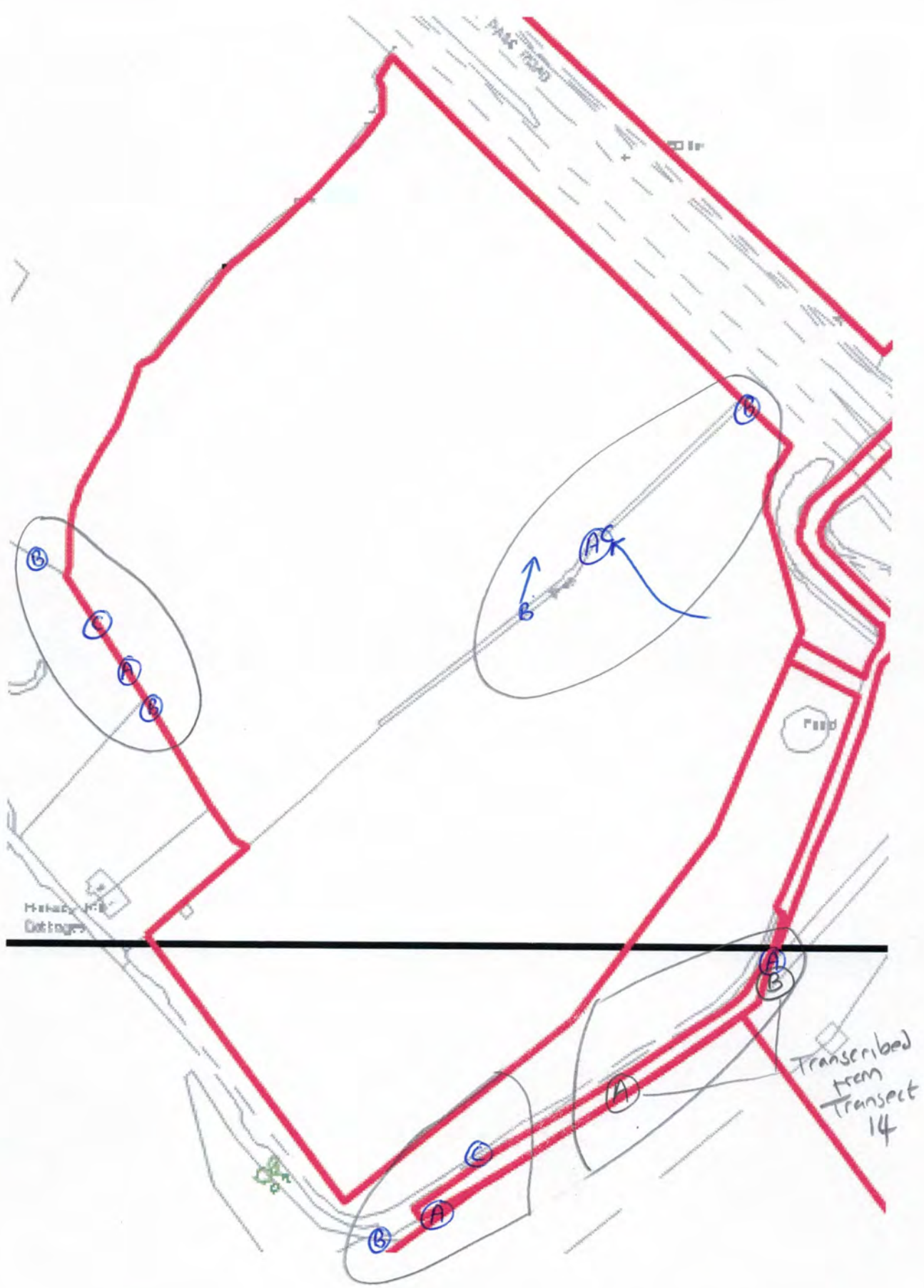

TRANSECT 15
DUNNOCK SPECIES MAP

4 territories

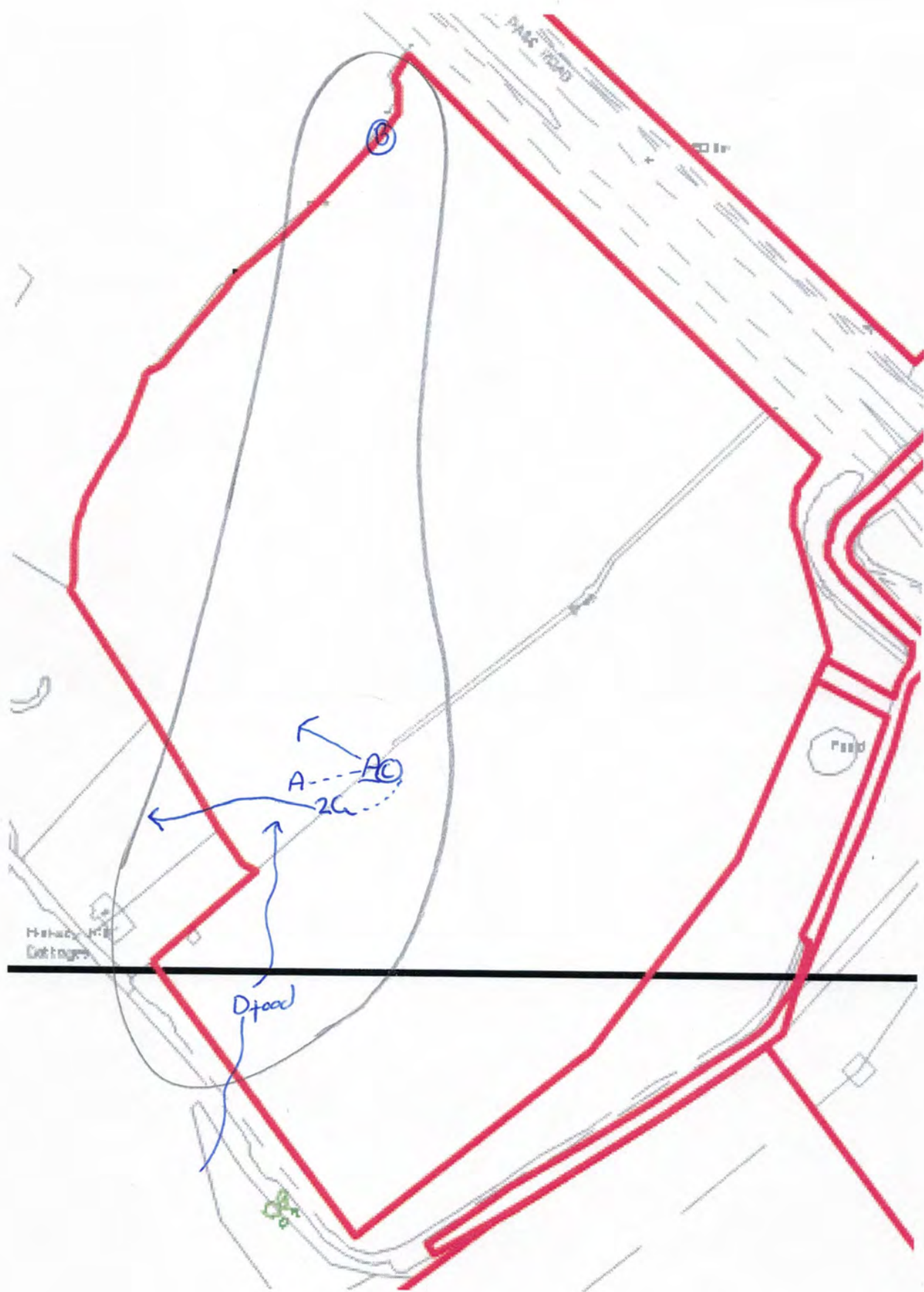

1 territory pair

TRANSECT 15
 SONG THRUSH SPECIES MAP