

This map is reproduced from Ordnance Survey material by Halton on behalf of ENVIRONMENT AGENCY with the permission of the Controller of Her Majesty's Stationery Office © Crown copyright. Unauthorised reproduction infringes Crown copyright and may lead to prosecution or civil proceedings. Licence Number: 100026380

PLAN
SCALE 1:2000 AT A1, 1:4000 AT A3

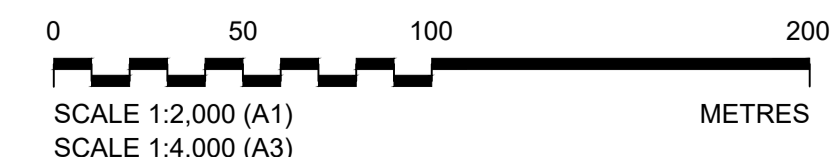

Key Plan:

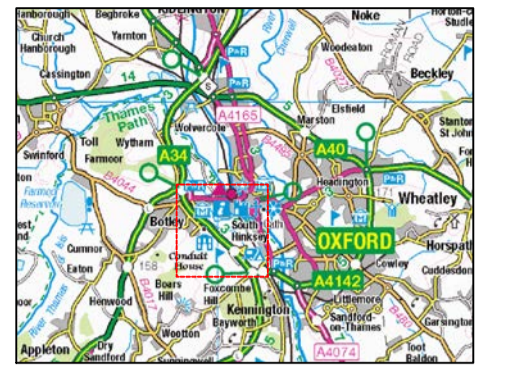

General notes:

- All dimensions are in millimetres unless otherwise stated. All levels are in metres above Ordnance Datum (mAOD) Newlyn.
- Do not scale from this drawing.

Notes:

- This drawing is to be read in conjunction with drawing IMSE500177-CH2-ZZ-A4-DR-C-4001.
- Services information is not shown on this drawing for clarity. Refer to drawing IMSE500177-CH2-00-00-VS-UT-0036 for the location of services.
- The Contractor may only remove the trees/vegetation that are herewith shown/labelled to be removed. Should additional trees/vegetation be required to be removed, the Contractor is to seek advance approval from the Environmental Clerk of Works prior to removal.

Legend:

- Proposed haul routes / working areas
- Proposed temporary crossings (Not to scale)
- Proposed compound areas and temporary material storage areas
- Proposed emergency access route
- Existing Watercourses
- New / Modified First-Stage Channel
- New Second-Stage Channel
- New Maintenance track
- Exchange land area
- Wetland Features (Scrapes, Backwaters)
- Existing trees to be retained
- Existing trees to be felled
- Root protection area
- Main access location for construction
- Main exit location for construction
- Provisional access and exit location for temporary work. Also access for emergency vehicles

S2-FIT FOR INFORMATION

| Rev | By | Chkd | Apprvd | Date | Description |
|-----|----|------|--------|----------|---------------------------|
| P01 | MM | MBA | PJM | 19/11/21 | PLANNING APPLICATION 2021 |



Project
WEM LOT 3 - OXFORD FLOOD ALLEVIATION SCHEME DETAILED DESIGN 684232

Drawing
AREA 4 SOUTH LOCATION FOR CONSTRUCTION ACCESS AND TEMPORARY STORAGE AREAS

Drawn by: V.HERNANDEZ JARA Date: 15/05/18
Checked by: Z.OMAR Date: 15/05/18
Approved by: P.MARSH Date: 17/05/18

| Drawing No. | Revision |
|----------------------------------|----------|
| IMSE500177-CH2-B00-A4-DR-PL-4011 | P01 |

Document Suitability: S2

Drawing File Path: C:\wms\wms\lot3\area4\planning\2021\IMSE500177-CH2-B00-A4-DR-PL-4011.dwg Layout: Layout1 User: v.hernandez Date: 15/05/2018 10:34:59 AM Plot Style Table: c:\programdata\autocad2010\plots\acad.ctb

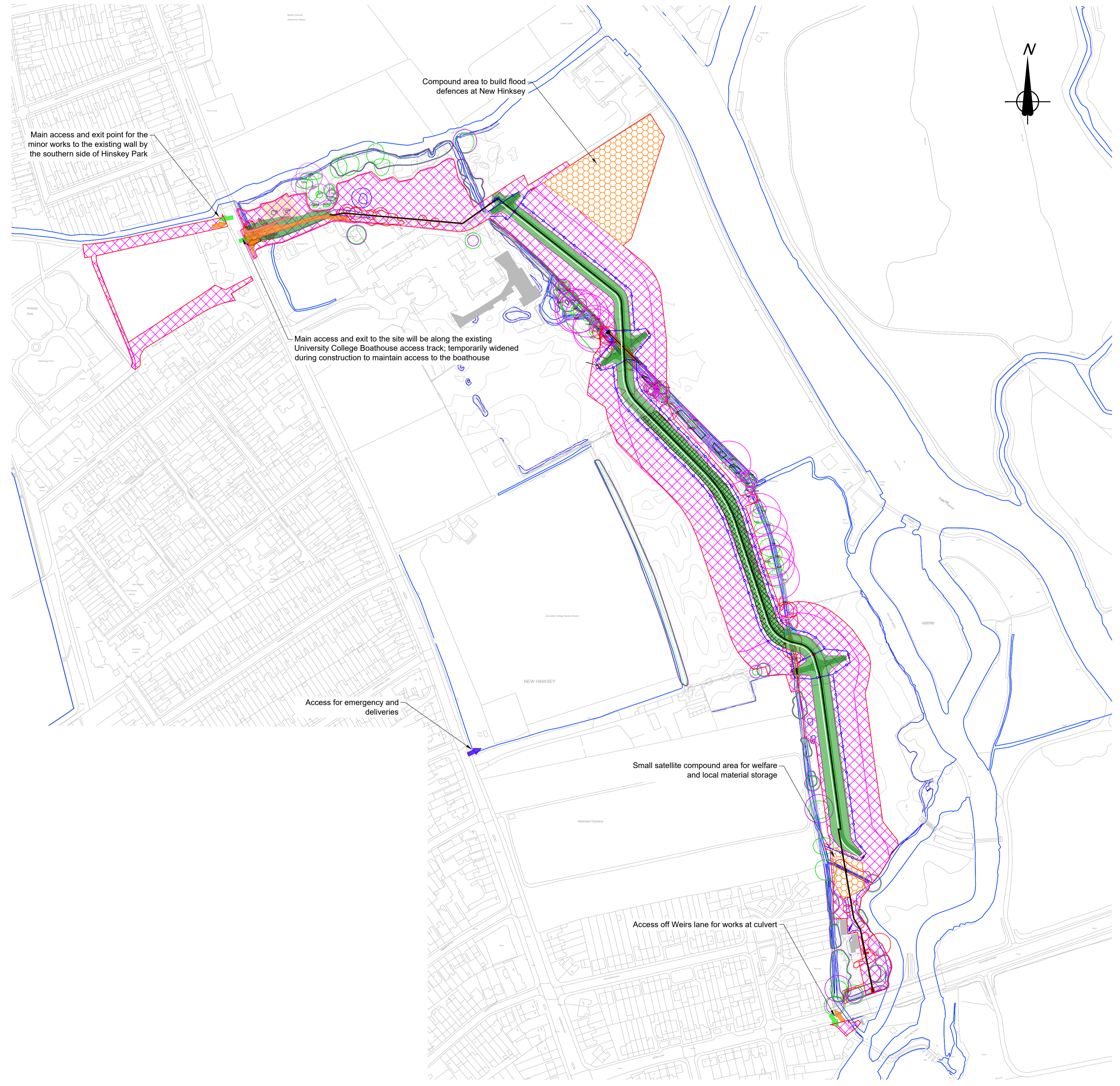

Key Plan:



General notes:

- All dimensions are in millimetres unless otherwise stated. All levels are in metres above Ordnance Datum (mAOD) Newlyn.
- Do not scale from this drawing.

Notes:

- This drawing is to be read in conjunction with drawing IMSE500177-CH2-ZZ-A4-DR-C-4005.
- Services information is not shown on this drawing for clarity. Refer to drawing IMSE500177-CH2-00-00-VS-UT-0036 for the location of services.
- The Contractor may only remove the trees/vegetation that are herewith shown/labelled to be removed. Should additional trees/vegetation be required to be removed, the Contractor is to seek advance approval from the Environmental Clerk of Works prior to removal.

Legend:

- Proposed haul routes / working areas
- Proposed temporary crossings (Not to scale)
- Proposed compound areas and temporary material storage areas
- Proposed emergency access route
- Existing Watercourses
- New / Modified First-Stage Channel
- New Second-Stage Channel
- New Maintenance track
- Exchange land area
- Wetland Features (Scrapes, Backwaters)
- Existing trees to be retained
- Existing trees to be felled
- Root protection area
- Main access location for construction
- Main exit location for construction
- Provisional access and exit location for temporary work. Also access for emergency vehicles

S2-FIT FOR INFORMATION

| Rev | By | Chkd | Apprvd | Date | Description |
|-----|----|------|--------|----------|---------------------------|
| P02 | KK | MBA | PJM | 13/12/21 | PLANNING APPLICATION 2021 |
| P01 | MM | MBA | PJM | 19/11/21 | PLANNING APPLICATION 2021 |



Project
WEM LOT 3 - OXFORD FLOOD ALLEVIATION SCHEME DETAILED DESIGN 684232

AREA 4 NORTH LOCATION FOR CONSTRUCTION ACCESS AND TEMPORARY STORAGE AREAS

Drawn by: V.HERNANDEZ JARA Date: 15/05/18
 Checked by: Z.OMAR Date: 15/05/18
 Approved by: P.MARSH Date: 17/05/18

| Drawing No. | Revision |
|----------------------------------|----------|
| IMSE500177-CH2-B00-A4-DR-PL-4015 | P02 |

Document Suitability: S2

PLAN
 SCALE 1:2000 AT A1, 1:4000 AT A3

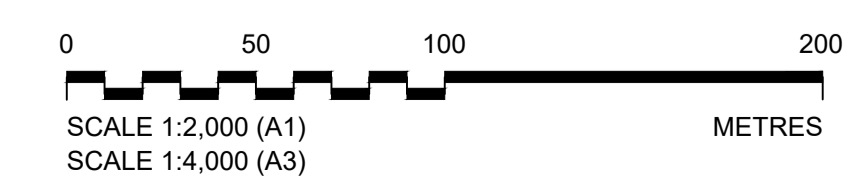

This map is reproduced from Ordnance Survey material by Halcrow on behalf of ENVIRONMENT AGENCY with the permission of the Controller of Her Majesty's Stationery Office. Crown copyright. Unauthorised reproduction infringes Crown copyright and may lead to prosecution or civil proceedings. Licence Number: 100026380

Drawing File Path: S:\Projects\2021\WEM Lot 3 - Oxford Flood Alleviation Scheme\Detailed Design\Area 4 North\Area 4 North Location for Construction Access and Temporary Storage Areas.dwg
 User: P.MARSH Date: 17/05/2018 11:02:42 AM

Phase 1

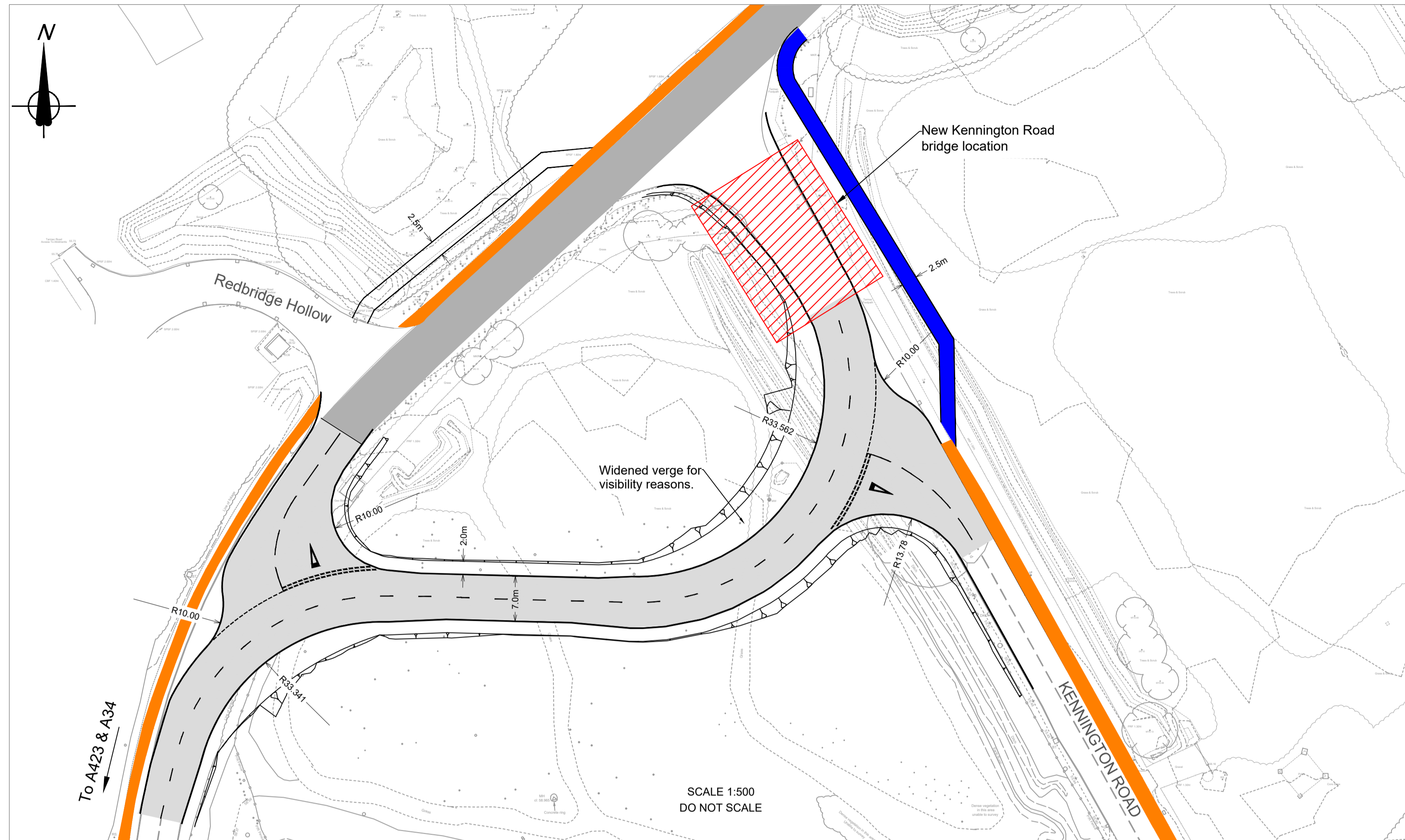

- Notes:**
- All dimensions are in metres unless otherwise stated. All levels are in metres above Ordnance Datum (mAOD).
 - A 20mph speed limit is to be put in place for the temporary diversion.
 - Phase 1 is when the bridge works take place on Kennington Road. Phase 2 is when bridge works take place at Old Abingdon Road bridge.
 - Statutory Undertakers (SU) plant are not shown on this drawing for clarity, refer to drawing number IMSE500177-CH2-BAR-A4D-DR-C-0003 for information. The contractor is to update and confirm all SU plant in the area and agree diversion and protection measures.
 - Refer to construction drawings for Safety, Health & Environmental information.

LEGEND

- Proposed carriageway
- Existing carriageway
- Existing footway
- Proposed temporary shared use footway/cycleway
- Bridge under construction
- Earthworks

DRAFT

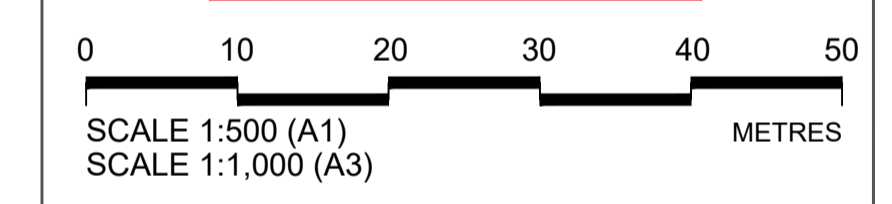

S2-FIT FOR INFORMATION

| Rev | By | Chkd | Apprvd | Date | Description |
|-----|----|------|--------|----------|-----------------|
| P02 | KW | RM | IC | 05/06/20 | For Information |
| P01 | RM | MH | IC | 05/03/20 | For Information |



Burderop Park
Swindon
SN4 0QD
Tel: +44 (0) 1793 812 479
Fax: +44 (0) 1793 812 089
www.ch2m.com

Project
WEM LOT 3 - OXFORD FLOOD ALLEVIATION
SCHEME DETAILED DESIGN
684232

Drawing
**Oxford OAR/KR
Temporary Diversion Route
General Arrangemen**
Sheet 1 of 1

| | |
|--|----------------|
| Drawn by: KW | Date: 05/03/20 |
| Checked by: RM | Date: 05/03/20 |
| Approved by: IC | Date: 05/03/20 |
| Drawing No. IMSE500177-CH2-BAR-A4D-DR-C-0001 | Revision P02 |

Document Suitability: S2

Phase 2

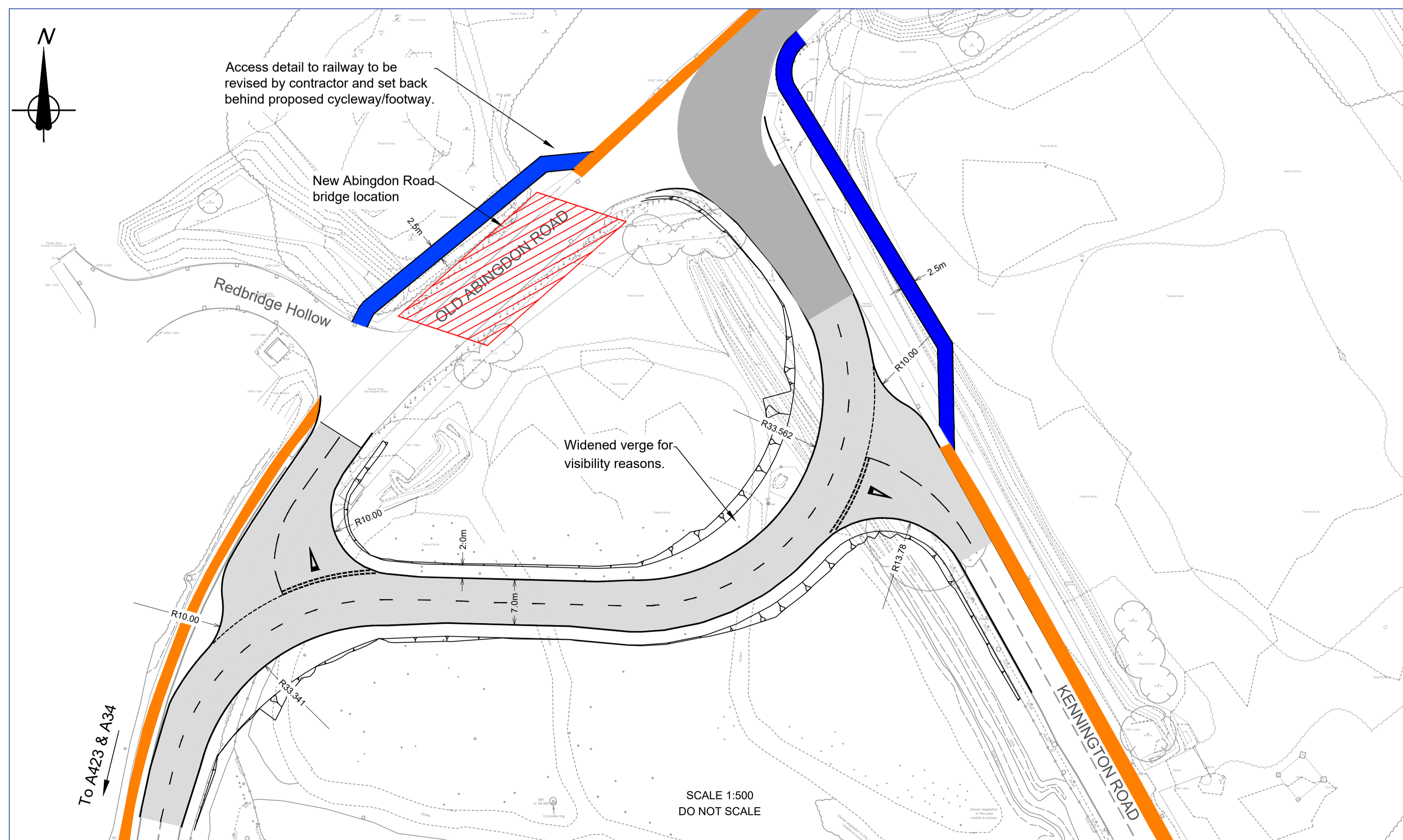

This map is reproduced from Ordnance Survey material by Halton on behalf of ENVIRONMENT AGENCY with the permission of the Controller of Her Majesty's Stationery Office. Crown copyright. Unauthorised reproduction infringes Crown copyright and may lead to prosecution or civil proceedings. Licence Number: 100026380

Drawing file path: C:\pwworking\ch2m\imse500177\ch2-bar-a4d-dr-c-0002.dwg; Layer: 1; User: J. Lupton; Date: 25/03/2020 23:11:16; Plot Date: 25/03/2020 23:11:16; Plot Style Table: C:\Program Files\Autodesk\AutoCAD 2010\Plot Styles\ch2m.ctb



Oxford Flood Alleviation Scheme
Kennington Road, Old Abingdon Road Carriageway Comparison

0

September 21st 2021

Environment Agency

ENVIMSE500177

Document history and status

| Revision | Date | Description | Author | Checked | Reviewed | Approved |
|----------|------------|--------------|--------|---------|----------|----------|
| 0 | 21-09-2021 | First issue | GAT | MH | PJM | PJM |
| 1 | 06-10-2021 | Second Issue | GAT | MH | HJD | HJD |
| | | | | | | |
| | | | | | | |
| | | | | | | |

Distribution of copies

| Revision | Issue approve | Date issued | Issued to | Comments |
|----------|---------------|-------------|-----------|----------|
| 0 | 23-09-21 | 24-09-21 | EA | |
| | | | | |
| | | | | |
| | | | | |
| | | | | |

Oxford Flood Alleviation Scheme

Project No: 684232CH
Document Title: Kennington Road, Old Abingdon Road Carriageway Comparison
Document No.: -
Revision: 0
Document Status: Final
Date: September 21st 2021
Client Name: Environment Agency
Client No: ENVIMSE500177
Project Manager: Phil Marsh
Author: Gethin Thomas
File Name: OAR KR Temp Carriageway Comparison Note

Jacobs U.K. Limited

NONE

www.jacobs.com

© Copyright 2021 Jacobs U.K. Limited. The concepts and information contained in this document are the property of Jacobs. Use or copying of this document in whole or in part without the written permission of Jacobs constitutes an infringement of copyright.

Limitation: This document has been prepared on behalf of, and for the exclusive use of Jacobs' client, and is subject to, and issued in accordance with, the provisions of the contract between Jacobs and the client. Jacobs accepts no liability or responsibility whatsoever for, or in respect of, any use of, or reliance upon, this document by any third party.