

THIS MAP IS REPRODUCED FROM ORDNANCE SURVEY MATERIAL BY HALCROW, A CH2M HILL COMPANY, ON BEHALF OF Environment Agency WITH THE PERMISSION OF THE CONTROLLER OF HER MAJESTY'S STATIONERY OFFICE. CROWN COPYRIGHT. UNAUTHORISED REPRODUCTION INFRINGES CROWN COPYRIGHT AND MAY LEAD TO PROSECUTION ON CIVIL PROCEEDINGS. LICENCE 10025452

PLAN
1:2500

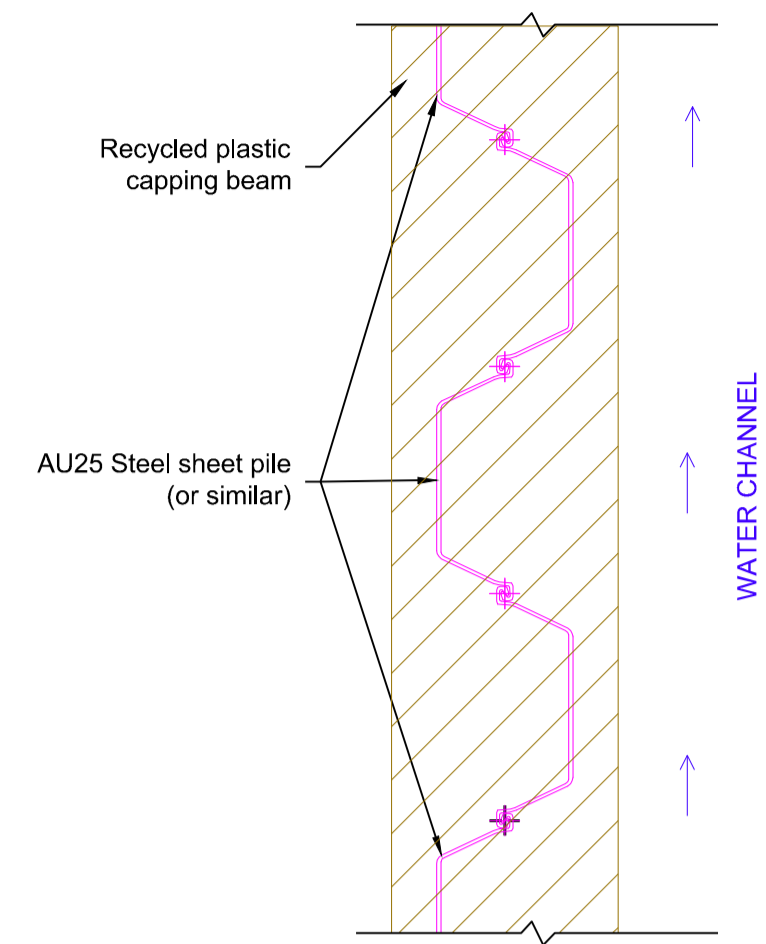

TYPICAL PLAN VIEW OF SHEET PILE WITH CAPPING BEAM
1:25

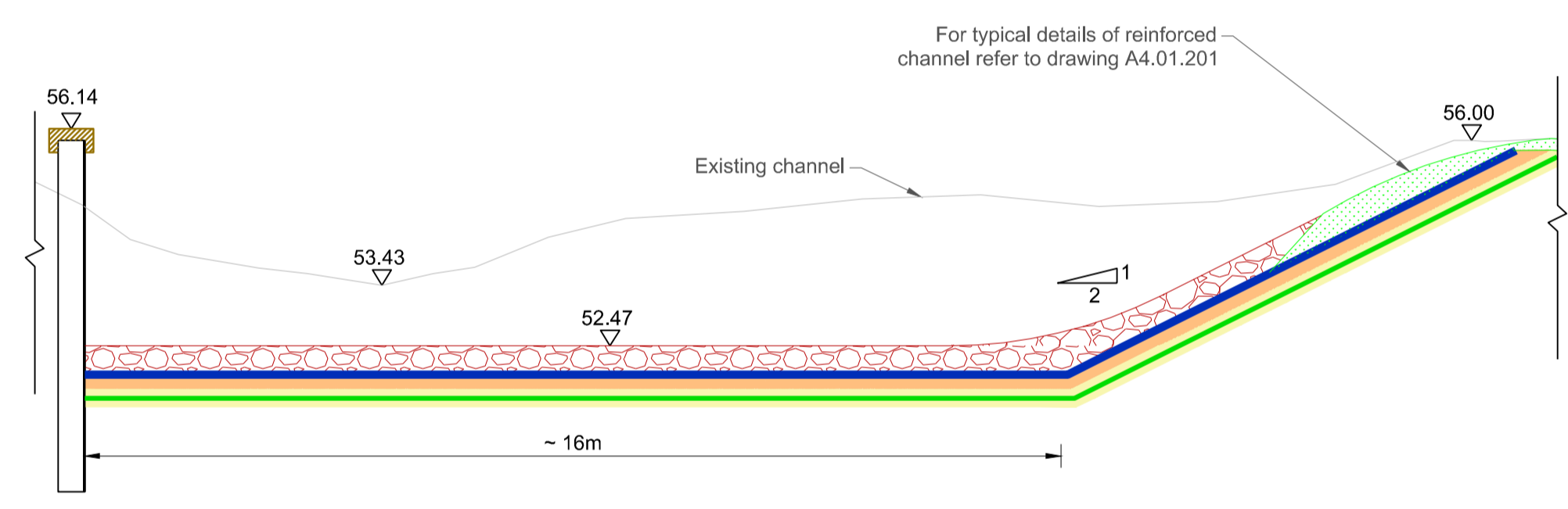

SECTION A-A
1:100

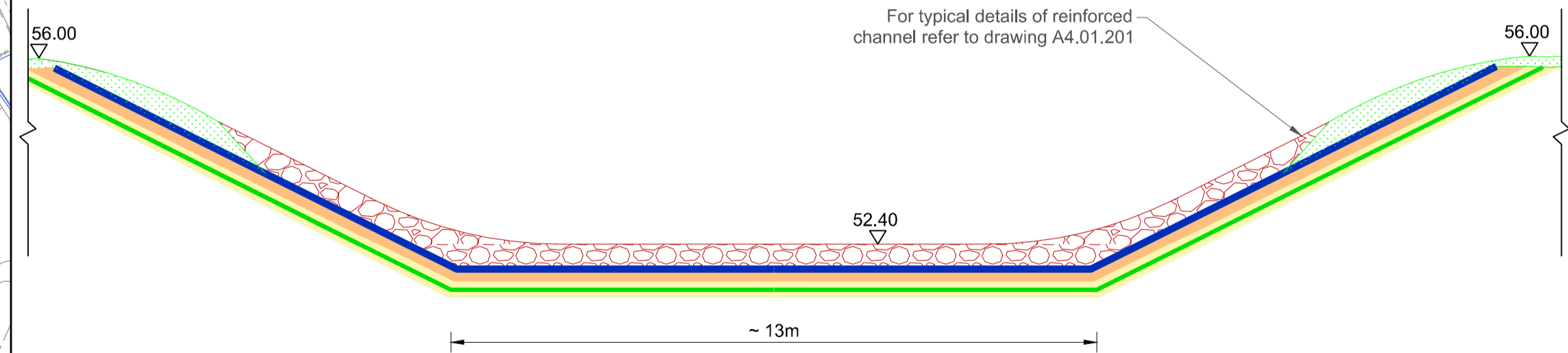

SECTION B-B
1:100

GENERAL NOTES

1. All dimensions are in millimetres unless otherwise stated. All levels are in metres above Ordnance Datum (mAOD) Newlyn.

NOTES

- Proposals and details shown are preliminary and all drawings are indicative. Also the details shown could change to accommodate considerations for temporary works and access of construction vehicles.
- This drawing is to be read in conjunction with drawings ZZ.00.100, A4.01.100 and A4.01.201.
- The services locations shown in this drawing are only indicative and based on information received (C2 Returns) from Service Providers in March 2015.
- The sizes of all the channels shown are only indicative and are subject to change.

LEGEND

- Existing Watercourses
 - Grouted riprap channel
 - Reinforced earth channel
 - Culvert crossing
 - Earth bund
 - Wetland features (scrapes, backwaters)
 - Low-level berms / Riffles
 - Sheet pile with concrete facing
 - Indicative boundary of Site of Specific Scientific Interest (SSI)
- Statutory Undertakers Information
- Communications
 - Electricity cable (High Voltage)
 - Electricity cable (Low Voltage)
 - Gas main
 - Gas main (Low Pressure)
 - Water main
 - Drainage - Foul Water
 - Drainage - Surface Water
 - Drainage - Combined
 - National Grid

SAFETY, HEALTH & ENVIRONMENTAL INFORMATION

In addition to the hazards/risks normally associated with the types of work detailed on this drawing, note the following:

CONSTRUCTION:

- Areas of work adjacent to watercourses and there is a risk of drowning. Temporary works required to isolate working area from water. Machines to be operated at furthestmost point from watercourses. No lone working within the vicinity of a watercourse.
- Working near public rights of way - Old Abingdon Road, Kennington Road, etc. Traffic management where appropriate. Fencing, signs and compliance with regulations. Also, access permission from Network Rail must be sought prior to accessing Network Rail.
- Contamination of controlled waters. Existing watercourses are to be isolated prior to any concreting works. There are works within a historic landfill site - possible presence of contaminated material.
- Unexploded ordnance. Site risk assessment to be produced and recommendations followed during investigation.
- Presence of underground and overhead cables. Utility plans to be kept on site during the works. Position of overhead electricity pylons to be noted.
- Known potential registered host site - status of registration to be confirmed prior to attending site. Safety and security advice to be sought prior attending site.

MAINTENANCE/CLEANING:

- Working near watercourses. No lone working and adjacent access tracks could ground vehicles.
- Access permission from Network Rail must be sought prior to accessing Network Rail land.

DECOMMISSIONING/DEMOLITION:

It is assumed that all works will be carried out by a competent contractor working, where appropriate, to an approved method statement.

DRAFT - INDICATIVE OUTLINE DESIGN

DRG STATUS		DRAFT		1	
BY	APVD	CHK	APVD	PJM	DRG REV
ZO	SYK	REVISION	CHANGES INCORPORATED FOLLOWING REVIEW BY EA	1	1
DATE	29/07/2016	DATE	29/07/2016	DR	1
REV	1	STATUS	FINAL	DR	1
DSGN		DATE		DR	
KCH		KCH		KCH	

Burderop Park
Swindon, Wiltshire SN4 0OD
TEL: +44 1753 812 479

Environment Agency

OXFORD FLOOD ALLEVIATION SCHEME OBC

South of Old Abingdon Road Sheet 1 of 2

BAR IS 25mm ON ORIGINAL DRAWING.
0 25mm

DATE	07/07/2016
PROJ	661656
DWG	A4.01.200
SHEET	1 of 2

REUSE OF DOCUMENTS: THIS DOCUMENT AND THE IDEAS AND DESIGNS INCORPORATED HEREIN AS AN INSTRUMENT OF PROFESSIONAL SERVICE IS THE PROPERTY OF CH2M HILL AND IS NOT TO BE USED, IN WHOLE OR IN PART, FOR ANY OTHER PROJECT WITHOUT THE WRITTEN AUTHORIZATION OF CH2M HILL. © CH2M HILL 2013. ALL RIGHTS RESERVED.