

Future land use of advertised land - Oxford Flood Alleviation Scheme

Seacourt Nature Park

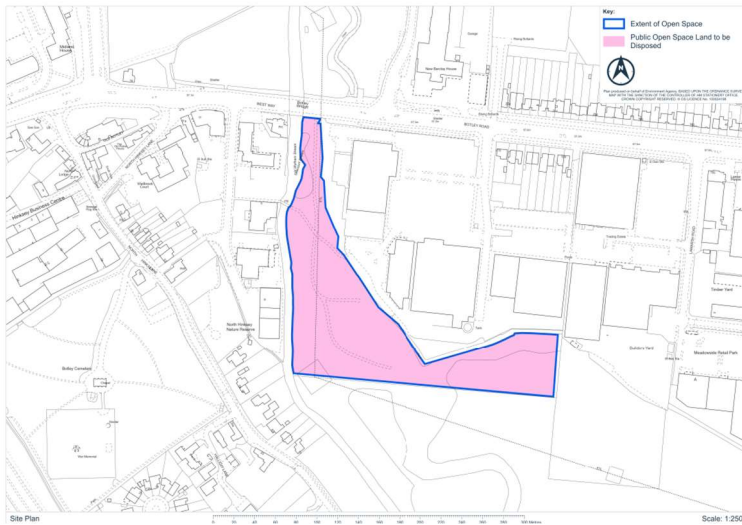

Once the scheme is built, the whole of Seacourt Nature Park will be open to the public once again. The Seacourt Stream will be more visible and accessible to visitors than it is now and some of the land in the Nature Park will be lower, so that it can hold floodwater when river levels are sufficiently high, drawing the water away from houses and offices along Botley Road and reducing the risk of flooding.

The majority of the park will be grassland and meadow which will be mown once or twice a year to maximise its ecological value. Much of the grassland will be suitable for walking all year round, while the grassland in the lowered areas will be suitable for walking during drier months. As is the case now, there will be a combination of mown and surfaced paths. Benches and interpretation boards will also be installed in consultation with park users.

In addition to the meadows and grassland there will be a mix of existing, and new, native trees and shrubs. The Seacourt Nature Park will be managed for people and wildlife for many decades to come as part of the wider Oxford Flood Alleviation Scheme.



Existing view (summer): Seacourt Nature Park looking south



Proposed view (summer): Showing widened second-stage channel and replacement bridge across Seacourt Stream

View South into Seacourt Nature Park from Botley Road

Grandpont

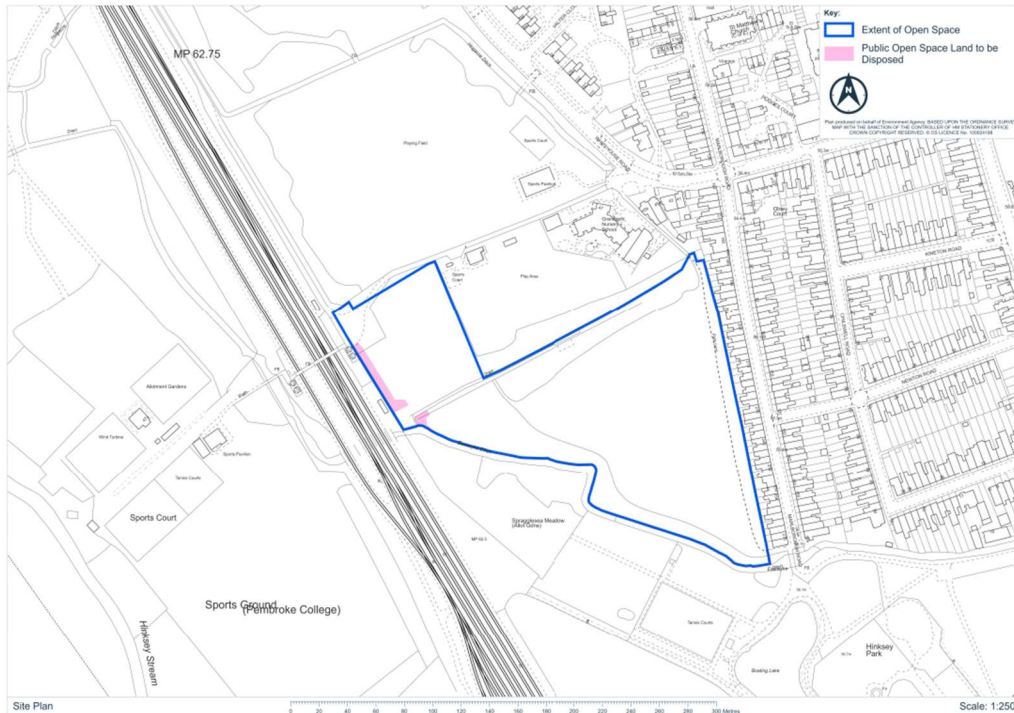

The narrow strip of land next to the railway line is going to have an access track built on it. The small piece of land next to the Eastwyke Ditch will have part of a new tilting weir structure built on it. The tilting weir will reduce the risk of flooding in New Hinksey.

Oatlands Recreation Ground

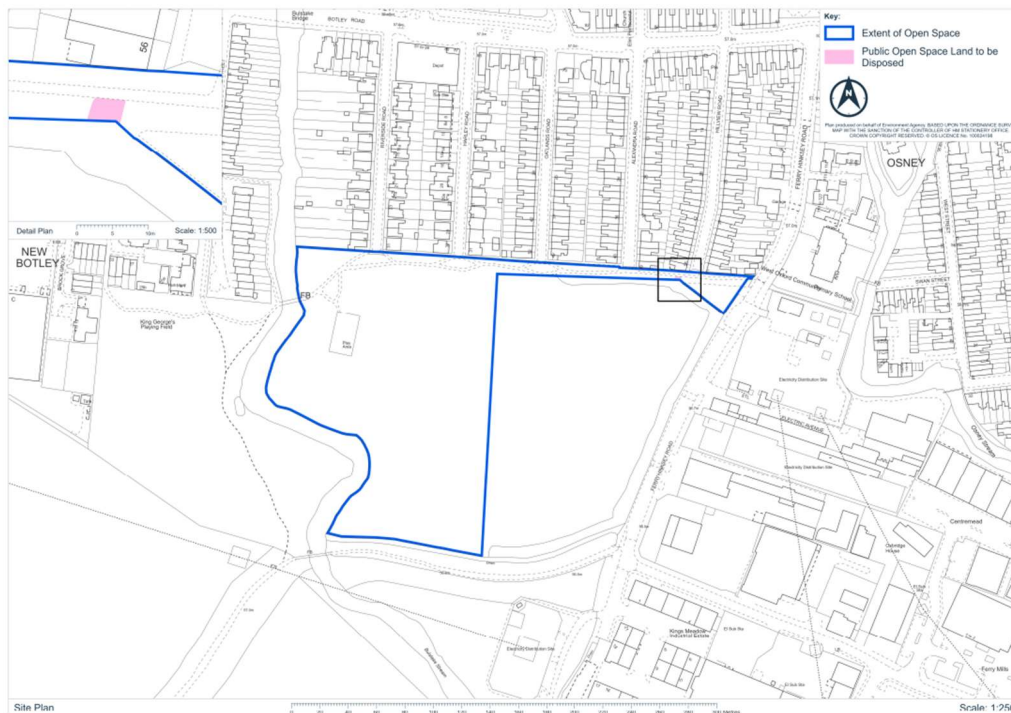

This small piece of land will be the very northern end of a flood embankment that will reduce the risk of flooding on Ferry Hinksey Road and in Osney Mead.

Kendall Copse

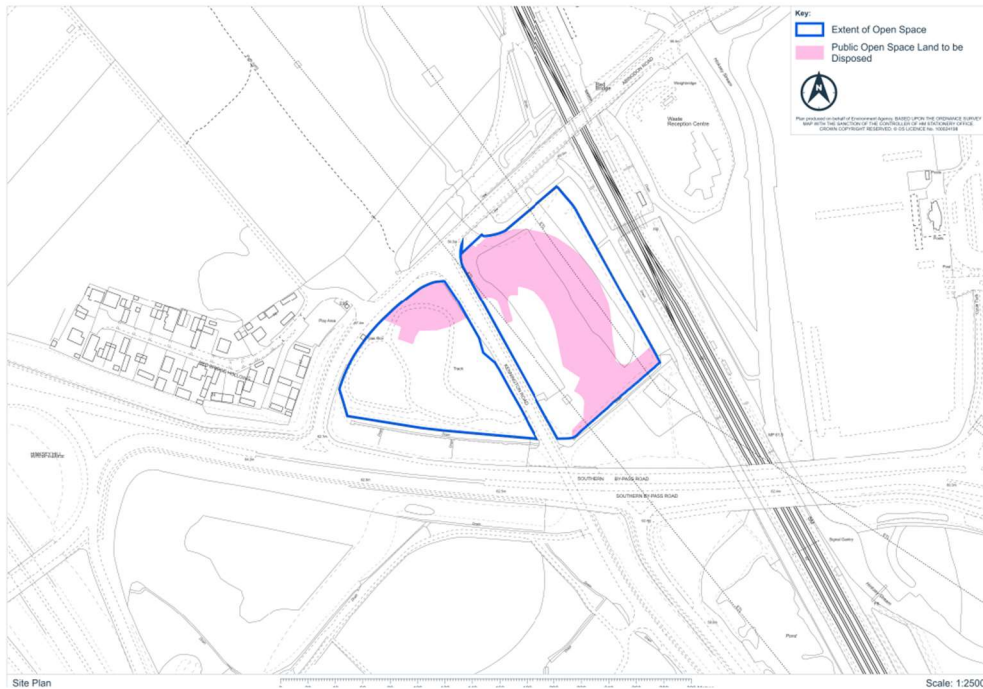

This land will be a flood channel and associated maintenance access tracks.

The remainder of Kendall Copse will be re-planted and will be open to the public again once the scheme is complete.