

KEY	DESCRIPTION
[Grey Box]	DROPPED CROSSING CONSTRUCTION
[Dark Grey Box]	SURFACE COURSE 25mm THICK 0/6mm DBM 190 PEN SURFACE COURSE L/STONE TO BS 4987-1:CLAUSE 7.5
[Light Grey Box]	BINDER COURSE 55mm THICK 0/20mm DBM 190 PEN BINDER COURSE L/STONE TO BS 4987-1: CLAUSE 6.5
[Blue Box]	SUB-BASE 150mm THICK TYPE 1 TO COMPLY WITH SPECIFICATION FOR HIGHWAY WORKS CLAUSE 803. MUST BE FREE FROM EXTRANEOUS MATTER. WEEDS MUST BE REMOVED AND THE SUBGRADE SPRAYED WITH A GLYPHOSATE TYPE WEEDKILLER.
[Dark Blue Box]	1000 GRADE GEOTEXTILE TERRAM REQUIRED ON NEW CARRIAGEWAY AND FOOTWAY FORMATION AREAS
[Blue Box]	FOOTWAY CONSTRUCTION
[Light Blue Box]	SURFACE COURSE 30mm THICK SMA10 OR 40mm THICK 30% HRA ON 60mm THICK AC20 DENSE BINDER
[Brown Box]	ACCESS TRACK CONSTRUCTION 200mm TYPE 1 SUB-BASE
[Yellow Box]	K4 KERB
[Red Box]	K7/K8 TRANSITION KERB
[Blue Box]	K1 KERB

THIS DRAWING SHOWS THE PRELIMINARY DESIGN ONLY AND IS SUBJECT TO DETAILED DESIGN, TOPOGRAPHICAL SURVEY INFORMATION AND LOCAL AUTHORITY APPROVAL

REV	AMENDMENTS	DATE

HY CONSULTING Ltd
 OFFICE 24, EVANS BUSINESS CENTRE
 BURLEY ROAD LEEDS LS4 2PU
 Tel: 0115 2883034 email: info@hyconsulting.com

PROPOSED FISHING PONDS
 WARMFIELD LANE, KIRKTHORPE
 DETAILED DESIGN

SCALE: AS SHOWN @A1
 DATE: DEC 2015

DRAWING No: 1513701

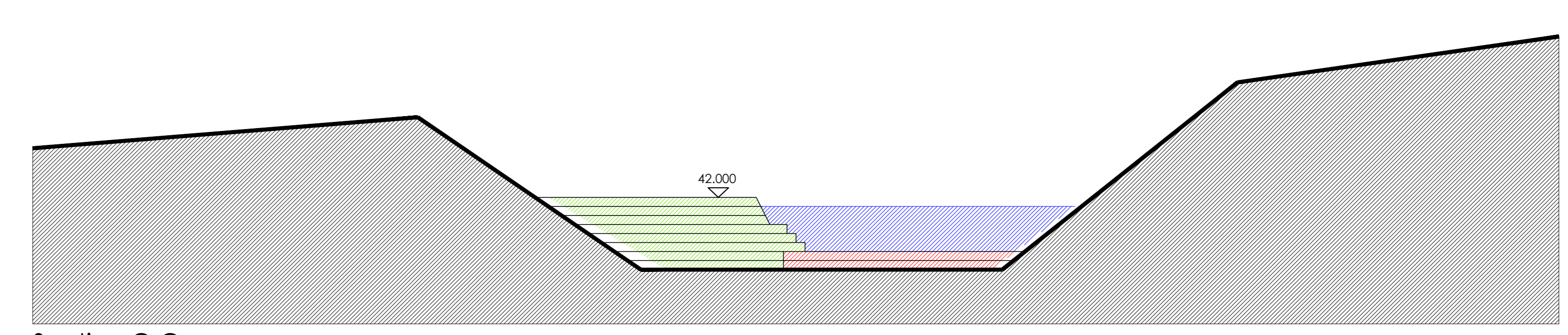
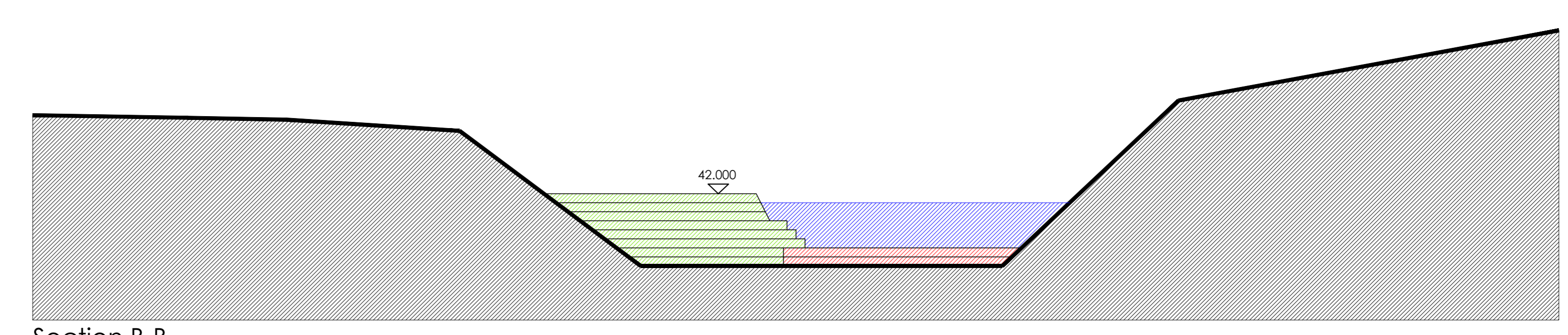
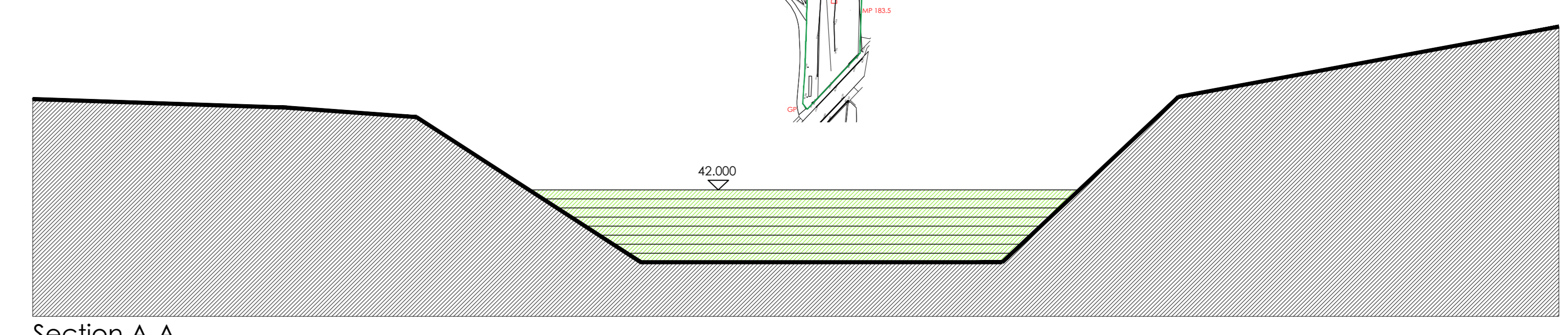
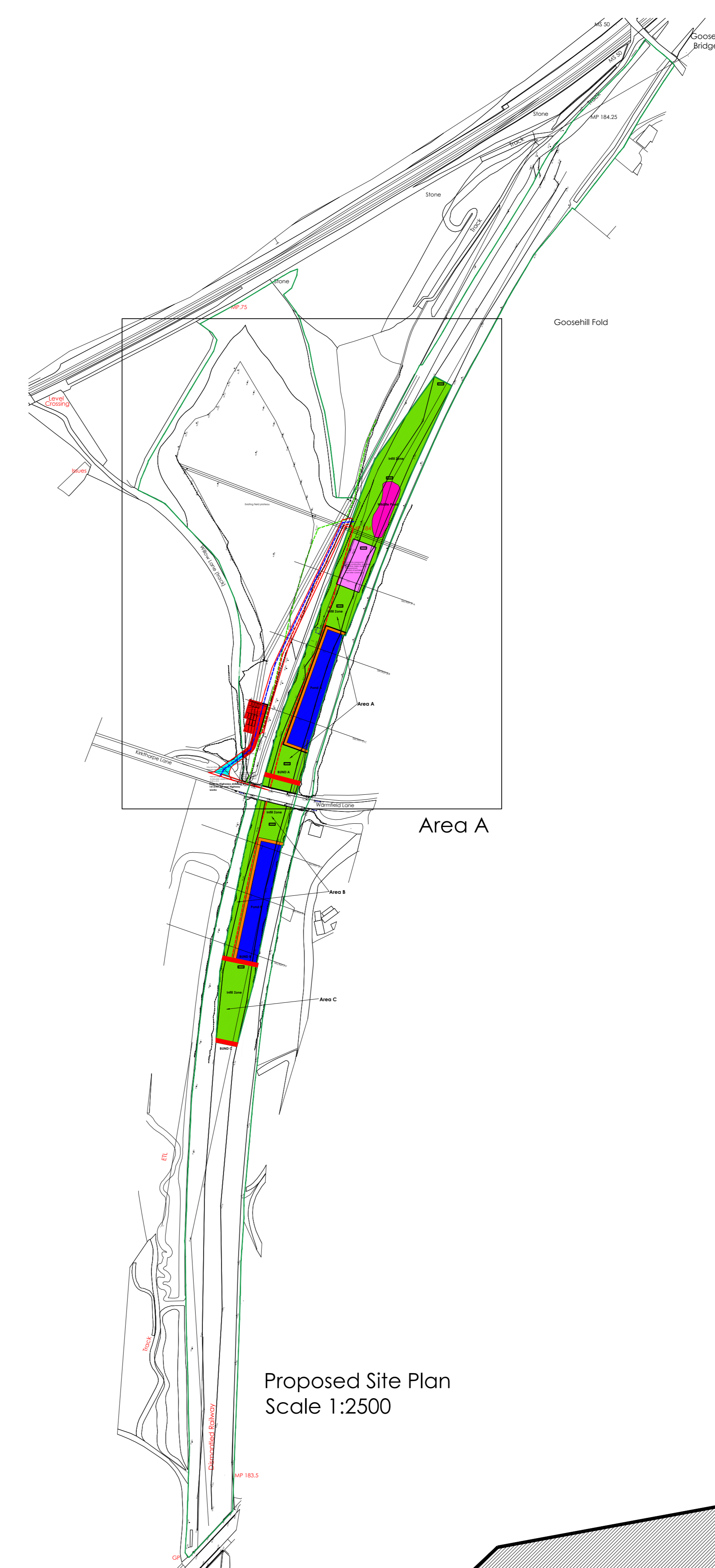
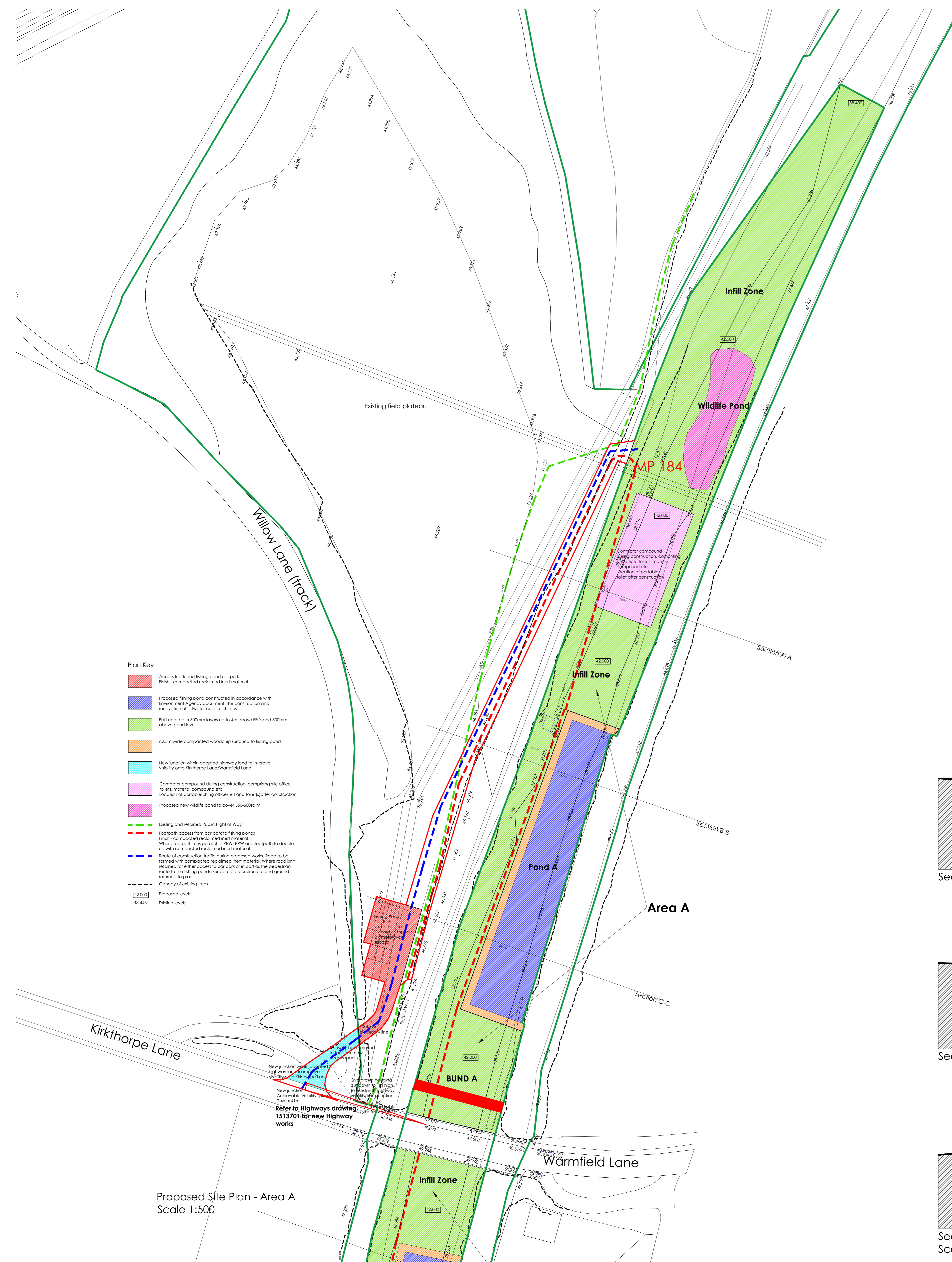

Rev	Date	Client / Amendment	By	CHK
A	26/10/2013	Client / Issue raised	ADP	ADP
B	15/11/2014	Section boundary revised	ADP	ADP
C	20/11/2014	Wildlife Pond added	ADP	ADP
D	21/10/2015	Reference to highways drawing added	ADP	ADP
E	14/10/2017	Revised layout	ADP	ADP

Section Colour Key and Volumes to Infill Zone

■	100mm thick capping layer over full extent of proposed fishing pond	Total volume - 2,500m ³
■	Proposed fishing pond constructed in accordance with Environment Agency document 'The construction and use of stillwater coarse fisheries'	Total volume - 7,200m ³
■	Built up area in 500mm layers up to 4m above FFL's and 500mm above pond level	Total volume - 41,845m ³ plus Wildlife Pond volume of 1,445

den architecture
 8 Wharf Street, Leeds, LS2 7EQ
 23 Hanover Square, London, W1S 1JB
 T: 0844 844 0070
 F: 0844 844 0071
 info@den.uk.com
 www.den.uk.com

Date	Scale	Site	ADP	Checked
Dec 2013	Varies	AD	ADP	
2618	200	E	Planning	

Copyright of this drawing remains the sole property of Den Architecture Ltd. It is not to be used for any other project, copied, altered or used in any way without the written consent of Den Architecture Ltd. The original drawing should be used.

Northpoint:

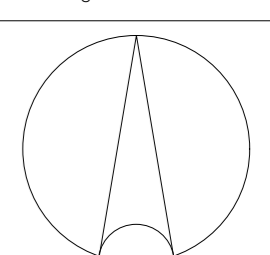

Rev	Date	Client/Amendment	By	CHK
A	20.12.2013	Client issue/revision	ADP	
B	15.01.2014	Section boundary revised	ADP	
C	20.11.2014	Wildlife Pond added	ADP	
D	31.10.2015	Reference to highways drawing added	ADP	
E	14.10.2016	Revisions added	ADP	

Notes:

Section Colour Key and Volumes to Infill Zone

- 1m thick capping layer over full extent of proposed fishing pond
Total volume - 2,500m³
- Proposed fishing pond constructed in accordance with Environment Agency document 'The construction and renovation of stillwater coarse fisheries'
Total volume - 7,200m³
- Built up area in 500mm layers up to 4m above FFL and 500mm above pond level
Total volume - 41,845m³ plus Wildlife Pond volume of 1,445m³

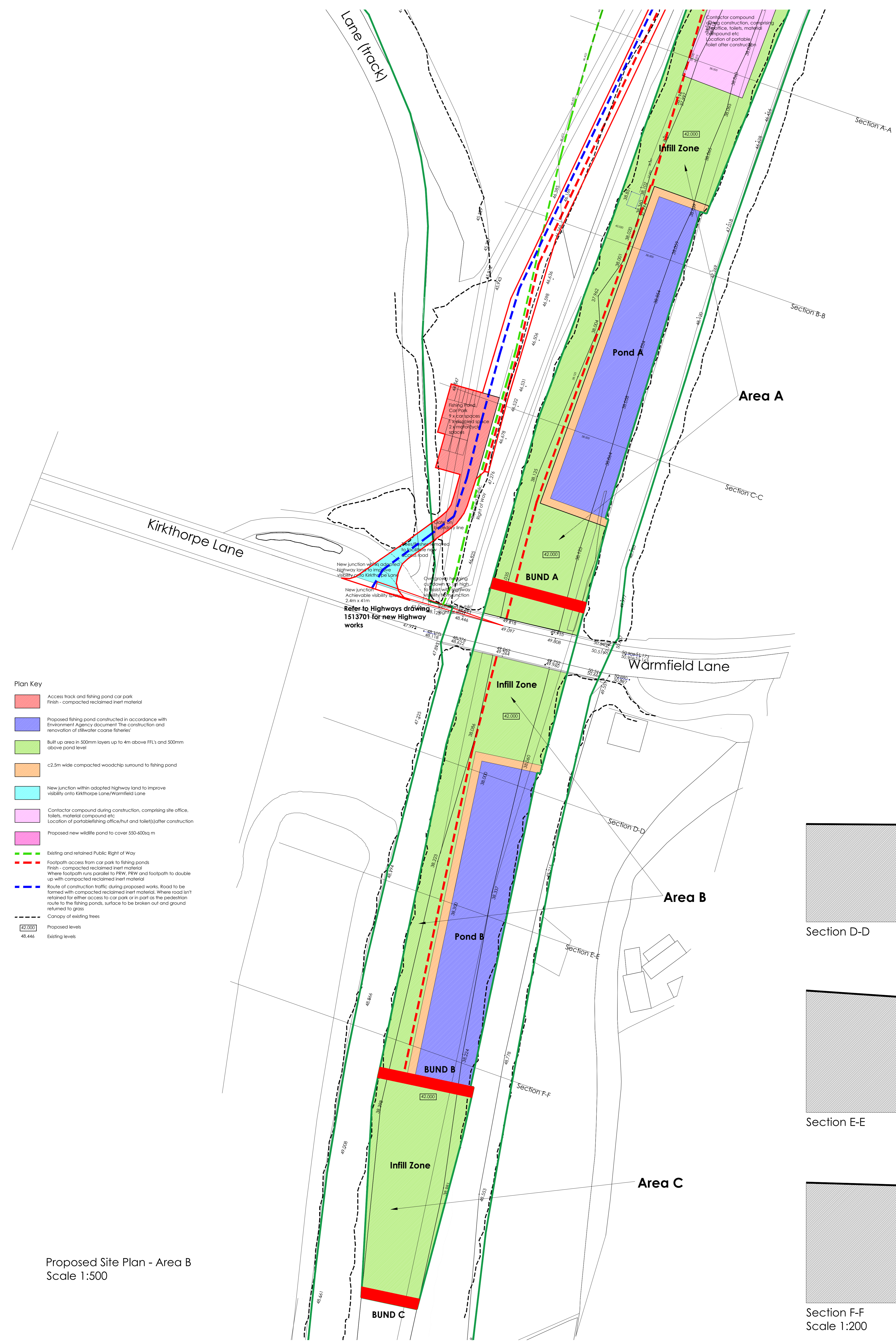
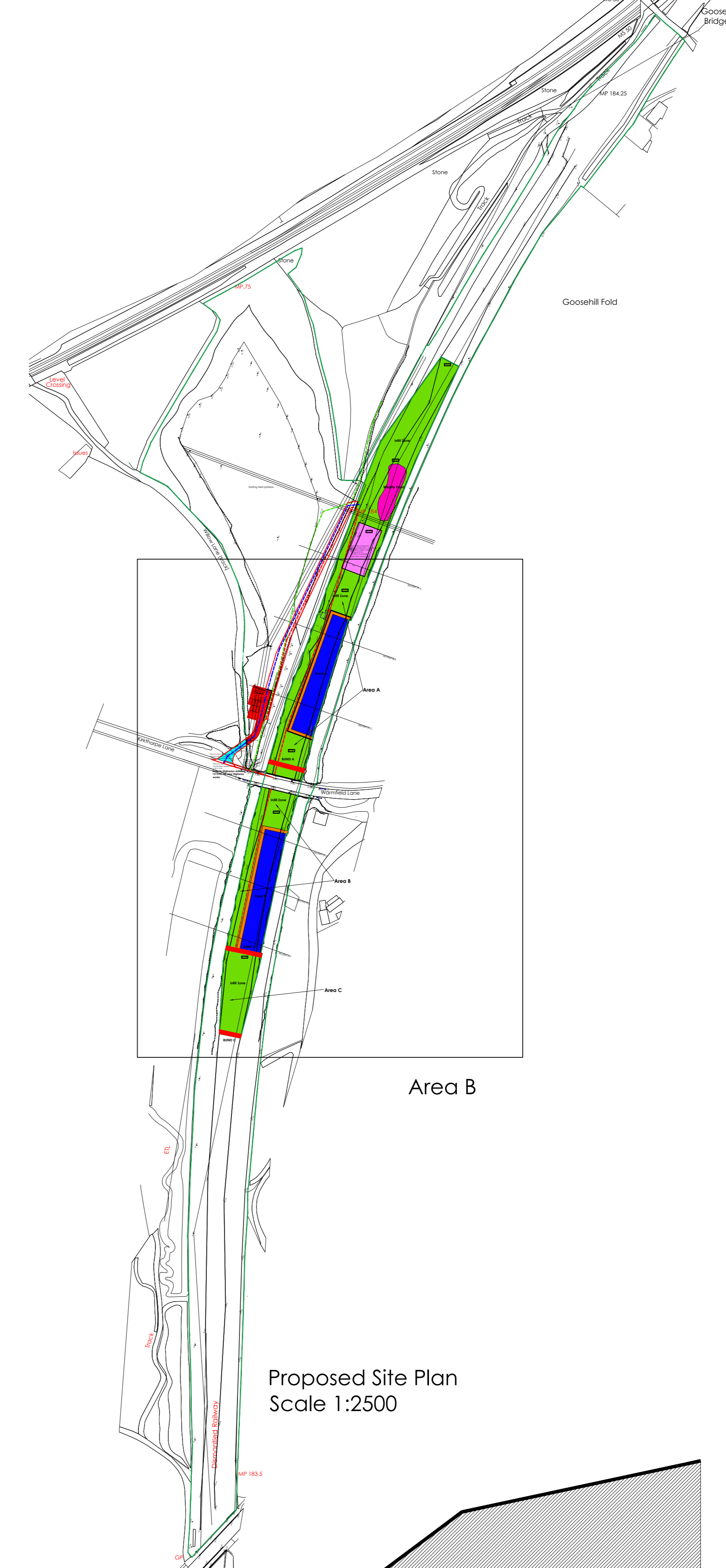

- Plan Key**
- Access track and fishing pond car park
 - Fish - compacted reclaimed inert material
 - Proposed fishing pond constructed in accordance with Environment Agency document 'The construction and renovation of stillwater coarse fisheries'
 - Built up area in 500mm layers up to 4m above FFL and 500mm above pond level
 - 2.5m wide compacted woodchip surround to fishing pond
 - New junction within adopted highway land to improve visibility onto Kirkthorpe Lane/Warmfield Lane
 - Contractor compound during construction, comprising site office, toilet, material compound etc.
 - Location of portablashing office/hut and toilet/jaffer construction
 - Proposed new wildlife pond to cover 550-600sq m
 - Existing and retained Public Right of Way
 - Footpath access from car park to fishing ponds
 - Fish - compacted reclaimed inert material
 - Where footpath runs parallel to PRW, PRW and footpath to double up with compacted reclaimed inert material
 - Route of construction traffic during proposed works. Road to be formed with compacted reclaimed inert material. Where road isn't retained for either access to car park or in part of the pedestrian route to the fishing ponds, surface to be broken out and ground returned to grass
 - Canopy of existing trees
 - Proposed levels
 - Existing levels

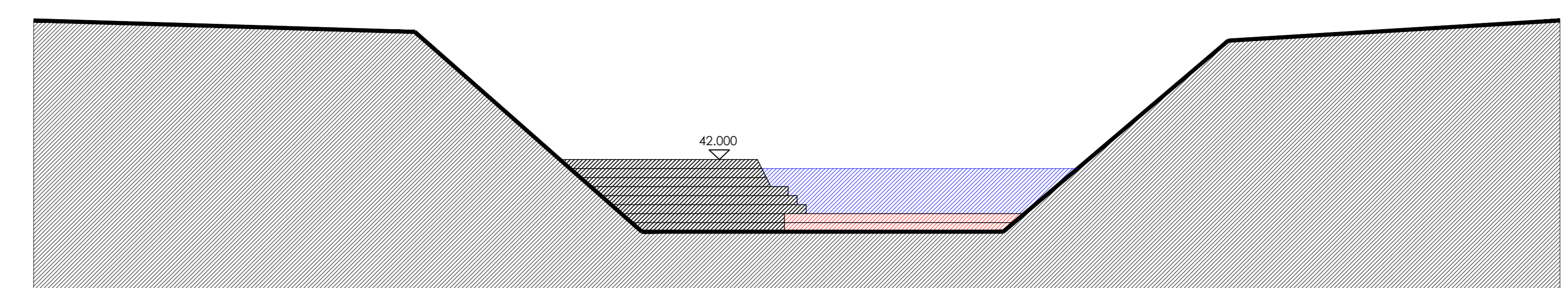
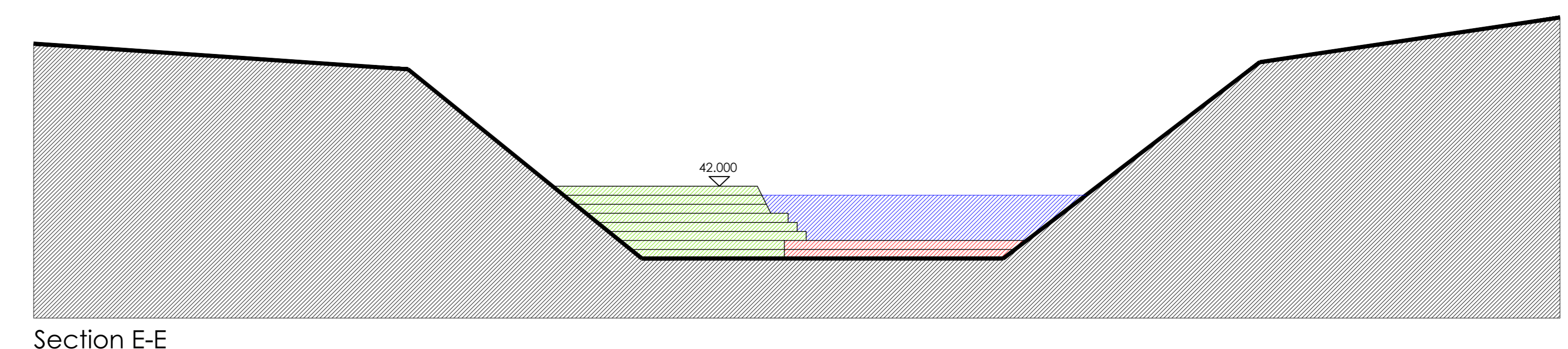
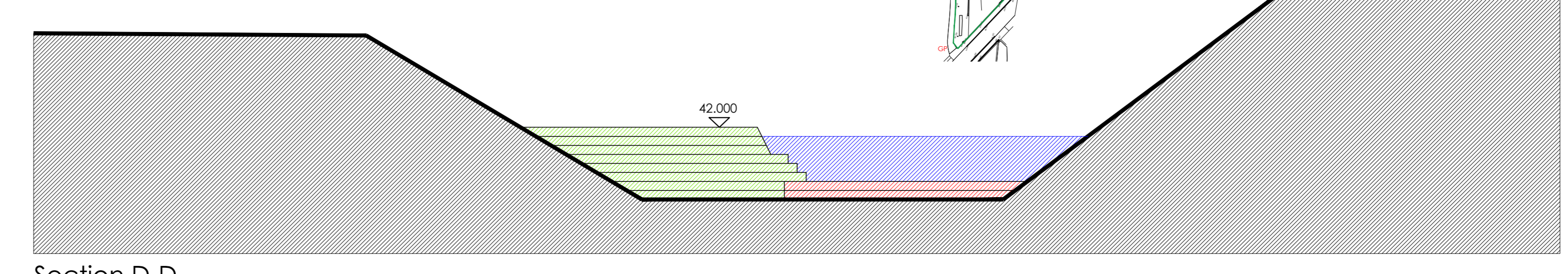

den
architecture

8 Wharf Street, Leeds, LS2 7EQ
23 Hanover Square, London, W1S 1JH

T: 0844 844 0070
F: 0844 844 0071
info@den.uk.com
www.den.uk.com

Project: Proposed Willow Lane Fishing Ponds
Land off Warmfield Lane, Kirkthorpe

Client: Pickup Skips

File: Proposed Site Plan and Sections
Pond A

Date	Scale	Set	Drawn	Checked
Dec 2013	Varies	AD	ADP	

Project No: 2618
Draw No: 201
Rev: E
Status: Planning

Den Architecture Ltd. 2016. All rights reserved.