

User Manual

Original document

Cyclone filters

PBS, PCS, PZS, POS, PCU



POETH B.V.
Tichlouwstraat 5
5932 AA Tegelen
Nederland

Date: 05-01-2023
Version: 02.5

Table of contents

1.	Introduction	2
1.1	Machine data	3
1.2	Manufacturer's data	3
1.3	Warranty	4
1.4	Liability	4
2.	Technical specifications	5
3.	Safety	6
3.1	Principles, regulatory use	6
3.2	Organisational measures	6
3.3	Building-in measures	7
3.4	During normal operation	7
3.5	During special operation	8
3.6	Safety provisions	9
4.	Construction and operation	10
4.1	Intended use	10
4.2	Unintended use	10
4.3	Layout	11
4.4	Operating controls	15
4.5	Global operation	15
5.	Receipt, transport and storage	16
6.	Installation	17
6.1	Mechanical installation	17
6.2	Electrical installation	18
6.3	Pneumatic connection	19
6.4	Filter controller	19
7.	Commissioning	20
7.1	Inspections	20
8.	Operation	21
8.1	Decommissioning	21
9.	Maintenance	22
9.1	Preventive maintenance	23
9.2	Assembly and disassembly of the filter hoses	24
9.3	Diaphragm valves	25
9.4	Spare and replacement parts	27
10.	Disposal of the machine or machine parts	28
11.	Appendices	29
11.1	CE conformity statement	29

1. Introduction

This user manual has been drawn up for operators, installers, service technicians, and others who are responsible for operation or maintenance of this machine. Before installation and commissioning, make sure to carefully read this user manual first.

The user manual should facilitate the familiarisation with the machine and the utilisation of the different applications for which it can be used.

This user manual contains important instructions/information on how to use the machine in a safe and competent way.

Make sure to especially study the safety section. Any damage and/or injury resulting from incompetent installation or use are not the responsibility of the manufacturer.

This user manual should be available at all times, near the place where the machine/installation is used.



Important points of attention, instructions or information are indicated with a warning sign.



This machine/installation may only be operated if it has been fully and completely installed.



This machine/installation may not be used until the user manual has been studied in full and is fully understood by the qualified user. Only operate the machine/installation if you have adequate knowledge of the user manual.

Copyright © 2023 Poeth BV

All rights and modifications reserved. No part of this publication may be reproduced and/or published by means of print, photocopy, microfilm, or in any other way, without the prior written permission by Poeth BV, with the exception of the parts that are intended to be reproduced for the purpose of using this publication, such as summarised instructions and indications to be affixed to the machine.

Author: Poeth BV, Tegelen (NL)

1.1 Machine data

A type plate has been affixed to the machine. The type plate contains the type indication, the order number, and the year of manufacture of the machine. A customer's machine number may be stated optionally.

A photograph of a metal type plate for a Poeth machine. The plate is light grey and has a red vertical bar on the left side. At the top left, the company name and contact information are printed: "Poeth bv", "Tichlouwstraat 5, NL-5932 AA Tegelen", "Phone +31(0) 77 373 19 41", "Fax +31(0) 77 373 71 37", "www.poeth.nl", and "poeth@poeth.nl". At the top right, the Poeth solids processing logo is printed. Below the contact information, there are four horizontal input fields. The first three fields are labeled "Type", "Order no.", and "Year" respectively. The fourth field is empty. To the right of the input fields, there is a large "CE" mark.

1.2 Manufacturer's data

Manufacturer : Poeth BV
Address : Tichlouwstraat 5
5932 AA Tegelen
Country : The Netherlands

Telephone : +31 (0)77 – 373 19 41
Fax : +31 (0)77 – 373 71 37

Internet : www.poeth.nl
Email : poeth@poeth.nl

When contacting Poeth BV, always state the machine number of the machine concerned, as it is stated on the type plate.

1.3 Warranty

The following warranty conditions apply, unless otherwise agreed in writing:

- Poeth BV provides warranty to the first user for 12 months after delivery,
- Any defects should be notified to Poeth BV within the warranty term,
- The warranty applies to defects that:
 - occur during normal use of the machine,
 - develop because of faulty construction or materials.
- The warranty does not apply in case of defect that are the result of:
 - normal wear,
 - incompetent or improper use,
 - use of consumables other than those prescribed.
- In case of a defect, Poeth BV will:
 - replace the parts. Poeth BV will become the owner of the parts that have been replaced,
 - repair the defect,
 - choose for another alternative solution if repair is not deemed reasonably possible.
- The customer should enable Poeth BV to remedy any defect,
- Concerning any built-in parts by third parties, the warranty conditions of the supplier concerned apply. The warranty term may deviate from what has been indicated above.

1.4 Liability

The delivery comprises a partial machine that is intended to be combined with other parts to form a single machine / installation. It is prohibited to commission this partial machine until a CE marking for the entire machine / installation has been executed according to Machine Directive 2006/42/EC and an EC conformity statement Appendix IIA has been drawn up and signed.

The delivery comprises a machine that cannot operate on its own. That is why this partial machine is accompanied by a building-in statement. The manufacturer of the total machine, or the machine composer, is to carry out an overall CE marking before commissioning this product.

Poeth BV is not liable for any unsafe situations, accidents and/or damages that are the result of the ignoring of warnings and/or instructions as indicated on the machine or in this user manual, including:

- incompetent or incorrect use or maintenance,
- the use for any other application or under any other conditions than those indicated in this user manual,
- use of other parts than those prescribed,
- repairs done without permission by Poeth BV,
- modifications to the machine. These include:
 - modifications in the controls,
 - welding, mechanical adjustments, etc.,
 - expansions to the machine or the controls.
- Poeth BV is not liable:
 - If the customer has not met all obligations regarding Poeth BV (financial or otherwise),
 - For any consequential damages as a result of malfunctions or defects of the machine (such as, for example, damage to any products (to be processed), downtime, delays, etc.).

2. Technical specifications



This machine may only be used within the specification limits indicated below. If the machine is used outside of these specifications, Poeth BV can no longer take any responsibility for this machine.

The machine is designed for the continuous control of dust formation in industrial processes, where powder and / or solid materials are processed.

The machine is solely intended to become a part of a machine / installation and may therefore not be used as a standalone machine.

The machine is suitable for indoor installation. Optionally, the machine may be provided with a suitable surface treatment in order to enable outdoor use.

Only use genuine Poeth BV parts. If any component is replaced by a component of another brand or type, all warranty and liability for Poeth BV will lapse.

General specifications and tolerances:

Description	Value
Noise level at operator position	Unknown. Depends on the products to be processed and the position of the operator. To be included in the CE marking of the total machine.
Ambient temperature	-20°C to +60°C Controller start-up 0°C to +50°C
Electrical connection	Controller: See Manual Controller Fan: See Manual Fan
Dimensions + Weight	See drawing of the supplied Filter
Compressed air pressure	4 - 5 Bar
Filter Material	Polyester needle felt, oil and water resistant anti-static

3. Safety

All markings (type plates, stickers, etc.) affixed to the machine/installation must remain clearly visible and legible throughout the life span of the machine and may therefore not be removed and/or painted over.



Warning:

The machine/installation may only be commissioned if it has been fully installed, including all safety provisions. Without safety provisions, life-threatening situations may arise.



Warning:

The machine may only be used for the purpose for which this machine was intended!



Warning:

Do never start the machine when someone is repairing or cleaning it. This can cause life-threatening situations.

3.1 Principles, regulatory use

The machine is intended to become a part of a complete machine / installation and may therefore not be used as a standalone machine. The machine may not be commissioned before the installation has been declared in conformity with the provisions of the Machine Directive.

The machine has been built according to the latest technologies and recognised safety regulations. However, dangerous situations may still occur during its use - both for the user and for third parties. Also, during use, damage may occur to the machine or to other objects.

The machine may only be used in technically correct condition and for the purpose for which this machine was intended. During use, always make sure you are aware of all the dangers that may possibly arise. Make sure to follow the user manual and observe all safety aspects. Remedy any malfunctions immediately, or have them remedied.

The machine may only be operated by appropriately trained and authorised personnel.

3.2 Organisational measures

Make sure the user manual remains within easy reach of the machine at all times.



Warning:

Each person operating the machine or performing maintenance to the machine must have read the user manual before starting any work!

Make sure only people who have been ordered to do so by an authorised person or body will operate the machine or perform maintenance to it.

If necessary, or according to regulations, personal protective equipment must be used.

In no circumstances may the safety devices be modified or any other changes be made that may affect safety, without written approval by Poeth BV.

3.3 Building-in measures

The machine is intended as a part of a complete installation. See the sections "Installation" and "Commissioning" for the minimum measures to be taken.



Warning:

Any incorrect building-in and/or commissioning of the machine may lead to life-threatening situations.

3.4 During normal operation

The safety provisions are of the highest importance and may never be removed. Safety must always come first and the operator has to make sure it does. Should the operator observe any abuse, or should he/she not agree with the safety measures taken, he/she must immediately notify the main person responsible of this fact. The operator must be sufficiently skilled to be able to deal with any situation arising during the operation of the machine.

All local health and safety regulations must be observed at all times.

Any procedure that may endanger safety and/or health must be refrained from.

Measures must be taken to ensure that the machine is only used or operated in safe conditions and in proper working order.

Only use the machine if all protective devices and safety-dependent devices are in place and in proper working order.

Immediately stop the work if it turns out that a control or operating switch is damaged or is not operating according to regulations. Do not resume the work until repaired/replaced and approval by an authorised maintenance technician.



Warning:

During normal use, the dust emissions at the clean air side of up to 5 mg/Nm³ is possible. Depending on the type of dust, this can have serious consequences.

3.5 During special operation

Observe the adjustment, maintenance and inspection work prescribed in the user manual.

Also, refer to the documentation and user manuals by relevant third parties.

Interrupt the power (mains voltage) before inspecting the machine/installation by switching off the operating switch or pulling the plug from the socket.

If the machine/installation has been completely switched off for maintenance or repair work, it must be secured against unexpected reconnecting.

For example by:

1. Disconnecting the drive motor from the fan from the mains by means of the operating switch. Make sure this switch is locked during the work (for example by means of a padlock),
2. Disconnect the filter unit from the pressure air by closing the main valve,
3. Release pressure from the vessel.
4. Disconnect the controller from the power supply.
5. Keep out unauthorised persons from the immediate vicinity of the machine, for example by means of demarcation tape. Also place warning signs to draw attention to the fact that the machine concerned is being maintained and must not be switched on,
6. Make sure to depressurise, disconnect or switch off any connected components such as filters, sliding cabinets and/or conveyors.

If the work has to be done with the power supply to the machine/installation switched on, make sure there is an extra person present to operate the emergency switch or the operating switch in case of an emergency.

During exchange, make sure to carefully connect and secure loose parts and large units to lifting equipment, so that these cannot cause any danger. Only use lifting equipment that is suitable, approved and technically proper, and which has sufficient capacity. Never go underneath suspended loads and do not perform any work underneath these.

Any work of an electrotechnical, pneumatic or hydraulic nature must be carried out by personnel with special knowledge and experience in the area concerned.

If work has to be done to pressure pipelines or expansion vessels (e.g. compressed air, hydraulics), the pipeline/unit has to be depressurised according to the instructions before the work is started.



Warning:

Insufficiently release pressure of the pneumatic system can give an unexpected pressure surge with serious eye damage.

To lift the sections, lifting eyes can be placed in the flanges. The sections are also provided with bent edges to be able to attach lifting hooks. The sections are also rigid enough to be able to lift them with lifting belts.

Only use approved lifting equipment of which you are certain it can safely lift the weight of the filter. Ensure secure attachment of the lifting equipment so that it cannot shift or become detached.

Note the location of the centre of gravity in relation to the weight of the drive.

Never use the lifting eye of the motor to handle the filter.



Warning:

If the drive motor is incompetently installed or repaired, this may lead to dangerous situations. Make sure to carefully study the user manuals included in the delivery of the drive motor first.

3.6 Safety provisions

This machine is equipped with the safety provisions listed below.

- A with star knobs screwed-on cover.

Various safety provisions have to be installed in the final installation this machine is a part of. See the sections "Installation", "Commissioning" and "Operation" for further measures.



Warning:

If the necessary safety provisions within the complete installation are not provided, this may lead to life-threatening situations.



Warning:

Never remove the safety provisions. This may lead to life-threatening situations.

4. Construction and operation

4.1 Intended use

The machine is only intended for the continuous control of dust in industrial processes in which powder and/or solid materials are handled.

The machine may only be commissioned after complete installation and may only be operated within the operating limits indicated in the section "Technical specifications".

The machine is solely intended to become a part of an installation and may therefore not be used as a standalone machine. The delivery only comprises a partial machine. Before this machine is commissioned, it has to be CE marked.

The machine is suitable for indoor installation. Optionally, the machine may be provided with a suitable surface treatment in order to enable outdoor use.



Warning:

Do not use this machine for any other purposes than those for which it was manufactured by Poeth BV! This may lead to damages and danger for the operator and his environment.



Warning:

Keep all doors and hatches closed while the machine is in operation. Do not switch on the machine if any of the doors or hatches is opened or if anyone is within the protective guards of this machine.

4.2 Unintended use

Make sure to observe all instructions as described in this user manual; particularly those in the safety section.



Warning:

Do not use the machine to process any other products than those agreed upon with Poeth B.V.

4.3 Layout

PBS/PZS

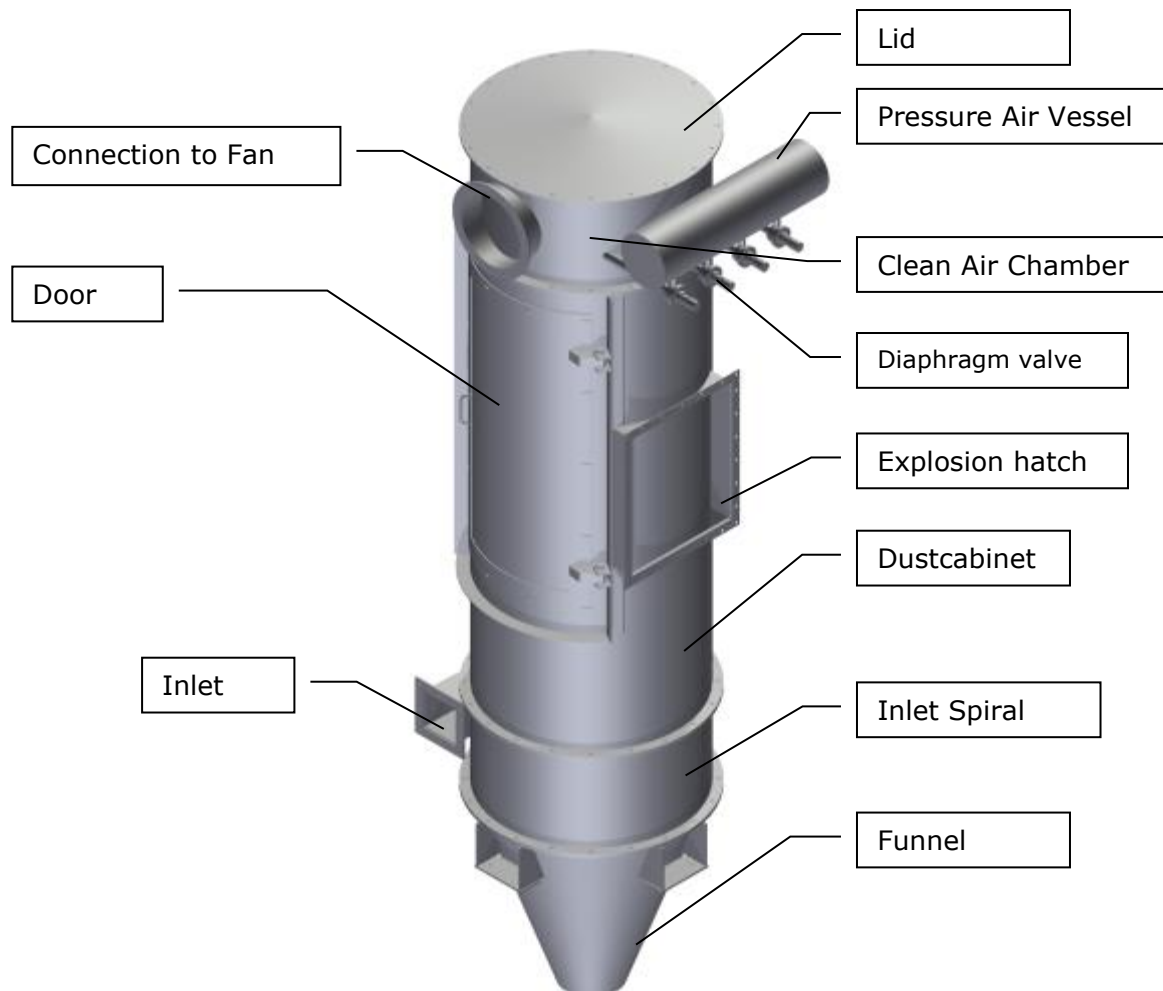

POS

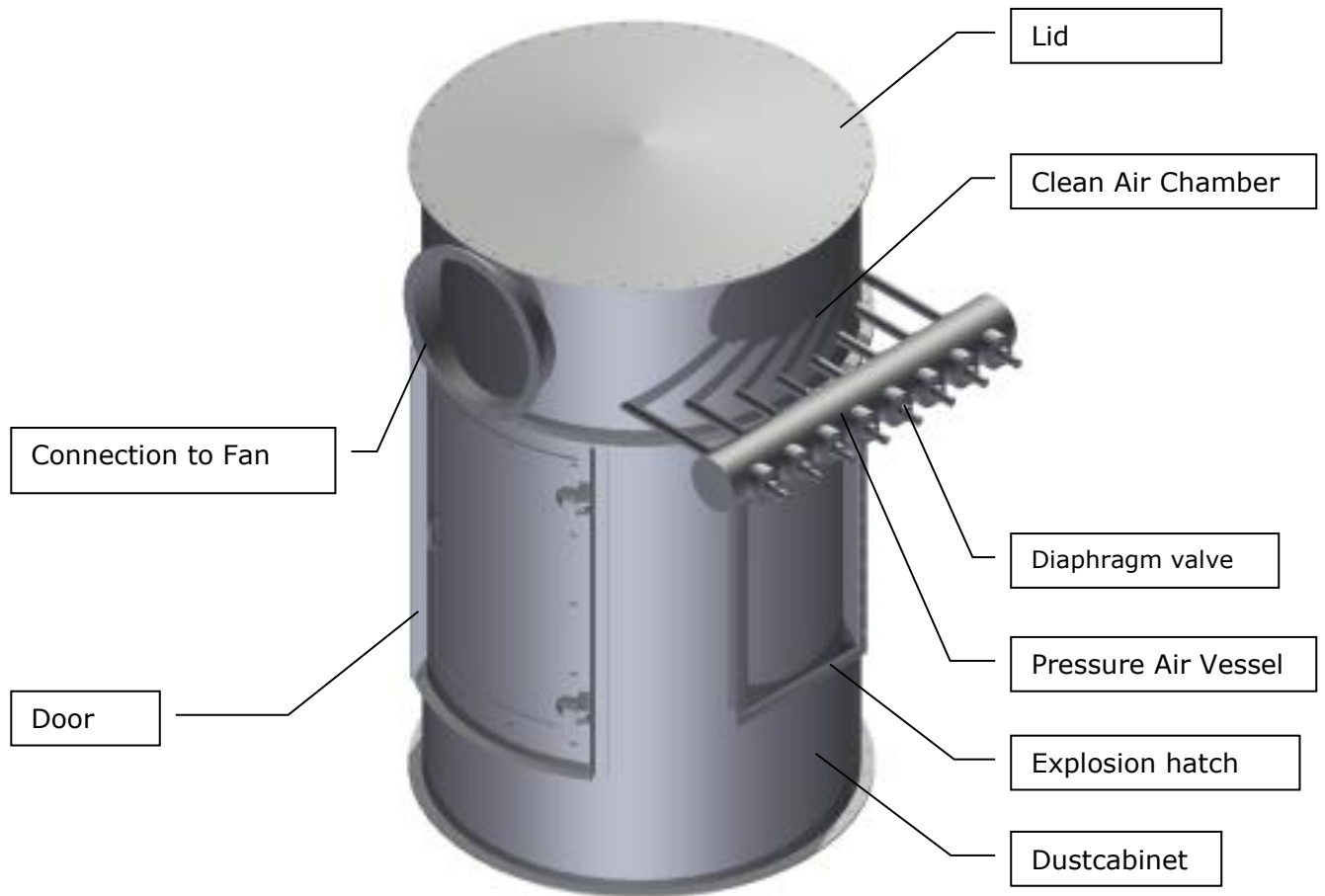

PCS

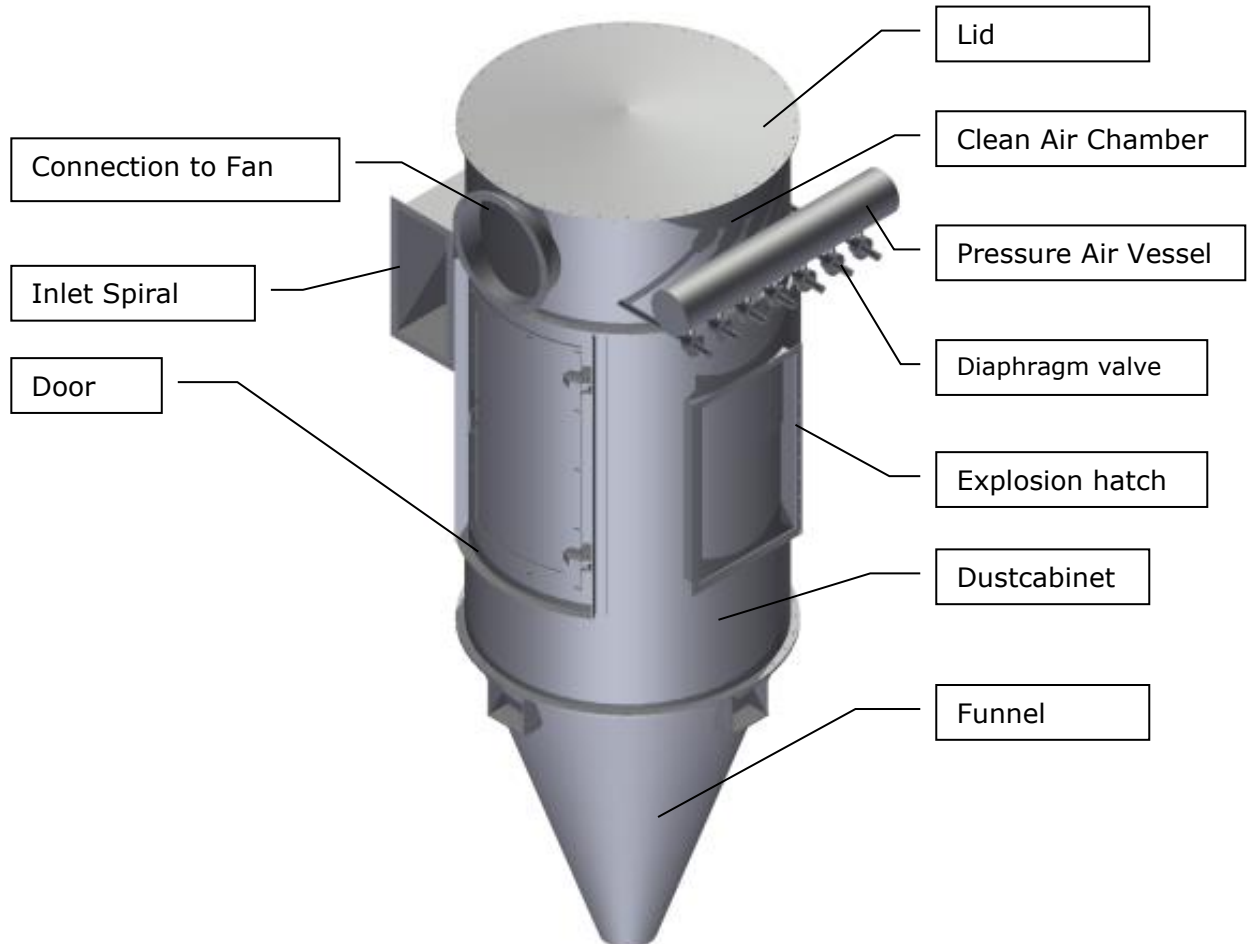

PCU

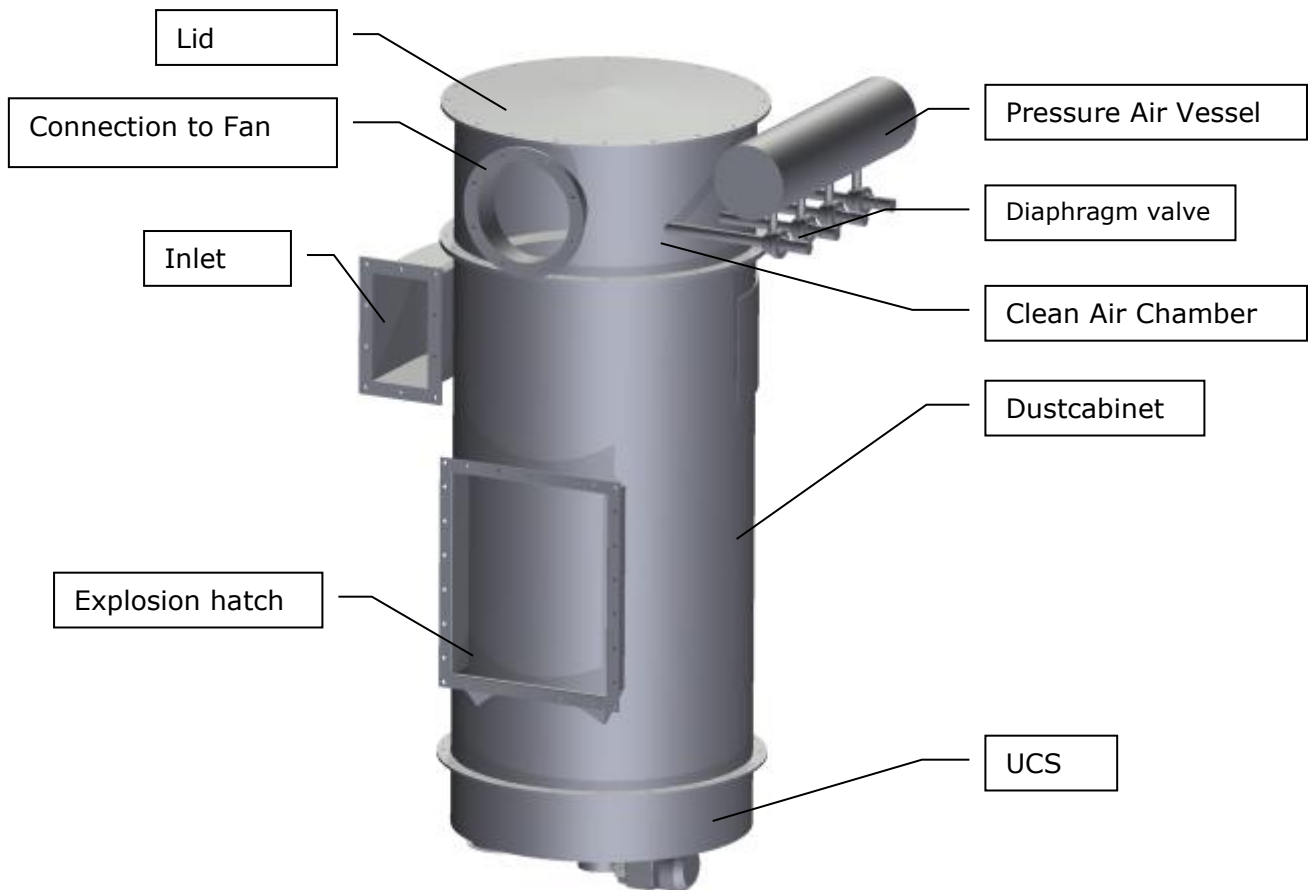

4.4 Operating controls

See chapter 8.

4.5 Global operation

The dust from the air blown in or sucked in the dust box is separated by a cyclone effect on the outside of the filter hoses, which are pushed over the filter baskets. The cleaned air passes through the pores of the filter hose to the clean air chamber. Afterwards the cleaned air leaves the filter through the air outlet opening.

Cleaning the filter hoses is achieved by blowing the filter hoses from the clean air side by using compressed air. The compressed air is supplied via a compressed air buffer tank on which membrane valves with a large passage are mounted. The pressure surge also creates a movement of the filter hoses so that the hose is "knocked" clean.

An electronically controlled unit opens in turn in a continuous cycle every valve, at predetermined intervals of 1 to 60 seconds. A short burst of compressed air enters the filter material at the clean air side. This causes the dust to fall down. In this way the filter hoses are cleaned one after the other. The duration of the short burst of compressed air is adjustable from 40 to 1000 milliseconds.

To get a good cleaning with minimum compressed air consumption, a controller can be built in that only cleans the filter hoses when differential pressure measurement across the filter hoses indicates that the contamination is greater than a preset value. The control unit is fully automatic.

5. Receipt, transport and storage

Receipt

Check the filter immediately after receipt for damage and report it to Poeth BV. Do not install damaged machines.

Transport

Make sure nobody is in front of, behind, on top of, underneath, beside or inside the machine during transport. A safe distance is 2x the height of the machine.

The transport temperature of this machine is the same as the ambient temperature (see section "Technical specifications").

The filter has been provided with bolt holes fit for lifting eyes and / or bow shackles. Only use approved lifting equipment of which you are certain it can safely lift the weight of the machine. Ensure secure attachment of the lifting equipment so that it cannot shift or become detached. Note the position of the centre of gravity.



Warning:

Never use the lifting eye of the drive motor to handle the machine.

During transport, also make sure that:

- the electrics and pneumatics of the installation are completely disconnected from the environment,
- the installation is clean, dry and empty,
- all components are adequately protected against ambient contamination and damage from the outside.

Storage

In case of temporary storage, the machine should be stored dry and protected from the weather.

Never place the machine directly on the floor but place it on a wooden pallet or other suitable surface to prevent collision damage or water and / or moisture damage.

6. Installation

6.1 Mechanical installation

Setting up

The cyclone filters are usually supplied in parts.

The insert frame (the plate to which the filter hoses are mounted) is delivered upside down on the filter head in most cases. It must be flipped over before assembly.

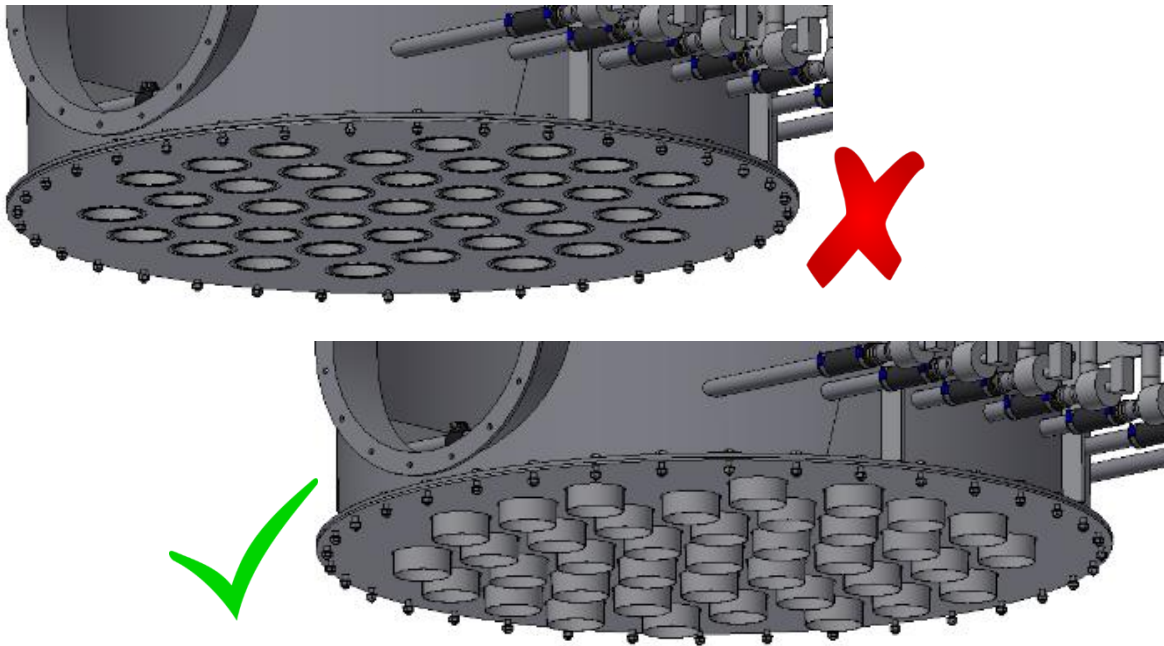

During the set-up of the machine, make sure there is ample space around the machine to be able to perform activities such as installation and maintenance.

If machines are set up on a raised platform, make sure to take measures to prevent parts/tools from falling down, thereby causing personal injury/damage.

The filter should be attached to the fixed world in such a way that it is impossible for it to come loose or topple over, and that the machine's stability and secure attachment are guaranteed at all times. Take into account not only the weight of the machine itself, but also the weight of the bulk material it may contain.

The supply and discharge openings of the machine have to be provided with special constructions (e.g. protective guards and connections to other machines/installations) to prevent any contact with moving parts.

The combination of this machine with other machines may not cause any further risks.

The machine must be set up level.

Protective guards

The mounting materials with which covers have been mounted, must never, under any conditions, be removed.

Protective guards of moving parts must remain in place during the complete life span of the machine.



Warning:

Under no circumstances may the moving parts be freely accessible! Contact with moving parts may lead to serious injury.



Warning:

Improper assembly from the filter can loosen the filter which can result into dangerous situations.

6.2 Electrical installation

Considering the fact that the electrical installation determines the safety of the machine to a major extent, it is of the utmost importance to ensure correct installation. Make sure all necessary safety measures are taken to ensure sufficiently safe operation of the machine. The drive motor has to be included in the safety circuit in conformity with the regulations.

In order to prevent unexpected switching on of the machine during maintenance, etc., the drive motor **must be provided with a manually operated operating switch that can be locked in switched-off position**. This operating switch must be positioned in such a way that it is well visible during the work that is done to the machine, while the machine is well visible during operation of this operating switch. It must be impossible to undo the switching off of the drive motor using this operating switch from any other location.

Furthermore, the operating switch must switch all phases/terminals and null. It must be of reliable quality and adapted to the motor power (both peak and continuous).



Warning:

If the necessary safety provisions within the complete installation are not provided, this may lead to life-threatening situations.

Power supply controller

See chapter 8.

Further guidelines

- Mount 24VDC cables and pneumatically hoses separated from power cables..
- Avoid interference fields as twisted cables and use shielded cables.
- Be sure all power systems (pneumatic and electric) are switched off when maintenance is going to be done.
- Change fuses only with the same type.
- Use wiring with enough thickness if especially a 24VDC power supply controller is used.
- Don't start the filter when the is opened.
- Disconnecting cable connections can't and should not be done during operation.

6.3 Pneumatic connection

The machine may only be connected within the operating limits indicated in the section "Technical specifications".

The maximum operating temperature of the diaphragm valve is 20°C to +85°C.
The compressed air storage tank has to be connected to the compressed air supply (at least 4 bar, a maximum of 5 bar).

If no oil or water-free compressed air is available, an oil-water separator should be mounted just before the vessel.



Warning :

To be not aware of the dangers while settings are done can lead to very dangerous situations.

Making the pneumatic installation pressureless

Pressure relief of the buffer tank for repairs or maintenance can be done in several ways:

1. Close the compressed air valve on the buffer tank and open the mini ball valve to empty the tank.
2. Close the compressed air valve on the buffer tank and have the system cleaned another 5 to 10 times until the tank is empty.
3. Take the pressure off of the general mains system.

6.4 Filter controller

Different filter controllers are possible for the filter. See chapter 8.

7. Commissioning

The machine is intended to become a part of a complete installation and may therefore not be used as a standalone machine. The machine may not be commissioned before all conditions listed in section "Installation" have been met and the installation has been declared in conformity with the provisions of the Machine Directive. If the mechanical and/or electrical installation has been executed by third parties, the manufacturer will not be held liable for any damage and/or injury caused by any shortcomings therein.

Before commissioning this machine, the different parts must be inspected on correct operation. Because dangerous situations may develop during these inspections (e.g. because of an incorrectly connected operating switch or the missing of protective guards), all persons involved must be aware of the increased risks of accidents during such a first commissioning.

Make sure the workplace is tidy, neat and well organised.

Make sure to keep a safe distance from moving parts when switching on the drive motor, connecting up the compressed air, and carrying out the inspections.



Warning:

Failing to be fully aware of the risks during commissioning of the machine may lead to life-threatening situations.

7.1 Inspections

After installation and connection of the power voltages, the following inspections must at least be carried out:

1. Ensure that there are no loose parts (tools, etc.) lying in or on the filterunit,
2. Check the air pressure in the pressure vessel. It must be between 4 and 5 bar.
3. Make sure the filter controller is switched on before the fan starts.
4. Start the fan
5. Check the rotation of the fan. The direction must match with the attached label,
6. Check the free movement of all moving parts,
7. Check for one cycle if all filter hoses are being cleaned. For this purpose the door has to be opened.
8. Check if the air pressure rises enough between 2 cleaning pulses.
9. Inspect the filter unit to run correctly.

When all inspections have been carried out and the results are satisfactory, and all protective guards and safety provisions are in place, the machine may be commissioned.

8. Operation

The operation of the filter is in the form of a controller. There are multiple types of filter controllers possible for the filter. See separate manual

Examples of filter controllers:

- WK Basic
- WK Economic

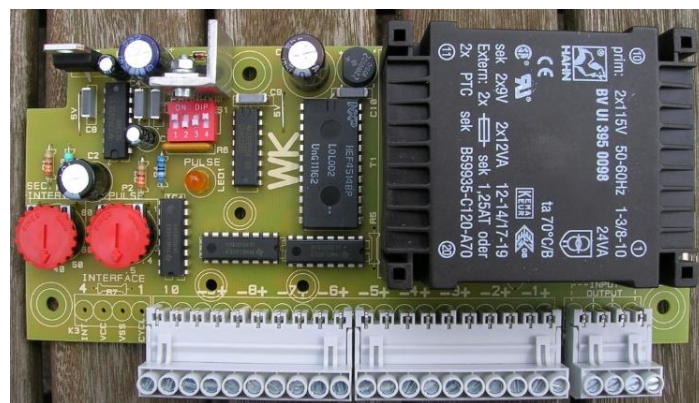

WK Basic



WK Economic

8.1 Decommissioning

Procedure:

1. Remove the products from the machine and empty the product reservoirs,
2. Stop the machine as written in by the main contractor or his authorised representative user manual,
3. Execute the usual maintenance.

9. Maintenance



Warning:

Maintenance work may only be done by authorised maintenance and/or service technicians. Incompetence may lead to life-threatening situations.

Interrupt the power (mains voltage) before inspecting the machine/installation by switching off the operating switch or pulling the plug from the socket.

If the machine/installation has been completely switched off for maintenance or repair work, it must be secured against unexpected reconnecting.

For example by:

1. Disconnecting the drive motor from the fan from the mains by means of the operating switch. Make sure this switch is locked during the work (for example by means of a padlock),
2. Disconnect the filter unit from the pressure air by closing the main valve,
3. Release pressure from the vessel.
4. Disconnect the controller from the power supply.
5. Keep out unauthorised persons from the immediate vicinity of the machine, for example by means of demarcation tape. Also place warning signs to draw attention to the fact that the machine concerned is being maintained and must not be switched on,
6. Make sure to depressurise, disconnect or switch off any connected components such as filters, sliding cabinets and/or conveyors.

If the work has to be done with the power supply to the machine/installation switched on, make sure there is an extra person present to operate the emergency switch or the operating switch in case of an emergency.



Warning:

Before starting maintenance, be sure the air pressure in the vessel is released to 0 bar, so there is no risk of eye injury.

Never remove lids and protective guards of moving parts (e.g. inspection hatches, etc.) unless this is absolutely necessary to carry out maintenance work. Immediately upon conclusion of the work, make sure that all lids and protective guards are put back.

Never leave the machine running if moving parts are easily accessible, for example when the protective guards are not in place.

After maintenance activities, carry out the relevant inspections as described in the section "Commissioning".

Make sure to carefully connect and secure loose parts and large units to lifting equipment, so that these cannot cause any danger. Only use lifting equipment that is suitable, approved and technically sound, and which has sufficient capacity. Never go underneath suspended loads and do not perform any work underneath these.

Any work of an electrotechnical, pneumatic or hydraulic nature must be carried out by personnel with special knowledge and experience in the area concerned.

If work has to be done to pressure pipelines or expansion vessels (e.g. compressed air, hydraulics), the pipeline/unit has to be depressurised according to the instructions before the work is started.



Warning:

If the drive motor is incompetently installed or repaired, this may lead to dangerous situations. Make sure to carefully study the user manuals included in the delivery of the drive motor first.



Warning:

before performing maintenance on the machine, silo or bin where the filter is mounted on, turn the filter off and make the air vessel pressure less.

9.1 Preventive maintenance

Make sure to perform the periodic inspections prescribed and the terms as indicated in the user manual!

Spare parts have to meet the technical requirements laid down by the manufacturer. This is automatically guaranteed if genuine spare parts are used.

Make sure everything is clean before starting on any maintenance work.

If necessary, cover the inlet and outlet during maintenance work so that any tools or parts dropped cannot disappear in the installation and cause damage there.

During maintenance of machines that are installed on a raised platform, make sure to take measures to prevent parts/tools from falling down, thereby causing personal injury/damage.

Description of part	Check 1x per...	Maintenance 1x per...	Grease 1x per...	Remarks
Electrical equipment	Month			Visual check for damage and correct cable connections
Warning stickers	Month			Readability check and replace stickers if necessary
Diaphragm valves	Year			Verify proper operation of the valves
Dust leakage	Quarter Year			Visual check for pollution
Air pressure	Quarter Year			Visual check for air pressure. The pressure in the vessel must be between 4 and 5 bar.
Filter hoses	Quarter Year	Depending on product		Visual check on damage.

9.2 Assembly and disassembly of the filter hoses



Warning:

While changing filter hoses, use an mask and gloves. Any additional measures should be taken when working with hazardous substances.



The filter hoses can be removed from the dust air side. To do so, follow the next steps:

1. Take off the filter hose (3) and the cage (2) by unscrewing the clamping ring (1).
2. Remove the filter cage by pulling him out of the filter hose
3. Remove the old filter hose.
4. Pull the new filter hose over the filter cage.
- 5. Fold the filter hose inwards into the cage.**
6. Put the cage with the hose onto the collar with the hose clamp.

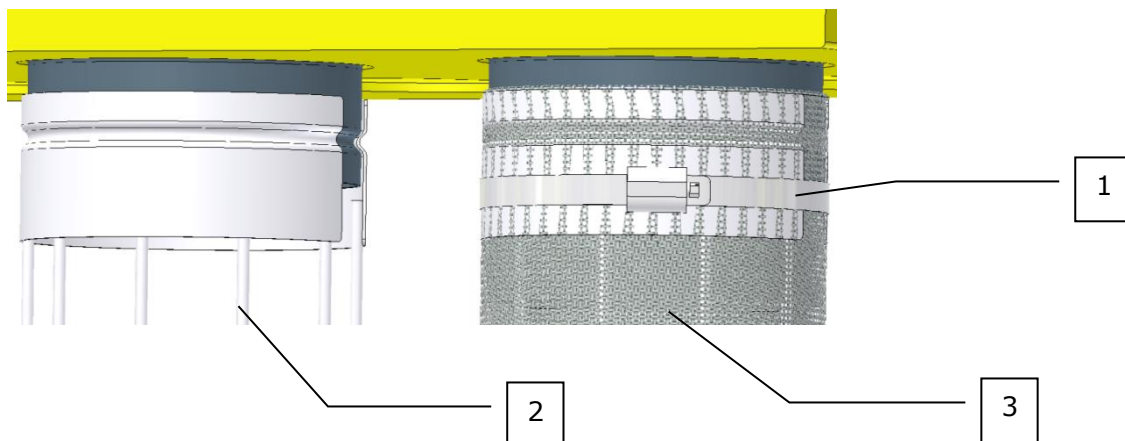

Detailed and comprehensive instruction is available on request

9.3 Diaphragm valves

There are two different kinds of valves which can be used.

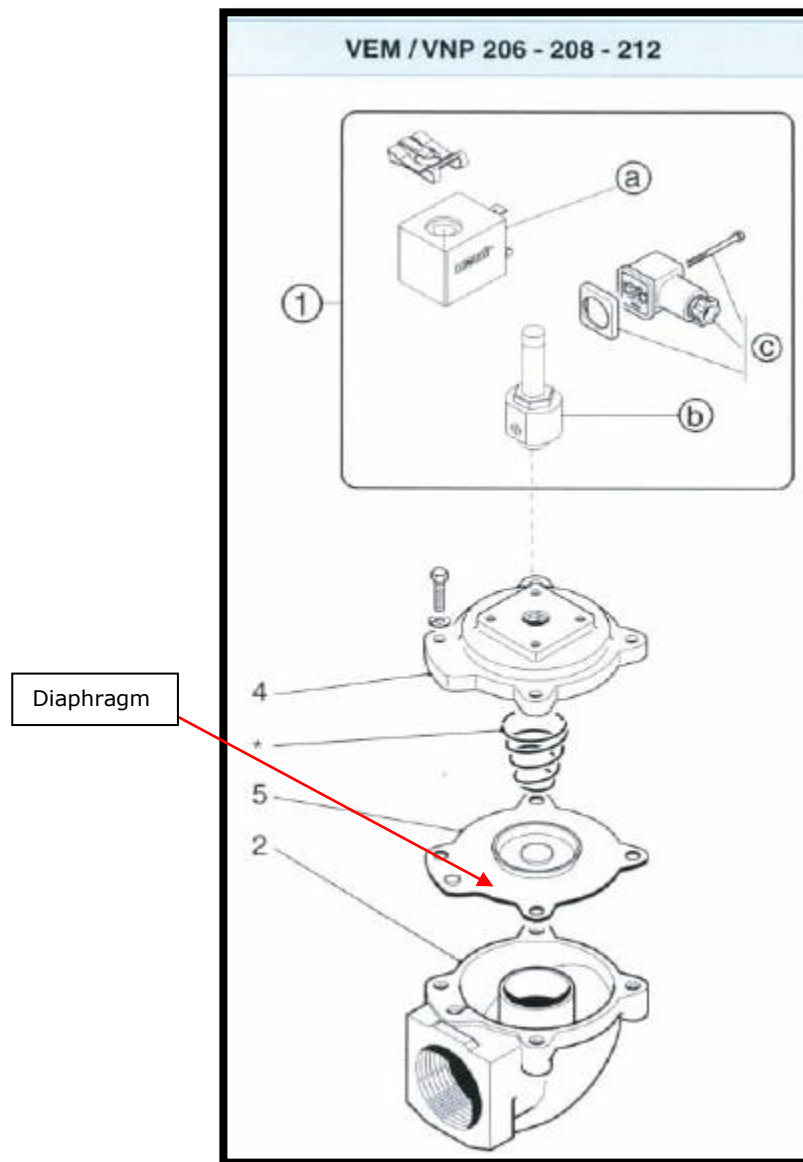

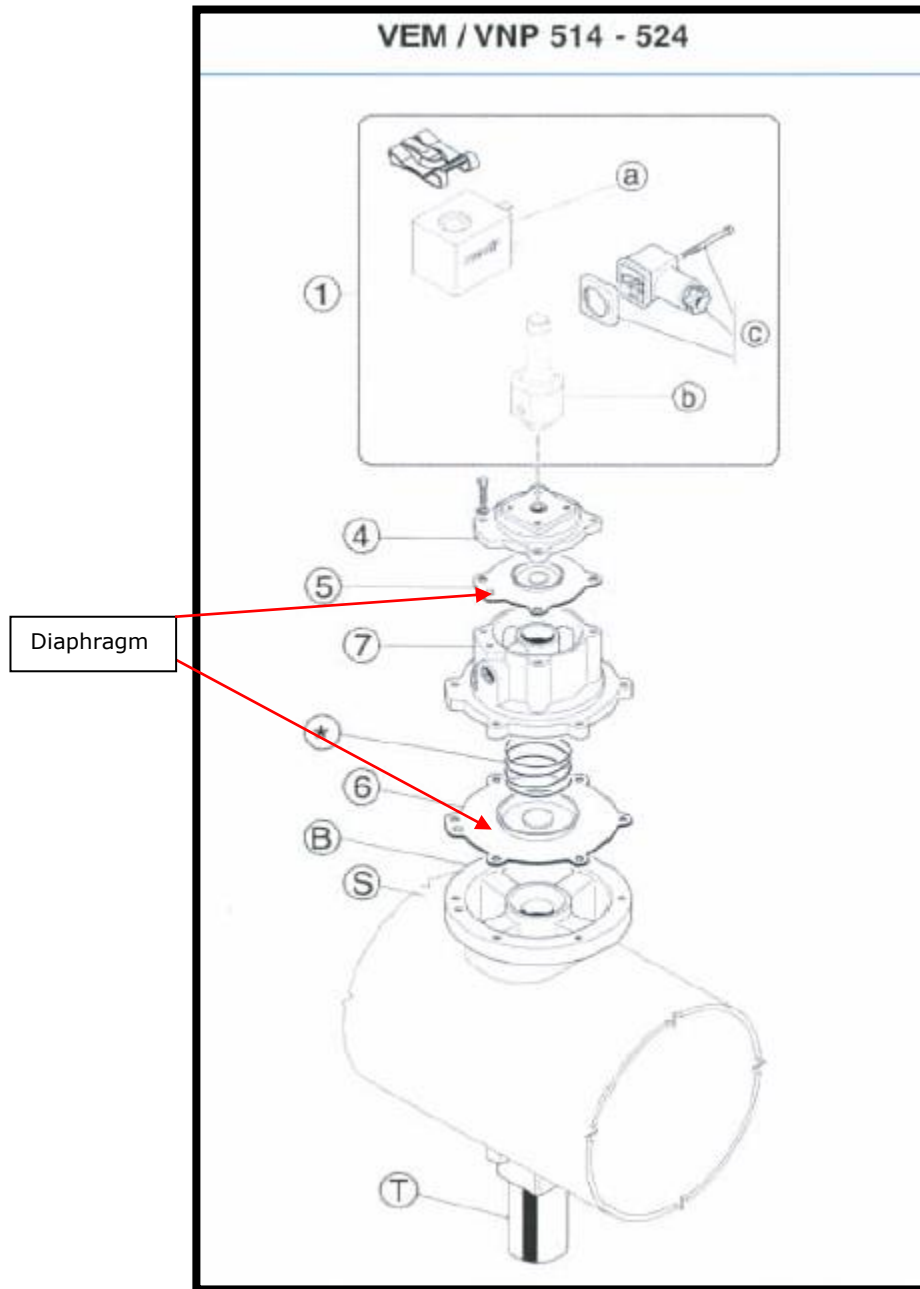

9.4 Spare and replacement parts

When ordering spare or replacement parts from Poeth BV, make sure to state the following data:

- Order number filter.....:

Poeth BV strongly advises to keep certain parts in stock because of their susceptibility to wear and/or to avoid machine downtime while the parts concerned are being ordered. Spare parts are not normally included in the delivery of the machine.

Typical spare and wear parts for this machine are the

- filter hoses;
- membranes;
- pilot valves.

You can find the correct types and numbers in the parts list included on the drawing.

Only use genuine Poeth BV parts. If any component is replaced by a component of another brand or type, all warranty and liability for Poeth BV will lapse.

10. Disposal of the machine or machine parts



Warning:

Each person responsible for operation or maintenance of the machine/installation must have read the user manual before starting any work! In particular the safety section.

During disposal of the machine/installation or parts thereof, make sure to take the following into account:

1. stop the machine/installation according to the instructions,
2. make sure there is no energy left – in any form – stored in the machine/ installation,
3. make sure that pressurised parts are depressurised by competent personnel,
4. the installation must be cleared of product or product residues,
5. during disassembly, make sure to carefully connect and secure loose parts and large units to lifting equipment, so that these cannot cause any danger. Only use lifting equipment that is suitable, technically sound, and approved, and which has sufficient capacity. Never go underneath suspended loads and do not perform any work underneath these,
6. scrap the installation according to the locally applicable regulations.

11. Appendices

11.1 CE conformity statement

Conformity statement

(Directive 2006/42/EC, Appendix II, sub building-in statement)

Prohibition of operation



Poeth BV
Tichlouwstraat 5
5932 AC Tegelen
The Netherlands

declares that:

the cyclone filter PBS, PCS, PZS, POS, PCU

- is intended to be built into a machine or assembled together with other machines and does not (in itself) meet the Machine Directive (2006/42/EC);

The Netherlands, Tegelen
05-01-2023

General Manager:
Marc Peerlings

A handwritten signature in black ink, appearing to be "M. Peerlings", written over a light blue grid background.

General remark with the building-in statement

Because this product is not intended as a standalone machine and is, therefore, yet to be built into a complete machine, this product is supplied with a building-in statement. The manufacturer himself who is going to build in this product is to ensure the CE marking of the final machine.