

Health and Safety Notice
 The following technical health and safety notes have not been addressed by design and are identified below.
 Refer to Design Risk Assessments Ref: 2017069-DR-A001.
 Safe methods and systems of work remain the responsibility of the contractor.

This drawing is to be read in conjunction with:
 Specification Ref: 2017069-005 Drainage

LEGEND
 --- INDICATES SURFACE WATER, ALL 1500 LINS
 --- INDICATES FOUL WATER, ALL 1500 LINS

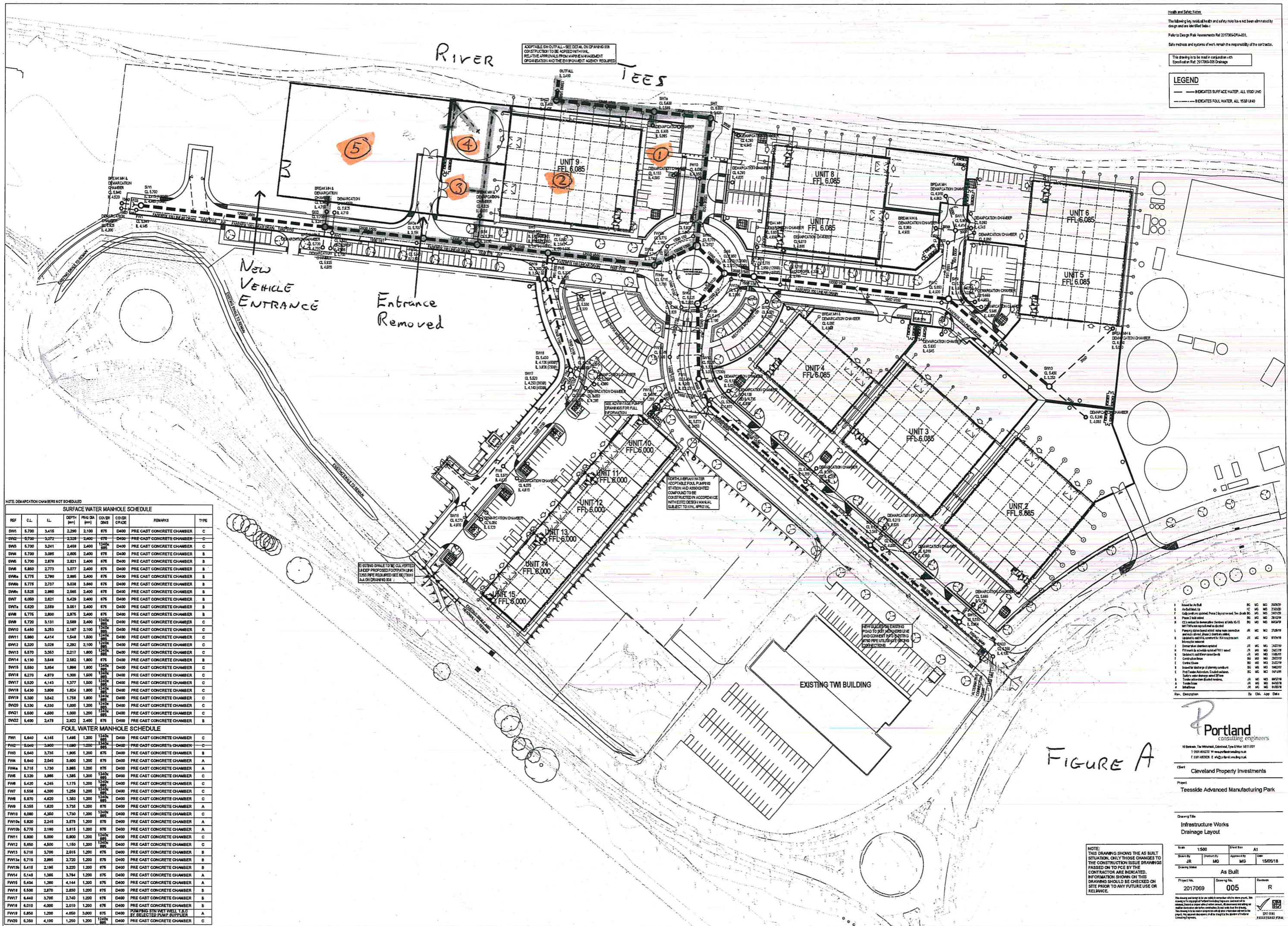

NOTE: DEMARCATION CHAMBERS NOT SCHEDULED

REF	CL	IL	DEPTH (mm)	FRING DIA (mm)	COVER DIA (mm)	COVER GRADE	REMARKS	TYPE
DW1	6.700	3.416	2,290	2,100	675	D400	PRE CAST CONCRETE CHAMBER	C
DW2	6.700	3.272	2,320	2,400	675	D400	PRE CAST CONCRETE CHAMBER	C
DW3	6.700	3.241	2,460	2,400	675	D400	PRE CAST CONCRETE CHAMBER	C
DW4	6.700	3.095	2,400	2,400	675	D400	PRE CAST CONCRETE CHAMBER	B
DW5	6.700	2.879	2,821	2,400	675	D400	PRE CAST CONCRETE CHAMBER	B
DW6	6.850	2.773	3.077	2,400	675	D400	PRE CAST CONCRETE CHAMBER	B
DW7	6.775	2.790	2,865	2,400	675	D400	PRE CAST CONCRETE CHAMBER	B
DW8	6.775	2.737	3.038	2,400	675	D400	PRE CAST CONCRETE CHAMBER	B
DW9	6.525	2.980	2,565	2,400	675	D400	PRE CAST CONCRETE CHAMBER	B
DW10	6.050	3.421	3,420	2,400	675	D400	PRE CAST CONCRETE CHAMBER	B
DW11	6.420	2.559	3.051	2,400	675	D400	PRE CAST CONCRETE CHAMBER	B
DW12	6.775	3.000	2,875	2,400	675	D400	PRE CAST CONCRETE CHAMBER	B
DW13	6.720	3.131	3,589	2,400	675	D400	PRE CAST CONCRETE CHAMBER	C
DW14	6.450	3.253	2,187	2,100	675	D400	PRE CAST CONCRETE CHAMBER	C
DW15	6.860	4.114	1,548	1,500	675	D400	PRE CAST CONCRETE CHAMBER	C
DW16	6.520	3.020	2,292	2,100	675	D400	PRE CAST CONCRETE CHAMBER	C
DW17	6.570	3.353	2,317	1,800	675	D400	PRE CAST CONCRETE CHAMBER	C
DW18	6.130	3.848	2,562	1,800	675	D400	PRE CAST CONCRETE CHAMBER	B
DW19	6.560	3.654	1,866	1,800	675	D400	PRE CAST CONCRETE CHAMBER	C
DW20	6.270	4.870	1,300	1,600	675	D400	PRE CAST CONCRETE CHAMBER	C
DW21	6.520	4.143	1,377	1,600	675	D400	PRE CAST CONCRETE CHAMBER	C
DW22	6.430	3.806	1,824	1,800	675	D400	PRE CAST CONCRETE CHAMBER	C
DW23	6.530	3.542	1,758	1,800	675	D400	PRE CAST CONCRETE CHAMBER	C
DW24	6.330	4.330	1,000	1,200	675	D400	PRE CAST CONCRETE CHAMBER	C
DW25	6.500	4.500	1,000	1,200	675	D400	PRE CAST CONCRETE CHAMBER	C
DW26	6.400	2.478	2,822	2,400	675	D400	PRE CAST CONCRETE CHAMBER	B

REF	CL	IL	DEPTH (mm)	FRING DIA (mm)	COVER DIA (mm)	COVER GRADE	REMARKS	TYPE
FW1	6.840	4.148	1,488	1,200	1,200	D400	PRE CAST CONCRETE CHAMBER	C
FW2	6.040	3.900	1,080	1,200	675	D400	PRE CAST CONCRETE CHAMBER	C
FW3	6.840	3.735	1,905	1,200	675	D400	PRE CAST CONCRETE CHAMBER	B
FW4	6.840	2.240	3,400	1,200	675	D400	PRE CAST CONCRETE CHAMBER	A
FW5	6.715	1.730	3,985	1,200	675	D400	PRE CAST CONCRETE CHAMBER	A
FW6	6.320	3.885	1,285	1,200	675	D400	PRE CAST CONCRETE CHAMBER	C
FW7	6.420	4.241	1,175	1,200	675	D400	PRE CAST CONCRETE CHAMBER	C
FW8	6.538	4.300	1,258	1,200	675	D400	PRE CAST CONCRETE CHAMBER	C
FW9	6.870	4.820	1,360	1,200	675	D400	PRE CAST CONCRETE CHAMBER	C
FW10	6.555	1.820	3,735	1,200	675	D400	PRE CAST CONCRETE CHAMBER	A
FW11	6.080	4.260	1,730	1,200	675	D400	PRE CAST CONCRETE CHAMBER	C
FW12	6.820	2.248	3,876	1,200	675	D400	PRE CAST CONCRETE CHAMBER	A
FW13	6.775	2.190	3,816	1,200	675	D400	PRE CAST CONCRETE CHAMBER	A
FW14	6.800	6.000	0,800	1,200	675	D400	PRE CAST CONCRETE CHAMBER	C
FW15	6.850	4.500	1,150	1,200	675	D400	PRE CAST CONCRETE CHAMBER	C
FW16	6.715	3.700	2,915	1,200	675	D400	PRE CAST CONCRETE CHAMBER	B
FW17	6.715	2.895	2,720	1,200	675	D400	PRE CAST CONCRETE CHAMBER	B
FW18	6.415	2.195	3,220	1,200	675	D400	PRE CAST CONCRETE CHAMBER	B
FW19	6.148	1.365	3,784	1,200	675	D400	PRE CAST CONCRETE CHAMBER	A
FW20	6.404	1.260	4,144	1,200	675	D400	PRE CAST CONCRETE CHAMBER	A
FW21	6.500	2.870	2,830	1,200	675	D400	PRE CAST CONCRETE CHAMBER	B
FW22	6.440	3.700	2,740	1,200	675	D400	PRE CAST CONCRETE CHAMBER	B
FW23	6.010	4.000	2,010	1,200	675	D400	PRE CAST CONCRETE CHAMBER	B
FW24	6.850	1.200	4,850	3,000	675	D400	PUMPING STATION W/ 1.8m ³ BY SELECTOR PUMP SUPPORT	A
FW25	6.350	4.100	1,250	1,200	675	D400	PRE CAST CONCRETE CHAMBER	C

1	Issued for A/B	BC	MS	20/02/20
2	As Built	BC	MS	20/02/20
3	As Built	BC	MS	20/02/20
4	As Built	BC	MS	20/02/20
5	As Built	BC	MS	20/02/20
6	As Built	BC	MS	20/02/20
7	As Built	BC	MS	20/02/20
8	As Built	BC	MS	20/02/20
9	As Built	BC	MS	20/02/20
10	As Built	BC	MS	20/02/20
11	As Built	BC	MS	20/02/20
12	As Built	BC	MS	20/02/20
13	As Built	BC	MS	20/02/20
14	As Built	BC	MS	20/02/20
15	As Built	BC	MS	20/02/20
16	As Built	BC	MS	20/02/20
17	As Built	BC	MS	20/02/20
18	As Built	BC	MS	20/02/20
19	As Built	BC	MS	20/02/20
20	As Built	BC	MS	20/02/20
21	As Built	BC	MS	20/02/20
22	As Built	BC	MS	20/02/20
23	As Built	BC	MS	20/02/20
24	As Built	BC	MS	20/02/20
25	As Built	BC	MS	20/02/20
26	As Built	BC	MS	20/02/20
27	As Built	BC	MS	20/02/20
28	As Built	BC	MS	20/02/20
29	As Built	BC	MS	20/02/20
30	As Built	BC	MS	20/02/20

Portland
 consulting engineers
 10 Broomfield Way, Teeside, Middlesbrough, Cleveland, TS20 1JH
 T: 01642 803200 F: 01642 803201 E: info@portland.co.uk

Client: Cleveland Property Investments
 Project: Teeside Advanced Manufacturing Park

Drawing Title	
Infrastructure Works Drainage Layout	
Scale: 1:500	Sheet No: A1
Drawn by: JR	Checked by: MG
Approved by: MG	Date: 15/05/18
Drawing Status: As Built	
Project No: 2017069	Drawing No: 005
Revision: R	Date: 15/05/18

NOTE: THIS DRAWING SHOWS THE AS BUILT SITUATION. ONLY THOSE CHANGES TO THE CONSTRUCTION ISSUE DRAWINGS PASSED ON TO PCE BY THE CONTRACTOR ARE INDICATED. INFORMATION SHOWN ON THIS DRAWING SHOULD BE CHECKED ON SITE PRIOR TO ANY FUTURE USE OR RELIANCE.

FIGURE A