

Notes:

1. THIS DRAWING MUST NOT BE REPRODUCED IN WHOLE OR PART OR USED FOR THE MANUFACTURE OF ANY ARTICLE WITHOUT THE EXPRESS PERMISSION OF THE COPYRIGHT HOLDERS. THE COPYRIGHT OF THIS CONFIDENTIAL DOCUMENT AND ALL INFORMATION CONTAINED IN IT IS OWNED BY MULLER UK & IRELAND UK. THIS DOCUMENT AND ALL INFORMATION CONTAINED IN IT ARE NOT TO BE MADE AVAILABLE TO THE PUBLIC OR TO ANYONE ELSE (WHETHER IN THE UNITED KINGDOM OR ELSEWHERE) BY WRITTEN OR ORAL DESCRIPTION, OR BY USE, OR IN ANY OTHER WAY, UNLESS BY PRIOR WRITTEN AUTHORITY FROM THE COPYRIGHT OWNER.
2. THIS DRAWING IS TO BE READ IN CONJUNCTION WITH ALL RELEVANT ENGINEERS & ARCHITECTS DWG, SCHEDULES & SPECIFICATIONS.
3. DO NOT SCALE DRAWING.

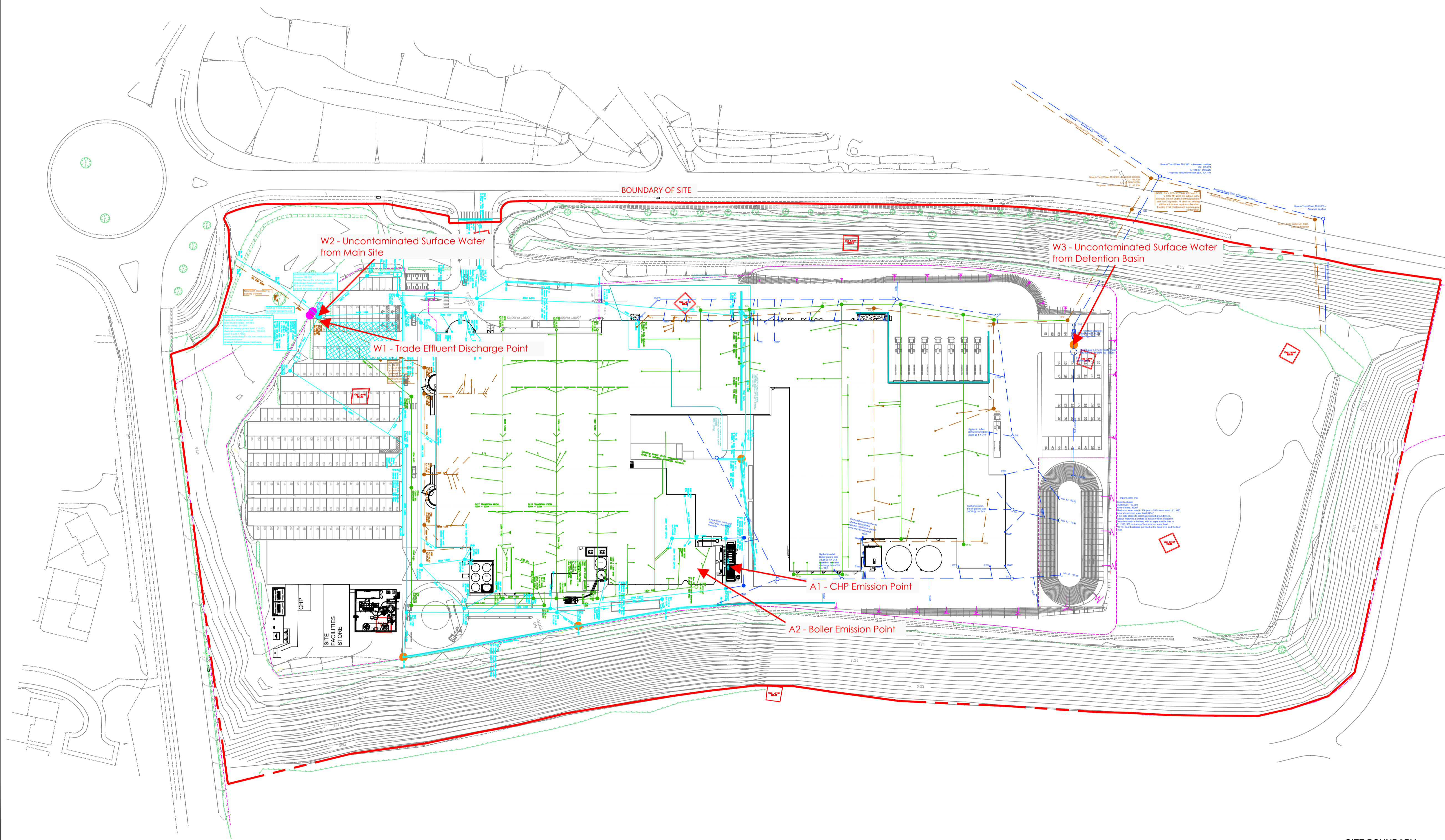

- - - - - SITE BOUNDARY
- — — — — SURFACE WATER
- - - - - STORM WATER
- - - - - FOUL
- — — — — EFFLUENT
- PENSTOCK
- PROPOSED PENSTOCK

Rev	Description	Approved	Date
A	Released As Built	K.H	28/03/19

STATUS: **Released**

müller Muller UK & Ireland Group LLP
 Tern Valley Business Park,
 Shrewsbury Road,
 Market Drayton,
 Shropshire, TF9 3SQ
 +44 (0)1630 692000

Project No: Drawing No: **WTE-SL-OV-0000**

Title: **Site Layout Overview Master**

Drawn By: Checked By: Date: