

Site Safety

- No Smoking**
- Eye Protection must be worn**
- Protective Gloves must be worn**
- High visibility jackets must be worn beyond this point**
- Hard hats must be worn on this site at all times**
- Ear Defenders must be worn**
- Protective footwear must be worn**

EMERGENCY ISOLATION POINTS

MANDATORY PPE AREA
SAFE WALKING ROUTE
INCOMING TRAFFIC
OUTGOING TRAFFIC
BARRIER

KEY PERSONNEL

FIRST AIDERS:

FIRE WARDENS:

EMERGENCY TEL:

INCIDENT HOTLINE: xxxxxx xxxxxxxx

ASSOCIATED DRAWINGS

SITE NAME
WALPOLE MRF (PROPOSED)

DRAWING TITLE
SITE SAFETY & INDUCTION LAYOUT SHEET 1 OF 2

DRAWING NUMBER
WAL-MRF2000

TASK NUMBER: 21406

SCALE: 1:2500 @ A2	REVISION
OID/DRN: R.L. Meaden	R/DRN
O/DATE: 07.06.2023	R/DATE
O/APP: L. Edmonds	R/APP
O/DATE:	R/DATE

INFORMATION TAKEN FROM

SURVEY SERVICES MASTER FILE: WAL 166s-May 2022 RevA

OTHER DRAWINGS: WAL 175-Proposed MRF Location-Op 3-Plan

NO UNAUTHORISED REPRODUCTION OR DISTRIBUTION

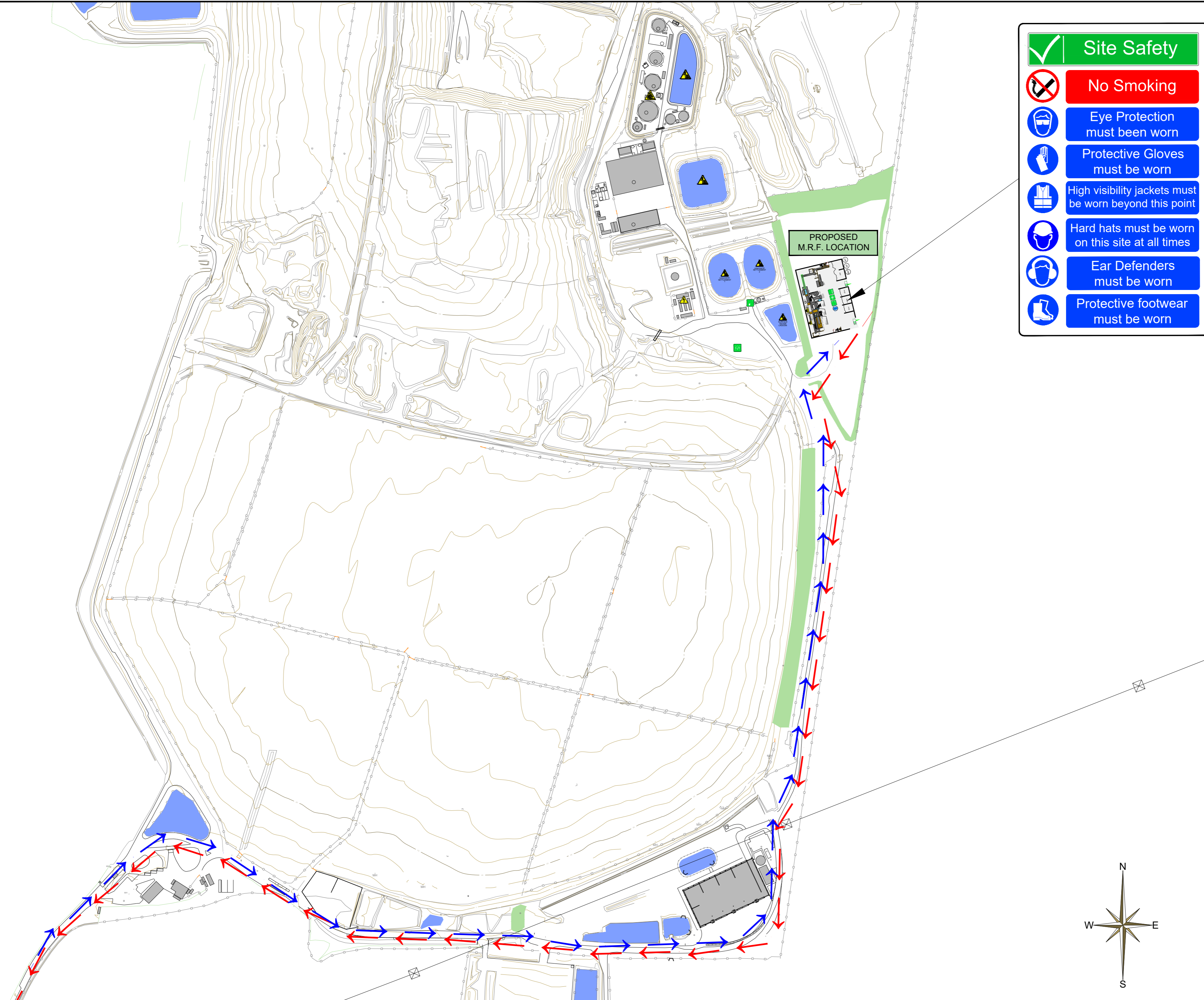

PROPOSED M.R.F. LOCATION

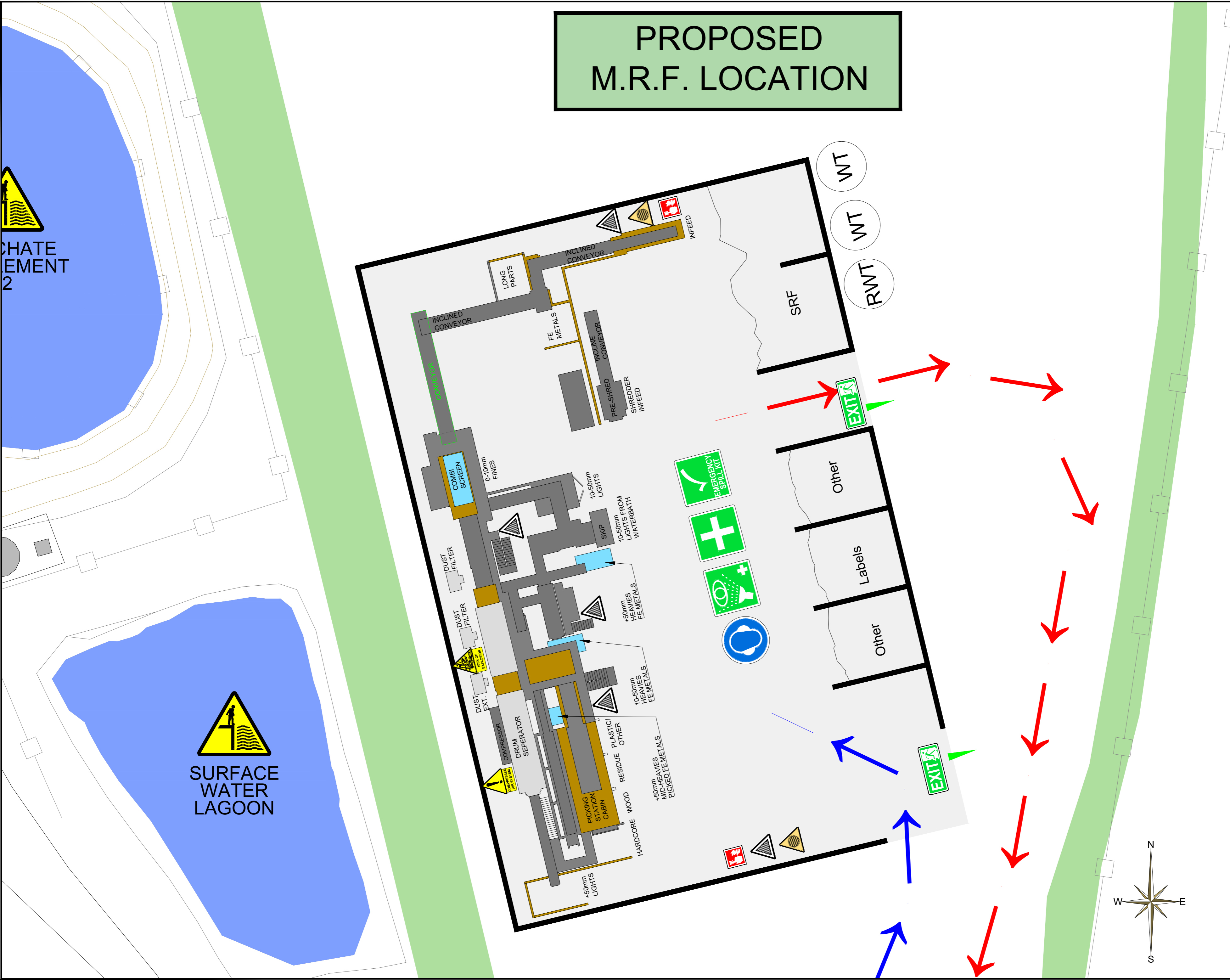

- ### EMERGENCY ISOLATION POINTS
- | | | | |
|---------------------------|-----------------------|----------------|-------------------------|
| FIRST AID KIT | EMERGENCY SHOWER | EYE WASH | HEART DEFIB |
| SPILL KIT | CRITICAL KEYS | EMERGENCY EXIT | MUSTER POINT |
| EMERGENCY INFORMATION | MANDATORY INFORMATION | NO SMOKING | DESIGNATED SMOKING AREA |
| AUTHORISED PERSONNEL ONLY | SPEED LIMIT 5 | TEXT DETAIL | TEXT DETAIL |
- ### HAZARDOUS MATERIALS
- | | |
|-----------------------|---------------------|
| HAZARDOUS INFLAMMABLE | FIRE-FIGHTING WATER |
|-----------------------|---------------------|
- ### KEY PERSONNEL
- | | | | |
|---------------------|--------------------------|-----------------|-----------------------|
| CALL POINT | FIRE ALARM CONTROL PANEL | FIRE HYDRANT | METER BOX |
| FIRE BLANKET | H ₂ O | CO ₂ | FOAM |
| POWDER | HAZARDOUS MATERIALS | HIGH VOLTAGE | HAZARDOUS INFLAMMABLE |
| HAZARDOUS CORROSIVE | HAZARDOUS OXIDISING | HAZARDOUS TOXIC | HAZARDOUS EXPLOSIVE |
- ### KEY PERSONNEL
- FIRST AIDERS:
- FIRE WARDENS:
- EMERGENCY TEL:
- INCIDENT HOTLINE: xxxxxx xxxxxxx

KEY PERSONNEL

FIRST AIDERS:

FIRE WARDENS:

EMERGENCY TEL:

INCIDENT HOTLINE: xxxxxx xxxxxxx

ASSOCIATED DRAWINGS

ASSOCIATED DRAWINGS

SITE NAME WALPOLE MRF (PROPOSED)	
DRAWING TITLE SITE SAFETY & INDUCTION LAYOUT SHEET 2 OF 2	
DRAWING NUMBER WAL-MRF2000	
TASK NUMBER 21406	
SCALE 1:250 @ A2	REVISION
OIDRN R.L. Meaden	R/DRN
O/DATE 07.06.2023	R/DATE
O/APP L. Edmonds	R/APP
O/DATE	R/DATE
INFORMATION TAKEN FROM SURVEY SERVICES MASTER FILE OTHER DRAWINGS	
WAL 166s-May 2022 RevA	
WAL 175-Proposed MRF Location-Op 3-Prelim	

