

© Crown Copyright. All Rights Reserved. License Number 100022432.

Envirocheck®

LANDMARK INFORMATION GROUP®

Groundwater Vulnerability

General

- ◊ Specified Site
- Specified Buffer(s)
- ✕ Bearing Reference Point
- Slice
- B Map ID

Agency and Hydrological

Bedrock Aquifers

- High Vulnerability, Principal Aquifer
- High Vulnerability, Secondary Aquifer
- Medium Vulnerability, Principal Aquifer
- Medium Vulnerability, Secondary Aquifer
- Low Vulnerability, Principal Aquifer
- Low Vulnerability, Secondary Aquifer

Superficial Aquifers

- High Vulnerability, Principal Aquifer
- High Vulnerability, Secondary Aquifer
- Medium Vulnerability, Principal Aquifer
- Medium Vulnerability, Secondary Aquifer
- Low Vulnerability, Principal Aquifer
- Low Vulnerability, Secondary Aquifer

Unproductive Aquifer

Soluble Rock

Site Sensitivity Context Map - Slice A

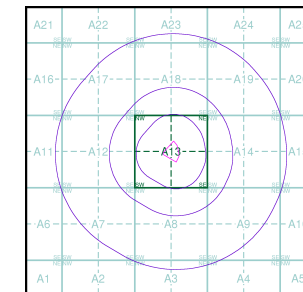

Order Details

Order Number: 340889871_1_1
 Customer Ref: TAR/BSN/PF/5759/01
 National Grid Reference: 350140, 309580
 Slice: A
 Site Area (Ha): 1.66
 Search Buffer (m): 1000

Site Details

Site at 350134, 309581

Landmark®
 INFORMATION GROUP

Tel: 0844 844 9952
 Fax: 0844 844 9951
 Web: www.envirocheck.co.uk

348500 349000 349500 350000 350500 351000 351500 352000

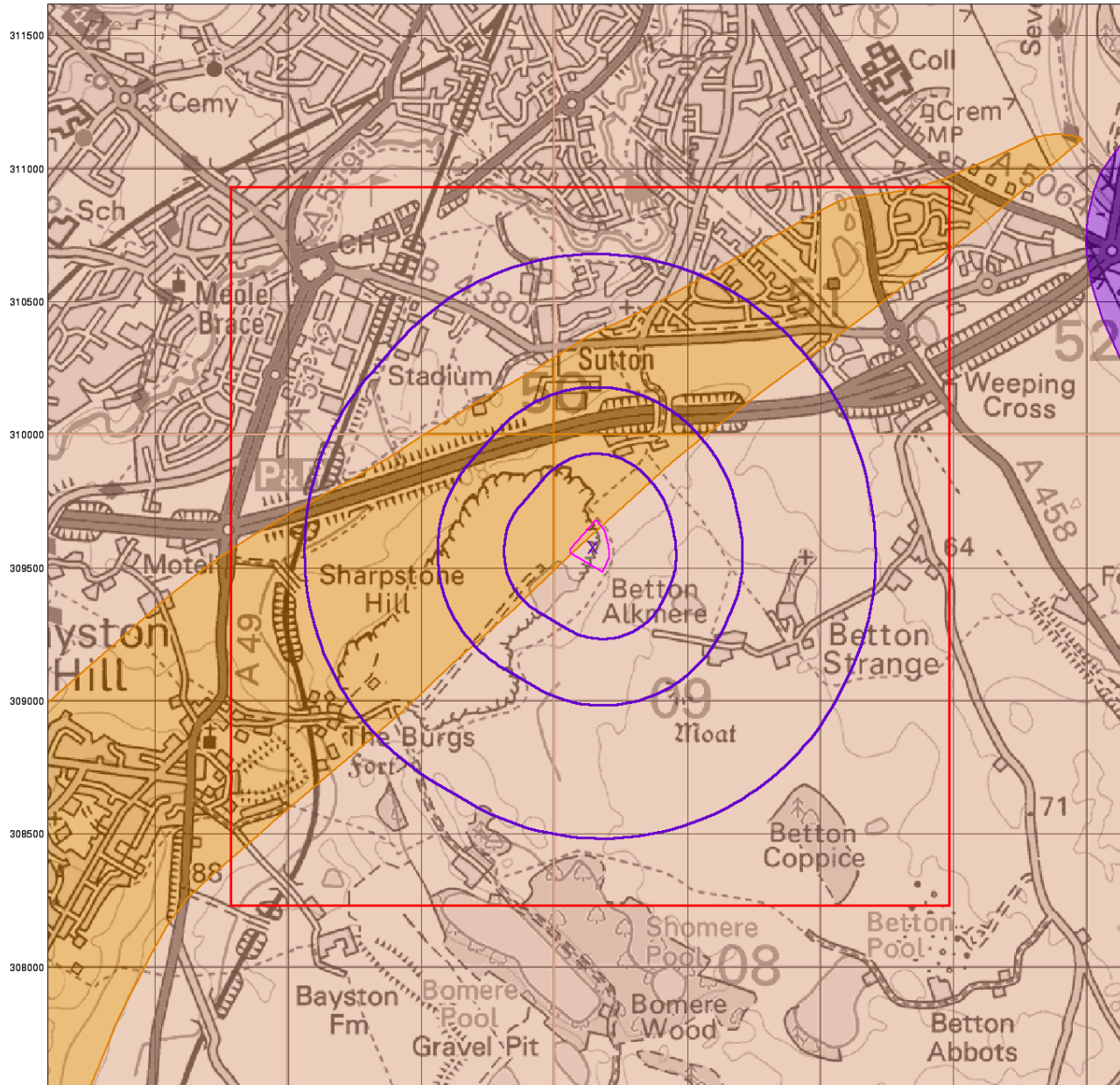

© Crown Copyright. All Rights Reserved. License Number 100022432

0 1 km

Envirocheck®

LANDMARK INFORMATION GROUP®

Bedrock Aquifer Designation

General

- Specified Site
- Specified Buffer(s)
- Bearing Reference Point
- Slice
- Map ID

Agency and Hydrological

Geological Classes

- Principal Aquifer
- Secondary A Aquifer
- Secondary B Aquifer
- Secondary Undifferentiated
- Unproductive Strata
- Unknown
- Unknown (Lakes and Landslip)

Site Sensitivity Context Map - Slice A

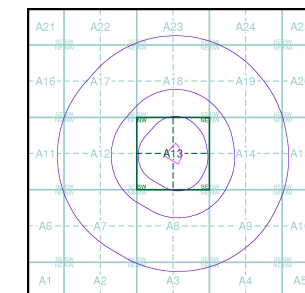

Order Details

Order Number: 340889871_1_1
 Customer Ref: TAR/BSN/PF/5759/01
 National Grid Reference: 350140, 309580
 Slice: A
 Site Area (Ha): 1.66
 Search Buffer (m): 1000

Site Details

Site at 350134, 309581

Landmark®
 INFORMATION GROUP

Tel: 0844 844 9952
 Fax: 0844 844 9951
 Web: www.envirocheck.co.uk

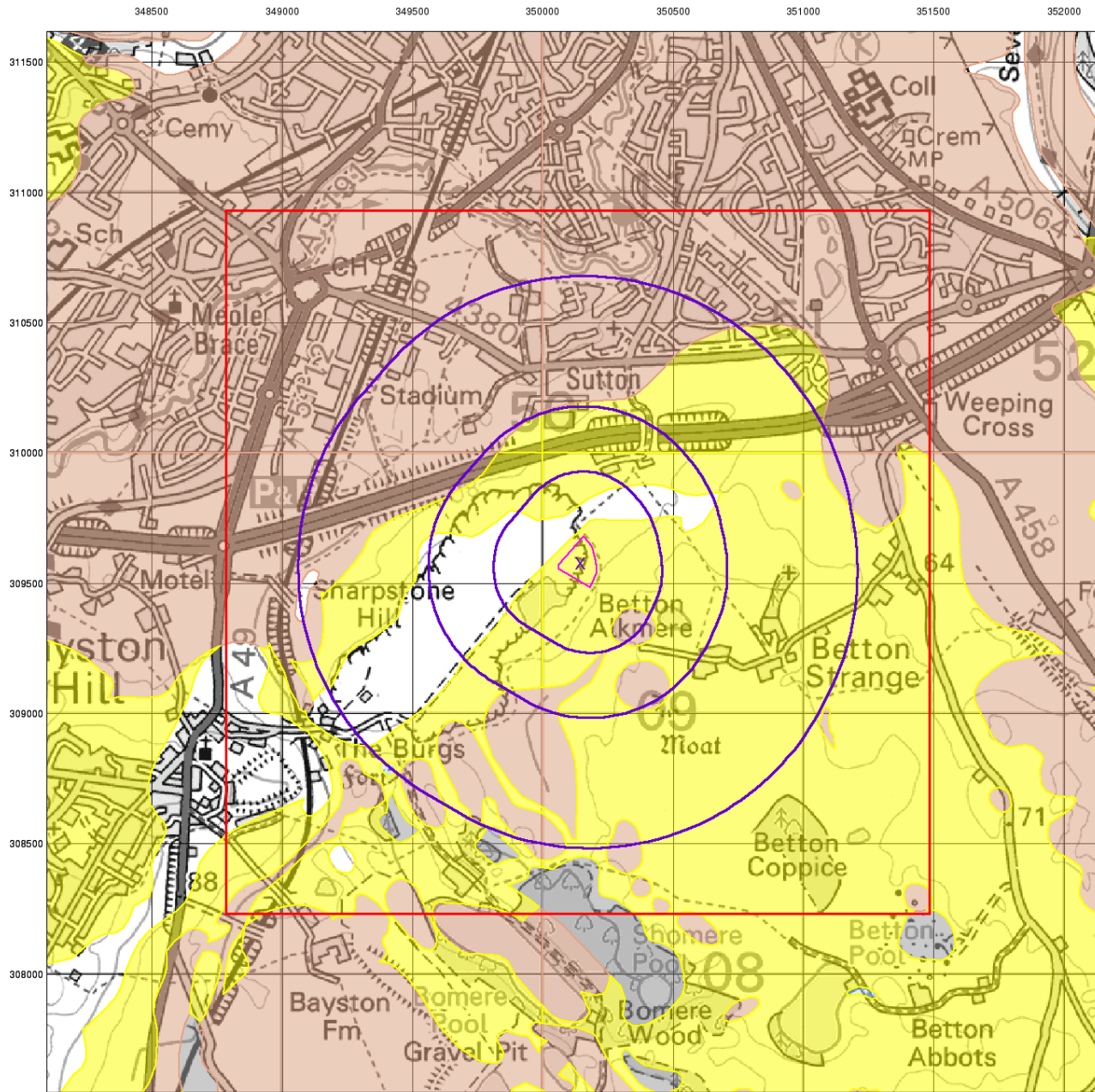

© Crown Copyright. All Rights Reserved. License Number 100022432.

Envirocheck®

LANDMARK INFORMATION GROUP®

Superficial Aquifer Designation

General

- Specified Site
- Specified Buffer(s)
- Bearing Reference Point
- Slice
- Map ID

Agency and Hydrological

Geological Classes

- Principal Aquifer
- Secondary A Aquifer
- Secondary B Aquifer
- Secondary Undifferentiated
- Unproductive Strata
- Unknown
- Unknown (Lakes and Landslip)

Site Sensitivity Context Map - Slice A

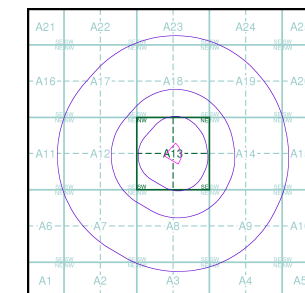

Order Details

Order Number: 340889871_1_1
 Customer Ref: TAR/BSN/PF/5759/01
 National Grid Reference: 350140, 309580
 Slice: A
 Site Area (Ha): 1.66
 Search Buffer (m): 1000

Site Details

Site at 350134, 309581

Landmark®
 INFORMATION GROUP

Tel: 0844 844 9952
 Fax: 0844 844 9951
 Web: www.envirocheck.co.uk

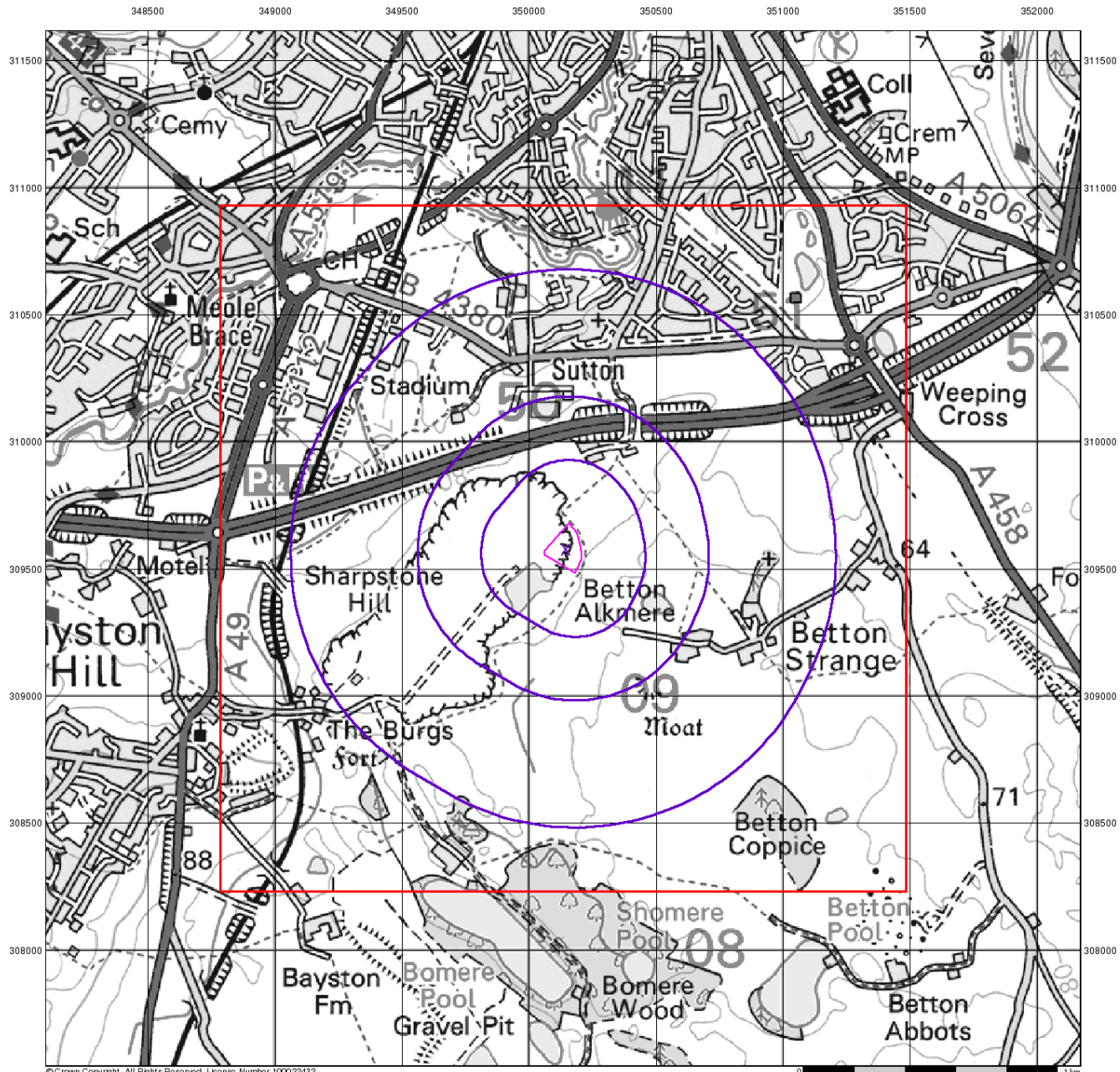

© Crown Copyright. All Rights Reserved. License Number 100022432

Envirocheck®

LANDMARK INFORMATION GROUP®

Source Protection Zones

General

- ◆ Specified Site
- Specified Buffer(s)
- ✕ Bearing Reference Point
- Slice
- B Map ID

Agency and Hydrological

- Inner zone (Zone 1)
- Inner zone - subsurface activity only (Zone 1c)
- Outer zone (Zone 2)
- Outer zone - subsurface activity only (Zone 2c)
- Total catchment (Zone 3)
- Total catchment - subsurface activity only (Zone 3c)
- Special interest (Zone 4)

Site Sensitivity Context Map - Slice A

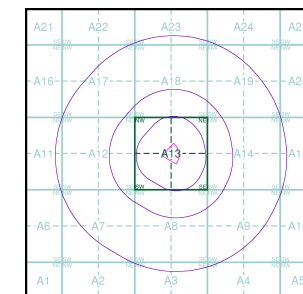

Order Details

Order Number: 340889871_1_1
 Customer Ref: TAR/BSN/PF/5759/01
 National Grid Reference: 350140, 309580
 Slice: A
 Site Area (Ha): 1.66
 Search Buffer (m): 1000

Site Details

Site at 350134, 309581

Landmark®
 INFORMATION GROUP

Tel: 0844 844 9952
 Fax: 0844 844 9951
 Web: www.envirocheck.co.uk

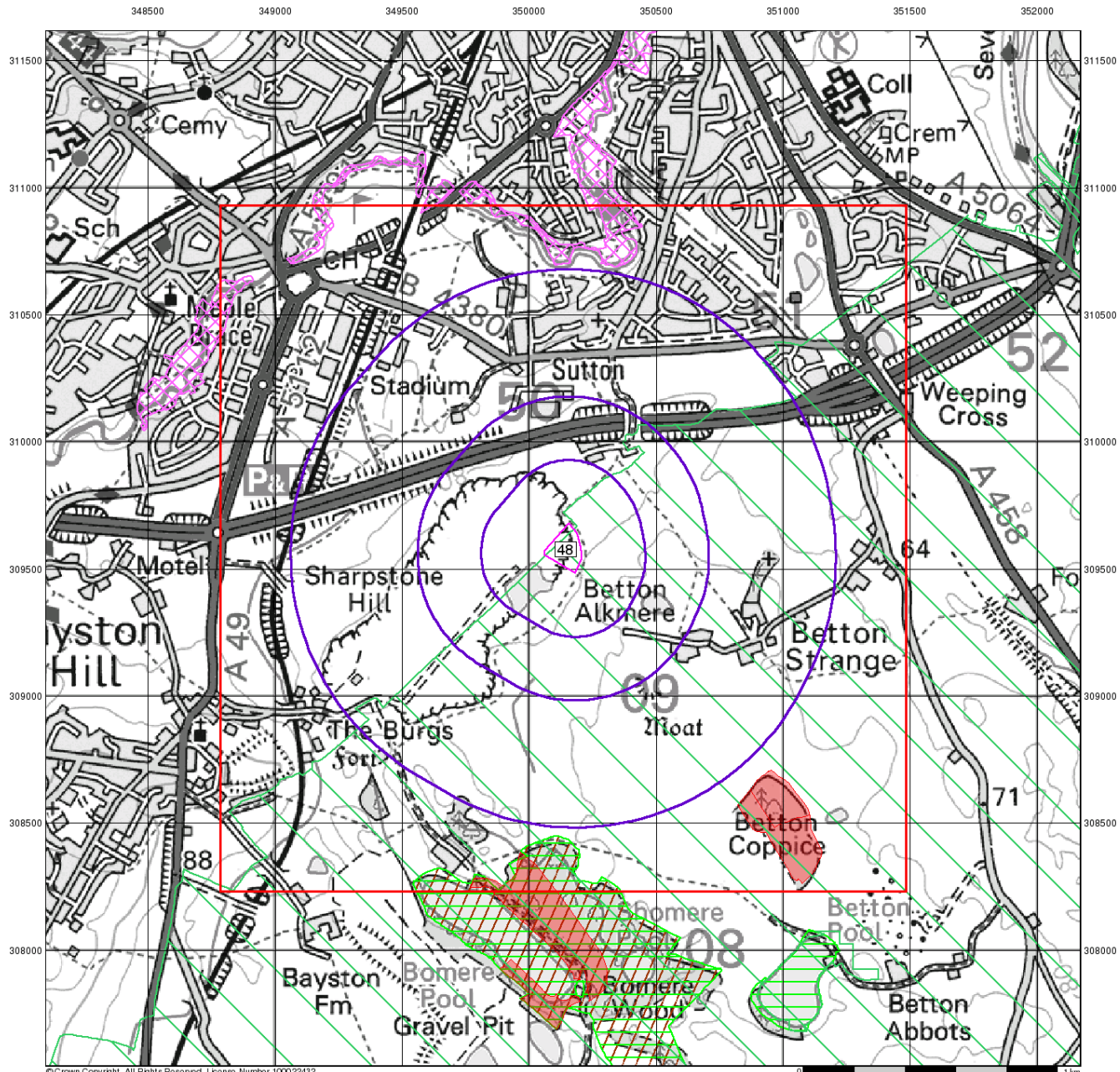

© Crown Copyright. All Rights Reserved. License Number 100022432.

Envirocheck®

LANDMARK INFORMATION GROUP®

Sensitive Land Uses

General

- Specified Site
- Specified Buffer(s)
- Bearing Reference Point
- Slice
- Map ID

Sensitive Land Uses

- Ancient Woodland
- Area of Adopted Green Belt
- Area of Unadopted Green Belt
- Area of Outstanding Natural Beauty
- Environmentally Sensitive Area
- Forest Park
- Local Nature Reserve
- Marine Nature Reserve
- National Nature Reserve
- National Park
- Nitrate Sensitive Area
- Nitrate Vulnerable Zone
- Ramsar Site
- Site of Special Scientific Interest
- Special Area of Conservation
- Special Protection Area
- World Heritage Sites

Site Sensitivity Context Map - Slice A

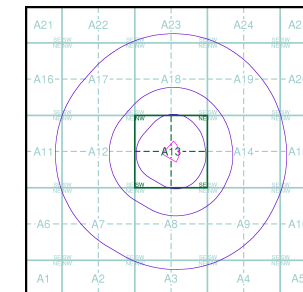

Order Details

Order Number: 340889871_1_1
 Customer Ref: TAR/BSN/PF/5759/01
 National Grid Reference: 350140, 309580
 Slice: A
 Site Area (Ha): 1.66
 Search Buffer (m): 1000

Site Details

Site at 350134, 309581

Landmark®
 INFORMATION GROUP

Tel: 0844 844 9952
 Fax: 0844 844 9951
 Web: www.envirocheck.co.uk

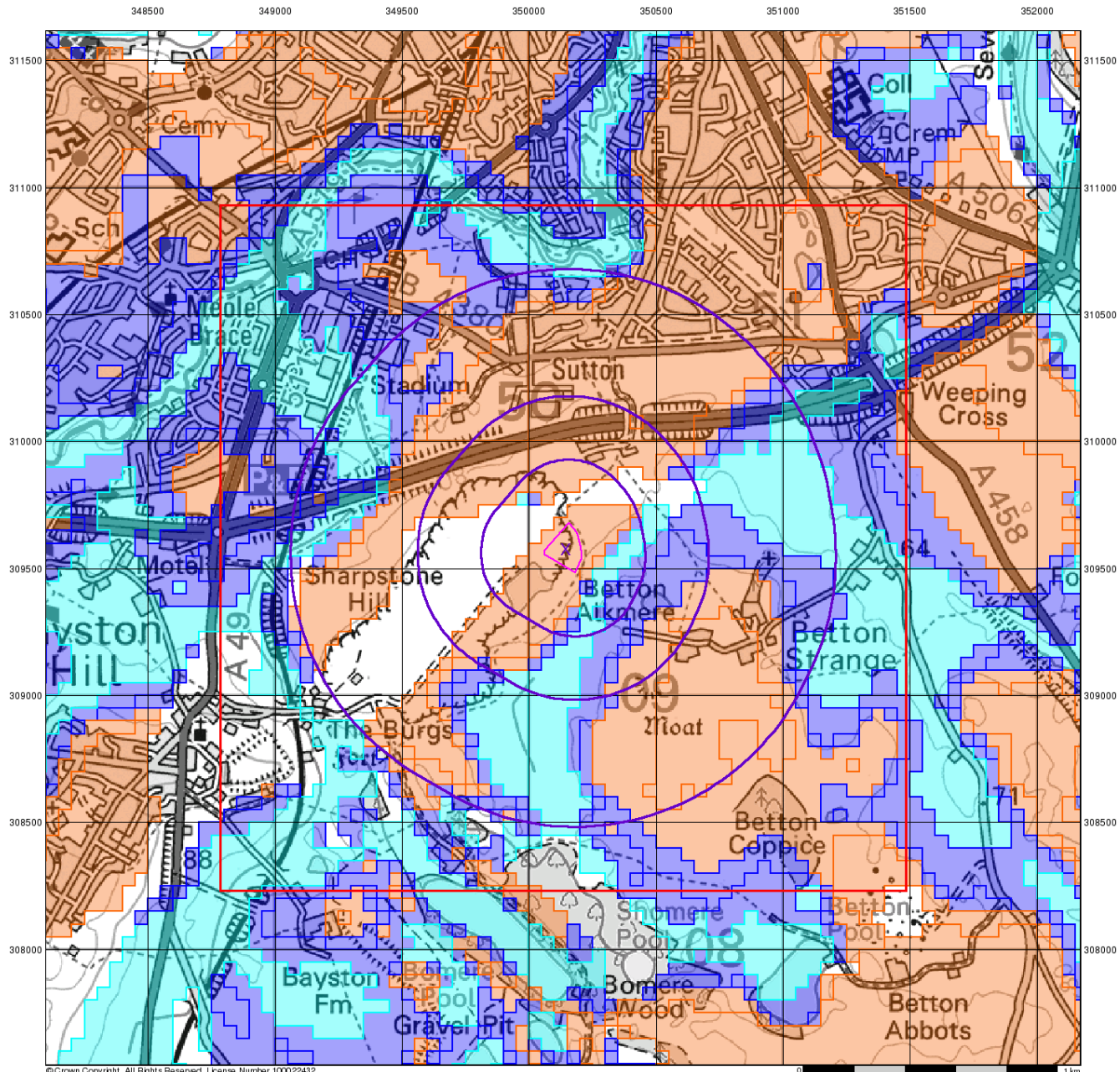

© Crown Copyright. All Rights Reserved. License Number 100022432

Envirocheck®

LANDMARK INFORMATION GROUP®

BGS Flood GFS Data

General

- Specified Site
- Specified Buffer(s)
- Bearing Reference Point
- Slice

Agency and Hydrological (Flood)

- Limited Potential for Groundwater Flooding to Occur
- Potential for Groundwater Flooding of Property Situated Below Ground Level
- Potential for Groundwater Flooding to Occur at Surface

Site Sensitivity Context Map - Slice A

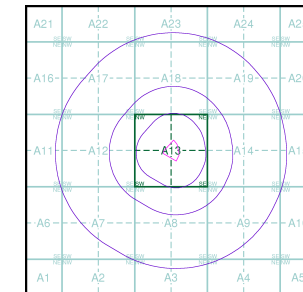

Order Details

Order Number: 340889871_1_1
 Customer Ref: TAR/BSN/PF/5759/01
 National Grid Reference: 350140, 309580
 Slice: A
 Site Area (Ha): 1.66
 Search Buffer (m): 1000

Site Details

Site at 350134, 309581

Landmark®
 LANDMARK INFORMATION GROUP

Tel: 0844 844 9952
 Fax: 0844 844 9951
 Web: www.envirocheck.co.uk