

**LEGEND**

- Site Boundary
- Solvent Storage area
- Warehouse 2 Storage Container
- Warehouse 1
- Warehouse 2
- Lipid Airlock
- Separex Utilities Room
- Outside Pilot Plant

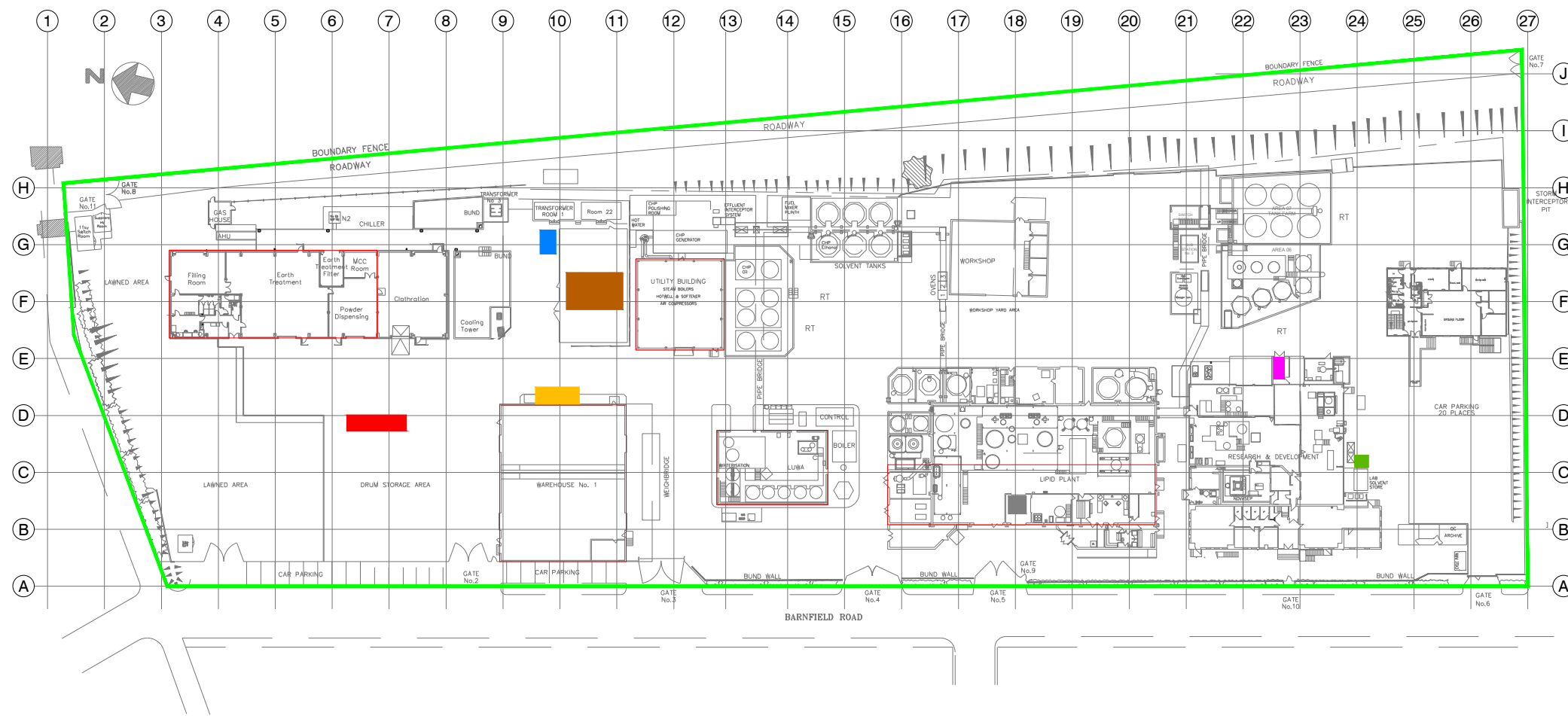

**NOTES**  
 Contains Ordnance Survey Data  
 © Crown Copyright and database  
 right 2020

**ISSUE PURPOSE**  
 FINAL  
**PROJECT NUMBER**  
 60641314  
**SHEET TITLE**  
 Location of Hazardous Materials  
 Storage Areas  
**SHEET NUMBER**  
 Figure 6

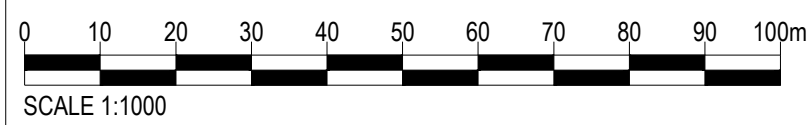

Filename: \\uk\d\szp\p\w001\NA-AECOM\NET\COM\DATA\DCS\PROJECTS\EGE\60641314\_CRODA\_LEEK\_EP900\_CAD\_GIS\910\_CAD\FIGURE 6 - LOCATION OF HAZARDOUS MATERIALS STORAGE AREAS.DWG  
 Printed on % Post-Consumer Recycled Content Paper