

KEY

- SWS and chamber
- land drain
- dirty water sewer and chamber
- FWS and chamber
- drainage channel
- 88.20 finished floor level
- 88.00 proposed level

ABINGTON
 CONSULTING ENGINEERS
 CHARTERED CIVIL & STRUCTURAL ENGINEERS
4 Colinton Lane, Wootton Bassett, Northampton, NN4 6BB Tel: 01208 702441
 info@abingtoneng.co.uk www.abingtoneng.co.uk

PROJECT: Masterplan Infrastructure – Park Grounds Farm, Wootton Bassett
 TITLE: Permit Application Drainage Proposals
 DRAWING NO.: 16067/103 REVISION: —
 SCALE: 1:500 @ A1
 DRAWN: EJB CHECKED: IB DATE: 12/1/17



- Notes**
- 1) Private drainage to be constructed in accordance with the Building Regulations.
 - 2) Private drainage chamber types to be determined in accordance with the Building Regulations.
 - 3) All private drains to be 100mm, unless shown otherwise.
 - 4) All trenches within trafficked areas to be backfilled with type 1 or type 2 material.
 - 5) All gully connections to be 150mm.
 - 6) All storage tanks, interceptors and package treatment plants to be installed and protected in accordance with the manufacturer's instructions.

KEY

	SWS and chamber
	gully and connection
	FWS and chamber
	drainage channel
	finished floor level
	proposed level
	polypropylene inspection chamber
	rectangular pre-cast concrete manhole Type E
	manhole Type B

A IB Manhole types added. Surface water tanks, pump and package treatment plant specified. 14/2/17
 REV. BY REVISION DETAILS DATE



PROJECT: Park Grounds, Wootton Bassett, Masterplan
 TITLE: Engineering Layout

DRAWING NO. 16067/104	REVISION A
SCALE 1:500 @ A1	DATE 31/1/17
DRAWN EJB	CHECKED IB

- Notes**
- 1) Private drainage to be constructed in accordance with the Building Regulations.
 - 2) Private drainage chamber types to be determined in accordance with the Building Regulations.
 - 3) All private drains to be 100mm ϕ , unless shown otherwise.
 - 4) All trenches within trafficked areas to be backfilled with Type 1 or Type 2 material.
 - 5) All gully connections to be 150mm ϕ .
 - 6) All storage tanks, interceptors and package treatment plants to be installed and protected in accordance with the manufacturer's instructions.

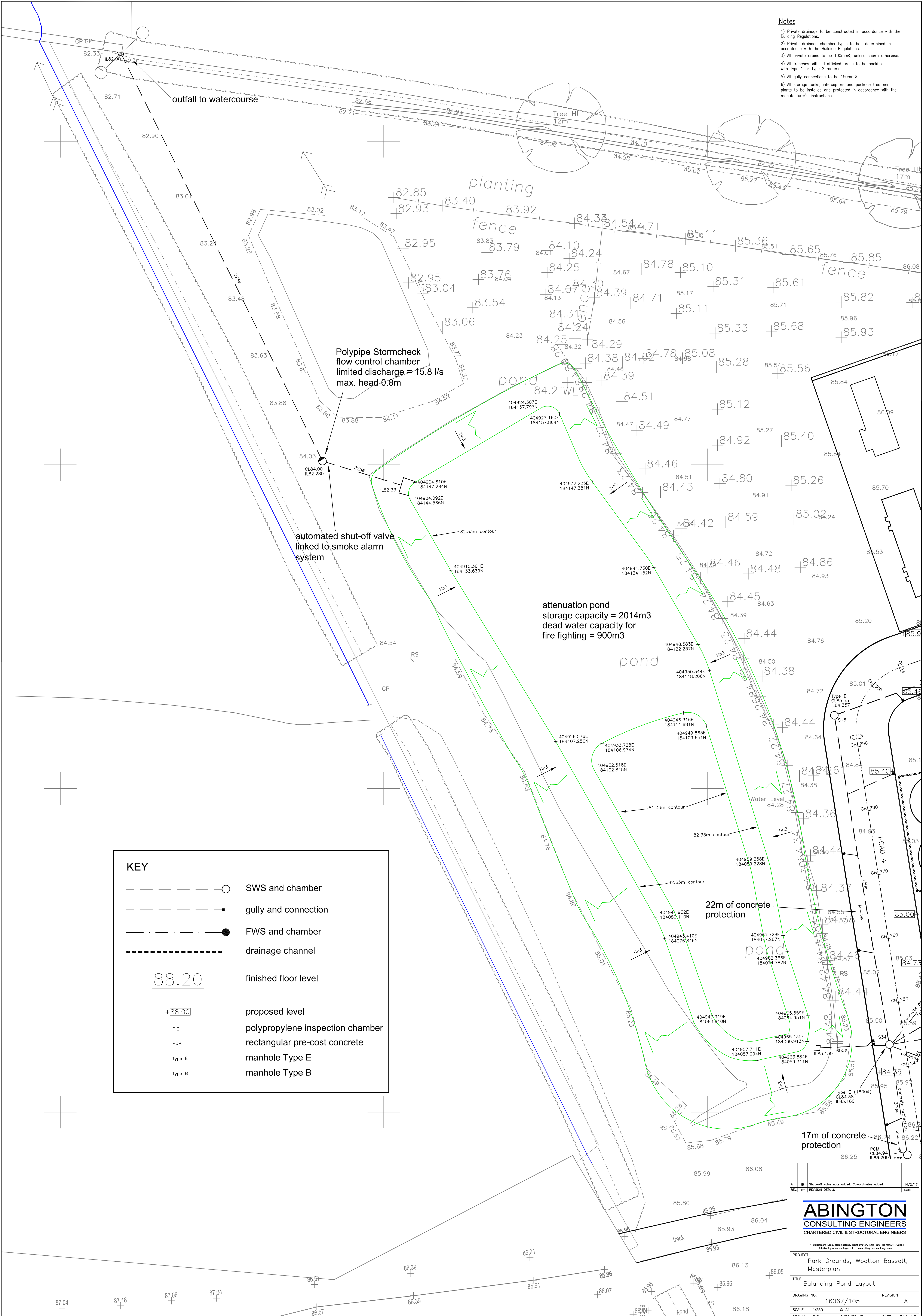

KEY	
	SWS and chamber
	gully and connection
	FWS and chamber
	drainage channel
	finished floor level
	proposed level
	polypropylene inspection chamber
	rectangular pre-cast concrete manhole Type E
	manhole Type B

ABINGTON
CONSULTING ENGINEERS
CHARTERED CIVIL & STRUCTURAL ENGINEERS

PROJECT: Park Grounds, Wootton Bassett, Masterplan
TITLE: Balancing Pond Layout

DRAWING NO. 16067/105 REVISION A
SCALE 1:250
DRAWN: EJB CHECKED: IB DATE: 31/1/17

14/2/17 DATE