

FOR DETAILS IN THIS AREA REFER TO JOHN TOOKE & PARTNERS DRAWING NUMBERS 3360/526 & 527

FOR DETAILS IN THIS AREA REFER TO JOHN TOOKE & PARTNERS DRAWING NUMBERS 3360/532 & 533

FOR DRAINAGE LAYOUT REFER TO JOHN TOOKE & PARTNERS DRAWING NUMBERS 3360/504

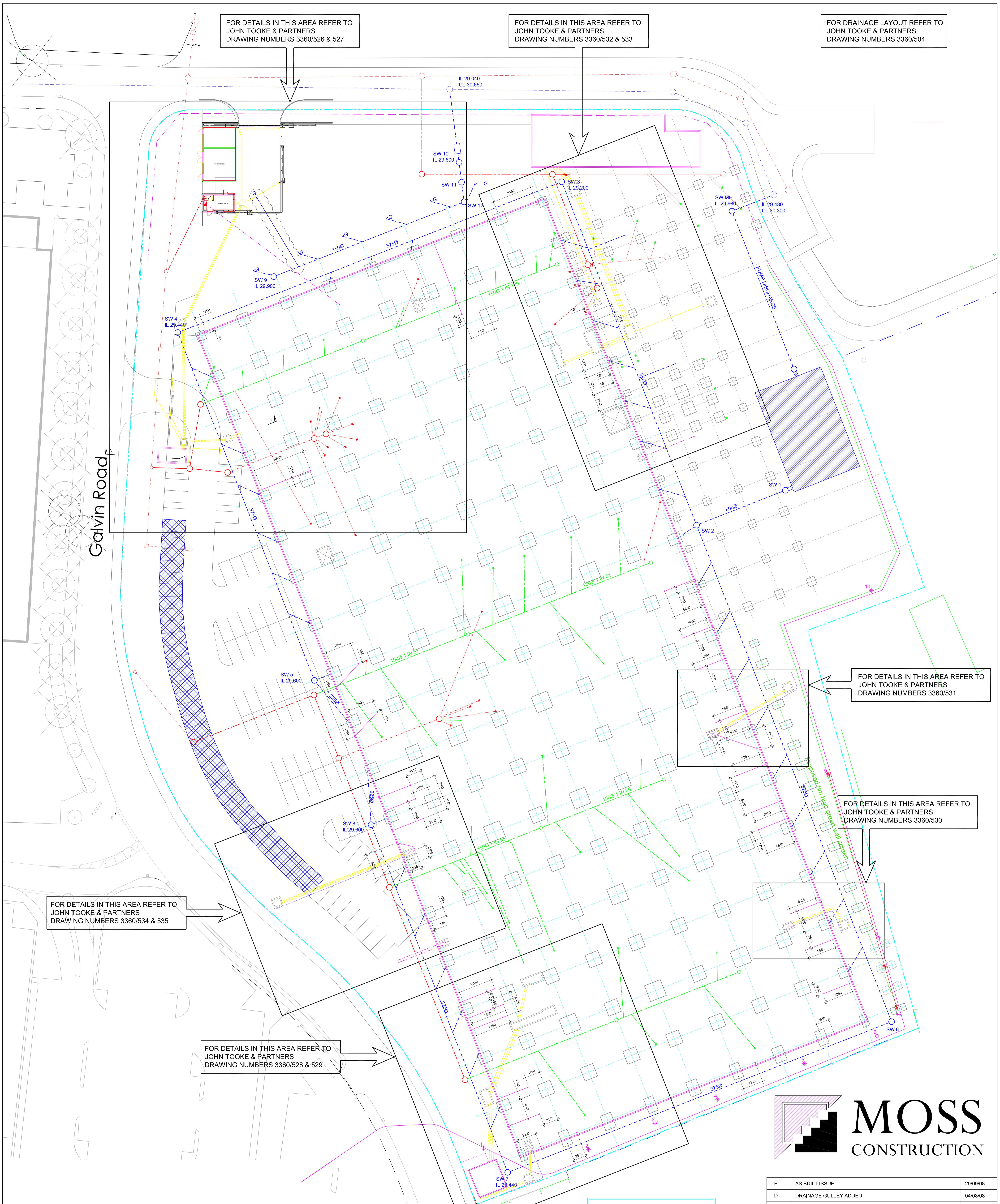

FOR DETAILS IN THIS AREA REFER TO JOHN TOOKE & PARTNERS DRAWING NUMBERS 3360/534 & 535

FOR DETAILS IN THIS AREA REFER TO JOHN TOOKE & PARTNERS DRAWING NUMBERS 3360/531

FOR DETAILS IN THIS AREA REFER TO JOHN TOOKE & PARTNERS DRAWING NUMBERS 3360/530

FOR DETAILS IN THIS AREA REFER TO JOHN TOOKE & PARTNERS DRAWING NUMBERS 3360/528 & 529

**KEY**

- EXISTING SURFACE WATER NETWORK
- PROPOSED SURFACE WATER NETWORK
- EXISTING FOUL WATER NETWORK
- PROPOSED EXTERNAL FOUL WATER / PROCESS NETWORK
- PROPOSED INTERNAL FOUL WATER NETWORK
- PROPOSED INTERNAL PROCESS NETWORK
- FOUL DRAINAGE POINT
- PROCESS DRAINAGE POINT
- PROPOSED BT DUCTS
- EARTHING DUCTS

AS BUILT DRAWING

**NOTES**  
 1) THIS DRAWING IS TO BE READ IN CONJUNCTION WITH ALL RELEVANT ARCHITECTS AND ENGINEERS DRAWINGS AND SPECIFICATIONS



REV	AMENDMENTS	DATE
E	AS BUILT ISSUE	29/09/08
D	DRAINAGE GULLEY ADDED	04/08/08
C	EARTH DUCT POSITIONS AMENDED (GRIDS A-10 & 11)	02/04/08
B	DRAINAGE LOCATIONS ADDED	26/03/08
A	CONSTRUCTION ISSUE	17/03/08

SEGRO	DATE FEBRUARY 2008
667 - 673 GALVIN ROAD SLOUGH	SCALE 1:250 @ A0
COORDINATED ON-SITE SERVICES PLAN	DRAWN BY <i>LLOYD</i>
	DRG No 3360/525 E

**JOHN TOOKE & PARTNERS**  
 CONSULTING ENGINEERS  
 1A, MONTFORD PLACE, LONDON SE11 5DE  
 TEL No 020-7582-0255 FAX No 020-7820-0297