

- General**
- Specified Site
  - Specified Buffer(s)
  - Bearing Reference Point
  - Map ID
  - Several of Type at Location
- Agency and Hydrological**
- Contaminated Land Register Entry or Notice (Location)
  - Contaminated Land Register Entry or Notice
  - Discharge Consent
  - Enforcement or Prohibition Notice
  - Integrated Pollution Control
  - Integrated Pollution Prevention Control
  - Local Authority Integrated Pollution Prevention and Control
  - Local Authority Pollution Prevention and Control Enforcement
  - Pollution Incident to Controlled Waters
  - Prosecution Relating to Authorised Processes
  - Prosecution Relating to Controlled Waters
  - Registered Radioactive Substance
  - River Network or Water Feature
  - River Quality Sampling Point
  - Substantiated Pollution Incident Register
  - Water Abstraction
  - Water Industry Act Referral
- Waste**
- BGS Recorded Landfill Site (Location)
  - BGS Recorded Landfill Site
  - EA Historic Landfill (Buffered Point)
  - EA Historic Landfill (Polygon)
  - Integrated Pollution Control Registered Waste Site
  - Licensed Waste Management Facility (Landfill Boundary)
  - Licensed Waste Management Facility (Location)
  - Local Authority Recorded Landfill Site (Location)
  - Local Authority Recorded Landfill Site
  - Registered Landfill Site
  - Registered Landfill Site (Location)
  - Registered Landfill Site (Point Buffered to 100m)
  - Registered Landfill Site (Point Buffered to 250m)
  - Registered Waste Transfer Site (Location)
  - Registered Waste Transfer Site
  - Registered Waste Treatment or Disposal Site (Location)
  - Registered Waste Treatment or Disposal Site
- Hazardous Substances**
- COMAH Site
  - Explosive Site
  - NIHHS Site
  - Planning Hazardous Substance Consent
  - Planning Hazardous Substance Enforcement
- Geological**
- BGS Recorded Mineral Site
- Industrial Land Use**
- Contemporary Trade Directory Entry
  - Fuel Station Entry

Site Sensitivity Map - Slice B

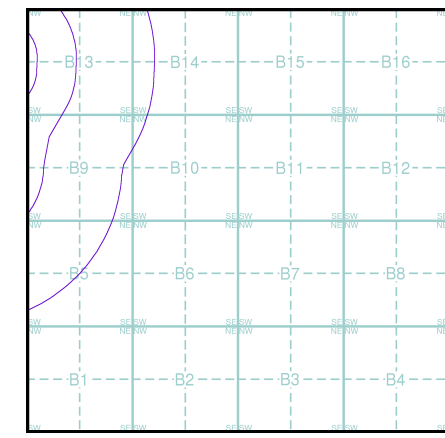

**Order Details**

Order Number: 71701570\_1\_1  
 Customer Ref: R64036  
 National Grid Reference: 503720, 179340  
 Slice: B  
 Site Area (Ha): 52.89  
 Search Buffer (m): 1000

**Site Details**

Langley Airfield, North Park Road, Langley, Ritchings Park, Slough, Buckinghamshire, SL0 9DJ



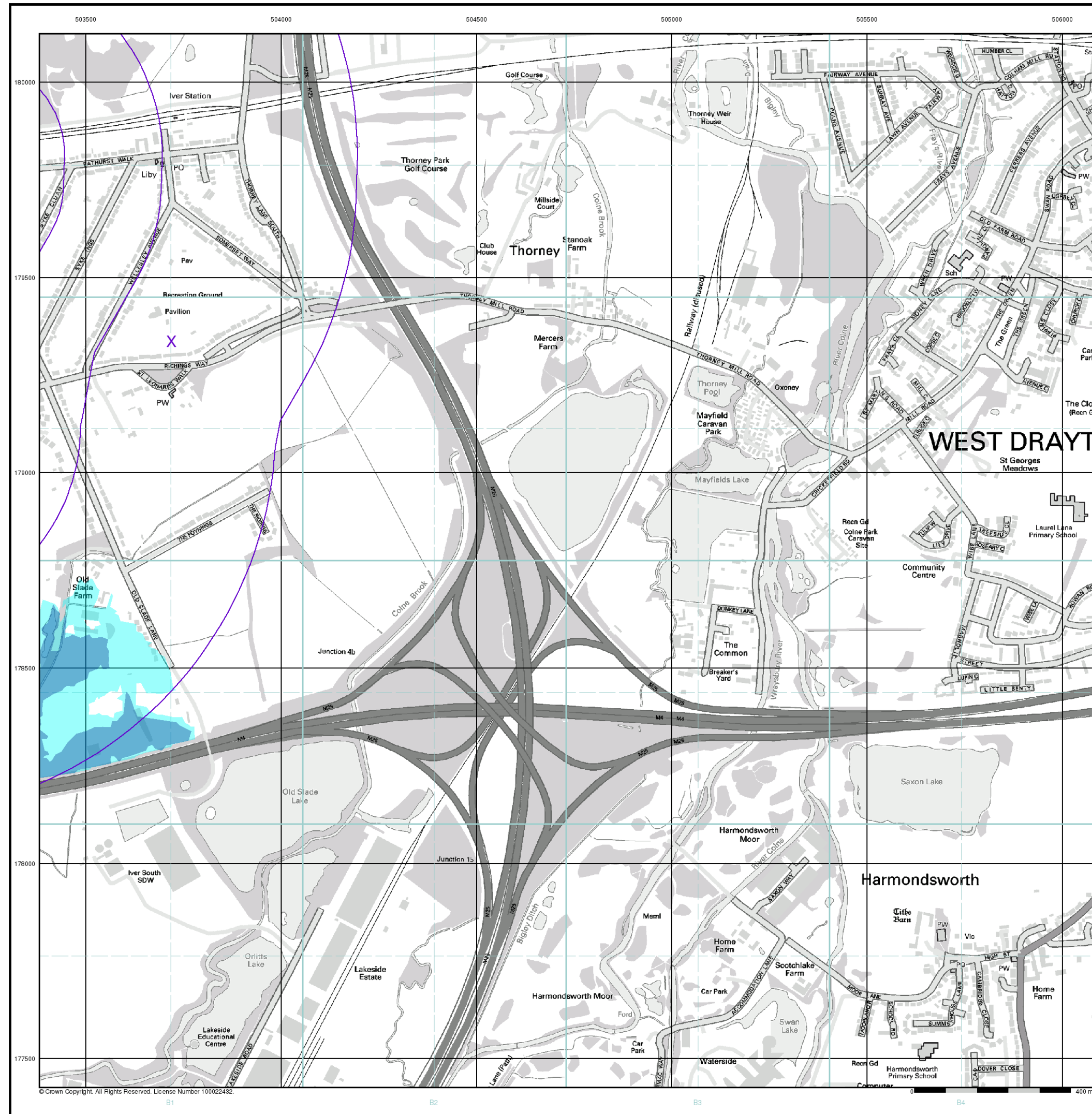

**General**

- Specified Site
- Specified Buffer(s)
- Bearing Reference Point

**Agency and Hydrological (Flood)**

- Extreme Flooding from Rivers or Sea without Defences (Zone 2)
- Flooding from Rivers or Sea without Defences (Zone 3)
- Area Benefiting from Flood Defence
- Flood Water Storage Areas
- Flood Defence

**Flood Map - Slice B**

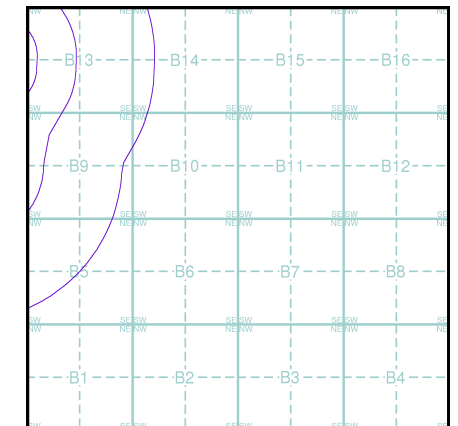

**Order Details**

Order Number: 71701570\_1\_1  
Customer Ref: R64036  
National Grid Reference: 503720, 179340  
Slice: B  
Site Area (Ha): 52.89  
Search Buffer (m): 1000

**Site Details**

Langley Airfield, North Park Road, Langley, Ritchings Park, Slough, Buckinghamshire, SL0 9DJ



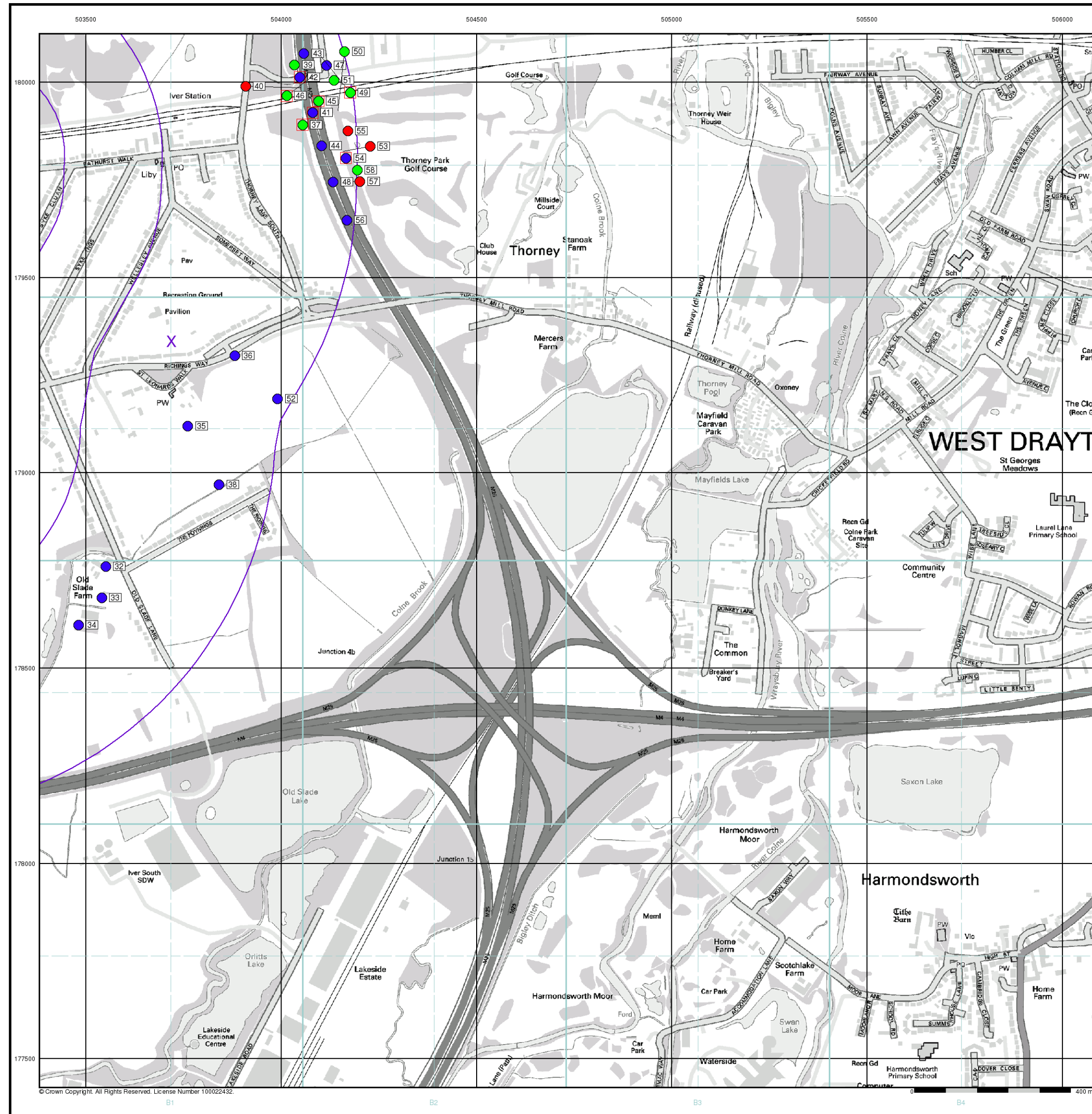

**General**

- Specified Site
- Specified Buffer(s)
- Bearing Reference Point
- Map ID
- Several of Type at Location

**Agency and Hydrological (Boreholes)**

- BGS Borehole Depth 0 - 10m
- BGS Borehole Depth 10 - 30m
- BGS Borehole Depth 30m +
- Confidential
- Other

For Borehole information please refer to the Borehole .csv file which accompanied this slice.

A copy of the BGS Borehole Ordering Form is available to download from the Support section of [www.envirocheck.co.uk](http://www.envirocheck.co.uk).

**Borehole Map - Slice B**

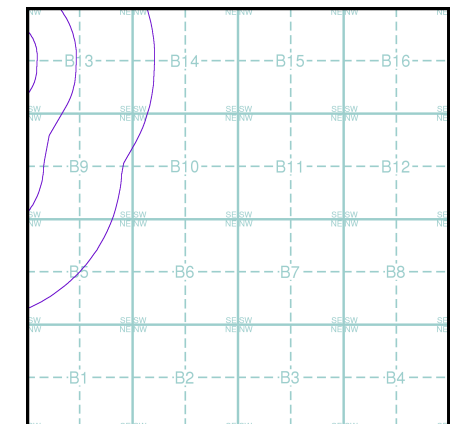

**Order Details**

Order Number: 71701570\_1\_1  
Customer Ref: R64036  
National Grid Reference: 503720, 179340  
Slice: B  
Site Area (Ha): 52.89  
Search Buffer (m): 1000

**Site Details**

Langley Airfield, North Park Road, Langley, Ritchings Park, Slough, Buckinghamshire, SL0 9DJ



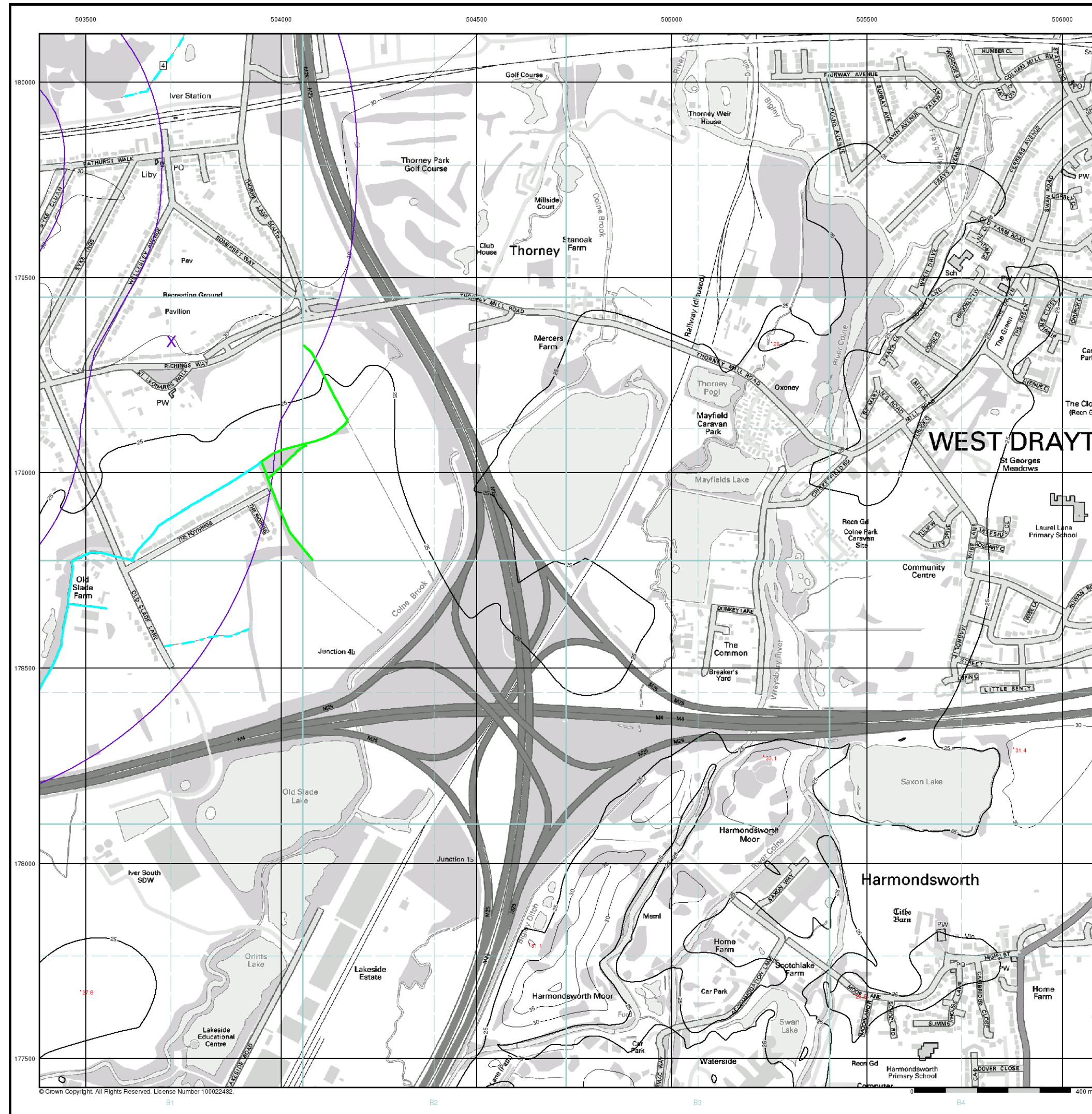

### General

- Specified Site
- Specified Buffer(s)
- Bearing Reference Point
- Map ID

### Detailed River Network Data

- |                          |                                     |
|--------------------------|-------------------------------------|
| Primary River            | Extended Culvert (greater than 50m) |
| Secondary River          | Underground River (inferred)        |
| Tertiary River           | Underground River (local knowledge) |
| Canal                    | Downstream of High Water Mark       |
| Canal Tunnel             | Downstream of Seaward Extension     |
| Undefined River          | Not assigned River feature          |
| Lake/Reservoir           |                                     |
| Offline Drainage Feature |                                     |

### Contours (height in metres)

- Standard Contour 105 100 95
- Master Contour
- Spot Height \*167.3
- MLW Mean Low Water
- MHW Mean High Water

### EANRW Detailed River Network Map - Slice B

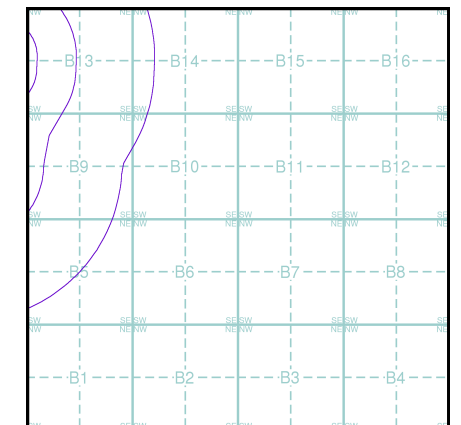

### Order Details

Order Number: 71701570\_1\_1  
Customer Ref: R64036  
National Grid Reference: 503720, 179340  
Slice: B  
Site Area (Ha): 52.89  
Search Buffer (m): 1000

### Site Details

Langley Airfield, North Park Road, Langley, Ritchings Park, Slough, Buckinghamshire, SL0 9DJ



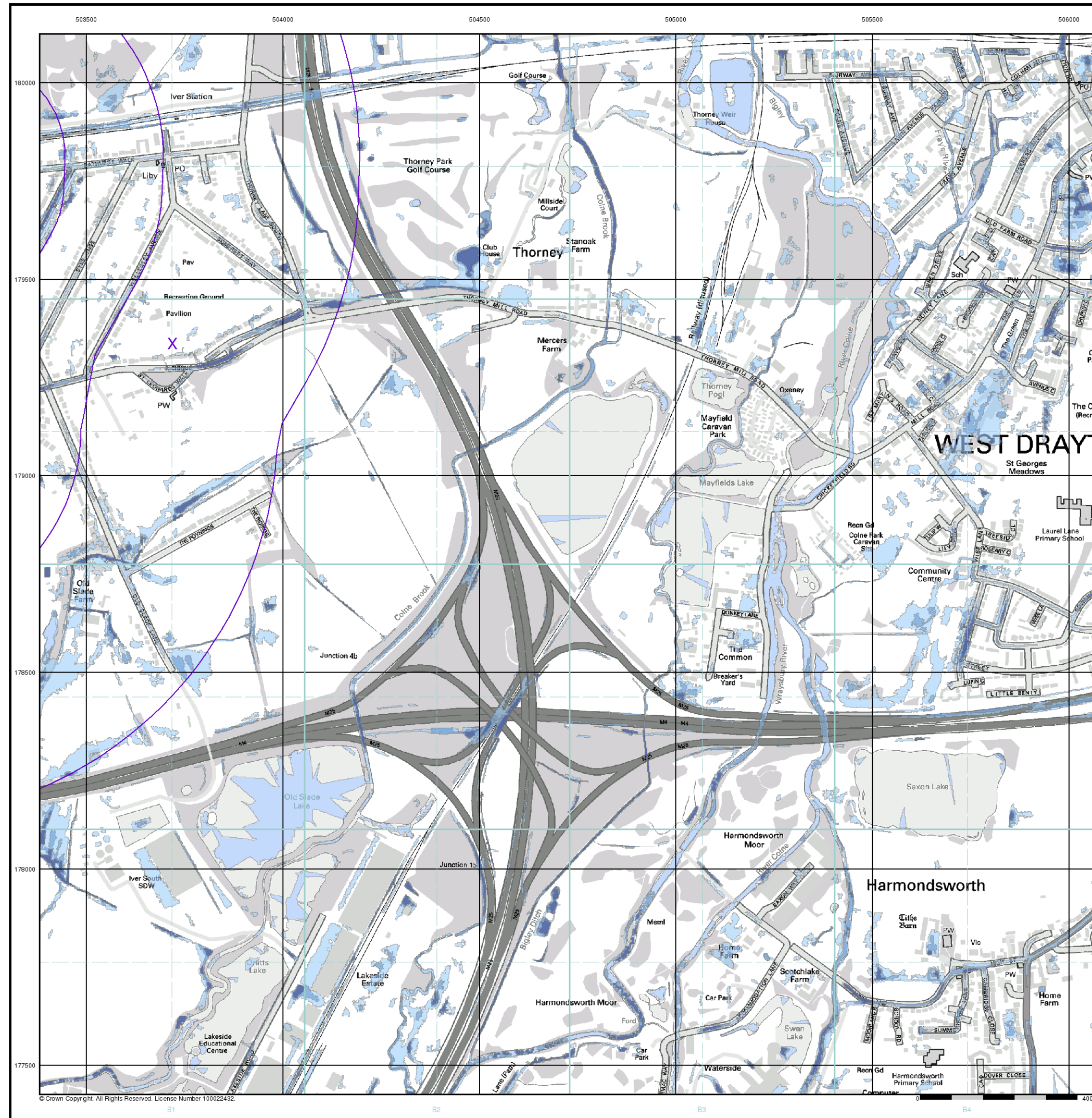

### General

- Specified Site
- Specified Buffer(s)
- Bearing Reference Point

### Risk of Flooding from Surface Water

- High - 30 Year Return
- Medium - 100 Year Return
- Low - 1000 Year Return

### Suitability

See the suitability map below

- National to county
- County to town
- Town to street
- Street to parcels of land
- Property

### EANRW Suitability Map - Slice B

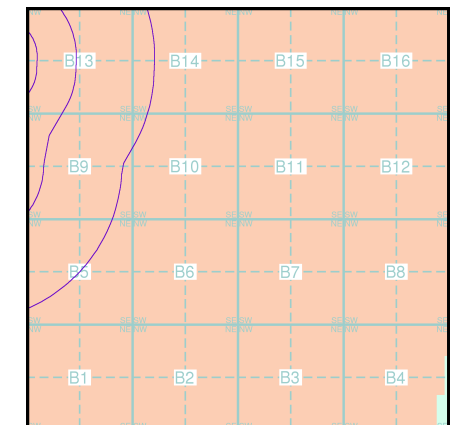

### Order Details

Order Number: 71701570\_1\_1  
Customer Ref: R64036  
National Grid Reference: 503720, 179340  
Slice: B  
Site Area (Ha): 52.89  
Search Buffer (m): 1000

### Site Details

Langley Airfield, North Park Road, Langley, Ritchings Park, Slough, Buckinghamshire, SL0 9DJ