

Historical Mapping Legends

Ordnance Survey County Series 1:10,560

- Gravel Pit
- Sand Pit
- Other Pits
- Quarry
- Shingle
- Orchard
- Osiers
- Reeds
- Marsh
- Mixed Wood
- Deciduous
- Brushwood
- Fir
- Furze
- Rough Pasture
- Arrow denotes flow of water
- Trigonometrical Station
- Site of Antiquities
- Bench Mark
- Pump, Guide Post, Signal Post
- Well, Spring, Boundary Post
- 285** Surface Level
- Sketched Contour
- Instrumental Contour
- Main Roads
- Minor Roads
- Sunken Road
- Raised Road
- Road over Railway
- Railway over River
- Railway over Road
- Level Crossing
- Road over River or Canal
- Road over Stream
- Road over Stream
- County Boundary (Geographical)
- County & Civil Parish Boundary
- Administrative County & Civil Parish Boundary
- County Borough Boundary (England)
- County Burgh Boundary (Scotland)
- Rural District Boundary
- Civil Parish Boundary

Ordnance Survey Plan 1:10,000

- Chalk Pit, Clay Pit or Quarry
- Gravel Pit
- Sand Pit
- Disused Pit or Quarry
- Refuse or Slag Heap
- Lake, Loch or Pond
- Dunes
- Boulders
- Coniferous Trees
- Non-Coniferous Trees
- Orchard
- Scrub
- Coppice
- Bracken
- Heath
- Rough Grassland
- Marsh
- Reeds
- Saltings
- Building
- Glasshouse
- Sloping Masonry
- Pylon
- Electricity Transmission Line
- Pole
- Cutting
- Embankment
- Standard Gauge Multiple Track
- Standard Gauge Single Track
- Siding, Tramway or Mineral Line
- Narrow Gauge
- Geographical County
- Administrative County, County Borough or County of City
- Municipal Borough, Urban or Rural District, Burgh or District Council
- Borough, Burgh or County Constituency
- Civil Parish
- BP, BS** Boundary Post or Stone
- Ch** Church
- CH** Club House
- F E Sta** Fire Engine Station
- FB** Foot Bridge
- Fn** Fountain
- GP** Guide Post
- MP** Mile Post
- MS** Mile Stone
- Pol Sta** Police Station
- PO** Post Office
- PC** Public Convenience
- PH** Public House
- SB** Signal Box
- Spr** Spring
- TCB** Telephone Call Box
- TCP** Telephone Call Post
- W** Well

1:10,000 Raster Mapping

- Gravel Pit
- Rock
- Boulders
- Shingle
- Sand
- Slopes
- Refuse tip or slag heap
- Rock (scattered)
- Boulders (scattered)
- Mud
- Sand Pit
- Top of cliff
- General detail
- Overhead detail
- Multi-track railway
- County boundary (England only)
- District, Unitary, Metropolitan, London Borough boundary
- Underground detail
- Narrow gauge railway
- Single track railway
- Civil, parish or community boundary
- Constituency boundary
- Area of wooded vegetation
- Non-coniferous trees
- Non-coniferous trees (scattered)
- Coniferous trees
- Coniferous trees (scattered)
- Orchard
- Rough Grassland
- Scrub
- Water feature
- Mean high water (springs)
- Telephone line (where shown)
- Bench mark (where shown)
- Point feature (e.g. Guide Post or Mile Stone)
- Site of (antiquity)
- General Building
- Non-coniferous trees
- Coniferous trees
- Positioned tree
- Coppice or Osiers
- Heath
- Marsh, Salt Marsh or Reeds
- Flow arrows
- Mean low water (springs)
- Electricity transmission line (with poles)
- Triangulation station
- Pylon, flare stack or lighting tower
- Glasshouse
- Important Building



Historical Mapping & Photography included:

Mapping Type	Scale	Date	Pg
Hertfordshire	1:10,560	1884	2
Hertfordshire	1:10,560	1899	3
Hertfordshire	1:10,560	1925	4
Hertfordshire	1:10,560	1938	5
Hertfordshire	1:10,560	1946	6
Historical Aerial Photography	1:10,560	1949	7
Ordnance Survey Plan	1:10,000	1960	8
Ordnance Survey Plan	1:10,000	1960	9
Ordnance Survey Plan	1:10,000	1977 - 1978	10
Ordnance Survey Plan	1:10,000	1980 - 1989	11
Ordnance Survey Plan	1:10,000	1993 - 1994	12
10K Raster Mapping	1:10,000	1999	13
10K Raster Mapping	1:10,000	2006	14
VectorMap Local	1:10,000	2021	15

Historical Map - Slice A

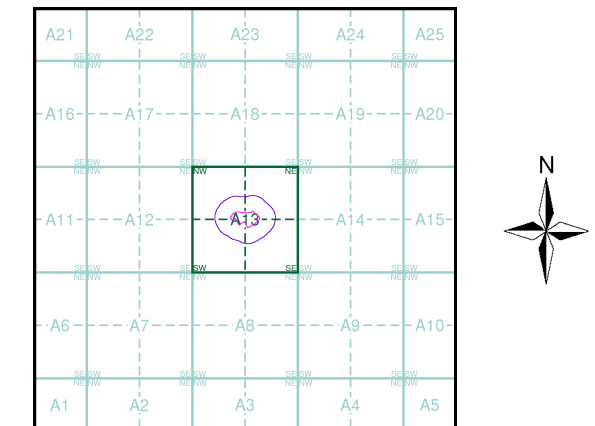

Order Details

Order Number: 285081324_1_1
 Customer Ref: JER8369
 National Grid Reference: 534250, 216080
 Slice: A
 Site Area (Ha): 1.16
 Search Buffer (m): 1000

Site Details

Ware WTS



Tel: 0844 844 9952
 Fax: 0844 844 9951
 Web: www.envirocheck.co.uk

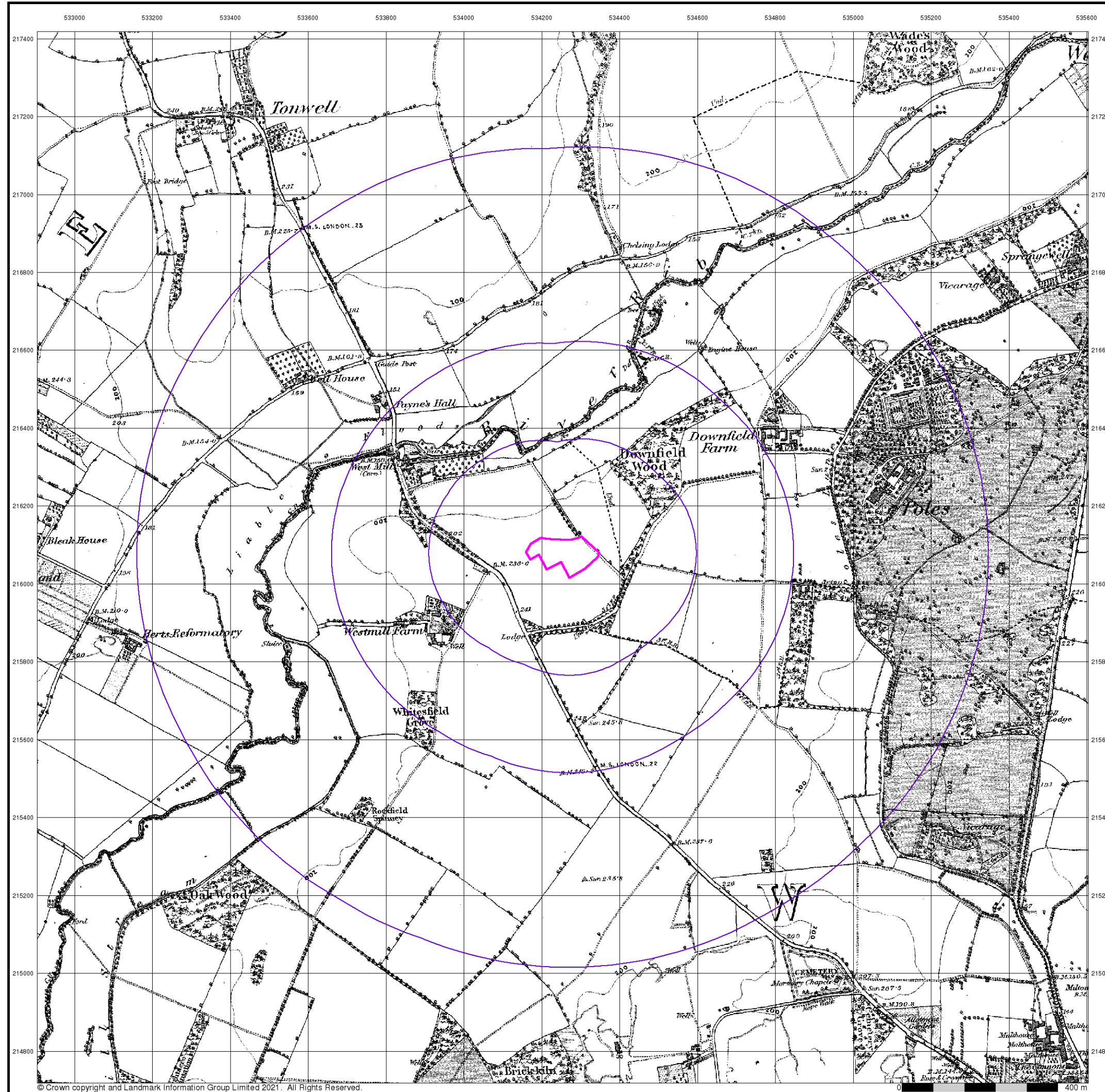

Hertfordshire

Published 1884

Source map scale - 1:10,560

The historical maps shown were reproduced from maps predominantly held at the scale adopted for England, Wales and Scotland in the 1840's. In 1854 the 1:2,500 scale was adopted for mapping urban areas; these maps were used to update the 1:10,560 maps. The published date given therefore is often some years later than the surveyed date. Before 1938, all OS maps were based on the Cassini Projection, with independent surveys of a single county or group of counties, giving rise to significant inaccuracies in outlying areas. In the late 1940's, a Provisional Edition was produced, which updated the 1:10,560 mapping from a number of sources. The maps appear unfinished - with all military camps and other strategic sites removed. These maps were initially overprinted with the National Grid. In 1970, the first 1:10,000 maps were produced using the Transverse Mercator Projection. The revision process continued until recently, with new editions appearing every 10 years or so for urban areas.

Map Name(s) and Date(s)

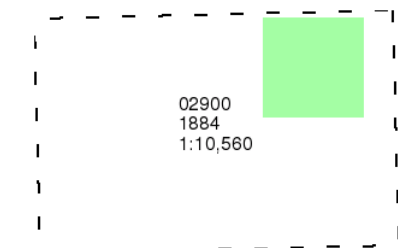

Historical Map - Slice A

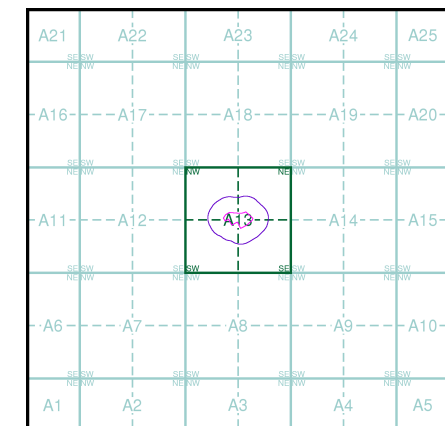

Order Details

Order Number: 285081324_1_1
 Customer Ref: JER8369
 National Grid Reference: 534250, 216080
 Slice: A
 Site Area (Ha): 1.16
 Search Buffer (m): 1000

Site Details

Ware WTS



Tel: 0844 844 9952
 Fax: 0844 844 9951
 Web: www.envirocheck.co.uk

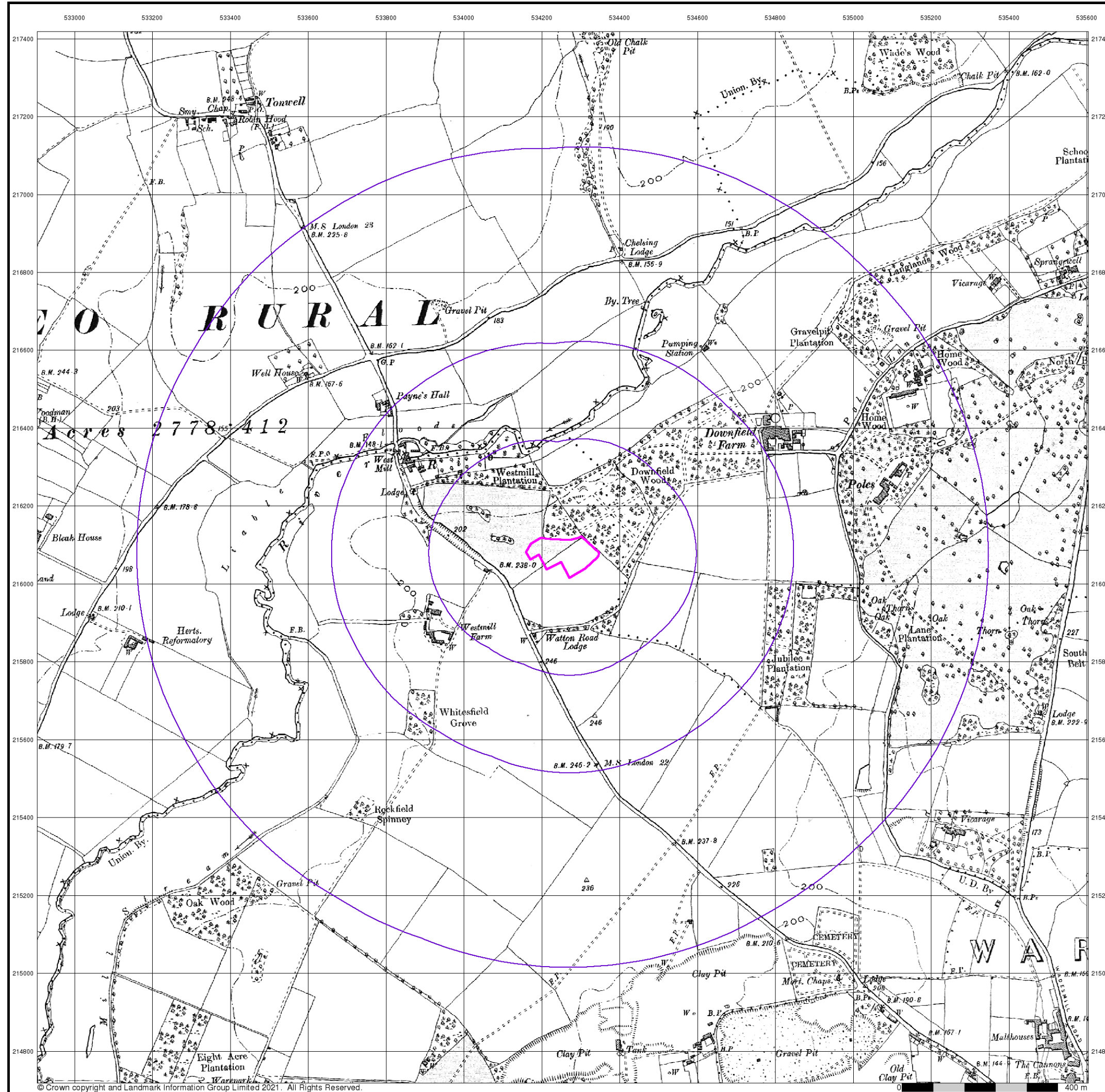

Hertfordshire

Published 1899

Source map scale - 1:10,560

The historical maps shown were reproduced from maps predominantly held at the scale adopted for England, Wales and Scotland in the 1840's. In 1854 the 1:2,500 scale was adopted for mapping urban areas; these maps were used to update the 1:10,560 maps. The published date given therefore is often some years later than the surveyed date. Before 1938, all OS maps were based on the Cassini Projection, with independent surveys of a single county or group of counties, giving rise to significant inaccuracies in outlying areas. In the late 1940's, a Provisional Edition was produced, which updated the 1:10,560 mapping from a number of sources. The maps appear unfinished - with all military camps and other strategic sites removed. These maps were initially overprinted with the National Grid. In 1970, the first 1:10,000 maps were produced using the Transverse Mercator Projection. The revision process continued until recently, with new editions appearing every 10 years or so for urban areas.

Map Name(s) and Date(s)

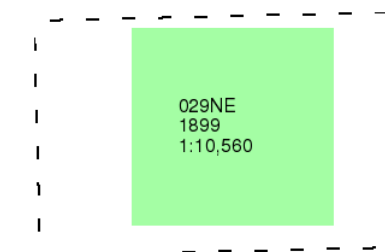

Historical Map - Slice A

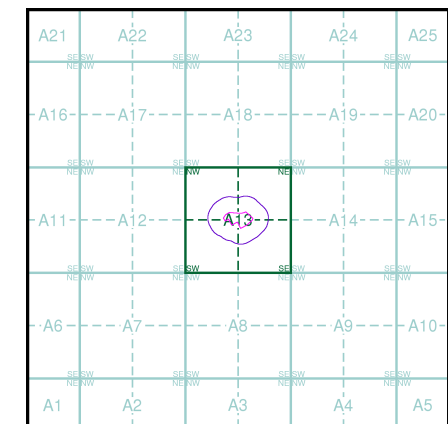

Order Details

Order Number: 285081324_1_1
 Customer Ref: JER8369
 National Grid Reference: 534250, 216080
 Slice: A
 Site Area (Ha): 1.16
 Search Buffer (m): 1000

Site Details

Ware WTS



Tel: 0844 844 9952
 Fax: 0844 844 9951
 Web: www.envirocheck.co.uk

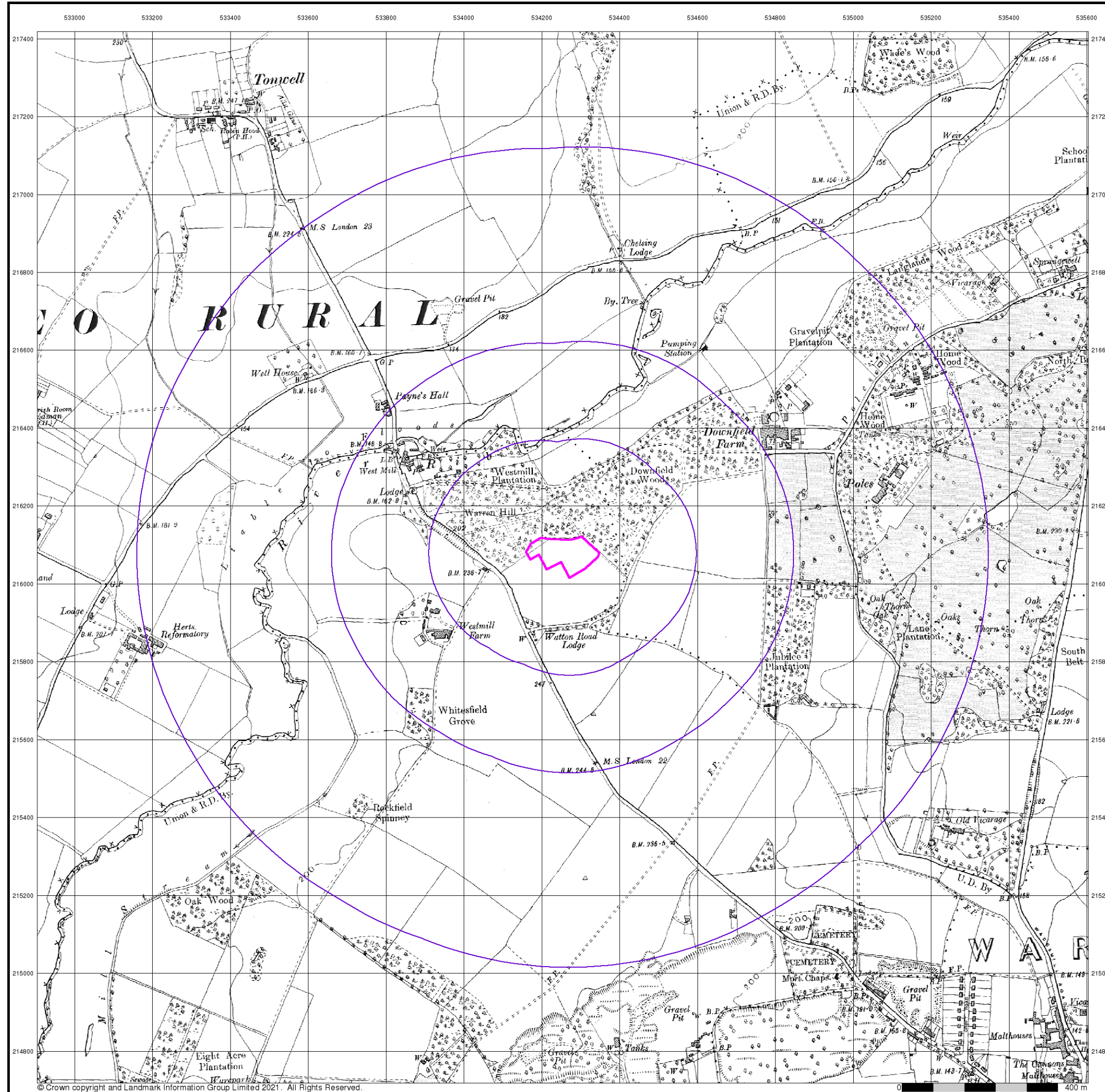

© Crown copyright and Landmark Information Group Limited 2021. All Rights Reserved.



Hertfordshire
Published 1925
Source map scale - 1:10,560

The historical maps shown were reproduced from maps predominantly held at the scale adopted for England, Wales and Scotland in the 1840's. In 1854 the 1:2,500 scale was adopted for mapping urban areas; these maps were used to update the 1:10,560 maps. The published date given therefore is often some years later than the surveyed date. Before 1938, all OS maps were based on the Cassini Projection, with independent surveys of a single county or group of counties, giving rise to significant inaccuracies in outlying areas. In the late 1940's, a Provisional Edition was produced, which updated the 1:10,560 mapping from a number of sources. The maps appear unfinished - with all military camps and other strategic sites removed. These maps were initially overlaid with the National Grid. In 1970, the first 1:10,000 maps were produced using the Transverse Mercator Projection. The revision process continued until recently, with new editions appearing every 10 years or so for urban areas.

Map Name(s) and Date(s)

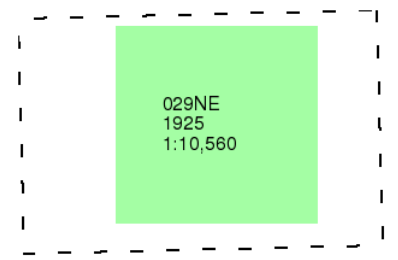

Historical Map - Slice A

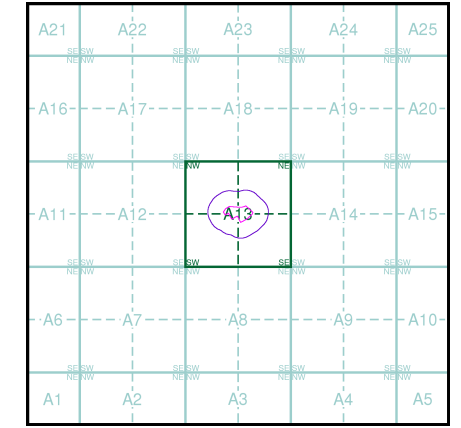

Order Details

Order Number: 285081324_1_1
 Customer Ref: JER8369
 National Grid Reference: 534250, 216080
 Slice: A
 Site Area (Ha): 1.16
 Search Buffer (m): 1000

Site Details

Ware WTS



Tel: 0844 844 9952
 Fax: 0844 844 9951
 Web: www.envirocheck.co.uk

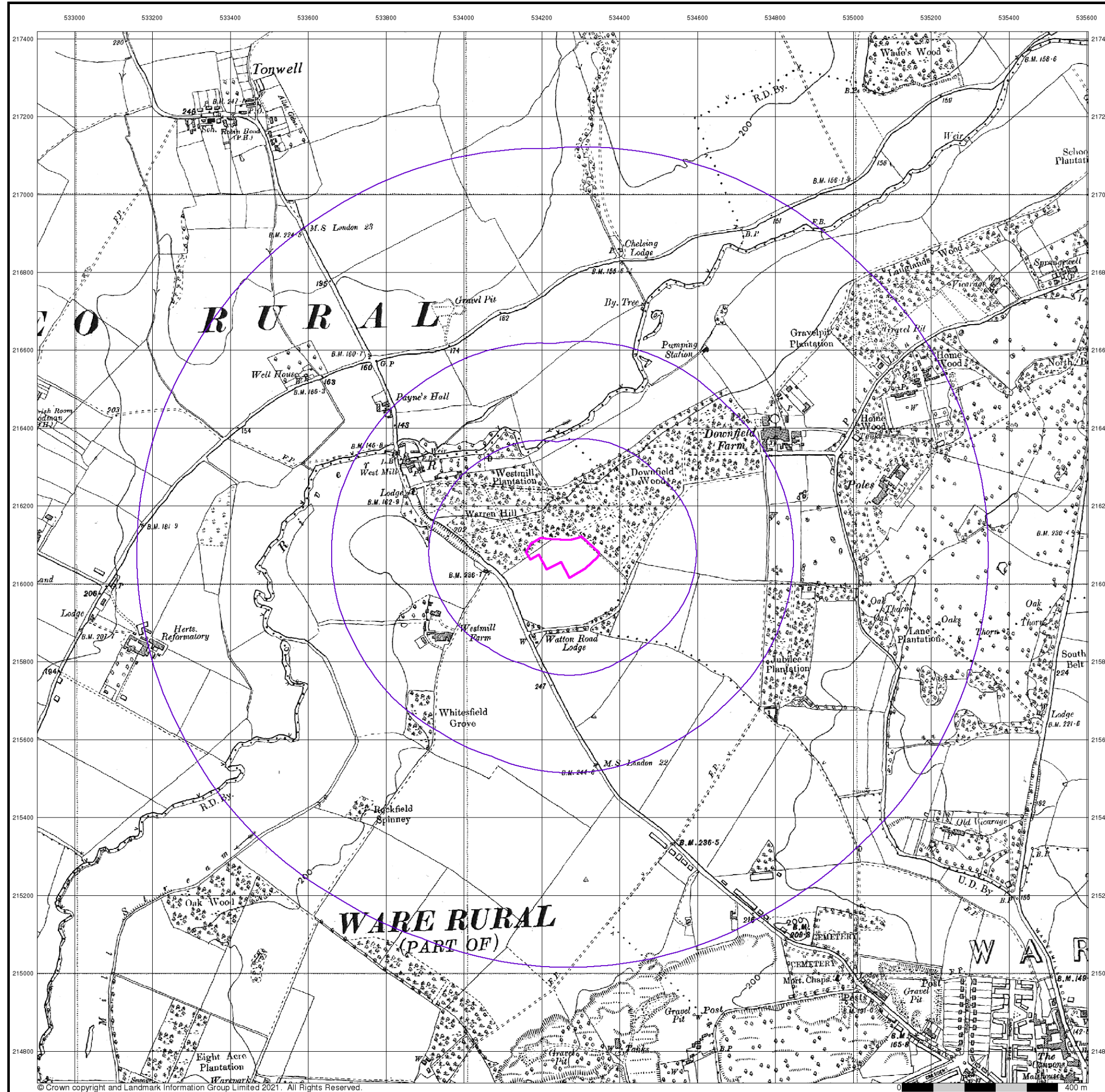

Hertfordshire

Published 1938

Source map scale - 1:10,560

The historical maps shown were reproduced from maps predominantly held at the scale adopted for England, Wales and Scotland in the 1840's. In 1854 the 1:2,500 scale was adopted for mapping urban areas; these maps were used to update the 1:10,560 maps. The published date given therefore is often some years later than the surveyed date. Before 1938, all OS maps were based on the Cassini Projection, with independent surveys of a single county or group of counties, giving rise to significant inaccuracies in outlying areas. In the late 1940's, a Provisional Edition was produced, which updated the 1:10,560 mapping from a number of sources. The maps appear unfinished - with all military camps and other strategic sites removed. These maps were initially overprinted with the National Grid. In 1970, the first 1:10,000 maps were produced using the Transverse Mercator Projection. The revision process continued until recently, with new editions appearing every 10 years or so for urban areas.

Map Name(s) and Date(s)

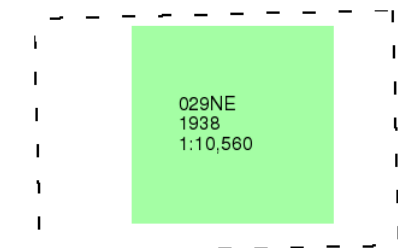

Historical Map - Slice A

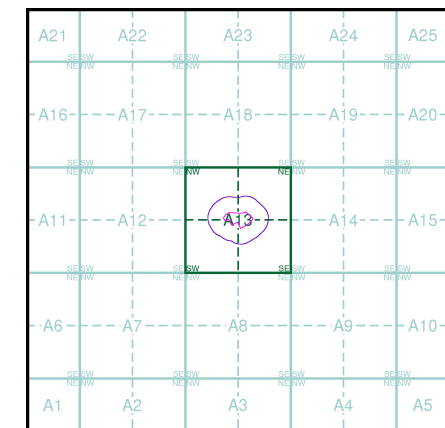

Order Details

Order Number: 285081324_1_1
 Customer Ref: JER8369
 National Grid Reference: 534250, 216080
 Slice: A
 Site Area (Ha): 1.16
 Search Buffer (m): 1000

Site Details

Ware WTS



Tel: 0844 844 9952
 Fax: 0844 844 9951
 Web: www.envirocheck.co.uk

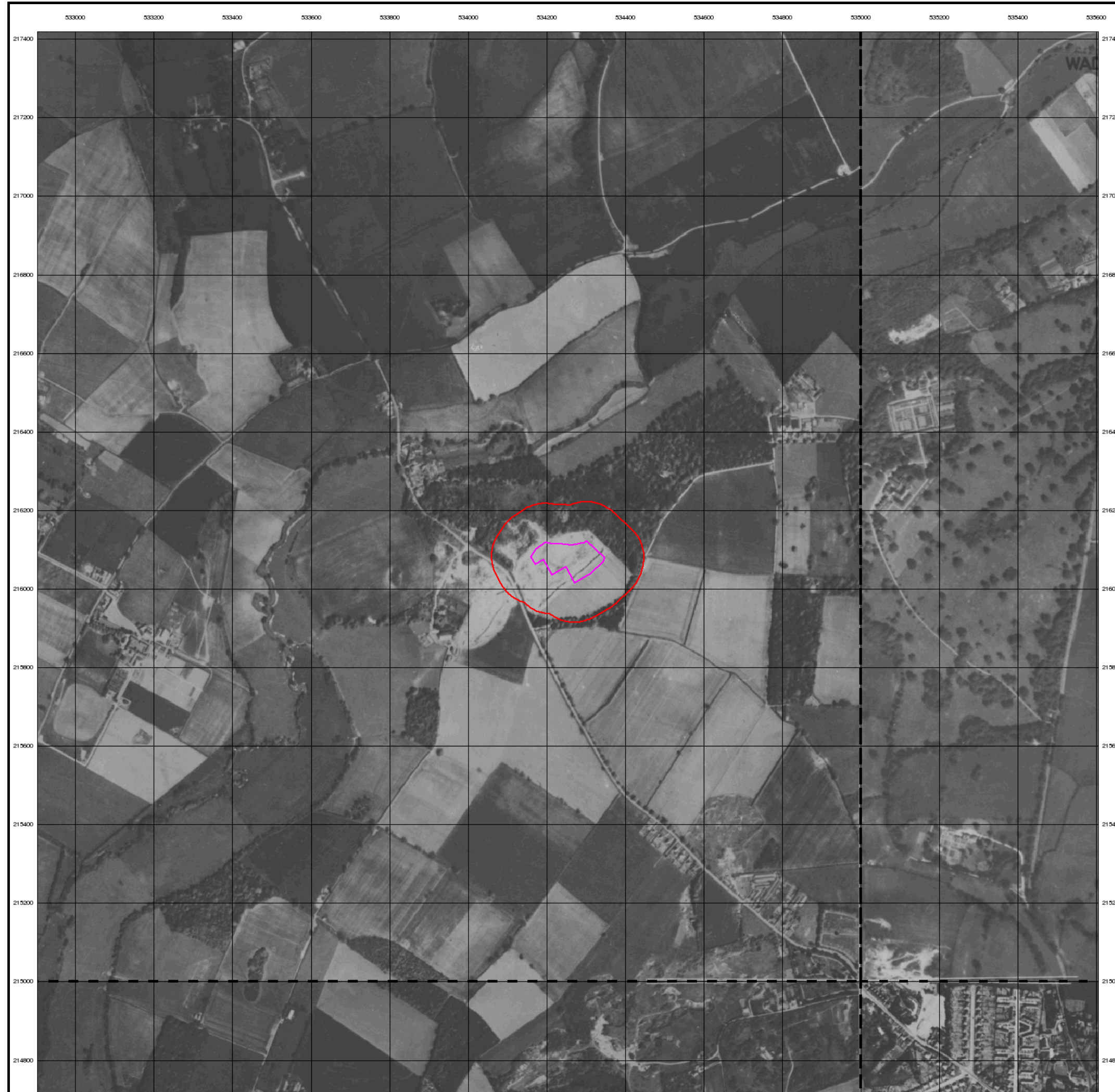

Historical Aerial Photography

Published 1949

Source map scale - 1:10,560

The Historical Aerial Photos were produced by the Ordnance Survey at a scale of 1:1,250 and 1:10,560 from Air Force photography. They were produced between 1944 and 1951 as an interim measure, pending preparation of conventional mapping, due to post war resource shortages. New security measures in the 1950's meant that every photograph was re-checked for potentially unsafe information with security sites replaced by fake fields or clouds. The original editions were withdrawn and only later made available after a period of fifty years although due to the accuracy of the editing, without viewing both revisions it is not easy to spot the edits. Where available Landmark have included both revisions.

© Landmark Information Group and/or Data Suppliers 2010.

Map Name(s) and Date(s)

TL31NW 1949 1:10,560	TL31NE 1949 1:10,560
TL31SW 1949 1:10,560	TL31SE 1949 1:10,560

Historical Aerial Photography - Slice A

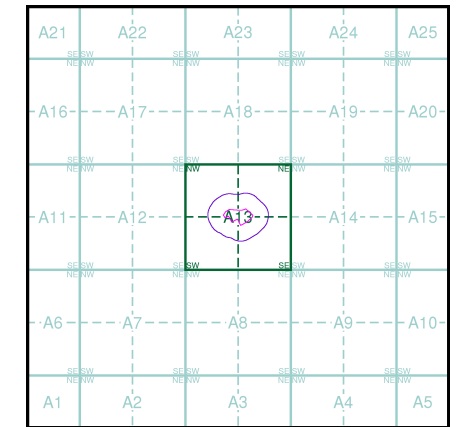

Order Details

Order Number: 285081324_1_1
 Customer Ref: JER8369
 National Grid Reference: 534250, 216080
 Slice: A
 Site Area (Ha): 1.16
 Search Buffer (m): 1000

Site Details

Ware WTS



Tel: 0844 844 9952
 Fax: 0844 844 9951
 Web: www.envirocheck.co.uk

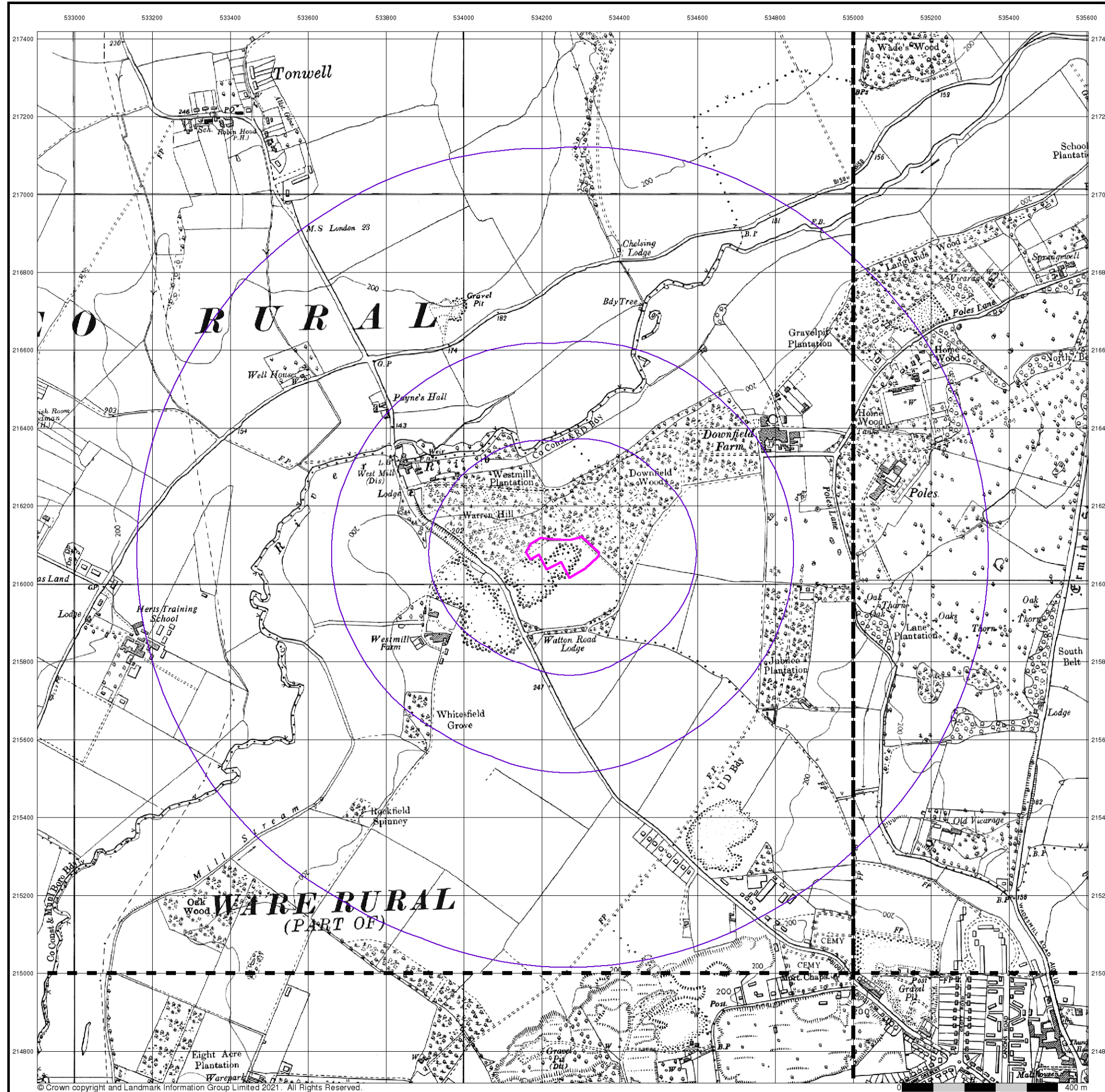

© Crown copyright and Landmark Information Group Limited 2021. All Rights Reserved.



Ordnance Survey Plan
Published 1960
Source map scale - 1:10,000

The historical maps shown were reproduced from maps predominantly held at the scale adopted for England, Wales and Scotland in the 1840's. In 1854 the 1:2,500 scale was adopted for mapping urban areas; these maps were used to update the 1:10,560 maps. The published date given therefore is often some years later than the surveyed date. Before 1938, all OS maps were based on the Cassini Projection, with independent surveys of a single county or group of counties, giving rise to significant inaccuracies in outlying areas. In the late 1940's, a Provisional Edition was produced, which updated the 1:10,560 mapping from a number of sources. The maps appear unfinished - with all military camps and other strategic sites removed. These maps were initially overprinted with the National Grid. In 1970, the first 1:10,000 maps were produced using the Transverse Mercator Projection. The revision process continued until recently, with new editions appearing every 10 years or so for urban areas.

Map Name(s) and Date(s)

TL31NW	TL31NE
1960	1960
1:10,560	1:10,560
TL31SW	TL31SE
1960	1960
1:10,560	1:10,560

Historical Map - Slice A

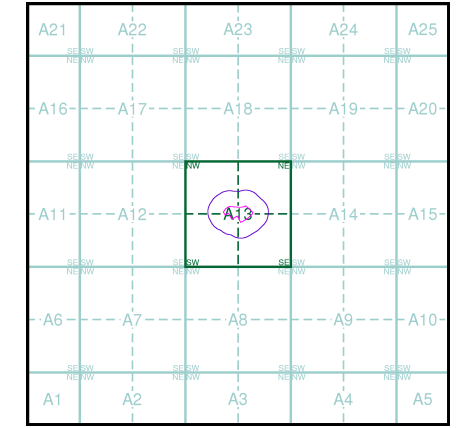

Order Details

Order Number: 285081324_1_1
 Customer Ref: JER8369
 National Grid Reference: 534250, 216080
 Slice: A
 Site Area (Ha): 1.16
 Search Buffer (m): 1000

Site Details

Ware WTS



Tel: 0844 844 9952
 Fax: 0844 844 9951
 Web: www.envirocheck.co.uk

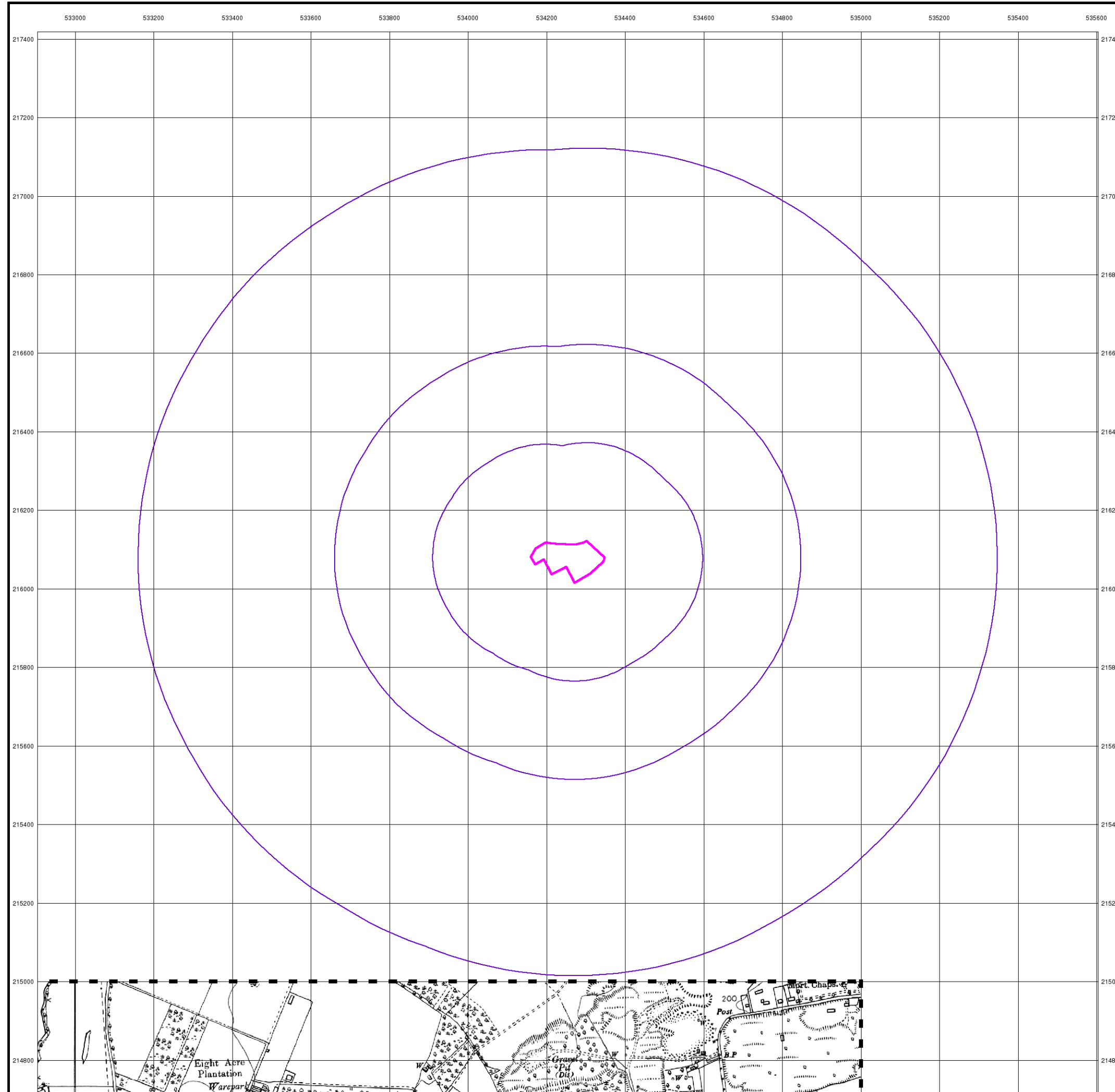

© Crown copyright and Landmark Information Group Limited 2021. All Rights Reserved.



Ordnance Survey Plan
Published 1960
Source map scale - 1:10,000

The historical maps shown were reproduced from maps predominantly held at the scale adopted for England, Wales and Scotland in the 1840's. In 1854 the 1:2,500 scale was adopted for mapping urban areas; these maps were used to update the 1:10,560 maps. The published date given therefore is often some years later than the surveyed date. Before 1938, all OS maps were based on the Cassini Projection, with independent surveys of a single county or group of counties, giving rise to significant inaccuracies in outlying areas. In the late 1940's, a Provisional Edition was produced, which updated the 1:10,560 mapping from a number of sources. The maps appear unfinished - with all military camps and other strategic sites removed. These maps were initially overprinted with the National Grid. In 1970, the first 1:10,000 maps were produced using the Transverse Mercator Projection. The revision process continued until recently, with new editions appearing every 10 years or so for urban areas.

Map Name(s) and Date(s)

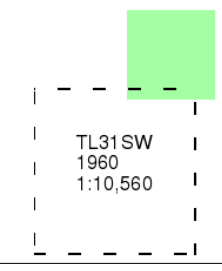

Historical Map - Slice A

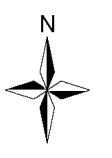
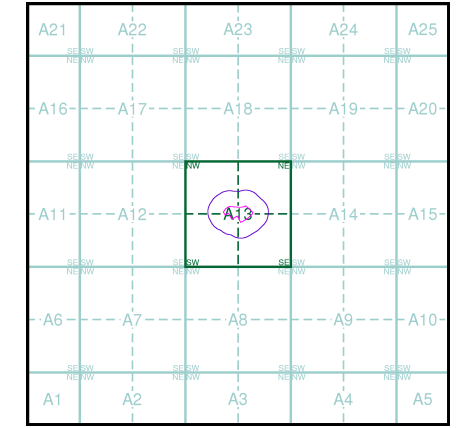

Order Details

Order Number: 285081324_1_1
 Customer Ref: JER8369
 National Grid Reference: 534250, 216080
 Slice: A
 Site Area (Ha): 1.16
 Search Buffer (m): 1000

Site Details

Ware WTS



Tel: 0844 844 9952
 Fax: 0844 844 9951
 Web: www.envirocheck.co.uk

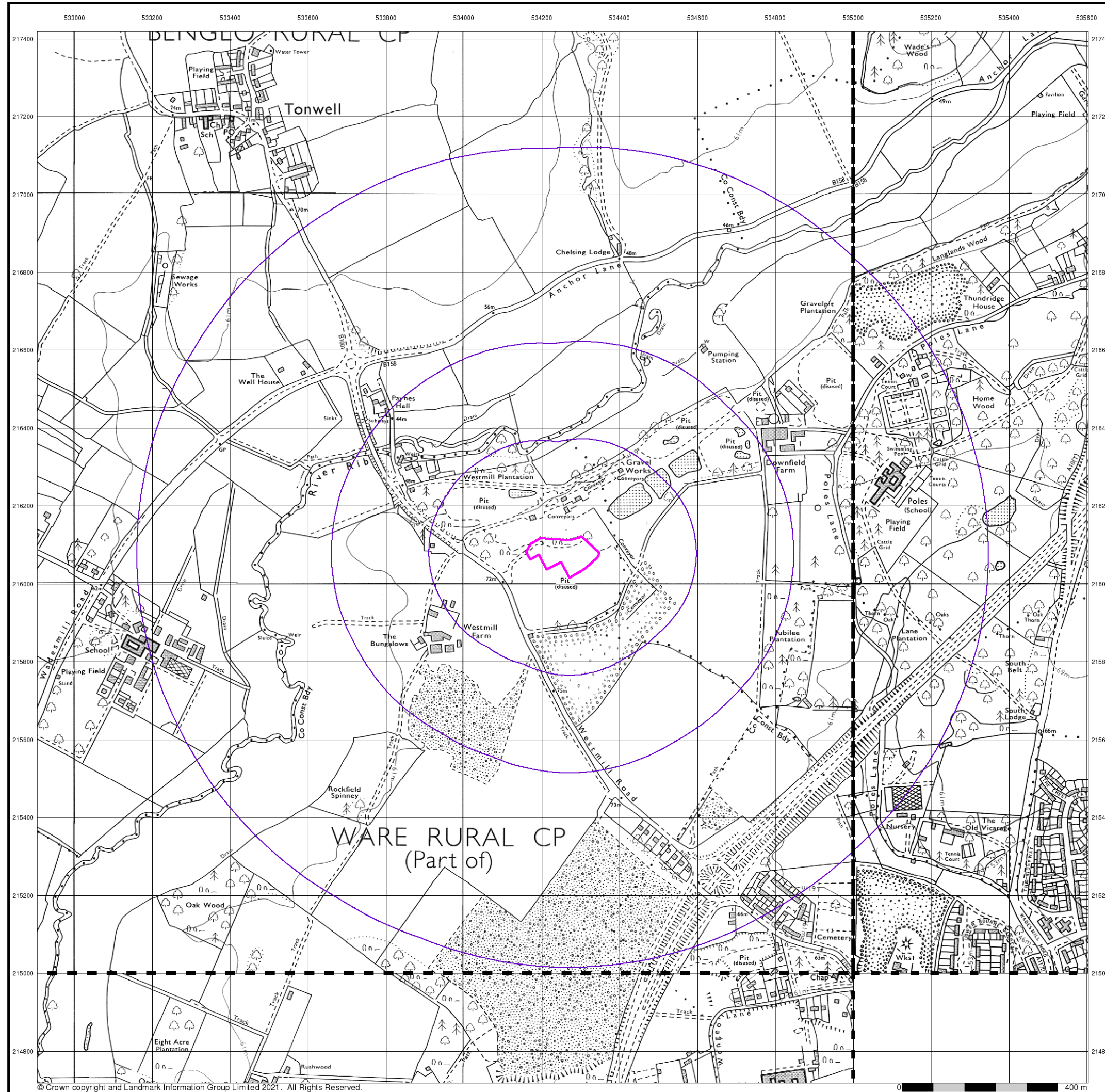

Ordnance Survey Plan

Published 1977 - 1978

Source map scale - 1:10,000

The historical maps shown were reproduced from maps predominantly held at the scale adopted for England, Wales and Scotland in the 1840's. In 1854 the 1:2,500 scale was adopted for mapping urban areas; these maps were used to update the 1:10,560 maps. The published date given therefore is often some years later than the surveyed date. Before 1938, all OS maps were based on the Cassini Projection, with independent surveys of a single county or group of counties, giving rise to significant inaccuracies in outlying areas. In the late 1940's, a Provisional Edition was produced, which updated the 1:10,560 mapping from a number of sources. The maps appear unfinished - with all military camps and other strategic sites removed. These maps were initially overprinted with the National Grid. In 1970, the first 1:10,000 maps were produced using the Transverse Mercator Projection. The revision process continued until recently, with new editions appearing every 10 years or so for urban areas.

Map Name(s) and Date(s)

TL31NW 1977 1:10,000	TL31NE 1977 1:10,000
TL31SW 1978 1:10,000	

Historical Map - Slice A

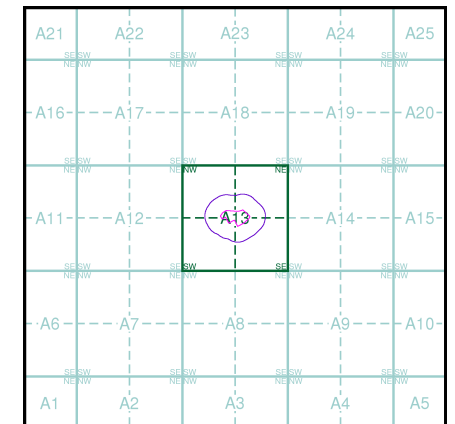

Order Details

Order Number: 285081324_1_1
 Customer Ref: JER8369
 National Grid Reference: 534250, 216080
 Slice: A
 Site Area (Ha): 1.16
 Search Buffer (m): 1000

Site Details

Ware WTS



Tel: 0844 844 9952
 Fax: 0844 844 9951
 Web: www.envirocheck.co.uk

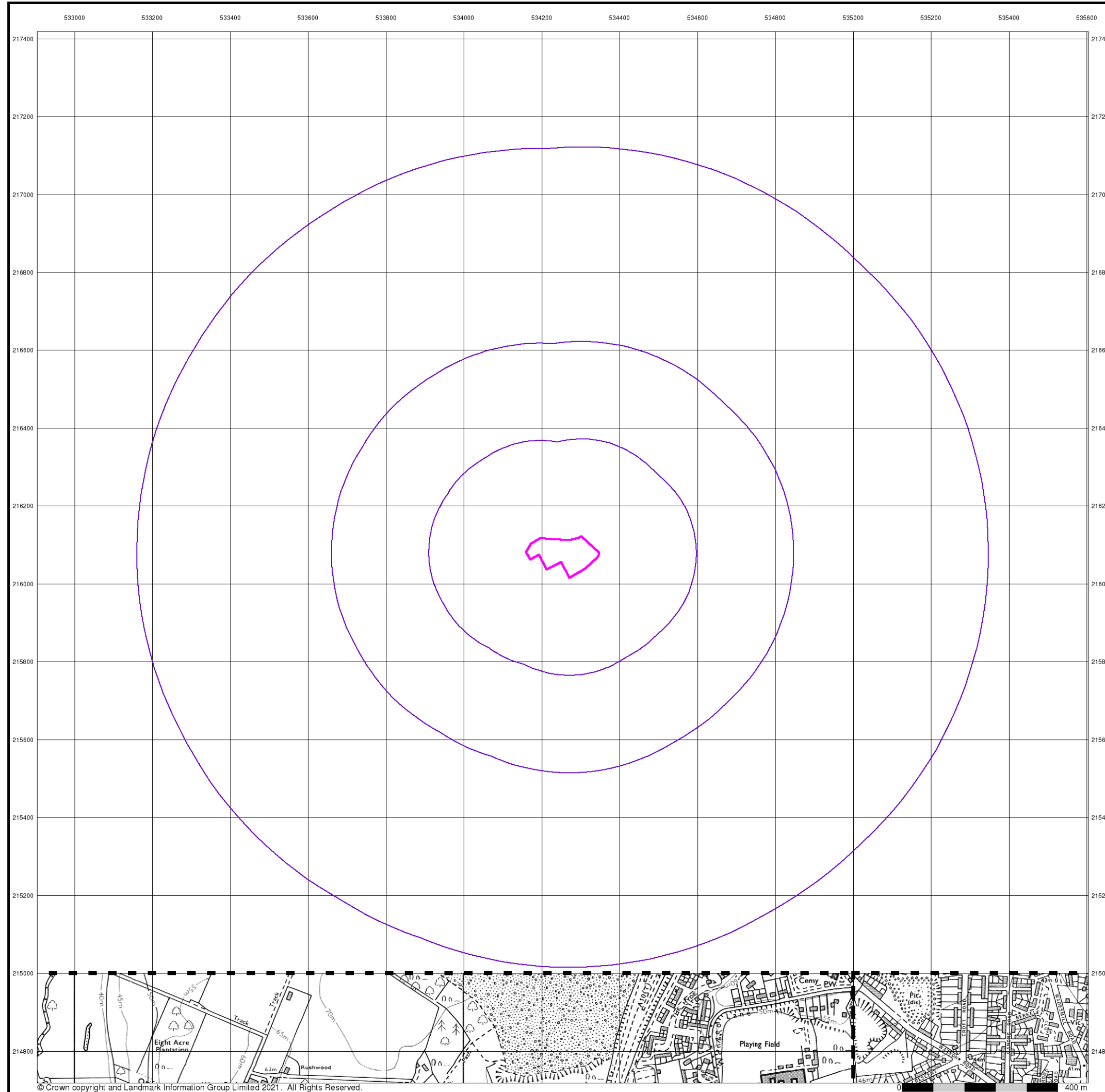

© Crown copyright and Landmark Information Group Limited 2021. All Rights Reserved.



Ordnance Survey Plan

Published 1980 - 1989

Source map scale - 1:10,000

The historical maps shown were reproduced from maps predominantly held at the scale adopted for England, Wales and Scotland in the 1840's. In 1854 the 1:2,500 scale was adopted for mapping urban areas; these maps were used to update the 1:10,560 maps. The published date given therefore is often some years later than the surveyed date. Before 1938, all OS maps were based on the Cassini Projection, with independent surveys of a single county or group of counties, giving rise to significant inaccuracies in outlying areas. In the late 1940's, a Provisional Edition was produced, which updated the 1:10,560 mapping from a number of sources. The maps appear unfinished - with all military camps and other strategic sites removed. These maps were initially overprinted with the National Grid. In 1970, the first 1:10,000 maps were produced using the Transverse Mercator Projection. The revision process continued until recently, with new editions appearing every 10 years or so for urban areas.

Map Name(s) and Date(s)

TL31SW 1989 1:10,000	TL31SE 1980 1:10,000
----------------------------	----------------------------

Historical Map - Slice A

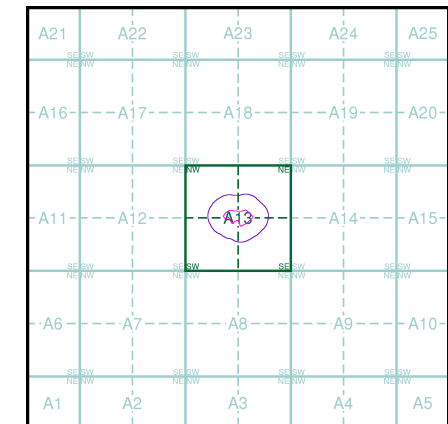

Order Details

Order Number: 285081324_1_1
 Customer Ref: JER8369
 National Grid Reference: 534250, 216080
 Slice: A
 Site Area (Ha): 1.16
 Search Buffer (m): 1000

Site Details

Ware WTS



Tel: 0844 844 9952
 Fax: 0844 844 9951
 Web: www.envirocheck.co.uk

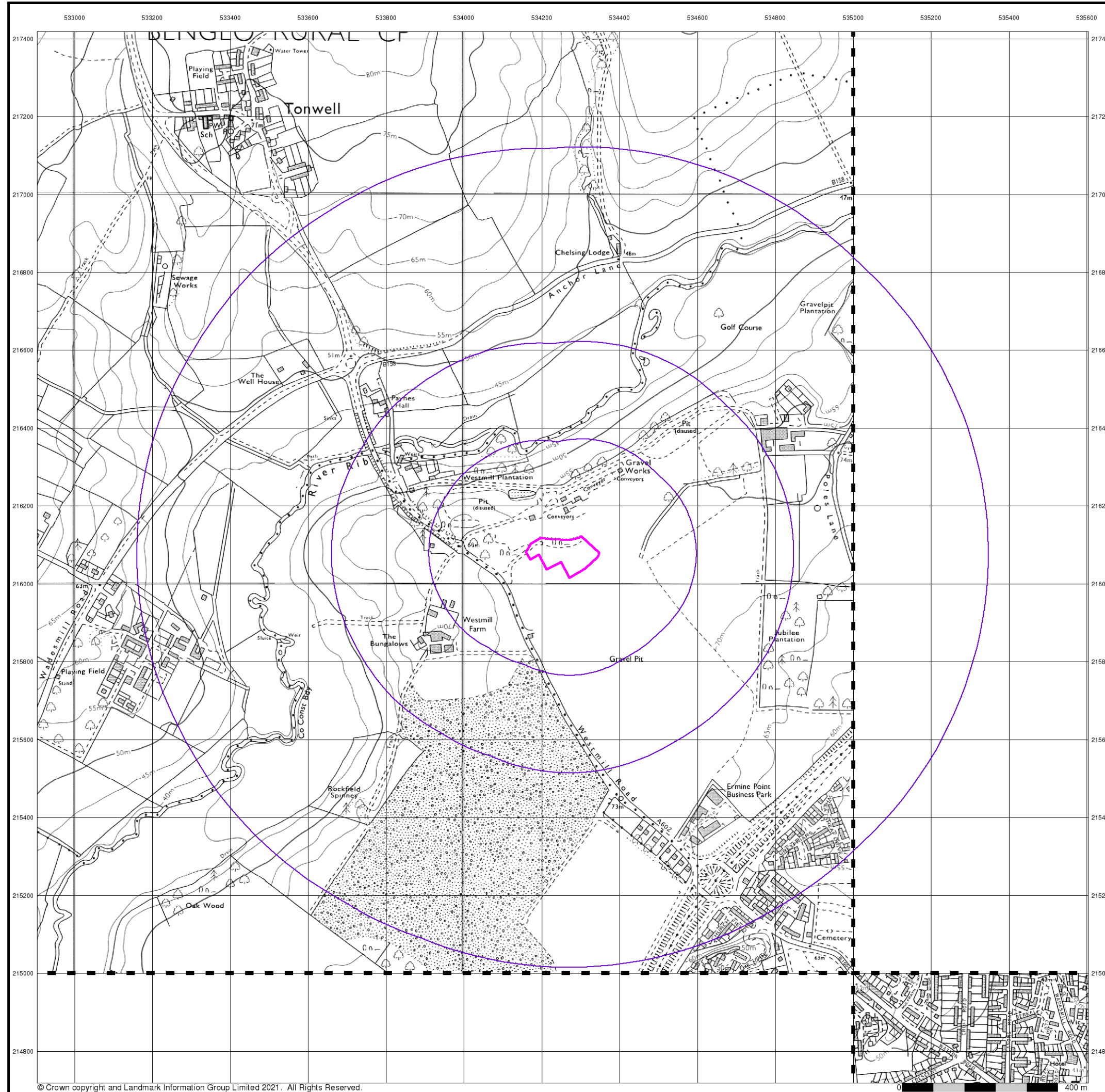

© Crown copyright and Landmark Information Group Limited 2021. All Rights Reserved.



Ordnance Survey Plan

Published 1993 - 1994

Source map scale - 1:10,000

The historical maps shown were reproduced from maps predominantly held at the scale adopted for England, Wales and Scotland in the 1840's. In 1854 the 1:2,500 scale was adopted for mapping urban areas; these maps were used to update the 1:10,560 maps. The published date given therefore is often some years later than the surveyed date. Before 1938, all OS maps were based on the Cassini Projection, with independent surveys of a single county or group of counties, giving rise to significant inaccuracies in outlying areas. In the late 1940's, a Provisional Edition was produced, which updated the 1:10,560 mapping from a number of sources. The maps appear unfinished - with all military camps and other strategic sites removed. These maps were initially overprinted with the National Grid. In 1970, the first 1:10,000 maps were produced using the Transverse Mercator Projection. The revision process continued until recently, with new editions appearing every 10 years or so for urban areas.

Map Name(s) and Date(s)

TL31NW	1993	1:10,000
TL31SE	1994	1:10,000

Historical Map - Slice A

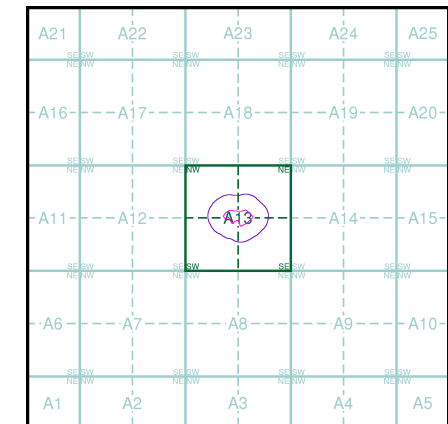

Order Details

Order Number: 285081324_1_1
 Customer Ref: JER8369
 National Grid Reference: 534250, 216080
 Slice: A
 Site Area (Ha): 1.16
 Search Buffer (m): 1000

Site Details

Ware WTS



Tel: 0844 844 9952
 Fax: 0844 844 9951
 Web: www.envirocheck.co.uk

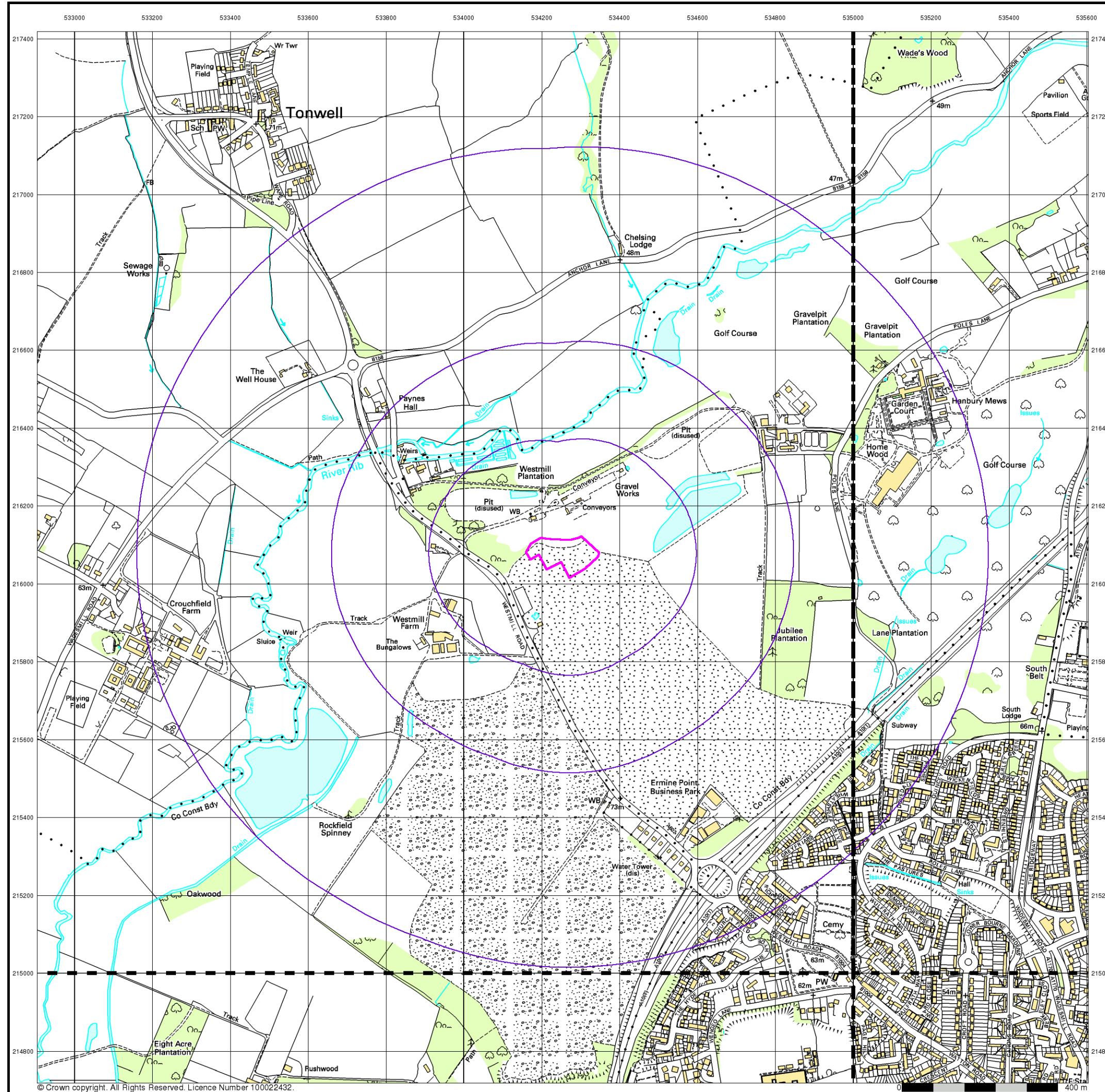

© Crown copyright. All Rights Reserved. Licence Number 100022432.



10k Raster Mapping

Published 1999

Source map scale - 1:10,000

The historical maps shown were produced from the Ordnance Survey's 1:10,000 colour raster mapping. These maps are derived from Landplan which replaced the old 1:10,000 maps originally published in 1970. The data is highly detailed showing buildings, fences and field boundaries as well as all roads, tracks and paths. Road names are also included together with the relevant road number and classification. Boundary information depiction includes county, unitary authority, district, civil parish and constituency.

Map Name(s) and Date(s)

TL31NW 1999 1:10,000	TL31NE 1999 1:10,000
TL31SW 1999 1:10,000	TL31SE 1999 1:10,000

Historical Map - Slice A

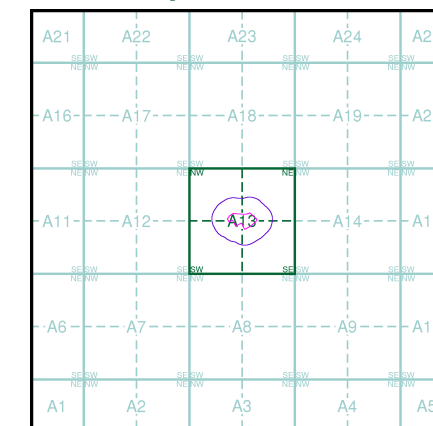

Order Details

Order Number: 285081324_1_1
 Customer Ref: JER8369
 National Grid Reference: 534250, 216080
 Slice: A
 Site Area (Ha): 1.16
 Search Buffer (m): 1000

Site Details

Ware WTS



Tel: 0844 844 9952
 Fax: 0844 844 9951
 Web: www.envirocheck.co.uk

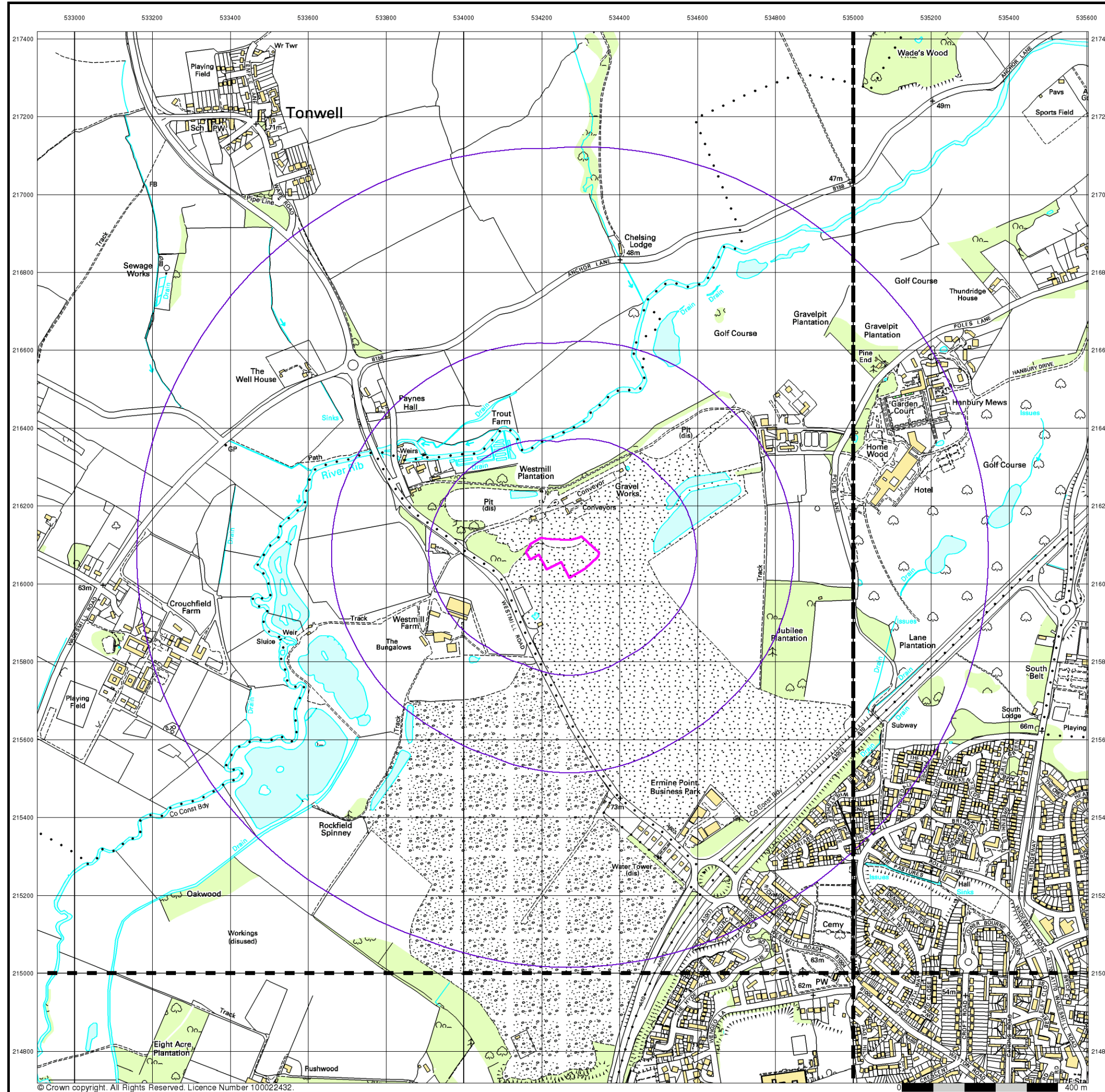

© Crown copyright. All Rights Reserved. Licence Number 100022432.



10k Raster Mapping

Published 2006

Source map scale - 1:10,000

The historical maps shown were produced from the Ordnance Survey's 1:10,000 colour raster mapping. These maps are derived from Landplan which replaced the old 1:10,000 maps originally published in 1970. The data is highly detailed showing buildings, fences and field boundaries as well as all roads, tracks and paths. Road names are also included together with the relevant road number and classification. Boundary information depiction includes county, unitary authority, district, civil parish and constituency.

Map Name(s) and Date(s)

TL31NW 2006 1:10,000	TL31NE 2006 1:10,000
TL31SW 2006 1:10,000	TL31SE 2006 1:10,000

Historical Map - Slice A

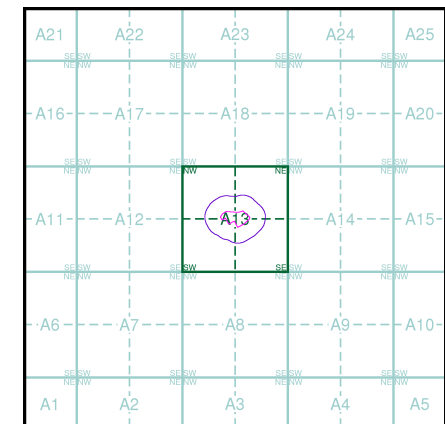

Order Details

Order Number: 285081324_1_1
 Customer Ref: JER8369
 National Grid Reference: 534250, 216080
 Slice: A
 Site Area (Ha): 1.16
 Search Buffer (m): 1000

Site Details

Ware WTS



Tel: 0844 844 9952
 Fax: 0844 844 9951
 Web: www.envirocheck.co.uk

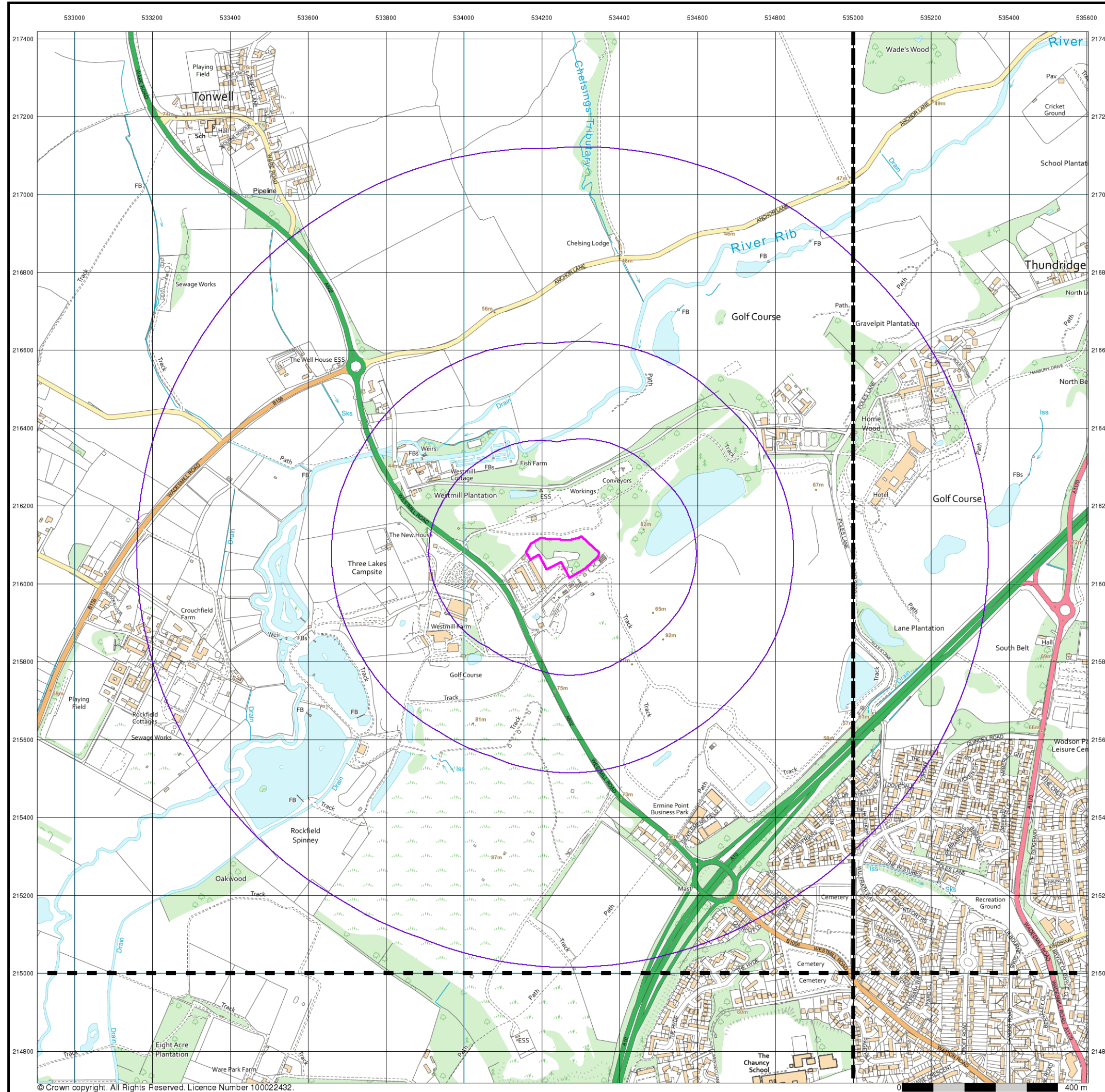

© Crown copyright. All Rights Reserved. Licence Number 100022432.



VectorMap Local

Published 2021

Source map scale - 1:10,000

VectorMap Local (Raster) is Ordnance Survey's highest detailed 'backdrop' mapping product. These maps are produced from OS's VectorMap Local, a simple vector dataset at a nominal scale of 1:10,000, covering the whole of Great Britain, that has been designed for creating graphical mapping. OS VectorMap Local is derived from large-scale information surveyed at 1:1250 scale (covering major towns and cities), 1:2500 scale (smaller towns, villages and developed rural areas), and 1:10 000 scale (mountain, moorland and river estuary areas).

Map Name(s) and Date(s)

TL31NW 2021 Variable	TL31NE 2021 Variable
TL31SW 2021 Variable	TL31SE 2021 Variable

Historical Map - Slice A

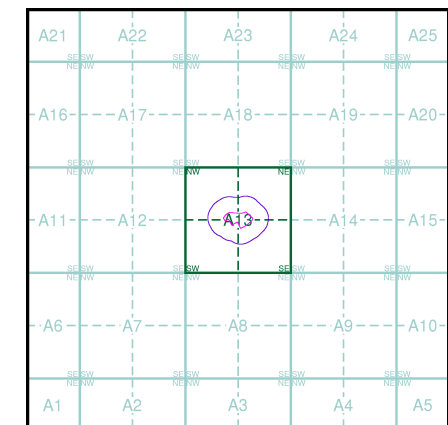

Order Details

Order Number: 285081324_1_1
 Customer Ref: JER8369
 National Grid Reference: 534250, 216080
 Slice: A
 Site Area (Ha): 1.16
 Search Buffer (m): 1000

Site Details

Ware WTS



Tel: 0844 844 9952
 Fax: 0844 844 9951
 Web: www.envirocheck.co.uk