

Notes

1. This drawing has been prepared in accordance with the scope of RPS's appointment with its client and is subject to the terms and conditions of that appointment. RPS accepts no liability for any use of this document other than by its client and only for the purposes for which it was prepared and provided.
2. If received electronically it is the recipient's responsibility to print to correct scale. Only written dimensions should be used.
3. This drawing should be read in conjunction with all other relevant drawings and specifications.

Key

- Fire Hydrant
- Muster Point
- Quarantine Area
- Fuel Tanks
- Sprinkler tanks/Fire water tanks/Pump house
- Odour Abatement
- Main access routes for fire engines
- Area confirmed by HCC that will not be built on and will remain for vehicle manoeuvring only
- Permit Boundary

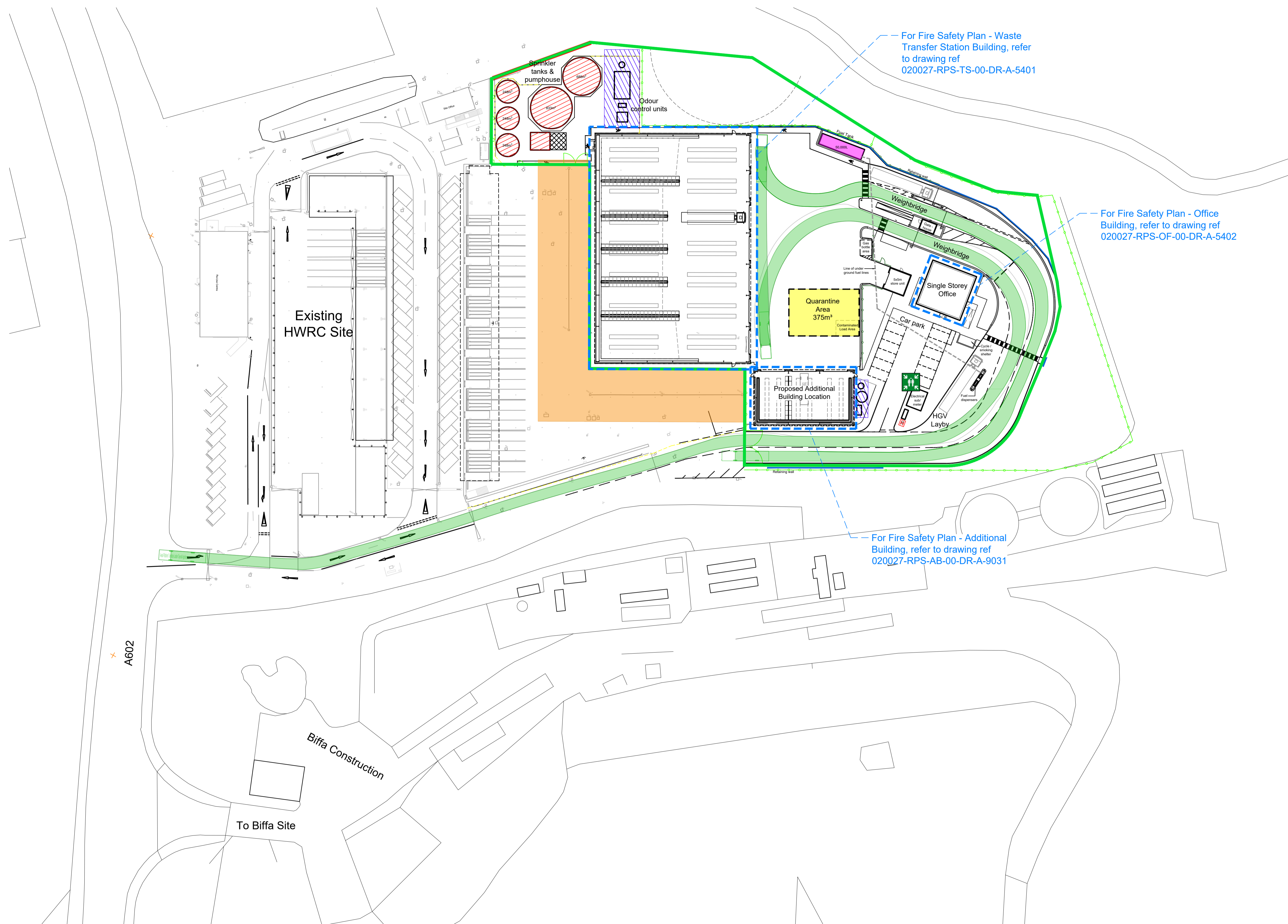

For Fire Safety Plan - Waste Transfer Station Building, refer to drawing ref 020027-RPS-TS-00-DR-A-5401

For Fire Safety Plan - Office Building, refer to drawing ref 020027-RPS-OF-00-DR-A-5402

For Fire Safety Plan - Additional Building, refer to drawing ref 020027-RPS-AB-00-DR-A-9031

Site Plan
Scale 1:500



P01	First Issue	JJD	SG	15.12.21
Rev	Description	By	Ckd	Date



Sherwood House, Sherwood Avenue,
Newark, Nottinghamshire, NG24 1QQ
T:01636 605 700 E: rpsnewark@rpsgroup.com

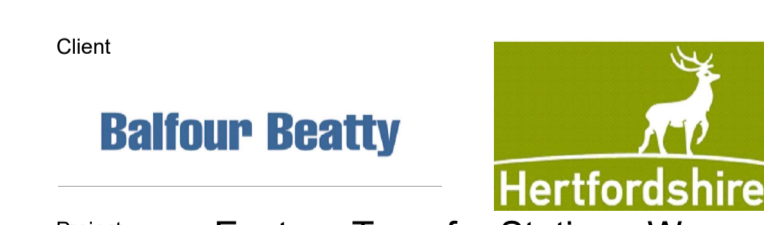

Project Eastern Transfer Station - Ware

Title Fire Safety Plan - Site

RPS Project Number	Scale @ A1	Date Created
NK020027	1:500	11.10.2021
Task Team Manager	Information Author	Task Information Manager
SG	AT	ET

Status
S2 (Suitable for Information)
Document Number
20027-RPS-SI-XX-DR-A-0121
Project Code - Originator - Zone - Level - Type - Role - Drawing Number
rpsgroup.com