

wardell-armstrong.com

ENERGY AND CLIMATE CHANGE
ENVIRONMENT AND SUSTAINABILITY
INFRASTRUCTURE AND UTILITIES
LAND AND PROPERTY
MINING AND MINERAL PROCESSING
MINERAL ESTATES
WASTE RESOURCE MANAGEMENT



RON HULL JNR. LIMITED

GRANGE MILL METAL RECYCLING FACILITY

NON-TECHNICAL SUMMARY

APRIL 2024

DATE ISSUED: April 2024
JOB NUMBER: ST20716
REPORT NUMBER:
VERSION: V0.2
STATUS: Final

RON HULL JNR LTD

APPLICATION TO VARY PERMIT NUMBER EPR/KB3902KR

NON-TECHNICAL SUMMARY

APRIL 2024

PREPARED BY:

Alison Cook Technical Director



APPROVED BY:

Andy Belton
Team Lead Waste
Resource Management



This report has been prepared by Wardell Armstrong LLP with all reasonable skill, care and diligence, within the terms of the Contract with the Client. The report is confidential to the Client and Wardell Armstrong LLP accepts no responsibility of whatever nature to third parties to whom this report may be made known.

No part of this document may be reproduced without the prior written approval of Wardell Armstrong LLP.



CONTENTS

1 INTRODUCTION 1

2 ENVIRONMENTAL PERMIT APPLICATION 2

3 SITE SETTING 2

4 PROPOSED ACTIVITIES 2

5 ENVIRONMENTAL RISK AND MITIGATION 3

6 ENVIRONMENTAL MANAGEMENT SYSTEMS 3

1 INTRODUCTION

- 1.1 Wardell Armstrong have been commissioned by Ron Hull Jnr. Limited to prepare a permit variation application for their operation of metal recycling facility at 8 Grange Mill Lane, Sheffield, S9 1HW.
- 1.2 The permit reference is EPR/KB2902KR.
- 1.3 The variation of the existing permit is to change the list of accepted waste codes. It is proposed to re-introduce five waste codes that were originally on the sites waste management licence (EAWML65522). A range of other wastes will also be added to the list, allowing the operation of a waste transfer station.
- 1.4 The variation will add an activity to the permit for the storage of hazardous and non-hazardous waste. It is noted that both hazardous and non-hazardous wastes can currently be accepted on site as part of the metal recycling operation.
- 1.5 There will be no change to the site throughput or the site boundary.
- 1.6 The site has been designed, and currently operates, to provide comprehensive environmental protection. The site is operated under an Environmental Management System, and in accordance with relevant Environment Agency guidance. This has been updated to reflect this variation application.
- 1.7 The documents that comprise the permit application are detailed in Section 2.
- 1.8 The site is located on an industrial estate to the east of Sheffield, bordering the M1 motorway. Further details are provided in Section 3.
- 1.9 Metals, WEEE and end-of-life vehicles that are accepted at the site will undergo treatment within a shredder and associated activities. From there materials will be stored in bays awaiting removal from the site. Other materials will be accepted for storage only. Further details are provided in Section 4.
- 1.10 Measures will be in place at the site to ensure that the environment remains protected during operation. These includes procedures to deal with emissions of noise and dust. Further details are provided in Section 5.
- 1.11 The site will be operated under an Environmental Management System (EMS). Details are provided in Section 6.

2 ENVIRONMENTAL PERMIT APPLICATION

2.1 This application comprises the following:

- Application forms;
 - Part A
 - List of Directors
 - Part C2
 - Part C3
 - Additional Wastes List
 - Part F
- Non-Technical Summary;
- Operating techniques, describing the new activities;
- Environmental Risk Assessment (inclusive of Habitats Risk Assessment);
- Updated Fire Prevention Plan,
- Updated Dust Management Plan and
- An updated Environment Management System.

2.2 These documents demonstrate that operations at the facility will not pose an adverse risk to the environment. The site will be operated in accordance with an Environmental Management System (EMS), and comprehensive management procedure is in place to ensure that any risks are managed.

3 SITE SETTING

3.1 The site is located to the Northeast of Sheffield, approximately 6km from the City centre, at National Grid Reference (NGR) SK 38043 93199.

3.2 The site is located in an industrial area along Grange Mill Lane, and currently operates as a Metal Recycling Facility. The variation does not include any proposal to change site operations or buildings.

3.3 A scrap yard lies to the Southeast of the site, a truck park to the Northwest, Blackburn Brook to the Southwest boundary (immediately adjacent to the Penistone Line railway and B6082 Ecclesfield Road) and Grange Mill Lane to the North East (running parallel to the M1 motorway which is situated on a raised embankment).

3.4 The site is accessed exclusively from Grange Mill Lane.

3.5 The site layout is shown on drawing ST20716-001.

- 3.6 The site is a metal recycling operation that includes baling, gas cutting, shearing, magnetic sorting, air blower sorting, hand sorting and shredding of up to 295,000 tonnes per annum of metal wastes.
- 3.7 The facility currently comprises:
- A metal shredding installation with capacity exceeding 75 tonnes per day;
 - A manual vehicle storage, depollution, and dismantling operation;
 - A WEEE storage and treatment operation;
 - A metal recycling operation; and
 - Storage of furnace ready scrap.
- 3.8 The variation will allow Ron Hull Jnr to offer a more comprehensive service to clients by accepting additional waste types for storage only. Materials will be provided with appropriate containment, including secondary containment where necessary to minimise the risk of emissions.

4 ENVIRONMENTAL RISK AND MITIGATION

- 4.1 The design, operation and subsequent decommissioning of the site will be undertaken in accordance with regulatory requirements and best practice guidance. This will minimise the potential for any uncontrolled emissions to air, water or land.
- 4.2 The site is provided with impermeable surfacing and sealed drainage. Wastes will be provided with additional containment where required to minimise the risk of leaks, spills or dust.
- 4.3 Procedures within the site EMS will ensure that inspections and maintenance of environmental protection infrastructure are completed in accordance with a required schedule.
- 4.4 Staff will be provided with regular training on the environmental protection requirements for the site.

5 ENVIRONMENTAL MANAGEMENT SYSTEMS

- 5.1 Ron Hull Jnr Limited operate the site in compliance with an EMS. The Company have complete control over site operations, maintenance, competence and training, prevention of accidents, organisation and document management and records.
- 5.2 Adherence to the management system will ensure that regular training, checks and preventative maintenance are carried out at the facility, along with promoting an

ethos of continuous improvement to site operations.

- 5.3 The site will be under the control of a Technically Competent Manager who holds the appropriate qualifications. The TCM will ensure that their site attendance will comply with Environment Agency requirements.
- 5.4 An updated EMS forms part of this application.

DRAWINGS

DO NOT SCALE FROM THIS DRAWING

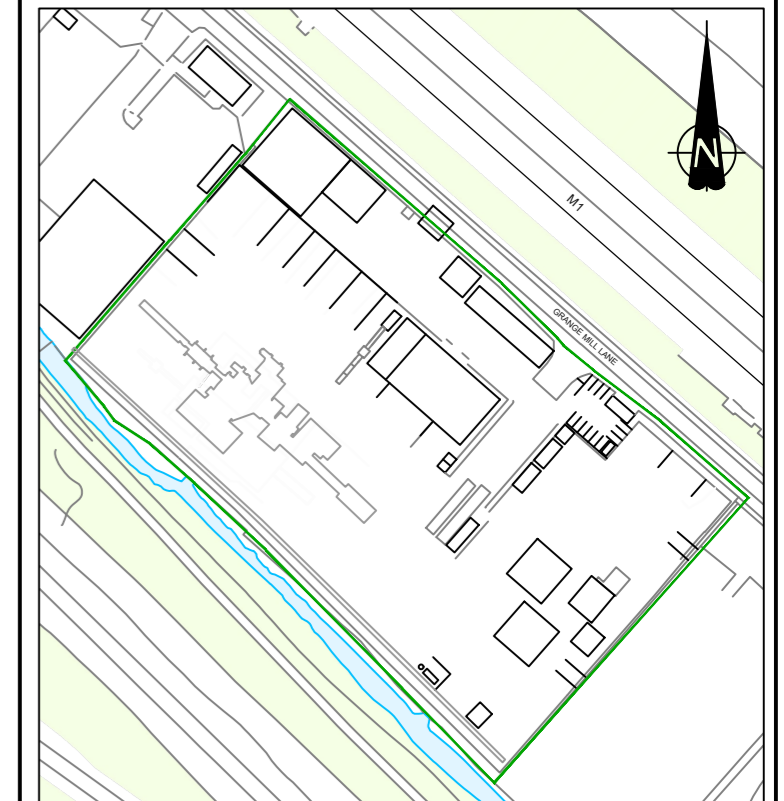

KEY PLAN
SCALE 1:2500

KEY
— PERMIT BOUNDARY
- - - FOUL WATER DRAIN

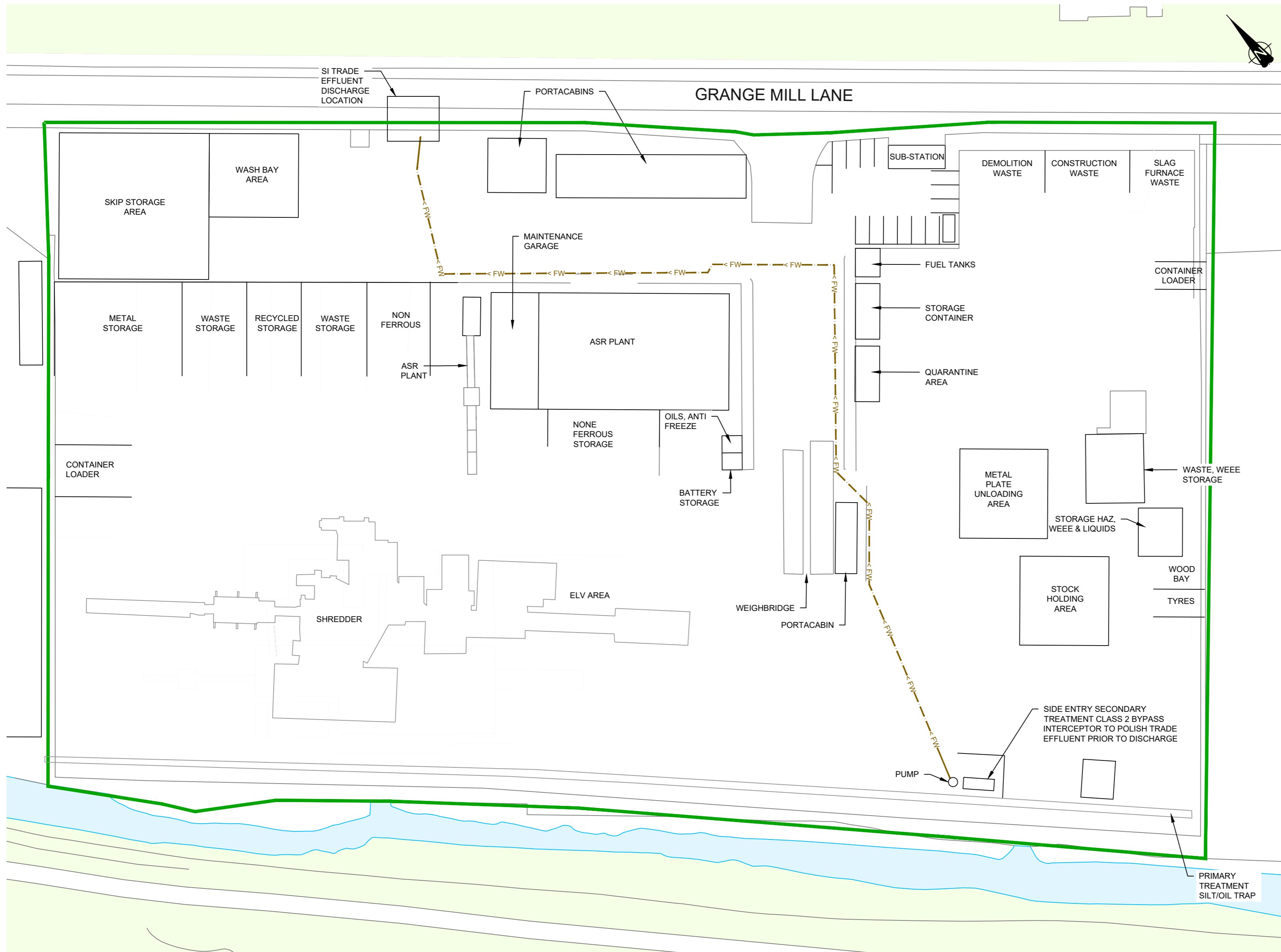

A	FIRST ISSUE	04/04/24	SJB	AC	AC
REVISION	DETAILS	DATE	DRAWN	CHKD	APPD

CLIENT
THE RON HULL JR LTD.

PROJECT
PERMIT VARIATIONS TO EXTEND WASTE TYRES

DRAWING TITLE
SITE LAYOUT PLAN

DRG No.	ST20716-001	REV	A	SUIT. CODE	
DRG SIZE	A2	SCALE	1:500	DATE	26/03/24
DRAWN BY	SJB	CHECKED BY	AC	APPROVED BY	AC

©Crown Copyright and database rights 2024
 Ordnance Survey 0100031673

