



College

- KEY:**
- Installation Boundary
 - Area Excluded from Permit Scope
 - Air Emission Point
 - Liquor Transfer Point
 - Return Liquor Sampling Point

- A1a - CHP Engine 1
- A1b - Steam Boiler 1
- A2a - CHP Engine 2
- A2b - Steam Boiler 2
- A3a - CHP Engine 3
- A3b - Steam Boiler 3
- A4 - Emergency Flare
- A6 - THP PRV
- A7 - Primary Digester Tank PRV
- A8 - Primary Digester Tank PRV
- A9 - Primary Digester Tank PRV
- A10 - Primary Digester Tank PRV
- A11 - Biogas Storage PRV
- A12 - Biogas Storage PRV
- A13 - OCU 1
- A14 - OCU 3
- A15 - Cake Barn Ventilation Emission Stack

- S1 - Sludge Dewatering Liquors, Digested Sludge Dewatering Liquors, Biogas Condensate, OCU Waste Waters, Boiler Waste Waters

- T1 - Sludge Dewatering Liquors, Digested Sludge Dewatering Liquors, Biogas Condensate, OCU Waste Waters, Boiler Waste Waters

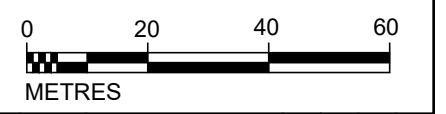

Rev	Rev. Date	Purpose of revision	Drawn	Checked	Rev'd	Apprv'd
P06	NOV. 2023	FOR INFORMATION	AR	MM	JK	MM
P05	NOV. 2023	FOR INFORMATION	AR	MM	JK	MM
P04	NOV. 2023	FOR INFORMATION	AR	MM	JK	MM
P03	OCT. 2023	FOR INFORMATION	AR	MM	JK	MM
P02	AUG. 2023	FOR INFORMATION	AR	MM	JK	MM
P01	NOV. 2021	FOR INFORMATION	AR	MM	JK	MM

Jacobs
 1108 Eakdale Road, Winnersh, Reading, RG41 5TU
 Tel: +44(0)118 946 7000
 www.jacobs.com

Client

Project
STC IED PERMIT RIVERSIDE STW

Drawing title
**FIGURE 2
 INSTALLATION BOUNDARY
 AND AIR EMISSION POINTS**

Drawing status
PERMITTING

Scale
 1:1250 @A3
DO NOT SCALE

Jacobs No. B22849AM Rev P06

Drawing number
B22849AM-JAC-RVE-DR-0002

© Copyright 2020 Jacobs U.K. Limited. The concepts and information contained in this document are the property of Jacobs. Use or copying of this document in whole or in part without the written permission of Jacobs constitutes an infringement of copyright. Limitation: This drawing has been prepared on behalf of, and for the exclusive use of Jacobs' Client, and is subject to, and issued in accordance with, the provisions of the contract between Jacobs and the Client. Jacobs accepts no liability or responsibility whatsoever for or in respect of any use of, or reliance upon, this drawing by any third party.

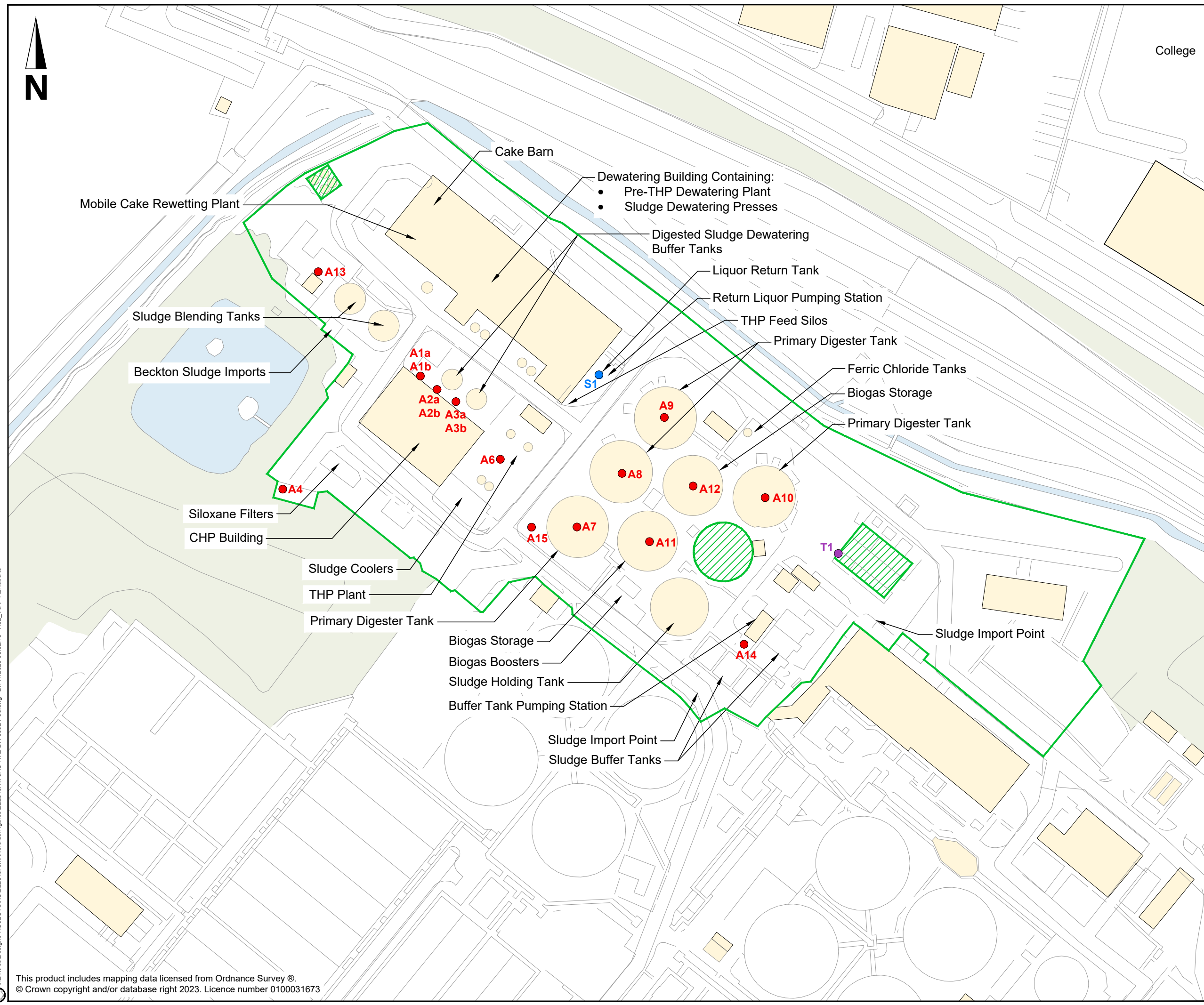

I:\enviros\Design\PROJECTS\KUIB22849AM\Riverside\Figures\B22849AM-JAC-RVE-DR-0002-P06.dwg - 27/11/2023 08:52:15 - A3L_Vert - ALRoberts