

# Historical Mapping Legends

## Ordnance Survey County Series 1:10,560

	Gravel Pit		Sand Pit		Other Pits
	Quarry		Shingle		Orchard
	Osiers		Reeds		Marsh
	Mixed Wood		Deciduous		Brushwood
	Fir		Furze		Rough Pasture
	Arrow denotes flow of water		Trigonometrical Station		
	Site of Antiquities		Bench Mark		
	Pump, Guide Post, Signal Post		Well, Spring, Boundary Post		
	<b>-285</b> Surface Level				
	Sketched Contour		Instrumental Contour		
	Main Roads		Minor Roads		
	Sunken Road		Raised Road		
	Road over Railway		Railway over River		
	Railway over Road		Level Crossing		
	Road over River or Canal		Road over Stream		
	Road over Stream				
	County Boundary (Geographical)				
	County & Civil Parish Boundary				
	Administrative County & Civil Parish Boundary				
	County Borough Boundary (England)				
	County Burgh Boundary (Scotland)				
	Rural District Boundary				
	Civil Parish Boundary				

## Ordnance Survey Plan 1:10,000

	Chalk Pit, Clay Pit or Quarry		Gravel Pit
	Sand Pit		Disused Pit or Quarry
	Refuse or Slag Heap		Lake, Loch or Pond
	Dunes		Boulders
	Coniferous Trees		Non-Coniferous Trees
	Orchard		Scrub
	Coppice		
	Bracken		Heath
	Rough Grassland		
	Marsh		Reeds
	Saltings		
	Building		Glasshouse
	Sloping Masonry		Pylon
	Electricity Transmission Line		Pole
	Cutting		Embankment
	Standard Gauge Multiple Track		
	Standard Gauge Single Track		
	Siding, Tramway or Mineral Line		
	Narrow Gauge		
	Geographical County		
	Administrative County, County Borough or County of City		
	Municipal Borough, Urban or Rural District, Burgh or District Council		
	Borough, Burgh or County Constituency Shown only when not coincident with other boundaries		
	Civil Parish Shown alternately when coincidence of boundaries occurs		
	BP, BS Boundary Post or Stone		Pol Sta Police Station
	Ch Church		PO Post Office
	CH Club House		PC Public Convenience
	F E Sta Fire Engine Station		PH Public House
	FB Foot Bridge		SB Signal Box
	Fn Fountain		Spr Spring
	GP Guide Post		TCB Telephone Call Box
	MP Mile Post		TCP Telephone Call Post
	MS Mile Stone		W Well

## 1:10,000 Raster Mapping

	Gravel Pit		Refuse tip or slag heap
	Rock		Rock (scattered)
	Boulders		Boulders (scattered)
	Shingle		Mud
	Sand		Sand Pit
	Slopes		Top of cliff
	General detail		Underground detail
	Overhead detail		Narrow gauge railway
	Multi-track railway		Single track railway
	County boundary (England only)		Civil, parish or community boundary
	District, Unitary, Metropolitan, London Borough boundary		Constituency boundary
	Area of wooded vegetation		Non-coniferous trees
	Non-coniferous trees (scattered)		Coniferous trees
	Coniferous trees (scattered)		Positioned tree
	Orchard		Coppice or Osiers
	Rough Grassland		Heath
	Scrub		Marsh, Salt Marsh or Reeds
	Water feature		Flow arrows
	MHW(S) Mean high water (springs)		MLW(S) Mean low water (springs)
	Telephone line (where shown)		Electricity transmission line (with poles)
	Bench mark (where shown)		Triangulation station
	Point feature (e.g. Guide Post or Mile Stone)		Pylon, flare stack or lighting tower
	Site of (antiquity)		Glasshouse
	General Building		Important Building

# Envirocheck®

LANDMARK INFORMATION GROUP®

## Historical Mapping & Photography included:

Mapping Type	Scale	Date	Pg
Surrey	1:10,560	1874	2
Sussex	1:10,560	1879 - 1880	3
Sussex	1:10,560	1898 - 1899	4
Surrey	1:10,560	1898	5
Sussex	1:10,560	1913 - 1914	6
Surrey	1:10,560	1919	7
Surrey	1:10,560	1920	8
Sussex	1:10,560	1932	9
Sussex	1:10,560	1938	10
Ordnance Survey Plan	1:10,000	1961 - 1962	11
Ordnance Survey Plan	1:10,000	1966	12
Ordnance Survey Plan	1:10,000	1980 - 1982	13
Ordnance Survey Plan	1:10,000	1991 - 1993	14
10K Raster Mapping	1:10,000	1999 - 2000	15
10K Raster Mapping	1:10,000	2006	16
VectorMap Local	1:10,000	2019	17

## Historical Map - Slice A

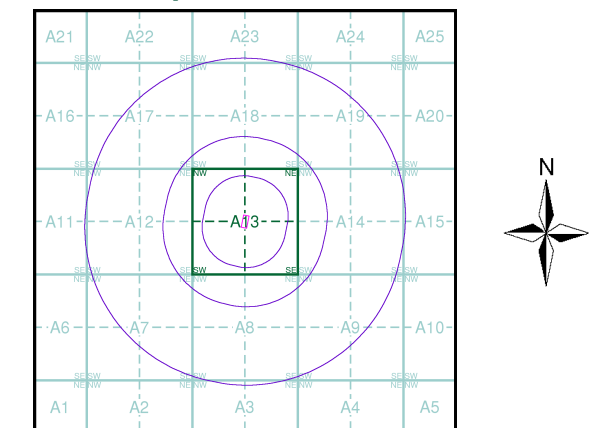

## Order Details

Order Number: 19554212\_1\_1  
 Customer Ref: Biffa Brookhurst Wood  
 National Grid Reference: 517050, 134630  
 Slice: A  
 Site Area (Ha): 0.28  
 Search Buffer (m): 1000

## Site Details

Site at 517110, 134660

**Landmark**  
 INFORMATION GROUP

Tel: 0844 844 9952  
 Fax: 0844 844 9951  
 Web: www.envirocheck.co.uk

## Surrey

Published 1874

Source map scale - 1:10,560

The historical maps shown were reproduced from maps predominantly held at the scale adopted for England, Wales and Scotland in the 1840's. In 1854 the 1:2,500 scale was adopted for mapping urban areas; these maps were used to update the 1:10,560 maps. The published date given therefore is often some years later than the surveyed date. Before 1938, all OS maps were based on the Cassini Projection, with independent surveys of a single county or group of counties, giving rise to significant inaccuracies in outlying areas. In the late 1940's, a Provisional Edition was produced, which updated the 1:10,560 mapping from a number of sources. The maps appear unfinished - with all military camps and other strategic sites removed. These maps were initially overprinted with the National Grid. In 1970, the first 1:10,000 maps were produced using the Transverse Mercator Projection. The revision process continued until recently, with new editions appearing every 10 years or so for urban areas.

### Map Name(s) and Date(s)

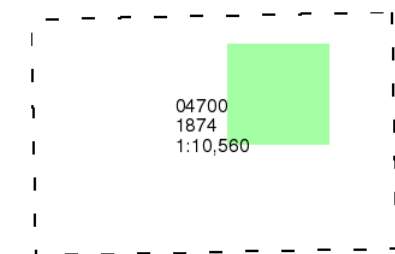

### Historical Map - Slice A

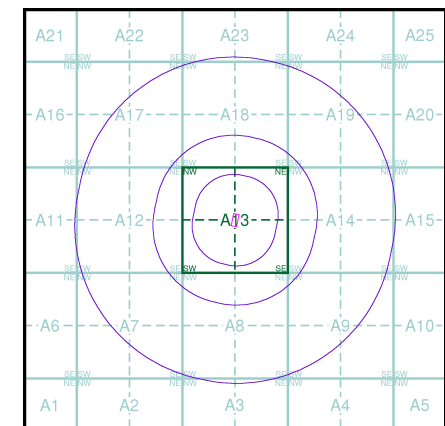

### Order Details

Order Number: 195554212\_1\_1  
Customer Ref: Biffa Brookhurst Wood  
National Grid Reference: 517050, 134630  
Slice: A  
Site Area (Ha): 0.28  
Search Buffer (m): 1000

### Site Details

Site at 517110, 134660

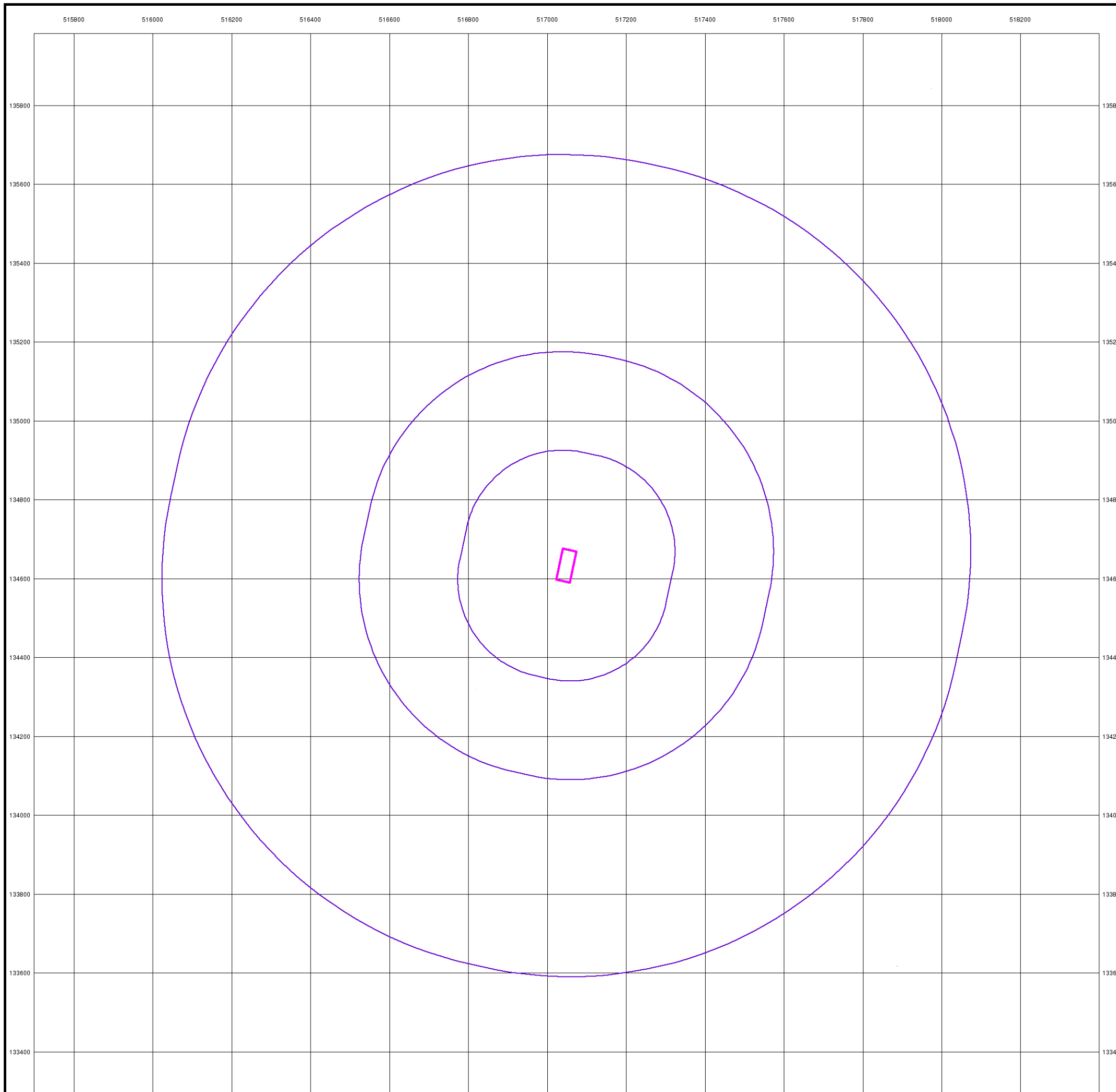



Sussex

Published 1879 - 1880

Source map scale - 1:10,560

The historical maps shown were reproduced from maps predominantly held at the scale adopted for England, Wales and Scotland in the 1840's. In 1854 the 1:2,500 scale was adopted for mapping urban areas; these maps were used to update the 1:10,560 maps. The published date given therefore is often some years later than the surveyed date. Before 1938, all OS maps were based on the Cassini Projection, with independent surveys of a single county or group of counties, giving rise to significant inaccuracies in outlying areas. In the late 1940's, a Provisional Edition was produced, which updated the 1:10,560 mapping from a number of sources. The maps appear unfinished - with all military camps and other strategic sites removed. These maps were initially overprinted with the National Grid. In 1970, the first 1:10,000 maps were produced using the Transverse Mercator Projection. The revision process continued until recently, with new editions appearing every 10 years or so for urban areas.

### Map Name(s) and Date(s)

00200	1879	1:10,560
01300	1880	1:10,560

### Historical Map - Slice A

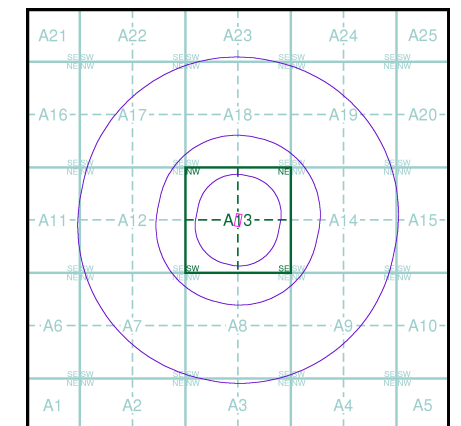

### Order Details

Order Number: 195554212\_1\_1  
 Customer Ref: Biffa Brookhurst Wood  
 National Grid Reference: 517050, 134630  
 Slice: A  
 Site Area (Ha): 0.28  
 Search Buffer (m): 1000

### Site Details

Site at 517110, 134660

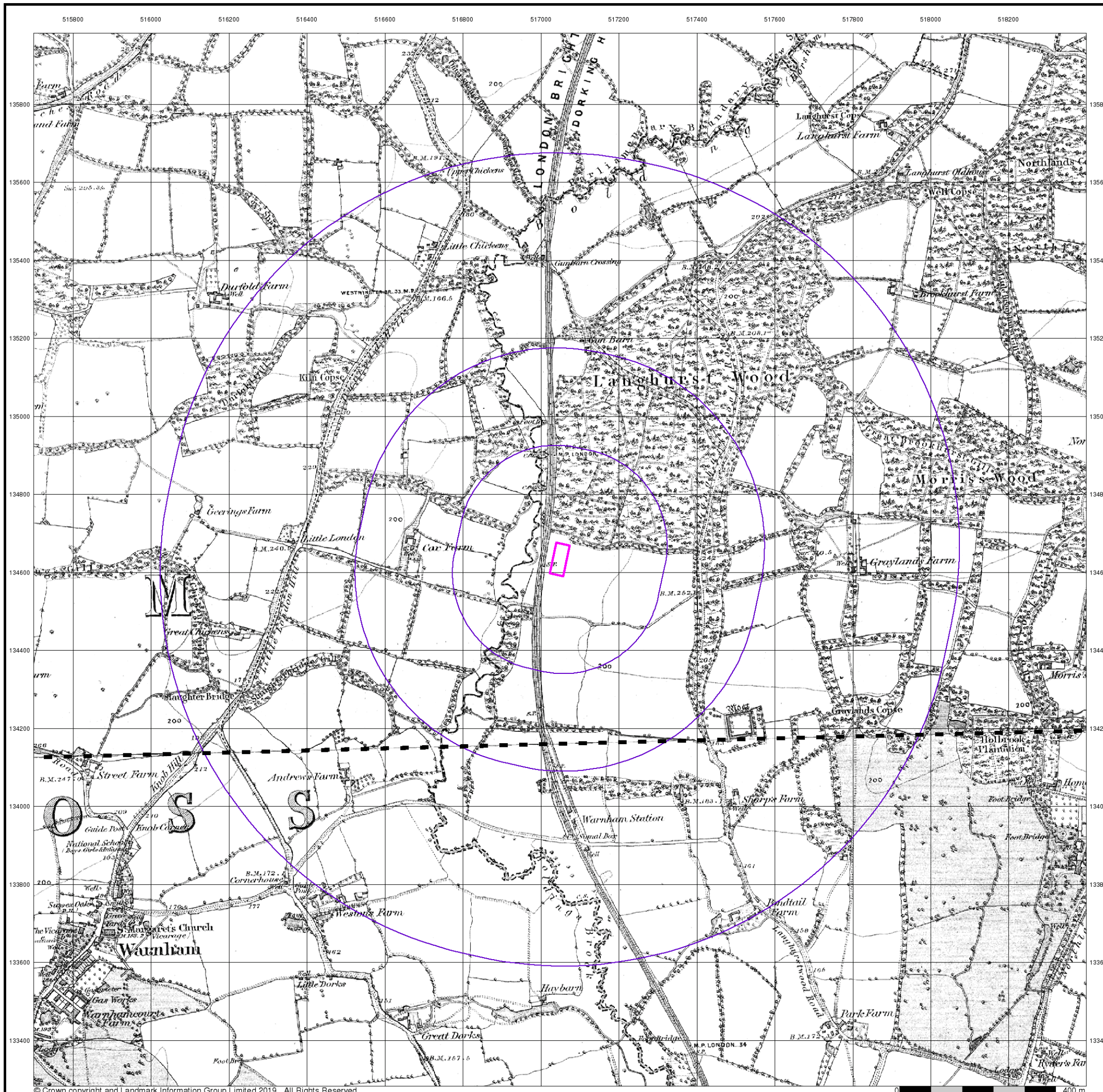



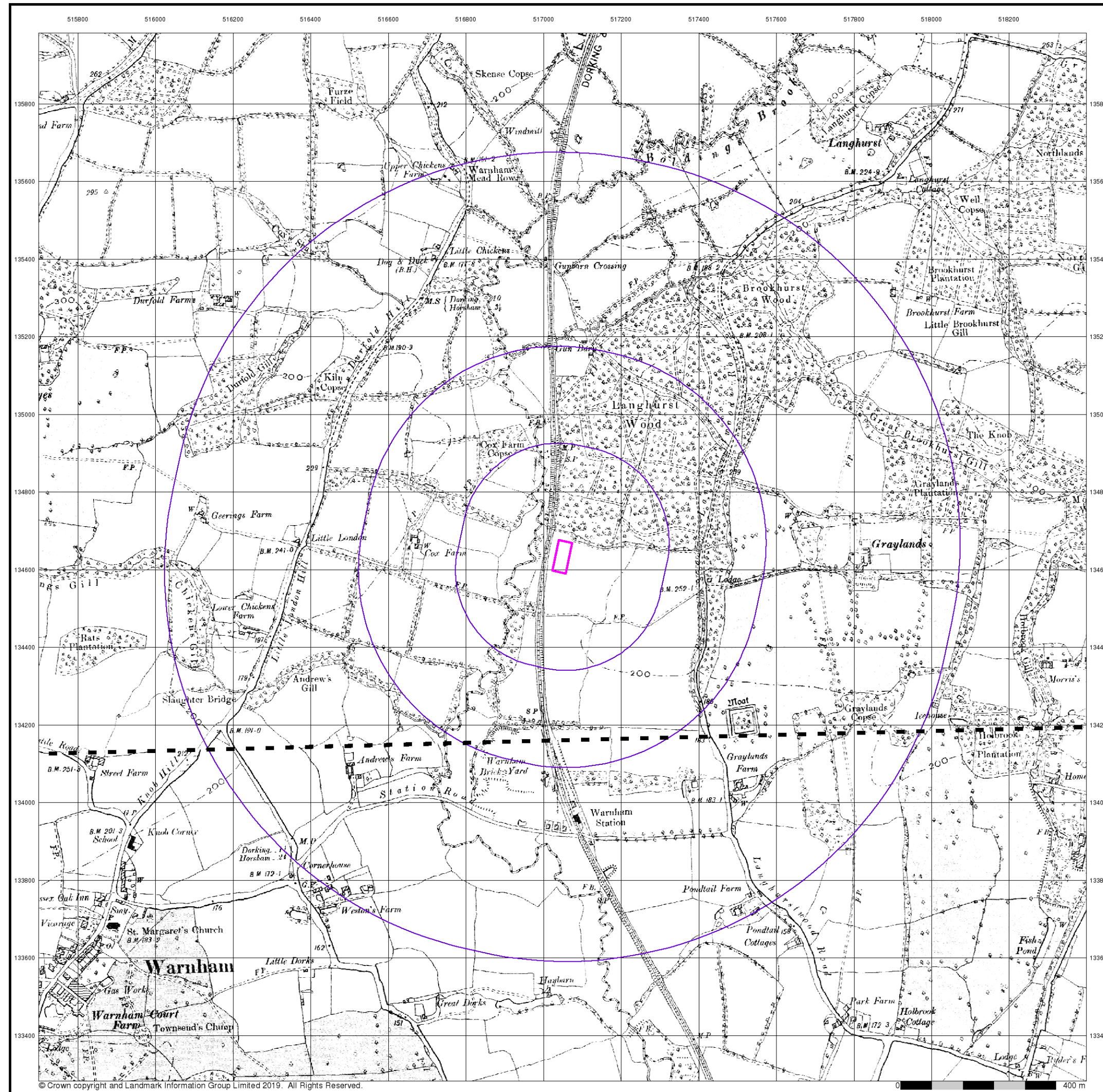

# Envirocheck®

LANDMARK INFORMATION GROUP®

Sussex

Published 1898 - 1899

Source map scale - 1:10,560

The historical maps shown were reproduced from maps predominantly held at the scale adopted for England, Wales and Scotland in the 1840's. In 1854 the 1:2,500 scale was adopted for mapping urban areas; these maps were used to update the 1:10,560 maps. The published date given therefore is often some years later than the surveyed date. Before 1938, all OS maps were based on the Cassini Projection, with independent surveys of a single county or group of counties, giving rise to significant inaccuracies in outlying areas. In the late 1940's, a Provisional Edition was produced, which updated the 1:10,560 mapping from a number of sources. The maps appear unfinished - with all military camps and other strategic sites removed. These maps were initially overprinted with the National Grid. In 1970, the first 1:10,000 maps were produced using the Transverse Mercator Projection. The revision process continued until recently, with new editions appearing every 10 years or so for urban areas.

## Map Name(s) and Date(s)

002SE	1899	1:10,560
013NE	1898	1:10,560

## Historical Map - Slice A

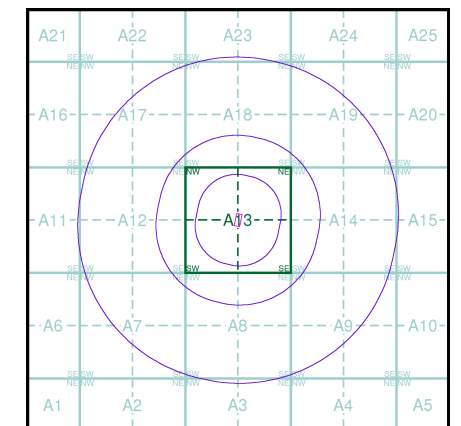

## Order Details

Order Number: 195554212\_1\_1  
 Customer Ref: Biffa Brookhurst Wood  
 National Grid Reference: 517050, 134630  
 Slice: A  
 Site Area (Ha): 0.28  
 Search Buffer (m): 1000

## Site Details

Site at 517110, 134660

**Landmark**  
 INFORMATION GROUP

Tel: 0844 844 9952  
 Fax: 0844 844 9951  
 Web: www.envirocheck.co.uk



## Surrey

Published 1898

Source map scale - 1:10,560

The historical maps shown were reproduced from maps predominantly held at the scale adopted for England, Wales and Scotland in the 1840's. In 1854 the 1:2,500 scale was adopted for mapping urban areas; these maps were used to update the 1:10,560 maps. The published date given therefore is often some years later than the surveyed date. Before 1938, all OS maps were based on the Cassini Projection, with independent surveys of a single county or group of counties, giving rise to significant inaccuracies in outlying areas. In the late 1940's, a Provisional Edition was produced, which updated the 1:10,560 mapping from a number of sources. The maps appear unfinished - with all military camps and other strategic sites removed. These maps were initially overprinted with the National Grid. In 1970, the first 1:10,000 maps were produced using the Transverse Mercator Projection. The revision process continued until recently, with new editions appearing every 10 years or so for urban areas.

### Map Name(s) and Date(s)

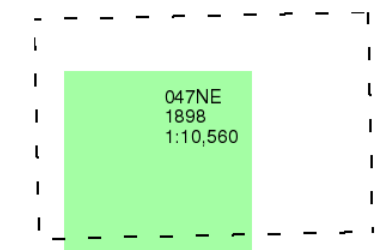

### Historical Map - Slice A

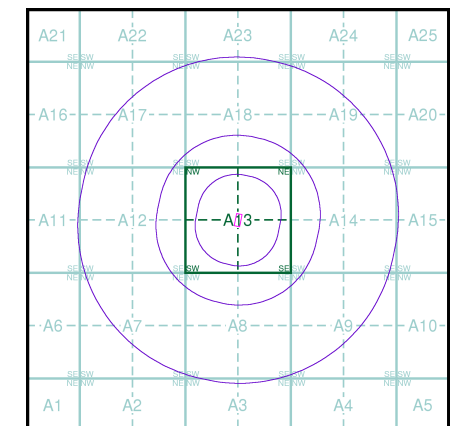

### Order Details

Order Number: 195554212\_1\_1  
Customer Ref: Biffa Brookhurst Wood  
National Grid Reference: 517050, 134630  
Slice: A  
Site Area (Ha): 0.28  
Search Buffer (m): 1000

### Site Details

Site at 517110, 134660

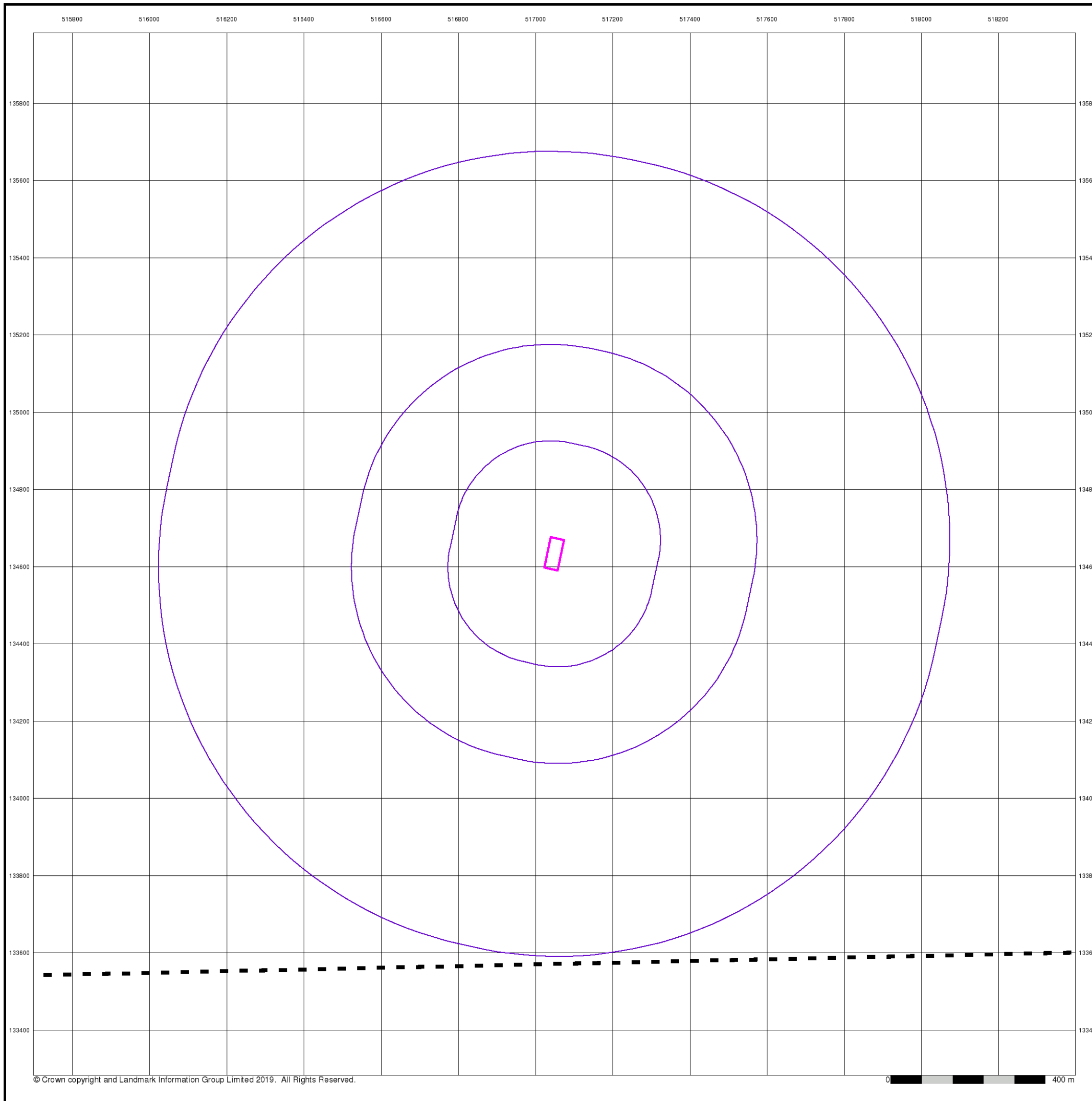



The historical maps shown were reproduced from maps predominantly held at the scale adopted for England, Wales and Scotland in the 1840's. In 1854 the 1:2,500 scale was adopted for mapping urban areas; these maps were used to update the 1:10,560 maps. The published date given therefore is often some years later than the surveyed date. Before 1938, all OS maps were based on the Cassini Projection, with independent surveys of a single county or group of counties, giving rise to significant inaccuracies in outlying areas. In the late 1940's, a Provisional Edition was produced, which updated the 1:10,560 mapping from a number of sources. The maps appear unfinished - with all military camps and other strategic sites removed. These maps were initially overprinted with the National Grid. In 1970, the first 1:10,000 maps were produced using the Transverse Mercator Projection. The revision process continued until recently, with new editions appearing every 10 years or so for urban areas.

### Map Name(s) and Date(s)

002SE	1914	1:10,560
013NE	1913	1:10,560

### Historical Map - Slice A

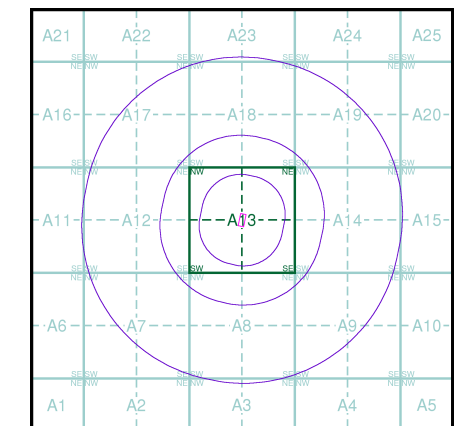

### Order Details

Order Number: 19554212\_1\_1  
 Customer Ref: Biffa Brookhurst Wood  
 National Grid Reference: 517050, 134630  
 Slice: A  
 Site Area (Ha): 0.28  
 Search Buffer (m): 1000

### Site Details

Site at 517110, 134660

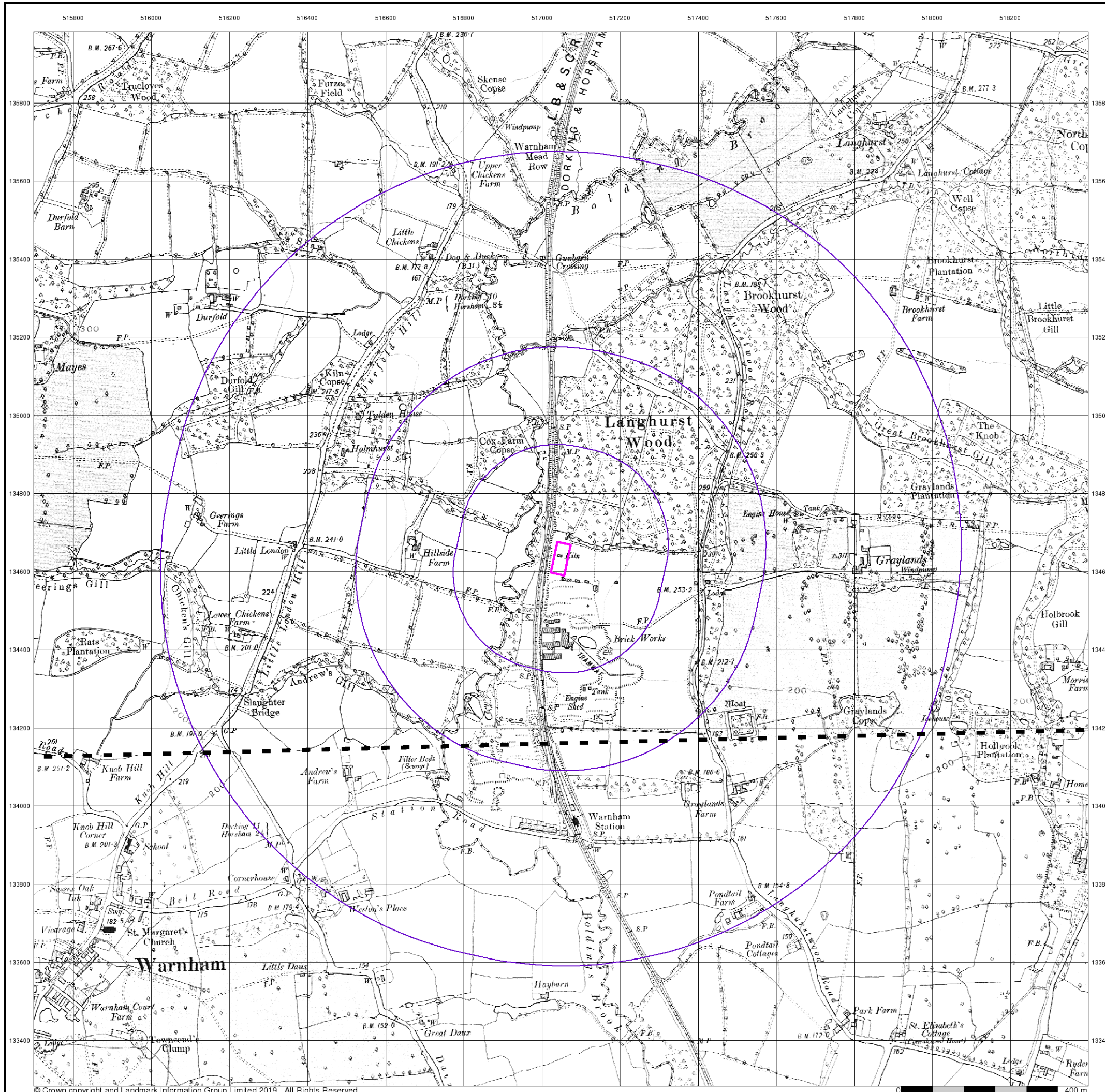



## Surrey

Published 1919

Source map scale - 1:10,560

The historical maps shown were reproduced from maps predominantly held at the scale adopted for England, Wales and Scotland in the 1840's. In 1854 the 1:2,500 scale was adopted for mapping urban areas; these maps were used to update the 1:10,560 maps. The published date given therefore is often some years later than the surveyed date. Before 1938, all OS maps were based on the Cassini Projection, with independent surveys of a single county or group of counties, giving rise to significant inaccuracies in outlying areas. In the late 1940's, a Provisional Edition was produced, which updated the 1:10,560 mapping from a number of sources. The maps appear unfinished - with all military camps and other strategic sites removed. These maps were initially overprinted with the National Grid. In 1970, the first 1:10,000 maps were produced using the Transverse Mercator Projection. The revision process continued until recently, with new editions appearing every 10 years or so for urban areas.

### Map Name(s) and Date(s)

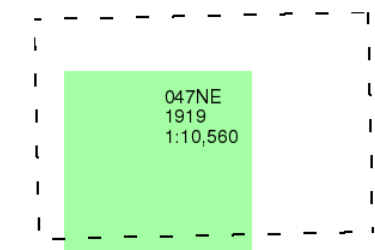

### Historical Map - Slice A

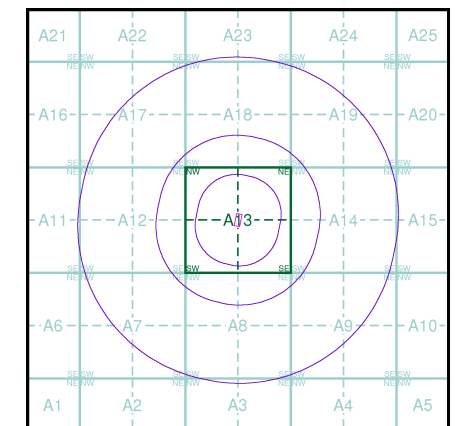

### Order Details

Order Number: 195554212\_1\_1  
Customer Ref: Biffa Brookhurst Wood  
National Grid Reference: 517050, 134630  
Slice: A  
Site Area (Ha): 0.28  
Search Buffer (m): 1000

### Site Details

Site at 517110, 134660

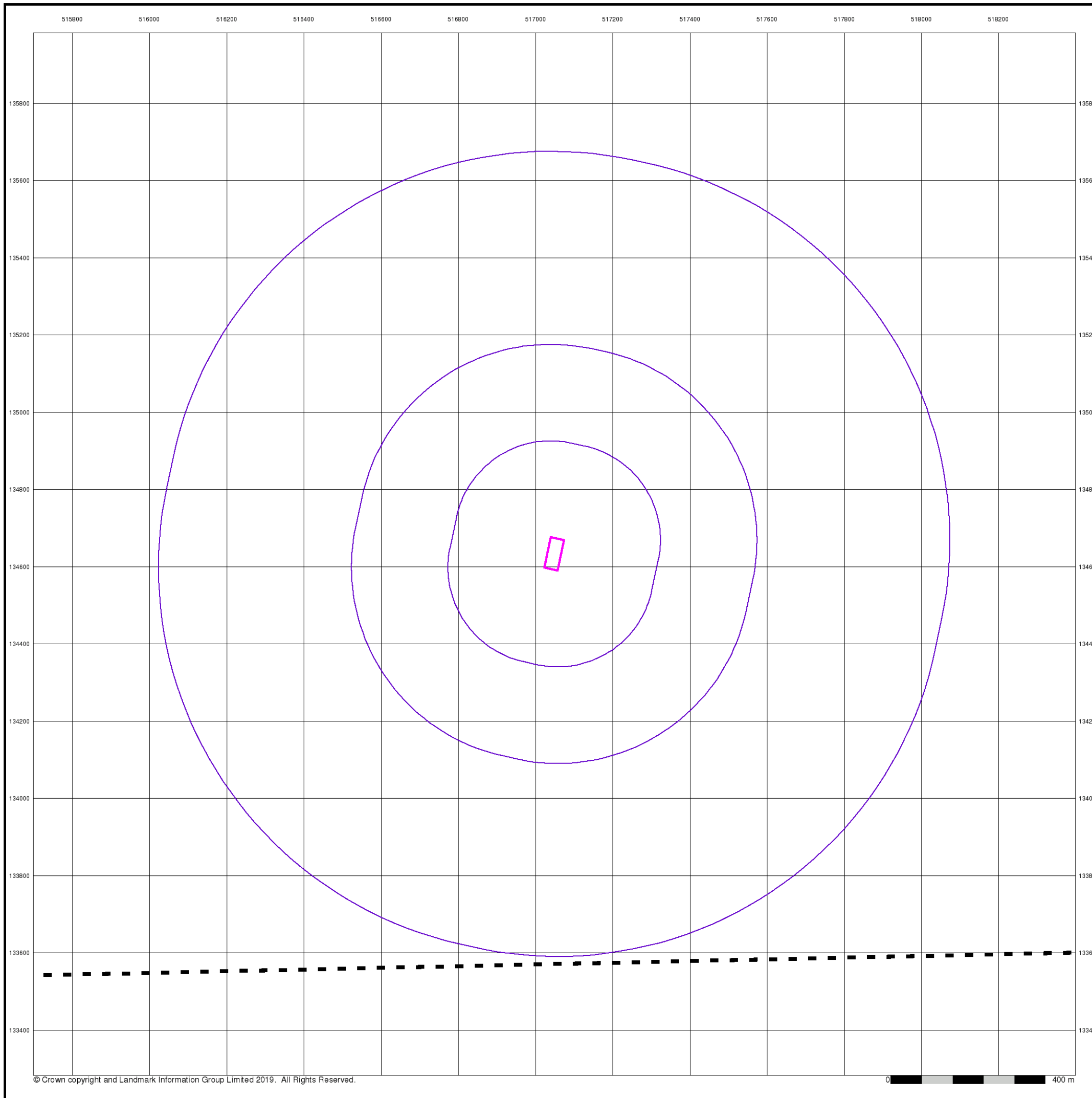



## Surrey

Published 1920

Source map scale - 1:10,560

The historical maps shown were reproduced from maps predominantly held at the scale adopted for England, Wales and Scotland in the 1840's. In 1854 the 1:2,500 scale was adopted for mapping urban areas; these maps were used to update the 1:10,560 maps. The published date given therefore is often some years later than the surveyed date. Before 1938, all OS maps were based on the Cassini Projection, with independent surveys of a single county or group of counties, giving rise to significant inaccuracies in outlying areas. In the late 1940's, a Provisional Edition was produced, which updated the 1:10,560 mapping from a number of sources. The maps appear unfinished - with all military camps and other strategic sites removed. These maps were initially overprinted with the National Grid. In 1970, the first 1:10,000 maps were produced using the Transverse Mercator Projection. The revision process continued until recently, with new editions appearing every 10 years or so for urban areas.

### Map Name(s) and Date(s)

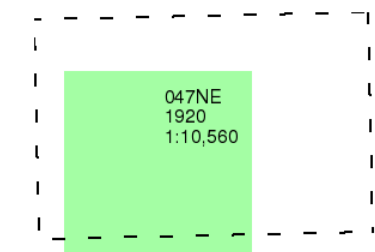

### Historical Map - Slice A

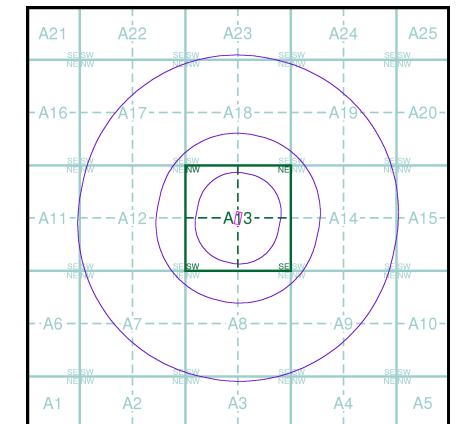

### Order Details

Order Number: 195554212\_1\_1  
Customer Ref: Biffa Brookhurst Wood  
National Grid Reference: 517050, 134630  
Slice: A  
Site Area (Ha): 0.28  
Search Buffer (m): 1000

### Site Details

Site at 517110, 134660

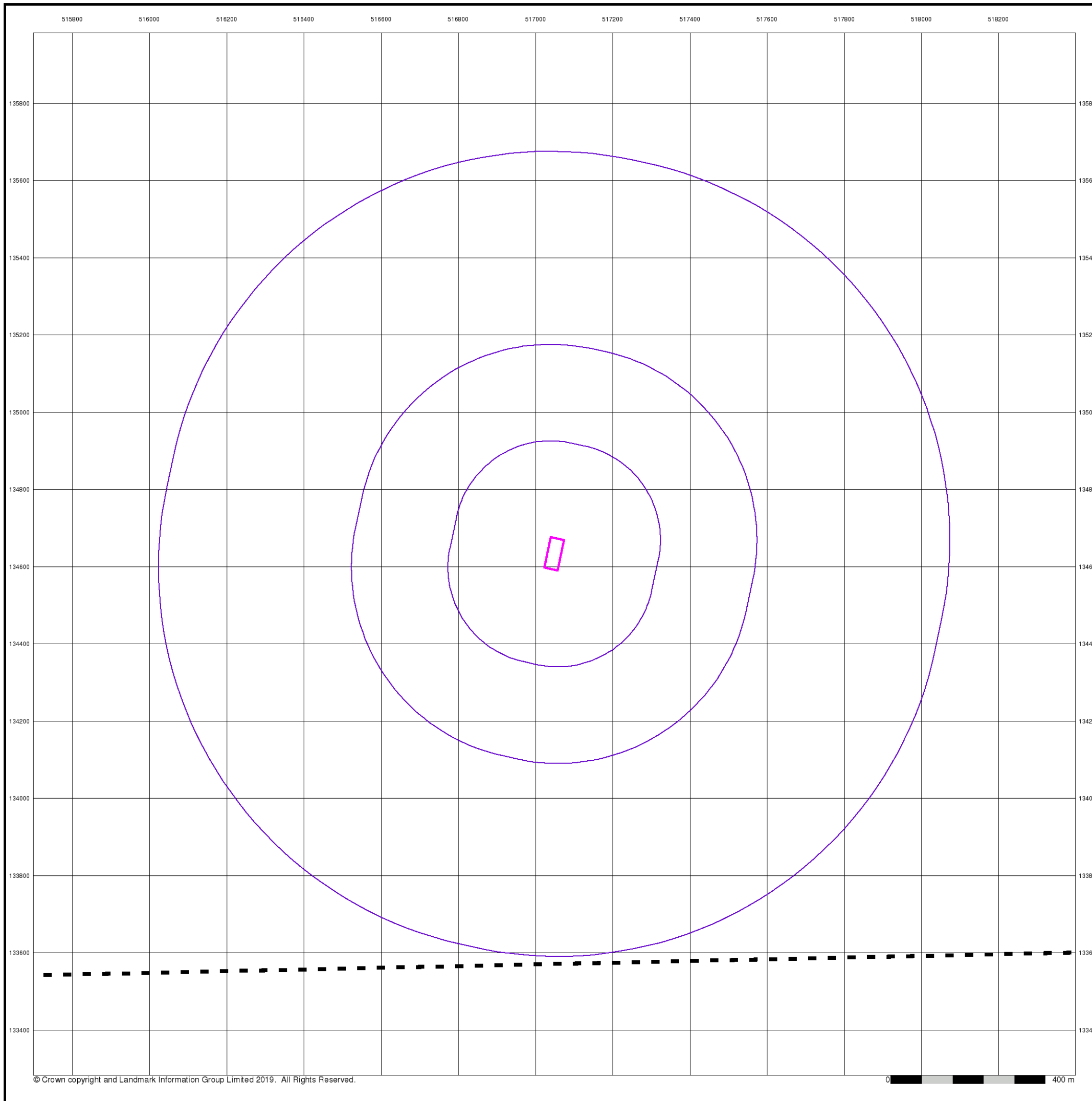



515800 516000 516200 516400 516600 516800 517000 517200 517400 517600 517800 518000 518200

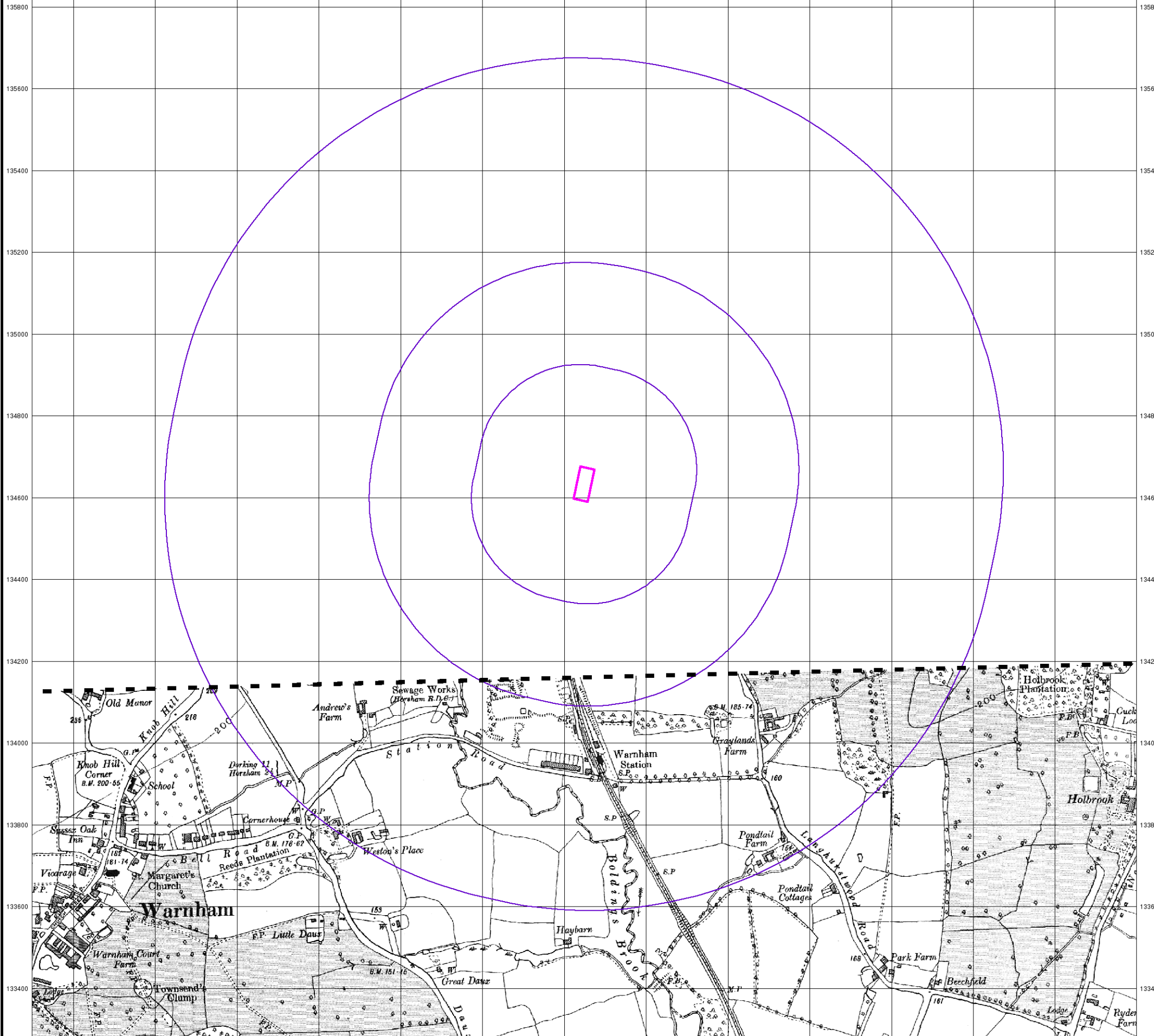

© Crown copyright and Landmark Information Group Limited 2019. All Rights Reserved.

# Envirocheck®

LANDMARK INFORMATION GROUP®

Sussex

Published 1932

Source map scale - 1:10,560

The historical maps shown were reproduced from maps predominantly held at the scale adopted for England, Wales and Scotland in the 1840's. In 1854 the 1:2,500 scale was adopted for mapping urban areas; these maps were used to update the 1:10,560 maps. The published date given therefore is often some years later than the surveyed date. Before 1938, all OS maps were based on the Cassini Projection, with independent surveys of a single county or group of counties, giving rise to significant inaccuracies in outlying areas. In the late 1940's, a Provisional Edition was produced, which updated the 1:10,560 mapping from a number of sources. The maps appear unfinished - with all military camps and other strategic sites removed. These maps were initially overprinted with the National Grid. In 1970, the first 1:10,000 maps were produced using the Transverse Mercator Projection. The revision process continued until recently, with new editions appearing every 10 years or so for urban areas.

## Map Name(s) and Date(s)

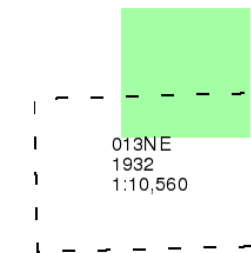

## Historical Map - Slice A

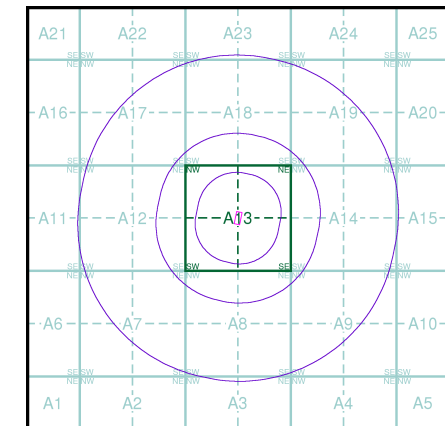

## Order Details

Order Number: 195554212\_1\_1  
 Customer Ref: Biffa Brookhurst Wood  
 National Grid Reference: 517050, 134630  
 Slice: A  
 Site Area (Ha): 0.28  
 Search Buffer (m): 1000

## Site Details

Site at 517110, 134660

**Landmark**  
 INFORMATION GROUP

Tel: 0844 844 9952  
 Fax: 0844 844 9951  
 Web: www.envirocheck.co.uk







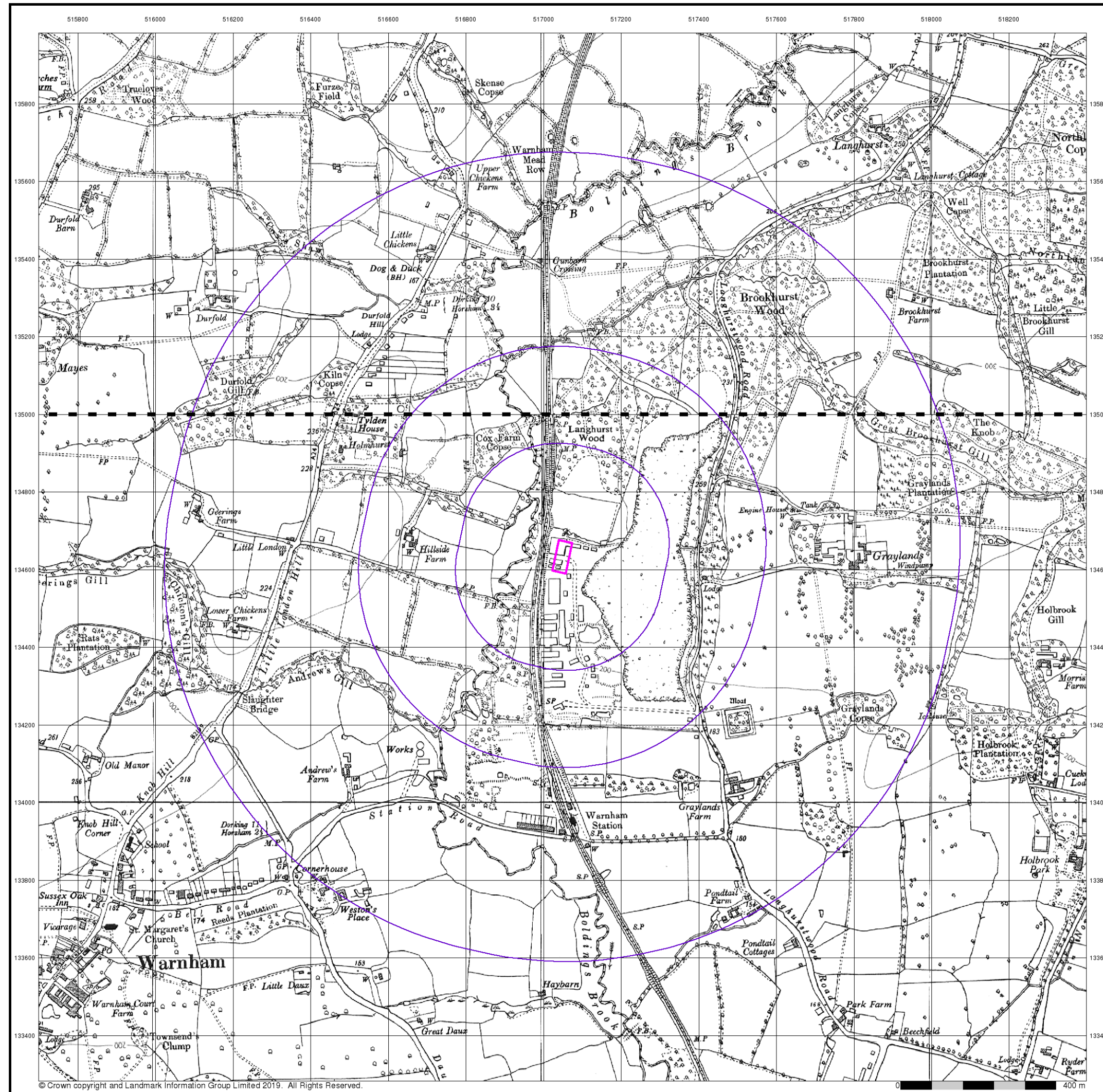

# Envirocheck®

LANDMARK INFORMATION GROUP®

**Ordnance Survey Plan**  
**Published 1961 - 1962**  
**Source map scale - 1:10,000**

The historical maps shown were reproduced from maps predominantly held at the scale adopted for England, Wales and Scotland in the 1840's. In 1854 the 1:2,500 scale was adopted for mapping urban areas; these maps were used to update the 1:10,560 maps. The published date given therefore is often some years later than the surveyed date. Before 1938, all OS maps were based on the Cassini Projection, with independent surveys of a single county or group of counties, giving rise to significant inaccuracies in outlying areas. In the late 1940's, a Provisional Edition was produced, which updated the 1:10,560 mapping from a number of sources. The maps appear unfinished - with all military camps and other strategic sites removed. These maps were initially overprinted with the National Grid. In 1970, the first 1:10,000 maps were produced using the Transverse Mercator Projection. The revision process continued until recently, with new editions appearing every 10 years or so for urban areas.

### Map Name(s) and Date(s)

TQ13NE	1962	1:10,560
TQ13SE	1961	1:10,560

### Historical Map - Slice A

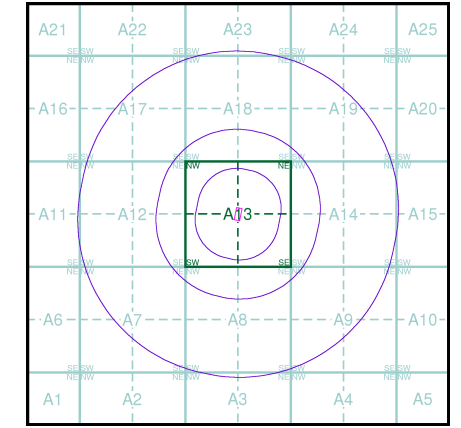

### Order Details

Order Number: 19554212\_1\_1  
 Customer Ref: Biffa Brookhurst Wood  
 National Grid Reference: 517050, 134630  
 Slice: A  
 Site Area (Ha): 0.28  
 Search Buffer (m): 1000

### Site Details

Site at 517110, 134660

**Landmark®**  
 INFORMATION GROUP

Tel: 0844 844 9952  
 Fax: 0844 844 9951  
 Web: www.envirocheck.co.uk



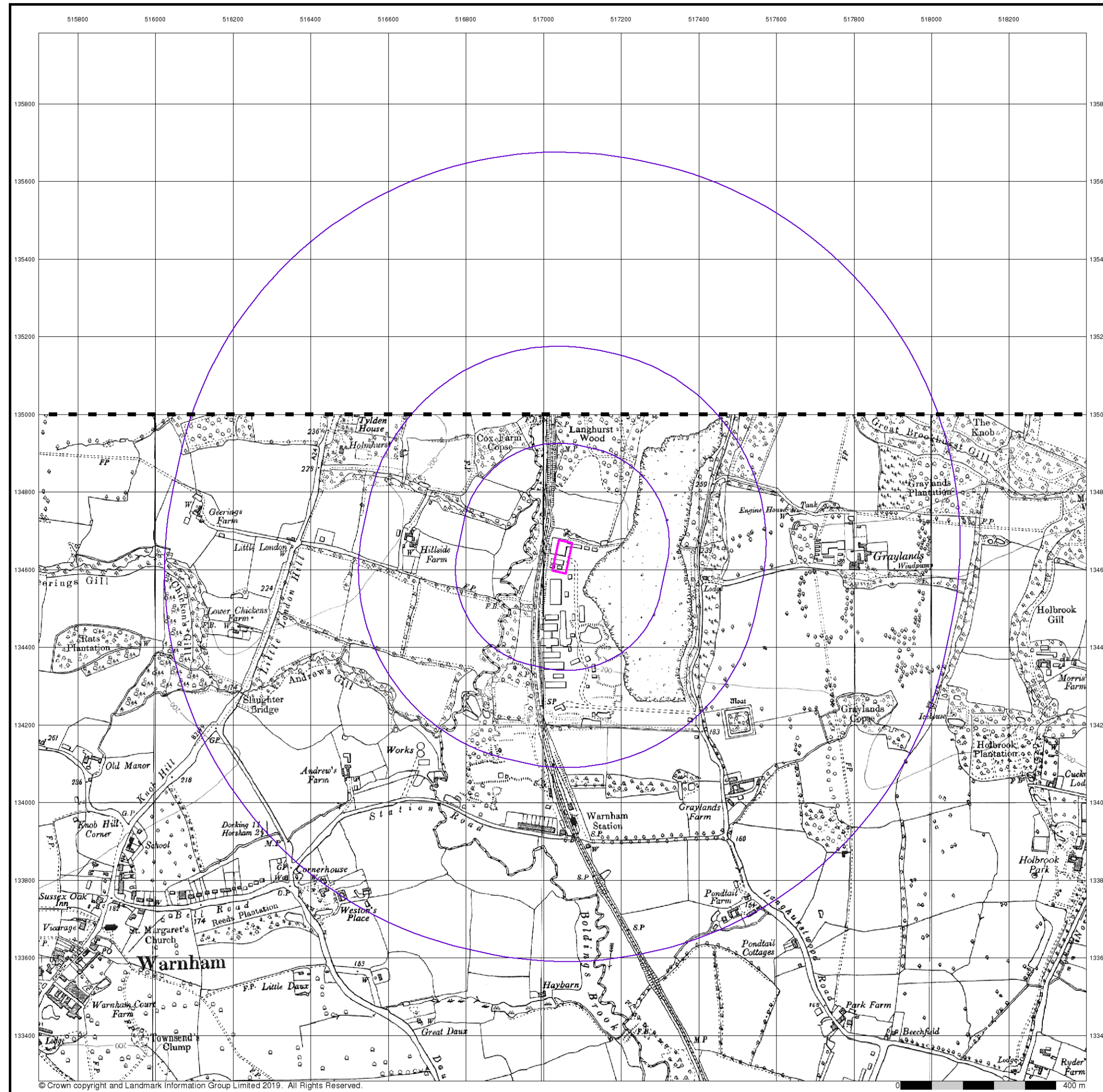

## Ordnance Survey Plan

Published 1966

Source map scale - 1:10,000

The historical maps shown were reproduced from maps predominantly held at the scale adopted for England, Wales and Scotland in the 1840's. In 1854 the 1:2,500 scale was adopted for mapping urban areas; these maps were used to update the 1:10,560 maps. The published date given therefore is often some years later than the surveyed date. Before 1938, all OS maps were based on the Cassini Projection, with independent surveys of a single county or group of counties, giving rise to significant inaccuracies in outlying areas. In the late 1940's, a Provisional Edition was produced, which updated the 1:10,560 mapping from a number of sources. The maps appear unfinished - with all military camps and other strategic sites removed. These maps were initially overprinted with the National Grid. In 1970, the first 1:10,000 maps were produced using the Transverse Mercator Projection. The revision process continued until recently, with new editions appearing every 10 years or so for urban areas.

### Map Name(s) and Date(s)

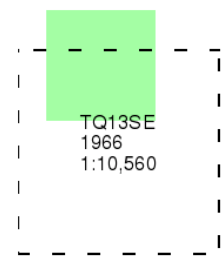

### Historical Map - Slice A

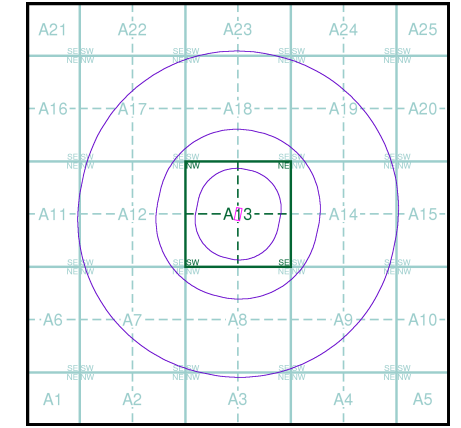

### Order Details

Order Number: 195554212\_1\_1  
 Customer Ref: Biffa Brookhurst Wood  
 National Grid Reference: 517050, 134630  
 Slice: A  
 Site Area (Ha): 0.28  
 Search Buffer (m): 1000

### Site Details

Site at 517110, 134660



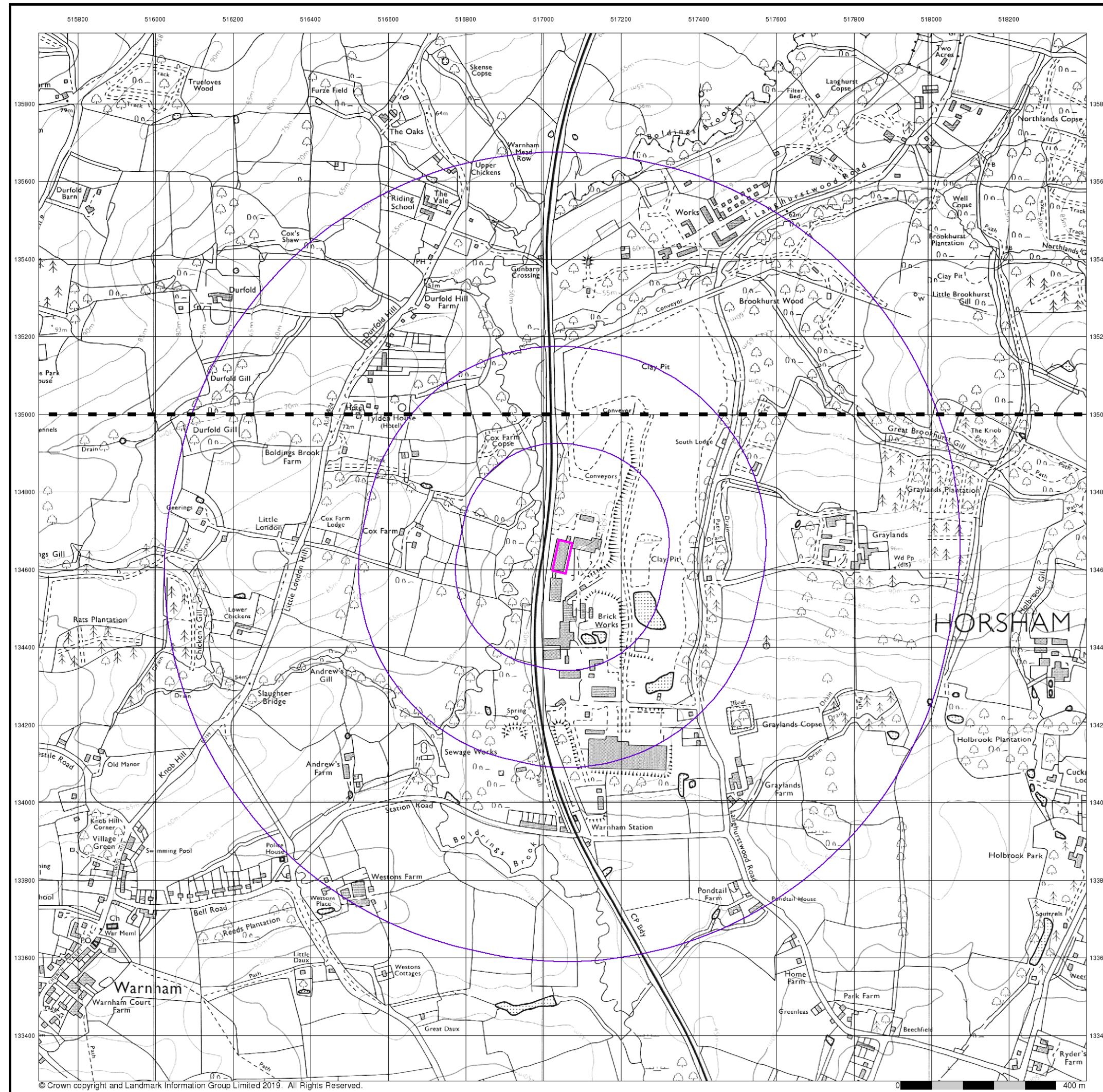

## Ordnance Survey Plan

Published 1980 - 1982

Source map scale - 1:10,000

The historical maps shown were reproduced from maps predominantly held at the scale adopted for England, Wales and Scotland in the 1840's. In 1854 the 1:2,500 scale was adopted for mapping urban areas; these maps were used to update the 1:10,560 maps. The published date given therefore is often some years later than the surveyed date. Before 1938, all OS maps were based on the Cassini Projection, with independent surveys of a single county or group of counties, giving rise to significant inaccuracies in outlying areas. In the late 1940's, a Provisional Edition was produced, which updated the 1:10,560 mapping from a number of sources. The maps appear unfinished - with all military camps and other strategic sites removed. These maps were initially overprinted with the National Grid. In 1970, the first 1:10,000 maps were produced using the Transverse Mercator Projection. The revision process continued until recently, with new editions appearing every 10 years or so for urban areas.

### Map Name(s) and Date(s)

TQ13NE	1980	1:10,000
TQ13SE	1982	1:10,000

### Historical Map - Slice A

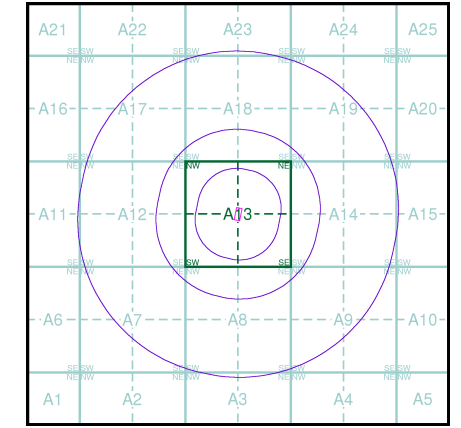

### Order Details

Order Number: 19554212\_1\_1  
 Customer Ref: Biffa Brookhurst Wood  
 National Grid Reference: 517050, 134630  
 Slice: A  
 Site Area (Ha): 0.28  
 Search Buffer (m): 1000

### Site Details

Site at 517110, 134660



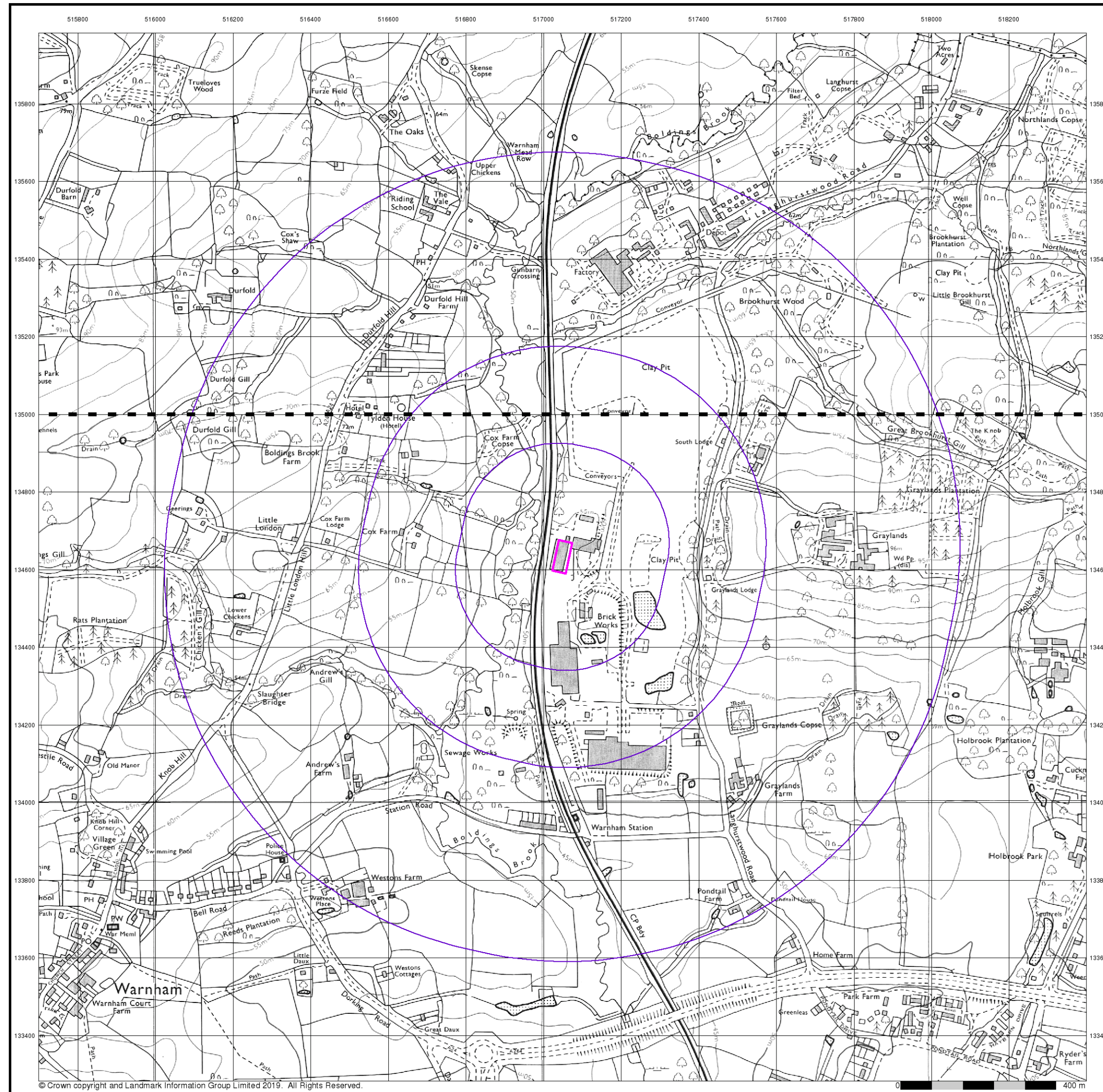

# Envirocheck®

LANDMARK INFORMATION GROUP®

**Ordnance Survey Plan**  
**Published 1991 - 1993**  
**Source map scale - 1:10,000**

The historical maps shown were reproduced from maps predominantly held at the scale adopted for England, Wales and Scotland in the 1840's. In 1854 the 1:2,500 scale was adopted for mapping urban areas; these maps were used to update the 1:10,560 maps. The published date given therefore is often some years later than the surveyed date. Before 1938, all OS maps were based on the Cassini Projection, with independent surveys of a single county or group of counties, giving rise to significant inaccuracies in outlying areas. In the late 1940's, a Provisional Edition was produced, which updated the 1:10,560 mapping from a number of sources. The maps appear unfinished - with all military camps and other strategic sites removed. These maps were initially overprinted with the National Grid. In 1970, the first 1:10,000 maps were produced using the Transverse Mercator Projection. The revision process continued until recently, with new editions appearing every 10 years or so for urban areas.

### Map Name(s) and Date(s)

TQ13NE	1991	1:10,000
TQ13SE	1993	1:10,000

### Historical Map - Slice A

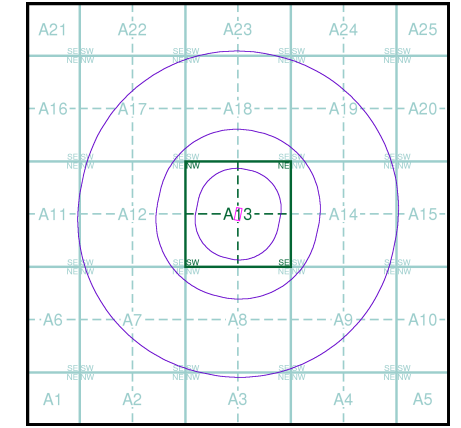

### Order Details

Order Number: 19554212\_1\_1  
 Customer Ref: Biffa Brookhurst Wood  
 National Grid Reference: 517050, 134630  
 Slice: A  
 Site Area (Ha): 0.28  
 Search Buffer (m): 1000

### Site Details

Site at 517110, 134660

**Landmark**  
 INFORMATION GROUP

Tel: 0844 844 9952  
 Fax: 0844 844 9951  
 Web: www.envirocheck.co.uk



## 10k Raster Mapping

Published 1999 - 2000

Source map scale - 1:10,000

The historical maps shown were produced from the Ordnance Survey's 1:10,000 colour raster mapping. These maps are derived from Landplan which replaced the old 1:10,000 maps originally published in 1970. The data is highly detailed showing buildings, fences and field boundaries as well as all roads, tracks and paths. Road names are also included together with the relevant road number and classification. Boundary information depiction includes county, unitary authority, district, civil parish and constituency.

### Map Name(s) and Date(s)

TQ13NE	1999	1:10,000
TQ13SE	2000	1:10,000

### Historical Map - Slice A

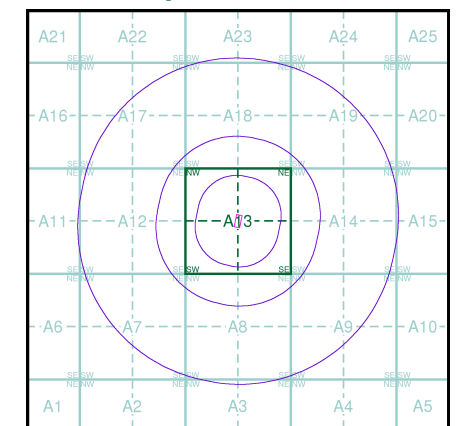

### Order Details

Order Number: 195554212\_1\_1  
 Customer Ref: Biffa Brookhurst Wood  
 National Grid Reference: 517050, 134630  
 Slice: A  
 Site Area (Ha): 0.28  
 Search Buffer (m): 1000

### Site Details

Site at 517110, 134660

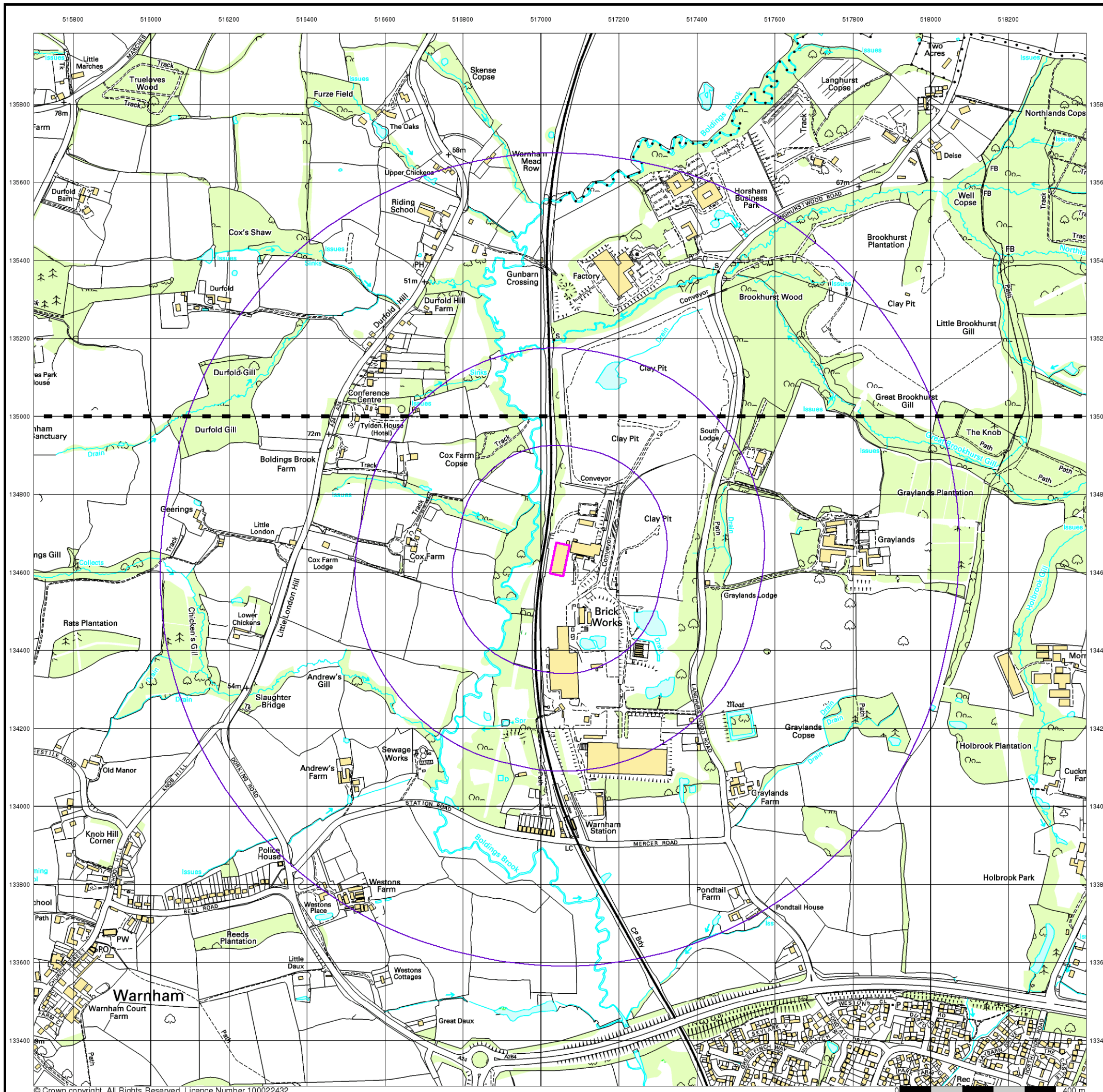



## 10k Raster Mapping

Published 2006

Source map scale - 1:10,000

The historical maps shown were produced from the Ordnance Survey's 1:10,000 colour raster mapping. These maps are derived from Landplan which replaced the old 1:10,000 maps originally published in 1970. The data is highly detailed showing buildings, fences and field boundaries as well as all roads, tracks and paths. Road names are also included together with the relevant road number and classification. Boundary information depiction includes county, unitary authority, district, civil parish and constituency.

### Map Name(s) and Date(s)

TQ13NE	2006	1:10,000
TQ13SE	2006	1:10,000

### Historical Map - Slice A

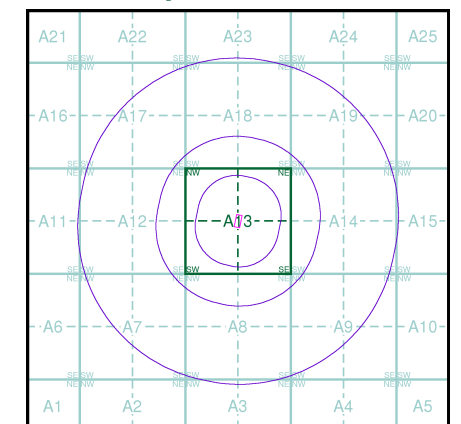

### Order Details

Order Number: 19554212\_1\_1  
 Customer Ref: Biffa Brookhurst Wood  
 National Grid Reference: 517050, 134630  
 Slice: A  
 Site Area (Ha): 0.28  
 Search Buffer (m): 1000

### Site Details

Site at 517110, 134660

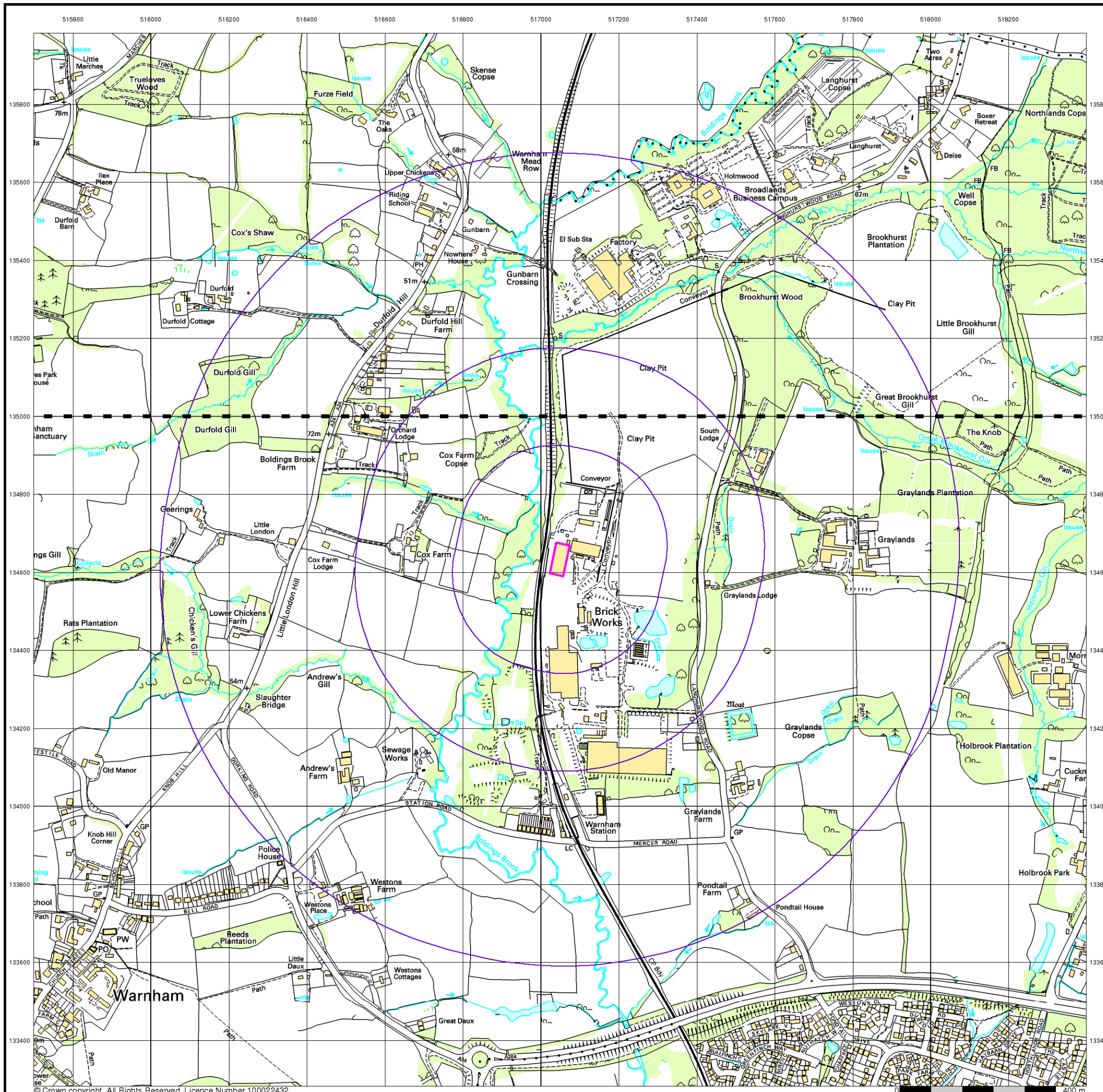

© Crown copyright. All Rights Reserved. Licence Number 100022432.



## VectorMap Local

Published 2019

Source map scale - 1:10,000

VectorMap Local (Raster) is Ordnance Survey's highest detailed 'backdrop' mapping product. These maps are produced from OS's VectorMap Local, a simple vector dataset at a nominal scale of 1:10,000, covering the whole of Great Britain, that has been designed for creating graphical mapping. OS VectorMap Local is derived from large-scale information surveyed at 1:1250 scale (covering major towns and cities), 1:2500 scale (smaller towns, villages and developed rural areas), and 1:10 000 scale (mountain, moorland and river estuary areas).

### Map Name(s) and Date(s)

TQ13NE |  
2019 |  
Variable |  
TQ13SE |  
2019 |  
Variable |

### Historical Map - Slice A

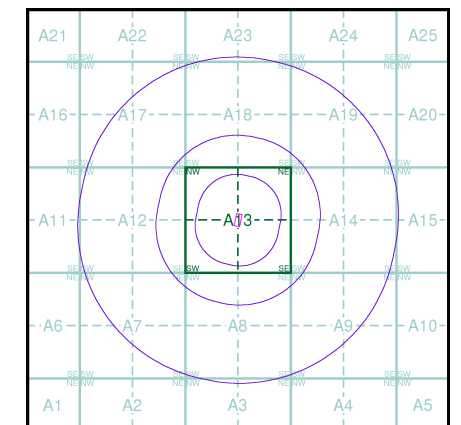

### Order Details

Order Number: 195554212\_1\_1  
 Customer Ref: Biffa Brookhurst Wood  
 National Grid Reference: 517050, 134630  
 Slice: A  
 Site Area (Ha): 0.28  
 Search Buffer (m): 1000

### Site Details

Site at 517110, 134660

