

**Legend:**

Environmental Permit Boundary

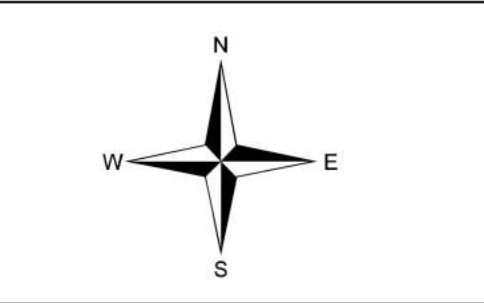

|          |          |          |          |
|----------|----------|----------|----------|
| Created: | Checked: | Date:    | Version: |
| IM       | MJ       | 08/02/21 | V1       |

Ordnance Survey © Crown Copyright 2018. All rights reserved. Licence number 100022432



**Client:**

**MICK GEORGE**

**Project:**

**Watlington Quarry Environmental Permit Application**

**Title:**

**SITE LOCATION AND ENVIRONMENTAL PERMIT BOUNDARY**

|                       |                         |                                    |
|-----------------------|-------------------------|------------------------------------|
| Office:<br>Nottingham | Project Ref:<br>A117209 | Drawing No.:<br>MGL/A117209/PER/01 |
|-----------------------|-------------------------|------------------------------------|

© Crown Copyright 2021. All Rights Reserved. Licence number 100022432

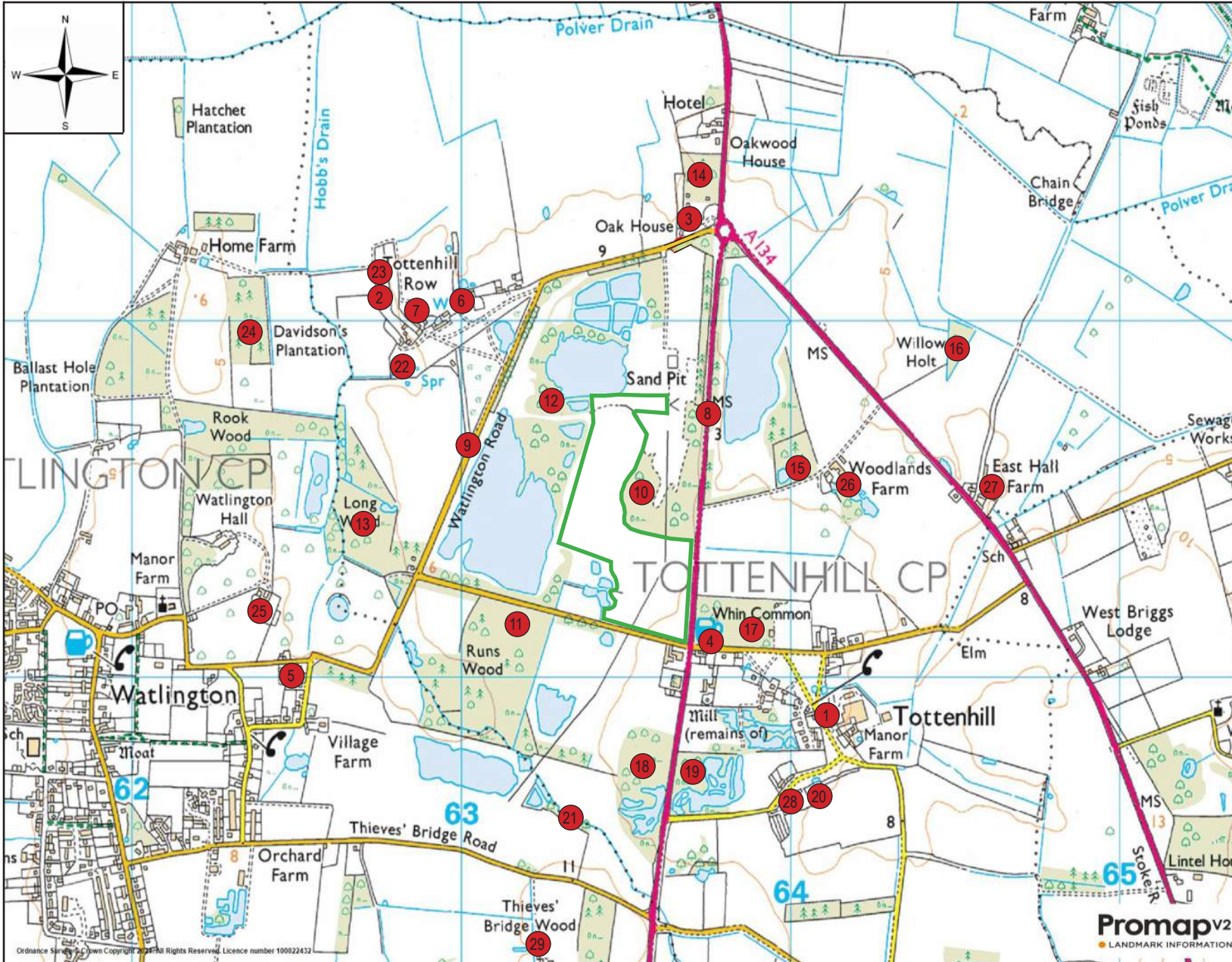

| ID  | Receptor  |
|---|---|
| <b>Designated ecological habitats/sites of geological importance e.g. Ramsar, SAC, SPA, SSSI, LNR, NNR, LWS</b> |   |
| 1   | Tottenhill Village Green (LWS)  |
| 2   | Tottenhill Row Common (LWS)   |
| <b>Domestic Dwellings</b>   |   |
| 3   | Oak House   |
| 4   | Residential area of Tottenhill  |
| 5   | Residential area of Watlington  |
| 6   | Residential area of Tottenhill Row                                      |
| 7   | Laundry Cottage   |
| <b>Highways or Minor Roads</b>  |   |
| 8   | A10   |
| 9   | Watlington Road   |
| <b>Priority Habitats</b>  |   |
| 10  | Priority Habitat Inventory – Deciduous Woodland                         |
| 11  | Priority Habitat Inventory – Deciduous Woodland (Runs Wood)             |
| 12  | Priority Habitat Inventory – Deciduous Woodland                         |
| 13  | Priority Habitat Inventory – Deciduous Woodland (Long Wood)             |
| 14  | Priority Habitat Inventory – Deciduous Woodland (Oak Wood)              |
| 15  | Priority Habitat Inventory – Deciduous Woodland (The Spinney)           |
| 16  | Priority Habitat Inventory – Deciduous Woodland (Willow Holt)           |
| 17  | Priority Habitat Inventory – Deciduous Woodland (Whin Common)           |
| 18  | Priority Habitat Inventory – Deciduous Woodland                         |
| 19  | Priority Habitat Inventory – Deciduous Woodland                         |
| 20  | Priority Habitat Inventory – Deciduous Woodland                         |
| 21  | Priority Habitat Inventory – Deciduous Woodland                         |
| 22  | Priority Habitat Inventory – Deciduous Woodland                         |
| 23  | Priority Habitat Inventory – Deciduous Woodland                         |
| 24  | Priority Habitat Inventory – Deciduous Woodland (Davidson's Plantation) |
| 25  | Priority Habitat Inventory – Traditional Orchard                        |
| <b>Sensitive land uses e.g. farmland, allotments, commercial fish farms</b>                                     |   |
| 26  | Woodlands Farm  |
| 27  | East Hall Farm  |
| 28  | Meadow Farm   |
| 29  | Thieves Bridge Farm   |

Legend:  
 Environmental Permit Boundary  
 Receptor

Office:  
Nottingham  
Created:  
IM

Project Ref:  
A117209  
Checked:  
MJ

Drawing No.:  
MGL/A117209/PER/01  
Date:  
08/02/21  
Version:  
V1

Title:  
Site Plan and  
Environmental Permit  
Boundary

Project:  
Watlington Quarry  
Environmental Permit  
Application

Client:  
**MICK GEORGE**

**TETRA TECH**

Ordnance Survey  
© Crown Copyright  
2018. All rights  
reserved. Licence  
number 100022432

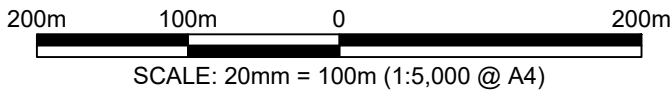

- Application boundary
- Other land under the Applicant's control
- Direction of working
- Permit Boundary

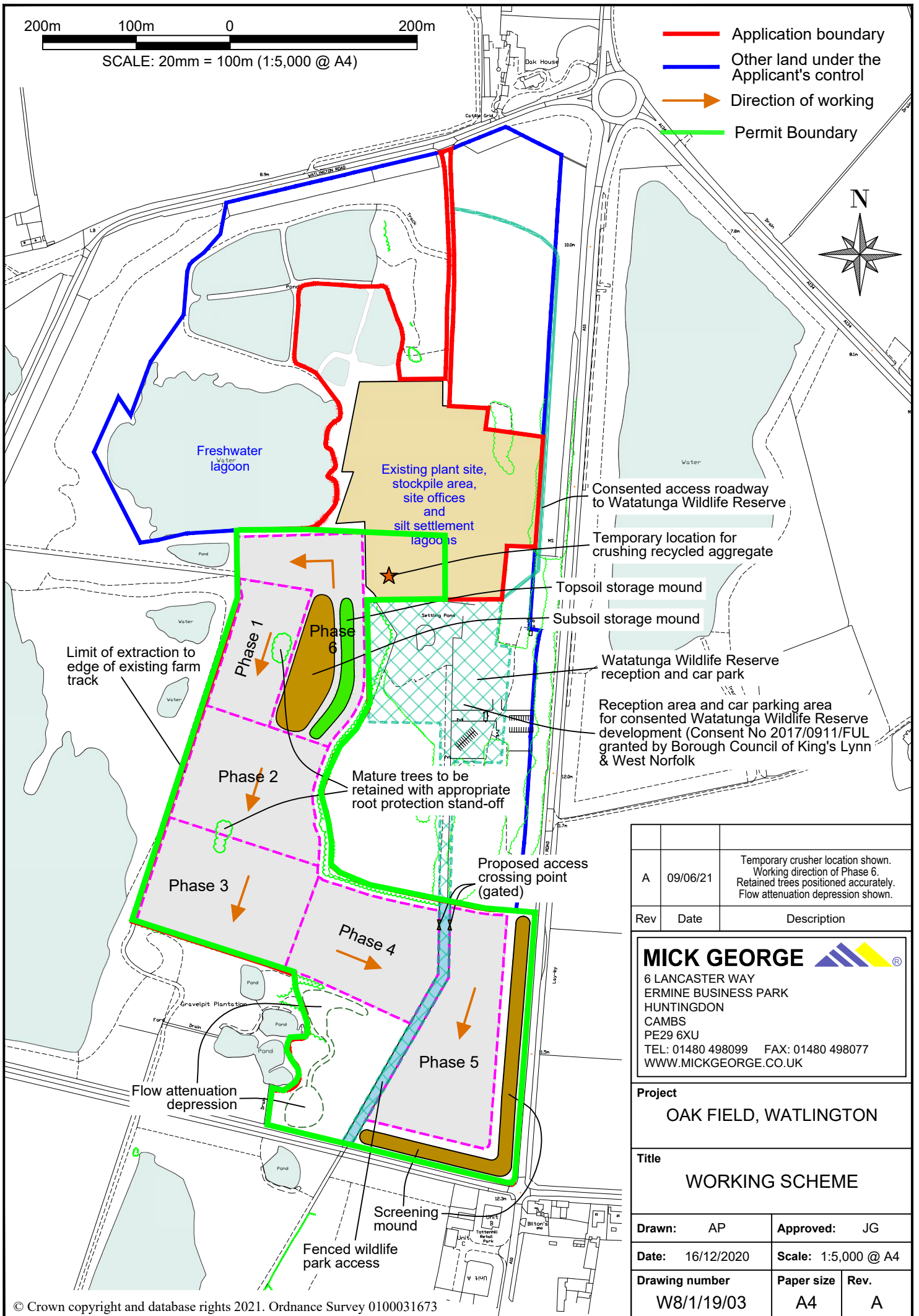

| A   | 09/06/21 | Temporary crusher location shown. Working direction of Phase 6. Retained trees positioned accurately. Flow attenuation depression shown. |
|-----|----------|--|
| Rev | Date     | Description  |

**MICK GEORGE**

6 LANCASTER WAY  
 ERMINE BUSINESS PARK  
 HUNTINGDON  
 CAMBS  
 PE29 6XU  
 TEL: 01480 498099 FAX: 01480 498077  
 WWW.MICKGEORGE.CO.UK

**Project**  
 OAK FIELD, WATLINGTON

**Title**  
 WORKING SCHEME

|                                     |                            |
|-------------------------------------|----------------------------|
| <b>Drawn:</b> AP                    | <b>Approved:</b> JG        |
| <b>Date:</b> 16/12/2020             | <b>Scale:</b> 1:5,000 @ A4 |
| <b>Drawing number</b><br>W8/1/19/03 | <b>Paper size</b><br>A4    |
|                                     | <b>Rev.</b><br>A           |

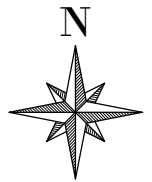
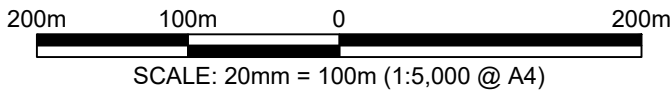

Silt lagoons restored to reedbeds, surrounded by species-rich grassland

- Application boundary
- Other land under the Applicant's control
- 10 Proposed contours
- ← Swale or culvert
- Outfall

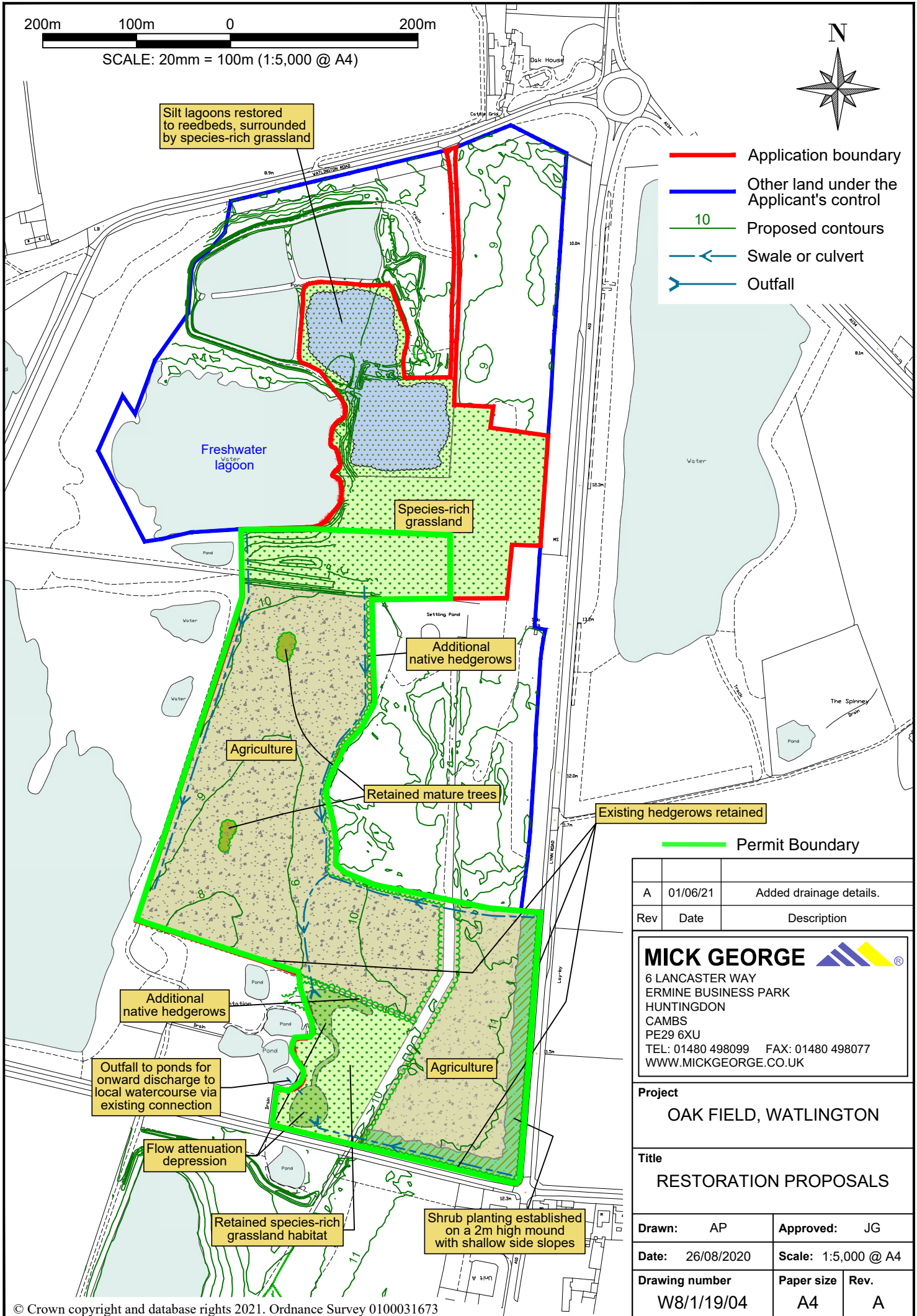

— Permit Boundary

| Rev | Date     | Description             |
|-----|----------|-------------------------|
| A   | 01/06/21 | Added drainage details. |

**MICK GEORGE**

6 LANCASTER WAY  
 ERMINE BUSINESS PARK  
 HUNTINGDON  
 CAMBS  
 PE29 6XU  
 TEL: 01480 498099 FAX: 01480 498077  
 WWW.MICKGEORGE.CO.UK

**Project**  
 OAK FIELD, WATLINGTON

**Title**  
 RESTORATION PROPOSALS

|                                   |                            |
|-----------------------------------|----------------------------|
| <b>Drawn:</b> AP                  | <b>Approved:</b> JG        |
| <b>Date:</b> 26/08/2020           | <b>Scale:</b> 1:5,000 @ A4 |
| <b>Drawing number:</b> W8/1/19/04 | <b>Paper size:</b> A4      |
|                                   | <b>Rev.:</b> A             |

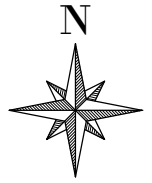
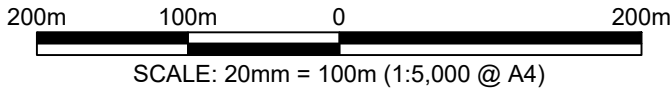

Silt lagoons restored to reedbeds, surrounded by species-rich grassland

- Application boundary
- Other land under the Applicant's control
- 10 Proposed contours
- ← Swale or culvert
- ⇨ Outfall
- Permit Boundary
- In Waste Boreholes

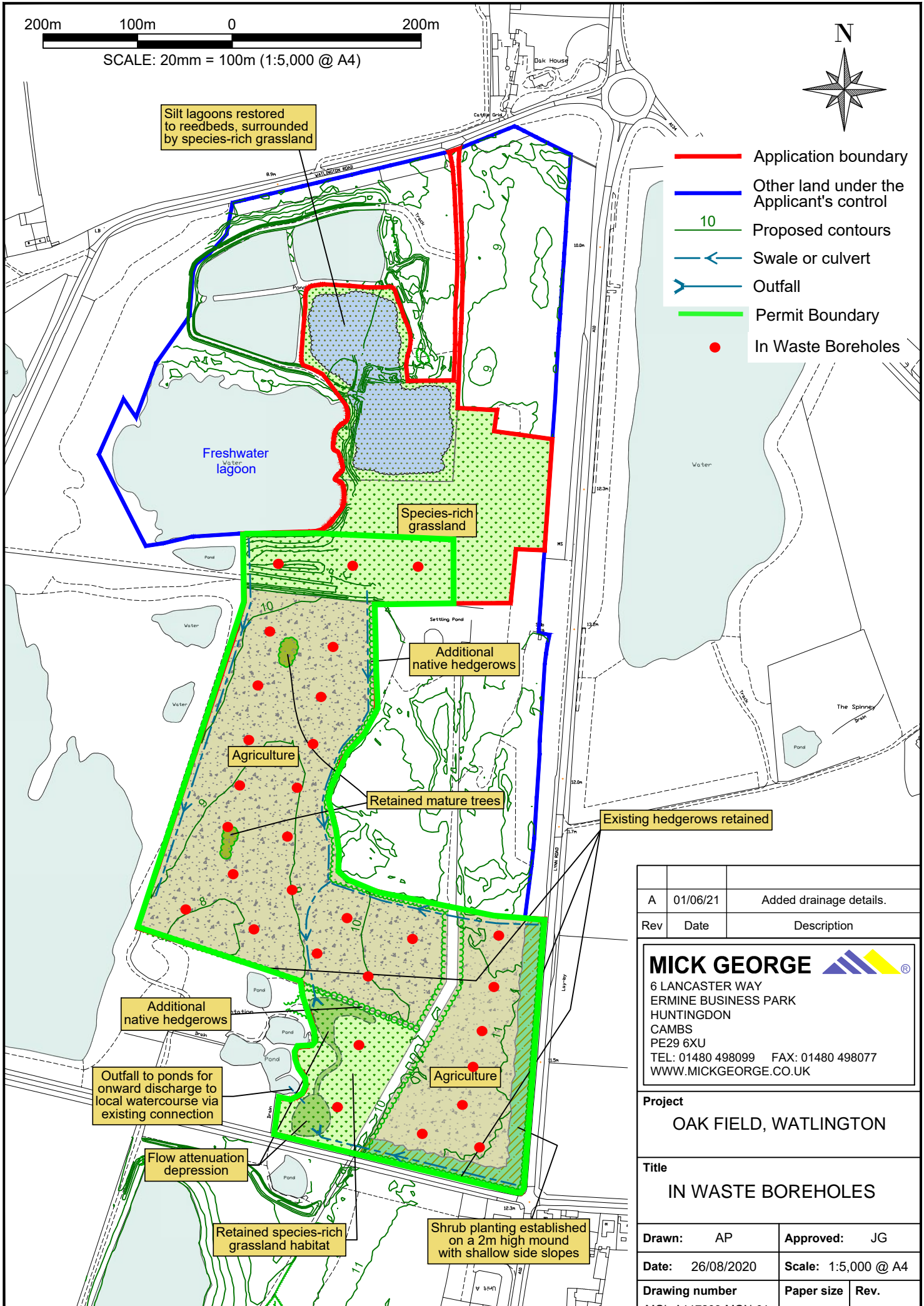

| Rev | Date     | Description             |
|-----|----------|-------------------------|
| A   | 01/06/21 | Added drainage details. |

**MICK GEORGE**

6 LANCASTER WAY  
ERMINE BUSINESS PARK  
HUNTINGDON  
CAMBS  
PE29 6XU  
TEL: 01480 498099 FAX: 01480 498077  
WWW.MICKGEORGE.CO.UK

**Project**  
OAK FIELD, WATLINGTON

**Title**  
IN WASTE BOREHOLES

|   |                            |
|---|----------------------------|
| <b>Drawn:</b> AP                          | <b>Approved:</b> JG        |
| <b>Date:</b> 26/08/2020                   | <b>Scale:</b> 1:5,000 @ A4 |
| <b>Drawing number:</b> MGL-A117209-MON-01 | <b>Paper size:</b> A4      |
|   | <b>Rev.</b>                |