

All dimensions to be verified on site. Figured dimensions to take precedent to those scaled. Any areas indicated on this drawing are for guidance only, no responsibility is taken for their accuracy.  
 The drawing is the property of GP Planning Limited. Copyright is reserved by them and the drawing is issued on the condition that it is not copied, reproduced, related or disclosed to any unauthorised person, either wholly or in part without the written consent in writing of GP Planning.  
 © 2020 GP Planning Limited. All rights reserved.

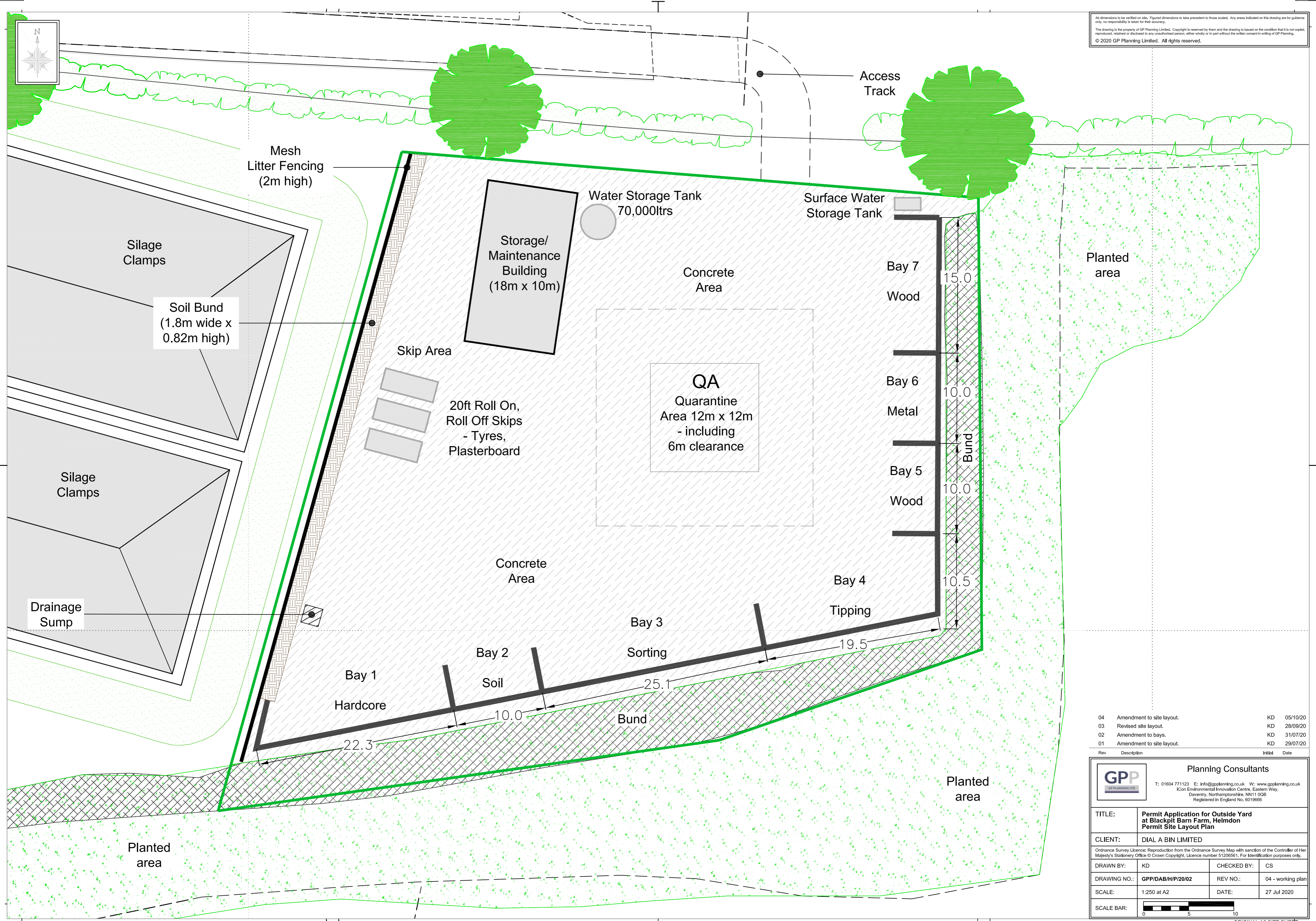
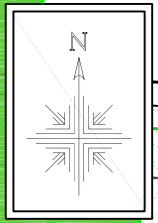

|    |                           |    |          |
|----|---------------------------|----|----------|
| 04 | Amendment to site layout. | KD | 05/10/20 |
| 03 | Revised site layout.      | KD | 28/09/20 |
| 02 | Amendment to bays.        | KD | 31/07/20 |
| 01 | Amendment to site layout. | KD | 29/07/20 |

**GPP** Planning Consultants  
 T: 01604 771123 E: info@gppanning.co.uk W: www.gppanning.co.uk  
 ICon Environmental Innovation Centre, Eastern Way,  
 Daventry, Northamptonshire, NN11 0QS  
 Registered in England No. 6019666

|   |  |             |                   |
|---|--|-------------|-------------------|
| TITLE:  | Permit Application for Outside Yard at Blackpit Barn Farm, Helmdon Permit Site Layout Plan |             |                   |
| CLIENT:   | DIAL A BIN LIMITED   |             |                   |
| Ordnance Survey Licence: Reproduction from the Ordnance Survey Map with sanction of the Controller of Her Majesty's Stationery Office © Crown Copyright. Licence number 51206561. For Identification purposes only. |  |             |                   |
| DRAWN BY:   | KD   | CHECKED BY: | CS                |
| DRAWING NO.:  | GPP/DAB/H/P/20/02  | REV NO.:    | 04 - working plan |
| SCALE:  | 1:250 at A2  | DATE:       | 27 Jul 2020       |
| SCALE BAR:  |  |             |                   |