

Denotes Existing kerbs

Notes:
 1. Figures shown are to be taken from drawings.
 2. All dimensions to be indicated on site to be shown to the nearest millimetre.
 3. All dimensions to comply with the current Building Regulations.
 4. The drawing is not to scale.
 5. See Drawing No.

OS License No: 100053143



Site Boundary: █

- W1 Surface water discharge ●
- S1 Sewer Emission Point ●
- A2 Blood Tank ●
- A1 and BEP Air Emission Point ●

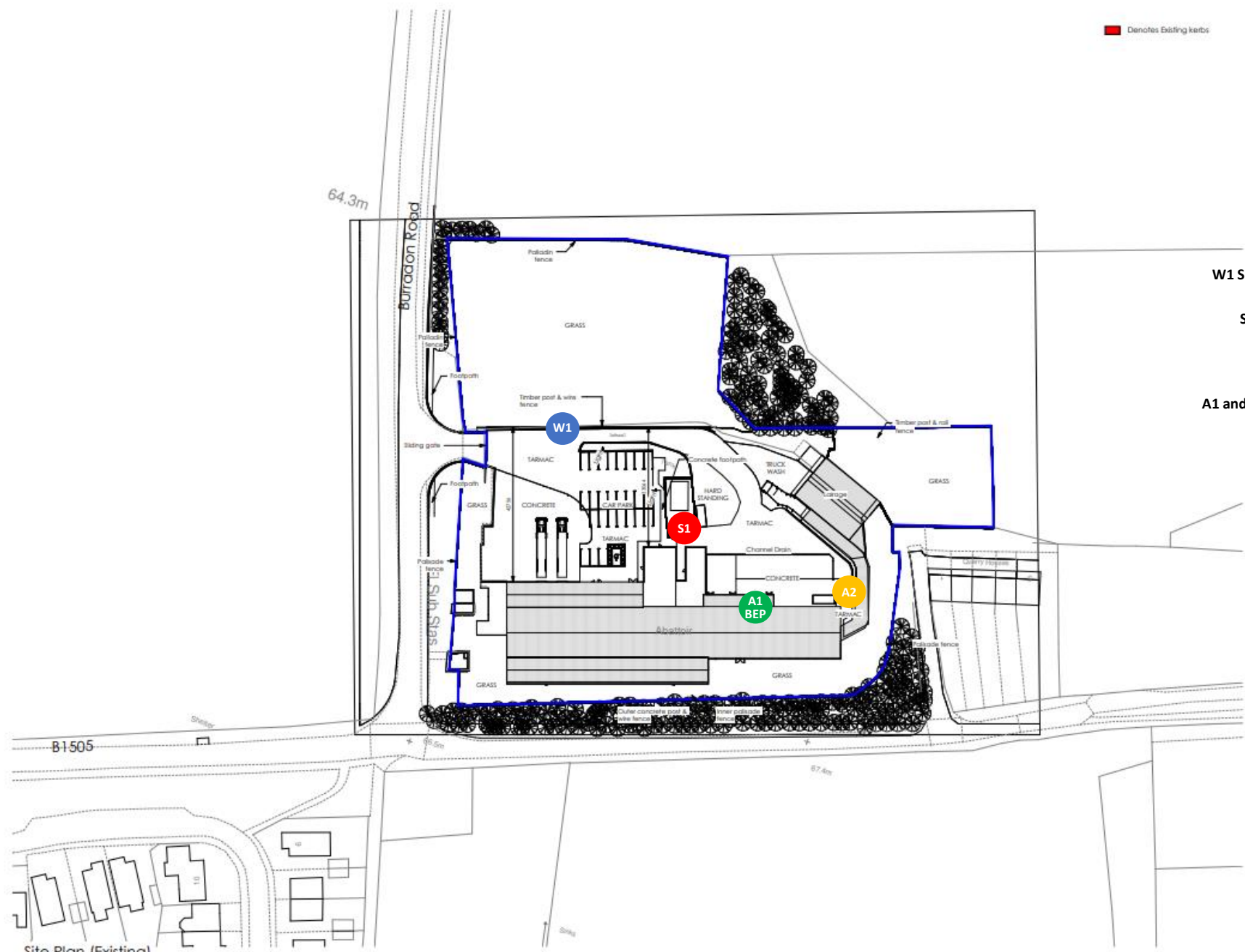

Site Plan (Existing)
 1 : 500

No.	Date	Revision
Revision Schedule		
ABP DEVELOPMENT		
14 Castle Street, Arklow, Co. Louth, Ireland. A92 2AG		 Food Group Tel : 041-4854100 Fax : 041-4854455
Project Proposed By Products Processing & Storage Extension, Linden Foods, 2 Quarry Cottages, Burton, Cramlington NE23 7NB, United Kingdom		
Title Existing Site Plan		
Date	02/04/20	Org no
Drawn L. Giván		BD-21-TD-1.01
Scale	1 : 500	Site A1
Project Status	Tender	
© Copyright ABP Development		