

Oil Separator

LEGEND:
 — FINISHED GROUND PROFILE
 - - - EXISTING GROUND PROFILE

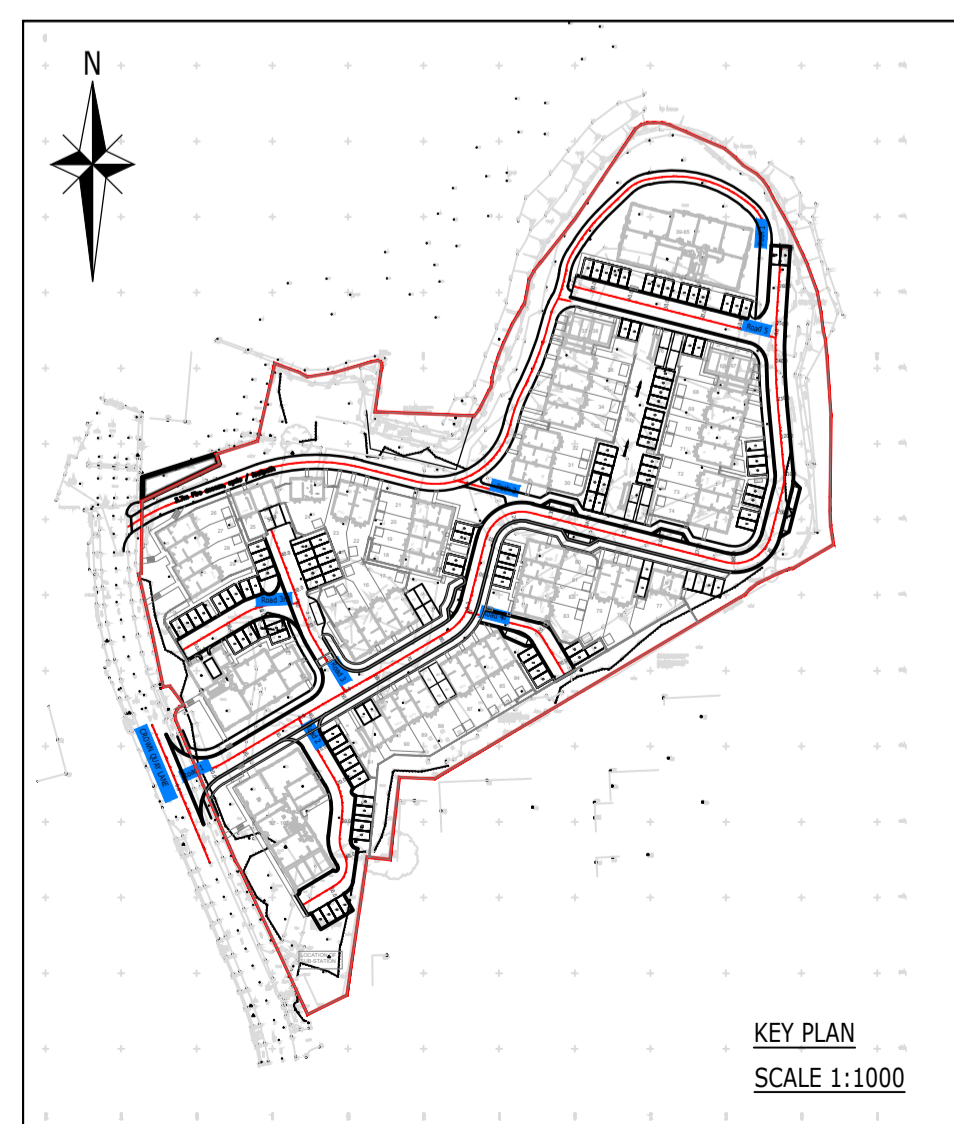

- NOTES:**
- THIS DRAWING IS TO BE READ IN CONJUNCTION WITH THE RELEVANT SPECIFICATION AND ALL OTHER RELATED DRAWINGS ISSUED BY THE ENGINEER.
 - DO NOT SCALE FROM THIS DRAWING. WORK FROM FIGURED DIMENSIONS ONLY.
 - ALL DIMENSIONS SHOWN ON THIS DRAWING ARE IN METRES UNLESS OTHERWISE STATED.
 - ALL DIMENSIONS, LEVELS AND SURVEY GRID CO-ORDINATES ARE TO BE CHECKED ON SITE AND THE ENGINEER NOTIFIED IMMEDIATELY OF ANY DISCREPANCIES PRIOR TO THE COMMENCEMENT OF THE WORKS.
 - NO DEVIATION FROM THE DETAILS SHOWN ON THIS DRAWING IS PERMITTED WITHOUT PRIOR PERMISSION FROM THE ENGINEER.
 - ALL ADAPTABLE DRAINAGE WORKS SUBJECT TO SOUTHERN WATER'S APPROVAL.
 - ALL MATERIALS AND WORKMANSHIP SHALL COMPLY FULLY WITH KCC DESIGN GUIDE, SPECIFICATION FOR HIGHWAY WORKS AND THE LOCAL AUTHORITY SPECIFICATION FOR ROAD CONSTRUCTION AND STANDARD DETAILS.
 - ALL EXCAVATED MATERIAL SHALL BE SUBJECT TO WAC TESTING AND REUSED ON SITE WHERE SUITABLE IN ACCORDANCE WITH THE MATERIALS MANAGEMENT PLAN.
 - ALL EXCAVATED MATERIAL NOT SUITABLE FOR REUSE ON SITE SHALL BE DISPOSED OF AT AN APPROVED TIP OFF-SITE.
 - THE PUBLIC HIGHWAY AND WORKS WILL BE KEPT CLEAN AND FREE OF DEBRIS BY USE OF WHEEL WASHING FACILITIES AND ROAD SWEEPERS TO THE COUNCIL'S SATISFACTION.
 - ALL SETTING OUT, RESIDENTIAL CHAMBERS, COVERS AND BOX COVERS SHALL BE AGREED ON-SITE WITH THE ENGINEER, PRIOR TO THE COMMENCEMENT OF THE WORKS.
 - THE CONTRACTOR SHALL BE RESPONSIBLE FOR OBTAINING ALL NECESSARY APPROVALS FROM THE LOCAL AUTHORITY PRIOR TO COMMENCING WORKS ON THE HIGHWAY.
 - NO DOORS, WINDOWS, GATES ETC. SHOULD OPEN OVER THE ADOPTABLE HIGHWAY AND THERE SHOULD BE NO PROJECTING RAIN WATER DOWN PIPES OR OVERHANGING EAVES FROM ROOFS.
 - NO SURFACE WATER RUN-OFF FROM PRIVATE AREAS OR HIGHWAY WATER FLOWING INTO THE PRIVATE AREAS SHALL DISCHARGE ONTO THE ADOPTABLE HIGHWAY.
 - VISIBILITY SPLAYS 1.5x1.5m ARE REQUIRED EITHER SIDE OF PRIVATE DRIVES AND ACCESSES, AND THERE SHALL BE NO PLANTING OVER 600mm IN HEIGHT IN THESE ZONES.
 - 'T' MARKS DIRECTION OF OWNERSHIP AND DIRECTION OF POSTS/ARIS RAILS - TO BE ESTABLISHED FROM CONVEYANCE PLANS.

Consultant Information

ARDENT CONSULTING ENGINEERS

Third Floor, The Hallmark Building
 52-56 Leadenhall Street
 London
 EC3M 5JE

Tel: 020 7680 4088
 Web: www.ardent-ce.co.uk
 E-mail: enquiries@ardent-ce.co.uk

worksafe consultant
 www.emasstd.com

SSIP
 SAFETY SCHEDULED BY THE HEALTH AND SAFETY EXECUTIVE

- CDM NOTES**
- THE ATTENTION OF THE CLIENT AND THE PRINCIPAL CONTRACTOR IS DRAWN TO THE FOLLOWING POTENTIAL RISKS IN CONJUNCTION WITH THE PROPOSED ON-SITE AND OFF-SITE WORKS AS DESIGNED FOR THIS PROJECT:
- WORKS IN THE VICINITY OF LIVE SERVICES WILL BE NECESSARY AND THE ADVICE OF ALL STATUTORY SERVICE COMPANIES MUST BE SOUGHT BEFORE ANY WORKS COMMENCE.
 - WORKS WITHIN AND ABUTTING THE EXISTING HIGHWAY WILL ENTAIL TRAFFIC HAZARDS AND ALL APPROPRIATE SAFETY MEASURES INCLUDING BARRIERS, SIGNS AND LIGHTING MUST BE UNDERTAKEN TO THE APPROVAL OF THE LOCAL AUTHORITY, THE HIGHWAY AUTHORITY AND THE POLICE.
 - HAZARDOUS MATERIALS INCLUDING CEMENT AND BITUMINOUS MATERIALS ARE SPECIFIED AND THE MANUFACTURER'S ADVICE ON SAFE HANDLING PROCEDURES MUST BE OBTAINED AND MADE CLEAR TO ALL OPERATIVES.
 - THE CONTRACTOR WILL BE RESPONSIBLE FOR LOCATING ALL EXISTING SERVICES WITHIN THE VICINITY OF THE WORKS AND ENSURE THESE ARE PROTECTED THROUGHOUT THE DURATION OF THE WORKS. ALL UTILITY PLANT SHOULD BE CLEARLY MARKED ON THE GROUND PRIOR TO COMMENCEMENT OF THE WORKS.
 - THE CONTRACTOR MUST ENSURE ALL WORKING AREAS ARE FULLY SECURE.

CONSTRUCTION ISSUE

C1	17.12.2021	CONSTRUCTION ISSUE	JJ	JH	DWJP
Rev.	Date	Description	Drn	Chk	App

Original size 100mm - this print may be reduced

Note: All dimensions, materials and workmanship in accordance with NIBC standards and Building Regulations.
 Do not scale from this drawing. All dimensions to be verified with the drawing office.
 All dimensions shown are structural unless otherwise stated.

Bellway

Kent Division
 30 Tower View
 Kings Hill
 West Malling
 Kent ME19 4UY
 Telephone 01732 879750
 www.bellway.co.uk

Project
CROWN QUAY LANE
SITTINGBOURNE
KENT

Drawing Title
LONG SECTIONS - SHEET 6

Scale	Date	Drawn	Checked	Approved
1:500/A1	DEC 2021	JJ	JH	DP

Drawing No	Rev.
AT-1204	C1