



2

3

4

5

6

7

8

9

10

11

12

13

14

15

16

KEY:

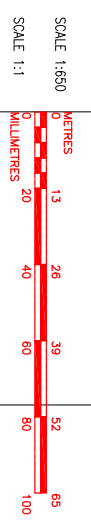
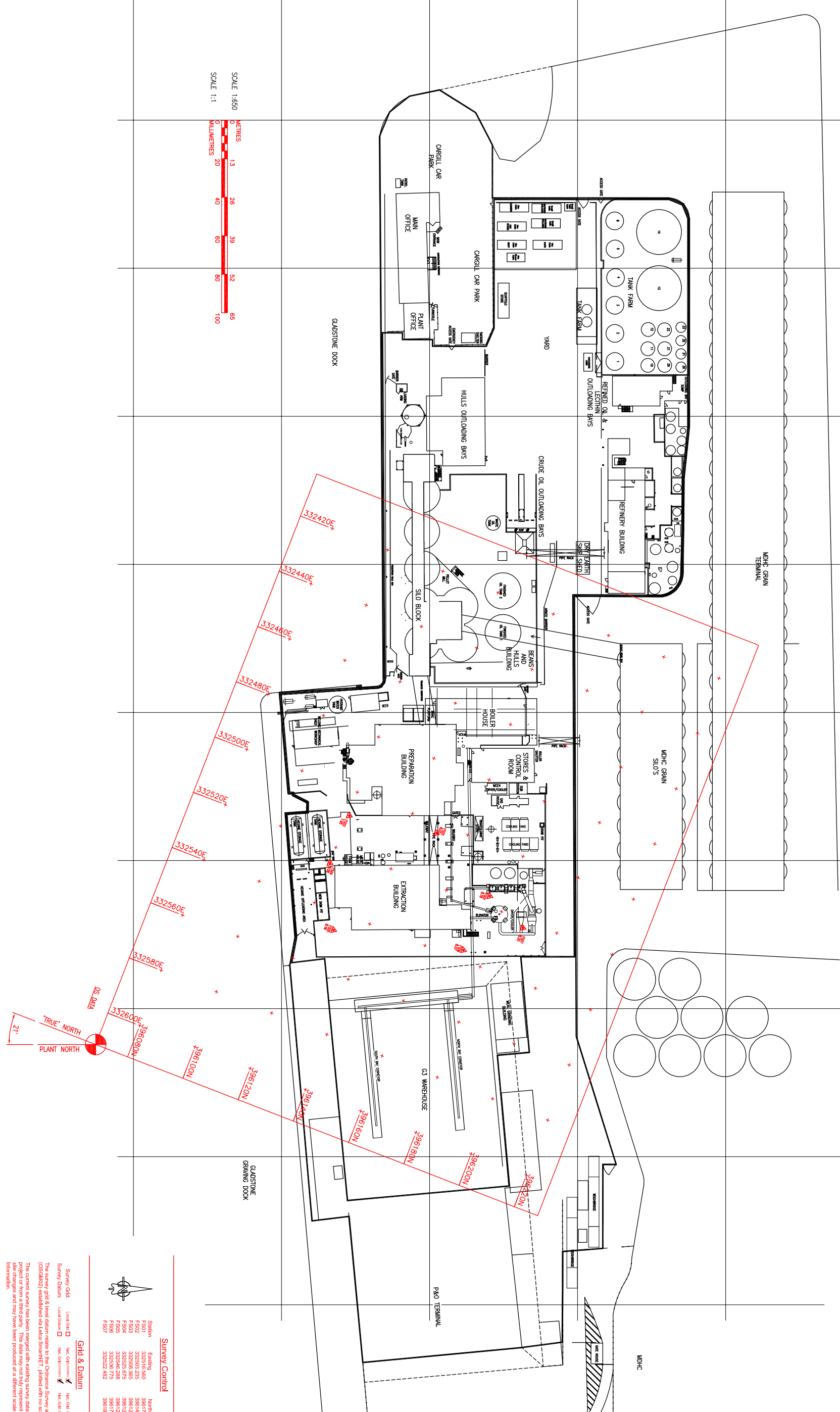

Survey Control

Station	Easting	Northing	Level
FS90	332303.860	396174.425	8.184
FS92	332303.235	396148.883	8.010
FS93	332308.385	396120.328	7.892
FS94	332325.598	396120.327	8.157
FS95	332325.598	396120.327	8.157
FS96	332336.775	396172.700	8.065
FS97	332322.482	396188.686	8.204

Grid & Datum

Survey Grid: Local Grid UK Ordnance Survey Existing OS
 Survey Datum: Local Datum UK Ordnance Survey OS BM
 The survey grid & level datum relate to the Ordnance Survey datum, OS datum (OSBM) established via the Survey of the Great Britain (SOGB) datum.

The current survey has been merged with existing survey data, from either a previous project or from a third party. This data may not always represent current conditions due to changes in the site and may have been produced at a different scale to the current project.

NOTES

REV	DATE	DESCRIPTION	APPROVED	DATE
D	03.09.20	PM PROLEN - EMISSION POINTS GENERAL UPDATE		
C	23.09/2013	NEW PROJECTS ADDED AND REVISIONS TO EMISSION POINTS A1, A2, A3 & A15		
B	28.03.2011	RE-ISSUED FOR GENERAL DRAWING UPDATES		

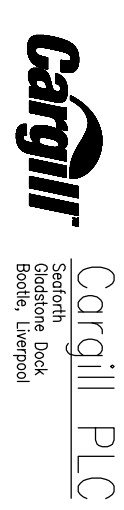

TITLE
SITE PLAN
PCF PERMIT - PROPOSED EMISSION POINTS

REV	DATE	DESCRIPTION	APPROVED	DATE	PERIODS REV. NO.	REV
D	03.09.20	PM PROLEN - EMISSION POINTS GENERAL UPDATE			05941-MP-1000-7 / S./40/8038	
C	23.09/2013	NEW PROJECTS ADDED AND REVISIONS TO EMISSION POINTS A1, A2, A3 & A15				
B	28.03.2011	RE-ISSUED FOR GENERAL DRAWING UPDATES				

MINIMUM TEXT SIZE 2.5mm TO SUIT MICROFILMING

DO NOT SCALE