

DO NOT SCALE

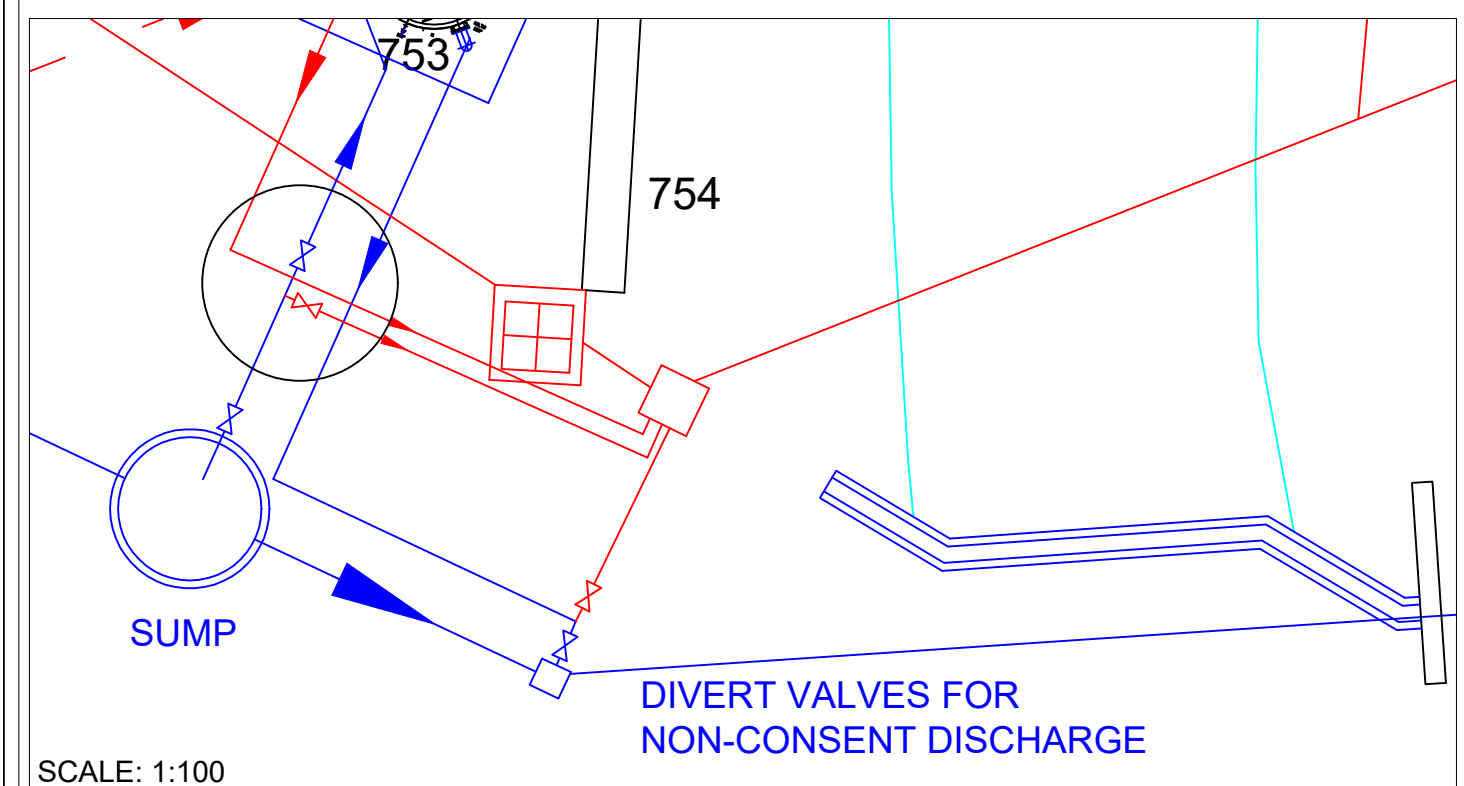
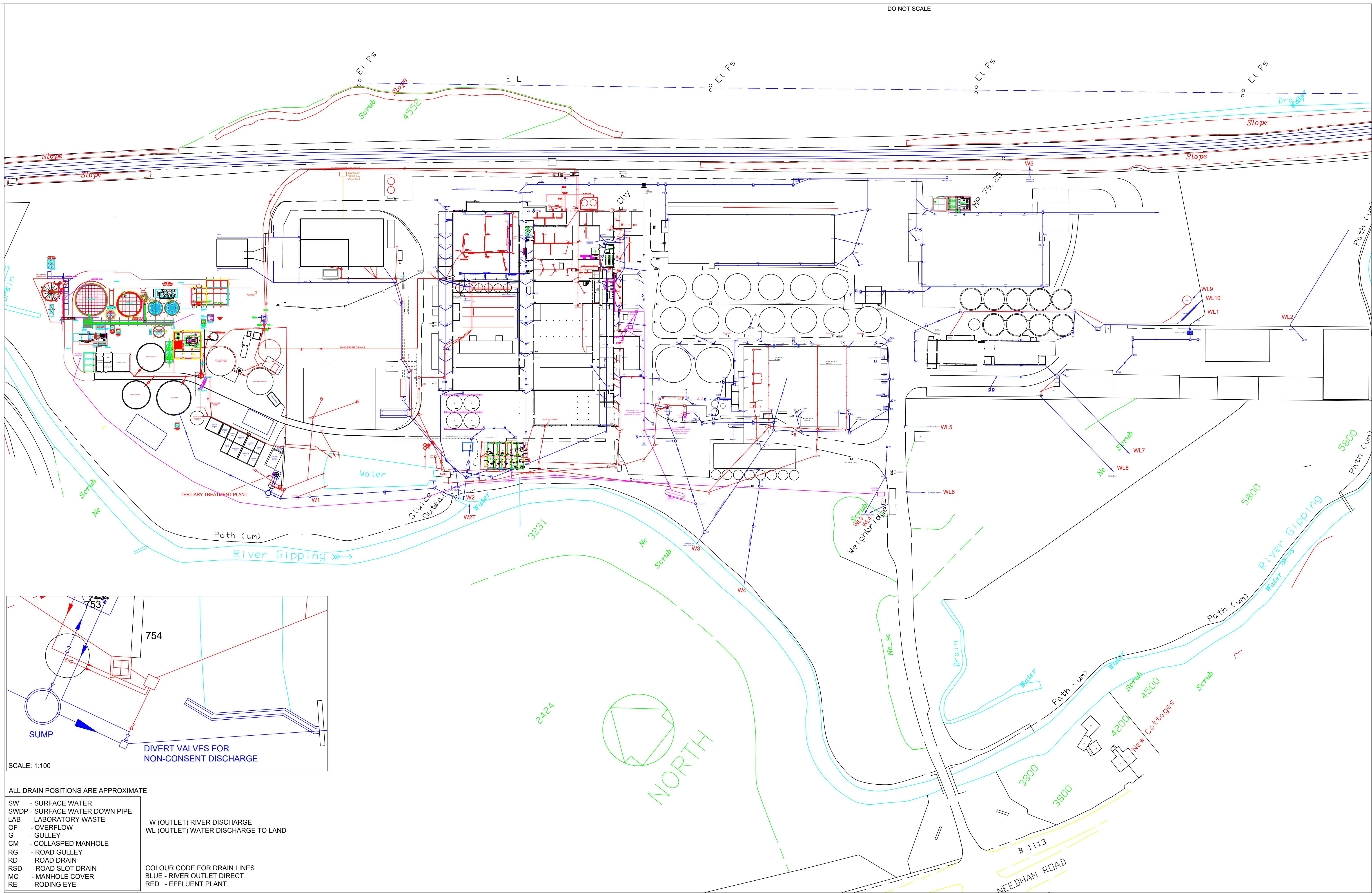

- SCALE: 1:100
- ALL DRAIN POSITIONS ARE APPROXIMATE
- SW - SURFACE WATER
  - SWDP - SURFACE WATER DOWN PIPE
  - LAB - LABORATORY WASTE
  - OF - OVERFLOW
  - G - GULLY
  - CM - COLLAPSED MANHOLE
  - RG - ROAD GULLY
  - RD - ROAD DRAIN
  - RSD - ROAD SLOT DRAIN
  - MC - MANHOLE COVER
  - RE - RODING EYE
- W (OUTLET) RIVER DISCHARGE
  - WL (OUTLET) WATER DISCHARGE TO LAND
- COLOUR CODE FOR DRAIN LINES
- BLUE - RIVER OUTLET DIRECT
  - RED - EFFLUENT PLANT

REVISION	DESCRIPTION	DATE	REVISION	DESCRIPTION	DATE
L	VITAL AND OTHER MODS ADDED	20/03/23	F	B BLOCK TANKER AREA MODS ADDED	12-7-12
K	Domestic Effluent Plants added	21/12/17	E	GREENHOUSE REMOVED	20-12-11
J	River discharge project & AD Plant ADDED	31/08/17	D	CENTRE FOR EXCELLENCE ADDED	18-6-10
I	Railway pit drains to effluent updated	06/01/14	C	INTERCEPTOR ADDED BY RAILWAY DITCH	2-3-07
H	CEDARS DRAINS MODIFIED	27/03/13	B	RIVER & GROUND DISCHARGES ADDED	12-1-06
G	GATEHOUSE DOMESTIC EFFLUENT FILTER DRAINAGE ADDED	16/07/12	A	DRAIN REDIRECTED TO EFFLUENT LINE	12-8-05

TITLE: MASTER DRAINAGE RECORD DRAWING  
FOUL AND SURFACE WATER

DEPT: STOWMARKET SITE

THIS DRAWING IS THE PROPERTY OF MUNTONS plc AND MUST NOT BE COPIED OR USED FOR ANY PURPOSE WHATSOEVER WITHOUT THE EXPRESS PERMISSION AND LICENCE OF MUNTONS plc.

Drawn: PS  
Date: 10-11-2004  
Chkd: [Signature]  
Scale: 1:600 1:100 (A0)

**MUNTONS plc**  
**STOWMARKET IP14 2AG**

DRG No. 40M58-1