

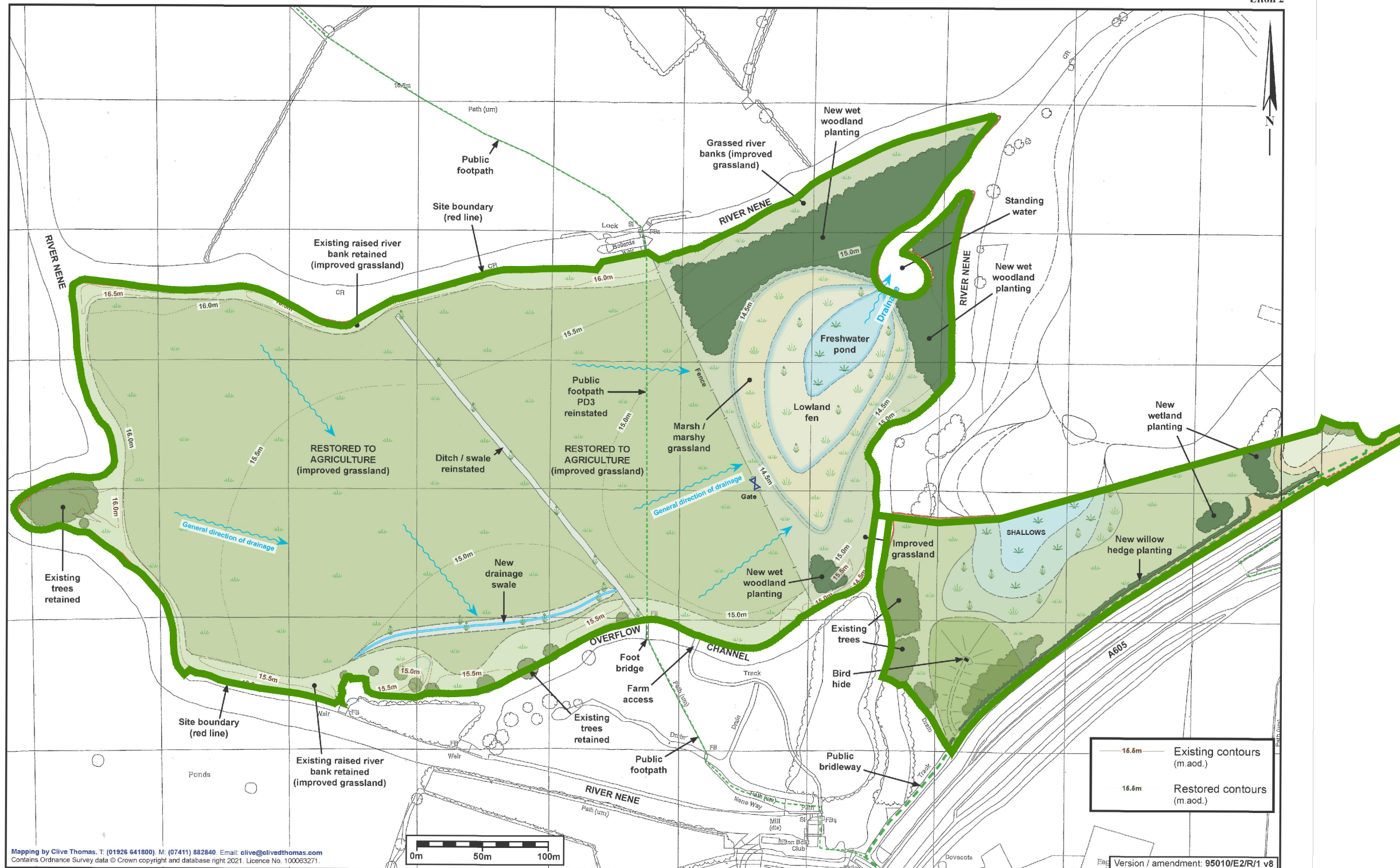

Elton 2



Mapping by Clive Thomas, T: (01926 641800), M: (07411) 882840, Email: [clive@clivethomas.com](mailto:clive@clivethomas.com)  
 Contains Ordnance Survey data © Crown copyright and database right 2021. Licence No. 100063271.

16.6m Existing contours (m.a.o.d.)  
 15.6m Restored contours (m.a.o.d.)

Version / amendment: 95010/E2/R/1 v8

NOTES

1. DRAWING IS SUPPLIED BY D.K. SYMES ASSOCIATES, DRAWING: RESTORATION SCHEME - EXTENSION AREA, REF: 95010/E2/R/1 V8, DATED: 30.03.2021 & RESTORATION SCHEME - PLANT SITE, REF: 95010/E2/R/2, DATED: 15.04.2019.

LEGEND

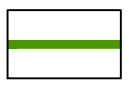
 PROPOSED ELTON 2 WASTE RECOVERY OPERATION ENVIRONMENTAL PERMIT BOUNDARY



INGREBOURNE VALLEY LTD



3RD FLOOR  
 THE BREW HOUSE  
 JACOB STREET  
 BRISTOL, BS2 0EQ

T: 01179 064280  
 www.slrconsulting.com

ELTON 2 QUARRY RESTORATION  
 ENVIRONMENTAL PERMIT APPLICATION  
 RESTORATION SCHEME

DRAWING 05

Scale NTS (A3)

Date DECEMBER 2021

01526.00029.003.13.005.2\_RESTORATION\_SCHEME.dwg

Ingrebourne Valley Limited

Restoration Scheme - Extension Area

Scale - 1:2,500 (at A3)

Date - 30-03-2021

Plan No. 95010/E2/R/1