

DEEP MOOR TRANSFER STATION AND COMPOSTING
 FPP SITE PLAN
 NOV 2021
 SCALE 1:1000 at A3
 Drg No WD/N(16)/861

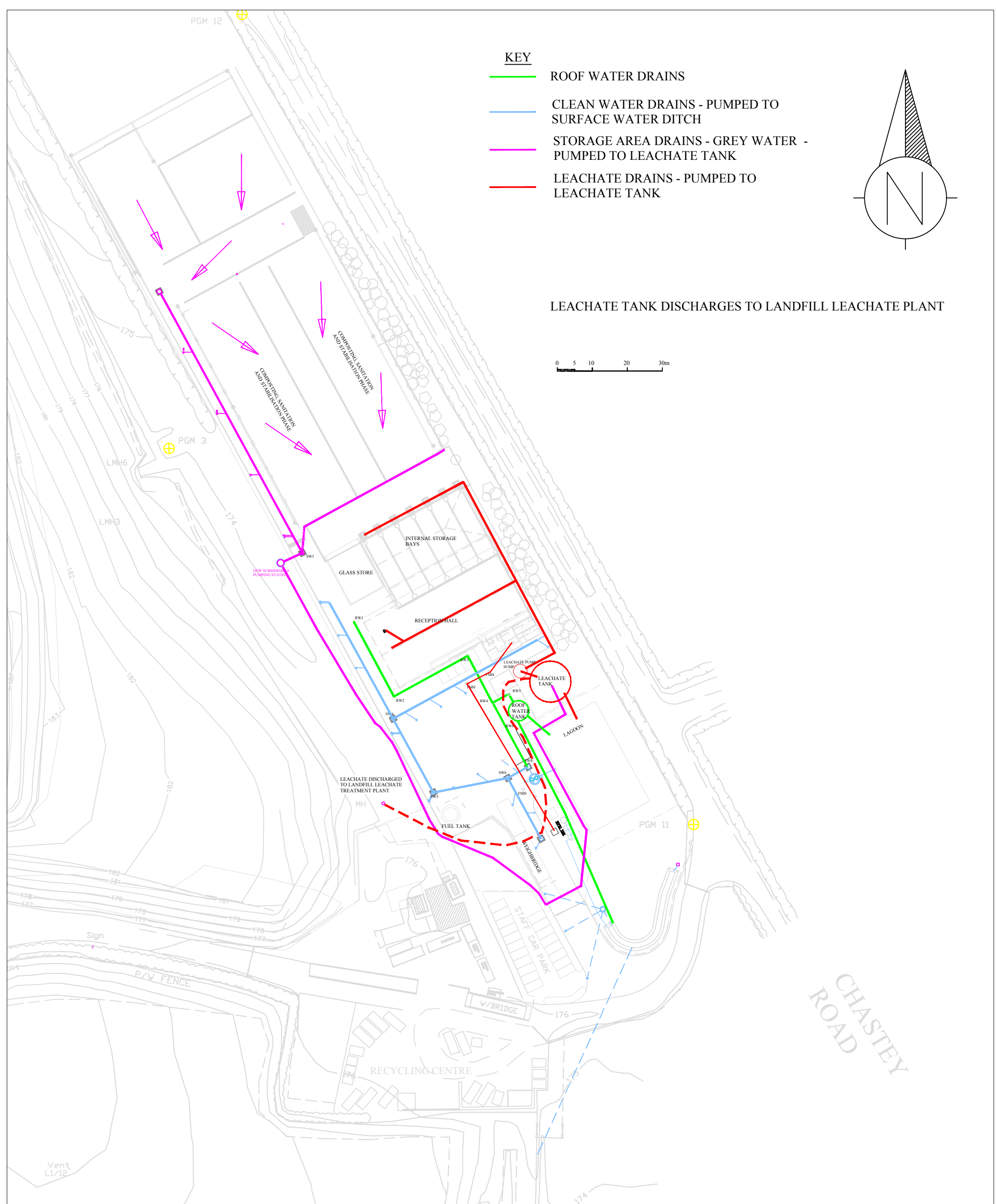

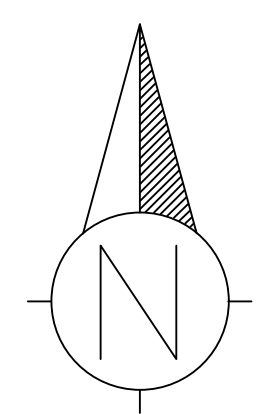

- KEY**
- ROOF WATER DRAINS
 - CLEAN WATER DRAINS - PUMPED TO SURFACE WATER DITCH
 - STORAGE AREA DRAINS - GREY WATER - PUMPED TO LEACHATE TANK
 - LEACHATE DRAINS - PUMPED TO LEACHATE TANK



LEACHATE TANK DISCHARGES TO LANDFILL LEACHATE PLANT

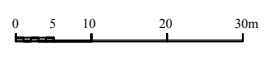

DEEP MOOR TRANSFER STATION AND COMPOSTING
 FPP DRAINAGE PLAN
 NOV 2021
 SCALE 1:1000 at A3
 Drg No WD/N(16)/862



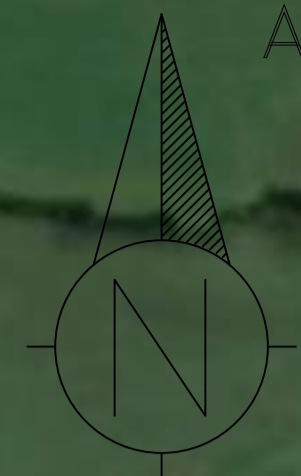
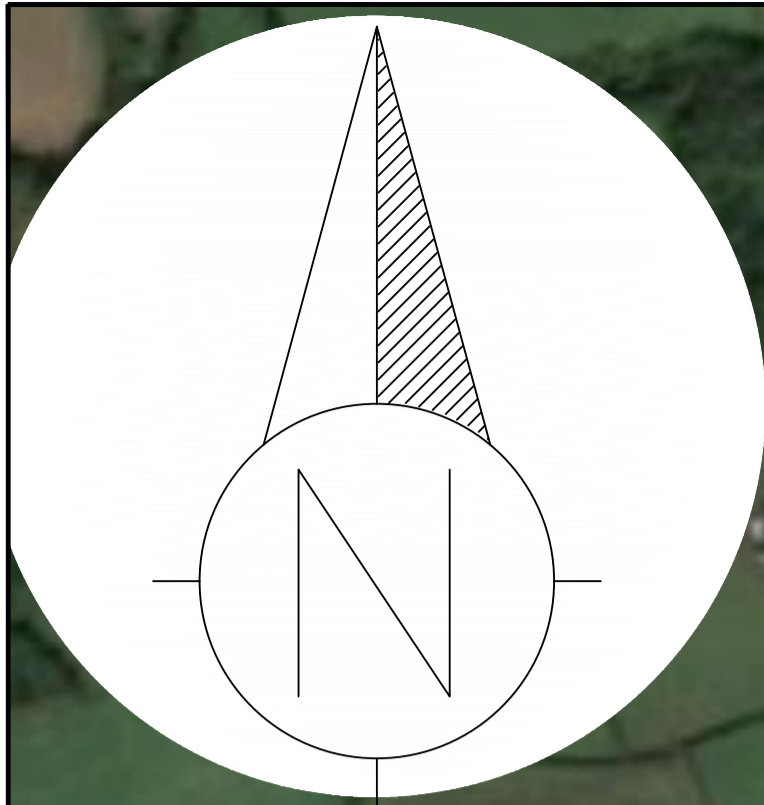

REVISIONS
 Details
 Change Approved

NOTES

- SENSITIVE RECEPTORS
- SITE BOUNDARY

DRAWN	NEB	SCALE(S)	NTS
CHECKED	NEB	DATE	DEC 2021

**COASTAL
UK GROUP**

COASTAL UK GROUP LTD
 Units 1-2 Mulberry Court
 Lustleigh Close
 Matford Business Park
 EXETER
 EX2 8PW

JOB
 DEEP MOOR TRANSFER STATION
 AND COMPOSTING
 FIRE PREVENTION PLAN

DRAWING TITLE
 LOCATION OF SENSITIVE
 RECEPTORS

DRAWING NUMBER
 WD/N(16)/863

