

DO NOT SCALE

KEY:

- PROPOSED SURFACE WATER FILTER DRAIN AND MANHOLE
- PROPOSED SURFACE WATER PIPE AND MANHOLE
- PROPOSED FOUL WATER FILTER DRAIN AND MANHOLE
- PROPOSED FOUL WATER PIPE AND MANHOLE
- PROPOSED PERFORATED PIPE
- PROPOSED BEANY BLOCK STRAIGHT BACKED HB WITH 205 BASE UNIT
- PROPOSED MAX-E CHANNEL CAST IRON TOP WITH 295 BASE UNIT
- PROPOSED MAX-E CHANNEL CAST IRON TOP WITH 205 BASE UNIT
- PROPOSED S100 ACO DRAIN
- PROPOSED SURFACE WATER PUMP
- FOUL WATER POP-UP POINT
- SPEL 200 SERIES TANKSTOR UNDERGROUND SEPTIC TANK (OR SIMILAR APPROVED)

- NOTES:**
- DIMENSIONS SHALL NOT BE SCALED FROM THIS DRAWING.
 - DIMENSIONS SHOWN ARE IN METRES AND LEVELS IN METRES AOD.
 - THIS DRAWING SHOULD BE READ IN CONJUNCTION WITH ALL OTHER RELEVANT DOCUMENTATION, DRAWINGS AND STANDARD DETAILS.
 - THE CONTRACTOR IS RESPONSIBLE TO LOCATE ALL EXISTING SERVICES PRIOR TO UNDERTAKING ANY EXCAVATIONS.
 - CONFLICTING INFORMATION SHOWN ON THE DESIGNERS DRAWINGS OR DISCREPANCIES BETWEEN THE INFORMATION GIVEN BY THE ENGINEER AND THAT PROVIDED BY OTHERS MUST BE REFERRED TO THE ENGINEER BEFORE THE WORKS COMMENCE.
 - LEVELS DESIGN IS BASED ON TOPOGRAPHIC SURVEY PROVIDED BY DANIEL CHARLES DATED 11/05/2023.
 - CONCRETE PROTECTION/SURROUND REQUIRED WHERE PIPES RUN LESS THAN 1.2M DEEP AND ARE SUBJECT TO VEHICULAR LOADING.

FOR H&S RISKS REFER GENERAL ARRANGEMENT DRAWING 70096275-WSP-XX-XX-DG-CV-1201 AND 'T447-SIGNIFICANT RESIDUAL HS RISK SCHEDULE'

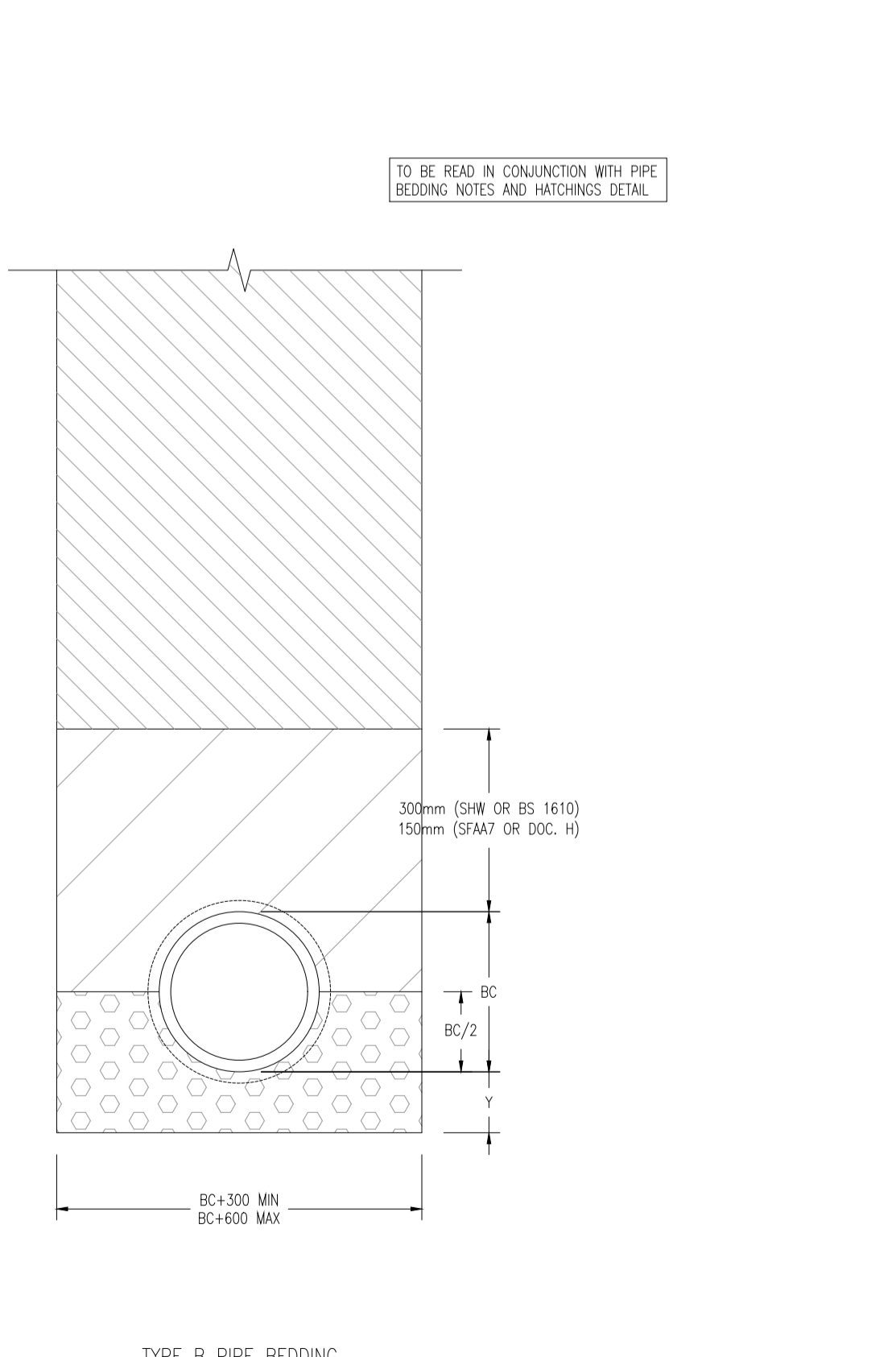
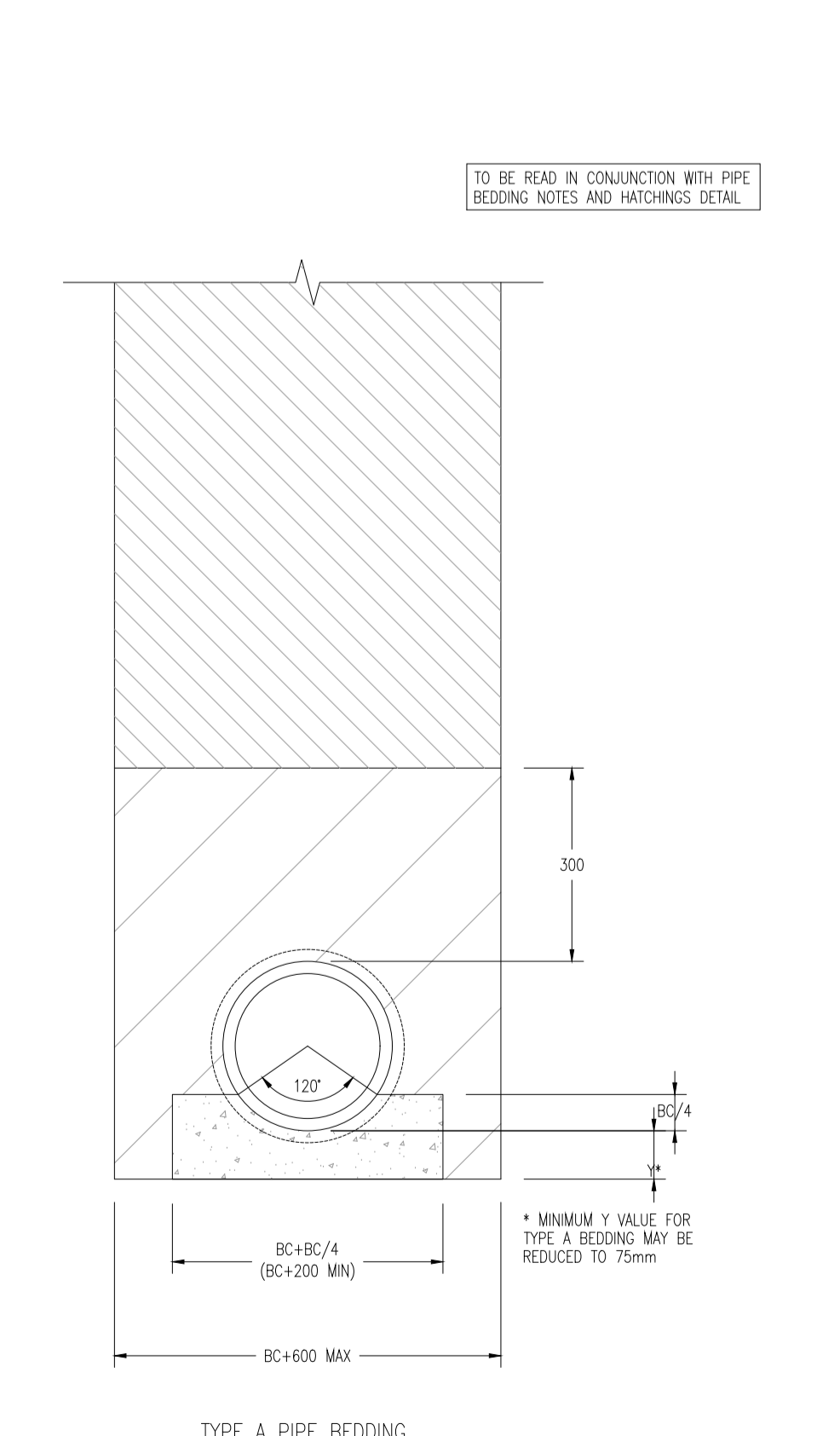
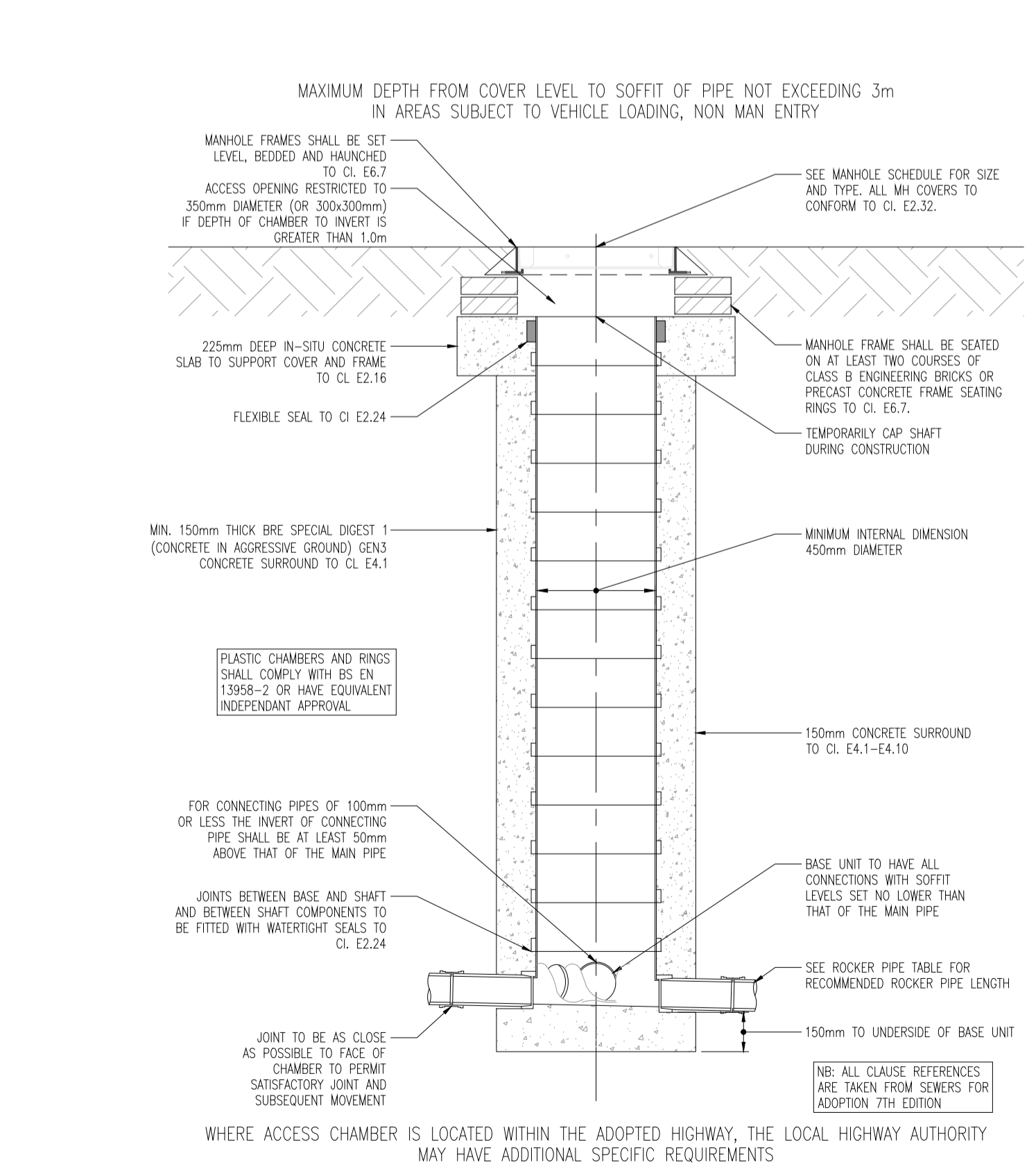
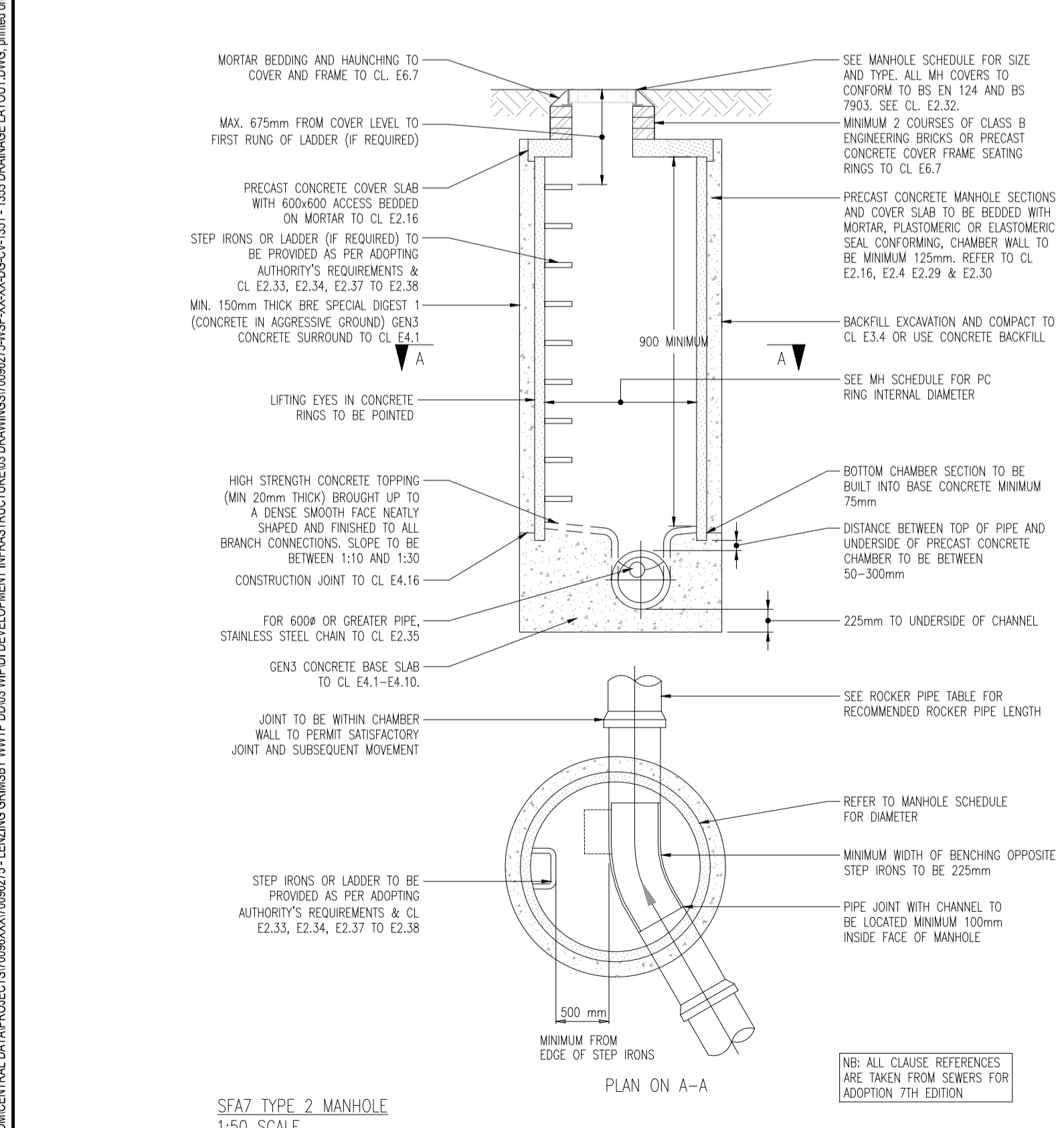

REV	DATE	BY	DESCRIPTION	CHK	APP
C05	24/07/2024	JS	CONSTRUCTION ISSUE - OUTFALL DISCHARGE RATE REVISED	FWW	IP
C04	05/10/2023	MH	CONSTRUCTION ISSUE - UPDATED LEVELS	MD	IP
C03	27/09/2023	MH	CONSTRUCTION ISSUE - UPDATED LEVELS	MD	IP
C02	19/09/2023	MH	CONSTRUCTION ISSUE - UPDATED LEVELS	MD	IP
C01	25/07/2023	JS	CONSTRUCTION ISSUE	MD	IP
P01	31/05/2023	MH	TENDER ISSUE	NM	IP

DRAWING STATUS: A - FIT FOR CONSTRUCTION

Amber Court, William Armstrong Drive, Newcastle upon Tyne, NE4 7YQ, UK
T+ 44 (0) 191 226 2000, F+ 44 (0) 191 226 2104
wsp.com

CLIENT: LENZING FIBERS GRIMSBY

SITE/PROJECT: WASTE WATER TREATMENT PLANT

TITLE: BELOW GROUND DRAINAGE LAYOUT OVERALL

SCALE @ A1:	CHECKED:	APPROVED:
1:500	NM	IP
PROJECT NO:	DESIGNED:	DRAWN:
70096275	MH	MH
DRAWING NO:	DATE:	
70096275-WSP-XX-XX-DG-CV-1351	July 2024	

REV: C05

© WSP UK Ltd

File name: \\UK.VSP.GROUP\CENTRAL\DATA\PROJECTS\70096275\WSP-XX-XX-DG-CV-1351 - 1351 DRAINAGE LAYOUT DWG.dwg, created on 24 July 2024 12:18:32, by Stephen Job