

KEY LEGEND

- Bank matting
- Waterbody
- Unmade ground
- Grass/Vegetation
- Concrete/Tarmac
- Site Boundary
- Building Outline
- Rising Main
- Foul Water
- Surface Water
- Roof Surface Water
- Private Foul Water
- Trade Waste
- Trade Waste (Decommissioned)
- Gas Pipe
- Electricity Line
- Ductwork
- Bulk Storage/Container
- Waste Skip/Compactor Area
- Hazardous Substance Storage
- Spill Kit

Construction staff and operatives must ensure the principal contractor has provided thorough and accurate information on all health and safety aspects relating to the designs identified on this drawing including the review of:

- Designers/contractors risk assessments
- Method statements
- Permit to work
- Pre construction information

The designers note that the following health and safety risks relating to this drawing have not been eliminated during the design process:

ref	residual risk

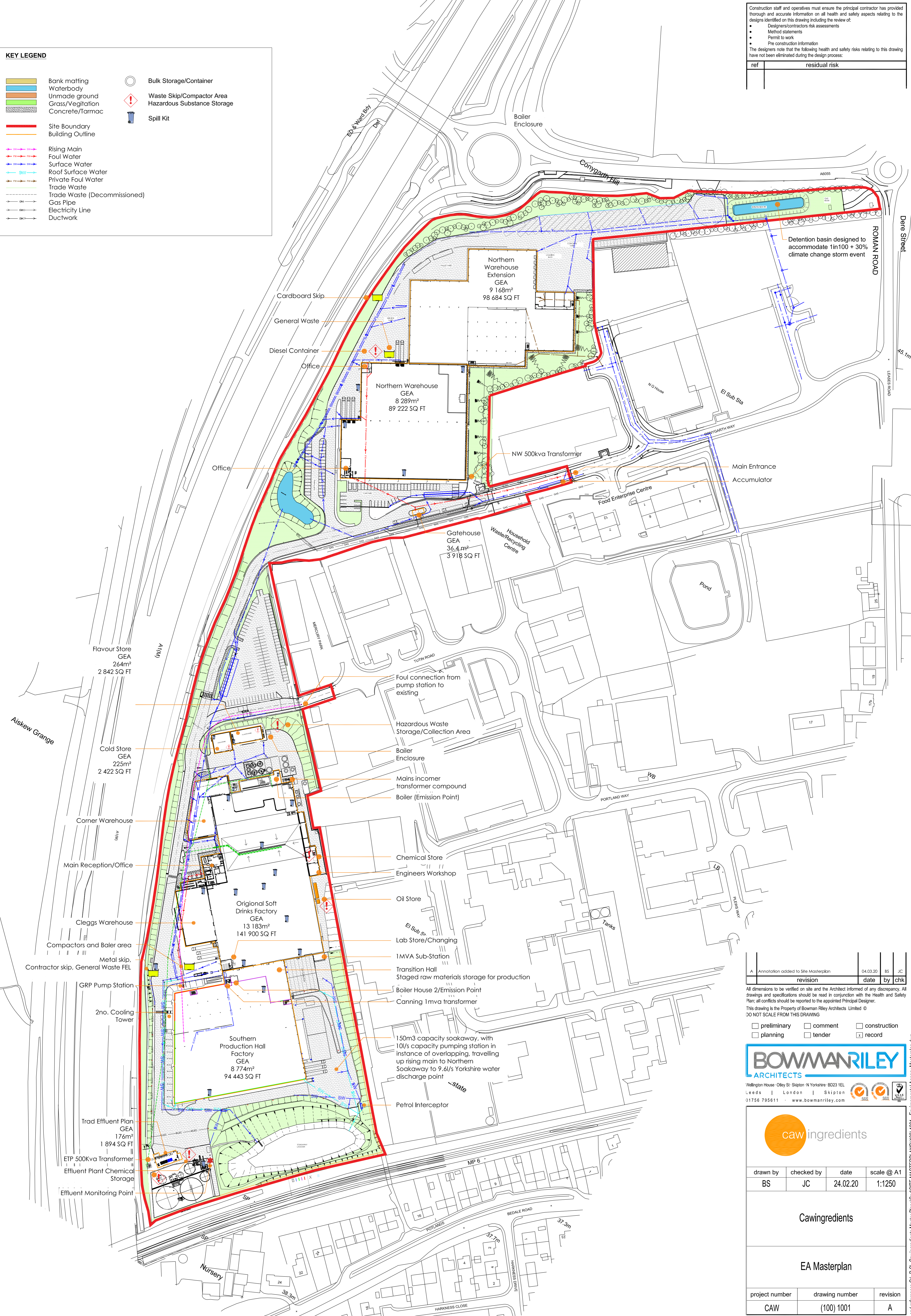

Detention basin designed to accommodate 1in100 + 30% climate change storm event

Flavour Store
GEA
264m²
2 842 SQ FT

Cold Store
GEA
225m²
2 422 SQ FT

Corner Warehouse

Main Reception/Office

Cleggs Warehouse

Compactors and Baler area
Metal skip,
Contractor skip, General Waste FEL

GRP Pump Station

2no. Cooling Tower

Trad Effluent Plan
GEA
176m²
1 894 SQ FT

EIP 500Kva Transformer

Effluent Plant Chemical Storage

Effluent Monitoring Point

Cardboard Skip

General Waste

Diesel Container

Office

Northern Warehouse
GEA
8 289m²
89 222 SQ FT

Office

Northern Warehouse Extension
GEA
9 168m²
98 684 SQ FT

NW 500kva Transformer

Food Enterprise Centre

Gatehouse
GEA
36.4m²
3 918 SQ FT

Waste/Recycling Centre

Household

Foul connection from pump station to existing

Hazardous Waste Storage/Collection Area

Boiler Enclosure

Mains incomer transformer compound

Boiler (Emission Point)

Chemical Store

Engineers Workshop

Oil Store

Lab Store/Changing

1MVA Sub-Station

Transition Hall

Staged raw materials storage for production

Boiler House 2/Emission Point

Canning 1mva transformer

150m³ capacity soakaway, with 10l/s capacity pumping station in instance of overlapping, travelling up rising main to Northern Soakaway to 9.6l/s Yorkshire water discharge point

Petrol Interceptor

Trad Effluent Plan

EIP 500Kva Transformer

Effluent Plant Chemical Storage

Effluent Monitoring Point

revision	date	by	chk
A	04.03.20	BS	JC

All dimensions to be verified on site and the Architect informed of any discrepancy. All drawings and specifications should be read in conjunction with the Health and Safety Plan; all conflicts should be reported to the appointed Principal Designer. This drawing is the Property of Bowman Riley Architects Limited © DO NOT SCALE FROM THIS DRAWING

- preliminary
- planning
- comment
- tender
- construction
- record

BOWMAN RILEY ARCHITECTS

Wellington House · Otley St · Skipton · N Yorkshire · BD23 1EL
Leeds | London | Skipton
01756 795611 · www.bowmanriley.com

CAW ingredients

drawn by	checked by	date	scale @ A1
BS	JC	24.02.20	1:1250

Cawingredients

EA Masterplan

project number	drawing number	revision
CAW	(100) 1001	A

cat reference: G1_P-C_Cawingredients Master Plans/CAW SITE MASTERPLANS(100)1001 - Environmental Agency Masterplan.dwg