

AIR EMISSIONS						
Release Point Reference						
A22	A14	A31	A15	A17	A26	A10
	A19	A32	A16	A18	A36	A11
	A20	A33			A37	A12
	A21	A34			A38	A13
	A23	A35			A39	A8
	A24					A9
	A25					
THERMAL ABATEMENT	DUST EXTRACTION	HTII-1	HTII-2	FUME EXTRACTION	BOILER EMISSIONS	EMERGENCY RELIEF VENTS FOR CVD FURNACES

ENLARGED VIEW OF PPC AREA  
SHOWING DRAINAGE AND  
EMISSION POINTS

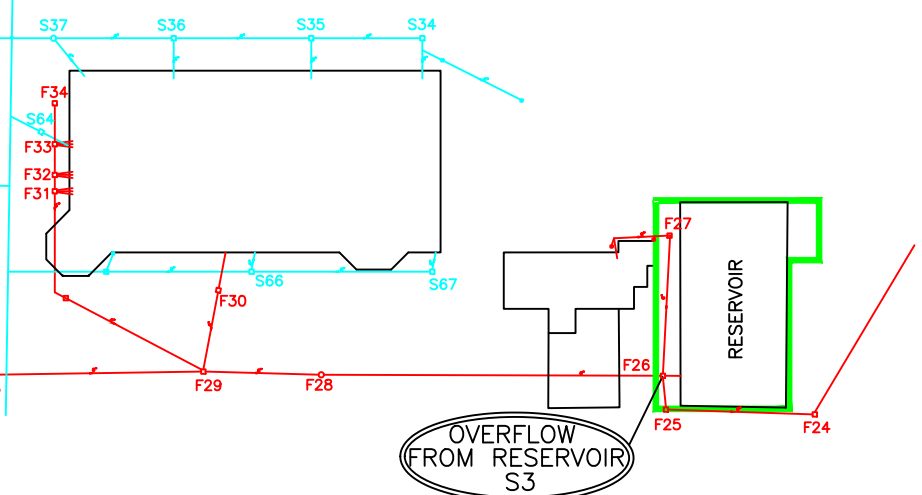

SEWER (FOUL) WATER EMISSIONS			
S1	S2	S3	S4
BOILER BLOW DOWN	DRAIN FROM COOLING TOWERS	OVERFLOW FROM RESERVOIR	DRAIN FOR NEW COOLING TOWERS

STORM WATER EMISSIONS	
Release Point Reference	
W1	
COMBINED STORM WATER EXIT FROM WHOLE SITE	

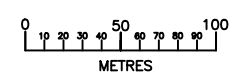
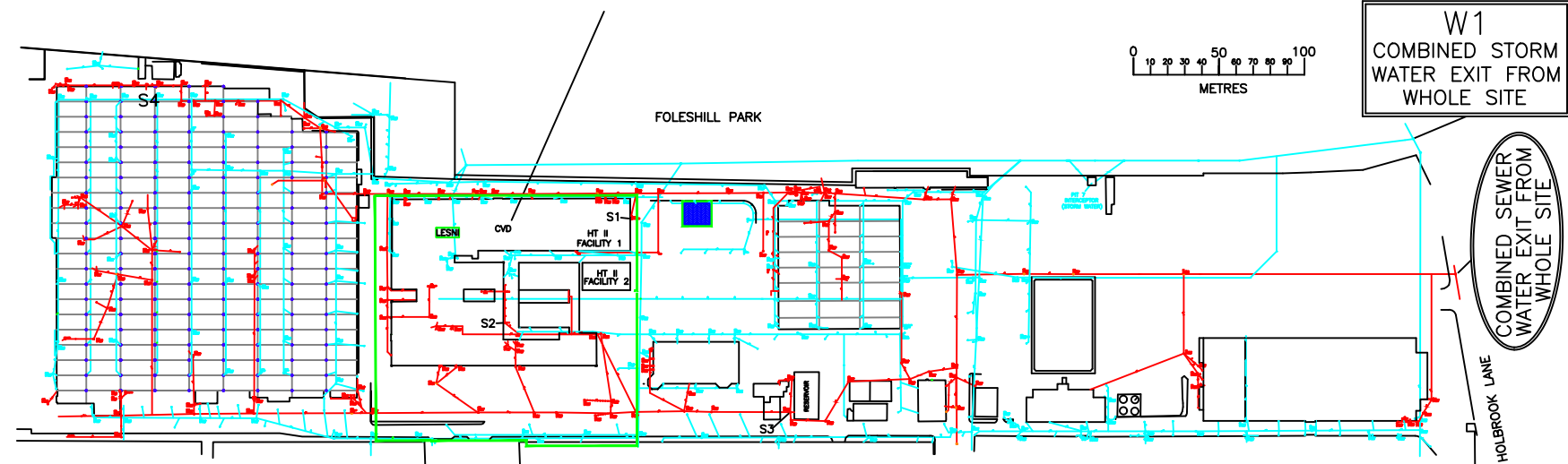

W1  
COMBINED STORM  
WATER EXIT FROM  
WHOLE SITE

COMBINED SEWER  
WATER EXIT FROM  
WHOLE SITE

© 2019 RPS Group

Notes

1. This drawing has been prepared in accordance with the scope of RPS's appointment with its client and is subject to the terms and conditions of that appointment. RPS accepts no liability for any use of this document other than by its client and only for the purposes for which it was prepared and provided.
2. If received electronically it is the recipient's responsibility to print to correct scale. Only written dimensions should be used.
3. Where applicable Ordnance Survey (c) Crown Copyright 2019. All rights reserved. Licence number 0100031673

Legend

- Permit Boundary
- Storm Drain
- Sewer (Foul) Drain

Data Source

Drawing WE 3262 Issue 6 (Dated May 2017)

Rev	Description	By	CB	Date



260 Park Avenue, Aztec West, Almondsbury, Bristol BS32 4SY  
T: 01454 853 000 E: rpsww@rpsgroup.com

Client Meggitt Aerospace Ltd.

Project Meggitt Nu-Carb Variation

Title Air & Water Emission Points

Status Draft  
Drawn By RJ  
PM/Checked by TC

Job Ref JER8395  
Scale @ A3 NTS  
Date Created APR 2020

RPS Drawing / Figure Number JER8395-PER-003  
Rev -

rpsgroup.com