

All dimensions to be verified on site. Figured dimensions to take precedence to those scaled. Any areas indicated on this drawing are for guidance only, no responsibility is taken for their accuracy.
 The drawing is the property of GP Planning Limited. Copyright is reserved by them and the drawing is issued on the condition that it is not copied, reproduced, retained or disclosed to any unauthorized person, either wholly or in part without the written consent in writing of GP Planning.
 © 2023 GP Planning Limited. All rights reserved.

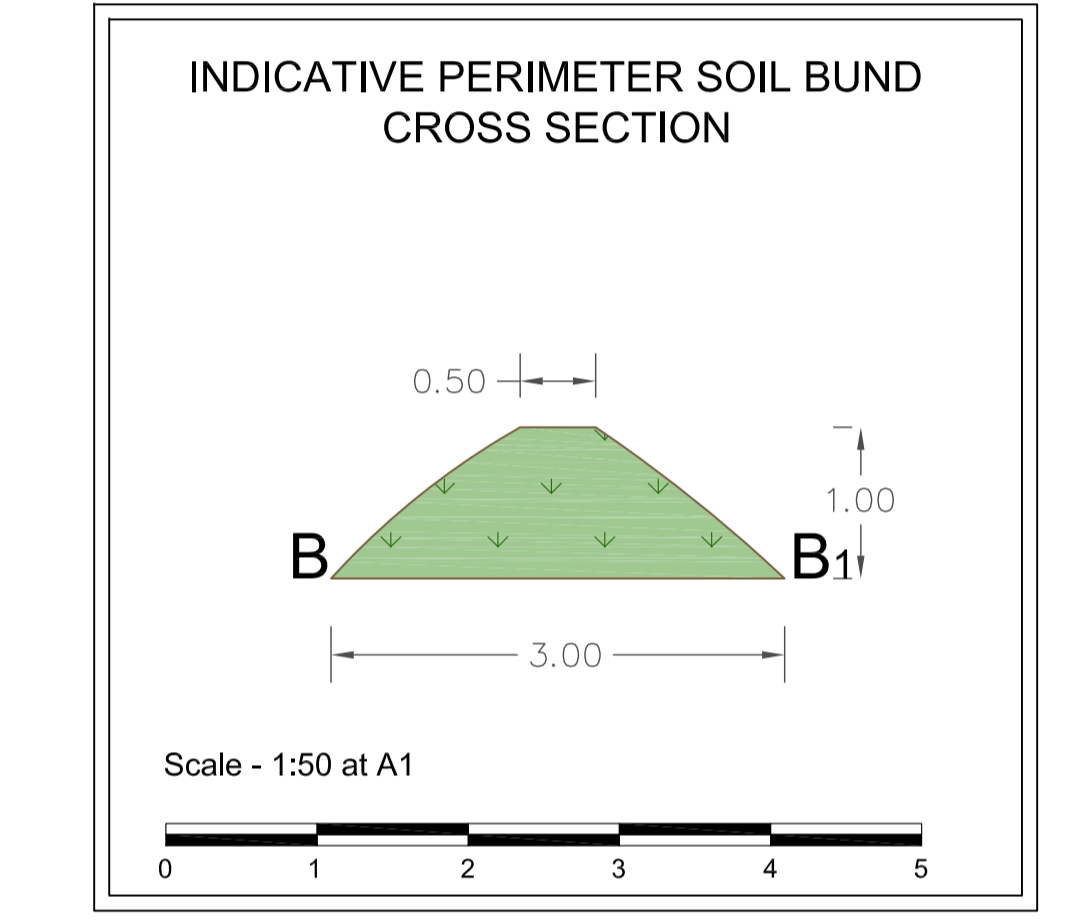
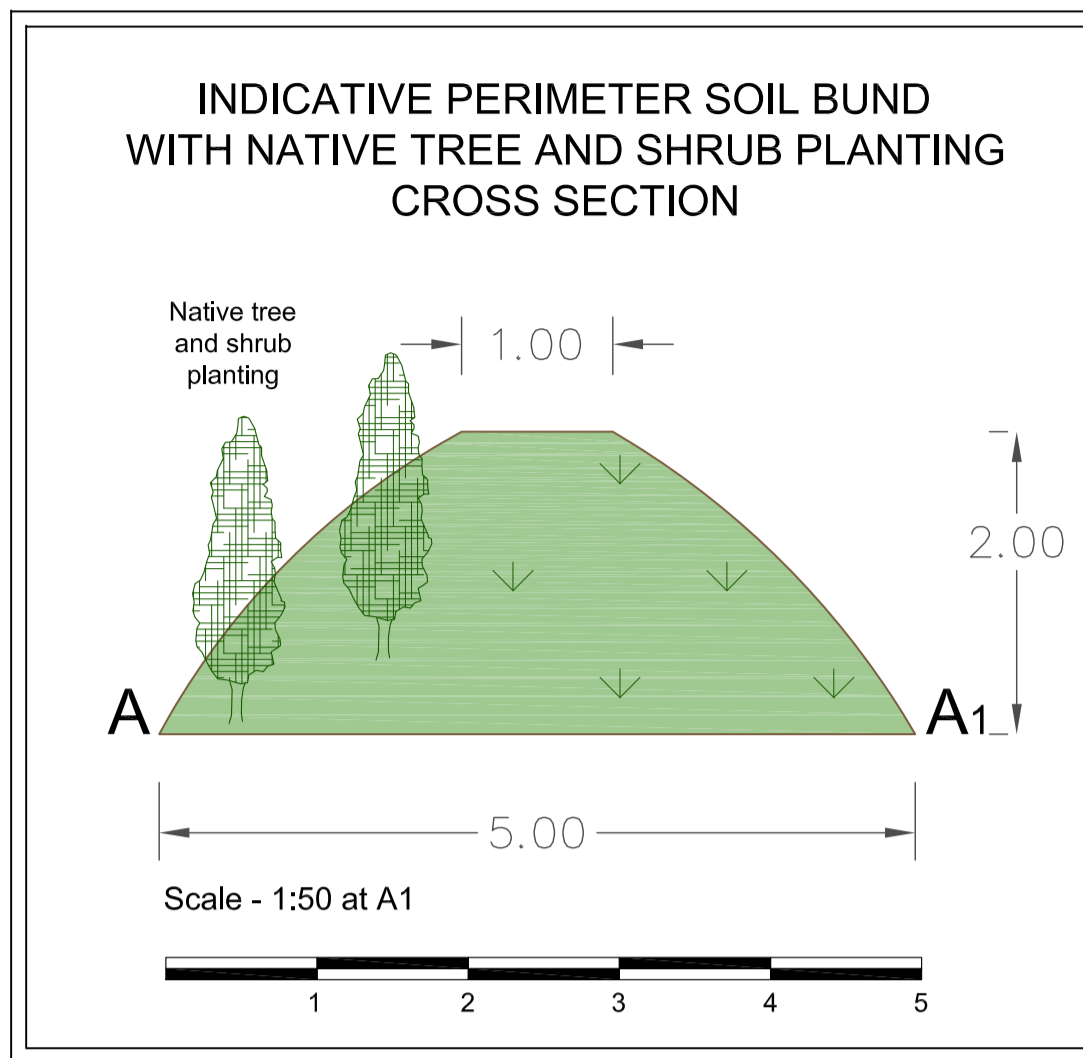
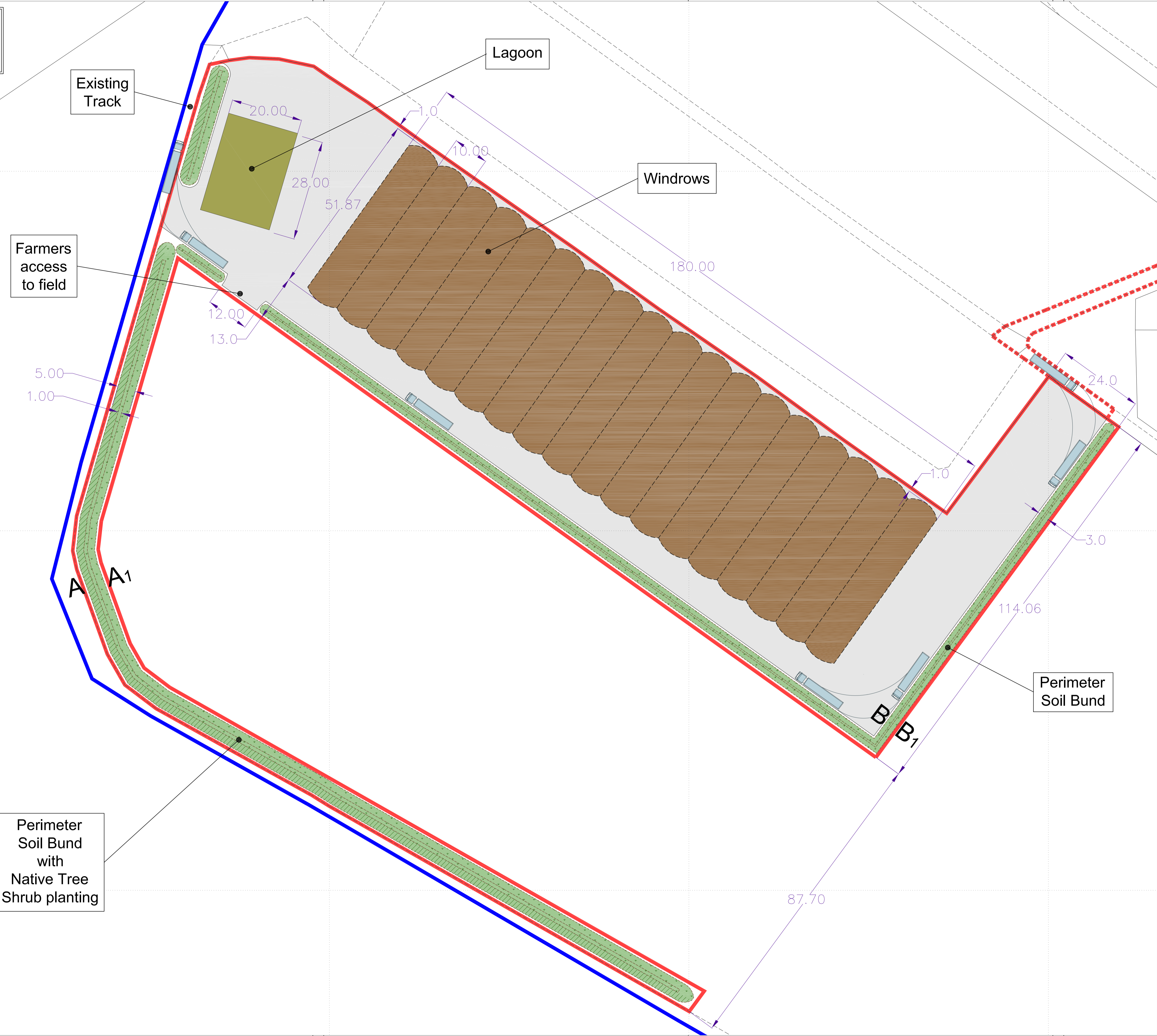

DRAFT V2

| | | | |
|----------|--|----|----------|
| draft v2 | Lagoon relocation slightly to allow for perimeter bund. Perimeter bund with native tree and shrub planting width reduced to 5m. Concrete area added, passing bays and track removed. Farmers access to field added. Perimeter bund with native tree and shrub planting to the south put back at reduced width (5m). Planning application boundary amended accordingly. | KD | 29/01/24 |
| draft v1 | Lagoon relocation slightly to the south. Perimeter bund height reduced to 2m. Planning application boundary reduced from the south, perimeter bund with native tree and shrub planting removed. Passing bays, vehicle movement and straw bales added. Discussion re location of lagoon and straw bales. | KD | 22/01/24 |
| draft v0 | Perimeter soil bund with native tree and shrub planting added to outer edge of site. Smaller bund added to run alongside track. Lagoon added. Planning application boundary updated. Site layout to be confirmed. | KD | 18/12/23 |

| | | | |
|---|--|--|-------------|
| | | Planning Consultants T: 01604 771123 E: info@gpplanning.co.uk W: www.gpplanning.co.uk iCon Environmental Innovation Centre, Eastern Way, Daventry, Northamptonshire, NN11 0GB Registered in England No. 6019669 | |
| TITLE: | Proposed Extension at Birch Airfield Composting, Blind Lane, Colchester Site Layout Plan | | |
| CLIENT: | BIRCH AIRFIELD COMPOSTING SERVICES LIMITED | | |
| <small>Ordnance Survey Licence; Reproduction from the Ordnance Survey Map with sanction of the Controller of Her Majesty's Stationary Office © Crown Copyright, Licence number 100036801. For Identification purposes only.</small> | | | |
| DRAWN BY: | KD | CHECKED BY: | CS |
| DRAWING NO.: | GPP/BAC/C/EXT/23/02 | REV NO.: | 1 draft v2 |
| SCALE: | 1:500 at A1 | DATE: | 08 Dec 2023 |
| SCALE BAR: | | | |