



Notes:

- Legend:
- Hardstanding
 - Tarmac
 - Compacted Stone
 - Plant parking by night loading by day
 - Quarantine Area
 - Fridges, Tyres and Plasterboard
 - 2no FLT's chargers
 - Workshop Area
 - Spare RORO
 - Quick action doors
 - Waste Transfer Station Environmental Permit Boundary
 - Fire Walls
 - Call Point
 - Co2 Extinguisher
 - Foam Extinguisher
 - 60,000 Litre GTL Tank

- Approximate Waste Bay Sizes:
- Metal: 4.7m x 6.2m
 - General after picking: 4.7m x 6.2m
 - Cardboard: 6.3m x 12.5m
 - Hardcore: 6.3m x 7m
 - Glass: 6.3m x 4m
 - Green: 6.3m x 5.2m
 - Plastic: 6.2m x 7.7m
 - Flock: 6.2m x 8m
 - Mattress: 12.7m x 17.2m
 - Wood: 12.7m x 13.3m
 - Carpet: 5.3m x 6.3m
 - General: 9m x 6.3m
 - Processing Building Bays: 10.7m x 6m

| Rev | Amendments | Date | By | Chk | Auth |
|-----|------------|------|----|-----|------|
| | | | | | |



Drawing Status & Suitability Code

PERMITTING

Client



Project

AVONMOUTH WASTE TRANSFER STATION

Drawing Title

SITE LAYOUT DURING CONSTRUCTION

Scale

| | | | |
|----------|--------|-----------------|------------|
| 1:500 | @ A1 | SLR Project No. | 08721 |
| Designed | Drawn | Checked | Authorised |
| MS | RW | DP | HK |
| Date | Date | Date | Date |
| OCT 23 | OCT 23 | OCT 23 | OCT 23 |

Drawing Number

005

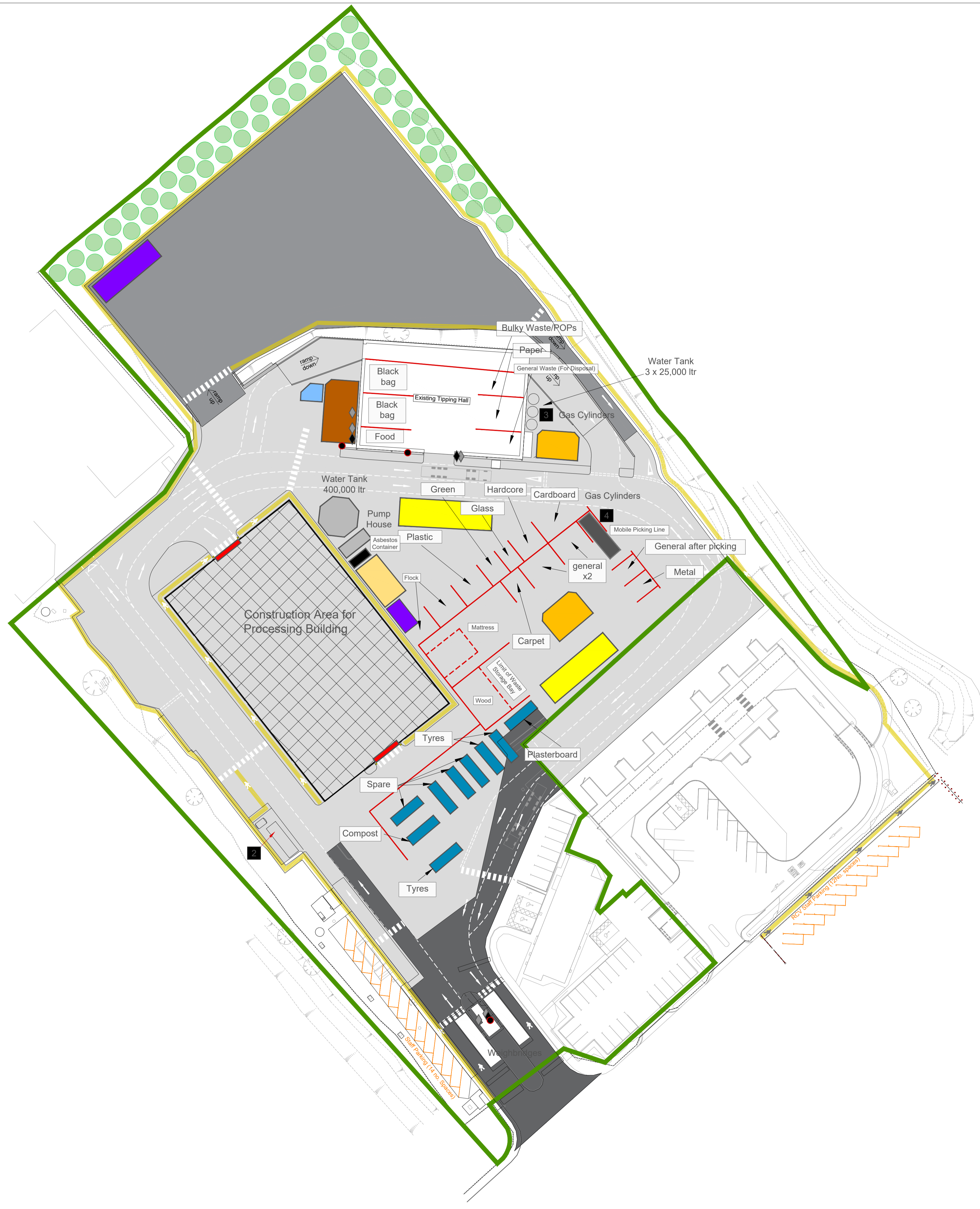

03/10/2024

\\nauf6\BRAFS-EP\Projects\402\08721 - Bristol Waste Company\402_V\54839\0001 - Avonmouth WTS Planning and Design\Tech\OVDwg\Wkg\Permit Drawings\RW\402_08721_00006\07_0_EXISTING_OPERATIONAL_SPACE_ALLOCATION_231221_AR.dwg