

ALL INFORMATION ON THIS DRAWING IS INDICATIVE ONLY, AND MAY BE SUBJECT TO FURTHER DESIGN DEVELOPMENT.
DO NOT SCALE

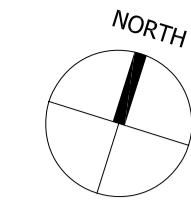

KEY
 INSTALLATION BOUNDARY
 MATERIALS STORAGE AREAS

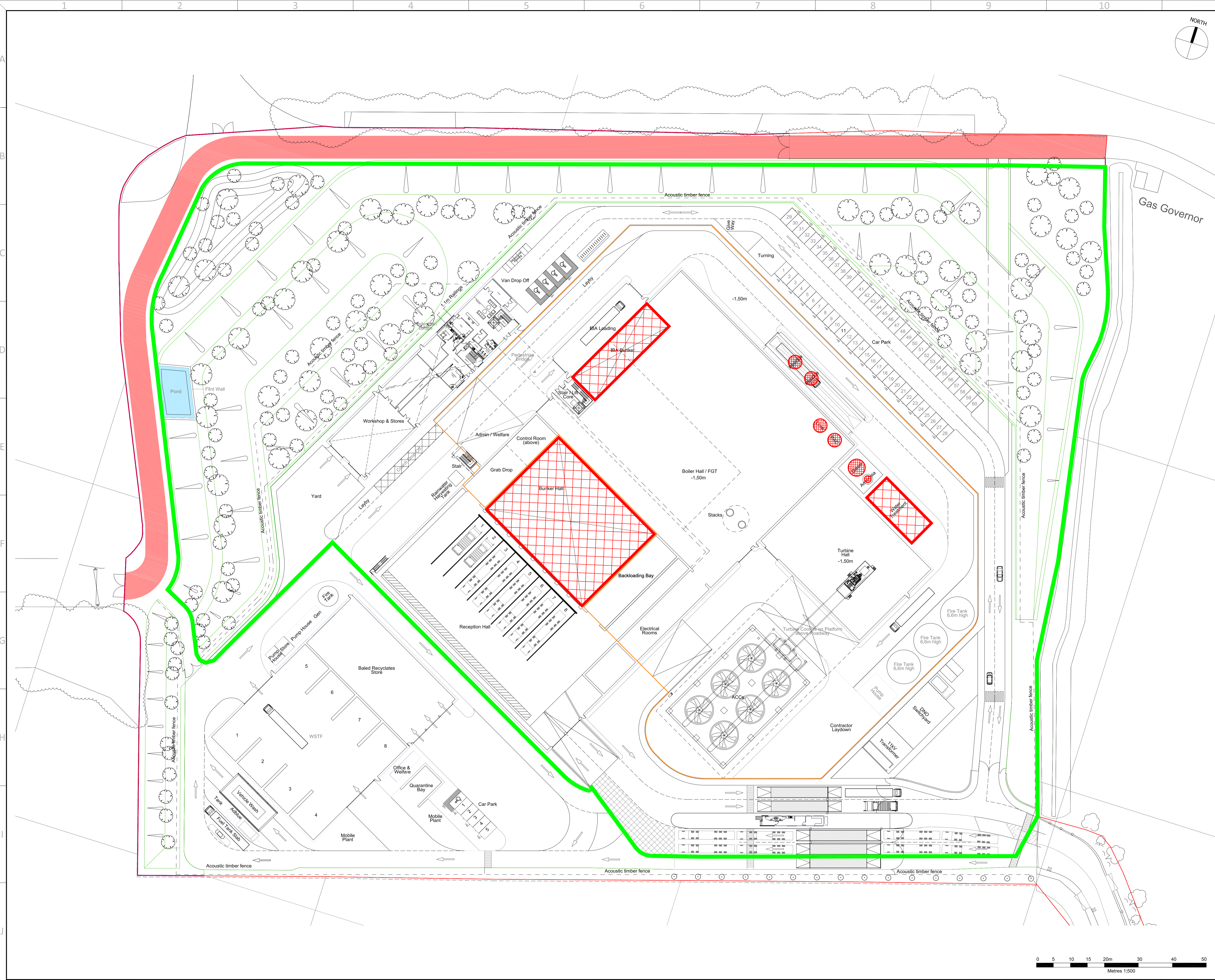

R3.0	SITE LAYOUT AMENDED	AO	KLH	JRS	09.04.21
R2.0	SITE LAYOUT AMENDED	AO	KLH	JRS	26.01.21
R1.0	PRELIMINARY	AO	KLH	JRS	17.12.20
R0.0	PRELIMINARY	AO	KLH	JRS	15.12.20
REV.	DETAILS OF REVISION	DRAWN	CHKD	APR	DATE

FICHTNER
CONSULTING ENGINEERS LIMITED
Kingsgate, Wellington Road North,
Stockport, Cheshire, SK4 1LW, UK Tel:
0161 476 0032
Website: www.fichtner.co.uk

CLIENT: **FORD EFW Ltd**

SITE: **FORD CIRCULAR TECHNOLOGY PARK**

PROJECT: **EP APPLICATION RESUBMISSION**

TITLE: **MATERIALS STORAGE AREAS -ERF**

DRAWING STATUS:	PRELIMINARY				
DRAWN BY:	AO	DATE:	15.12.20		
CHECKED BY:	KLH	DATE:	15.12.20		
APPROVED BY:	JRS	DATE:	15.12.20		
FILENAME:	S2881-8000-0012A01 MATERIALS STORAGE AREAS -ERF R3.0				
OFFICE OF ISSUE:	STOCKPORT				
SHEET SIZE:	A1	SCALE:	1:500		
DRAWING No.:	S2881-8000-0012				REVISION:
	Sheet 1 of 1				R3.0

